

F.A.S. RTE.	SECTION	COUNTY	TOTAL SHEETS	SHEET NO.
2320	113X-N	WILL	133	52
STA.		TO STA.		
FED. ROAD DIST. NO.		ILLINOIS FED. AID PROJECT		
171+78.5		CONTRACT NO. 62910		
167.5' LT		172+12.5		
		158.7' LT		

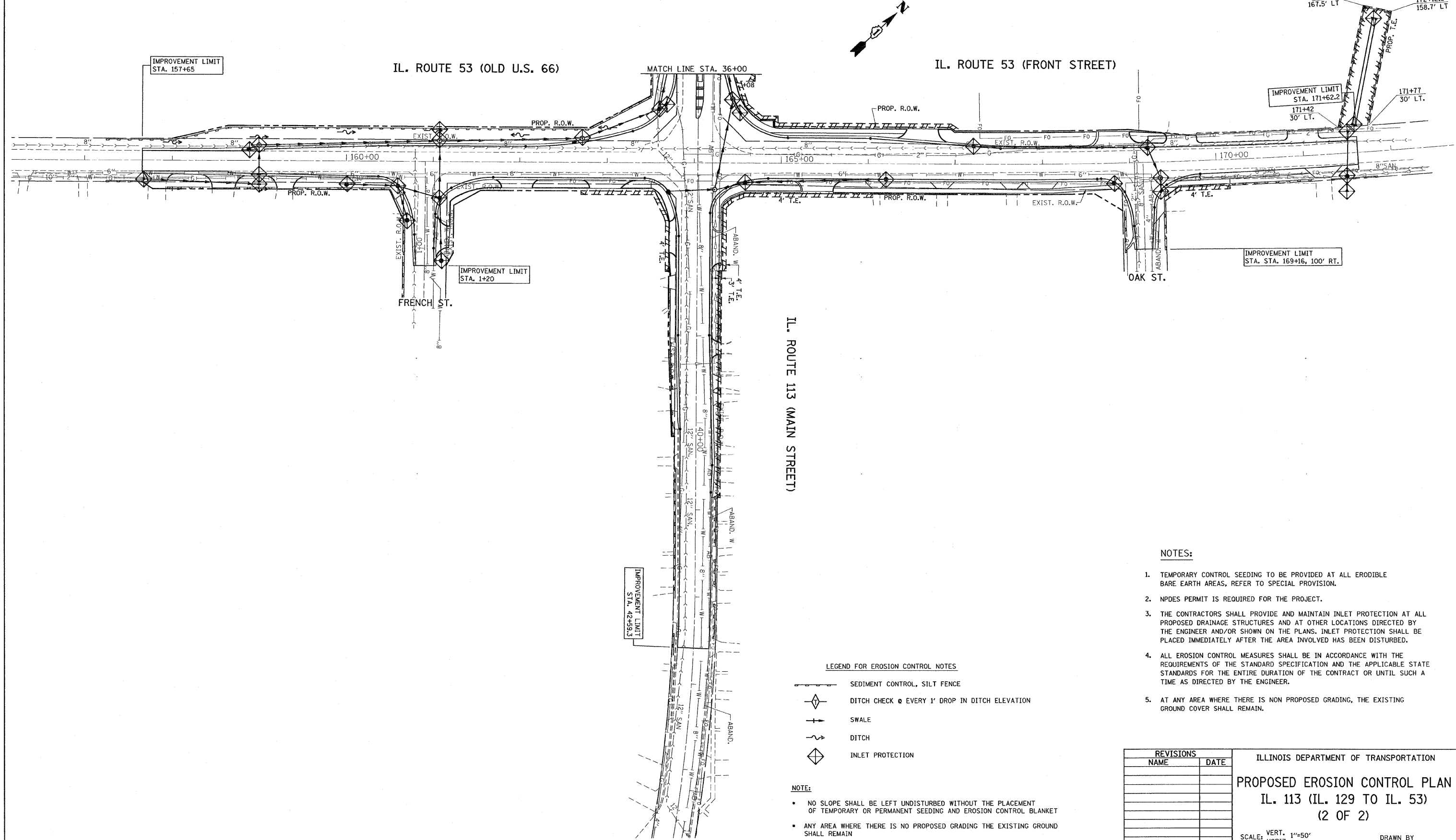

NOTES:

1. TEMPORARY CONTROL SEEDING TO BE PROVIDED AT ALL ERODIBLE BARE EARTH AREAS, REFER TO SPECIAL PROVISION.
2. NPDES PERMIT IS REQUIRED FOR THE PROJECT.
3. THE CONTRACTORS SHALL PROVIDE AND MAINTAIN INLET PROTECTION AT ALL PROPOSED DRAINAGE STRUCTURES AND AT OTHER LOCATIONS DIRECTED BY THE ENGINEER AND/OR SHOWN ON THE PLANS. INLET PROTECTION SHALL BE PLACED IMMEDIATELY AFTER THE AREA INVOLVED HAS BEEN DISTURBED.
4. ALL EROSION CONTROL MEASURES SHALL BE IN ACCORDANCE WITH THE REQUIREMENTS OF THE STANDARD SPECIFICATION AND THE APPLICABLE STATE STANDARDS FOR THE ENTIRE DURATION OF THE CONTRACT OR UNTIL SUCH A TIME AS DIRECTED BY THE ENGINEER.
5. AT ANY AREA WHERE THERE IS NON PROPOSED GRADING, THE EXISTING GROUND COVER SHALL REMAIN.

LEGEND FOR EROSION CONTROL NOTES

- SEDIMENT CONTROL, SILT FENCE
- ◇ DITCH CHECK @ EVERY 1' DROP IN DITCH ELEVATION
- + SWALE
- DITCH
- ◇ INLET PROTECTION

NOTE:

- NO SLOPE SHALL BE LEFT UNDISTURBED WITHOUT THE PLACEMENT OF TEMPORARY OR PERMANENT SEEDING AND EROSION CONTROL BLANKET
- ANY AREA WHERE THERE IS NO PROPOSED GRADING THE EXISTING GROUND SHALL REMAIN

REVISIONS	
NAME	DATE

ILLINOIS DEPARTMENT OF TRANSPORTATION
PROPOSED EROSION CONTROL PLAN
IL. 113 (IL. 129 TO IL. 53)
(2 OF 2)
 SCALE: VERT. 1"=50'
 HORIZ. DATE 9/14/2007
 DRAWN BY
 CHECKED BY