

*REF-pmk02

F.A.S. RTE.	SECTION	COUNTY	TOTAL SHEETS	SHEET NO.
2320	113X-N	WILL	133	75
STA.		TO STA.		
FED. ROAD DIST. NO.		ILLINOIS FED. AID PROJECT		
171+78.5		CONTRACT NO. 62910		
167.5' LT		172+12.5		
		158.7' LT		

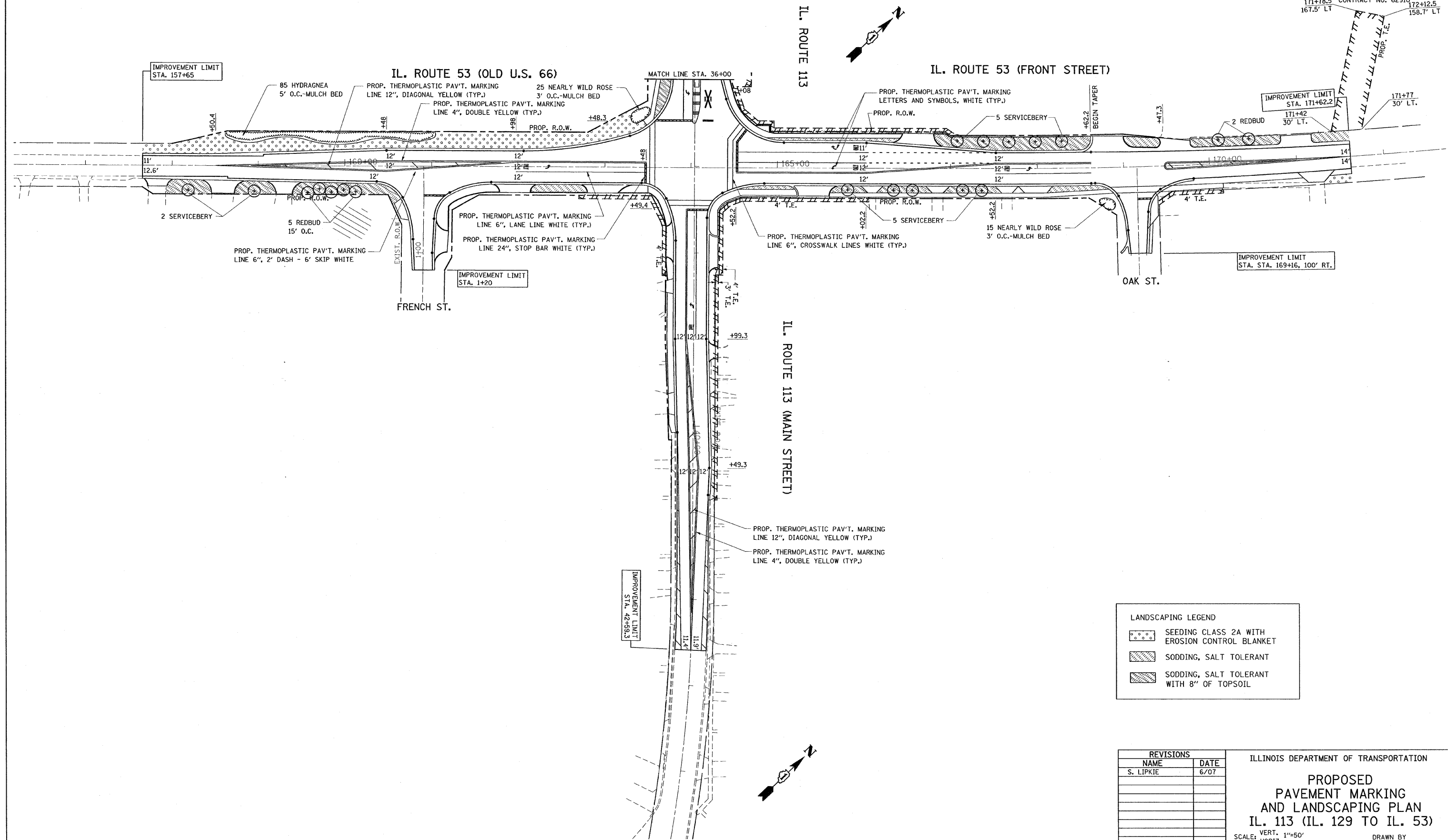

LANDSCAPING LEGEND

	SEEDING CLASS 2A WITH EROSION CONTROL BLANKET
	SODDING, SALT TOLERANT
	SODDING, SALT TOLERANT WITH 8" OF TOPSOIL

REVISIONS	
NAME	DATE
S. LIPKIE	6/07

ILLINOIS DEPARTMENT OF TRANSPORTATION

PROPOSED PAVEMENT MARKING AND LANDSCAPING PLAN

IL. 113 (IL. 129 TO IL. 53)

SCALE: VERT. 1"=50'
HORIZ. DATE 9/14/2007

DRAWN BY
CHECKED BY