

F.A.U. RTE.	SECTION	COUNTY	TOTAL SHEETS	SHEET NO.
363	06-00339-00-TL	KANE	33	4
STA.		TO STA.		
FED. ROAD DIST. NO. 7		ILLINOIS FED. AID PROJECT		

EXISTING AND PROPOSED CONTROLLER SEQUENCE

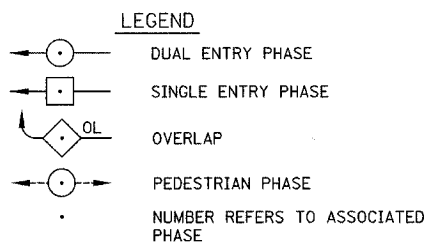

PHASE DESIGNATION DIAGRAM

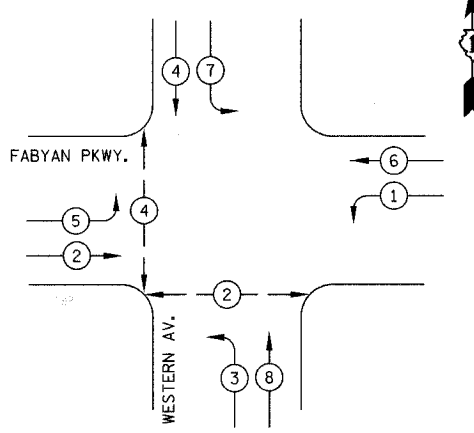
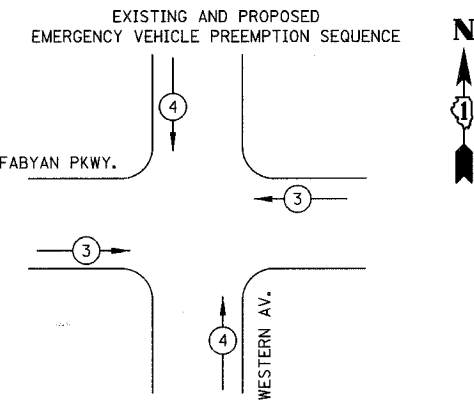

PROPOSED EMERGENCY VEHICLE PREEMPTORS

EMERGENCY VEHICLE PREEMPTOR	3	4
MOVEMENT	←	↑

CABLE PLAN LEGEND

- |          |          |   |
|----------|----------|---|
| EXISTING | PROPOSED |   |
|          |          | 8" (200mm) TRAFFIC SIGNAL SECTION   |
|          |          | 12" (300mm) TRAFFIC SIGNAL SECTION  |
|          |          | 12" (300mm) PEDESTRIAN SIGNAL SECTION   |
|          |          | CONTROLLER CABINET  |
|          |          | SERVICE INSTALLATION  |
|          |          | TELEPHONE CONNECTION  |
|          |          | MAGNETIC DETECTOR   |
|          |          | EMERGENCY VEHICLE LIGHT DETECTOR  |
|          |          | CONFIRMATION BEACON   |
|          |          | PUSHBUTTON DETECTOR   |
|          |          | VEHICLE DETECTOR, INDUCTION LOOP  |
|          |          | DENOTES NUMBER OF CONDUCTORS, ALL CABLE NO. 14 EXCEPT AS INDICATED. ALL LOOP DETECTOR CABLE TO BE SHIELDED. |
|          |          | MICROWAVE VEHICLE SENSOR  |
|          |          | SIGNAL FACE WITH BACKPLATE, "P" INDICATES PROGRAMMED HEAD   |
|          |          | RAILROAD CONTROL CABINET  |
|          |          | ILLUMINATED SIGN "NO LEFT TURN"   |
|          |          | ILLUMINATED SIGN "NO RIGHT TURN"  |
|          |          | GROUND ROD AT HANDHOLE (H), DOUBLE HANDHOLE (H), OR CONTROLLER (C).   |
|          |          | GROUND ROD AT POST (P), OR MAST ARM POLE (MA).  |
|          |          | GROUND ROD AT ELECTRIC SERVICE INSTALLATION   |
|          |          | GROUND CABLE IN CONDUIT NO. 6 SOLID COPPER (GREEN)  |
|          |          | FIBER OPTIC CABLE IN CONDUIT NO. 62.5/125 2-MM12F SM12F   |
|          |          | COAXIAL CABLE   |
|          |          | IMAGE SENSOR  |
|          |          | STREET LIGHT LUMINAIRE  |
|          |          | DOMED PAN/TILT/ZOOM (PTZ) CAMERA  |
|          |          | UNINTERRUPTIBLE POWER SUPPLY  |
|          |          | "R" RELOCATED SIGNAL EQUIPMENT  |

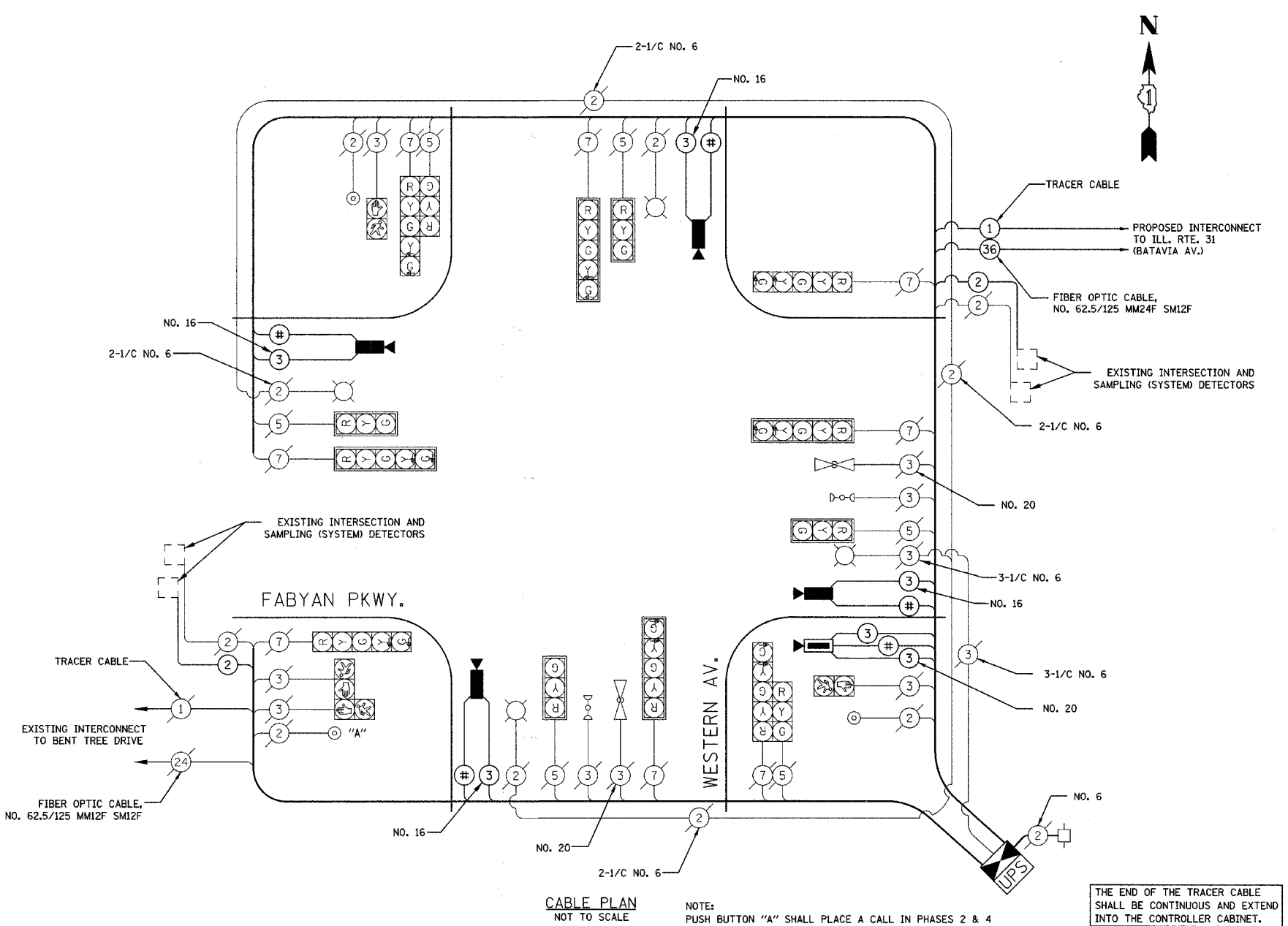

CABLE PLAN NOT TO SCALE

NOTE: PUSH BUTTON "A" SHALL PLACE A CALL IN PHASES 2 & 4

THE END OF THE TRACER CABLE SHALL BE CONTINUOUS AND EXTEND INTO THE CONTROLLER CABINET.

SCHEDULE OF QUANTITIES

PAY ITEM	UNIT	QUANTITY
MAINTENANCE OF EXISTING TRAFFIC SIGNAL INSTALLATION	EACH	1
FULL-ACTUATED CONTROLLER AND TYPE IV CABINET, SPECIAL	EACH	1
TRANSCIVER - FIBER OPTIC	EACH	1
ELECTRIC CABLE IN CONDUIT, SIGNAL NO. 14 3C	FOOT	98
ELECTRIC CABLE IN CONDUIT, LEAD-IN, NO. 14 1 PAIR	FOOT	868
INDUCTIVE LOOP DETECTOR	EACH	4
RELOCATE EXISTING EMERGENCY VEHICLE PRIORITY SYSTEM.	EACH	1
PHASING UNIT		
REMOVE ELECTRIC CABLE FROM CONDUIT	FOOT	1031
REMOVE EXISTING TRAFFIC SIGNAL EQUIPMENT	EACH	1
REMOVE EXISTING HANDHOLE	EACH	1
UNINTERRUPTIBLE POWER SUPPLY	EACH	1
ELECTRIC CABLE IN CONDUIT, SIGNAL NO. 16 3/C	FOOT	1026
ELECTRIC CABLE IN CONDUIT, COAXIAL	FOOT	1124
ELECTRIC CABLE IN CONDUIT, VIDEO, NO. 20 3C	FOOT	98
VIDEO DETECTION SYSTEM COMPLETE INTERSECTION	EACH	1
INTERSECTION VIDEO TRAFFIC MONITORING SYSTEM WITH PTZ CAMERA	EACH	1

NOTE: THE TRAFFIC SIGNAL CONTROLLER EQUIPMENT FOR THIS PROJECT SHALL BE "EAGLE" TO MATCH THE EXISTING ADJACENT SYSTEM.

REVISIONS

NAME	DATE

KANE COUNTY DIVISION OF TRANSPORTATION  
 CABLE PLAN, PHASE DESIGNATION DIAGRAM, EMERGENCY VEHICLE PREEMPTION SEQUENCE AND SCHEDULE OF QUANTITIES  
 FABYAN PARKWAY & WESTERN AVENUE  
 SCALE: NOT TO SCALE  
 DATE: 12/14/2007  
 DRAWN BY: CEC  
 DESIGNED BY: BRD/JSH  
 CHECKED BY: JJE

I.D.O.T. TRAFFIC SIGNAL INSTALLATION ELECTRICAL SERVICE REQUIREMENTS

TYPE	NO. LAMPS	WATTAGE	% OPERATION	TOTAL WATTAGE
SIGNAL (RED)	14	17	0.50	119
(YELLOW)	14	25	0.25	88
(GREEN)	14	15	0.25	53
ARROW	16	12	0.10	20
PED. SIGNAL	4	25	1.00	100
CONTROLLER	1	100	1.00	100
VIDEO SYSTEMS	1	150	1.00	150
LUMINAIRE	4	310	0.50	620
FLASHER			0.50	
TOTAL =				1250

ENERGY COSTS TO: CITY OF BATAVIA  
 100 N. ISLAND AVENUE  
 BATAVIA, IL 60510  
 ENERGY SUPPLY: CONTACT: STEVE LUSTED  
 PHONE: (630) 879-1424  
 COMPANY: CITY OF BATAVIA

FOUNDATION (DEPTH)	FT. (m)	CABLE SLACK	FT. (m)	VERTICAL	FT. (m)
TYPE A - POST	4 (1.2)	HANDHOLE	6.5 (2.0)	ALL FOUNDATIONS	3.5 (2.0)
D- CONTROLLER	4 (1.2)	DOUBLE HANDHOLE	13 (4.0)	MAST ARM (L) POLE	20'H-2= (6m+L-0.6m)=
E- M. ARM POLE		SIGNAL POST	2 (1.0)	BRACKET MOUNTED	13 (4.0)
24" (600mm)	10 (3.0)	CONTROLLER CAB.	1 (0.5)	PED. PUSHBUTTON	4 (1.2)
30" (750mm)	15 (4.6)	FIBER OPTIC	13 (4.0)	ELECTRIC SERVICE	13.5 (4.1)
36" (900mm)	15 (4.6)	ELECTRIC SERVICE	1 (0.5)	SERVICE TO GROUND	13.5 (4.1)
		GROUND CABLE	1 (0.5)	POST MOUNTED	6 (1.8)