

F.A.U. RTE.	SECTION	COUNTY	TOTAL SHEETS	SHEET NO.
326	05-00395-00-TL	WILL	31	11
STA.		TO STA.		
FED. ROAD DIST. NO.		ILLINOIS	FED. AID PROJECT	
CONTRACT NO: 83992				

TRAFFIC SIGNAL LEGEND

- | | | |
|--|--|--|
| CONTROLLER | | |
| SERVICE INSTALLATION | | |
| SIGNAL HEAD | | |
| SIGNAL HEAD WITH BACKPLATE | | |
| SIGNAL HEAD, PEDESTRIAN | | |
| SIGNAL POST | | |
| MAST ARM ASSEMBLY AND POLE, STEEL | | |
| MAST ARM ASSEMBLY AND POLE, ALUMINUM | | |
| COMBINATION MAST ARM ASSEMBLY AND POLE, STEEL WITH LUMINAIRE | | |
| UNIT DUCT | | |
| COMMON TRENCH | | |
| HANDHOLE | | |
| HEAVY DUTY HANDHOLE | | |
| DOUBLE HANDHOLE | | |
| G.S. CONDUIT IN TRENCH (T) OR PUSHED (P) | | |
| PEDESTRIAN PUSHBUTTON DETECTOR | | |
| DETECTOR LOOP | | |
| CAST IRON JUNCTION BOX | | |
| EMERGENCY VEHICLE LIGHT DETECTOR | | |
| CONFIRMATION BEACON | | |
| SIGNAL HEAD OPTICALLY PROGRAMMED | | |
| CONDUIT SPLICE | | |
| WOOD POLE | | |
| RACEWAY FOR MAGNETIC DETECTOR, TYPE I OR TYPE II | | |
| VEHICLE DETECTOR, NON COMPENSATED MAGNETIC TYPE | | |
| RAILROAD CONTROL CABINET | | |
| TELEPHONE CONNECTION | | |
| ILLUMINATED SIGN NO LEFT TURN | | |
| ILLUMINATED SIGN NO RIGHT TURN | | |
| RADIO ANTENNA | | |

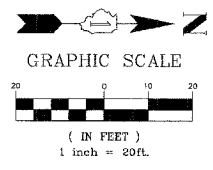

THE TRAFFIC SIGNAL CONTROL EQUIPMENT FOR THIS PROJECT SHALL BE "ECONOLITE."

NEW CABINETS SHALL HAVE FRONT AND BACK DOORS AND A SEPARATE CIRCUIT BREAKER FOR STREET LIGHTING.

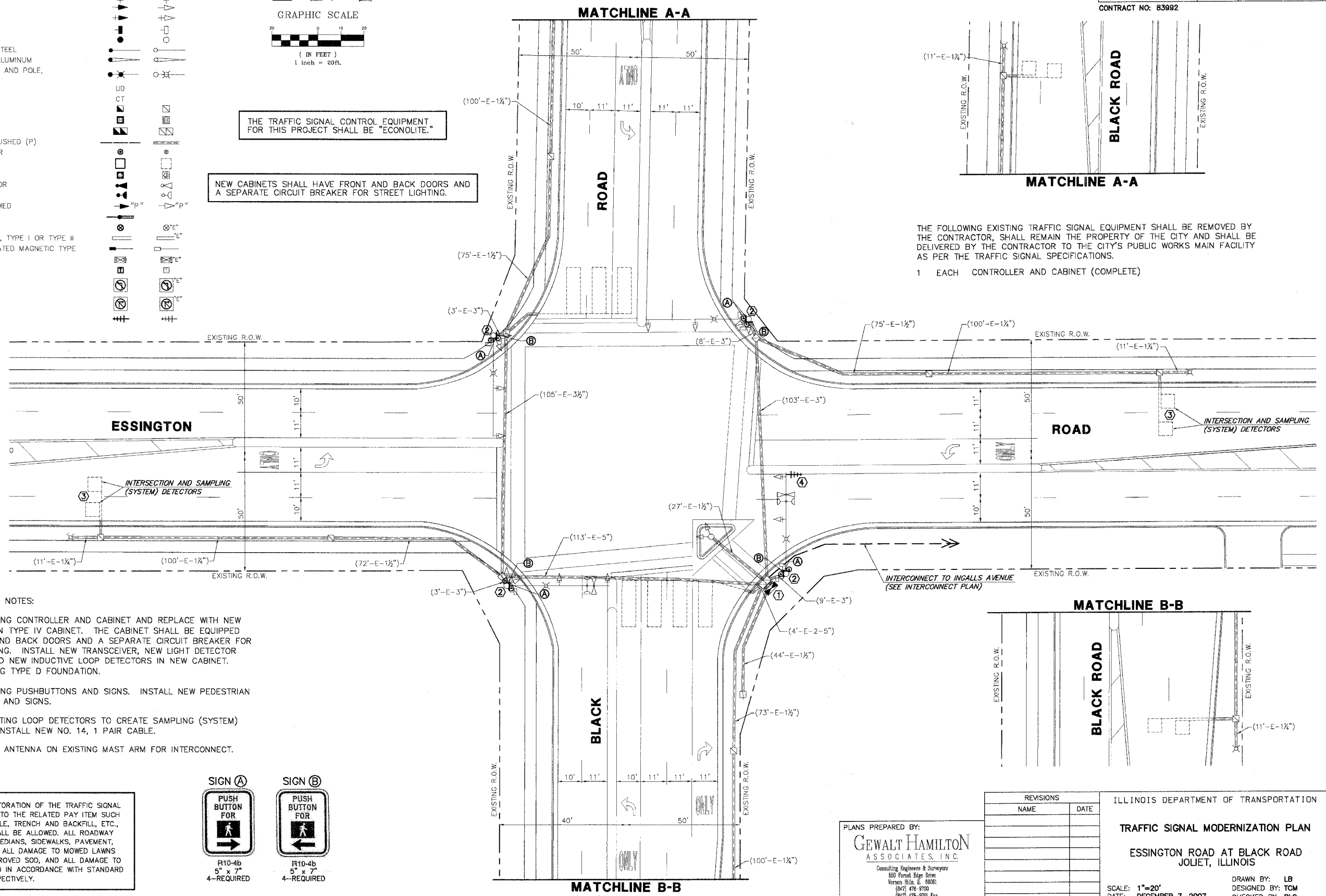

THE FOLLOWING EXISTING TRAFFIC SIGNAL EQUIPMENT SHALL BE REMOVED BY THE CONTRACTOR, SHALL REMAIN THE PROPERTY OF THE CITY AND SHALL BE DELIVERED BY THE CONTRACTOR TO THE CITY'S PUBLIC WORKS MAIN FACILITY AS PER THE TRAFFIC SIGNAL SPECIFICATIONS.

- 1 EACH CONTROLLER AND CABINET (COMPLETE)

CONSTRUCTION NOTES:

- ① REMOVE EXISTING CONTROLLER AND CABINET AND REPLACE WITH NEW CONTROLLER IN TYPE IV CABINET. THE CABINET SHALL BE EQUIPPED WITH FRONT AND BACK DOORS AND A SEPARATE CIRCUIT BREAKER FOR STREET LIGHTING. INSTALL NEW TRANSCEIVER, NEW LIGHT DETECTOR AMPLIFIER, AND NEW INDUCTIVE LOOP DETECTORS IN NEW CABINET. REUSE EXISTING TYPE D FOUNDATION.
- ② REMOVE EXISTING PUSHBUTTONS AND SIGNS. INSTALL NEW PEDESTRIAN PUSHBUTTONS AND SIGNS.
- ③ RESPLICE EXISTING LOOP DETECTORS TO CREATE SAMPLING (SYSTEM) DETECTORS. INSTALL NEW NO. 14, 1 PAIR CABLE.
- ④ INSTALL RADIO ANTENNA ON EXISTING MAST ARM FOR INTERCONNECT.

RESTORATION OF WORK AREA. RESTORATION OF THE TRAFFIC SIGNAL WORK AREA SHALL BE INCIDENTAL TO THE RELATED PAY ITEM SUCH AS FOUNDATION, CONDUIT, HANDHOLE, TRENCH AND BACKFILL, ETC., AND NO EXTRA COMPENSATION SHALL BE ALLOWED. ALL ROADWAY SURFACES SUCH AS SHOULDERS, MEDIANS, SIDEWALKS, PAVEMENT, ETC. SHALL BE REPLACED IN KIND. ALL DAMAGE TO MOWED LAWNS SHALL BE REPLACED WITH AN APPROVED SOO, AND ALL DAMAGE TO UNMOWED FIELDS SHALL BE SEEDED IN ACCORDANCE WITH STANDARD SPECIFICATIONS 252 AND 250 RESPECTIVELY.



REVISIONS	
NAME	DATE

PLANS PREPARED BY:
GEWALT HAMILTON ASSOCIATES, INC.
 Consulting Engineers & Surveyors
 650 Forest Edge Drive
 Vernon Hills, IL 60061
 (847) 476-9700
 (847) 476-9701 Fax

ILLINOIS DEPARTMENT OF TRANSPORTATION
TRAFFIC SIGNAL MODERNIZATION PLAN
 ESSINGTON ROAD AT BLACK ROAD
 JOLIET, ILLINOIS
 SCALE: 1"=20'
 DATE: DECEMBER 7, 2007
 DRAWN BY: LB
 DESIGNED BY: TCM
 CHECKED BY: BLS