

SECTION F-F

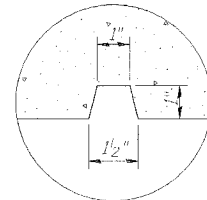

DETAIL A

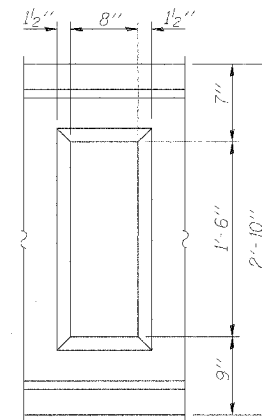

WINDOW DETAIL

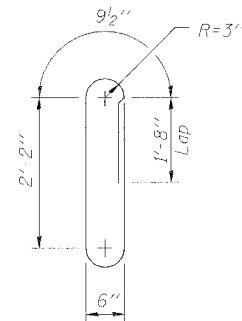

BAR d3(E)

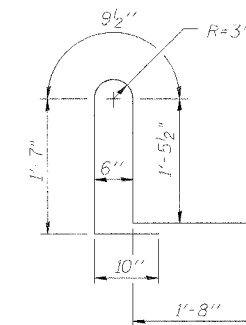

BAR d4(E)

MIN. BAR LAP
 #5 bars = 1'-8"
 #7 bars = 2'-8"

NOTES:

All concrete for railing wall shall be Class BS according to Article 1020.04 of the Standard Specifications. Surface of railing shall receive a rubbed finish according to Article 503.15(b) of the Standard Specifications.
 All parts of the railing including concrete and reinforcing will be paid for at the contract unit price per foot for Concrete Bridge Railing.
 Holes and recesses must be formed or cored. Drilling is not permitted.
 Reinforcement bars designated (E) shall be epoxy coated.
 Bars marked thus 3x2 - #4 etc. indicate 3 lines of bars with 2 lengths per line.
 Work this Sheet with Sheet 6 of 19.

**CONCRETE BRIDGE RAILING
 BILL OF MATERIAL**

Bar No.	Size	Length	Shape
d3(E)	#5	7'-7"	
d4(E)	#5	6'-4"	
e9(E)	#7	17'-9"	
e10(E)	#7	21'-0"	
e11(E)	#5	17'-3"	
e12(E)	#5	20'-6"	
Concrete Bridge Railing		Foot	104

Corporate License Number 184-001-084

CONCRETE BRIDGE RAILING
 FAIRVIEW DRIVE BRIDGE OVER
 SOUTH BRANCH OF KISHWAUKEE RIVER
 FAU 5345
 SECTION 04-00166-00-BR
 DEKALB, ILLINOIS
 STRUCTURE NUMBER 019-6106
 STATION 18+34.34

© Copyright Hanson Professional Services Inc. 2007



JOB NO. 06R1555

DATE 11/05/07

12:40:06 PM
 11/05/2007 12:41 PM
 I:\06\105\067\55\Cont-Struct\Sheet\04-CBR.dgn
 LAYOUT: VWH 11/28/06
 DRAWN: VWH 10/19/07
 REVIEWED: JKR 10/19/07