





**LEGEND**

-  TREE REMOVAL
-  PAVEMENT REMOVAL
- (TBR) - TO BE REMOVED
- (TBR&R) - TO BE REMOVED & RELOCATED
- (TBRBO) - TO BE REMOVED BY OTHERS
- (TBR&RBO) - TO BE REMOVED & RELOCATED BY OTHERS
- (TBA) - TO BE ADJUSTED

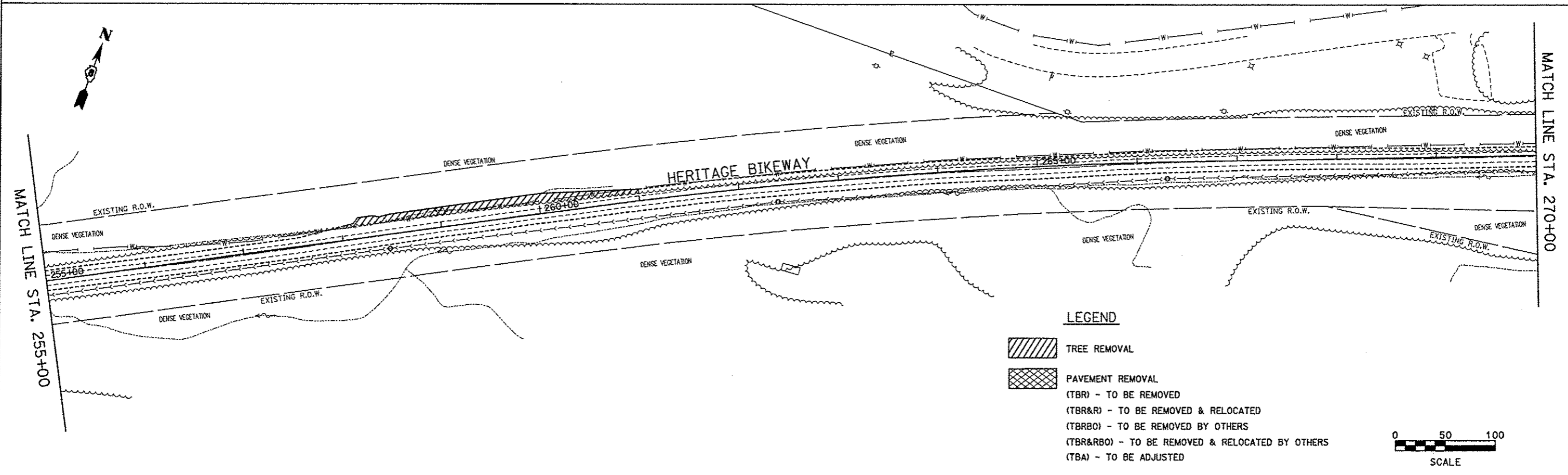

**LEGEND**

-  TREE REMOVAL
-  PAVEMENT REMOVAL
- (TBR) - TO BE REMOVED
- (TBR&R) - TO BE REMOVED & RELOCATED
- (TBRBO) - TO BE REMOVED BY OTHERS
- (TBR&RBO) - TO BE REMOVED & RELOCATED BY OTHERS
- (TBA) - TO BE ADJUSTED

FILE NAME * rem_86.dgn	USER NAME * Jeremy	DESIGNED - SAS	REVISED -	<b>MADISON COUNTY TRANSIT DISTRICT HERITAGE BIKEWAY</b>	<b>REMOVAL SHEETS</b>			F.A. RTE.	SECTION	COUNTY	TOTAL SHEETS	SHEET NO.
		DRAWN - JDH	REVISED -		SCALE: 1" = 50'	SHEET NO. 6 OF 15 SHEETS	STA. 241+00.00 TO STA. 270+00.00	06-00016-00-8T	MADISON	310	138	
		CHECKED - WJB	REVISED -					CONTRACT NO. 97433				
		DATE - 11/30/12	REVISED -					FED. ROAD DIST. NO. [ILLINOIS] FED. AID PROJECT				