

PROPOSED MARKING REMOVAL

THE EXISTING TAXIWAY CENTERLINE STRIPES WHERE THE PROPOSED AIMING POINT BAR WILL BE PLACED OVER WILL BE REMOVED PRIOR TO THE PLACEMENT OF THE PROPOSED AIMING POINT BAR. THIS WORK WILL BE PAID FOR UNDER ITEM AR620900 PAVEMENT MARKING REMOVAL _ _ PER SQ. FT.

620-PAVEMENT MARKING-WATERBORNE NOTES

THE PAVEMENT MARKING-WATERBORNE (620) SHALL BE PLACED IN ACCORDANCE WITH ITEM 620 "PAVEMENT MARKING" AS STATED ON PAGE 272 OF THE STANDARD SPECIFICATIONS FOR CONSTRUCTION OF AIRPORTS, ADOPTED APRIL 1, 2012.

THIS ITEM SHALL CONSIST OF RUNWAY AND TURNAROUND MARKING (BASE BID) AND RUNWAY AND TAXIWAY MARKING (ADDITIVE ALTERNATE NO. 3) IN ACCORDANCE WITH THESE SPECIFICATIONS AND AT THE LOCATIONS SHOWN ON THE CONSTRUCTION PLANS. ALL MARKING WILL BE WHITE, YELLOW AND SOLID IN COLOR. ALL PROPOSED MARKING WILL HAVE A 6-IN BLACK BORDER. THE PROPOSED PAVEMENT MARKING WILL BE APPLIED IN TWO APPLICATIONS.

ANY MATERIAL DELIVERED THAT FAILS TO MEET THE SPECIFICATIONS SHALL BE DISPOSED OF BY THE VENDOR AND IMMEDIATELY REPLACED WITH ACCEPTABLE MATERIAL ENTIRELY AT THE VENDOR'S EXPENSE, INCLUDING HANDLING AND TRANSPORTATION CHARGES.

ALL CURING COMPOUND WILL BE CLEANED FROM CONCRETE PAVEMENT PRIOR TO APPLYING PAINT. NO EXCEPTIONS.

ALL PROPOSED MARKING WILL BE COMPLETED IN ACCORDANCE WITH THE DETAILS SHOWN ON THE CONSTRUCTION PLANS.

ALL PROPOSED PAVEMENT MARKING SHALL BE WATERBORNE PAINT IN ACCORDANCE WITH ITEM 620.

GLASS BEADS SHALL BE REQUIRED ONLY ON THE SECOND APPLICATION OF YELLOW MARKING.

CUT-OFF SHEETS WILL BE REQUIRED TO INSURE STRAIGHT EDGES.

THE PROPOSED MARKING WILL BE PAID FOR UNDER ITEM:

- BASE BID:
- AR620520 PAVEMENT MARKING-WATERBORNE _ _ PER S.F.
- AR620525 PAVEMENT MARKING-BLACK BORDER _ _ PER S.F.
- ADDITIVE ALTERNATE NO. 3
- AU620520 PAVEMENT MARKING-WATERBORNE _ _ PER S.F.
- AU620525 PAVEMENT MARKING-BLACK BORDER _ _ PER S.F.

MARKING QUANTITIES (BASE BID)			
DESCRIPTION	UNIT AREA	NO. REQUIRED	TOTAL AREA
RUNWAY THRESHOLD STRIPES	862.5	6	5,175
NUMBER 1	318	1	318
NUMBER 3	634	1	634
RUNWAY CENTERLINE STRIPE	360	6	2,160
AIMING POINTS	3,000	4	12,000
TOTAL WHITE			20,287
HOLDING LINE	212	1	212
TOTAL YELLOW			212
RUNWAY THRESHOLD STRIPES (BLACK BORDER)	6	156.75	941
NUMBER 1 (BLACK BORDER)	67	1	67
NUMBER 3 (BLACK BORDER)	94	1	94
RUNWAY CENTERLINE STRIPE (BLACK BORDER)	6	124	744
AIMING POINTS (BLACK BORDER)	171	4	684
HOLDING LINE (BLACK BORDER)	350	1	350
TOTAL BLACK			2,880
TOTAL MARKING			23,379
MARKING QUANTITIES (ADDITIVE ALTERNATE NO. 3)			
DESCRIPTION	UNIT AREA	NO. REQUIRED	TOTAL AREA
RUNWAY THRESHOLD STRIPES	862.5	6	5,175
NUMBER 1	318	1	318
NUMBER 3	634	1	634
RUNWAY CENTERLINE STRIPE	360	11	3,960
TOTAL WHITE			10,087
TAXIWAY CENTERLINE STRIPE	727	1	727
TOTAL YELLOW			727
RUNWAY THRESHOLD STRIPES (BLACK BORDER)	6	156.75	941
NUMBER 1 (BLACK BORDER)	67	1	67
NUMBER 3 (BLACK BORDER)	94	1	94
RUNWAY CENTERLINE STRIPE (BLACK BORDER)	124	11	1,364
TAXIWAY CENTERLINE STRIPE (BLACK BORDER)	731	1	731
TOTAL BLACK			3,197
TOTAL MARKING			14,011

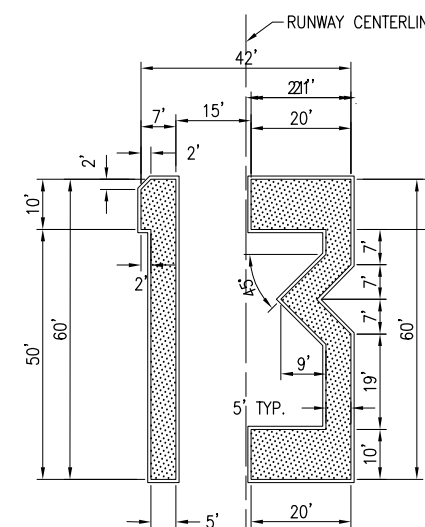

RUNWAY END 31 NUMERAL DETAIL
"NOT TO SCALE"

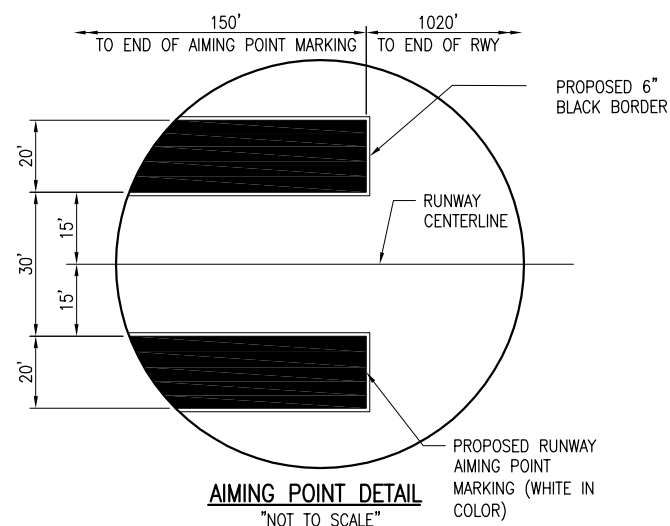

AIMING POINT DETAIL
"NOT TO SCALE"

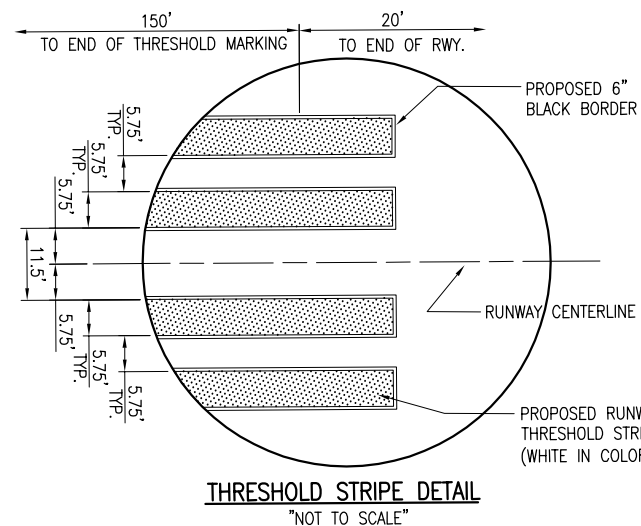

THRESHOLD STRIPE DETAIL
"NOT TO SCALE"

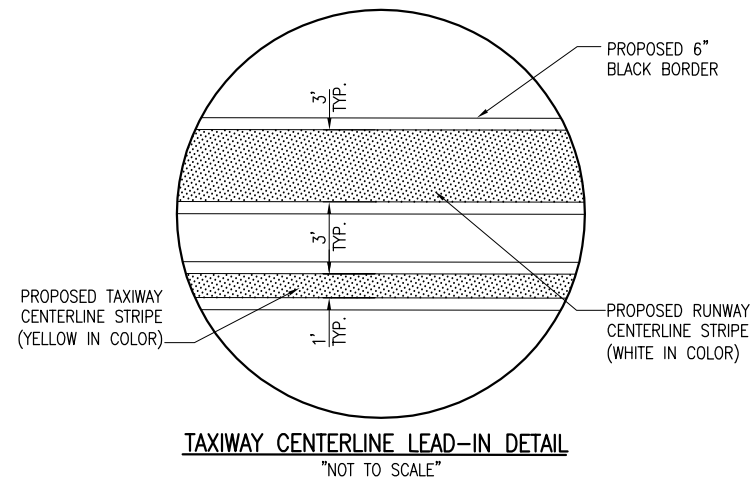

TAXIWAY CENTERLINE LEAD-IN DETAIL
"NOT TO SCALE"

- LEGEND**
- [White Box] EXISTING PAVEMENT
 - [Grey Box] PROPOSED PAVEMENT
 - [Dotted Box] EXISTING MARKING
 - [Solid Black Box] PROPOSED MARKING (BASE BID)
 - [Dotted Black Box] PROPOSED MARKING (ADD. ALT. 3)

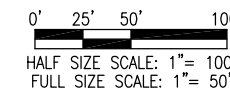
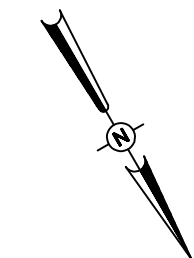

REVISION	DATE

MARSHALL COUNTY AIRPORT
LACON, ILLINOIS

BLOCK GRANT PROJ.: 3-17-0059-B15
IL PROJ.: C75-4223

Hanson Proj. No. 10A00051	BAK	07/15/10
Filename R=151MRK.DWG	BAK	07/15/10
Scale 1"=50'	DRAWN	07/15/10
Date 12/14/12	REVIEWED	03/30/11

HANSON
© Copyright Hanson Professional Services Inc. 2013
Hanson Professional Services Inc.
1525 South Sixth Street
Springfield, Illinois 62703-2986
Ph: (217) 788-2450 Fax: (217) 788-2503
www.hanson-inc.com
Offices Nationwide

**PAVE, LIGHT AND MARK
805' EXTENSION**

PROPOSED MARKING PLAN
STA. 140+50 TO STA. 153+00