

STATE OF ILLINOIS  
DEPARTMENT OF TRANSPORTATION

| F.A.S. RTE. | SECTION | COUNTY   | TOTAL SHEETS       | SHEET NO. |
|-------------|---------|----------|--------------------|-----------|
| 743         | 19RS-7  | SCOTT    | 10                 | 1         |
|             |         | ILLINOIS | CONTRACT NO. 72724 |           |

FOR INDEX OF SHEETS, SEE SHEET NO. 2

# PROPOSED HIGHWAY PLANS

FAS ROUTE 743 (HILLVIEW BLACKTOP)  
SECTION 19RS-7

OVERLAY  
SCOTT COUNTY

C-96-022-24

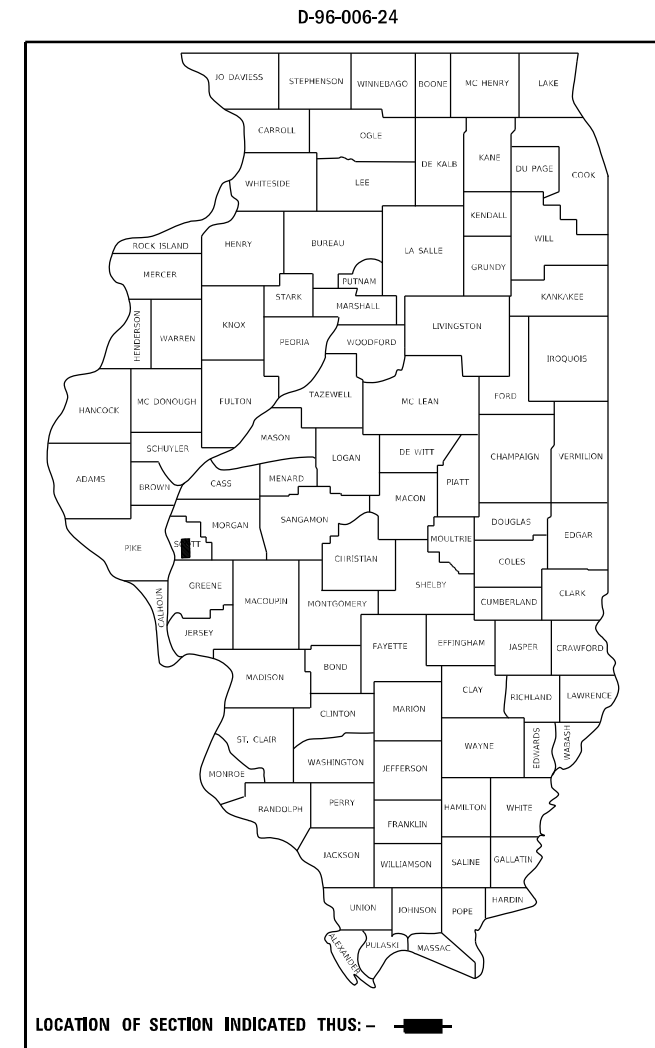

ADT = 600 (2020)  
SU = 70 (2020)  
MU = 90 (2020)

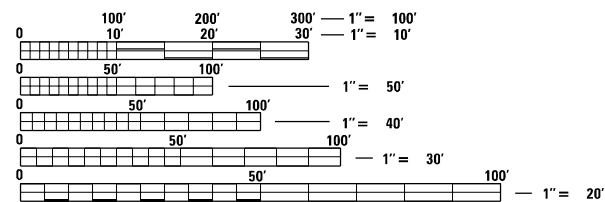

FULL SIZE PLANS HAVE BEEN PREPARED USING STANDARD ENGINEERING SCALES. REDUCED SIZED PLANS WILL NOT CONFORM TO STANDARD SCALES. IN MAKING MEASUREMENTS ON REDUCED PLANS, THE ABOVE SCALES MAY BE USED.

J.U.L.I.E.  
JOINT UTILITY LOCATION INFORMATION FOR EXCAVATORS  
1-800-892-0123  
OR 811

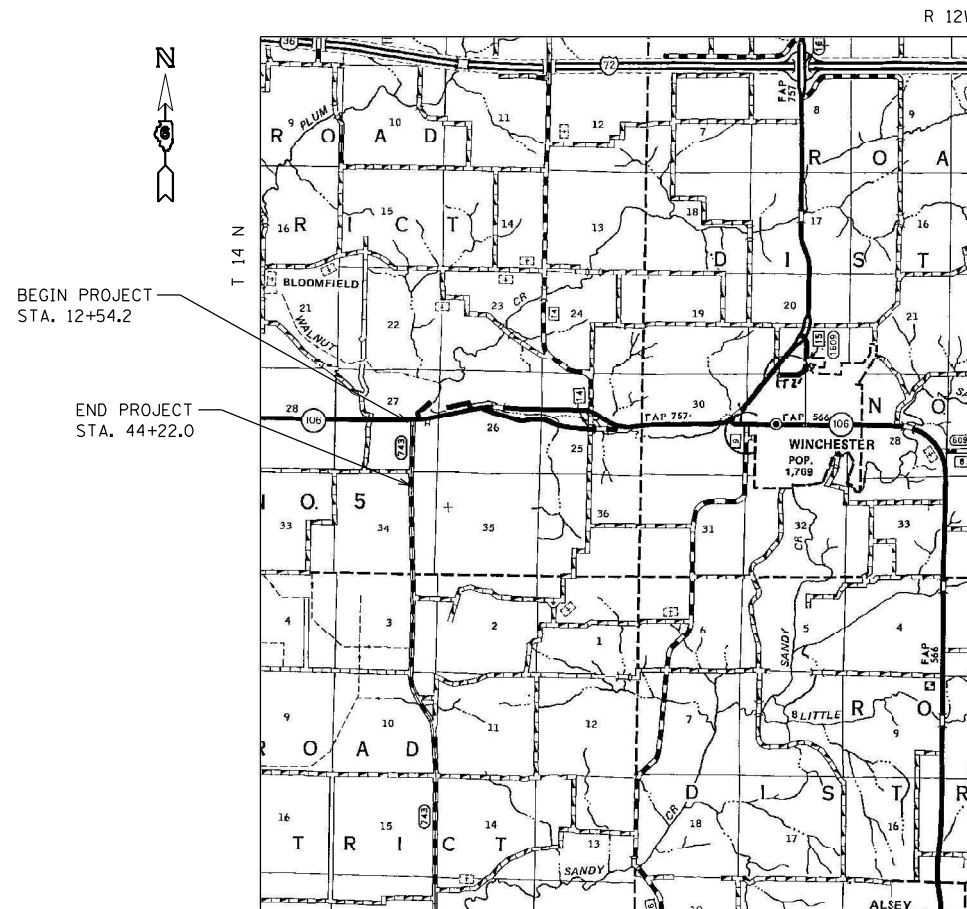

GROSS LENGTH = 3,168.00 FT. = 0.600 MILE  
NET LENGTH = 3,168.00 FT. = 0.600 MILE

PROJECT ENGINEER: MIKE HAMBY (217)524-7765  
PROJECT MANAGER TIM SHARP (217)524-9160

CONTRACT NO. 72724

STATE OF ILLINOIS  
DEPARTMENT OF TRANSPORTATION

SUBMITTED December 19 20 23

*John P. Meyer*  
REGIONAL ENGINEER

February 2, 2024  
*Scott A. Etkin*  
ENGINEER OF DESIGN AND ENVIRONMENT

February 2, 2024  
*Stephen M. Smith*  
DIRECTOR OF HIGHWAYS PROJECT IMPLEMENTATION

PRINTED BY THE AUTHORITY  
OF THE STATE OF ILLINOIS

## INDEX OF SHEETS

| SHEET NO. | DESCRIPTION  |
|-----------|--|
| 1.        | COVER SHEET  |
| 2.        | INDEX OF SHEETS, STANDARDS, GENERAL NOTES & SIGNATURES |
| 3.        | SUMMARY OF QUANTITIES                                  |
| 4.        | SCHEDULES  |
| 5.        | LOCATION MAP   |
| 6.        | PLAN   |
| 7.        | TYPICAL SECTION  |
| 8.        | BUTT JOINT DETAIL                                      |
| 9-10.     | ENTRANCE DETAILS                                       |

## STANDARDS

| STANDARD NO. | DESCRIPTION  |
|--------------|--|
| 000001-08    | STANDARD SYMBOLS, ABBREVIATIONS AND PATTERNS   |
| 001006       | DECIMAL OF AN INCH AND OF A FOOT   |
| 701001-02    | OFF-RD OPERATIONS, 2L, 2W, MORE THAN 15' AWAY  |
| 701006-05    | OFF-RD OPERATIONS, 2L, 2W, 15' TO 24" FROM PAVEMENT EDGE                                 |
| 701306-04    | LANE CLOSURE, 2L, 2W, DAY ONLY, SLOW MOVING OPERATIONS DAY ONLY FOR SPEEDS $\geq$ 45 MPH |
| 701901-09    | TRAFFIC CONTROL DEVICES  |
| 780001-05    | TYPICAL PAVEMENT MARKINGS  |
| 781001-04    | TYPICAL APPLICATIONS RAISED REFLECTIVE PAVEMENT MARKERS                                  |
| B.L.R. 21-9  | TYPICAL APPLICATION OF TRAFFIC CONTROL DEVICES FOR CONSTRUCTION ON RURAL LOCAL HIGHWAYS  |

| STATE OF ILLINOIS<br>DEPARTMENT OF TRANSPORTATION<br>DIVISION OF HIGHWAYS<br>DISTRICT 6 |   |
|---|---|
| EXAMINED  | December, 22 20 23<br><i>[Signature]</i><br>ENGINEER OF OPERATIONS            |
| EXAMINED  | December 22 20 23<br><i>[Signature]</i><br>ENGINEER OF PROJECT IMPLEMENTATION |
| EXAMINED  | December 22 20 23<br><i>[Signature]</i><br>ENGINEER OF PROGRAM DEVELOPMENT    |

THE FOLLOWING RATES OF APPLICATION HAVE BEEN ASSUMED IN CALCULATING PLAN QUANTITIES:

|                                  |   |
|----------------------------------|---|
| BITUMINOUS MATERIALS (TACK COAT) | 0.05 LBS/SQ FT (EX HMA, MILLED SURFACE) |
| HMA SURFACE/BINDER (112 LBS)     | 0.056 TON/SQUARE YARD - INCH (MIX A-C)  |

| MIXTURE REQUIREMENTS |                  |                    |
|----------------------|------------------|--------------------|
| MIXTURE USE(S):      | POLY HMA BINDER  | HMA SURFACE COURSE |
| PG:                  | COURSE SBS PG    | 64-22              |
| DESIGN AIR VOIDS:    | 70-28 4.0% @ N50 | 4.0% @ N50         |
| MIXTURE COMPOSITION: | IL-4.75          | IL-9.5             |
| FRICTION AGGREGATE:  | N/A              | MIX C              |
| QUALITY MANAGEMENT:  | QC/QA            | QC/QA              |
| SUBLOT SIZE:         | N/A              | N/A                |
| MTD REQUIRED:        | NO               | NO                 |

REV. - MS

MODEL: D:\dgn\11\11\CONSTRMNT\_CAD\72724 - FAS 743 (HILUREV) BLACKTOP - STANDARD COVERLAY - SCOTT CO (9-8-2024)\p\m\72724-sh-3-signatures-notes-standards.dgn

|                             |                  |                 |
|-----------------------------|------------------|-----------------|
| USER NAME = Timothy.Sharp   | DESIGNED - _____ | REVISED - _____ |
|                             | DRAWN - _____    | REVISED - _____ |
| PLOT SCALE = 40.0000' / in. | CHECKED - _____  | REVISED - _____ |
| PLOT DATE = 12/19/2023      | DATE - _____     | REVISED - _____ |

STATE OF ILLINOIS  
DEPARTMENT OF TRANSPORTATION

INDEX OF SHEETS, HIGHWAY STANDARDS,  
GENERAL NOTES, & SIGNATURES

SCALE: \_\_\_\_\_ SHEET \_\_\_\_\_ OF \_\_\_\_\_ SHEETS STA. \_\_\_\_\_ TO STA. \_\_\_\_\_

| F.A.S. RTE.        | SECTION | COUNTY | TOTAL SHEETS              | SHEET NO. |
|--------------------|---------|--------|---------------------------|-----------|
| 743                | 19R5-7  | SCOTT  | 10                        | 2         |
| CONTRACT NO. 72724 |         |        | ILLINOIS FED. AID PROJECT |           |

0-02178-6021  
 100% STATE  
 SCOTT  
 ROADWAY  
 0005  
 RURAL

| CODE NO.   | ITEM  | UNIT   | TOTAL QUANTITY |      |
|------------|---|--------|----------------|------|
| 40200800   | AGGREGATE SURFACE COURSE, TYPE B                        | TON    | 6              | 6    |
| 35800100   | PREPARATION OF BASE                                     | SQYD   | 76             | 76   |
| 35501310   | HOT-MIX ASPHALT BASE COURSE, 6 1/2"                     | SQYD   | 44             | 44   |
| 40600290   | BITUMINOUS MATERIALS (TACK COAT)                        | POUNDS | 5227           | 5227 |
| 40600982   | HOT-MIX ASPHALT SURFACE REMOVAL - BUTT JOINT            | SQYD   | 320            | 320  |
| 40600990   | TEMPORARY RAMP  | SQYD   | 37             | 37.0 |
| 40603200   | POLYMERIZED HOT-MIX ASPHALT BINDER COURSE, IL-4.75, N50 | TON    | 325            | 325  |
| 40604050   | HOT-MIX ASPHALT SURFACE COURSE, IL-9.5, MIX 'C', N50    | TON    | 650            | 650  |
| 40800029   | BITUMINOUS MATERIALS (TACK COAT)                        | POUND  | 50             | 50   |
| 40800050   | INCIDENTAL HOT-MIX ASPHALT SURFACING                    | TON    | 23             | 23   |
| 44000100   | PAVEMENT REMOVAL  | SQYD   | 44             | 44   |
| 44000153   | HOT-MIX ASPHALT SURFACE REMOVAL, 1"                     | SQYD   | 7744           | 7744 |
| 48102100   | AGGREGATE WEDGE SHOULDER, TYPE B                        | TON    | 246            | 246  |
| 67100100   | MOBILIZATION  | LSUM   | 1              | 1    |
| 70100460   | TRAFFIC CONTROL AND PROTECTION, STANDARD 701306         | LSUM   | 1              | 1    |
| 70300100   | SHORT-TERM PAVEMENT MARKING                             | FOOT   | 951            | 951  |
| 70300150   | SHORT-TERM PAVEMENT MARKING REMOVAL                     | SQ FT  | 318            | 318  |
| * 78001120 | PAINT PAVEMENT MARKING - LINE 5"                        | FOOT   | 7128           | 7128 |
| * 78100100 | RAISED REFLECTIVE PAVEMENT MARKER                       | EACH   | 40             | 40   |
| 78300200   | RAISED REFLECTIVE PAVEMENT MARKER REMOVAL               | EACH   | 40             | 40   |
| X7011800   | TRAFFIC CONTROL AND PROTECTION, STANDARD BLR21          | LSUM   | 1              | 1    |

\* SPECIALTY ITEM

REV. - MS

|   |   |                                     |           |
|---|---|-------------------------------------|-----------|
| FILE NAME =                             | USER NAME = Timothy.Shorp                 | DESIGNED -                          | REVISED - |
| SYCONTRACTANT_CAD72724 - FAS 743 (HILL) | /BW BLACKTOP) STANDARD OVERLAY - SCOTT (C | ORIANI1241plan1117,IMS-sh-3-SC0.dgn | REVISED - |
| Default                                 | PLOT SCALE = 40.0000' / 1in               | CHECKED -                           | REVISED - |
|   | PLOT DATE = 12/19/2023                    | DATE -                              | REVISED - |

STATE OF ILLINOIS  
 DEPARTMENT OF TRANSPORTATION

SUMMARY OF QUANTITIES

SCALE \_\_\_\_\_ SHEET \_\_\_\_\_ OF \_\_\_\_\_ SHEETS STA. \_\_\_\_\_ TO STA. \_\_\_\_\_

|                           |         |        |                    |           |
|---------------------------|---------|--------|--------------------|-----------|
| F.A.S. RTE                | SECTION | COUNTY | TOTAL SHEETS       | SHEET NO. |
| 143                       | 19RS-7  | SCOTT  | 10                 | 3         |
|                           |         |        | CONTRACT NO. 72724 |           |
| ILLINOIS FED. AID PROJECT |         |        |                    |           |

| HOT-MIX ASPHALT RESURFACING, FAS 743 (HILLVIEW BLACKTOP) |    |          |          |        |          |                         |   |   |                                  |                                  |
|--|----|----------|----------|--------|----------|-------------------------|---|---|----------------------------------|----------------------------------|
| LOCATION FOR MAINLINE HMA RESURFACING WORK               |    |          | DISTANCE | WIDTH  | AREA     | HMA SURFACE REMOVAL, 1" | POLYMERIZED HOT-MIX ASPHALT BINDER COURSE, IL-4.75, N50 | HOT-MIX ASPHALT SURFACE COURSE, IL-9.5, MIX "C", N50 (DEPTH = 1 1/2") | BITUMINOUS MATERIALS (TACK COAT) | HMA SURFACE REMOVAL - BUTT JOINT |
| STATION  | TO | STATION  | (FOOT)   | (FOOT) | (SQ FT)  | (SQ YD)                 | (TON)   | (TON)   |                                  |                                  |
| MAINLINE IL 78   |    |          |          |        |          |                         |   |   |                                  |                                  |
| 12+54.20   | TO | 44+22.00 | 3167.80  | 22     | 69,691.6 | 7,743.5                 | 325.0   | 650.5   | 5226.9                           | 270.0                            |
| TOTALS =   |    |          | 3,167.8  |        | 69,691.6 | 7,744                   | 325   | 650   | 5,227                            | 270                              |

| AGGREGATE SHOULDERS, FAS 743 (HILLVIEWW BLACKTOP) |    |          |   |                       |                          |                         |                                  |
|---|----|----------|---|-----------------------|--------------------------|-------------------------|----------------------------------|
| LOCATION FOR AGGREGATE SHOULDER WORK              |    |          | SIDE OF MAINLINE PAVEMENT OR SIDE OF SIDEROAD | HMA SHOULDER DISTANCE | AGGREGATE SHOULDER WIDTH | AGGREGATE SHOULDER AREA | AGGREGATE WEDGE SHOULDER, TYPE B |
| STATION   | TO | STATION  | (LEFT / RIGHT)                                | (FOOT)                | (FOOT)                   | (SQ YD)                 | 48102100                         |
| HILLVIEW BLACKTOP (LEFT SHOULDER)                 |    |          |   |                       |                          |                         |                                  |
| 12+54.20  | TO | 44+22.00 | LEFT  | 3167.80               | 3                        | 1,055.93                | 123.19                           |
| HILLVIEW BLACKTOP (RIGHT SHOULDER)                |    |          |   |                       |                          |                         |                                  |
| 12+54.20  | TO | 44+22.00 | RIGHT   | 3167.80               | 3                        | 1,055.93                | 123.19                           |
| TOTAL =   |    |          |   | 6,336                 |                          | 2,112                   | 246                              |

| TEMPORARY RAMPS, FAS 743 (HILLVIEW ROAD) |  |                  |                           |                             |                            |                          |                            |                           |                       |
|--|--|------------------|---------------------------|-----------------------------|----------------------------|--------------------------|----------------------------|---------------------------|-----------------------|
| LOCATION FOR TEMPORARY RAMP WORK         |  | STATION LOCATION | RAMP DROP (AFTER MILLING) | RAMP LENGTH (AFTER MILLING) | RAMP WIDTH (AFTER MILLING) | RAMP DROP (AFTER BINDER) | RAMP LENGTH (AFTER BINDER) | RAMP WIDTH (AFTER BINDER) | TEMPORARY RAMP (1:40) |
| RAMP LOCATIONS                           |  |                  | (INCHES)                  | (FOOT)                      | (FOOT)                     | (INCHES)                 | (FOOT)                     | (FOOT)                    | (SQ YD)               |
| IL 78                                    |  |                  |                           |                             |                            |                          |                            |                           |                       |
| BEGINNING OF PROJECT                     |  | 12+54.20         | 2.25"                     | 7.5                         | 22                         | 1.50"                    | 7.5                        | 22                        | 18.3                  |
| END OF PROJECT                           |  | 44+22.00         | 2.25"                     | 7.5                         | 22                         | 1.50"                    | 7.5                        | 22                        | 18.3                  |
| SUB-TOTAL =                              |  |                  |                           |                             |                            |                          |                            |                           | 36.7                  |
| TOTAL =                                  |  |                  |                           |                             |                            |                          |                            |                           | 37                    |

| PAINT PAVEMENT MARKING - LINE 5" |            |          |                  |            |
|----------------------------------|------------|----------|------------------|------------|
| LOCATION                         | BEGIN STA. | END STA. | YELLOW SKIP DASH | WHITE EDGE |
| LEFT & RIGHT                     | 12+54.20   | 44+22.00 | FT               | FT         |
|                                  | 12+54.20   | 44+22.00 | 791.95           | 6335.60    |
| TOTAL                            |            |          | 791.95           | 6335.60    |

| ENTRANCES SCHEDULE, FAS 743 (HILLVIEW BLACKTOP) |      |                            |  |                           |   |                         |                             |                                  |                                      |                                  |                     |                                  |
|---|------|----------------------------|--|---------------------------|---|-------------------------|-----------------------------|----------------------------------|--------------------------------------|----------------------------------|---------------------|----------------------------------|
| MAINLINE STATION OF ENTRANCE                    | SIDE | ENTRANCE TYPE (CE, PE, FE) | MAILBOX TURNOUT (LEADING, CENTER, OR TRAILING) | EXISTING SURFACE MATERIAL | ENTRANCE IMPROVEMENT DISTANCE (FROM E.O.P.) | PROPOSED AGGREGATE AREA | PROPOSED PAVED SURFACE AREA | AGGREGATE SURFACE COURSE, TYPE B | INCIDENTAL HOT-MIX ASPHALT SURFACING | BITUMINOUS MATERIALS (TACK COAT) | PREPARATION OF BASE | HMA SURFACE REMOVAL - BUTT JOINT |
|   |      |                            |  |                           | (FOOT)                                      | (SQ FT)                 | (SQ FT)                     | (TON)                            | (TON)                                | (POUND)                          | sq yd               | sq yd                            |
| IL 78   |      |                            |  |                           |   |                         |                             |                                  |                                      |                                  |                     |                                  |
| STA 12+77.7                                     | LEFT | PE                         | TRAILING                                       | AGGREGATE W/ HMA APRON    | 15.00                                       | 162.00                  | 448.00                      | 2.25                             | 4.20                                 | 22.40                            | 0.00                | 50.00                            |
| STA 38+71.7                                     | LEFT | PE                         | NO   | AGGREGATE                 | 15.00                                       | 112.00                  | 248.00                      | 1.56                             | 5.40                                 | 6.20                             | 27.00               | 0.00                             |
| STA 40+27.2                                     | LEFT | PE                         | TRAILING                                       | AGGREGATE                 | 15.00                                       | 126.00                  | 438.00                      | 1.75                             | 9.50                                 | 10.95                            | 49.00               | 0.00                             |
| TOTALS =  |      |                            |  |                           |   |                         |                             | 6                                | 19                                   | 40                               | 76                  | 50                               |

| SIDE ROAD, FAS 743 (HILLVIEW BLACKTOP)      |          |                        |                                     |                                  |                                      |                  |
|---|----------|------------------------|-------------------------------------|----------------------------------|--------------------------------------|------------------|
| LOCATION FOR SIDE ROAD HMA RESURFACING WORK | LOCATION | SURFACE AREA (BY CADD) | HOT-MIX ASPHALT BASE COURSE, 6 1/2" | BITUMINOUS MATERIALS (TACK COAT) | INCIDENTAL HOT-MIX ASPHALT SURFACING | PAVEMENT REMOVAL |
|   |          |                        | (SQ YD)                             | (SQ YD)                          | (TON)                                | (SQ YD)          |
| HILLVIEW BLACKTOP SIDE ROADS                |          |                        |                                     |                                  |                                      |                  |
| BROWN RD                                    | 38+71.70 | 400                    | 44.4                                | 10.0                             | 3.7                                  | 44.4             |
| TOTALS =                                    |          | 400                    | 44                                  | 10                               | 4                                    | 44               |

REV. - MS

MODEL: D:\64bit\CONTRMNT\_CADD\72724 - FAS 743 (HILLVIEW BLACKTOP)\_STANDARD\_OVERLAY - SCOTT CO (3-8-2024)\p\m\72724-st-4-sc-hedules.dgn

|                            |            |           |
|----------------------------|------------|-----------|
| USER NAME = Timothy.Sharp  | DESIGNED - | REVISED - |
|                            | DRAWN -    | REVISED - |
| PLOT SCALE = 2.0000' / in. | CHECKED -  | REVISED - |
| PLOT DATE = 12/19/2023     | DATE -     | REVISED - |

STATE OF ILLINOIS  
DEPARTMENT OF TRANSPORTATION

|              |  |                             |  |                          |  |
|--------------|--|-----------------------------|--|--------------------------|--|
| SCALE: _____ |  | SHEET _____ OF _____ SHEETS |  | STA. _____ TO STA. _____ |  |
|--------------|--|-----------------------------|--|--------------------------|--|

|                           |         |        |              |           |
|---------------------------|---------|--------|--------------|-----------|
| F.A.S. RTE.               | SECTION | COUNTY | TOTAL SHEETS | SHEET NO. |
| 743                       | 19R5-7  | SCOTT  | 10           | 4         |
| CONTRACT NO. 72724        |         |        |              |           |
| ILLINOIS FED. AID PROJECT |         |        |              |           |



MODEL Path: \\s:\CONTRACT\MAINT\_CAD\72724 - FAS 743 (HILLVIEW BLACKTOP)\_STANDARD\_OVERLAY - SCOTT CO 03-02-2024\plott\72724-shs-5-location\_map.dgn

|                            |                  |                 |
|----------------------------|------------------|-----------------|
| USER NAME = Timothy,Sharp  | DESIGNED - _____ | REVISED - _____ |
|                            | DRAWN - _____    | REVISED - _____ |
| PLOT SCALE = 2,0000' / in. | CHECKED - _____  | REVISED - _____ |
| PLOT DATE = 12/19/2023     | DATE - _____     | REVISED - _____ |

**STATE OF ILLINOIS**  
**DEPARTMENT OF TRANSPORTATION**

**LOCATION MAP**

SCALE: \_\_\_\_\_ SHEET \_\_\_\_ OF \_\_\_\_ SHEETS STA. \_\_\_\_\_ TO STA. \_\_\_\_\_

| F.A.S. RTE.               | SECTION | COUNTY | TOTAL SHEETS | SHEET NO. |
|---------------------------|---------|--------|--------------|-----------|
| 743                       | 19RS-7  | SCOTT  | 10           | 5         |
| CONTRACT NO. 72724        |         |        |              |           |
| ILLINOIS FED. AID PROJECT |         |        |              |           |



MODEL: Default  
 FILE NAME: S:\CONTRACTS\195\195-7\195-7-7274 - FAS 743 (HILLVIEW BLACKTOP) - STANDARD OVERLAY - SCOTT CO (3-8-2024)\plans\195-7-7274\_sht-6-plans.dgn

REV. - MS

|                            |             |           |
|----------------------------|-------------|-----------|
| USER NAME = tj_mj_s_larp   | DESIGNER -  | REVISED - |
| DRAWN -                    | REVISIONS - |           |
| PLOT SCALE = 2.0000' / in. | CHECKED -   | REVISED - |
| PLOT DATE = 12/19/2023     | DATE -      | REVISED - |

**STATE OF ILLINOIS**  
**DEPARTMENT OF TRANSPORTATION**

|              |                             |
|--------------|-----------------------------|
| <b>PLAN</b>  |                             |
| SCALE: _____ | SHEET _____ OF _____ SHEETS |
| STA. _____   | TO STA. _____               |

| F.A.S. RTE.               | SECTION | COUNTY | TOTAL SHEETS | SHEET NO. |
|---------------------------|---------|--------|--------------|-----------|
| 743                       | 195-7   | SCOTT  | 10           | 6         |
| CONTRACT NO. 72724        |         |        |              |           |
| ILLINOIS FED. AID PROJECT |         |        |              |           |

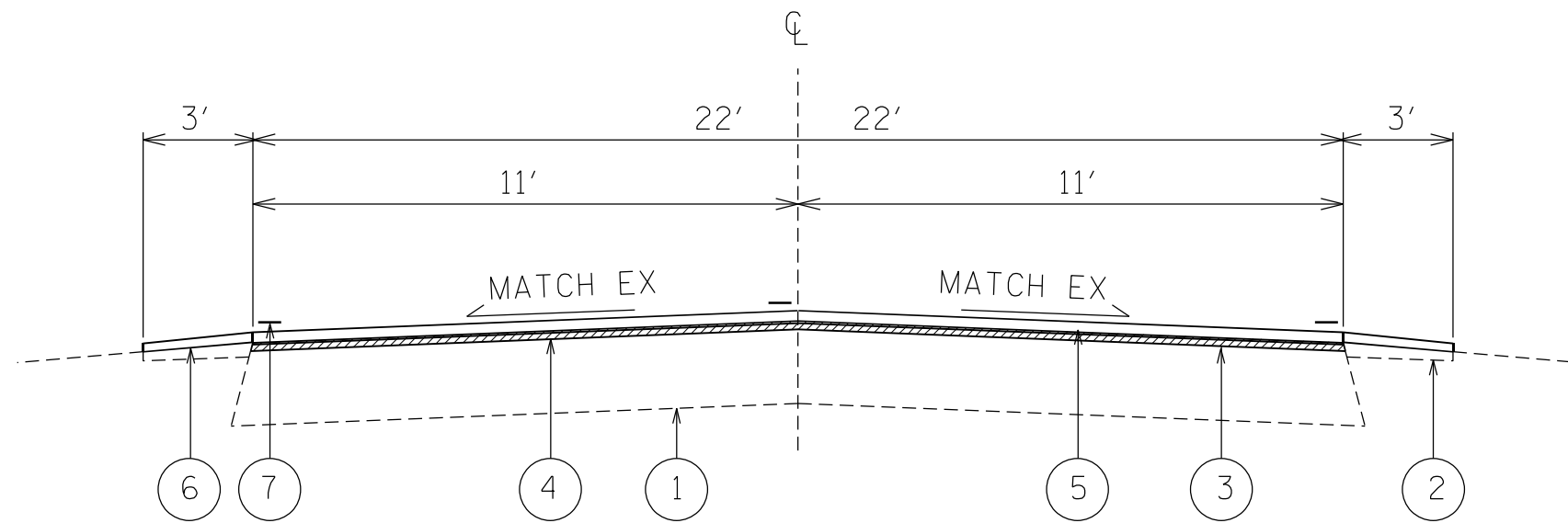

**STA. 12+54 TO STA. 44+22**

- ① EXIST. BITUMINOIUS SURFACE TREATMENT 10''
- ② EXIST. AGGREGATE SHOULDERS
- ③ PROP. SURFACE REMOVAL 1''
- ④ PROP. H.M.A BINDER COURES, IL-4.75, N50 3/4''
- ⑤ PROP. H.M.A. SURFACE COURSE, IL-9.5, MIX 'C', N50 1 1/2''
- ⑥ PROP. AGGREGATE WEDGE SHOULDERS, TYPE B
- ⑦ PROP. PAINT PAVEMENT MARKING - LINE 5''

MODEL: D:\64\h...  
 FILE NAME: S:\CONTRACT\MAINT\_CAD\72724 - FAS 743 (HILLVIEW BLACKTOP)\_STANDARD\_OVERLAY - SCOTT\_CO (3-8-2024)\plott\72724-shc-7-typrcal.dgn

|                            |            |           |
|----------------------------|------------|-----------|
| USER NAME = Timothy,Sharp  | DESIGNED - | REVISED - |
|                            | DRAWN -    | REVISED - |
| PLOT SCALE = 3,5620' / in. | CHECKED -  | REVISED - |
| PLOT DATE = 12/19/2023     | DATE -     | REVISED - |

**STATE OF ILLINOIS  
DEPARTMENT OF TRANSPORTATION**

|        |  |       |  |        |  |        |  |      |         |
|--------|--|-------|--|--------|--|--------|--|------|---------|
| SCALE: |  | SHEET |  | OF     |  | SHEETS |  | STA. | TO STA. |
|        |  | 743   |  | 19RS-7 |  | SCOTT  |  | 10   | 7       |

|                           |         |        |              |           |
|---------------------------|---------|--------|--------------|-----------|
| F.A.P. RTE.               | SECTION | COUNTY | TOTAL SHEETS | SHEET NO. |
| 743                       | 19RS-7  | SCOTT  | 10           | 7         |
| CONTRACT NO. 72724        |         |        |              |           |
| ILLINOIS FED. AID PROJECT |         |        |              |           |

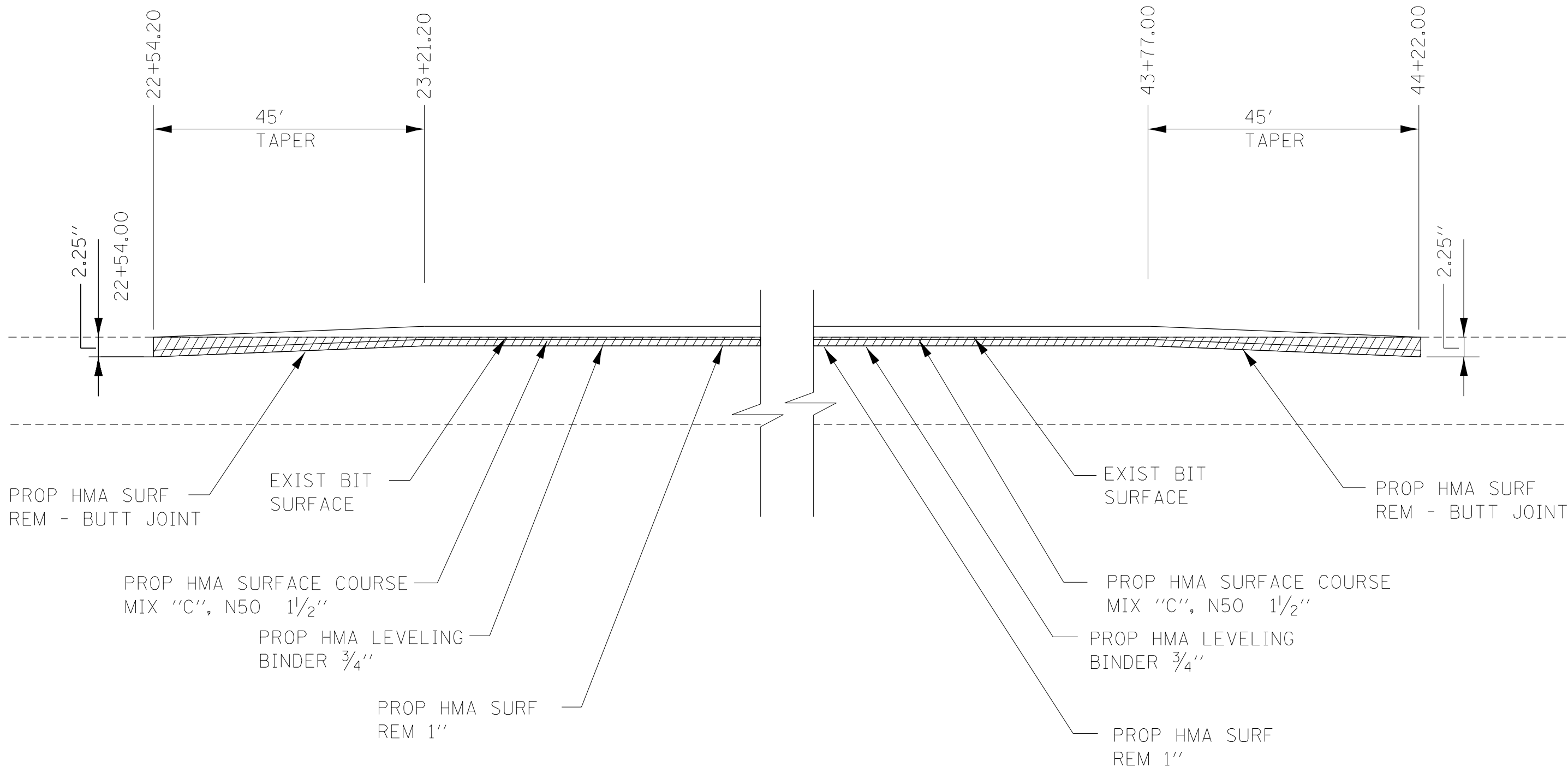

|   |   |  |           |
|---|---|--|-----------|
| FILE NAME =                             | USER NAME = Timothy.Sharp                     | DESIGNED -                             | REVISED - |
| S:\CONTRMAINT_CAD\72724 - FAS 743 (HILL | VIEW (BLACKTOP) - STANDARD OVERLAY - SCOTT CO | DRAWN 24\plans\72724-sh-8 - butt joint | REVISED - |
| Default                                 | PLOT SCALE = 2.0000' / in.                    | CHECKED -                              | REVISED - |
|   | PLOT DATE = 12/19/2023                        | DATE -                                 | REVISED - |

**STATE OF ILLINOIS  
DEPARTMENT OF TRANSPORTATION**

|                          |       |    |        |              |
|--------------------------|-------|----|--------|--------------|
| <b>BUTT-JOINT DETAIL</b> |       |    |        |              |
| SCALE:                   | SHEET | OF | SHEETS | STA. TO STA. |

|                           |         |        |              |           |
|---------------------------|---------|--------|--------------|-----------|
| F.A.S. RTE.               | SECTION | COUNTY | TOTAL SHEETS | SHEET NO. |
| 743                       | 19RS-7  | SCOTT  | 10           | 8         |
| CONTRACT NO. 72724        |         |        |              |           |
| ILLINOIS FED. AID PROJECT |         |        |              |           |



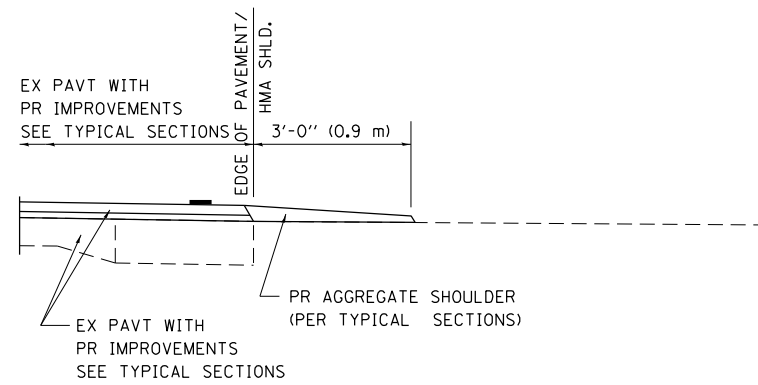

**SECTION A-A FOR EX EARTH/ AGGREGATE FE**

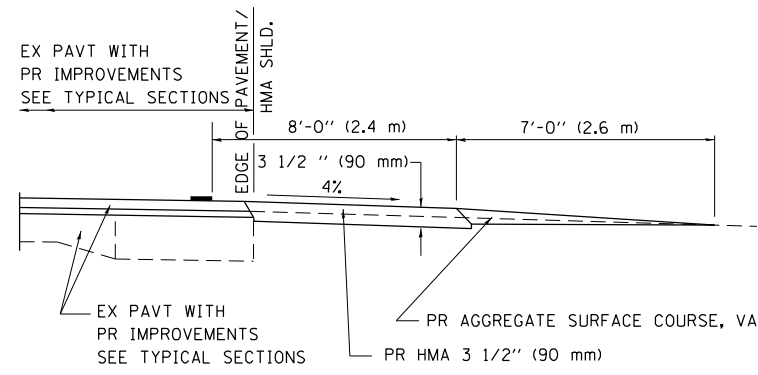

**SECTION A-A FOR EX EARTH/AGGREGATE PE**

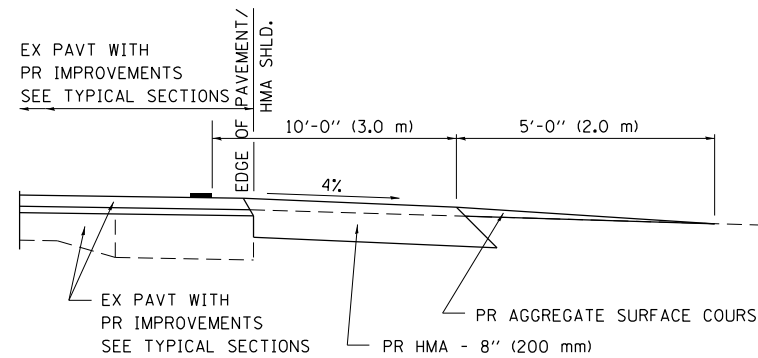

**SECTION A-A FOR EX EARTH/AGGREGATE CE & SIDE ROAD**

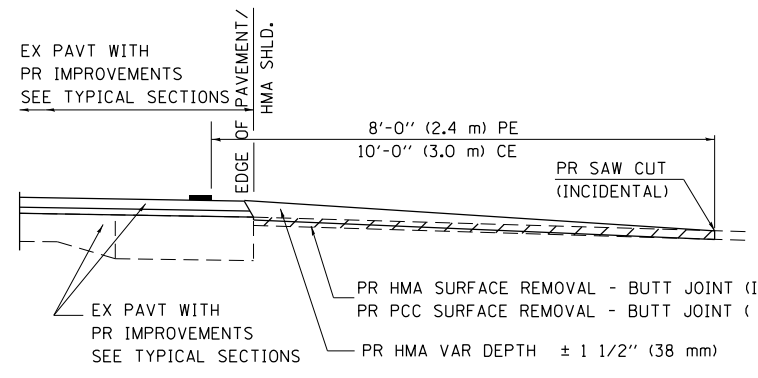

**SECTION A-A FOR EX HMA/ PC CONCRETE PE, CE & SIDE ROAD**

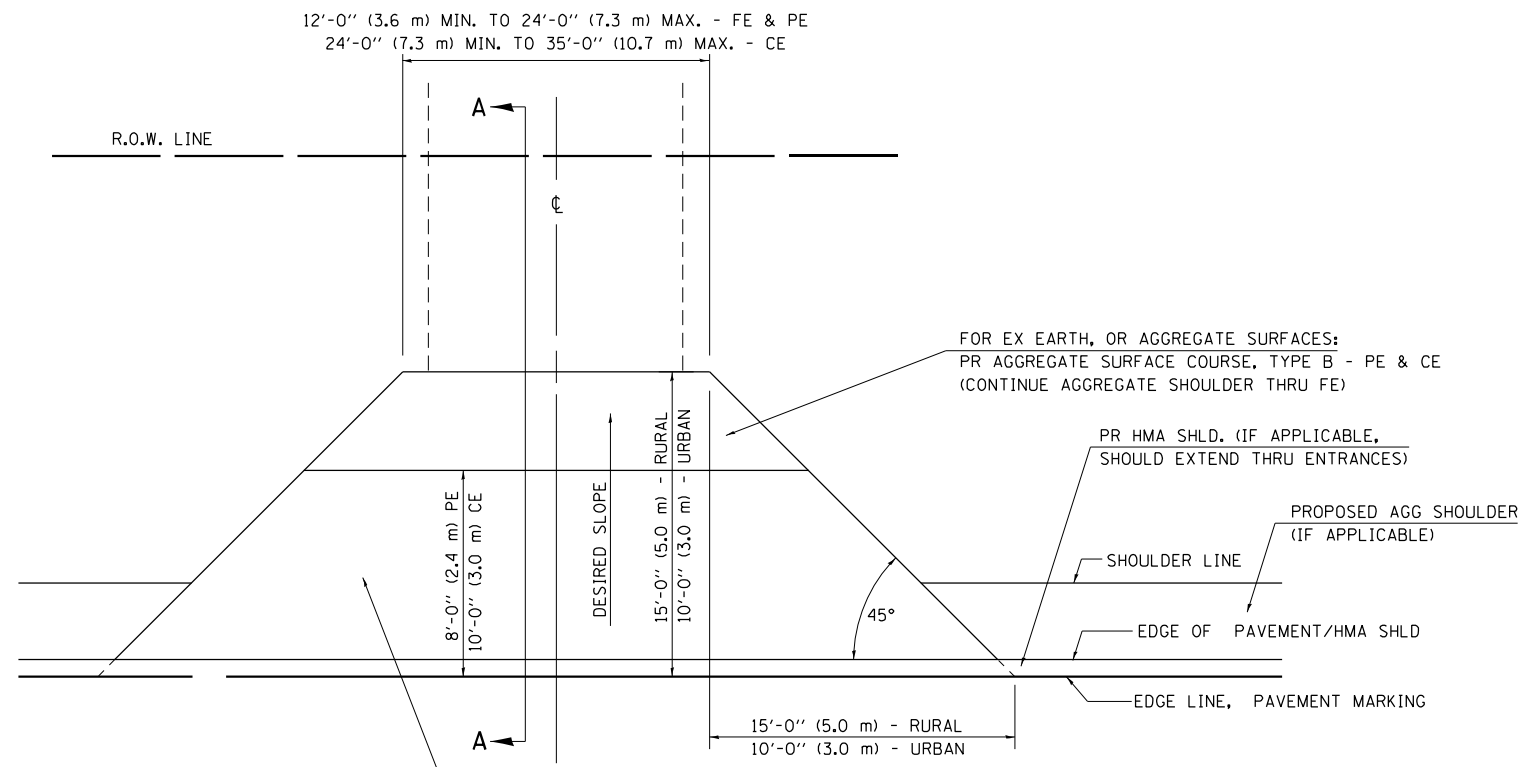

FOR EX EARTH OR AGGREGATE SURFACES:  
 PR HMA SURFACE REMOVAL (IF APPLICABLE)  
 PR AGGREGATE SHOULDER THRU - FE  
 PR HMA CONCRETE 3 1/2" (90 mm) - PE  
 PR HMA CONCRETE 8" (200 mm) - CE

FOR EX HMA CONCRETE SURFACES:  
 PR HMA SURFACE REMOVAL-BUTT JOINT

FOR EX PCC SURFACES:  
 PR PCC SURFACE REMOVAL-BUTT JOINT

**GENERAL NOTES:**

THE RESIDENT ENGINEER WILL DETERMINE THE EXACT TYPE OF IMPROVEMENT TO BE COMPLETED FOR ALL ENTRANCES, SIDEROADS AND MAILBOX TURNOUTS ON THIS PROJECT.

THE PLAN DETAILS AND SCHEDULES SHOULD BE USED AS A GUIDE FOR THE ENGINEER TO IMPLEMENT THE FINAL DESIGN. THE ENGINEER MAY DECIDE TO SALVAGE PORTIONS OF THE EXISTING ENTRANCE PAVEMENT STRUCTURE; THEREFORE, REDUCING PAY ITEM QUANTITIES. NO ADDITIONAL PAYMENT WILL BE ALLOWED FOR THIS REDUCTION IN QUANTITIES.

ANY WORK THE ENGINEER REQUIRES WHICH IS NOT COVERED BY A PAY ITEM CONTAINED IN THE PLANS WILL BE PAID FOR IN ACCORDANCE WITH ARTICLE 109.04 OF THE STANDARD SPECIFICATIONS.

HMA CONCRETE REQUIRED TO CONSTRUCT THE ENTRANCES SHALL BE IN ACCORDANCE WITH THE APPLICABLE PORTIONS OF SECTION 406 AND 408 OF THE STANDARD SPECIFICATIONS AND AS DIRECTED BY THE ENGINEER.

WHEN THE HMA CONCRETE PROPOSED FOR THE IMPROVEMENT IS THICKER THAN 3 INCHES (75 mm) AND REQUIRE PLACEMENT IN MORE THAN ONE LIFT. THE BOTTOM LIFT(S) SHALL MEET THE REQUIREMENTS OF HMA BASE COURSE IN SECTION 406 OF THE STANDARD SPECIFICATIONS AND THE TOP LIFT OF 2 INCHES (50 mm) SHALL MEET THE REQUIREMENTS OF HMA CONCRETE SURFACE COURSE, SUPERPAVE.

THIS WORK WILL BE PAID FOR IN ACCORDANCE WITH SECTIONS 351, 358, 408, 423 AND 440 OF THE STANDARD SPECIFICATIONS.

ALL DIMENSIONS ARE IN INCHES (MILLIMETERS) UNLESS OTHERWISE SHOWN.

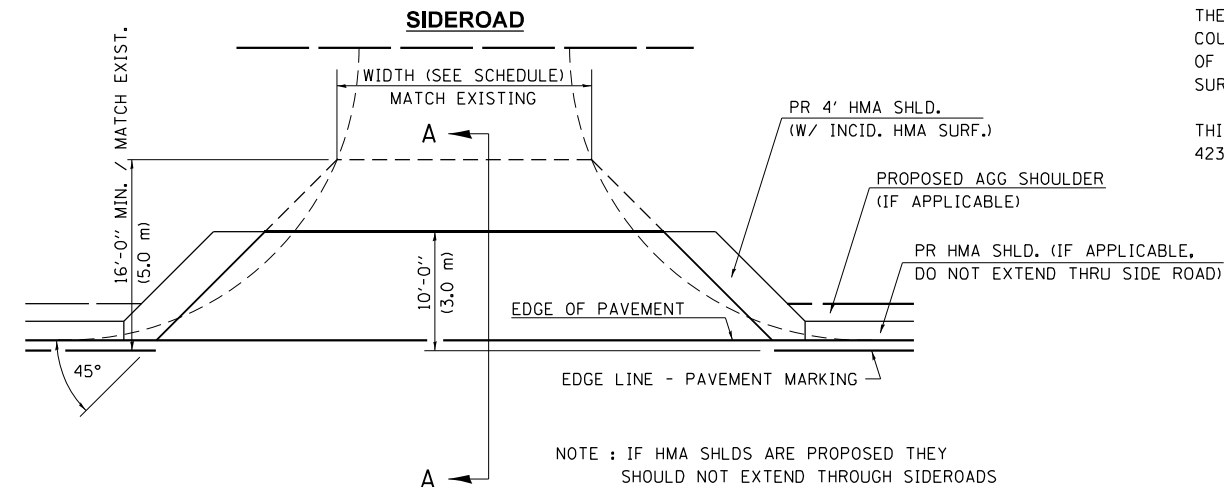

NOTE: IF HMA SHLDS ARE PROPOSED THEY SHOULD NOT EXTEND THROUGH SIDEROADS

|  |  |                                       |                       |   |  |                           |         |        |              |           |  |
|--|--|---------------------------------------|-----------------------|---|--|---------------------------|---------|--------|--------------|-----------|--|
| FILE NAME =                            | USER NAME = Timothy.Sharp                  | DESIGNED -                            | REVISED - 2/19/03 JCN | <b>STATE OF ILLINOIS<br/>DEPARTMENT OF TRANSPORTATION</b> | <b>DIST. 6 DETAILS FOR RURAL/URBAN ENT., MAILBOX<br/>TURNOUT &amp; SIDEROADS W/O CONC. GUTTER (3P-PROJ.)</b> | F.A. RTE.                 | SECTION | COUNTY | TOTAL SHEETS | SHEET NO. |  |
| S:\CONTRMINT_CAD\72724 - FAS 743 (HILL | VIEW BLACKTOP)-STANDARD OVERLAY - SCOTT CC | DRAWN - plens\72724\ent-9-10-entrance | REVISED - 4/01/04 JCN |   |  | 743                       | 19RS-7  | SCOTT  | 10           | 9         |  |
| ENT PPP.DGN                            | PLOT SCALE = 40.000' / in.                 | CHECKED - JCN                         | REVISED -             |   |  | CONTRACT NO. 72724        |         |        |              |           |  |
| Default                                | PLOT DATE = 12/19/2023                     | DATE - FEBRUARY 23, 1999              | REVISED -             |   |  | ILLINOIS FED. AID PROJECT |         |        |              |           |  |

## DETAILS OF MAILBOX TURNOUTS

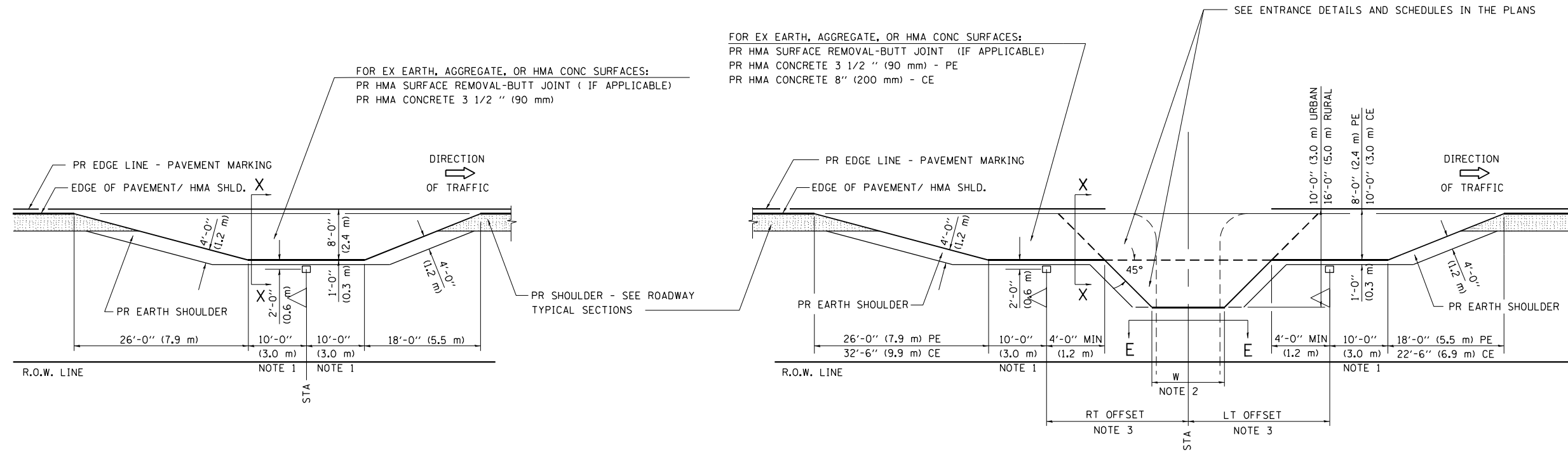

**PLAN - MAILBOX TURNOUTS**

**PLAN - COMBINED MAILBOX TURNOUT WITH TRAILING OR LEADING ENTRANCE**

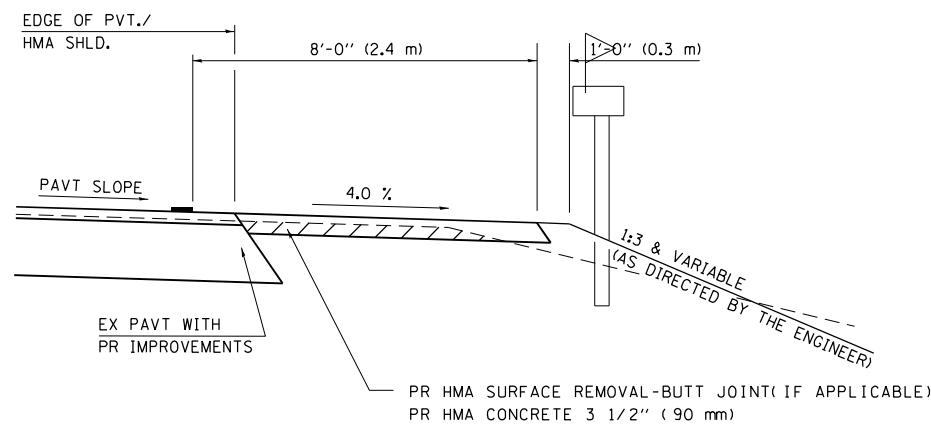

**SECTION X-X THRU MAILBOX TURNOUT  
ALSO APPLIES TO MAILBOX TURNOUTS COMBINED WITH  
EX EARTH, AGGREGATE, OR HMA PE & FE**

( DETAIL APPLIES WHEN M.B. TURNOUT DOES NOT EXIST.  
IF EXISTING, TREAT SAME AS ENTRANCE. )

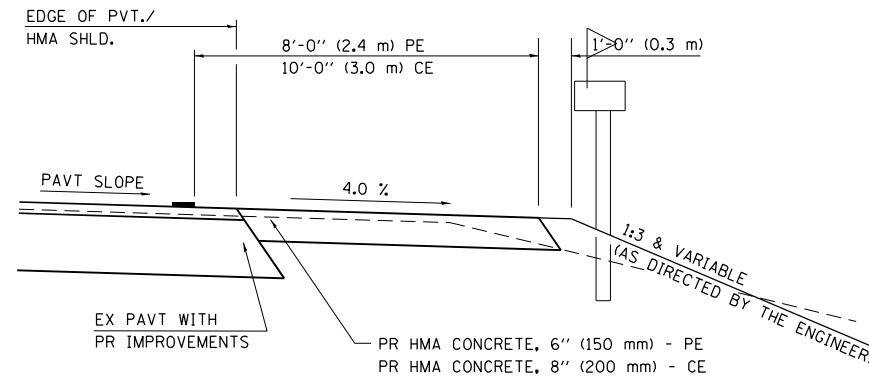

**SECTION X-X THRU MAILBOX TURNOUT  
COMBINED WITH EX HMA CONC & PC CONC PE & CE**

( DETAIL APPLIES WHEN M.B. TURNOUT DOES NOT EXIST.  
IF EXISTING, TREAT SAME AS ENTRANCE. )

- NOTE 1 IF MORE THAN ONE MAILBOX IS PRESENT, DIMENSION FROM CENTER OF END MAILBOX.
- NOTE 2 FOR ENTRANCE LAYOUT DIMENSIONS AND SECTIONS A-A & E-E REFER TO THE SCHEDULES IN THE PLANS.
- NOTE 3 BOTH LT OR RT OFFSETS FOR MAILBOX SHOWN USE OFFSET DIMENSION PER SCHEDULE AND REFER TO LAYOUT SHOWN ON THE PLAN.

ALL DIMENSIONS ARE IN INCHES ( MILLIMETERS )  
UNLESS OTHERWISE SHOWN.

|                                       |  |                                     |                       |
|---------------------------------------|--|-------------------------------------|-----------------------|
| FILE NAME =                           | USER NAME = Timothy.Sharp                  | DESIGNED -                          | REVISED - 2/19/03 JCN |
| S:\CONTRMNT_CAD\72724 - FAS 743 (HILL | VIEW BLACKTOP)-STANDARD OVERLAY - SCOTT CC | DRAWN 24\plans\CAD\sh-9-10-entrance | REVISED - 4/01/04 JCN |
| ENT PPP.DGN                           | PLOT SCALE = 40.000 ' / in.                | CHECKED - JCN                       | REVISED -             |
| Default                               | PLOT DATE = 12/19/2023                     | DATE - FEBRUARY 23, 1999            | REVISED -             |

**STATE OF ILLINOIS  
DEPARTMENT OF TRANSPORTATION**

**DIST.6 DETAILS FOR RURAL/URBAN ENT., MAILBOX  
TURNOUT & SIDEROADS W/O CONC. GUTTER (3P-PROJ.)**

SCALE: SHEET 1 OF 3 SHEETS STA. TO STA.

| F.A. RTE.                 | SECTION | COUNTY | TOTAL SHEETS | SHEET NO. |
|---------------------------|---------|--------|--------------|-----------|
| 743                       | 19RS-7  | SCOTT  | 10           | 10        |
| CONTRACT NO. 72724        |         |        |              |           |
| ILLINOIS FED. AID PROJECT |         |        |              |           |