

STATE OF ILLINOIS
DEPARTMENT OF TRANSPORTATION

F.A.P. RTE.	SECTION	COUNTY	TOTAL SHEETS	SHEET NO.
869	D9 BRIDGE OVERLAY 2023-8	FRANKLIN	27	1
		ILLINOIS	CONTRACT NO. 78997	

D-89-031-23

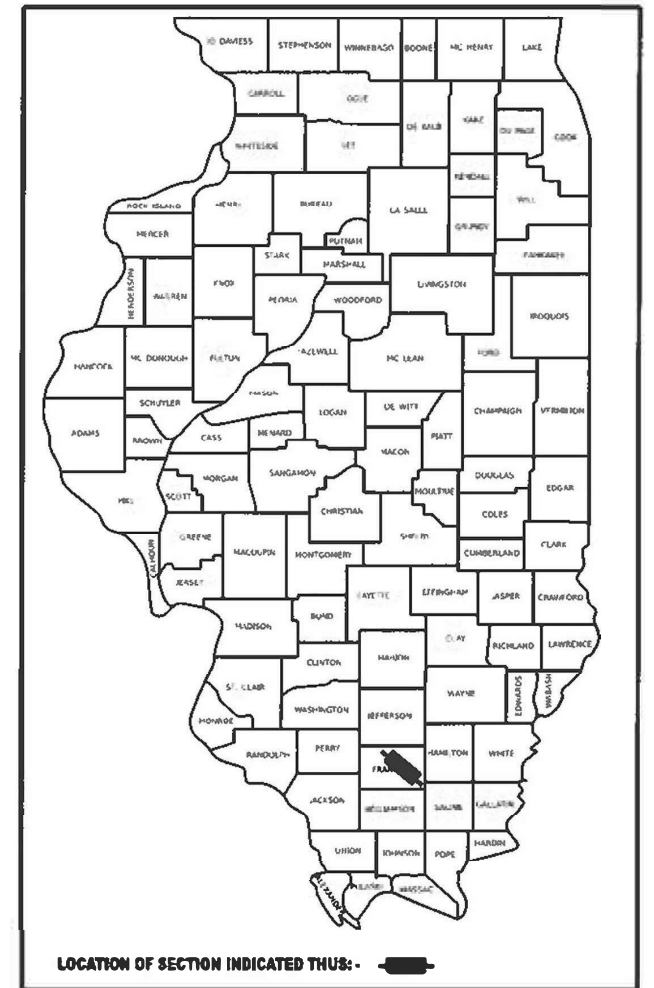

PROPOSED
HIGHWAY PLANS

FAP ROUTE 869 (IL 34)
D9 BRIDGE OVERLAY 2023-8
PROJECT HBFP-245Z(153)
BRIDGE DECK OVERLAY
FRANKLIN COUNTY

C-99-044-23

FOR INDEX OF SHEETS, SEE SHEET NO. 3
FOR SUMMARY OF QUANTITIES, SEE SHEET NO. 4-6

TRAFFIC DATA

2023: ADT = 3,880 (11% TRUCKS)
2033: ADT = 4,280 (11% TRUCKS)
2043: ADT = 4,730 (11% TRUCKS)

TOWNSHIPS
BENTON

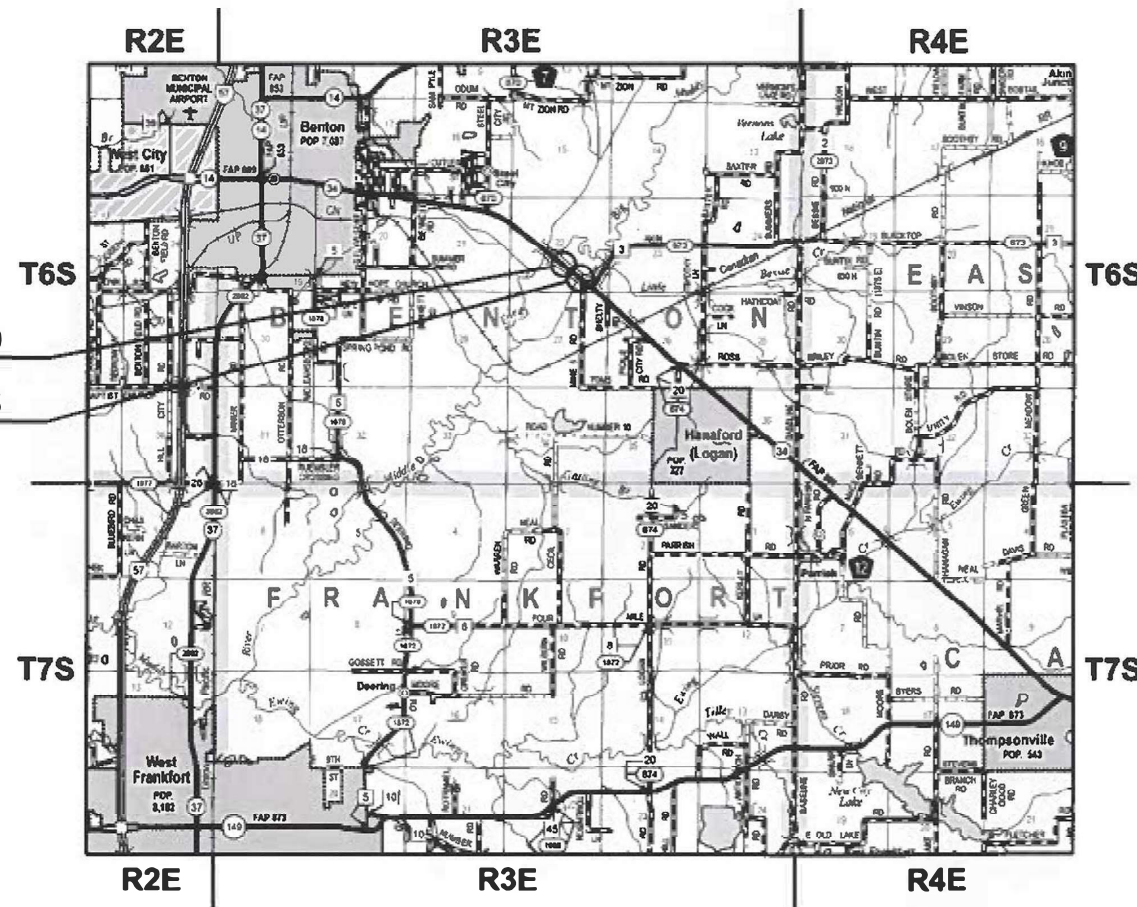

SN 028-0044 - STA 125+80
SN 028-0045 - STA 137+05

DESIGN DESIGNATION : N/A
COORDINATE SYSTEM : N/A
POSTED SPEED : 55 MPH

J.U.L.L.E.
JOINT UTILITY LOCATION INFORMATION FOR EXCAVATION
1-800-892-0123
OR 811

PROJECT ENGINEER: EHREN KIRBY
PROJECT DESIGNER: ZACH LOMAX

CONTRACT NO. 78997

GROSS LENGTH = 458.00 FT. = 0.09 MILES
NET LENGTH = 458.00 FT. = 0.09 MILES

STATE OF ILLINOIS
DEPARTMENT OF TRANSPORTATION

SUBMITTED Dec 11 2023
Kirk H. Brown
REGION FIVE ENGINEER

February 2, 2024
[Signature]
ENGINEER OF DESIGN AND ENVIRONMENT

February 2, 2024
[Signature]
DIRECTOR OF HIGHWAYS PROJECT IMPLEMENTATION

PRINTED BY THE AUTHORITY
OF THE STATE OF ILLINOIS

MODEL: Signature (Sheet)
FILE NAME: \\ms-srv-1\brilliant\com\p\m\DOT\Documents\DOT Office\Oletha BORD Project\2023\869\869-D9 Bridge\869-D9 Bridge-23-02.dwg

Prepared By: Charles Stein
DISTRICT STUDIES & PLANS ENGINEER

Examined By: Nancy Hei
DISTRICT LAND ACQUISITION ENGINEER

Examined By: Con Nelson
DISTRICT PROGRAM DEVELOPMENT ENGINEER

Examined By: [Signature]
DISTRICT OPERATIONS ENGINEER

Examined By: Daryl Muesel
DISTRICT PROJECT IMPLEMENTATION ENGINEER

Examined By: Daryl Muesel
DISTRICT CONSTRUCTION ENGINEER

Examined By: Aam Wang
DISTRICT MATERIALS ENGINEER

USER NAME	• david.a.wilson	DESIGNED	-	REVISED	-
DRAWN	-	REVISIONS	-	REVISIONS	-
PLOT SCALE	• 0.18668633 / in.	CHECKED	-	REVISIONS	-
PLOT DATE	• 12/4/2023	DATE	-	REVISIONS	-

STATE OF ILLINOIS
DEPARTMENT OF TRANSPORTATION

SIGNATURE SHEET

SCALE: SHEET 2 OF 27 SHEETS STA. TO STA.

F.A.P. RTE.	SECTION	COUNTY	TOTAL SHEETS	SHEET NO.
869	D9 BRIDGE OVERLAY 2023-8	FRANKLIN	27	2
ILLINOIS FED. AID PROJECT CONTRACT NO. 78997				

INDEX OF SHEETS

SHEET NO	DESCRIPTION
1	COVER SHEET
2	SIGNATURE SHEET
3	INDEX OF SHEETS, HIGHWAY STANDARDS, GENERAL NOTES, AND COMMITMENTS
4-6	SUMMARY OF QUANTITIES
7	SCHEDULES
8	TYPICAL SECTION - SN 028-0044 & SN 028-0045
9	STAGE CONSTRUCTION - SN 028-0044 & SN 028-0045
10	HMA BUTT-JOINT DETAILS - SN 028-0044 & SN 028-0045
11	GUARDRAIL DETAILS
12-13	STAGE I DETAILS
14-15	STAGE II DETAILS
16	STAGE III DETAILS
17	STAGE IV DETAILS
18	GENERAL PLAN AND ELEVATION - SN 028-0044
19	CONCRETE WEARING SURFACE PLAN - SN 028-0044
20	REINFORCEMENT DETAILS - SN 028-0044
21	GENERAL PLAN AND ELEVATION - SN 028-0045
22	CONCRETE WEARING SURFACE PLAN - SN 028-0045
23	REINFORCEMENT DETAILS - SN 028-0045
24	BAR SPICER ASSEMBLY - SN 028-0044 & SN 028-0045
25	STEEL RAILING DETAILS - SN 028-0044 & SN 028-0045
26	TEMPORARY CONCRETE BARRIER DETAILS - SN 028-0044 & SN 028-0045
27	DRAIN DETAILS - SN 028-0044 & SN 028-0045

HIGHWAY STANDARDS

000001-08	STANDARD SYMBOLS ABBREVIATIONS
001001-02	AREAS OF REINFORCEMENT BARS
001006-04	DECIMAL OF AN INCH & OF A FOOT
630001-13	STEEL PLATE BEAM GUARDRAIL
701001-02	OFF-ROAD OPERATIONS, 2L, 2W, MORE THAN 15' (4.5 m) AWAY
701006-05	OFF-ROAD OPERATIONS, 2L, 2W, 15' (4.5 m) TO 24' (600 mm) FROM PAVEMENT EDGE
701011-04	OFF-ROAD MOVING OPERATIONS 2L2W DAY ONLY
701201-05	LANE CLOSURE, 2L, 2W, DAY ONLY, FOR SPEEDS ≥ 45 MPH
701301-04	LANE CLOSURE, 2L2W, SHORT TIME OPERATIONS
701306-04	LANE CLOSURE, 2L2W, SLOW MOVING OPERATIONS DAY ONLY, FOR SPEEDS ≥ 45 MPH
701311-03	LANE CLOSURE 2L2W MOVING OPERATIONS DAY ONLY
701321-18	LANE CLOSURE, 2L, 2W, BRIDGE REPAIR WITH BARRIER
701326-04	LANE CLOSURE, 2L2W, PAVEMENT WIDENING FOR SPEEDS ≥ 45 MPH
701901-09	TRAFFIC CONTROL DEVICES
704001-08	TEMPORARY CONCRETE BARRIER
780001-05	TYPICAL PAVEMENT MARKINGS
782006-01	GUARDRAIL AND BARRIER REFLECTOR MOUNTING DETAILS
420001-10	PAVEMENT JOINTS
630301-09	SHOULDER WIDENING FOR TYPE 1 (SPECIAL) GUARDRAIL TERMINALS
631066	TRAFFIC BARRIER TERMINAL, TYPE 14
862001-01	UNINTERRUPTABLE POWER SUPPLY (UPS)

GENERAL NOTES

FACTORS USED FOR ESTIMATING PLAN QUANTITIES AREA AS FOLLOWS AND SHALL NOT BE USED AS BASIS OF FINALS QUANTITIES.

ALL HOT MIX ASPHALT

2.016 TONS/CU. YD.

THE QUANTITY OF SHORT TERM PAVEMENT MARKING SHOWN IN THE PLANS IS BASED ON ONE APPLICATION EACH FOR THE HMA SURFACE REMOVAL, BINDER COURSE, AND SURFACE COURSE

COMMITMENTS: NONE

HMA MIXTURE REQUIREMENTS TABLES

The following HMA mixture requirements are applicable for this project

Locations	Hot-Mix Asphalt Surface Course
Mixture Use(s):	Hot-Mix Asphalt Surface Course, Mix C, N70
AB/PG:	PG64-22
ABR % (Max):	See Special Provision
Design Air Voids:	4.0 %, 70 Gyration Design
Mixture Composition: (Gradation Mixture)	IL-9.5 mm
Friction Aggregate:	C Surface
Mixture Weight:	112 lbs/Sq Yd/in
Quality Management Program:	QC/QA
Sublot Size:	3,000 tons
Material Transfer Device (Required?)	No

Locations	Hot-Mix Asphalt Binder Course
Mixture Use(s):	Hot-Mix Asphalt Binder Course, IL-9.5FG, N70
AB/PG:	PG64-22
ABR % (Max):	See Special Provision
Design Air Voids:	4.0 %, 70 Gyration Design
Mixture Composition: (Gradation Mixture)	IL-9.5FG mm
Friction Aggregate:	None
Mixture Weight:	112 lbs/Sq Yd/in
Quality Management Program:	QC/QA
Sublot Size:	3,000 tons
Material Transfer Device (Required?)	No

REV. - MS

**STATE OF ILLINOIS
DEPARTMENT OF TRANSPORTATION**

**INDEX OF SHEETS, HIGHWAY STANDARDS,
GENERAL NOTES AND COMMITMENTS**

SCALE: SHEET 3 OF 27 SHEETS STA. TO STA.

F.A.P. RTE.	SECTION	COUNTY	TOTAL SHEETS	SHEET NO.
889	D9 BRIDGE OVERLAY 2023-8	FRANKLIN	27	3
CONTRACT NO. 78997				
ILLINOIS FED. AID PROJECT				

SUMMARY OF QUANTITIES

COUNTY:	FRANKLIN CO	FRANKLIN CO
ROUTE:	IL 34 (FAP 869)	IL 34 (FAP 869)
FUNDING:	80% FEDERAL 20% STATE	80% FEDERAL 20% STATE
LOCATION:	RURAL	RURAL
	SN 028-0044	SN 028-0045
	0047	0047

CODE NUMBER	ITEM DESCRIPTION	UNIT	TOTAL QUANTITY	SN 028-0044	SN 028-0045
20200500	EARTH EXCAVATION (WIDENING)	CU YD	98	48	50
35400500	PORTLAND CEMENT CONCRETE BASE COURSE WIDENING 10"	SQ YD	351	172	179
40600290	BITUMINOUS MATERIALS (TACK COAT)	POUND	528	264	264
40600982	HOT-MIX ASPHALT SURFACE REMOVAL - BUTT JOINT	SQ YD	231	115.5	115.5
40600990	TEMPORARY RAMP	SQ YD	263	131.5	131.5
40602970	HOT-MIX ASPHALT BINDER COURSE, IL-9.5FG, N70	TON	37	18.5	18.5
40604052	HOT-MIX ASPHALT SURFACE COURSE, IL-9.5, MIX "C", N70	TON	96	48	48
44000151	HOT-MIX ASPHALT SURFACE REMOVAL, 1/2"	SQ YD	578	289	289
50300100	FLOOR DRAINS	EACH	12	6	6
50300260	BRIDGE DECK GROOVING	SQ YD	554	277	277
50300300	PROTECTIVE COAT	SQ YD	574	287	287
50800205	REINFORCEMENT BARS, EPOXY COATED	POUND	7,280	3,640	3,640
50800515	BAR SPLICERS	EACH	180	90	90
50900207	STEEL RAILING, TYPE CO-10	FOOT	356	178	178
* 63000001	STEEL PLATE BEAM GUARDRAIL, TYPE A, 6 FOOT POSTS	FOOT	400	200	200

* SPECIALTY ITEM

REV. - MS

MODEL: SDO (Sheet)
 FILE NAME: p:\projects\p01\bridge\summary\DOT\Office\Drawings\DOT\Office\Drawings\DOT\Projects\869\IL34\Drawings\DOT\Summary\SOC_Soc.dgn

USER NAME = david.a.wilson	DESIGNED -	REVISED -
	DRAWN -	REVISED -
PLOT SCALE = 0.16666633 / in.	CHECKED -	REVISED -
PLOT DATE = 12/11/2023	DATE -	REVISED -

**STATE OF ILLINOIS
DEPARTMENT OF TRANSPORTATION**

SUMMARY OF QUANTITIES

SCALE: SHEET 4 OF 27 SHEETS STA TO STA.

F.A.P. RTE.	SECTION	COUNTY	TOTAL SHEETS	SHEET NO.
869	D9 BRIDGE OVERLAY 2023-8	FRANKLIN	27	4
CONTRACT NO. 78997				
ILLINOIS FED. AID PROJECT				

SUMMARY OF QUANTITIES - CONT

COUNTY:	FRANKLIN CO	FRANKLIN CO
ROUTE:	IL 34 (FAP 869)	IL 34 (FAP 869)
FUNDING:	80% FEDERAL 20% STATE	80% FEDERAL 20% STATE
LOCATION:	RURAL	RURAL

CODE NUMBER	ITEM DESCRIPTION	UNIT	TOTAL QUANTITY	FRANKLIN CO	
				SN 028-0044 0047	SN 028-0045 0047
70300221	TEMPORARY PAVEMENT MARKING - LINE 4" - PAINT	FOOT	3,957	1,978.5	1,978.5
70400100	TEMPORARY CONCRETE BARRIER	FOOT	600	300	300
70400125	PINNING TEMPORARY CONCRETE BARRIER	EACH	48	24	24
70400200	RELOCATE TEMPORARY CONCRETE BARRIER	FOOT	587.5	300.0	287.5
70600260	IMPACT ATTENUATORS, TEMPORARY (FULLY REDIRECTIVE, NARROW), TEST LEVEL 3	EACH	4	2	2
70600332	IMPACT ATTENUATORS, RELOCATE (FULLY REDIRECTIVE, NARROW), TEST LEVEL 3	EACH	4	2	2
* 72501000	TERMINAL MARKER - DIRECT APPLIED	EACH	8	4	4
* 78001110	PAINT PAVEMENT MARKING - LINE 4"	FOOT	3,957	1,978.5	1,978.5
* 78200005	GUARDRAIL REFLECTORS, TYPE A	EACH	16	8	8
78300201	PAVEMENT MARKING REMOVAL - GRINDING	SQ FT	2,638	1,319	1,319
* 86200300	UNINTERRUPTABLE POWER SUPPLY, EXTENDED	EACH	1	0.5	0.5
X5030305	CONCRETE WEARING SURFACE, 5"	SQ YD	554	277	277
X5870015	BRIDGE DECK CONCRETE SEALER	SQ FT	1,040	520	520
Z0012136	BRIDGE DECK SCARIFICATION 1 1/2"	SQ YD	554	277	277
Z0016001	DECK SLAB REPAIR (FULL DEPTH, TYPE I)	SQ YD	4.0	2.0	2.0

* SPECIALTY ITEM

REV. - MS

MODEL: S001 (Rev) FILE NAME: P:\2023\p1\bridge\summary\DOT\Office\Printed\8080 Project\78977CAD\Summary\Summary\Summary_S001_S001.dgn

USER NAME = david.s.wilson	DESIGNED -	REVISED -
PLOT SCALE = 0.16666633 / in.	DRAWN -	REVISED -
PLOT DATE = 12/11/2023	CHECKED -	REVISED -
	DATE -	REVISED -

**STATE OF ILLINOIS
DEPARTMENT OF TRANSPORTATION**

SUMMARY OF QUANTITIES

SCALE: SHEET 6 OF 27 SHEETS STA TO STA.

F.A.P. RTE.	SECTION	COUNTY	TOTAL SHEETS	SHEET NO.
869	D9 BRIDGE OVERLAY 2023-8	FRANKLIN	27	6
CONTRACT NO. 78997				
ILLINOIS FED. AID PROJECT				

PAVEMENT MARKING SCHEDULE

START STATION	END STATION	NOTES	PAINT PAVEMENT MARKING			PAVEMENT MARKING REMOVAL - GRINDING	SHORT TERM PAVEMENT MARKING	SHORT TERM PAVEMENT MARKING REMOVAL	TEMPORARY PAVEMENT MARKING - LINE 4" - PAINT
			LINE - 4" YELLOW						
			SOLID LT	SKIP-DASH	SOLID RT				
			FT	FT	FT				
IL 34 - SN 028-0044 TO SN 028-0045 STAGE I									
122+56.50	140+61.95				1,319				
IL 34 - SN 028-0044 TO SN 028-0045 STAGE III									
122+56.50	140+61.95					181			
IL 34 - SN 028-0044 TO SN 028-0045 STAGE IV									
122+56.50	140+61.95		1,692	460	1,805	1,319		61	3,957
PROJECT TOTALS			3,957			2,638	181	61	3,957

WIDENING SCHEDULE

LOCATION								LENGTH	PROPOSED WIDENING WIDTH	PCC BASE COURSE WIDENING	REMARKS
								FOR INFORMATIONAL PURPOSES ONLY		(10")	
								FT	FT	SQ YD	
IL 34 - SN 028-0044											
STA	124+09.50	LT	TO	STA	125+35.50	LT	126.0	3	42		
STA	123+99.50	RT	TO	STA	125+35.50	RT	136.0	3	46		
STA	126+24.50	LT	TO	STA	127+50.50	LT	126.0	3	42		
STA	126+24.50	RT	TO	STA	127+50.50	RT	126.0	3	42		
IL 34 - SN 028-0045											
STA	125+34.50	LT	TO	STA	126+60.50	LT	126.0	3	42		
STA	135+34.50	RT	TO	STA	136+60.50	RT	126.0	3	42		
STA	137+49.50	LT	TO	STA	139+08.50	LT	159.0	3	53		
STA	137+49.50	RT	TO	STA	138+75.50	RT	126.0	3	42		
PROJECT TOTALS								351			

MODEL: Schedules (Sheet)
 FILE NAME: P:\MIDOT\Documents\DOT Office\District 9\ORD Project\78997\CADD\Drawings\78997-SubE-Schedules.dgn

USER NAME = david.a.wilson	DESIGNED -	REVISED -
PLOT SCALE = 0.16666633' / in.	DRAWN -	REVISED -
PLOT DATE = 12/11/2023	CHECKED -	REVISED -
	DATE -	REVISED -

**STATE OF ILLINOIS
DEPARTMENT OF TRANSPORTATION**

SCHEDULES

SCALE: SHEET 7 OF 27 SHEETS STA. TO STA.

F.A.P. RTE.	SECTION	COUNTY	TOTAL SHEETS	SHEET NO.
869	D9 BRIDGE OVERLAY 2023-8	FRANKLIN	27	7
CONTRACT NO. 78997				
ILLINOIS FED. AID PROJECT				

**TYPICAL SECTION
(SN 028-0044 & SN 028-0045)**

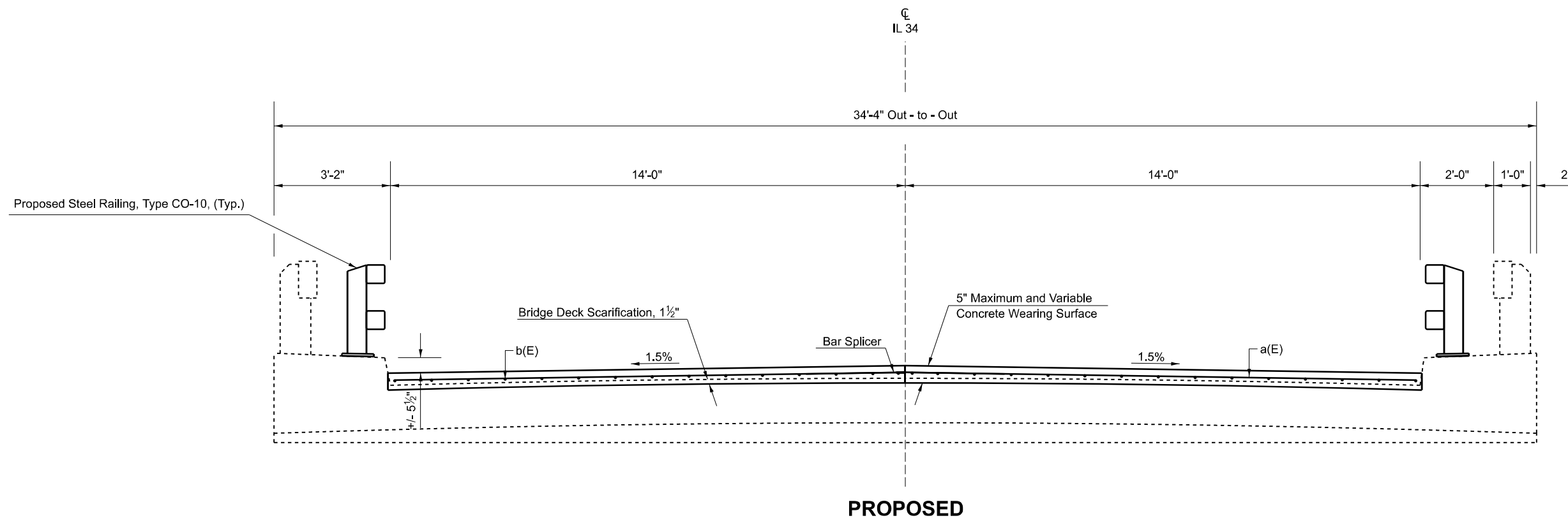
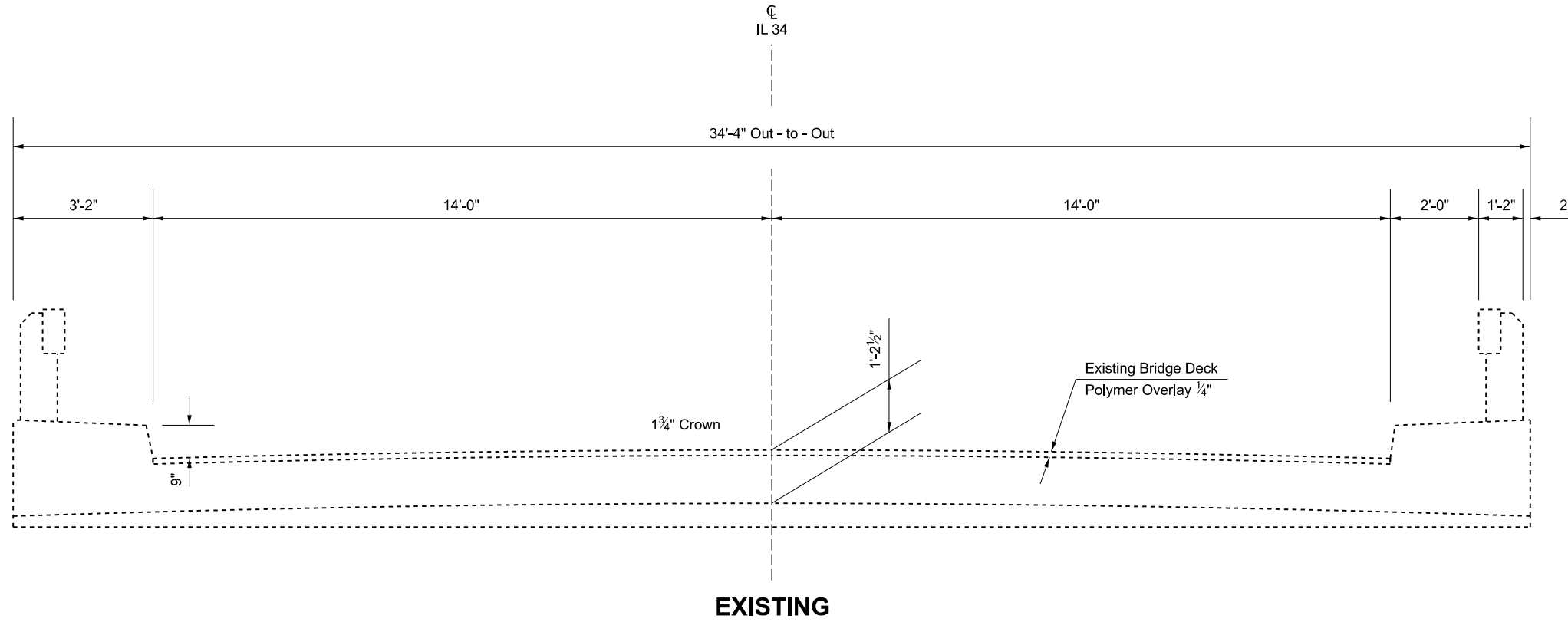

MODEL: Typical Section - 1 (Sheet)
 FILE NAME: P:\Public\Projects\78997\CADD\Drawings\CADD\Drawings\038997-2-Str.dgn

USER NAME = david.a.wilson	DESIGNED -	REVISED -
PLOT SCALE = 0.16666633' / in.	DRAWN -	REVISED -
PLOT DATE = 12/4/2023	CHECKED -	REVISED -
	DATE -	REVISED -

**STATE OF ILLINOIS
DEPARTMENT OF TRANSPORTATION**

TYPICAL SECTION SN 028-0044 & SN 028-0045			
SCALE:	SHEET 8	OF 27 SHEETS	STA. TO STA.

F.A.P. RTE.	SECTION	COUNTY	TOTAL SHEETS	SHEET NO.
869	D9 BRIDGE OVERLAY 2023-8	FRANKLIN	27	8
				CONTRACT NO. 78997
ILLINOIS FED. AID PROJECT				

**STAGE CONSTRUCTION
(SN 028-0044 & SN 028-0045)**

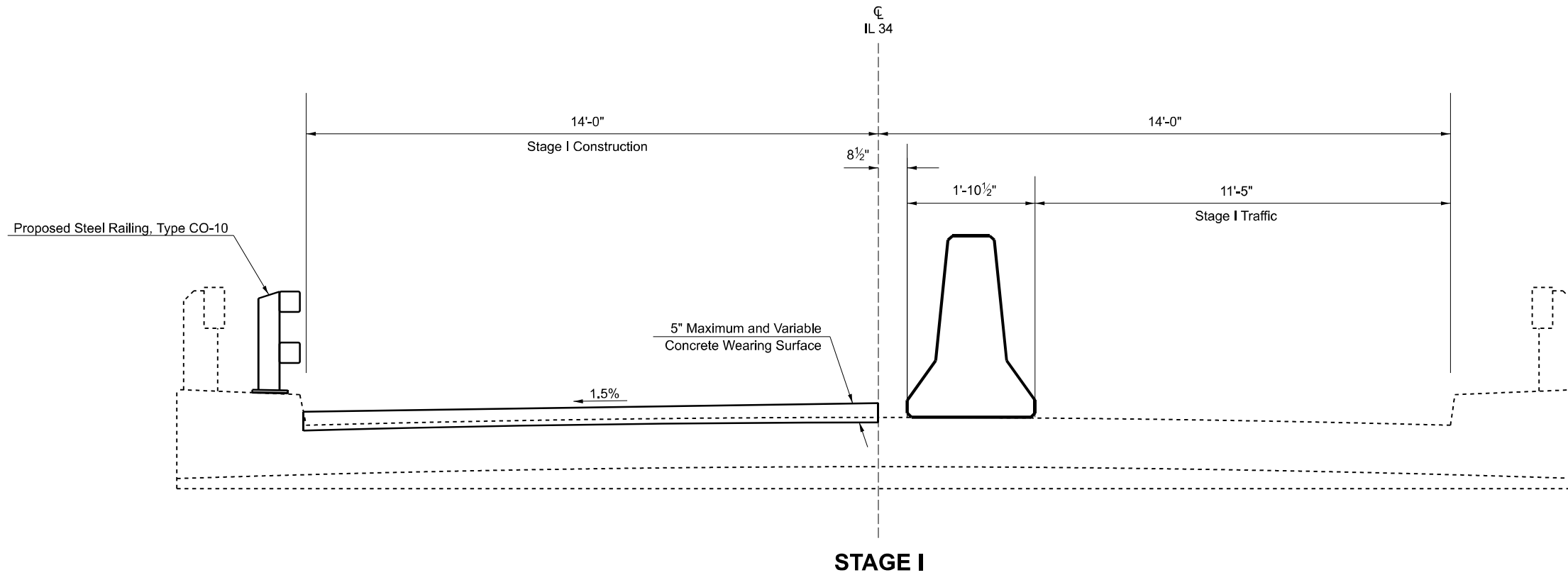

STAGE I

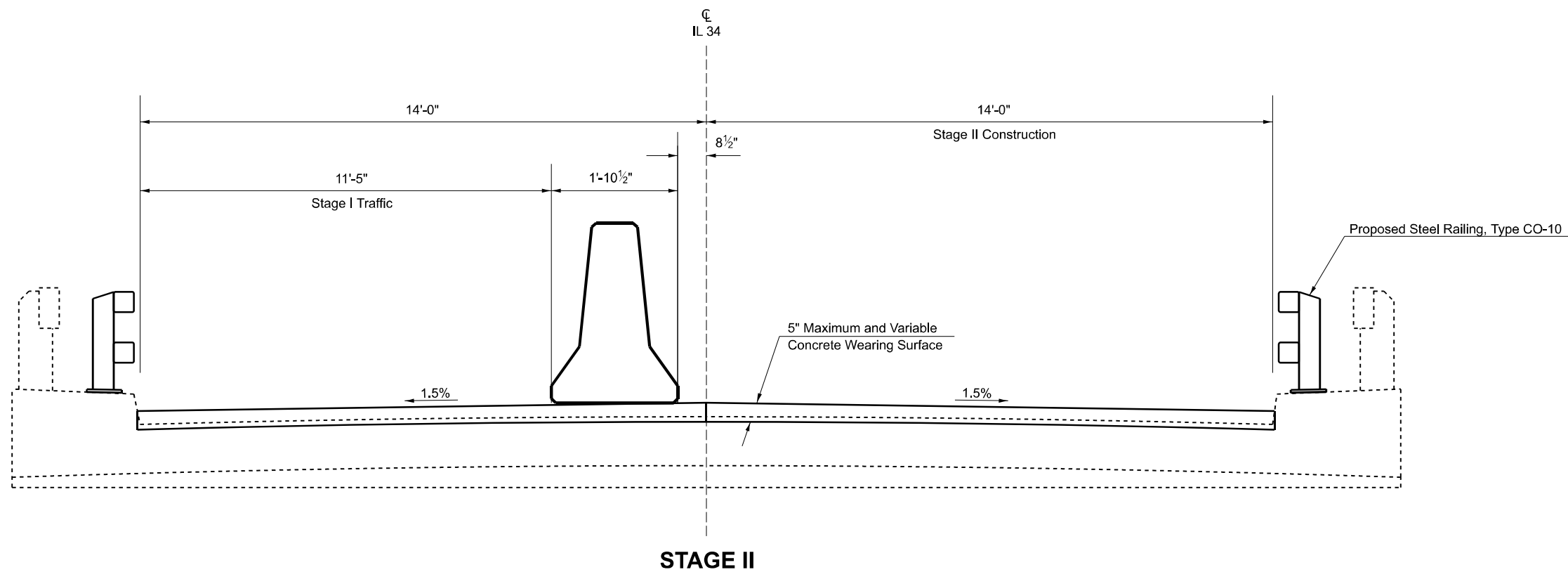

STAGE II

MODEL: Stage Construction - 1 (Sheet)
FILE NAME: P:\Public\Projects\PM\DOT\Documents\DOT Office\District 9\ORD Project\78997\CADD\Drawings\028997-Sub.dgn

USER NAME = david.a.wilson	DESIGNED -	REVISED -
	DRAWN -	REVISED -
PLOT SCALE = 0.16666633' / in.	CHECKED -	REVISED -
PLOT DATE = 12/4/2023	DATE -	REVISED -

**STATE OF ILLINOIS
DEPARTMENT OF TRANSPORTATION**

**STAGE CONSTRUCTION
SN 028-0044 & SN 028-0045**

SCALE: SHEET 9 OF 27 SHEETS STA. TO STA.

F.A.P. RTE.	SECTION	COUNTY	TOTAL SHEETS	SHEET NO.
869	D9 BRIDGE OVERLAY 2023-8	FRANKLIN	27	9
CONTRACT NO. 78997			ILLINOIS FED. AID PROJECT	

HMA BUTT-JOINT WITH MILLING

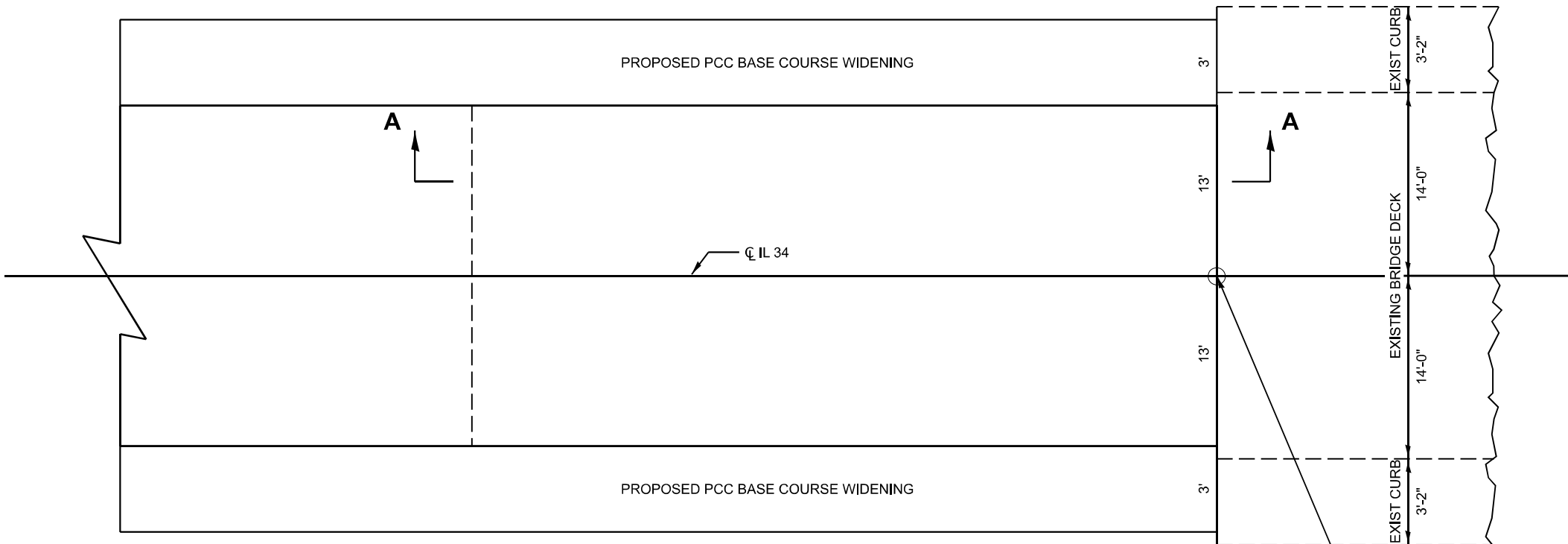

SN 028-0044 - STA 125+35.5
 SN 028-0044 - STA 126+24.5
 SN 028-0045 - STA 136+60.5
 SN 028-0045 - STA 137+49.5

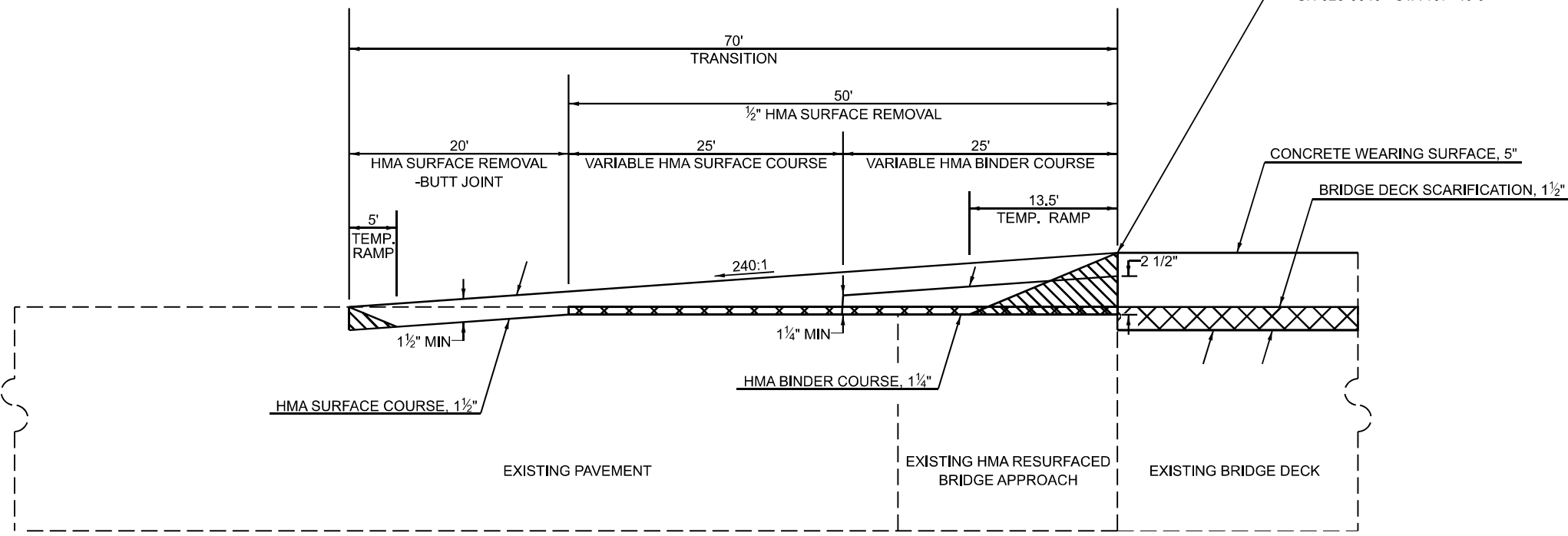

SECTION A-A

MODEL: HMA But Joint (Sheet)
 FILE NAME: P:\GIS\Projects\DOT\Office\District 9\ORD Project\78997\CADD\Drawings\028997-Str.dgn

USER NAME = david.a.wilson	DESIGNED -	REVISED -
PLOT SCALE = 0.16666633' / in.	DRAWN -	REVISED -
PLOT DATE = 12/4/2023	CHECKED -	REVISED -
	DATE -	REVISED -

STATE OF ILLINOIS
 DEPARTMENT OF TRANSPORTATION

HI IA BUTT-JOINT DETAILS
 SN 028-0044 & SN 028-0045

SCALE: SHEET 10 OF 27 SHEETS STA. TO STA.

F.A.P. RTE.	SECTION	COUNTY	TOTAL SHEETS	SHEET NO.
869	D9 BRIDGE OVERLAY 2023-8	FRANKLIN	27	10
CONTRACT NO. 78997				
ILLINOIS FED. AID PROJECT				

MODEL: I:\M-028-0044 (Sheet)
 FILE NAME: P:\GIS\Projects\I190RD\Project\78997\CADD\Info\CAD\Sheet\0280044-2.dwg

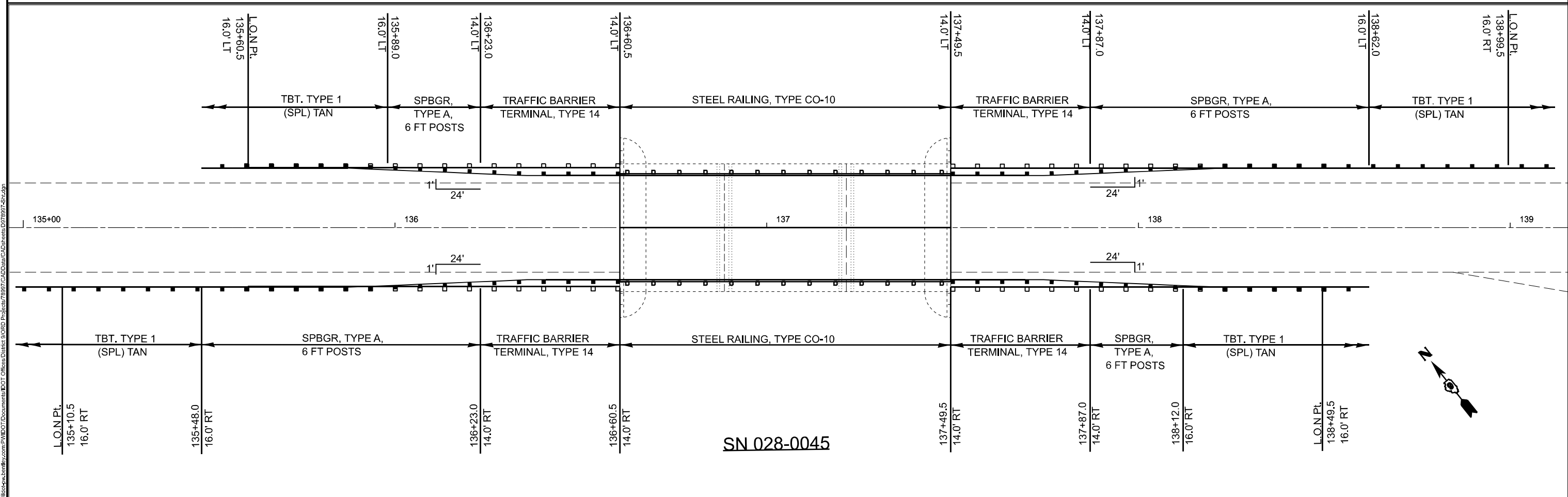
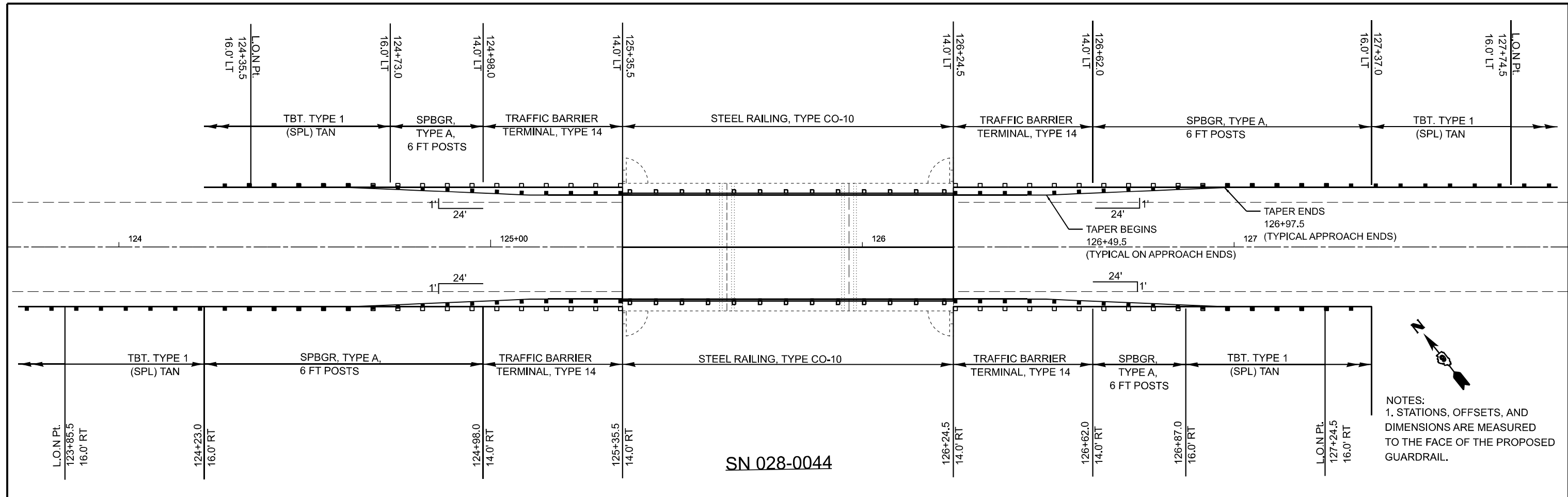

USER NAME = david.a.wilson	DESIGNED -	REVISED -
PLOT SCALE = 0.16666633' / in.	DRAWN -	REVISED -
PLOT DATE = 12/4/2023	CHECKED -	REVISED -
	DATE -	REVISED -

**STATE OF ILLINOIS
 DEPARTMENT OF TRANSPORTATION**

GUARDRAIL DETAILS

SCALE: CUSTOM 1:160 SHEET 11 OF 27 SHEETS STA. TO STA.

F.A.P. RTE.	SECTION	COUNTY	TOTAL SHEETS	SHEET NO.
869	D9 BRIDGE OVERLAY 2023-8	FRANKLIN	27	11
CONTRACT NO. 78997				
ILLINOIS FED. AID PROJECT				



* Must be installed pre-stage 1

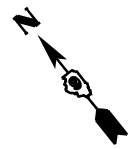
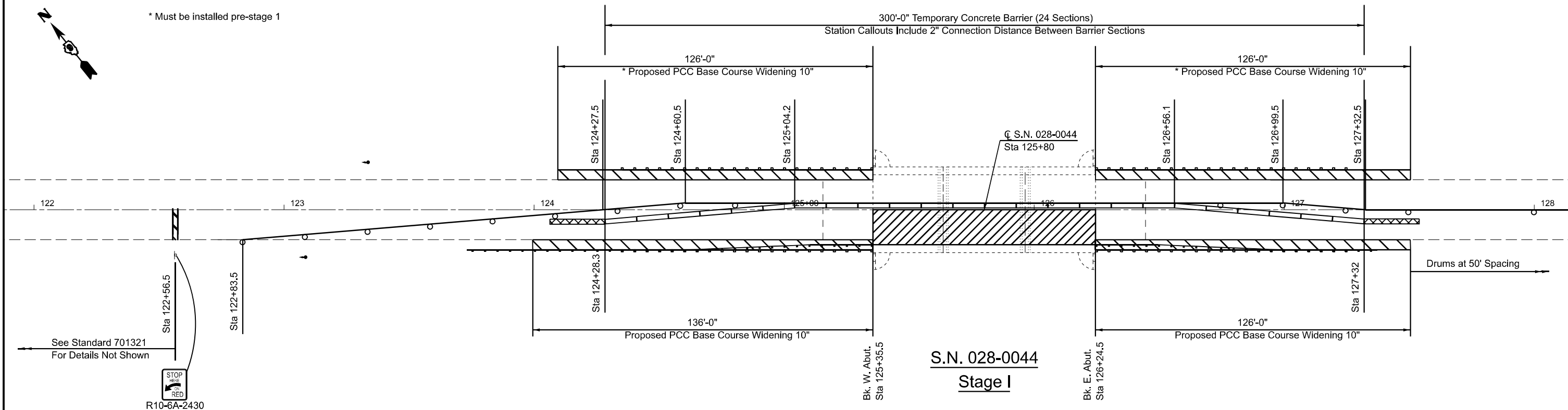

Continue Drums at 50' Spacing

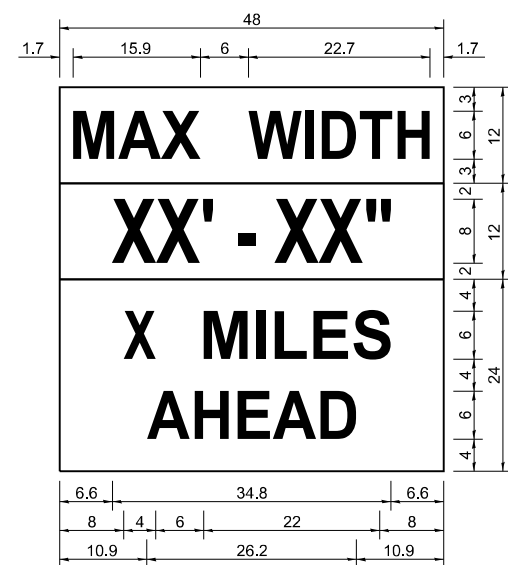

W12-1103

W12-1103 (WIDTH IS 80)
NO BORDER, BLACK ON WHITE:
[MAX WIDTH] D:

NO BORDER, BLACK ON ORANGE:
[XX' - XX"] D:

NO BORDER, BLACK ON WHITE:
[X MILES] D: [AHEAD] D:

ALL DIMENSIONS ARE IN INCHES UNLESS OTHERWISE NOTED.

Notes for Max Width Sign:

1. Install a Max Width Sign each direction on IL 34 to give traffic approaching work zone enough advance notice to change routes if needed. Exact locations as directed by engineer.
2. The contractor shall furnish the posts and erect the signs at the location directed by the engineer. All signs shall be post mounted.
3. The noted work, including signs, posts, hardware, and labor shall be included in the contract unit price, each, for Traffic Control and Protection, Std. 701321, no other compensation will be allowed.
4. The width shown on the W12-1103 sign shall be 18" less than what is shown in the staged lane widths or as directed by the Engineer.
5. The "X" MILES AHEAD will be determined by the engineer.

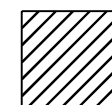

Concrete Wearing Surface

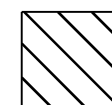

Base Course Widening 10"

Pre-Stage I:

1. Remove Existing Agg Wedge/Earth Shoulder
2. Construct PCC Base Course Widening, 10"
3. Traffic Control Shall Be In Accordance With Traffic Control and Protection Standard 701326

Traffic Control Notes:

1. Traffic Control Devices Not Shown In This Detail Shall Be Per Standard 701321
2. Rumble Strips Will Be Required As Shown In Standard 701321
3. Additional Traffic Control Devices and Striping shown in this detail to connect the traffic control at the bridges is included in the cost of Traffic Control and Protection, Standard 701321.

(Sheet 1 of 2)

**STATE OF ILLINOIS
DEPARTMENT OF TRANSPORTATION**

STAGE I DETAILS

SCALE: SHEET 12 OF 27 SHEETS STA. TO STA.

USER NAME = david.a.wilson	DESIGNED -	REVISED -
PLOT SCALE = 0.16666833' / in.	DRAWN -	REVISED -
PLOT DATE = 12/15/2023	CHECKED -	REVISED -
	DATE -	REVISED -

F.A.P. RTE.	SECTION	COUNTY	TOTAL SHEETS	SHEET NO.
869	D9 BRIDGE OVERLAY 2023-8	FRANKLIN	27	12
CONTRACT NO. 78997				
ILLINOIS FED. AID PROJECT				

MODEL: Stage 1 (13-in) FILE NAME: P:\DOT\Documents\DOT Office\Direct\BUREAU\Project\78997\CADD\Drawings\78997-Sub.dgn

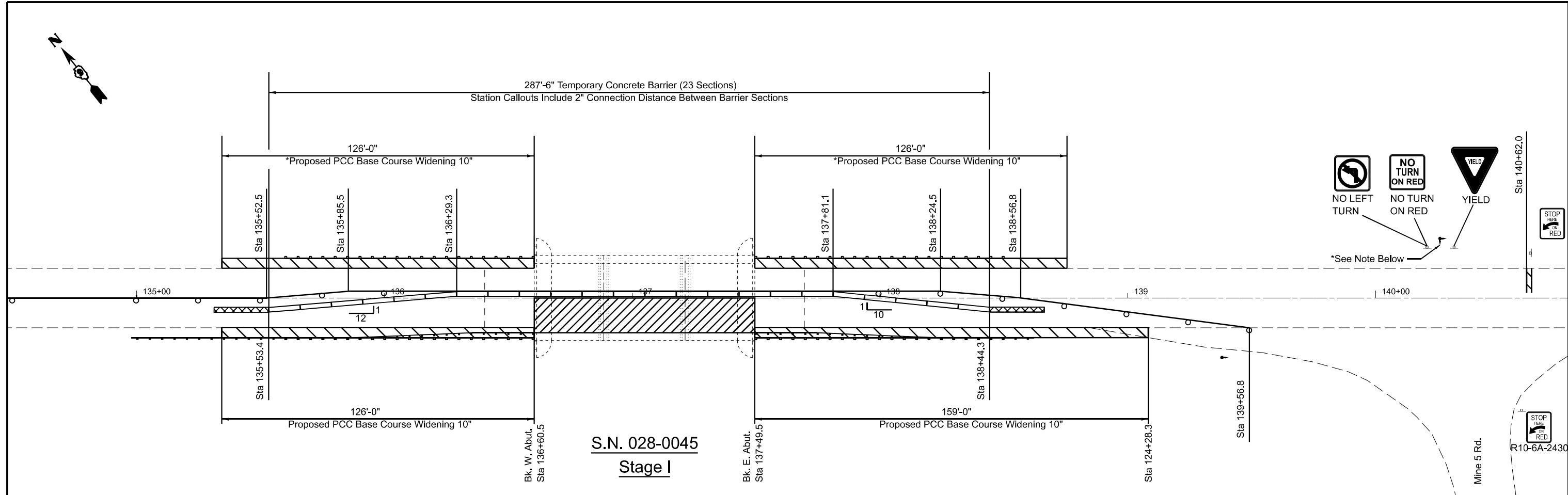

S.N. 028-0045
Stage I

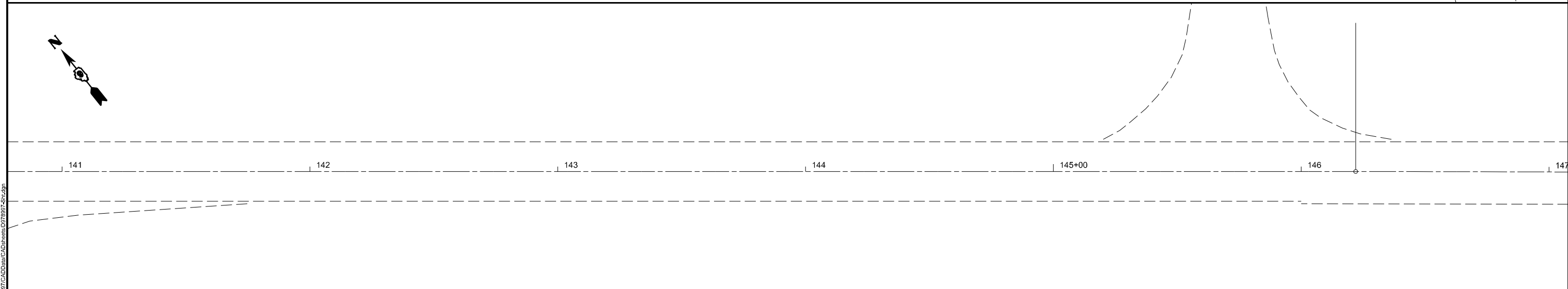

Notes for Mine 5 Rd. Signals:

* The Contractor shall provide a temporary signal across from Mine 5 Rd. The signal shall contain a red arrow and two yellow arrows. The Mine 5 Rd. signal shall be wired directly with the southbound phase. The phases shall coordinate with the southbound phases as follows:
 Red arrow to Red
 Top Yellow Arrow to Yellow
 Bottom Yellow Arrow to Green
 This Signal will be included in the cost of Temporary Bridge Traffic Signals, Each.

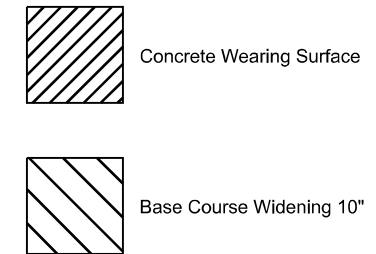

(Sheet 2 of 2)

MODEL: Stage I (2) (Sheet)
 FILE NAME: P:\MIDOT\Documents\DOT Office\District 9\ORD Project\78997\CADD\Sheet\0280045-2.dwg

USER NAME = david.a.wilson	DESIGNED -	REVISED -
DRAWN -	REVISED -	
PLOT SCALE = 0.16666633' / in.	CHECKED -	REVISED -
PLOT DATE = 12/15/2023	DATE -	REVISED -

STATE OF ILLINOIS
DEPARTMENT OF TRANSPORTATION

STAGE I DETAILS			
SCALE:	SHEET 13	OF 27 SHEETS	STA. TO STA.

F.A.P. RTE.	SECTION	COUNTY	TOTAL SHEETS	SHEET NO.
869	D9 BRIDGE OVERLAY 2023-8	FRANKLIN	27	13
CONTRACT NO. 78997			ILLINOIS FED. AID PROJECT	

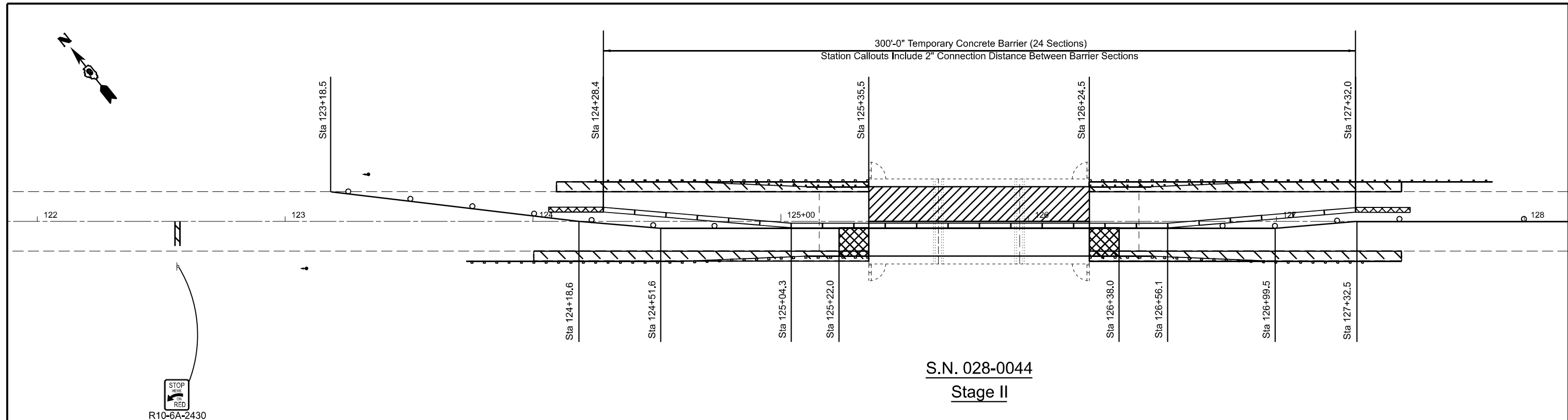
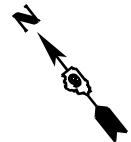

S.N. 028-0044
Stage II

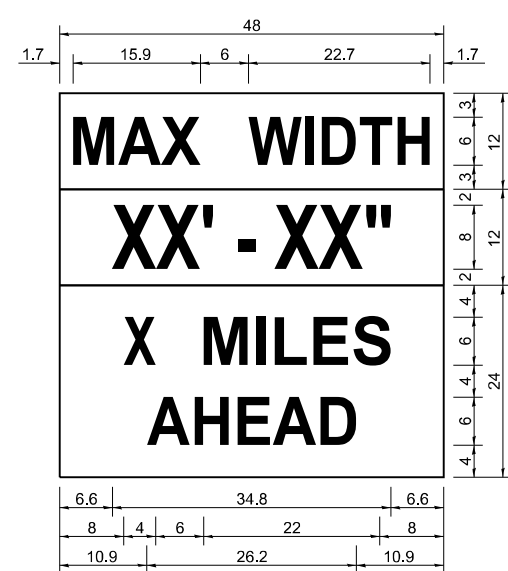
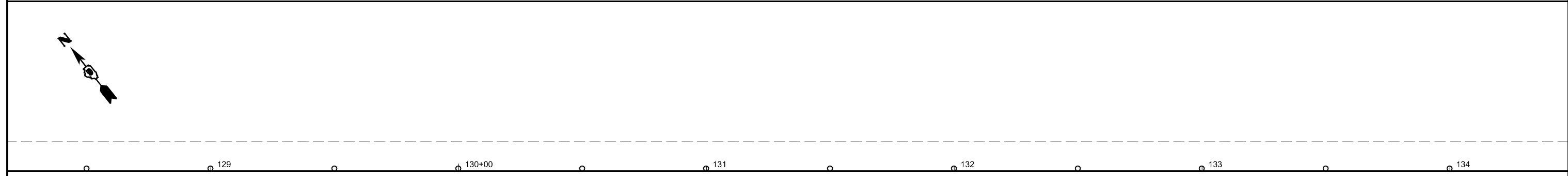
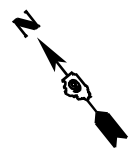

W12-1103

W12-1103 (WIDTH IS 80)
 NO BORDER, BLACK ON WHITE:
 [MAX WIDTH] D:
 NO BORDER, BLACK ON ORANGE:
 [XX' - XX"] D:
 NO BORDER, BLACK ON WHITE:
 [X MILES] D: [AHEAD] D:

Notes for Max Width Sign:

1. Install a Max Width Sign each direction on IL 34 to give traffic approaching work zone enough advance notice to change routes if needed. Exact locations as directed by engineer.
2. The contractor shall furnish the posts and erect the signs at the location directed by the engineer. All signs shall be post mounted.
3. The noted work, including signs, posts, hardware, and labor shall be included in the contract unit price, each, for Traffic Control and Protection, Std. 701321, no other compensation will be allowed
4. The width shown on the W12-1103 sign shall be 18" less than what is shown in the staged lane widths or as directed by the Engineer.
5. The "X" MILES AHEAD will be determined by the engineer.

ALL DIMENSIONS ARE IN INCHES UNLESS OTHERWISE NOTED.

Traffic Control Notes:

1. Traffic Control Devices Not Shown In This Detail Shall Be Per Standard 701321
2. Rumble Strips Will Be Required As Shown In Standard 701321
3. Additional Traffic Control Devices and Striping shown in this detail to connect the traffic control at the bridges is included in the cost of Traffic Control and Protection, Standard 701321.

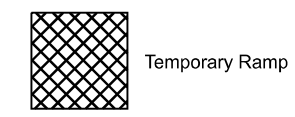

(Sheet 1 of 2)

MODEL: Stage II (Sheet)
 FILE NAME: P:\Illinois\Projects\DOT\Office\Direct\BUREAU\Projects\78997\CAD\Drawings\78997-Str.dgn

USER NAME = david.a.wilson	DESIGNED -	REVISED -
PLOT SCALE = 0.16666833' / in.	DRAWN -	REVISED -
PLOT DATE = 12/15/2023	CHECKED -	REVISED -
	DATE -	REVISED -

**STATE OF ILLINOIS
 DEPARTMENT OF TRANSPORTATION**

STAGE II DETAILS

SCALE: SHEET 14 OF 27 SHEETS STA. TO STA.

F.A.P. RTE.	SECTION	COUNTY	TOTAL SHEETS	SHEET NO.
869	D9 BRIDGE OVERLAY 2023-8	FRANKLIN	27	14
CONTRACT NO. 78997			ILLINOIS FED. AID PROJECT	

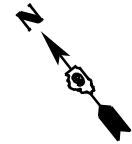

300'-0" Temporary Concrete Barrier (24 Sections)
 Station Callouts Include 2" Connection Distance Between Barrier Sections

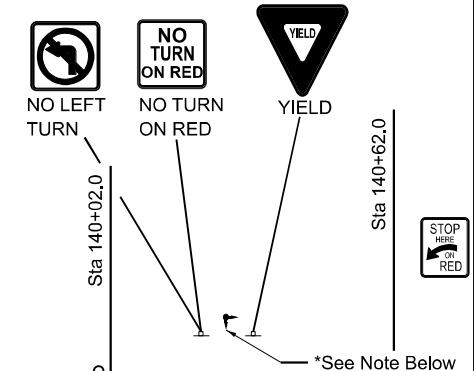

*See Note Below

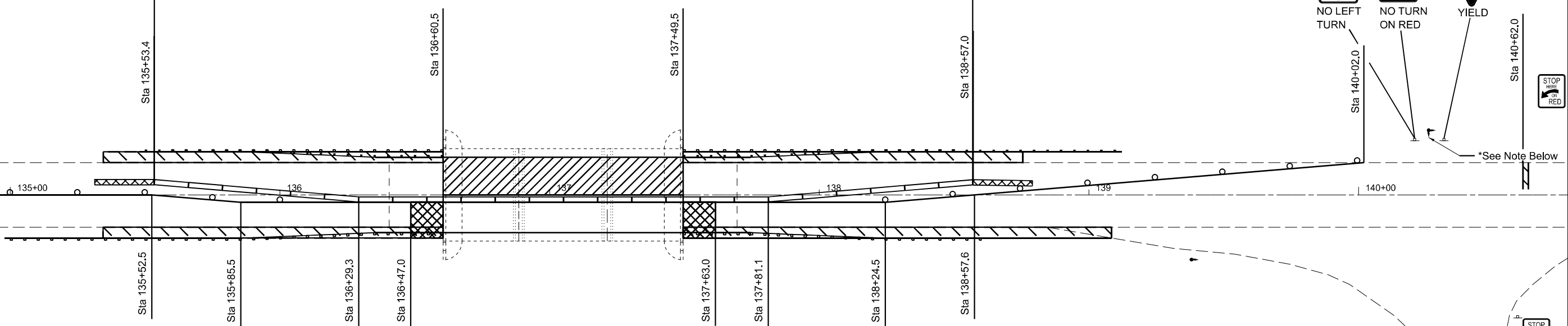

S.N. 028-0045
 Stage II

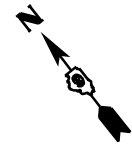

141 142 143 144 145+00 146 147

Notes for Mine 5 Rd. Signals:

* The Contractor shall provide a temporary signal across from Mine 5 Rd.
 The signal shall contain a red arrow and two yellow arrows.
 The Mine 5 Rd. signal shall be wired directly with the southbound phases.
 The phases shall coordinate with the southbound phases as follows:
 Red arrow to Red
 Top Yellow Arrow to Yellow
 Bottom Yellow Arrow to Green
 This Signal will be included in the cost of Temporary Bridge Traffic Signals, Each.



Concrete Wearing Surface

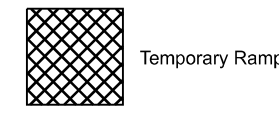

Temporary Ramp

(Sheet 2 of 2)

MODEL: Stage II (2) [Sheet]
 FILE NAME: P:\GIS\Projects\DOT\Office\District 9\ORD Project\78997\CADD\Info\CAD\Sheet\0280045-2.dgn

USER NAME = david.a.wilson	DESIGNED -	REVISED -
DRAWN -	REVISED -	
PLOT SCALE = 0.16666633' / in.	CHECKED -	REVISED -
PLOT DATE = 12/15/2023	DATE -	REVISED -

**STATE OF ILLINOIS
 DEPARTMENT OF TRANSPORTATION**

STAGE II DETAILS

SCALE: SHEET 15 OF 27 SHEETS STA. TO STA.

F.A.P. RTE.	SECTION	COUNTY	TOTAL SHEETS	SHEET NO.
869	D9 BRIDGE OVERLAY 2023-8	FRANKLIN	27	15
CONTRACT NO. 78997			ILLINOIS FED. AID PROJECT	

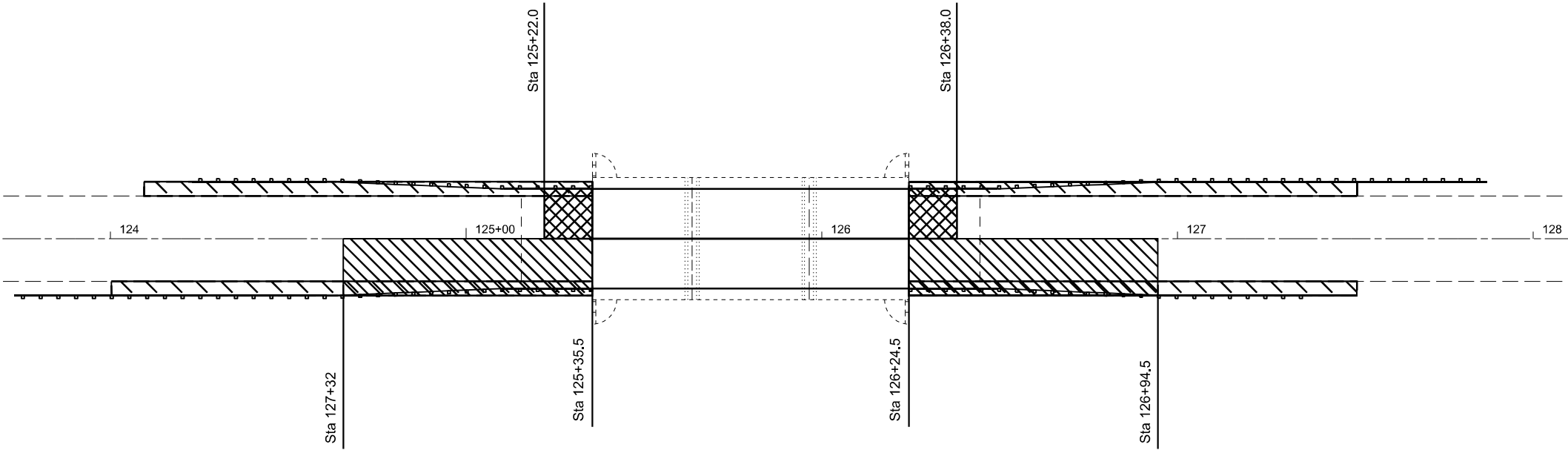

S.N. 028-0044
Stage III

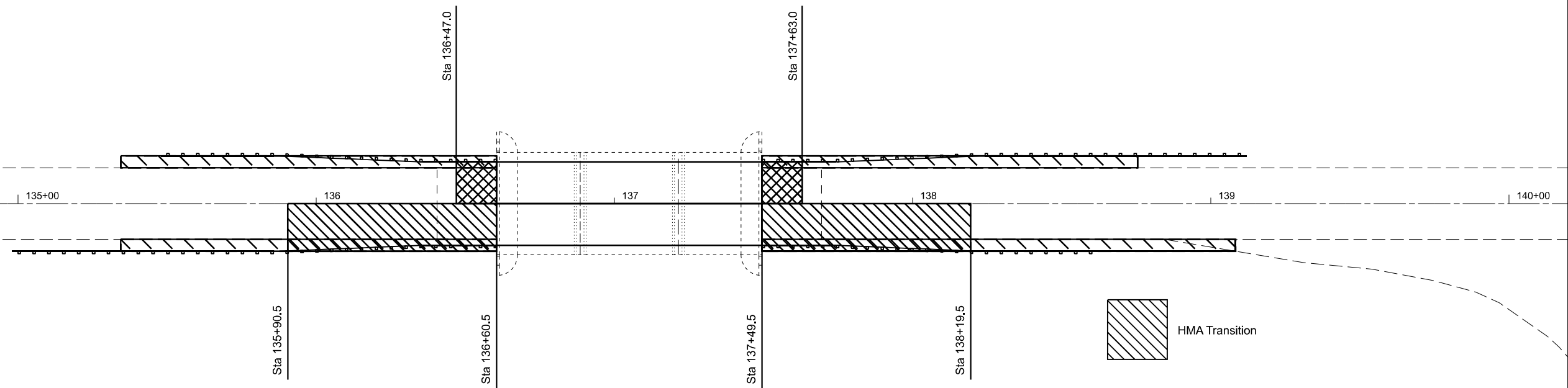

S.N. 028-0045
Stage III

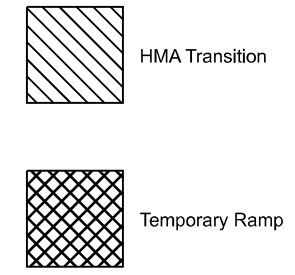

MODEL: Stage III.dwg (Sheet)
 FILE NAME: P:\Public\CD\Drawings\DOT Office\District 9\ORD Project\78997\CADData\CAD\Sheet\028997-2.dwg

USER NAME = david.a.wilson	DESIGNED -	REVISED -
DRAWN -	REVISOR -	REVISIONS -
PLOT SCALE = 0.16666633' / in.	CHECKED -	REVISIONS -
PLOT DATE = 12/4/2023	DATE -	REVISIONS -

STATE OF ILLINOIS
DEPARTMENT OF TRANSPORTATION

STAGE III DETAILS

SCALE: SHEET 16 OF 27 SHEETS STA. TO STA.

F.A.P. RTE.	SECTION	COUNTY	TOTAL SHEETS	SHEET NO.
869	D9 BRIDGE OVERLAY 2023-8	FRANKLIN	27	16
CONTRACT NO. 78997				
ILLINOIS FED. AID PROJECT				

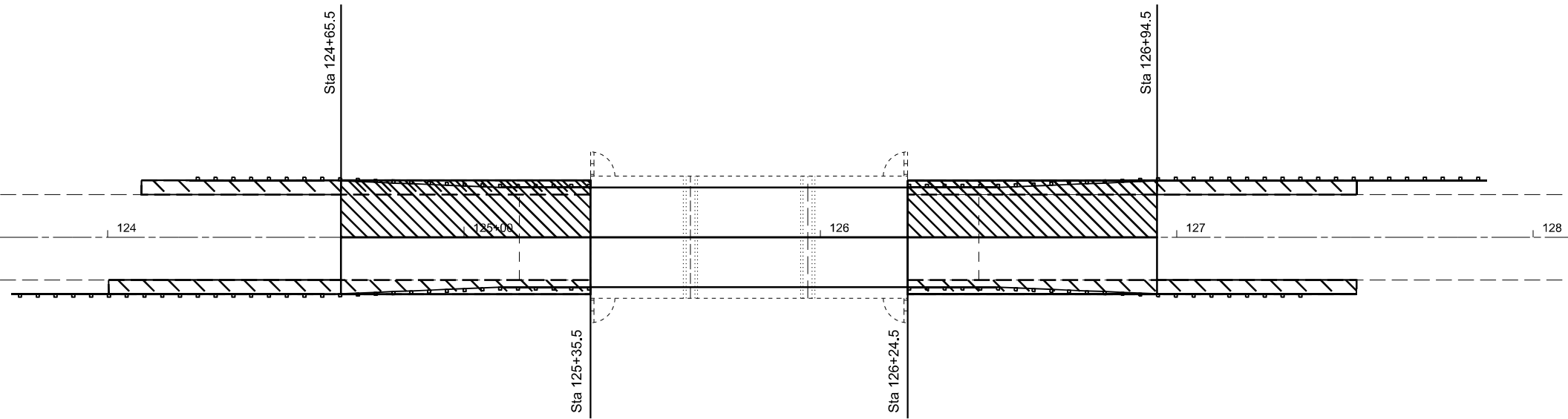

S.N. 028-0044
Stage IV

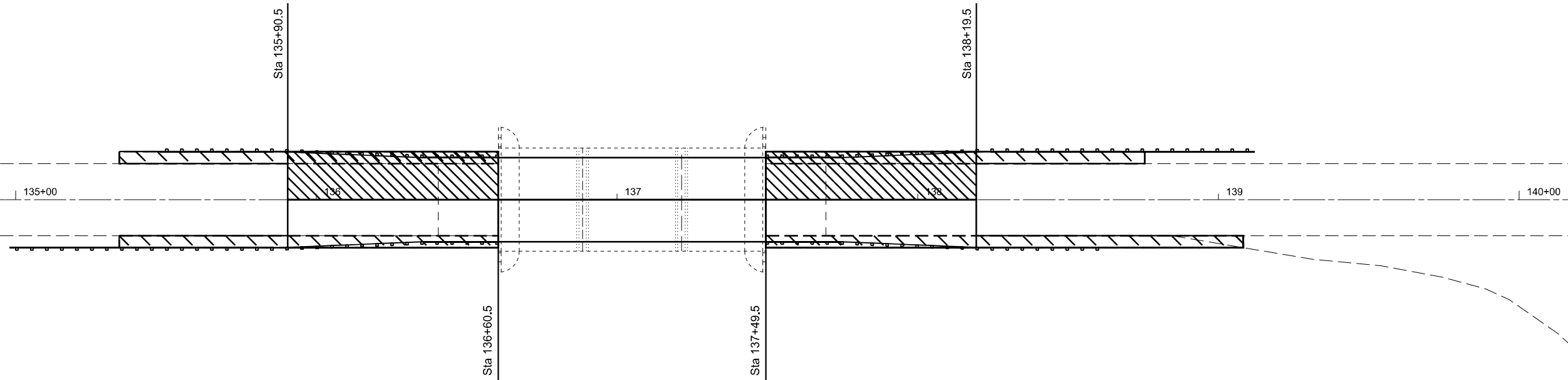

S.N. 028-0045
Stage IV



MODEL: Stage IV.dwg (Sheet)
 FILE NAME: P:\GIS\Projects\78997\CADD\Drawings\DOT\Office\District 9\ORD Project\78997\CADD\Drawings\DOT\78997-StageIV.dwg

USER NAME = david.a.wilson	DESIGNED -	REVISED -
DRAWN -	REVISED -	
PLOT SCALE = 0.16666633' / in.	CHECKED -	REVISED -
PLOT DATE = 12/4/2023	DATE -	REVISED -

STATE OF ILLINOIS
DEPARTMENT OF TRANSPORTATION

STAGE IV DETAILS

SCALE: SHEET 17 OF 27 SHEETS STA. TO STA.

F.A.P. RTE.	SECTION	COUNTY	TOTAL SHEETS	SHEET NO.
869	D9 BRIDGE OVERLAY 2023-8	FRANKLIN	27	17
CONTRACT NO. 78997			ILLINOIS FED. AID PROJECT	

Existing Structure: SN 028-0044 was built in 1957 as a 1 span superstructure.
 The joints were reconstructed in 2000.
 2004 Bridge Deck Polymer overlay.

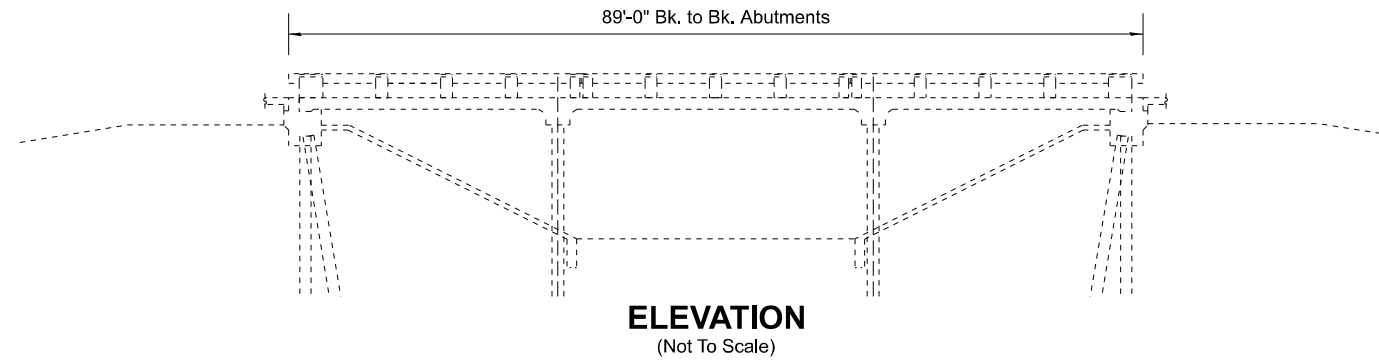
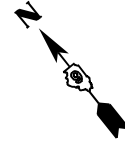

GENERAL NOTES

Reinforcement bars designated (E) shall be epoxy coated.

Plan dimensions and details relative to existing plans are subject to nominal construction variations. The Contractor shall verify existing dimensions and details affecting new construction and make necessary approved adjustments prior to construction or ordering of materials. Such variations shall not be cause for additional compensation for a change in scope of the work, however, the Contractor will be paid for the quantity actually furnished at the unit price bid for the work.

Existing reinforcement bars extending into removal area shall be cleaned, straightened and incorporated into the new construction. Any reinforcement bars that are damaged during concrete removal operations shall be repaired or replaced using an approved bar splicer or anchorage system. Cost included with "Concrete Removal".

Bridge Deck Scarification, reinforcement, and concrete wearing surface are to be done in two sequences during each phase of stage construction, all processes in sequence 1 must be fully completed and new concrete has reached a minimum of 650 psi modulus of rupture, before starting any sequence 2 procedures. See pages 19 and 20 of 27 for more details.

Concrete Sealer shall be placed on existing concrete on top/inside faces of curbs (full length). Cost included in "Bridge Deck Concrete Sealer".

Protective Coat shall be placed on the new concrete wearing surface & the new concrete on top/inside faces of curbs (full length). Cost included in "Protective Coat".

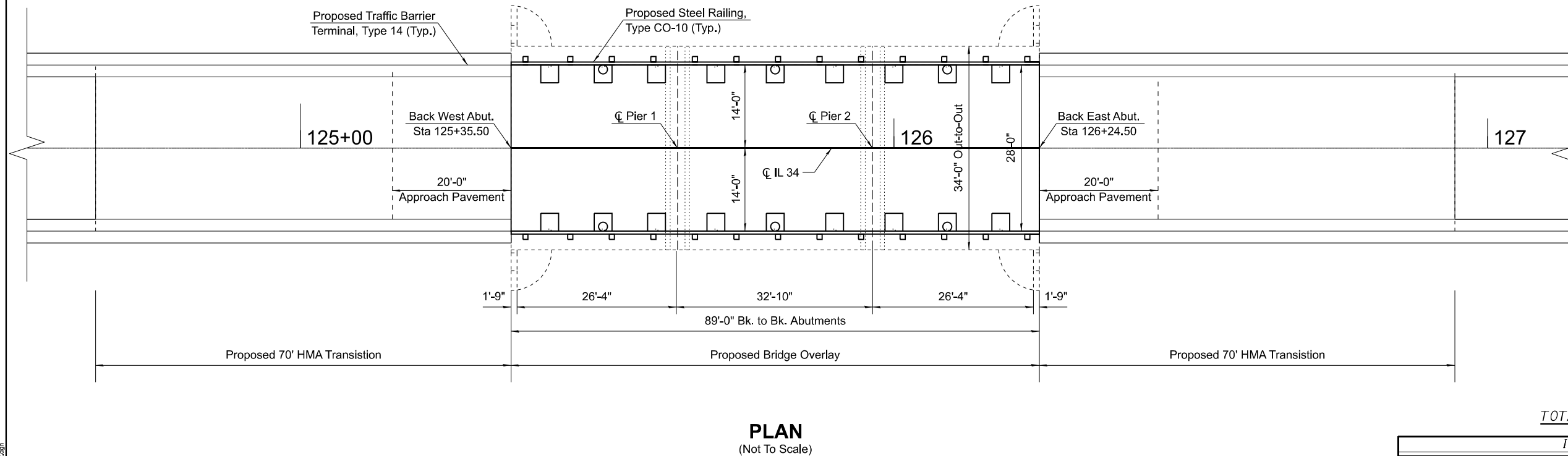

TOTAL BILL OF MATERIAL

ITEM	UNIT	TOTAL
Bridge Deck Grooving	Sq. Yd.	277
Reinforcement Bars, Epoxy Coated	Pound	3,640
Deck Slab Repair (Full Depth, Type I)	Sq. Yd.	2
Concrete Wearing Surface, 5"	Sq. Yd.	277
Bridge Deck Concrete Sealer	Sq. Ft.	520
Protective Coat	Sq. Yd.	287
Bridge Deck Scarification 1 1/2"	Sq. Yd.	277
Bar Splicers	Each	90
Floor Drains	Each	6
Steel Fence Railing, Type CO-10	Foot	178

SCOPE OF WORK

- 5" Concrete Wearing Surface (CWS) Overlay
- Full Depth Deck Slab Repairs to Remove & Replace Floor Drains
- Install Steel Fence Railing

DESIGN STRESSES

$f_c = 3500$ psi
 $f_y = 60,000$ psi (Reinforcement)

FLOOR DRAIN REPLACEMENT



Existing drains and adjacent concrete to be removed and replaced with a 6" circular drains and full deck patch. (See sheet 26 of 26 for more details)

FLOOR DRAIN ELIMINATION



Existing drains and adjacent concrete to be removed and replaced with full deck patch. (See sheet 26 of 26 for more details)

**BRIDGE DECK OVERLAY
 IL 34 OVER CREEK
 FAP 869 - D9 BRIDGE OVERLAY 2023-8
 FRANKLIN COUNTY
 STRUCTURE NO. 028-0044**

MODEL: 028-0044_CPE-1 (Sheet)
 FILE NAME: P:\Bids\2023\869\DOT\Documents\DOT Office\Direct\90869\Project\869\CAD\Drawings\028-0044-Str.dgn

USER NAME = zachary.jomax	DESIGNED -	REVISED -
	DRAWN -	REVISED -
PLOT SCALE = 0.16666633' / in.	CHECKED -	REVISED -
PLOT DATE = 1/17/2024	DATE -	REVISED -

**STATE OF ILLINOIS
 DEPARTMENT OF TRANSPORTATION**

**GENERAL PLAN AND ELEVATION
 SN 028-0044**

SCALE: SHEET 18 OF 27 SHEETS STA. TO STA.

F.A.P. RTE.	SECTION	COUNTY	TOTAL SHEETS	SHEET NO.
869	D9 BRIDGE OVERLAY 2023-8	FRANKLIN	27	18
CONTRACT NO. 78997				
ILLINOIS FED. AID PROJECT				

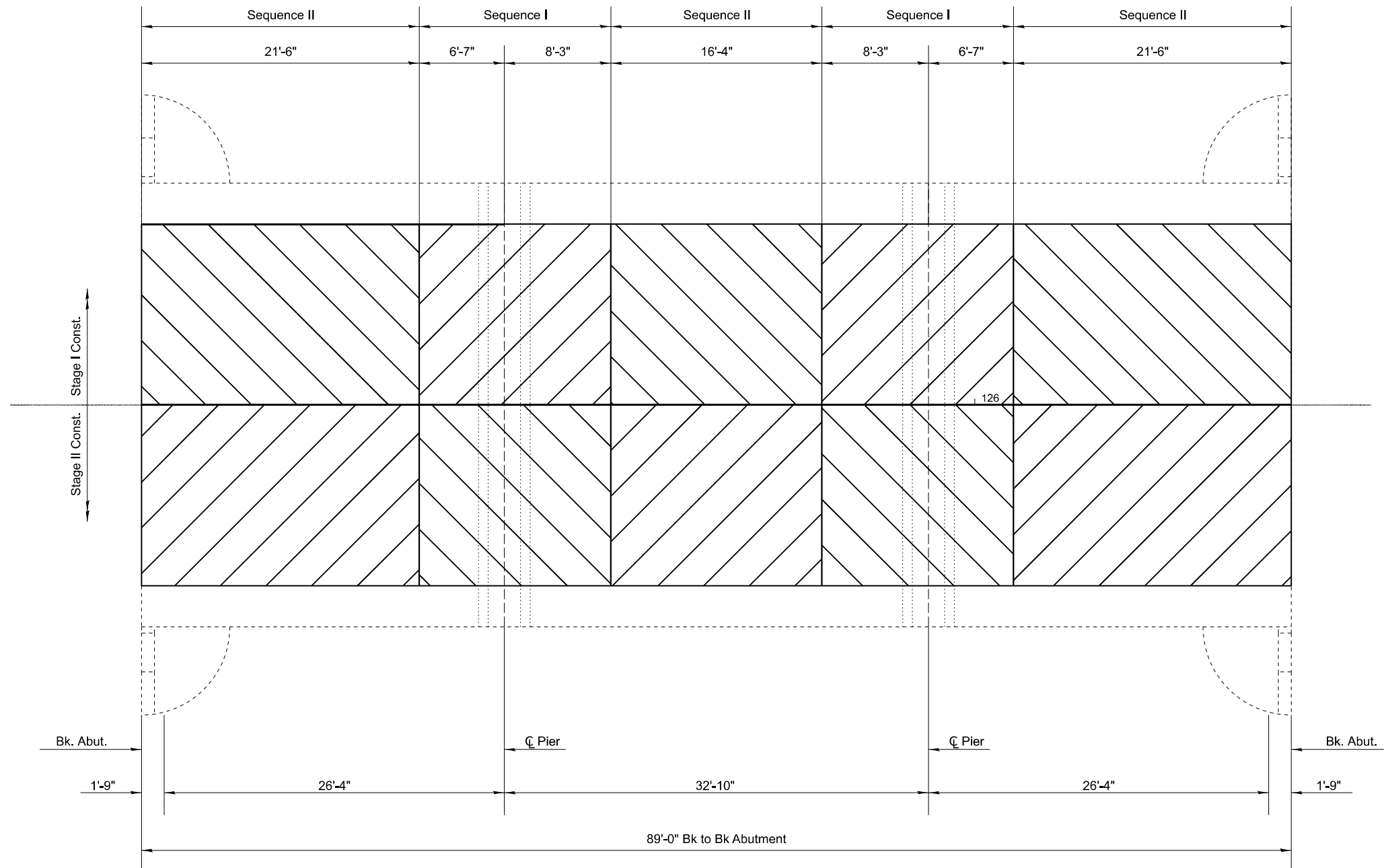

S.N. 028-0044
SUPERSTRUCTURE
BILL OF MATERIAL

Item	Unit	Quantity
Concrete Wearing Surface, 5"	Sq. Yd.	277
Bridge Deck Grooving	Sq. Yd.	277
Bridge Deck Concrete Sealer	Sq. Ft.	520
Protective Coat	Sq. Yd.	287

MODEL: 028-0044 CWS Plan - 1 (Sheet)
 FILE NAME: P:\Bids\2023\028-0044\Documents\DOT Office\Sheet\028-0044\CAD\Drawings\028-0044-S1.dwg

USER NAME = zachary.jomax	DESIGNED -	REVISED -
PLOT SCALE = 0.16666633' / in.	DRAWN -	REVISED -
PLOT DATE = 1/17/2024	CHECKED -	REVISED -
	DATE -	REVISED -

STATE OF ILLINOIS
DEPARTMENT OF TRANSPORTATION

CONCRETE WEARING SURFACE PLAN
SN 028-0044

SCALE: SHEET 19 OF 27 SHEETS STA. TO STA.

F.A.P. RTE.	SECTION	COUNTY	TOTAL SHEETS	SHEET NO.
869	D9 BRIDGE OVERLAY 2023-8	FRANKLIN	27	19
ILLINOIS FED. AID PROJECT			CONTRACT NO. 78997	

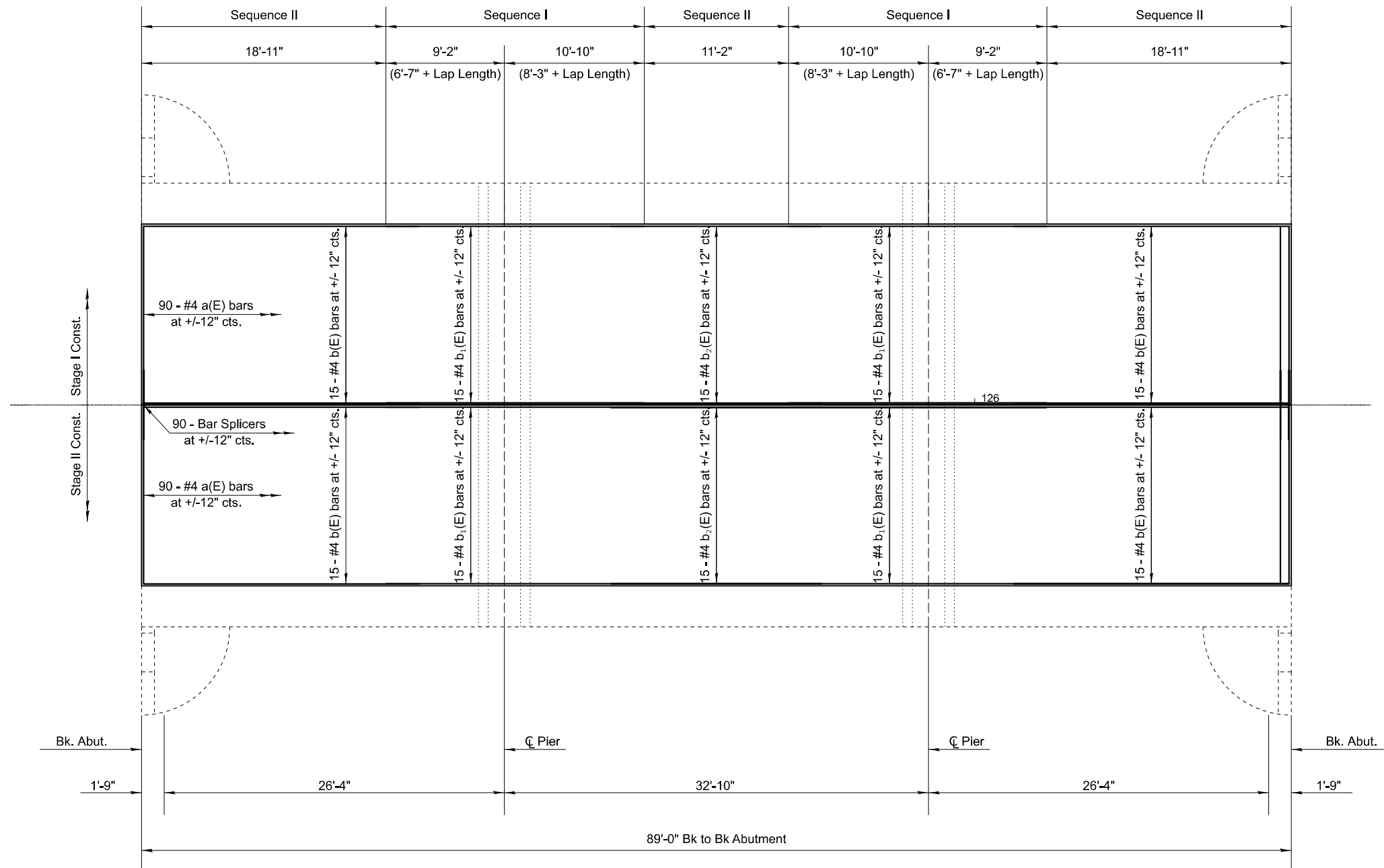

Provide Lap Length
#4 bars = 2'-7"

S.N. 028-0044
SUPERSTRUCTURE
BILL OF MATERIAL

Bar	No.	Size	Length	Shape
a(E)	180	#4	13'-9"	————
b(E)	60	#4	21'-4"	————
b1(E)	60	#4	20'-0"	————
b2(E)	30	#4	16'-4"	————
Reinforcement Bars, Epoxy Coated			Pound	3,640
Bar Splicers			Each	90
Bridge Deck Scarification 1½"			Sq. Yd.	277

MODEL: 028-0044 (Sheet) (Sheet)
 FILE NAME: P:\Info\Projects\2023\028-0044\Drawings\028-0044-Struct.rvt

USER NAME = zachary.jomax	DESIGNED -	REVISED -
PLOT SCALE = 0.16666633' / in.	DRAWN -	REVISED -
PLOT DATE = 1/17/2024	CHECKED -	REVISED -
	DATE -	REVISED -

STATE OF ILLINOIS
DEPARTMENT OF TRANSPORTATION

REINFORCEMENT DETAILS
SN 028-0044

SCALE: SHEET 20 OF 27 SHEETS STA. TO STA.

F.A.P. RTE.	SECTION	COUNTY	TOTAL SHEETS	SHEET NO.
869	D9 BRIDGE OVERLAY 2023-8	FRANKLIN	27	20
ILLINOIS FED. AID PROJECT			CONTRACT NO. 78997	

Existing Structure: SN 028-0045 was built in 1957 as a 1 span superstructure.
 The joints were reconstructed in 2000.
 2004 Bridge deck Polymer overlay.

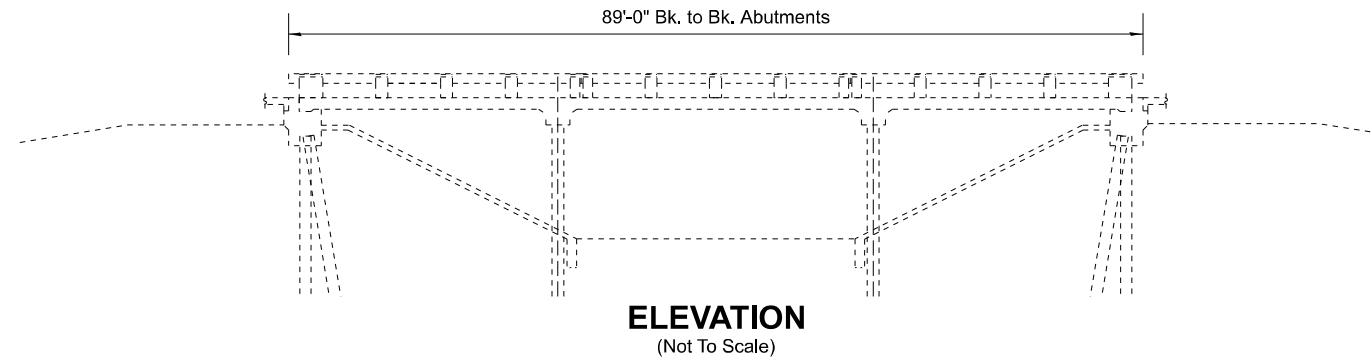
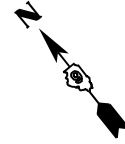

ELEVATION
(Not To Scale)

GENERAL NOTES

Reinforcement bars designated (E) shall be epoxy coated.

Plan dimensions and details relative to existing plans are subject to nominal construction variations. The Contractor shall verify existing dimensions and details affecting new construction and make necessary approved adjustments prior to construction or ordering of materials. Such variations shall not be cause for additional compensation for a change in scope of the work, however, the Contractor will be paid for the quantity actually furnished at the unit price bid for the work.

Existing reinforcement bars extending into removal area shall be cleaned, straightened and incorporated into the new construction. Any reinforcement bars that are damaged during concrete removal operations shall be repaired or replaced using an approved bar splicer or anchorage system. Cost included with "Concrete Removal".

Bridge Deck Scarification, reinforcement, and concrete wearing surface are to be done in two sequences during each phase of stage construction, all processes in sequence 1 must be fully completed and new concrete has reached a minimum of 650 psi modulus of rupture, before starting any sequence 2 procedures. See pages 22 and 23 of 27 for more details.

Concrete Sealer shall be placed on existing concrete on top/inside faces of curbs (full length). Cost included in "Bridge Deck Concrete Sealer".

Protective Coat shall be placed on the new concrete wearing surface & the new concrete on top/inside faces of curbs (full length). Cost included in "Protective Coat".

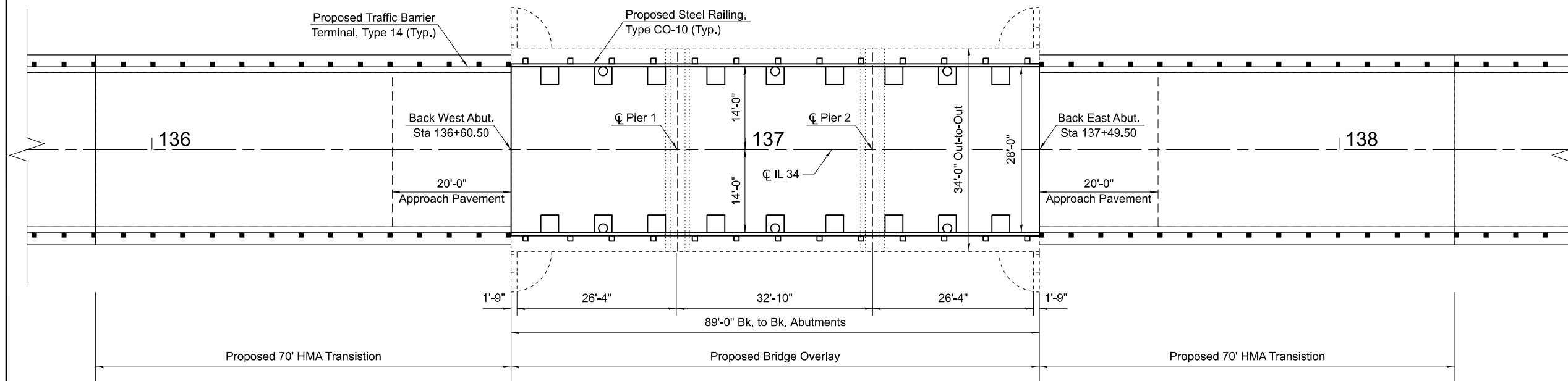

PLAN
(Not To Scale)

TOTAL BILL OF MATERIAL

ITEM	UNIT	TOTAL
Bridge Deck Grooving	Sq. Yd.	277
Reinforcement Bars, Epoxy Coated	Pound	3,640
Deck Slab Repair (Full Depth, Type I)	Sq. Yd.	2
Concrete Wearing Surface, 5"	Sq. Yd.	277
Bridge Deck Concrete Sealer	Sq. Ft.	520
Protective Coat	Sq. Yd.	287
Bridge Deck Scarification 1 1/2"	Sq. Yd.	277
Bar Splicers	Each	90
Floor Drains	Each	6
Steel Fence Railing, Type CO-10	Foot	178

SCOPE OF WORK
 5" Concrete Wearing Surface (CWS) Overlay
 Full Depth Deck Slab Repairs to Remove & Replace Floor Drains
 Install Steel Fence Railing

DESIGN STRESSES
 f_c = 3500 psi
 f_y = 60,000 psi (Reinforcement)

FLOOR DRAIN REPLACEMENT
 Existing drains and adjacent concrete to be removed and replaced with a 6" circular drains and full deck patch. (See sheet 26 of 26 for more details)

FLOOR DRAIN ELIMINATION
 Existing drains and adjacent concrete to be removed and replaced with full deck patch. (See sheet 26 of 26 for more details)

**BRIDGE DECK OVERLAY
 IL 34 OVER CREEK
 FAP 869 - D9 BRIDGE OVERLAY 2023-8
 FRANKLIN COUNTY
 STRUCTURE NO. 028-0045**

STATE OF ILLINOIS
 DEPARTMENT OF TRANSPORTATION

GENERAL PLAN AND ELEVATION
 SN 028-0045

F.A.P. RTE.	SECTION	COUNTY	TOTAL SHEETS	SHEET NO.
869	D9 BRIDGE OVERLAY 2023-8	FRANKLIN	27	21
CONTRACT NO. 78997				

SCALE: SHEET 21 OF 27 SHEETS STA. TO STA.

USER NAME	DESIGNED	REVISED
zachary.jomax	-	-
DRAWN	CHECKED	REVISION
-	-	-
PLOT SCALE	DATE	REVISION
= 0.16666633" / lin.	-	-
PLOT DATE	DATE	REVISION
= 1/17/2024	-	-

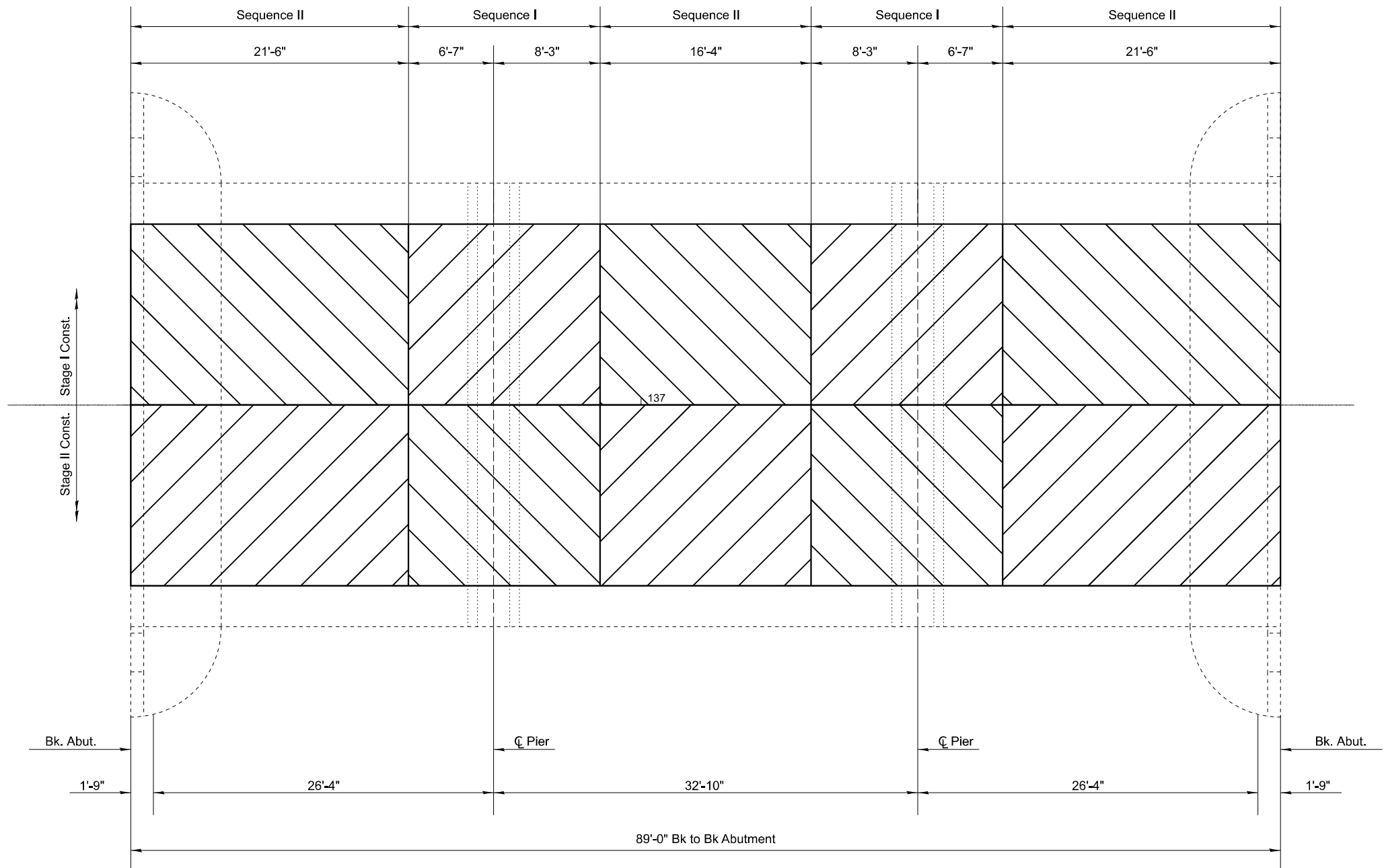

**S.N. 028-0045
SUPERSTRUCTURE
BILL OF MATERIAL**

Item	Unit	Quantity
Concrete Wearing Surface, 5"	Sq. Yd.	277
Bridge Deck Grooving	Sq. Yd.	277
Bridge Deck Concrete Sealer	Sq. Ft.	520
Protective Coat	Sq. Yd.	287

MODEL: 028-0045 CIVS Plan-1 (Sheet)
 FILE NAME: P:\Bids\2023\2023-08-01\DOT\Documents\DOT\Office\District 9\ORD Project\78997\CADD\Bids\CAD\Sheet\0280045-Str.dgn

USER NAME = zachary.jomax	DESIGNED -	REVISED -
PLOT SCALE = 0.16666633' / in.	DRAWN -	REVISED -
PLOT DATE = 1/17/2024	CHECKED -	REVISED -
	DATE -	REVISED -

**STATE OF ILLINOIS
DEPARTMENT OF TRANSPORTATION**

**CONCRETE WEARING SURFACE PLAN
SN 028-0045**

SCALE: SHEET 22 OF 27 SHEETS STA. TO STA.

F.A.P. RTE.	SECTION	COUNTY	TOTAL SHEETS	SHEET NO.
869	D9 BRIDGE OVERLAY 2023-8	FRANKLIN	27	22
			CONTRACT NO. 78997	
		ILLINOIS FED. AID PROJECT		

MODEL: 028-0045 Etabar (Sheet)
 FILE NAME: P:\Info\pcc\work\11\1100\Documents\DOT Office\District 9\ORD Project\028-0045\CAD\Rebar\028-0045-Str.rvt

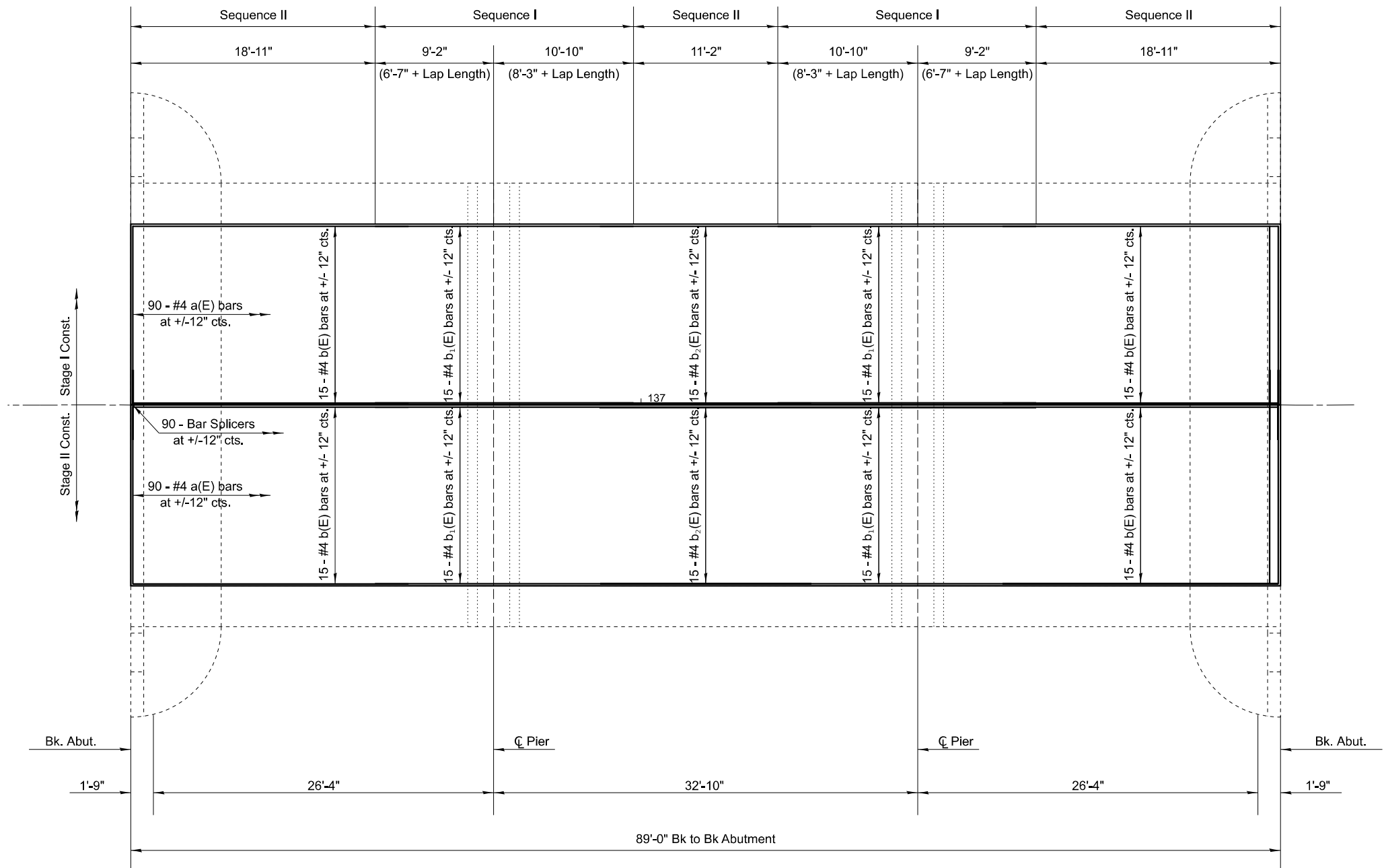

Provide Lap Length
 #4 bars = 2'-7"

S.N. 028-0045
SUPERSTRUCTURE
BILL OF MATERIAL

Bar	No.	Size	Length	Shape
a(E)	180	#4	13'-9"	————
b(E)	60	#4	21'-4"	————
b1(E)	60	#4	20'-0"	————
b2(E)	30	#4	16'-4"	————
Reinforcement Bars, Epoxy Coated			Pound	3,640
Bar Splicers			Each	90
Bridge Deck Scarification 1½"			Sq. Yd.	277

USER NAME = zachary.jomax	DESIGNED -	REVISED -
DRAWN -	REVISED -	
PLOT SCALE = 0.16666633' / in.	CHECKED -	REVISED -
PLOT DATE = 1/17/2024	DATE -	REVISED -

STATE OF ILLINOIS
DEPARTMENT OF TRANSPORTATION

REINFORCEMENT DETAILS
SN 028-0045

SCALE: SHEET 23 OF 27 SHEETS STA. TO STA.

F.A.P. RTE.	SECTION	COUNTY	TOTAL SHEETS	SHEET NO.
869	D9 BRIDGE OVERLAY 2023-8	FRANKLIN	27	23
ILLINOIS FED. AID PROJECT			CONTRACT NO. 78997	

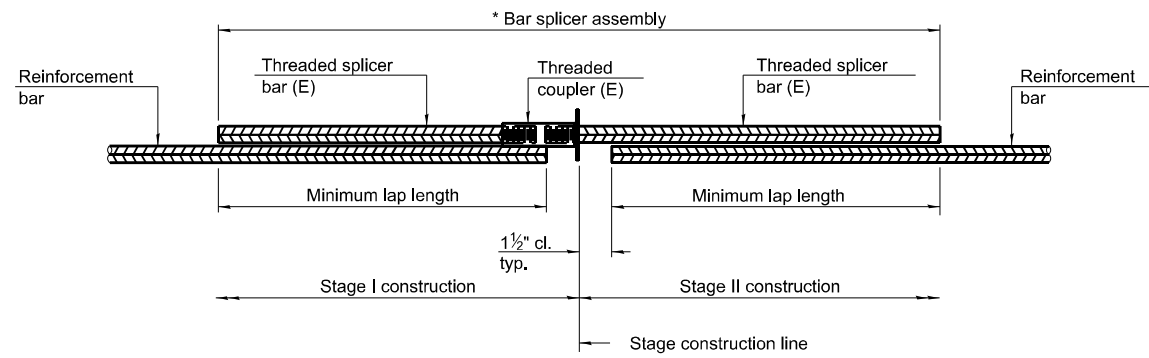

STANDARD BAR SPLICER ASSEMBLY PLAN

Only bar splicer assemblies as presented on the approved QPL list may be used.

Threaded splicer bar length = min. lap length + 1 1/2" + thread length

* Epoxy not required on Bar Splicer Assembly components used in conjunction with black bars.

SN 028-0045

Location	Bar size	No. assemblies required	Minimum lap length
Wearing Surface	#4	90	2'-7"

SN 028-0044

Location	Bar size	No. assemblies required	Minimum lap length
Wearing Surface	#4	90	2'-7"

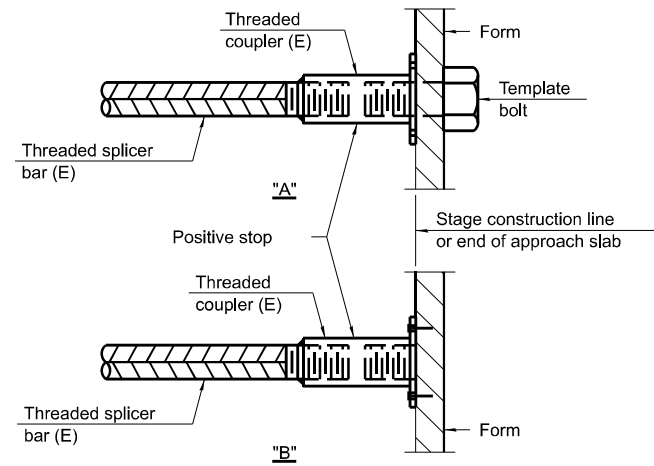

INSTALLATION AND SETTING METHODS

"A" : Set bar splicer assembly by means of a template bolt.

"B" : Set bar splicer assembly by nailing to wood forms or cementing to steel forms.

(E) : Indicates epoxy coating.

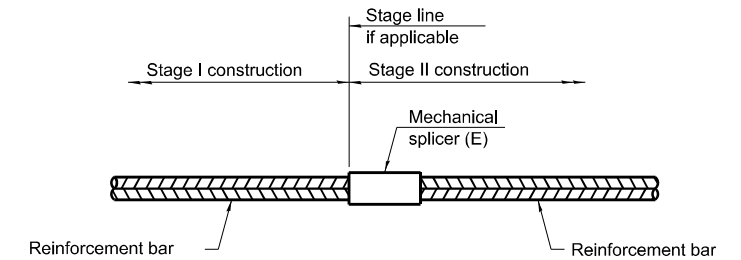

STANDARD MECHANICAL SPLICER

Location	Bar size	No. assemblies required

Notes:
 Splicer bars shall be deformed with threaded ends and have a minimum 60 ksi yield strength.
 All reinforcement shall be lapped and tied to the splicer bars.
 Bar splicer assemblies shall be epoxy coated according to the requirements for reinforcement bars. See Section 508 of the Standard Specifications.
 See approved list of bar splicer assemblies and mechanical splicers for alternatives.

BSD-1

2-1-2023

BAR SPLICER ASSEMBLY AND MECHANICAL SPLICER DETAILS
STRUCTURE NO. 028-0044
STRUCTURE NO. 028-0045

STATE OF ILLINOIS
DEPARTMENT OF TRANSPORTATION

BAR SPLICER ASSEMBLY DETAILS
SN 028-0044 & SN 028-0045

SCALE: SHEET 24 OF 27 SHEETS STA. TO STA.

F.A.P. RTE.	SECTION	COUNTY	TOTAL SHEETS	SHEET NO.
869	D9 BRIDGE OVERLAY 2023-8	FRANKLIN	27	24
ILLINOIS FED. AID PROJECT			CONTRACT NO. 78997	

MODEL: Bar Splicers - [Sheet]
 FILE NAME: P:\Bids\2023\11\11\DOT\Documents\DOT Office\District 9\ORD Project\78997\CADD\Drawings\CAD\Drawings\028997-Str.dgn

4 - 3/4" Ø x 7 1/2" Round head bolts with heavy hex locknuts and flat washers. Field drill 1/8" Ø holes in HSS tubing using holes in post as template.

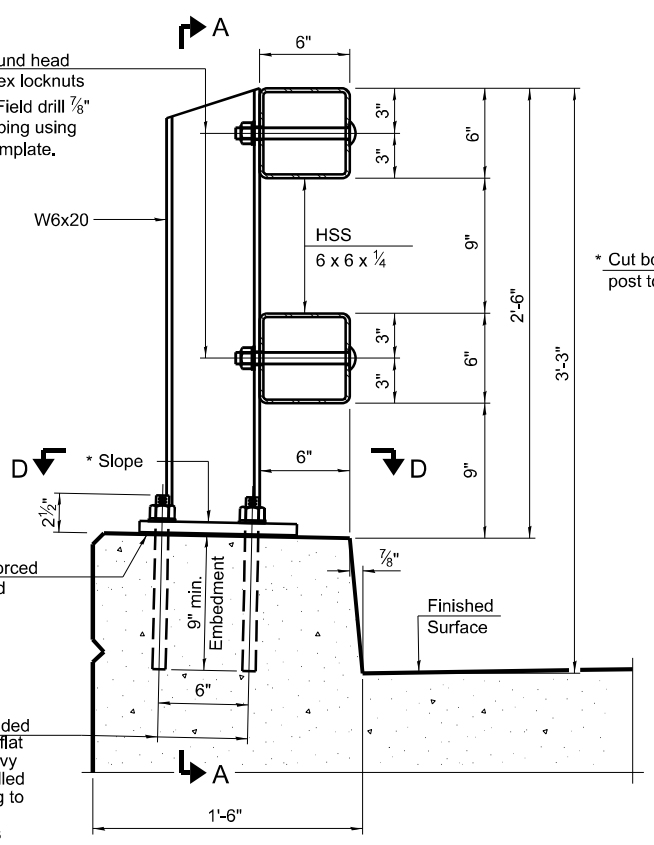

SECTION AT RAIL POST
(New construction)

4 - 3/4" Ø x 7 1/2" Round head bolts with heavy hex locknuts and flat washers. Field drill 1/8" Ø holes in HSS tubing using holes in post as template.

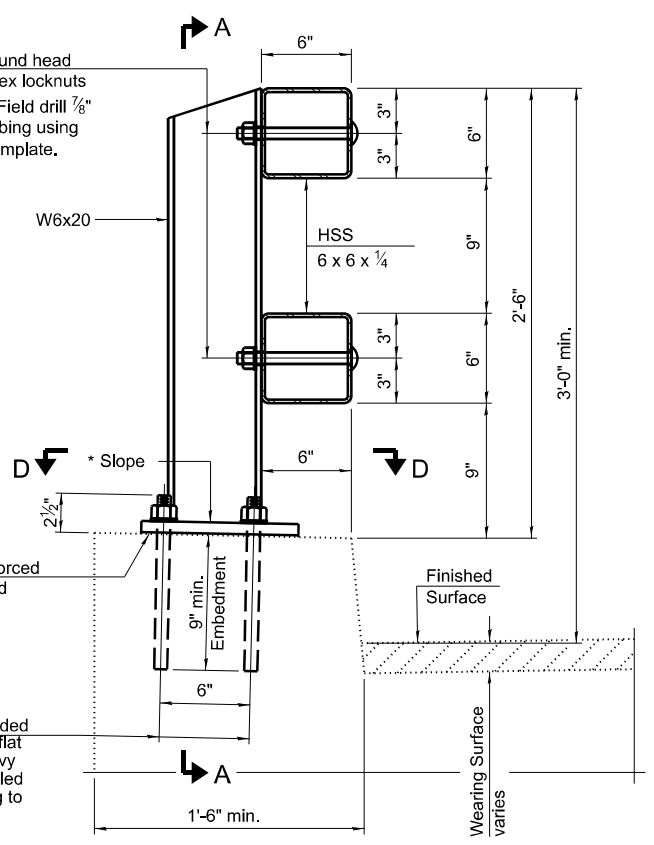
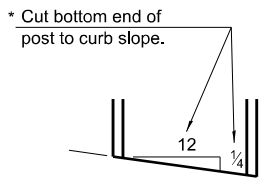

SECTION AT RAIL POST
(Retrofit construction)

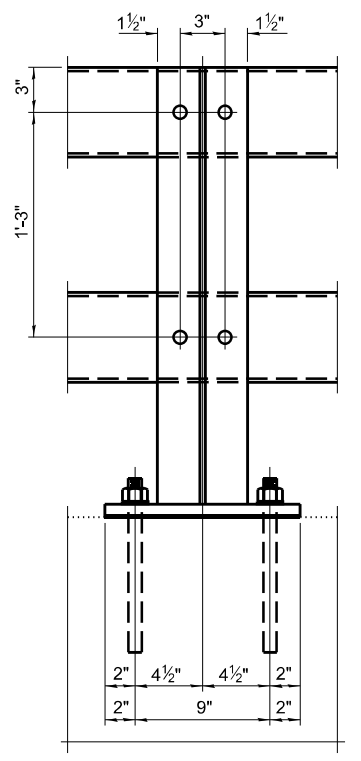

SECTION A-A

Notes:
 All HSS tubing shall be ASTM A500 grade C.
 All plates shall be AASHTO M270 grade 50.
 All heavy hex nuts shall be according to ASTM A563 grade DH.
 All fully threaded anchor rods shall be ASTM F1554 grade 105.
 The post base plate shall be fastened to the curb snug tight and given an additional 1/8" turn.
 Posts shall not be located closer than 2'-6" to a bridge expansion joint.
 Provide one 1/8" and two 1/16" steel shims for 25% of the posts. Shims shall be similar to base plates in size and holes.
 All steel rail elements shall be galvanized according to Article 509.05 of the Standard Specifications.
 All HSS tubing shall be CVN tested according to Article 1006.34(b) of the Standard Specifications.
 Rail splice inserts may be built out of 2 - 3/8" bent plates in lieu of the 4 plate rail splice inserts shown, provided the outside dimensions are matched.
 All round head bolts shall be ASTM A449.
 The centerline of rail splices shall be placed between 1'-8" to 2'-6" from the centerline of the posts.
 The free end of the splice tube shall be oriented away from the closest post.

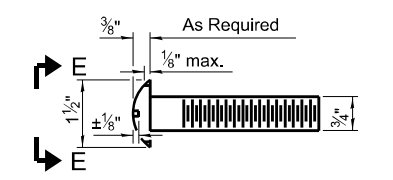

ROUND HEAD BOLT DETAIL

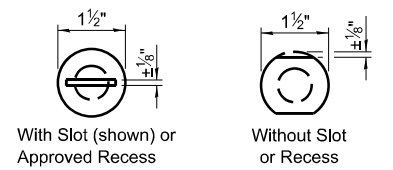

VIEW E-E

4-7/8" Ø fully threaded anchor rods with flat washers and heavy hex lock nuts, drilled and set according to Art. 509.06 of the Std. Specifications

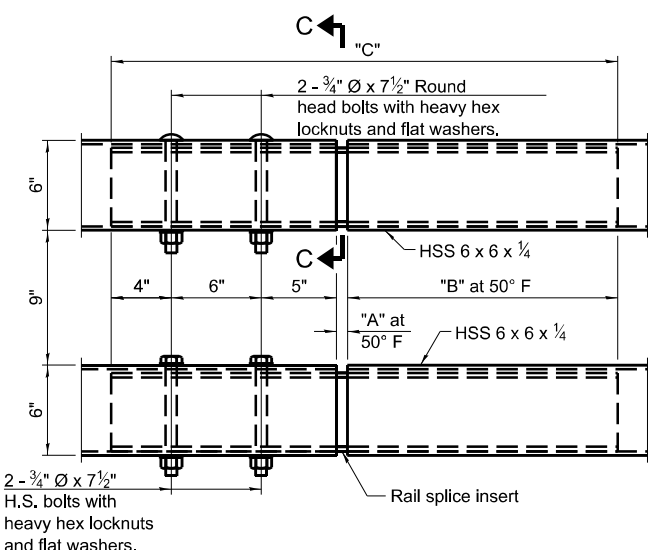

TOP AND BOTTOM RAIL SPLICE ELEVATION

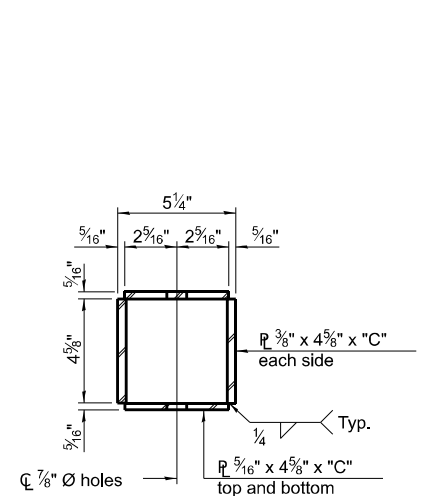

SECTION C-C

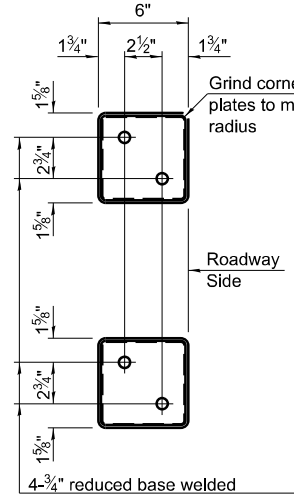

VIEW B-B

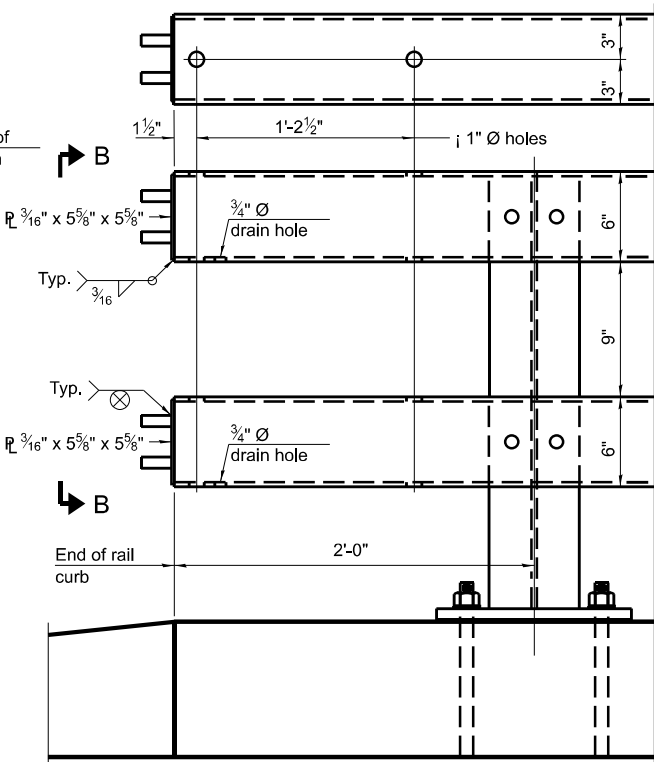

END OF RAIL DETAILS

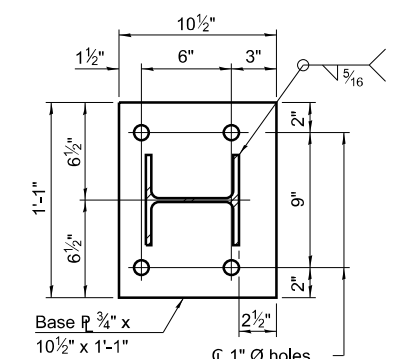

SECTION D-D

BILL OF MATERIAL

SN 028-0044

Item	Unit	Quantity
Steel Railing, Type CO-10	Foot	178

BILL OF MATERIAL

SN 028-0045

Item	Unit	Quantity
Steel Railing, Type CO-10	Foot	178

RAILING CRITERIA

MASH 2016 Test Level	4
Railing Weight (plf)	75
Min f _c (psi)	4,500
Post Spacing Range	6'-8" - 10'-0"

SPLICE DIMENSIONS

Location	T	A	B	C
All locs. not over exp. jts.	0	1/2"	1'-6"	2'-9 1/2"
Over Strip Seal Jt.	≤4"	2 1/2"	1'-8"	3'-1 1/2"
Over Finger or Modular Jt.	≤9 1/2"	5 1/2"	1'-10 3/4"	3'-7 1/4"
Over Finger or Modular Jt.	≤15"	8 1/4"	2'-1 1/2"	4'-0 3/4"

T = ; total movement along centerline of roadway at expansion joint.

R-42

10-12-2021

STATE OF ILLINOIS
DEPARTMENT OF TRANSPORTATION

STEEL RAILING DETAILS
STRUCTURE NO. 028-0044 & SN 028-0045

SCALE: SHEET 25 OF 27 SHEETS STA. TO STA.

F.A.P. RTE.	SECTION	COUNTY	TOTAL SHEETS	SHEET NO.
889	D9 BRIDGE OVERLAY 2023-8	FRANKLIN	27	25
CONTRACT NO. 78997				
ILLINOIS FED. AID PROJECT				

MODEL: Steel Railing-1 (Rev. 4)
 FILE NAME: P:\Info\Projects\DOT\Office\Direct\BUREAU\Project\78997\CAD\Drawings\0280045.dwg

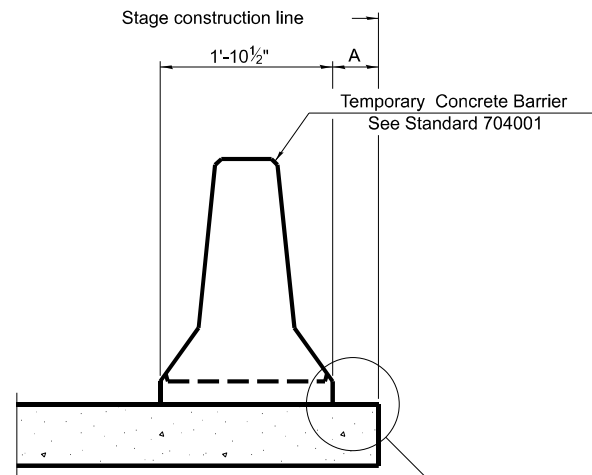

When "A" is 3'-1" or less, the temporary concrete barrier shall be restrained to the new slab according to Detail I, II or III. No restraint is required when "A" is greater than 3'-1".

NEW SLAB OR NEW DECK BEAM

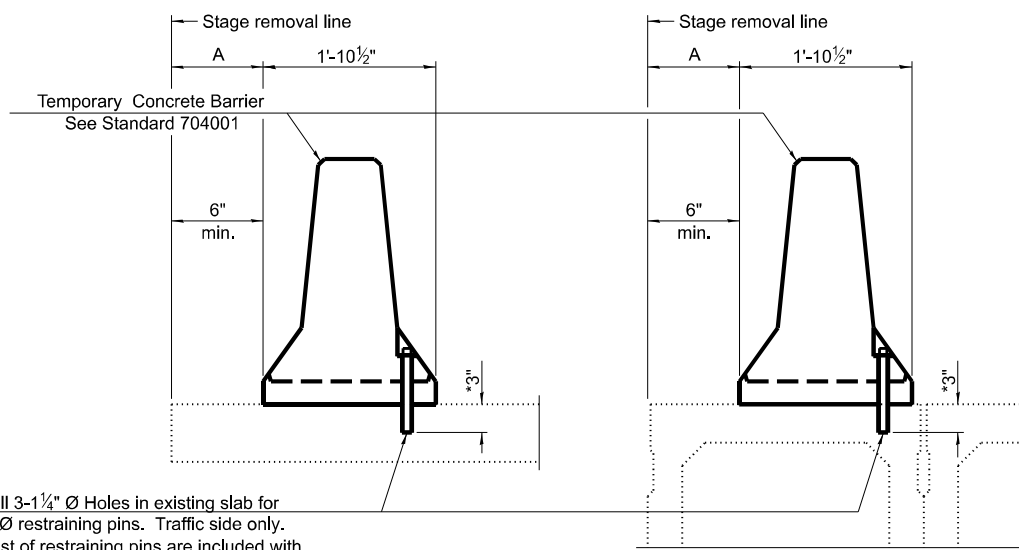

Drill 3-1/4" Ø Holes in existing slab for 1" Ø restraining pins. Traffic side only. Cost of restraining pins are included with Temporary Concrete Barrier. No restraint is required when "A" is greater than 3'-1".

EXISTING SLAB

EXISTING DECK BEAM

SECTIONS THRU SLAB OR DECK BEAM

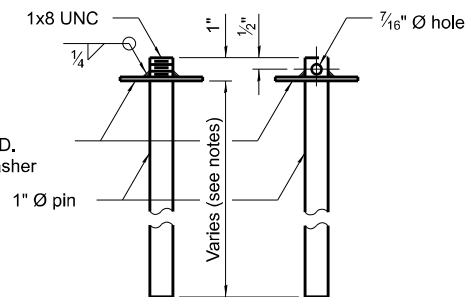

US Std. 1 1/8" I.D. x 2 1/2" O.D. x approx. 8 gauge thick washer

RESTRAINING PIN

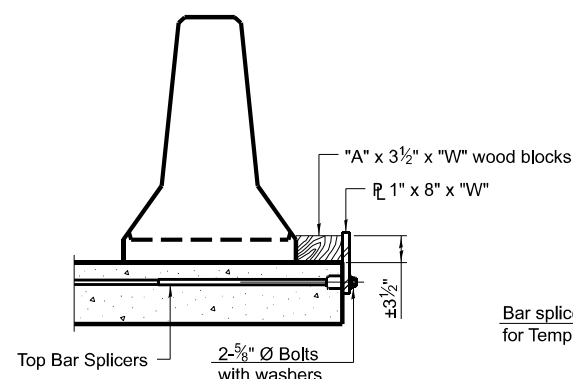

DETAIL I

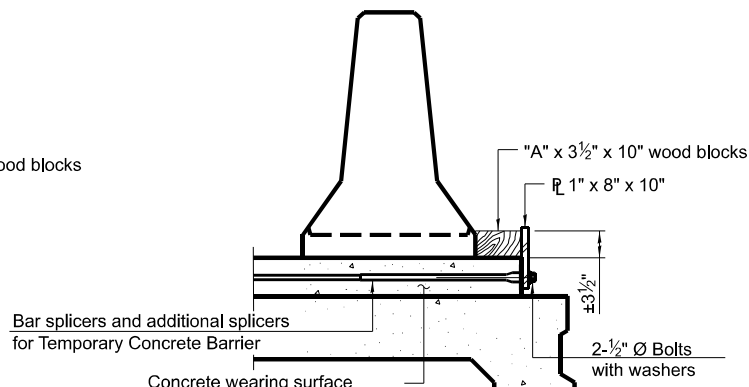

DETAIL II

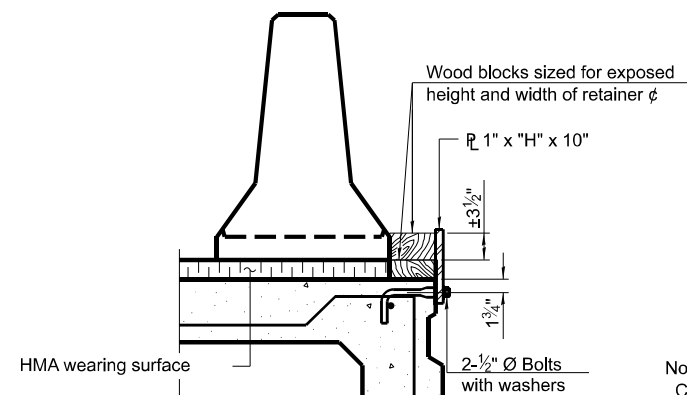

DETAIL III

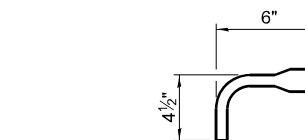

BAR SPLICER FOR #4 BAR - DETAIL III

Notes:

- Cost of retainer assembly is included with Temporary Concrete Barrier.
- A retainer assembly shall be located at the approximate C of each temporary concrete barrier.
- The retainer plate shall not be removed until the concrete on the adjacent stage is ready to be poured. For Detail III applications the retainer plate shall not be removed until just prior to placing the adjacent beam.
- When the 'A' dimension is less than 1 1/2", the wood block shall be omitted and the barrier shall be placed in direct contact with the steel retainer plate.
- For deck beam applications the minimum required 'A' distance is 6" to accommodate the shear key clamping device.

Detail I - Installation for a new bridge deck or bridge slab.

Detail II - Installation for a new deck beam with an initial concrete wearing surface. Additional bar splicers shall be provided at 6'-0" centers and paired with the bar splicers of the concrete wearing surface reinforcement to accommodate the installation of the retainer assemblies. The cost of the additional bar splicers is included with the concrete wearing surface.

Detail III - Installation for a new deck beam with no initial wearing surface or with an initial hot-mix asphalt (HMA) wearing surface present. The deck beam directly beneath the temporary concrete barrier shall be fabricated with bar splicer inserts in the side of the beam, as detailed, to accommodate the installation of the retainer assemblies. A pair of bar splicers, 6" apart, shall be placed at 6'-0" centers along the length of the beam. The cost of the bar splicers is included with the deck beam.

RAILING CRITERIA

NCHRP 350 Test Level	3
Railing Weight (plf)	440

R-27

10-12-2021

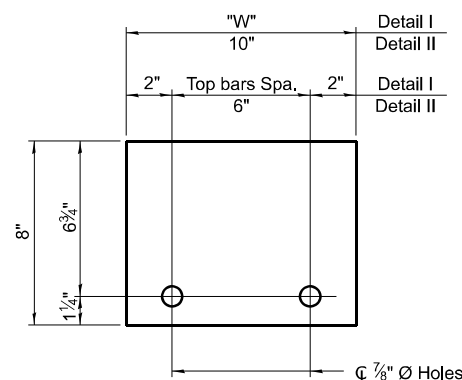

STEEL RETAINER R 1" x 8" x "W"

(Detail I and II)

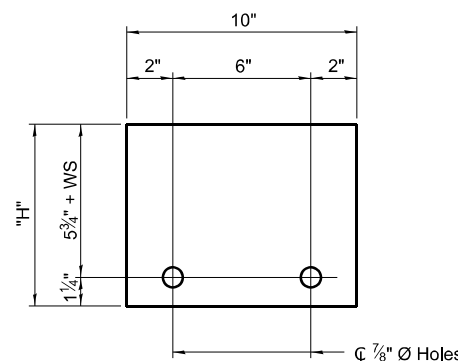

STEEL RETAINER R 1" x "H" x 10"

(Detail III)

**TEMPORARY CONCRETE BARRIER
STRUCTURE NO. 028-0044
STRUCTURE NO. 028-0045**

**STATE OF ILLINOIS
DEPARTMENT OF TRANSPORTATION**

**TEMPORARY CONCRETE BARRIER DETAILS
SN 028-0044 & SN 028-0045**

SCALE: SHEET 26 OF 27 SHEETS STA. TO STA.

F.A.P. RTE.	SECTION	COUNTY	TOTAL SHEETS	SHEET NO.
889	D9 BRIDGE OVERLAY 2023-8	FRANKLIN	27	26
ILLINOIS FED. AID PROJECT			CONTRACT NO. 78997	

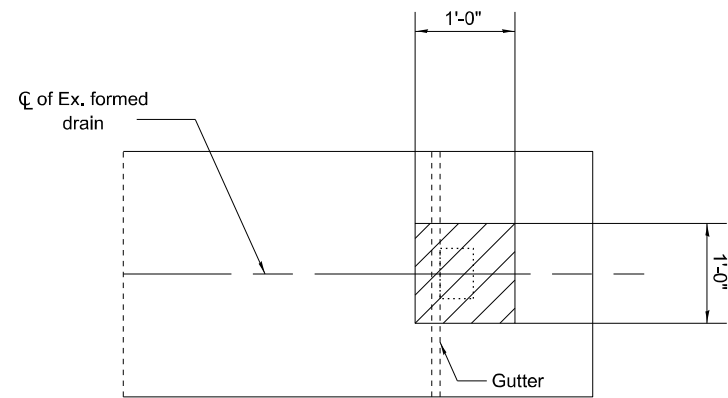

PLAN-REMOVAL OF EXISTING FORMED OPENING AND ADJACENT CONCRETE

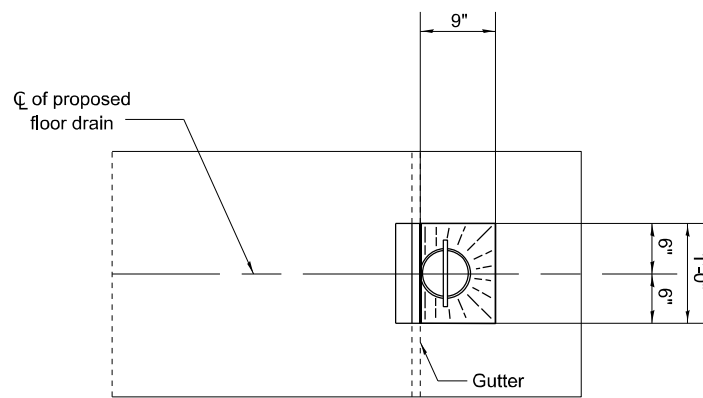

PLAN-PROPOSED FLOOR DRAIN & FULL DEPTH PATCH

(See sheet 17 and 20 of 26 for locations to replace formed drain with floor drains & full depth patch)

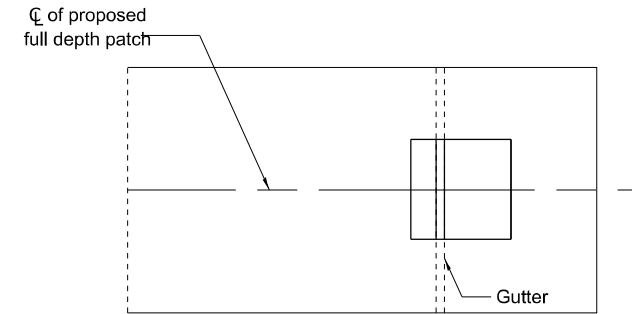

PLAN-PROPOSED FULL DEPTH PATCH @ ELIMINATED FLOOR DRAINS

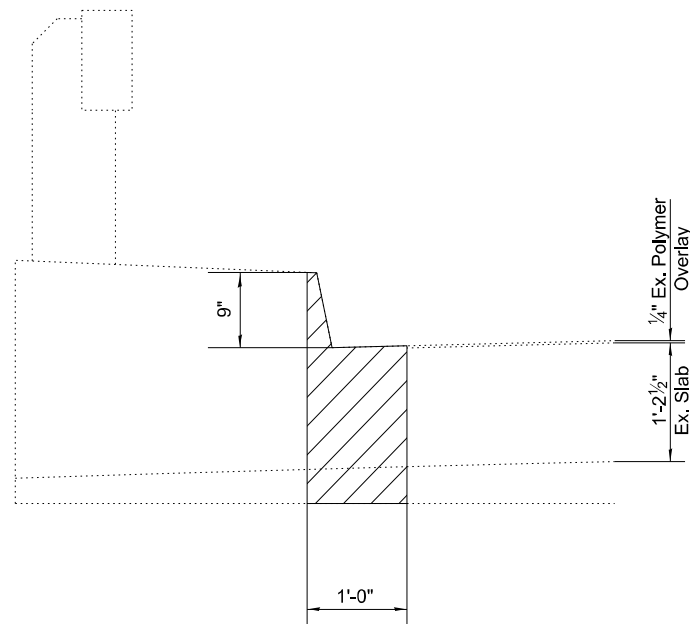

SECTION-REMOVAL OF EXISTING FORMED OPENING AND ADJACENT CONCRETE

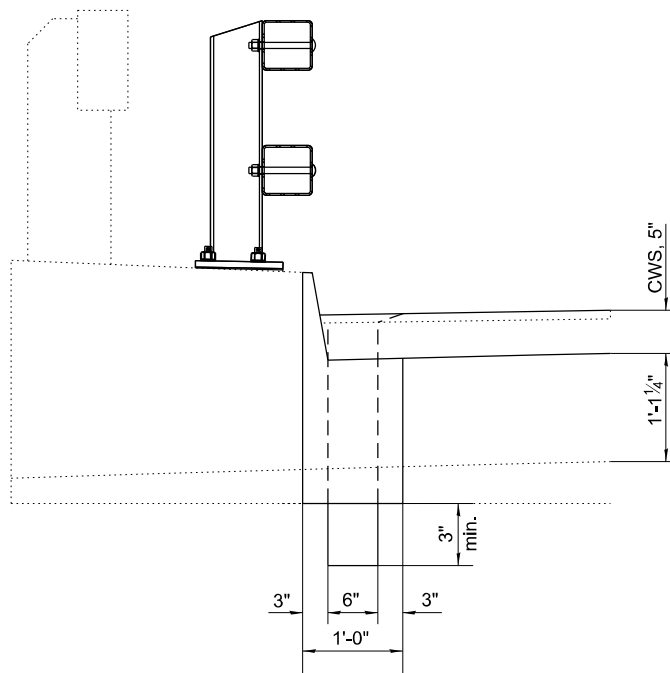

SECTION-PROPOSED FLOOR DRAIN & FULL DEPTH PATCH

(Place top of drain 1" below top of proposed CWS)

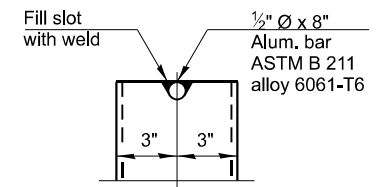

ALUMINUM TUBE

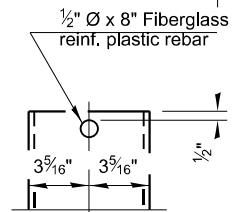

FIBERGLASS PIPE

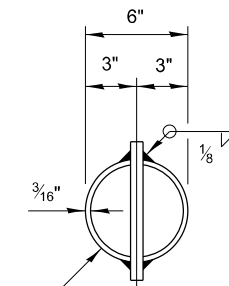

6" O.D. Aluminum tube alloy 6061-T6 or 6" ϕ fiberglass pipe

TOP PLAN

(Showing aluminum tube)

BILL OF MATERIAL SN 028-044

ITEM	UNIT	TOTAL
Deck Slab Repair (Full Depth, Type I)	Sq. Yd.	2
Floor Drains	Each	6

BILL OF MATERIAL SN 028-045

ITEM	UNIT	TOTAL
Deck Slab Repair (Full Depth, Type I)	Sq. Yd.	2
Floor Drains	Each	6

MODEL: Drain Details - 1 (Sheet) FILE NAME: P:\Bids\2023\11\17\2024\11\17\2024\DOT Office\Direct\9\028\Project\78997\CADD\Drawings\DOT\Drawings\028997-28.dgn

USER NAME = zachary.jomax	DESIGNED -	REVISED -
PLOT SCALE = 0.16666633 / in.	DRAWN -	REVISED -
PLOT DATE = 1/17/2024	CHECKED -	REVISED -
	DATE -	REVISED -

STATE OF ILLINOIS
DEPARTMENT OF TRANSPORTATION

DRAIN DETAILS SN 028-0044 & SN 028-0045			
SCALE:	SHEET 27	OF 27	SHEETS STA. TO STA.

F.A.P. RTE.	SECTION	COUNTY	TOTAL SHEETS	SHEET NO.
869	D9 BRIDGE OVERLAY 2023-8	FRANKLIN	27	27
				CONTRACT NO. 78997
ILLINOIS FED. AID PROJECT				