

STATE OF ILLINOIS  
DEPARTMENT OF TRANSPORTATION

# PROPOSED HIGHWAY PLANS

FAP ROUTE 574 (IL 41) & 22 (IL 78)  
PROJECT STP-R94Q(507)  
SECTION (14,15,16)RS-5;14RS-6  
PAVEMENT PRESERVATION  
KNOX & STARK COUNTY  
C-94-021-24

F.A.P. RITE	SECTION	COUNTY	TOTAL SHEETS	SHEET NO.
574/27	(14,15,16)RS-5;14RS-6	KNOX/STARK	22	1
		ILLINOIS	CONTRACT NO. 68J00	

INDEX OF SHEETS

- 1 COVER SHEET
- 2 COMMITMENTS AND JOB SPECIFIC NOTES
- 3-4 SUMMARY OF QUANTITIES
- 5-8 SCHEDULE OF QUANTITIES
- 9-10 LINE DIAGRAMS
- 11-14 TYPICAL SECTIONS
- 15-20 PAVEMENT MARKING DETAILS
- 21-22 DISTRICT CADD STANDARDS

HIGHWAY STANDARDS

- 701301-04
- 701306-04
- 701311-03
- 701901-09
- 780001-05

DISTRICT STANDARDS

780001

IL 41	IL 78
ADT: 5750	ADT: 2300
SU: 5.56%	SU: 3.91%
MU: 4.82%	MU: 5.22%

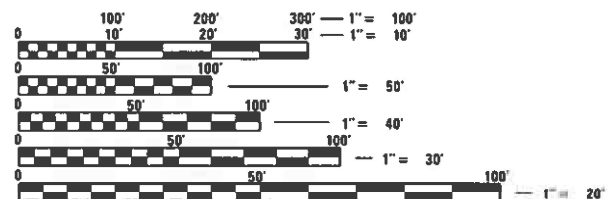

FULL SIZE PLANS HAVE BEEN PREPARED USING STANDARD ENGINEERING SCALES. REDUCED SIZED PLANS WILL NOT CONFORM TO STANDARD SCALES. IN MAKING MEASUREMENTS ON REDUCED PLANS, THE ABOVE SCALES MAY BE USED.

J.U.L.I.E.  
JOINT UTILITY LOCATION INFORMATION FOR EXCAVATORS  
1-800-892-0123  
OR 811

PROJECT ENGINEER: NICOLE FAYANT (309) 671-3454  
PROJECT MANAGER: MICHAEL JACOBS (309) 671-3460

CONTRACT NO. 68J00  
CATALOG NO. 036468-00D

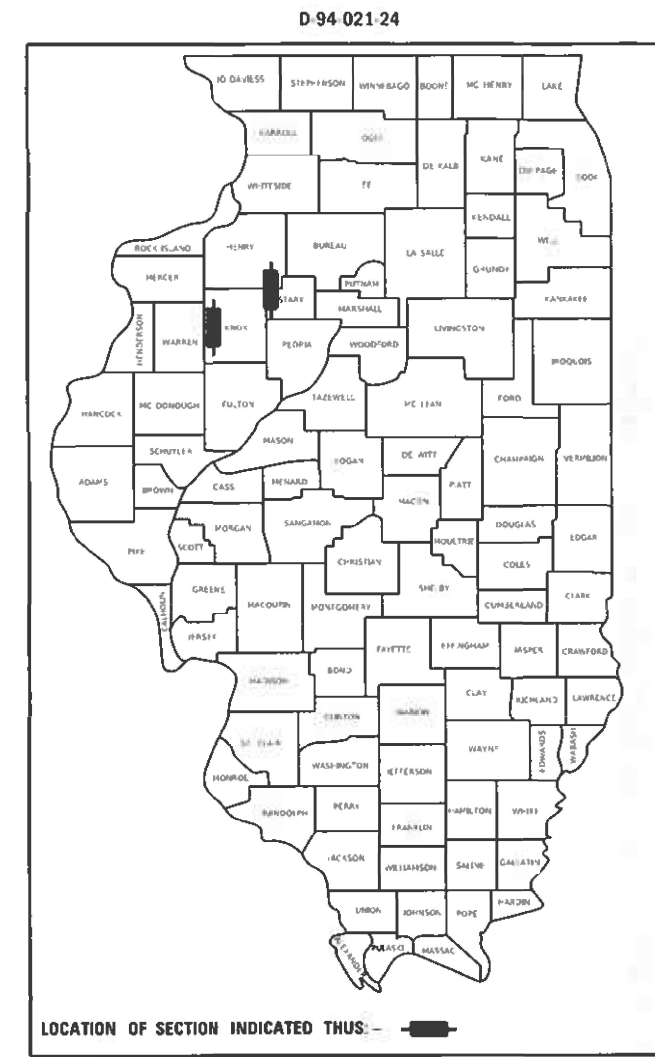

PROJECT DESCRIPTION:  
CAPE SEAL ON IL 41 FROM SOUTH OF MONMOUTH BLVD IN GALESBURG TO SOUTH OF W HUNTER ST. IN ABINGDON AND ON IL 78 FROM HENRY COUNTY LINE TO 17(W) IN STARK COUNTY

STATE OF ILLINOIS  
DEPARTMENT OF TRANSPORTATION

SUBMITTED December 11, 2023  
*Rosa O. Jarama*  
REGIONAL ENGINEER

February 2, 2024  
*Scott A. Etk*  
ENGINEER OF DESIGN AND ENVIRONMENT

February 2, 2024  
*Stephen M. Smith*  
DIRECTOR OF HIGHWAYS PROJECT IMPLEMENTATION

PRINTED BY THE AUTHORITY  
OF THE STATE OF ILLINOIS

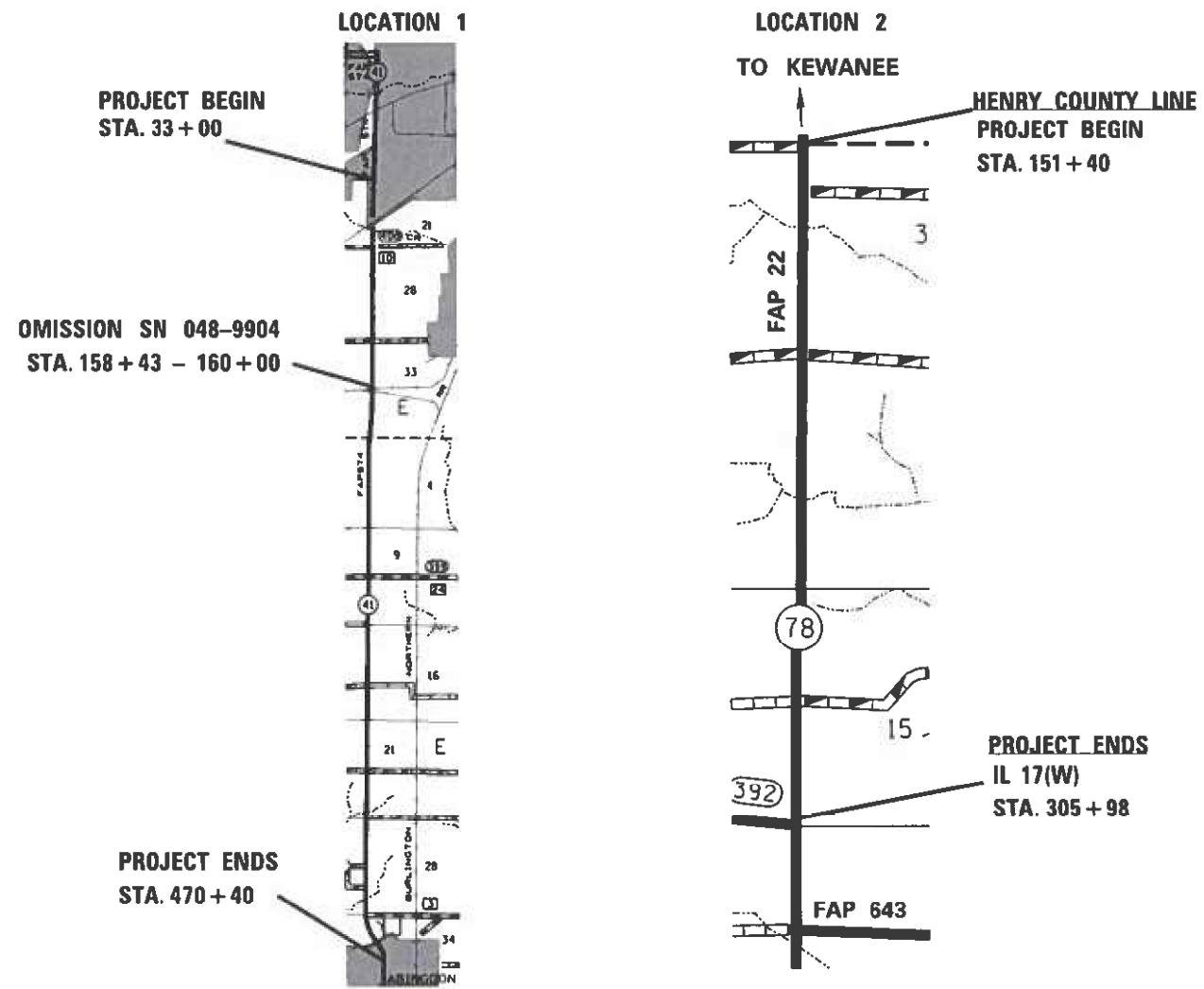

GROSS LENGTH = 59443 FT. = 11.26 MILES  
NET LENGTH = 59286 FT. = 11.23 MILES

# COMMITMENTS

NO COMMITMENTS HAVE BEEN MADE FOR THIS PROJECT.

# JOB SPECIFIC NOTES

## NO PASSING ZONE VERIFICATION:

THE RESIDENT SHALL CONTACT OPERATIONS TO VERIFY THE LOCATION OF NO PASSING ZONES PRIOR TO PLACEMENT OF CENTERLINE STRIPING

## SURFACE TEST APPLICATION:

SMOOTHNESS TESTS ON THE COMPLETED SURFACE WILL NOT BE REQUIRED; BUT THE ENGINEER RESERVES THE RIGHT TO REQUIRE CORRECTIVE MEASURES WHEN OBVIOUS SURFACE VARIATIONS ARE PRESENT.

## CAPE SEAL TREATMENT:

THE MATERIALS FOR THE A-1 SURFACE SHALL BE (CRUSHED) CA 20, (CRUSHED) CA 16 MAY BE USED IF APPROVED BY THE ENGINEER. THE MICRO-SURFACING APPLICATION SHALL BE SINGLE PASS.

## STATIONING:

THE EXISTING ROADWAY STATIONS SHALL BE COVERED PRIOR TO THE CAPE SEAL APPLICATIONS. THE COVER SHALL BE REMOVED AFTER WORK IS COMPLETED. THIS WORK SHALL BE INCLUDED IN THE COST OF THE "CAPE SEAL".

## MODIFIED URETHANE PAVEMENT MARKING:

TWO APPLICATIONS SHALL BE PLACED. THE FIRST APPLICATION SHALL BE APPLIED AFTER THE PROPOSED TREATMENT CURING TIME AS SPECIFIED IN THE STANDARD SPECIFICATIONS. THE SECOND APPLICATION SHALL BE APPLIED THIRTY (30) DAYS AFTER THE FIRST APPLICATION IS APPLIED.

PRIOR TO CAPE SEAL THE CONTRACTOR SHALL BE RESPONSIBLE FOR CAPTURING THE ORIGINAL CENTERLINE AS DIRECTED BY THE ENGINEER. THIS WORK SHALL BE INCLUDED IN THE COST OF THE "CAPE SEAL".

MODEL: Default  
 FILE: M:\MIS\_Plan\Subcontract\benefit.com\PIV\DOT\Documents\DOT Office\Director\_4\Project\104\_68166\CADD\Draws\CAD\Sheet68J00

USER NAME = Brian.Bouris	DESIGNED -	REVISED -	<b>STATE OF ILLINOIS DEPARTMENT OF TRANSPORTATION</b>	<b>COMMITMENTS AND JOB SPECIFIC NOTES</b>		F.A.P. RTE.	SECTION	COUNTY	TOTAL SHEETS	SHEET NO.
PLOT SCALE = 100,0000' / in.	DRAWN -	REVISED -				574/22	(14,15,16)RS-5;14RS-6	KNOX/STARK	22	2
PLOT DATE = 12/12/2023	CHECKED -	REVISED -		SCALE: SHEET OF SHEETS STA. TO STA.		CONTRACT NO. 68J00				
	DATE -	REVISED -		ILLINOIS FED. AID PROJECT						

CODE NO.	ITEM	UNIT	TOTAL QUANTITY	CONSTRUCTION CODE		
				80% FEDERAL 20% STATE	80% FEDERAL 20% STATE	80% FEDERAL 20% STATE
				KNOX COUNTY RURAL 0005	KNOX COUNTY URBAN 0005	STARK COUNTY RURAL 0005
* * 25000750	MOWING	ACRES	43	23	9	11
40400020	BUMP REMOVAL	EACH	175	107	43	25
40500001	FIBER-MODIFIED ASPHALT CRACK SEALING	FOOT	163000	105168	42332	15500
40500061	CAPE SEAL	SQ YD	165122	84463	36002	44657
67100100	MOBILIZATION	L SUM	1	0.53	0.21	0.26
70100460	TRAFFIC CONTROL AND PROTECTION, STANDARD 701306	L SUM	1	0.53	0.21	0.26
70107025	CHANGEABLE MESSAGE SIGN	CAL DA	28	7	7	14
70300100	SHORT-TERM PAVEMENT MARKING	FOOT	22941	13050	5253	4638
70300150	SHORT-TERM PAVEMENT MARKING REMOVAL	SQ FT	5110	2912	1172	1026
78009000	MODIFIED URETHANE PAVEMENT MARKING - LETTERS AND SYMBOLS	SQ FT	437	125	312	0
* 78009004	MODIFIED URETHANE PAVEMENT MARKING - LINE 4"	FOOT	90176	37633	27056	25487
* 78009006	MODIFIED URETHANE PAVEMENT MARKING - LINE 6"	FOOT	237552	125548	50172	61832
* 78009008	MODIFIED URETHANE PAVEMENT MARKING - LINE 8"	FOOT	3274	914	2360	0
* 78009012	MODIFIED URETHANE PAVEMENT MARKING - LINE 12"	FOOT	1510	560	950	0

\*\* 100% STATE FUNDS \*= SPECIALTY ITEM

MODEL D:\dell\...  
 FILE NAME: P:\Public\zww\ben\...  
 PROJECTS\DOT Documents\DOT Offices\Burlington\Projects\DOT\68168\CAD\Drawings\CAD\Sheets\68J00

USER NAME = Brian,Bouris	DESIGNED -	REVISED -
DRAWN -	REVISOR -	
PLOT SCALE = 100.0215' / in.	CHECKED -	REVISED -
PLOT DATE = 12/19/2023	DATE -	REVISED -

**STATE OF ILLINOIS  
DEPARTMENT OF TRANSPORTATION**

**SUMMARY OF QUANTITIES**

SCALE: SHEET OF SHEETS STA. TO STA.

F.A.P. RTE.	SECTION	COUNTY	TOTAL SHEETS	SHEET NO.
574/22	(14,15,16)RS-5;14RS-6	KNOX/STARK	22	3
CONTRACT NO. 68J00				
ILLINOIS FED. AID PROJECT				



CAPE SEAL			
LOCATION	LENGTH	WIDTH	AREA
	FOOT	FOOT	SQ YD
<b>KNOX COUNTY</b>			
<b>IL 41</b>			
STA. 33+00 - 36+15	315	35	1225.00
STA. 36+15 - 70+40	3425	24	9133.33
STA. 70+40 - 74+60	420	24-36	1400.00
STA. 74+60 - 80+00	540	36	2160.00
STA. 80+00 - 80+40	40	50	222.22
STA. 80+40 - 82+10	170	48	906.67
STA. 82+10 - 83+70	160	48-36	746.67
STA. 83+70 - 87+90	420	36-24	1400.00
STA. 87+90 - 158+43	7053	24	18808.00
<b>BRIDGE OMISSION STA 158+43 - 160+00</b>			
STA. 160+00 - 443+00	28300	24	75467.00
STA. 443+00 - 444+20	120	24-28.7	351.00
STA. 444+20 - 446+30	210	28.7-37	766.50
STA. 446+30 - 447+65	135	37-31.5	513.75
STA. 447+65 - 449+00	135	31.5-36	506.25
STA. 449+00 - 454+10	510	36	2040.00
STA. 454+10 - 458+90	480	36-28.7	1725.33
STA. 458+90 - 459+90	100	28.7-24	292.78
STA. 459+90 - 470+40	1050	24	2800.00
<b>KNOX COUNTY SUBTOTAL</b>			120465.00
<b>STARK COUNTY</b>			
<b>IL 78</b>			
STA. 151+40 - 305+98	15458	26	44656.44
<b>STARK COUNTY SUBTOTAL</b>			44657.00
<b>TOTAL</b>			<b>165,122</b>

HOT-MIX ASPHALT SURFACE REMOVAL, SPECIAL			
LOCATION	LENGTH	WIDTH	AREA
	FOOT	FOOT	SQ YD
<b>KNOX COUNTY</b>			
<b>IL 41</b>			
STA. 33+00 - 36+15	315	35	1225.00
STA. 36+15 - 70+40	3425	24	9133.33
STA. 70+40 - 74+60	420	24-36	1400.00
STA. 74+60 - 80+00	540	36	2160.00
STA. 80+00 - 80+40	40	50	222.22
STA. 80+40 - 82+10	170	48	906.67
STA. 82+10 - 83+70	160	48-36	746.67
STA. 83+70 - 87+90	420	36-24	1400.00
STA. 87+90 - 158+43	7053	24	18808.00
<b>BRIDGE OMISSION STA 158+43 - 160+00</b>			
STA. 160+00 - 443+00	28300	24	75467.00
STA. 443+00 - 444+20	80	24-28.7	351.00
STA. 444+20 - 446+30	210	28.7-37	766.50
STA. 446+30 - 447+65	135	37-31.5	513.75
STA. 447+65 - 449+00	135	31.5-36	506.25
STA. 449+00 - 454+10	510	36	2040.00
STA. 454+10 - 458+90	480	36-28.7	1725.33
STA. 458+90 - 459+90	100	28.7-24	292.78
STA. 459+90 - 470+40	1050	24	2800.00
<b>TOTAL</b>			<b>120,465</b>

BITUMINOUS MATERIALS (FOG SEAL)			
LOCATION	LENGTH	WIDTH	0.08 LBS/ SQFT
	FOOT	FOOT	POUND
<b>KNOX COUNTY</b>			
<b>IL 41 - SHOULDERS</b>			
STA. 33+00 - 158+43	12543	10	10035
<b>BRIDGE OMISSION STA 158+43 - 160+00</b>			
STA. 160+00 - 470+40	31040	10	24832
<b>TOTAL</b>			<b>34,867</b>

MODEL: Default  
 FILE: \\mfrpc01\pww\dot\Documents\DOT Office\B\State\_4\Projects\DOT\_68166\CA\Drawn\CAD\Sheet\68100

USER NAME = Brian.Bouris	DESIGNED -	REVISED -
	DRAWN -	REVISED -
PLOT SCALE = 100,0000' / in.	CHECKED -	REVISED -
PLOT DATE = 12/12/2023	DATE -	REVISED -

**STATE OF ILLINOIS**  
**DEPARTMENT OF TRANSPORTATION**

**SCHEDULE OF QUANTITIES**

SCALE: SHEET OF SHEETS STA. TO STA.

F.A.P. RTE.	SECTION	COUNTY	TOTAL SHEETS	SHEET NO.
574/22	(14,15,16)RS-5:14RS-6	KNOX/STARK	22	5
ILLINOIS FED. AID PROJECT			CONTRACT NO. 68J00	

MODIFIED URETHANE PAVEMENT MARKINGS											
LOCATION	LENGTH	SKIP DASH SOLID 4" (YELLOW)	NO PASS SOLID 4" (YELLOW)			LT & RT EDGE LINE SOLID 6" (WHITE)	ISLAND/TURN LN SOLID 8" (WHITE)	ISLAND SOLID DIAG 12" (WHITE)	DIAG SOLID 12" (YELLOW)	STOP BAR SOLID 24" (WHITE)	TURN ARROW (WHITE)
			LT	RT	DBL						
STATION		LIN FT	LIN FT				LIN FT				SQ FT
<b>KNOX COUNTY</b>											
<b>IL 41</b>											
STA. 33+00 - 37+11	411	102.75	411			822	100				31.2
STA. 37+11 - 48+00	1089	272.25				2178					
STA. 48+00 - 55+70	770	192.5		770		1540					
STA. 55+70 - 71+50	1580				3160	3160					
STA. 71+50 - 74+62	312				1248	624		85			
STA. 74+62 - 76+75	213				852	426		50			
STA. 76+75 - 78+95	220				440	440	207				46.8
CH 10 INTERSECTION											
STA. 78+95 - 81+80	285				570	570			12		78
STA. 81+80 - 83+70	190				760	380		45			
STA. 83+70 - 87+15	345				1380	690		90			
STA. 87+15 - 87+90	75				150	150					
STA. 87+90 - 93+80	590	147.5	590			1180					
STA. 93+80 - 147+48	5368	1342				10736					
STA. 147+48 - 156+60	912	228		912		1824					
STA. 156+60 - 164+75	815				1630	1630					
STA. 164+75 - 174+50	975	243.75	975			1950					
STA. 174+50 - 436+00	26150	6537.5				52300					
STA. 436+00 - 443+40	740				1480	1480					
STA. 443+40 - 446+28	288				1152	576		95			
STA. 446+28 - 448+98	270				1080	540		70			
STA. 448+98 - 451+35	237				474	474	237				31.2
TR 700 N (CH 5) INTERSECTION											
STA. 451+90 - 454+60	270				540	540	220				31.2
STA. 454+60 - 456+80	220				880	440		40			
STA. 456+80 - 459+87	307				1228	614		75			
STA. 459+87 - 472+85	1298				2596	2596					
<b>KNOX subtotal</b>		9066.25	1976	1682	19620	87860	1637	205	550	12	218.4
<b>2 APPLICATIONS</b>		18133	3952	3364	39240	175720	3274	410	1100	24	437
		<b>64,689</b>			<b>175,720</b>		<b>3,274</b>	<b>1,510</b>		<b>24</b>	<b>437</b>
<b>STARK COUNTY</b>											
<b>IL 78</b>											
STA. 151+40 - 153+74	234				468	468					
STA. 153+74 - 157+16	342	85	342			684					
STA. 157+16 - 176+18	1902	475				3804					
STA. 176+18 - 189+71	1353	338.25		1353		2706					
STA. 189+71 - 201+22	1151				2302	2302					
STA. 201+22 - 210+60	938	234.5	938			1876					
STA. 210+60 - 234+85	2425	606.25				4850					
STA. 234+85 - 240+94	609	152.25		609		1218					
STA. 240+94 - 243+51	257				514	514					
STA. 243+51 - 252+33	882	220.5	882			1764					
STA. 252+33 - 274+05	2172	543				4344					
STA. 274+05 - 279+66	561	140.25		561		1122					
STA. 279+66 - 282+25	259				518	518					
STA. 282+25 - 288+78	653	163.25	653			1306					
STA.. 288+78 - 304+75	1597	399.25				3194					
STA. 304+75 - 305+98	123				246	246					
<b>STARK Subtotal</b>		3357.5	2815	2523	4048	30916					
<b>2 APPLICATIONS</b>		6715	5630	5046	8096	61832					
		<b>25,487</b>			<b>61,832</b>						

MODEL: Default  
 FILE NAME: \\p0411101-pw-bentley.com\p0411101\Documents\11901 - Diff\res\Drawings - 419\Projects\01\_68166\CAD\Drawn\CAD\Sheet68100

USER NAME = B/ian_bouris	DESIGNED -	REVISED -
DRAWN -	REVISOR -	
PLOT SCALE = 100,0000' / in.	CHECKED -	REVISED -
PLOT DATE = 12/12/2023	DATE -	REVISED -

**STATE OF ILLINOIS**  
**DEPARTMENT OF TRANSPORTATION**

**SCHEDULE OF QUANTITIES**

SCALE: SHEET OF SHEETS STA. TO STA.

F.A.P. RTE.	SECTION	COUNTY	TOTAL SHEETS	SHEET NO.
574/22	(14,15,16)RS-5:14RS-6	KNOX/STARK	22	6
CONTRACT NO. 68J00			ILLINOIS FED. AID PROJECT	



MOBILZATION	
LOCATION	LUMP SUM
KNOX COUNTY - IL 41	0.74
STARK COUNTY - IL 78	0.26
<b>TOTAL</b>	<b>1</b>

MOWING	
LOCATION	ACRES
KNOX COUNTY IL 41	32
STARK COUNTY IL 78	11
<b>TOTAL</b>	<b>43</b>

TRAFFIC CONTROL AND PROTECTION STANDARD 701306	
LOCATION	LUMP SUM
KNOX COUNTY - IL 41	0.74
STARK COUNTY - IL 78	0.26
<b>TOTAL</b>	<b>1</b>

RAILROAD PROTECTIVE LIABILITY INSURANCE	
LOCATION	LUMP SUM
IL 41	1
<b>TOTAL</b>	<b>1</b>

CHANGEABLE MESSAGE SIGN	
LOCATION	LUMP SUM
KNOX COUNTY - IL 41 (2 SIGNS AT 7 DAYS EACH)	14
STARK COUNTY - IL 78 (2 SIGNS AT 7 DAYS EACH)	14
<b>TOTAL</b>	<b>28</b>

MODEL: Default  
 FILE NAME: \\p0401101-pw-bentley.com\p0401101\Documents\DOT Office\Bentley\_4\Projects\DOT\_68J00\CAD\Drawings\68J00

USER NAME = Brian.Bouris	DESIGNED -	REVISED -
	DRAWN -	REVISED -
PLOT SCALE = 100,0000' / in.	CHECKED -	REVISED -
PLOT DATE = 12/12/2023	DATE -	REVISED -

**STATE OF ILLINOIS**  
**DEPARTMENT OF TRANSPORTATION**

SCHEDULE OF QUANTITIES			
SCALE:	SHEET	OF	SHEETS

F.A.P. RTE.	SECTION	COUNTY	TOTAL SHEETS	SHEET NO.
574/22	(14,15,16)RS-5:14RS-6	KNOX/STARK	22	8
			CONTRACT NO. 68J00	
ILLINOIS FED. AID PROJECT				



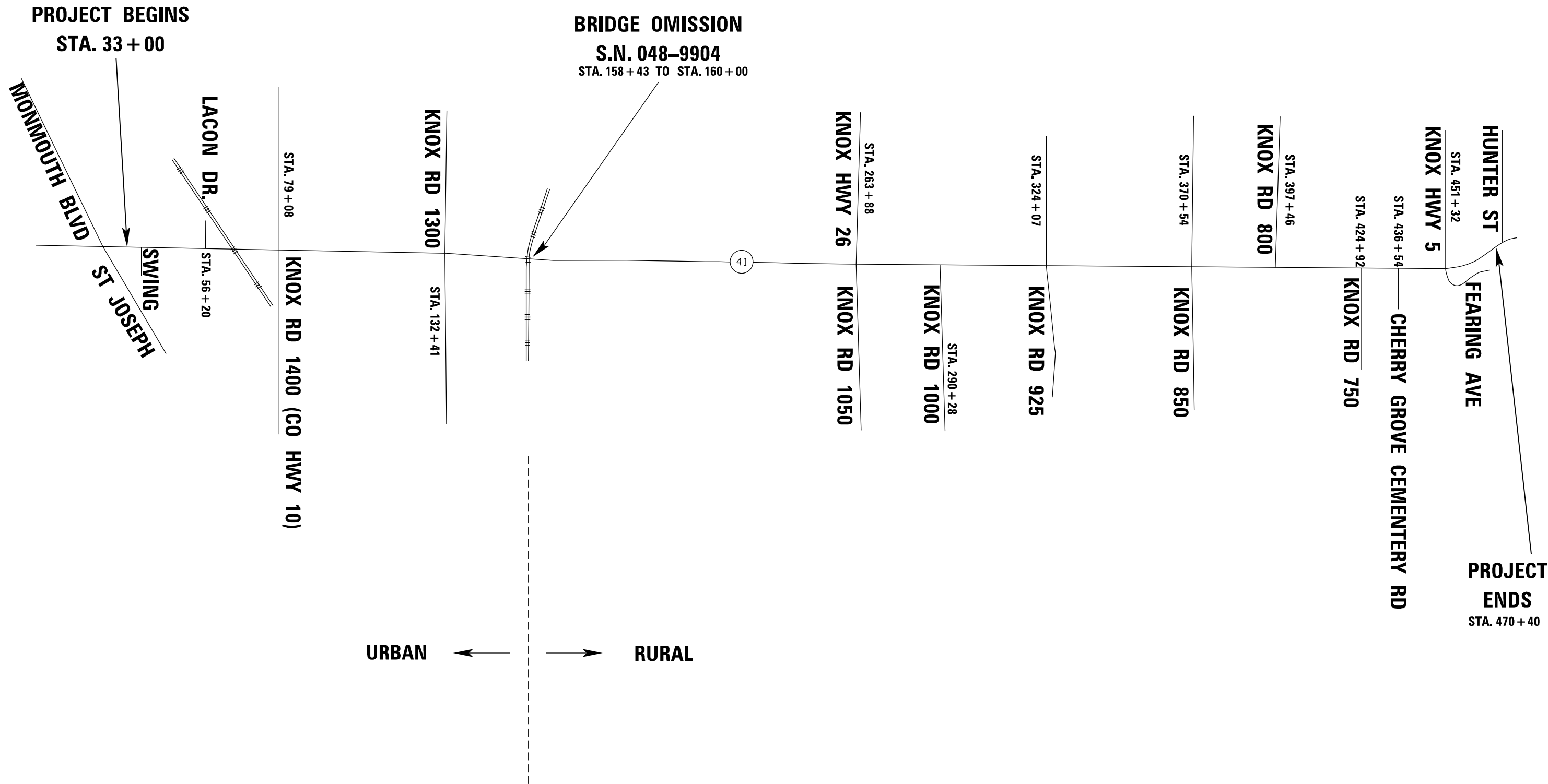

MODEL: Default  
 FILE: Mainfile.pia  
 SUBJECT: cw\_bentley.com:PIV\DOT\Documents\DOT\_Offices\Dir\drt.d\Project\104\_68166\CADD\Draws\CAD\Sheets\68J00

USER NAME = Brian,Bouris	DESIGNED -	REVISED -
	DRAWN -	REVISED -
PLOT SCALE = 100,0000 ' / in.	CHECKED -	REVISED -
PLOT DATE = 12/19/2023	DATE -	REVISED -

**STATE OF ILLINOIS  
DEPARTMENT OF TRANSPORTATION**

<b>LOCATION 1 - IL 41 LINE DIAGRAM</b>			
SCALE:	SHEET	OF	SHEETS
	STA.	TO	STA.

F.A.P. RTE.	SECTION	COUNTY	TOTAL SHEETS	SHEET NO.
574/22	(14,15,16)RS-5; 14RS-6	KNOX/STARK	22	9
CONTRACT NO. 68J00				
ILLINOIS FED. AID PROJECT				

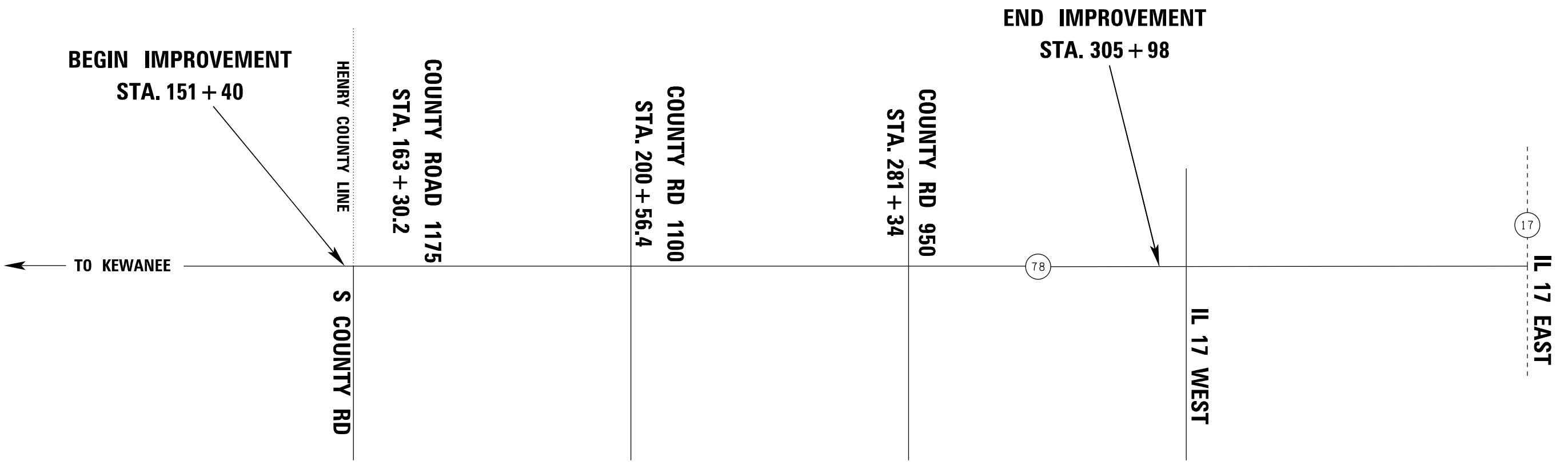
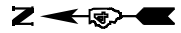

MODEL: Default  
 FILE NAME: p:\w\l\et\pw\ben\by.com\PIV\DOT\Documents\DOT Office\District 4\Projects\ID1\_68H68\CAD\Drawn\CAD\Sheet6669.dwg

USER NAME = Brian.Bouris	DESIGNED -	REVISED -
	DRAWN -	REVISED -
PLOT SCALE = 100,0000' / in.	CHECKED -	REVISED -
PLOT DATE = 12/12/2023	DATE -	REVISED -

**STATE OF ILLINOIS  
DEPARTMENT OF TRANSPORTATION**

**LOCATION 2 - IL 78 LINE DIAGRAM**

SCALE: SHEET OF SHEETS STA. TO STA.

F.A.P. RTE.	SECTION	COUNTY	TOTAL SHEETS	SHEET NO.
574/22	(14,15,16)RS-5:14RS-6	KNOX/STARK	22	10
CONTRACT NO. 68J00			ILLINOIS FED. AID PROJECT	

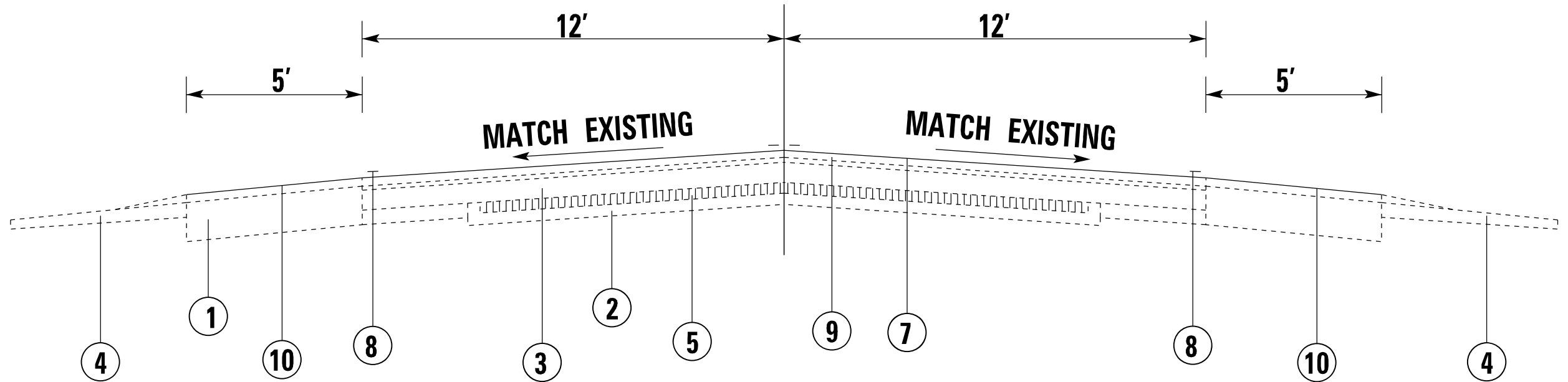

**LEGEND**

- 1 EXISTING HMA SHOULDER
- 2 EXISTING PCC PAVEMENT
- 3 EXISTING OVERLAY
- 4 EXISTING AGGREGATE SHOULDER
- 5 EXISTING BRICK COURSE 3"
- 6 EXISTING WIDENING
- 7 PROPOSED CAPE SEAL
- 8 PROPOSED PAVEMENT MARKING
- 9 PROPOSED HMA SURFACE REMOVAL, SPECIAL 1/2"
- 10 PROPOSED BITUMINOUS MATERIALS (FOG SEAL)

**STA. 33 + 00 TO STA. 68 + 00**  
**STA. 89 + 00 TO STA. 158 + 43**  
**STA. 160 + 00 TO STA. 443 + 40**  
**STA. 459 + 90 TO STA. 470 + 40**

MODEL: Default  
 FILE NAME: p:\work\paw\_bentley.com\PIV\DOT\Documents\DOT Office\Bentley 4\Project\DOT 68H68\CAD\Drawn\CAD\Sheet68J00

USER NAME = Brian.Bouris	DESIGNED -	REVISED -
PLOT SCALE = 100,0000' / in.	DRAWN -	REVISED -
PLOT DATE = 12/12/2023	CHECKED -	REVISED -
	DATE -	REVISED -

**STATE OF ILLINOIS  
 DEPARTMENT OF TRANSPORTATION**

**IL 41 TYPICAL SECTIONS**

SCALE: SHEET OF SHEETS STA. TO STA.

F.A.P. RTE.	SECTION	COUNTY	TOTAL SHEETS	SHEET NO.
574/22	(14,15,16)RS-5:14RS-6	KNOX/STARK	22	11
ILLINOIS FED. AID PROJECT			CONTRACT NO. 68J00	

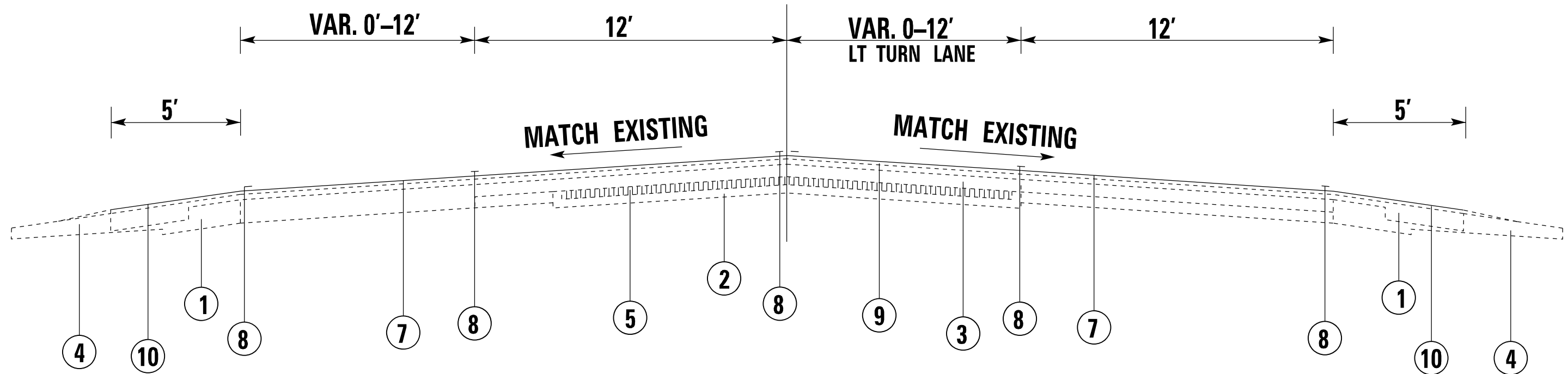

**STA. 68 + 00 TO STA. 89 + 00**

**LEGEND**

- 1** EXISTING HMA SHOULDER
- 2** EXISTING PCC PAVEMENT
- 3** EXISTING OVERLAY
- 4** EXISTING AGGREGATE SHOULDER
- 5** EXISTING BRICK COURSE 3"
- 6** EXISTING WIDENING
- 7** PROPOSED CAPE SEAL
- 8** PROPOSED PAVEMENT MARKING
- 9** PROPOSED HMA SURFACE REMOVAL, SPECIAL 1/2"
- 10** PROPOSED BITUMINOUS MATERIALS (FOG SEAL)

MODEL: Default  
 FILE NAME: \\pww\share\pww\benlby.com\PIV\DOT\Documents\DOT Office\Bouris\4\Project\01\_68H68-CAD\Drawn\CAD\Sheet\68J00

USER NAME = Brian.Bouris	DESIGNED -	REVISED -
PLOT SCALE = 100,0000' / in.	DRAWN -	REVISED -
PLOT DATE = 12/12/2023	CHECKED -	REVISED -
	DATE -	REVISED -

**STATE OF ILLINOIS  
DEPARTMENT OF TRANSPORTATION**

**IL 41 TYPICAL SECTIONS**

SCALE: SHEET OF SHEETS STA. TO STA.

F.A.P. RTE.	SECTION	COUNTY	TOTAL SHEETS	SHEET NO.
574/22	(14,15,16)RS-5:14RS-6	KNOX/STARK	22	12
CONTRACT NO. 68J00			ILLINOIS FED. AID PROJECT	

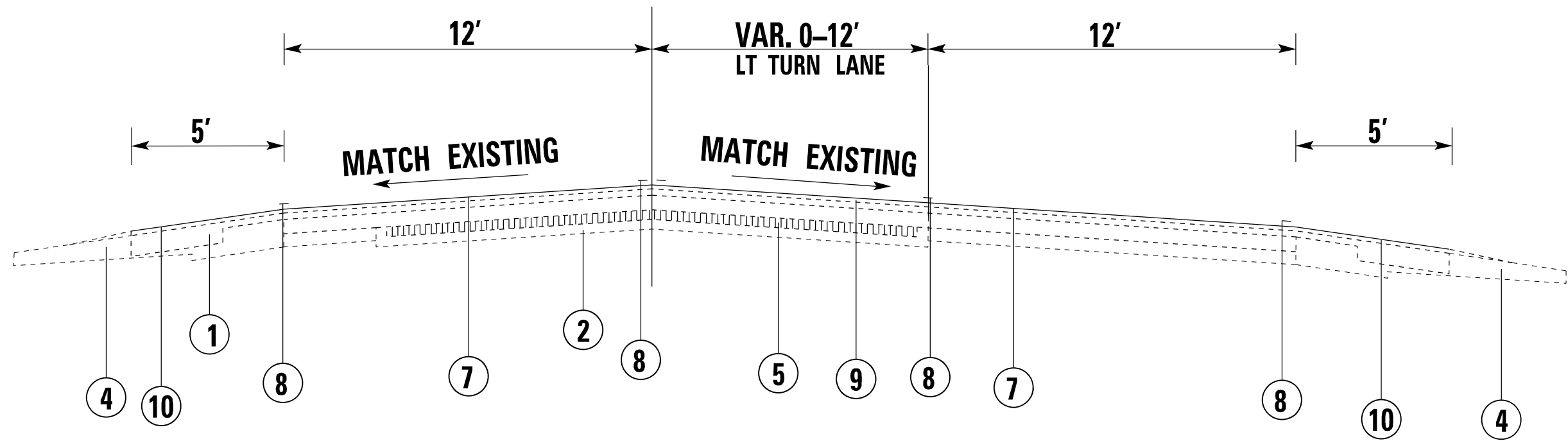

**STA. 443+40 TO STA. 459+90**

**LEGEND**

- 1 EXISTING HMA SHOULDER
- 2 EXISTING PCC PAVEMENT
- 3 EXISTING OVERLAY
- 4 EXISTING AGGREGATE SHOULDER
- 5 EXISTING BRICK COURSE 3"
- 6 EXISTING WIDENING
- 7 PROPOSED CAPE SEAL
- 8 PROPOSED PAVEMENT MARKING
- 9 PROPOSED HMA SURFACE REMOVAL, SPECIAL 1/2"
- 10 PROPOSED BITUMINOUS MATERIALS (FOG SEAL)

MODEL: Default  
 FILE NAME: \\pww\share\pww\benm\by.com\PIV\DOT\Documents\DOT Office\Bouris, Brian\41\Project\DOT Office\Bouris, Brian\CAD\Drawings\CAD\plans\68100

USER NAME = Brian.Bouris	DESIGNED -	REVISED -
	DRAWN -	REVISED -
PLOT SCALE = 100,0000' / in.	CHECKED -	REVISED -
PLOT DATE = 12/12/2023	DATE -	REVISED -

**STATE OF ILLINOIS  
DEPARTMENT OF TRANSPORTATION**

**IL 41 TYPICAL SECTIONS**

SCALE: SHEET OF SHEETS STA. TO STA.

F.A.P. RTE.	SECTION	COUNTY	TOTAL SHEETS	SHEET NO.
574/22	(14,15,16)RS-5:14RS-6	KNOX/STARK	22	13
ILLINOIS FED. AID PROJECT			CONTRACT NO. 68100	

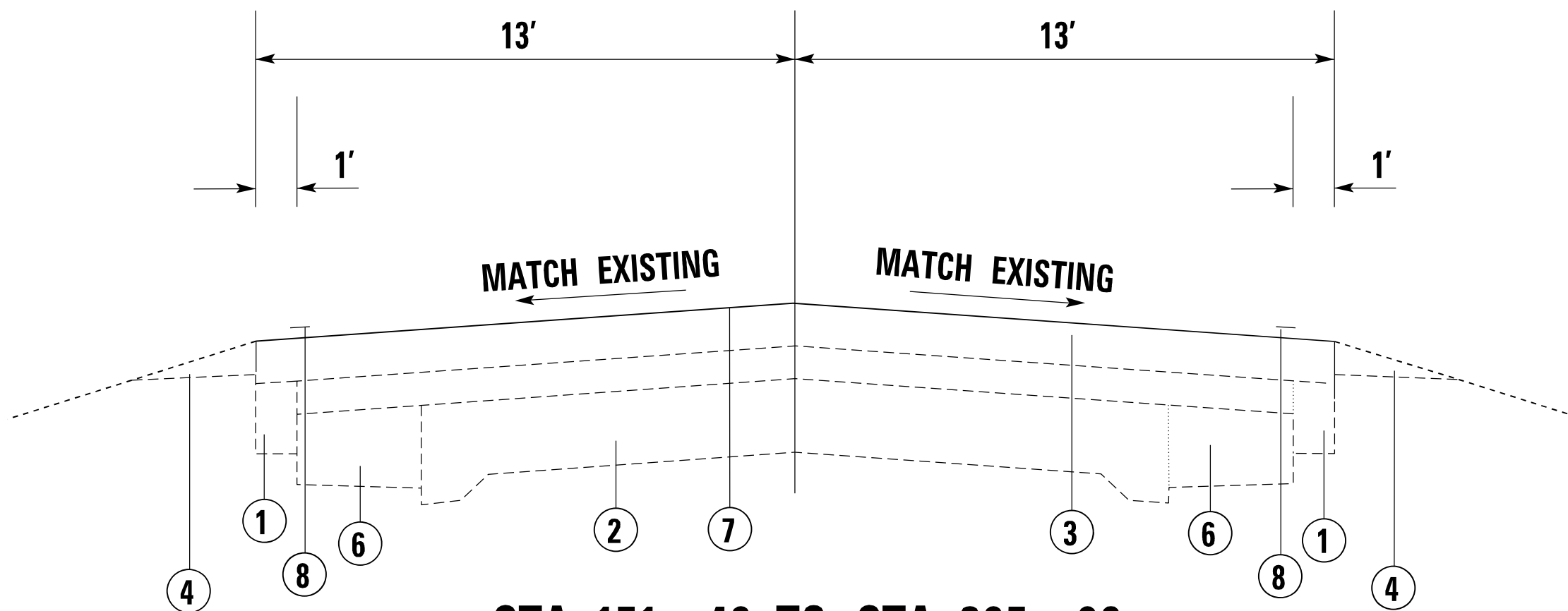

**STA. 151 + 40 TO STA. 305 + 98**

**LEGEND**

- 1** EXISTING HMA SHOULDER
- 2** EXISTING PCC PAVEMENT
- 3** EXISTING OVERLAY
- 4** EXISTING AGGREGATE SHOULDER
- 5** EXISTING BRICK COURSE 3"
- 6** EXISTING WIDENING
- 7** PROPOSED CAPE SEAL
- 8** PROPOSED PAVEMENT MARKING
- 9** PROPOSED HMA SURFACE REMOVAL, SPECIAL 1/2"
- 10** PROPOSED BITUMINOUS MATERIALS (FOG SEAL)

MODEL: Default  
 FILE NAME: \\pww\share\pww\benm\by.com\PIV\DOT\Documents\DOT Office\Bouris 4\Project\01\_68H68\CAD\Drawn\CAD\plans\68J00

USER NAME = Brian.Bouris	DESIGNED -	REVISED -
PLOT SCALE = 100,0000' / in.	DRAWN -	REVISED -
PLOT DATE = 12/12/2023	CHECKED -	REVISED -
	DATE -	REVISED -

**STATE OF ILLINOIS  
DEPARTMENT OF TRANSPORTATION**

**IL 78 TYPICAL SECTIONS**

SCALE: SHEET OF SHEETS STA. TO STA.

F.A.P. RTE.	SECTION	COUNTY	TOTAL SHEETS	SHEET NO.
574/22	(14,15,16)RS-5:14RS-6	KNOX/STARK	22	14
ILLINOIS FED. AID PROJECT			CONTRACT NO. 68J00	

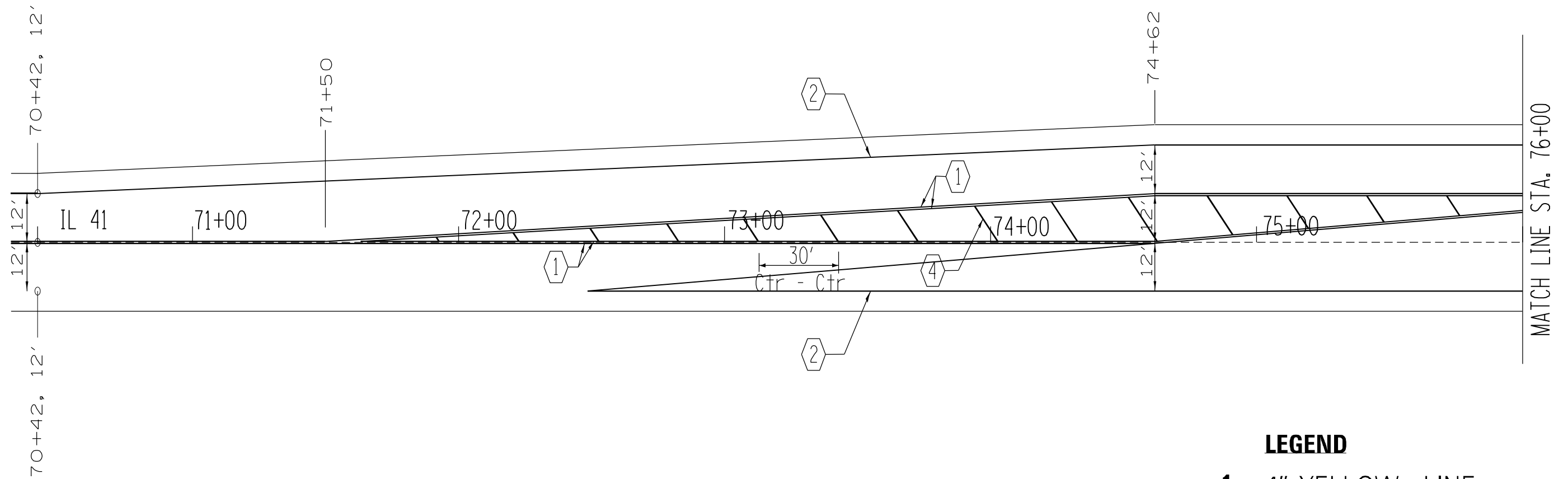

**LEGEND**

- 1 4" YELLOW LINE
- 2 6" WHITE LINE
- 3 8" WHITE LINE
- 4 12" YELLOW LINE
- 5 12" WHITE LINE
- 6 24" WHITE LINE

MODEL: Default  
 FILE NAME: p:\w\l\c\pww\benlby.com\PIV\DOT\Documents\DOT Office\District 4\Projects\DL 68H68\CAD\Drawn\CAD\Sheets\68J00

USER NAME = Brian.Bouris	DESIGNED -	REVISED -
DRAWN -	REVISED -	
PLOT SCALE = 100,0000' / in.	CHECKED -	REVISED -
PLOT DATE = 12/12/2023	DATE -	REVISED -

**STATE OF ILLINOIS  
DEPARTMENT OF TRANSPORTATION**

**PAVEMENT MARKING DETAILS (IL 41)**

SCALE: SHEET OF SHEETS STA. TO STA.

F.A.P. RTE.	SECTION	COUNTY	TOTAL SHEETS	SHEET NO.
574/22	(14,15,16) RS-5; 14RS-6	KNOX/STARK	22	15
CONTRACT NO. 68J00				
ILLINOIS FED. AID PROJECT				

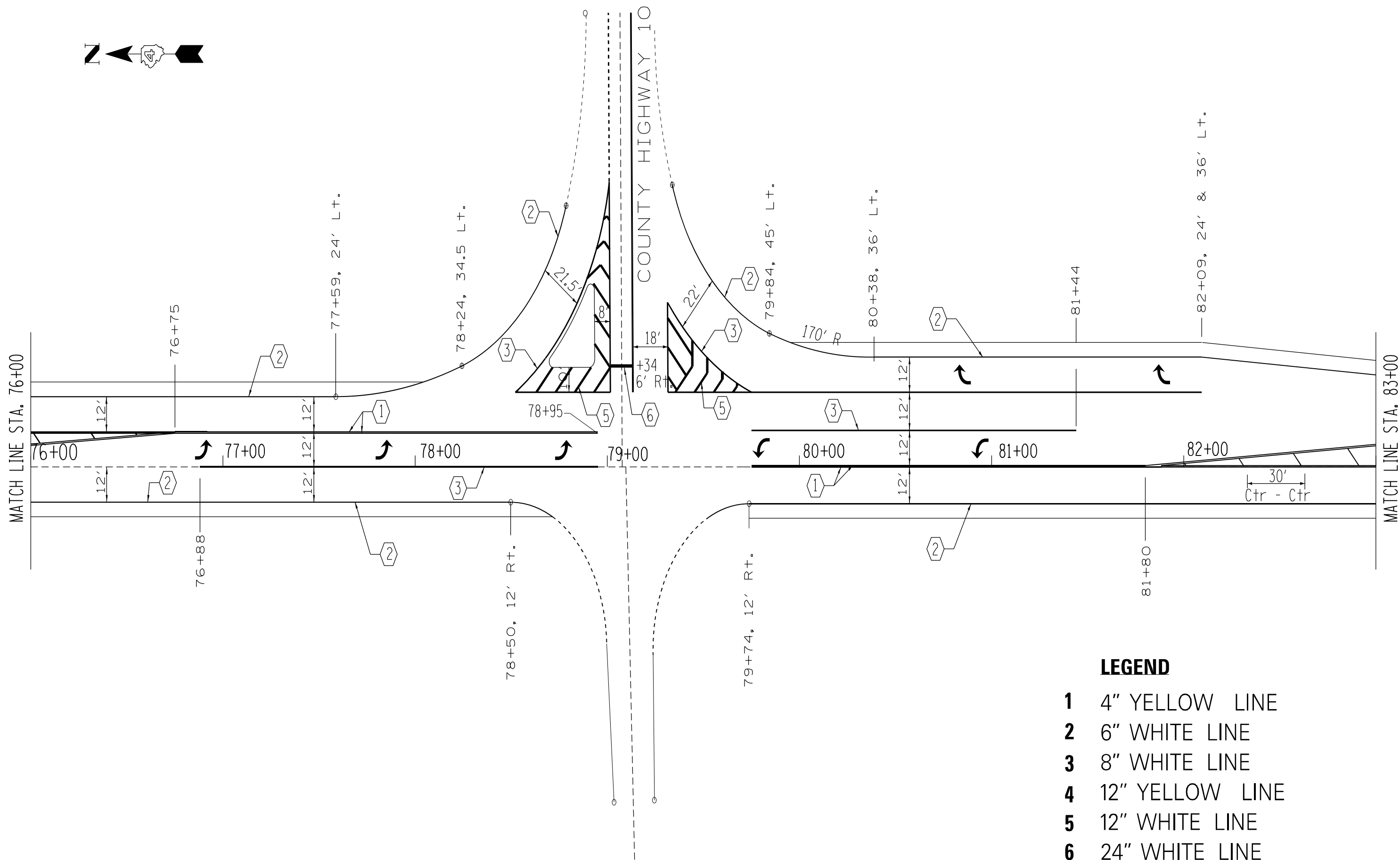

- LEGEND**
- 1 4" YELLOW LINE
  - 2 6" WHITE LINE
  - 3 8" WHITE LINE
  - 4 12" YELLOW LINE
  - 5 12" WHITE LINE
  - 6 24" WHITE LINE

MODEL: Default  
 FILE NAME: p:\ultra-cad\benefy.com\PIV\DOT\Documents\DOT Office\District\_4\Project\104\_68168\CADD\Drawings\CD\Sheet68J00

USER NAME = Brian,Bouris	DESIGNED -	REVISED -
DRAWN -	REVISOR -	
PLOT SCALE = 100,0000' / in.	CHECKED -	REVISED -
PLOT DATE = 12/12/2023	DATE -	REVISED -

**STATE OF ILLINOIS  
DEPARTMENT OF TRANSPORTATION**

PAVEMENT MARKING DETAILS (IL 41)			
SCALE:	SHEET	OF SHEETS	STA. TO STA.

F.A.P. RTE.	SECTION	COUNTY	TOTAL SHEETS	SHEET NO.
574/22	(14,15,16) RS-5; 14RS-6	KNOX/STARK	22	16
CONTRACT NO. 68J00				
ILLINOIS FED. AID PROJECT				



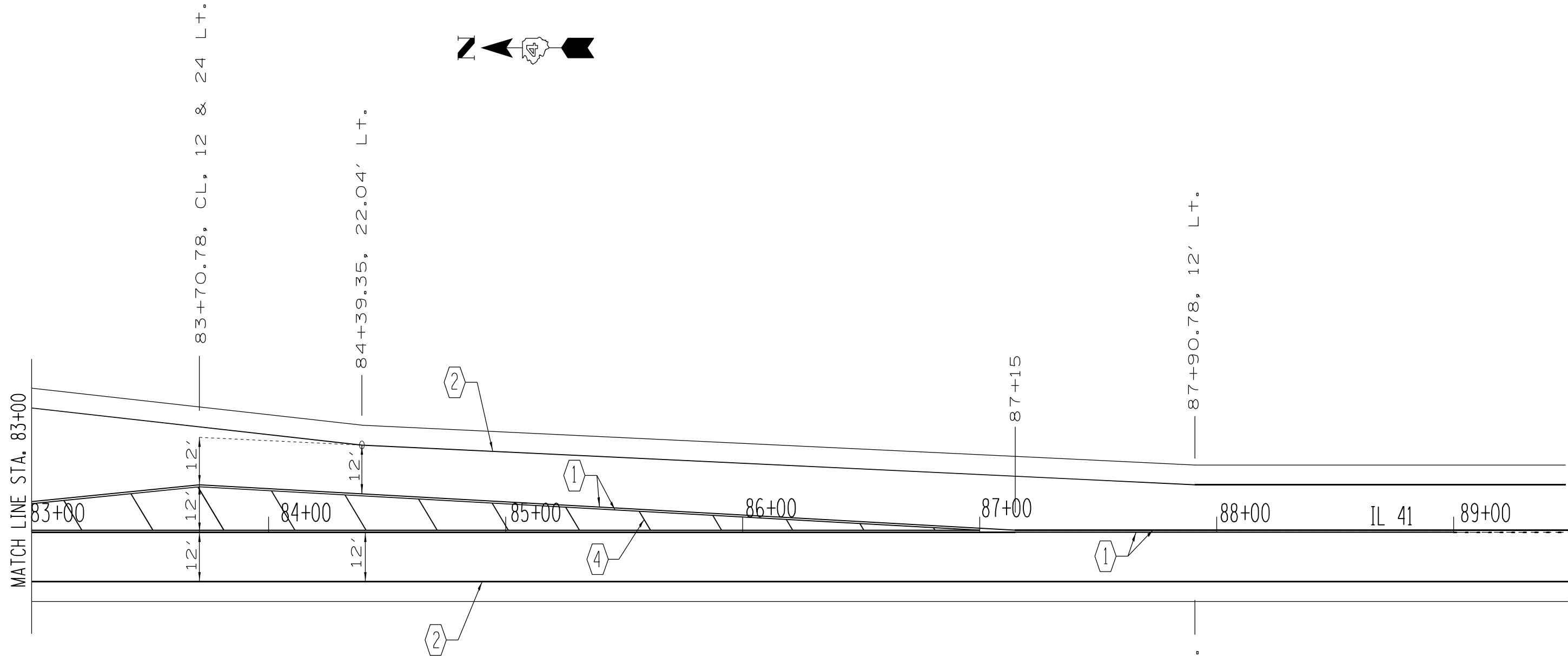

**LEGEND**

- 1 4" YELLOW LINE
- 2 6" WHITE LINE
- 3 8" WHITE LINE
- 4 12" YELLOW LINE
- 5 12" WHITE LINE
- 6 24" WHITE LINE

MODEL: Default  
 FILE NAME: p:\w\l\c\p\w\ben\by.com\PIV\DOT\Documents\DOT Office\Bouris\_4\Project\01\_68H68\CAD\Drawn\CAD\p\hsts\68.00

USER NAME = Brian.Bouris	DESIGNED -	REVISED -
DRAWN -	REVISED -	
PLOT SCALE = 100,0000' / in.	CHECKED -	REVISED -
PLOT DATE = 12/12/2023	DATE -	REVISED -

**STATE OF ILLINOIS**  
**DEPARTMENT OF TRANSPORTATION**

**PAVEMENT MARKING DETAILS (IL 41)**

SCALE: SHEET OF SHEETS STA. TO STA.

F.A.P. RTE.	SECTION	COUNTY	TOTAL SHEETS	SHEET NO.
574/22	(14,15,16) RS-5; 14RS-6	KNOX/STARK	22	17
CONTRACT NO. 68J00				
ILLINOIS FED. AID PROJECT				

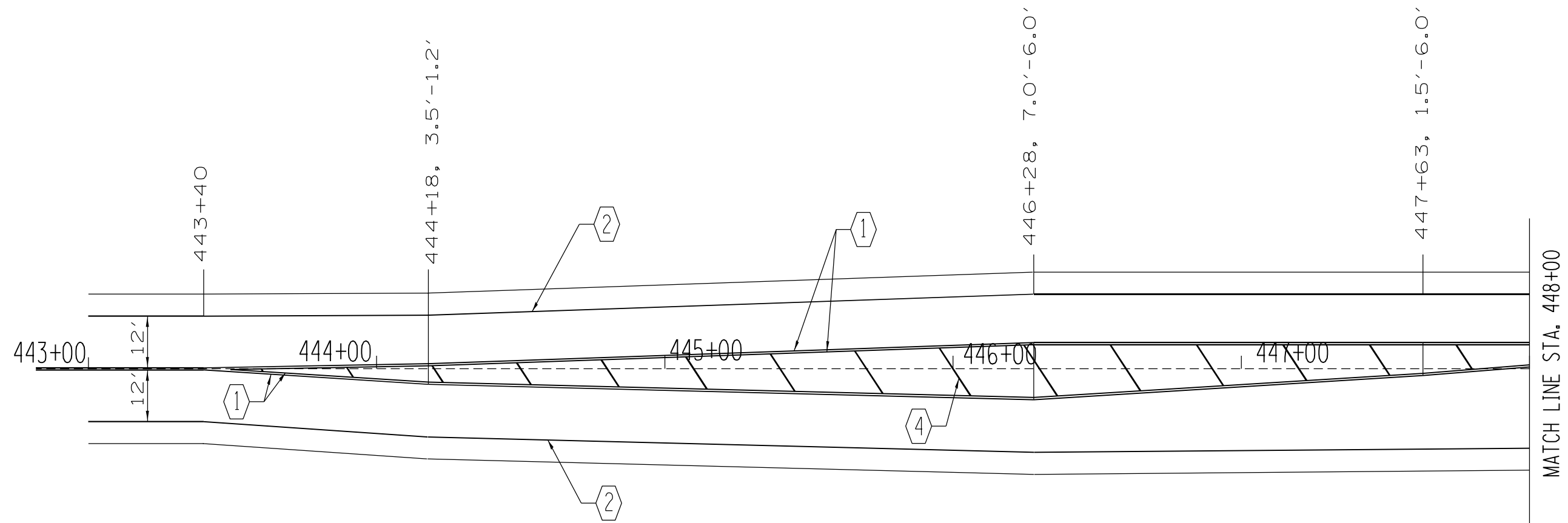

**LEGEND**

- 1 4" YELLOW LINE
- 2 6" WHITE LINE
- 3 8" WHITE LINE
- 4 12" YELLOW LINE
- 5 12" WHITE LINE
- 6 24" WHITE LINE

MODEL: Default  
 FILE NAME: p:\w\l\c\p\w\ben\by.com\PIV\DOT\Documents\DOT Office\District 4\Projects\DL 68H68\CAD\Drawn\CAD\Sheet6669.DWG

USER NAME = Brian.Bouris	DESIGNED -	REVISED -
	DRAWN -	REVISED -
PLOT SCALE = 100,0000' / in.	CHECKED -	REVISED -
PLOT DATE = 12/12/2023	DATE -	REVISED -

**STATE OF ILLINOIS**  
**DEPARTMENT OF TRANSPORTATION**

**PAVEMENT MARKING DETAILS (IL 41)**

SCALE: SHEET OF SHEETS STA. TO STA.

F.A.P. RTE.	SECTION	COUNTY	TOTAL SHEETS	SHEET NO.
574/22	(14,15,16) RS-5; 14RS-6	KNOX/STARK	22	18
CONTRACT NO. 68J00				
ILLINOIS FED. AID PROJECT				

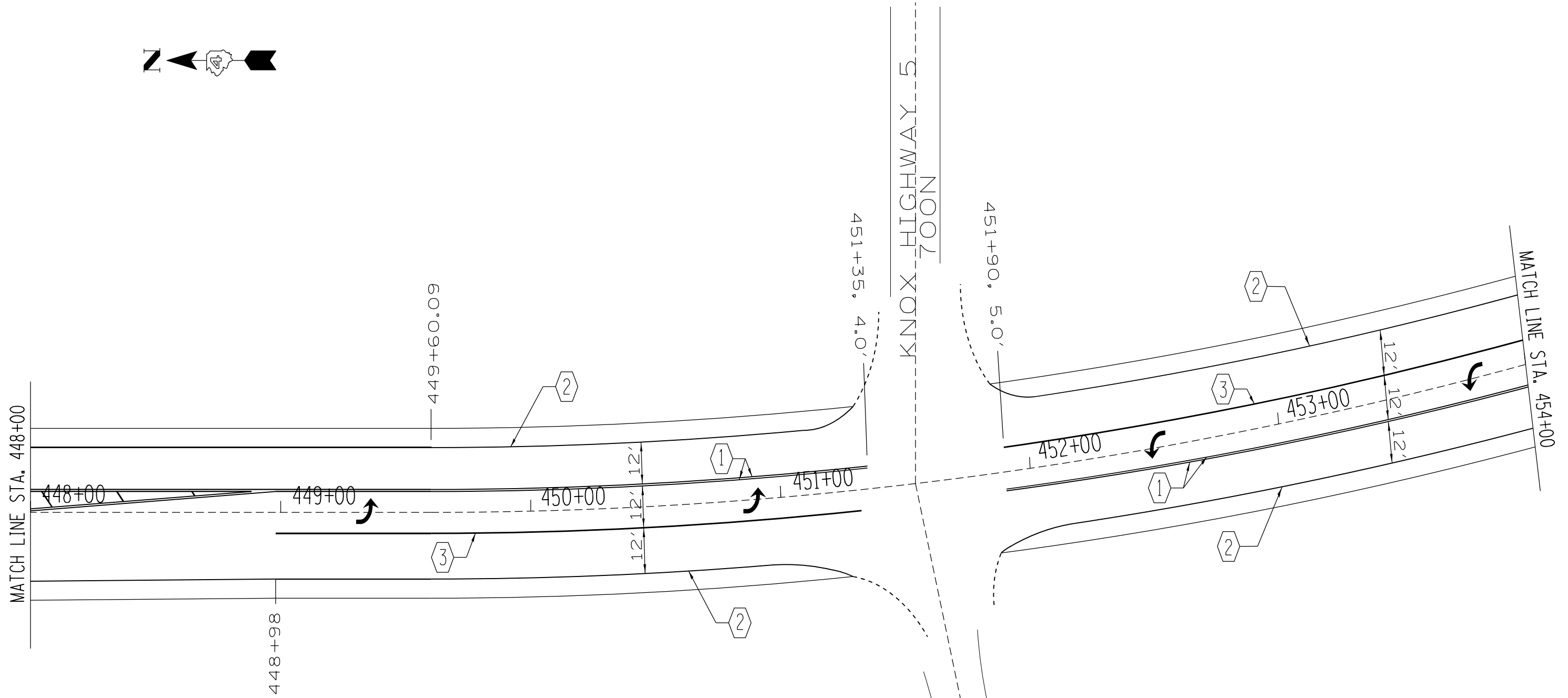

- LEGEND**
- 1 4" YELLOW LINE
  - 2 6" WHITE LINE
  - 3 8" WHITE LINE
  - 4 12" YELLOW LINE
  - 5 12" WHITE LINE
  - 6 24" WHITE LINE

MODEL: Default  
 FILE NAME: p:\w\l\c\pww\ben\by.com\PIV\DOT\Documents\DOT Office\District 4\Project\01\_68H68\CAD\Drawn\CAD\Sheet68J00

USER NAME = Brian.Bouris	DESIGNED -	REVISED -
	DRAWN -	REVISED -
PLOT SCALE = 100,0000' / in.	CHECKED -	REVISED -
PLOT DATE = 12/12/2023	DATE -	REVISED -

**STATE OF ILLINOIS  
DEPARTMENT OF TRANSPORTATION**

**PAVEMENT MARKING DETAILS (IL 41)**

SCALE: SHEET OF SHEETS STA. TO STA.

F.A.P. RTE.	SECTION	COUNTY	TOTAL SHEETS	SHEET NO.
574/22	(14,15,16) RS-5; 14RS-6	KNOX/STARK	22	19
CONTRACT NO. 68J00				
ILLINOIS FED. AID PROJECT				

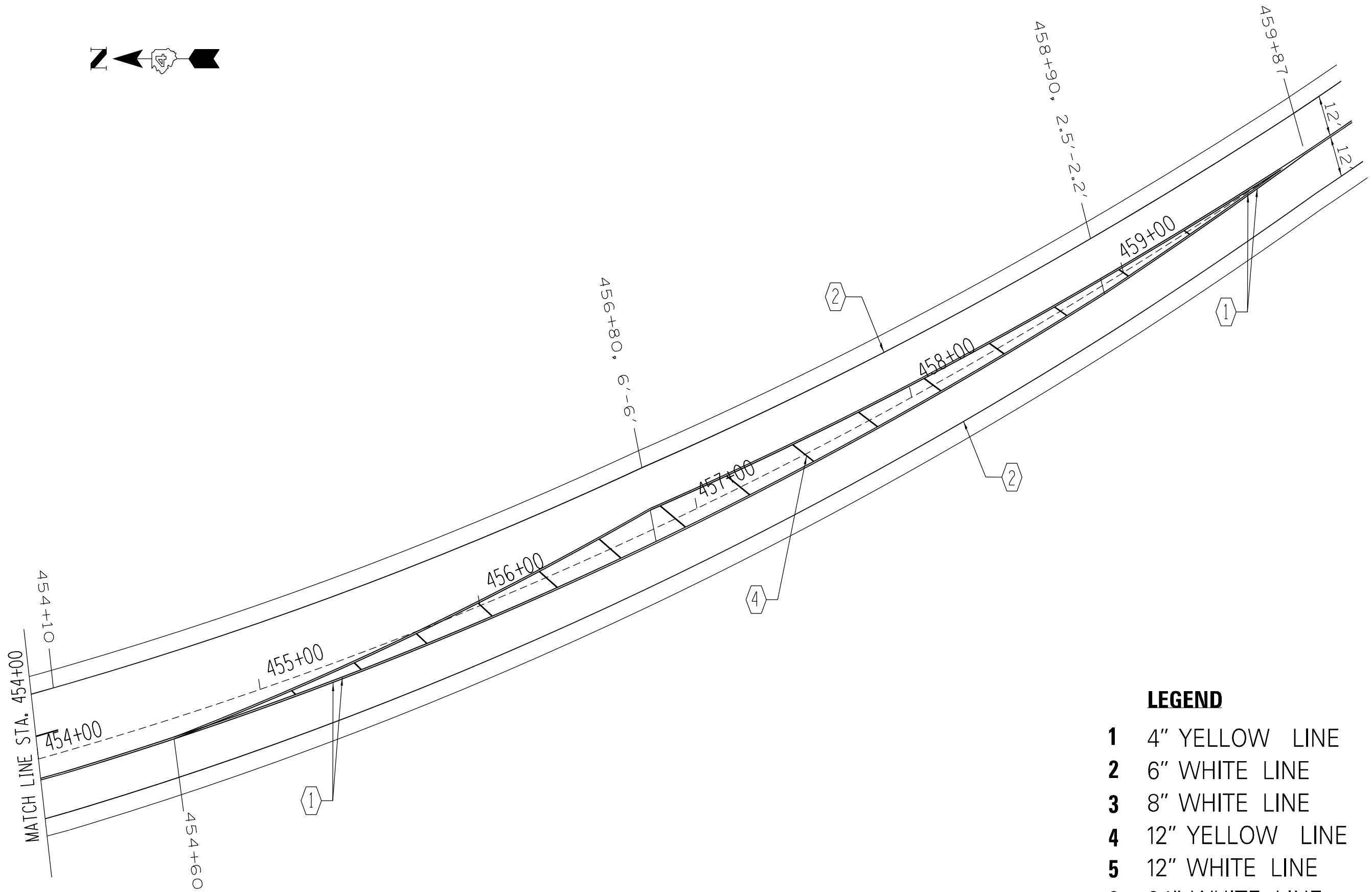

**LEGEND**

- 1** 4" YELLOW LINE
- 2** 6" WHITE LINE
- 3** 8" WHITE LINE
- 4** 12" YELLOW LINE
- 5** 12" WHITE LINE
- 6** 24" WHITE LINE

MODEL: Default  
 FILE NAME: s:\w\l\c\p\w\ben\m\by.com\PIV\DOT\Documents\DOT Office\District 4\Projects\DL 68H68 CAD\Drawn\CAD\Sheet68J00

USER NAME = Brian.Bouris	DESIGNED -	REVISED -
DRAWN -	REVISED -	
PLOT SCALE = 100,000' / in.	CHECKED -	REVISED -
PLOT DATE = 12/12/2023	DATE -	REVISED -

**STATE OF ILLINOIS**  
**DEPARTMENT OF TRANSPORTATION**

**PAVEMENT MARKING DETAILS (IL 41)**

SCALE: SHEET OF SHEETS STA. TO STA.

F.A.P. RTE.	SECTION	COUNTY	TOTAL SHEETS	SHEET NO.
574/22	(14,15,16) RS-5; 14RS-6	KNOX/STARK	22	20
ILLINOIS FED. AID PROJECT			CONTRACT NO. 68J00	

DESIGNER NOTES:  
1. Include State Standard 780001 (Typical Pavement Markings)

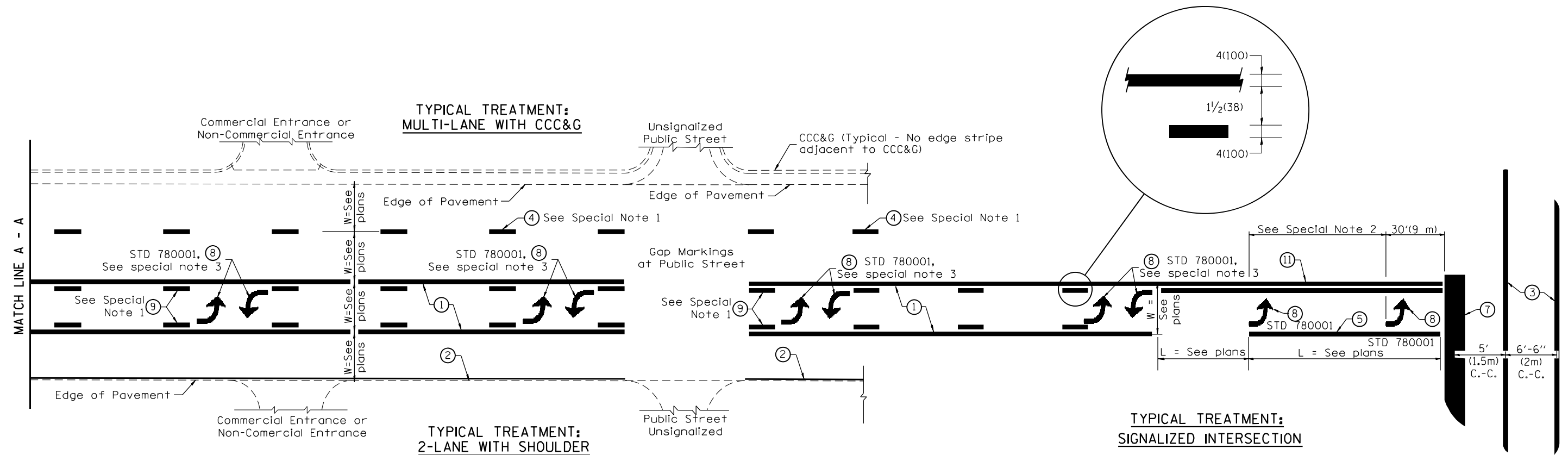

**FLUSH PAVED MEDIAN: TWO-WAY LEFT TURN LANE WITH ONE-WAY LEFT TURN LANE AT SIGNALIZED INTERSECTION**

**TYPICAL PAVEMENT MARKING LEGEND**

(Note: This is a District Standard Legend. Some elements may not apply to specific project.)

- ① 4(100) Solid (Yellow)
- ② 4(100) Solid (White)
- ③ 2-6(150) Crosswalk @ 6'-6" (2m)min C.-C. (White)  
2-8(200) Crosswalk @ 6'-6" (2m)min C.-C. (White) (When traffic signals are present.)
- ④ 6(150) Skip-Dash (White) (See Special Note 1)
- ⑤ 8(200) Solid (White)
- ⑥ 12(300) Diagonal (White) (Item ⑥ is shown on Std. 780001)
- ⑦ 24(600) Stop Bar (White)
- ⑧ Letters & Arrows (See Std. 780001 and Special Notes 2 & 3)
- ⑨ 4(100) Skip-Dash (Yellow) (See Special Note 1)
- ⑩ 12(300) Diagonal (Yellow) (See Table A) (See Table A)
- ⑪ 4(100) Double Solid (Yellow) (See Table A)

**SPECIAL NOTES**

- Skip-Dash markings will be centered between both ends of city blocks and shall be placed in alignment transversely across the pavement.
- The following shall apply to arrows located in one-way left turn lanes:
  - A. A minimum of two (2) arrows is required.
  - B. The maximum spacing between arrows is 80' (24 m).
  - C. Arrows shall be evenly spaced if three (3) or more are required.
- The following shall apply to arrow pairs located in two-way left turn lanes:
  - A. A minimum of two (2) arrow pairs is required.
  - B. The maximum spacing between arrow pairs is 200' (61 m).
  - C. Arrow pairs shall be evenly spaced if three (3) or more are required.
  - D. The spacing between Bi Directional Left Turn Arrows is 33' (10 m).

**GENERAL NOTES**

- Refer to State Standard 780001 for additional Pavement Markings including letters & arrows.
- See Plans for Pavement Markings adjacent to curbed islands and medians, and through lane reductions.
- Refer to Article 780.13 for letter, number and symbol areas (sq. ft.)
- Areas are grooved 1" beyond each edge for the following symbols:  
Through Arrow= 14.8 sq. ft.  
Large Left or Right Arrow= 21.9 sq. ft.  
2 Arrow Combination Left (or Right) and Through= 34.9 sq. ft.  
Wrong Way Arrow= 29.5 sq. ft.  
Railroad Crossing Symbol= 69.8 sq. ft.  
(For further information, refer to BDE Special Provision: Grooving for Recessed Pavement Markings)

01-01-97	RENUM. F-8.03, NEW REVISION BOX	T.P.	10-16-06	REVISED TO 2007 SPEC.	
02-07-97	ADD BI DIRECTIONAL DIMENSION	J.A.	2/29/16	ADDED GROOVING AREAS	R.D.
10-97	CORRECT BI DIRECTIONAL DIMENSION	J.A.	07-16-19	SPELLING CORRECTIONS	R.D.
08-02	ADD CROSSWALK DMNS. WITH T.S.	M.A.			

**STATE OF ILLINOIS  
DEPARTMENT OF TRANSPORTATION**

NOT TO SCALE

**TYPICAL PAVEMENT MARKINGS**

SHT. 1 OF 2  
CADD STD. 780001-D4

F.A. RTE.	SECTION	COUNTY	TOTAL SHEETS	SHEET NO.
574/22	(14,15,16)RS-5,14RS-6	KNOX/STARK	22	21
FED. ROAD DIST. NO. ILLINOIS FED. AID PROJECT			CONTRACT NO. 68J00	

