

CONTRACT NO.: 98881
 ROUTE: VARIOUS
 COUNTY: VARIOUS
 SECTION: D-9 CONTRACT MAINTENANCE 05-7
 SHEET NO.: 9 OF 31

B.M. 512W in root 30" Hickory 15' R.R. Sta. 37+77 El. 405.10
 Existing Structure: Penn Truss 1 span @ 160' R.C.D. Girders 4 spans @ 53', 2 spans @ 53'-3"

STATE OF ILLINOIS
 DEPARTMENT OF PUBLIC WORKS & BUILDINGS
 DIVISION OF HIGHWAYS

Temporary bridge not required.

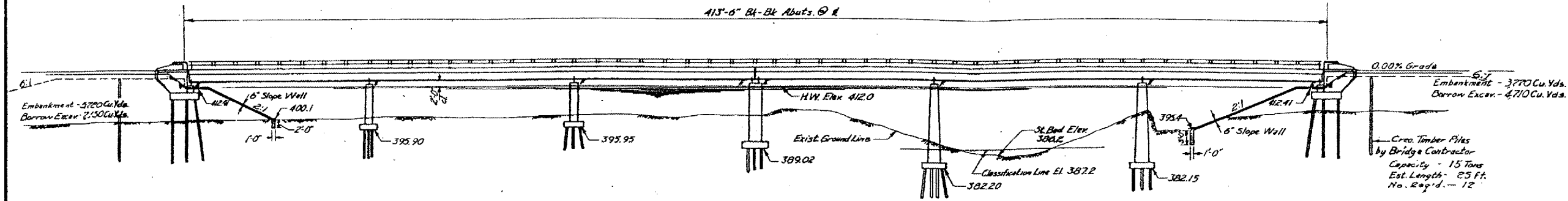

ELEVATION

STATION 39+90
 BUILT 196 BY
 STATE OF ILLINOIS
 S.B.I. Rt. 154 SEC. 108 B-1
 PROJECT F-118 (3)
 LOADING H20-510

NAME PLATE DATA
 See Standard 2113

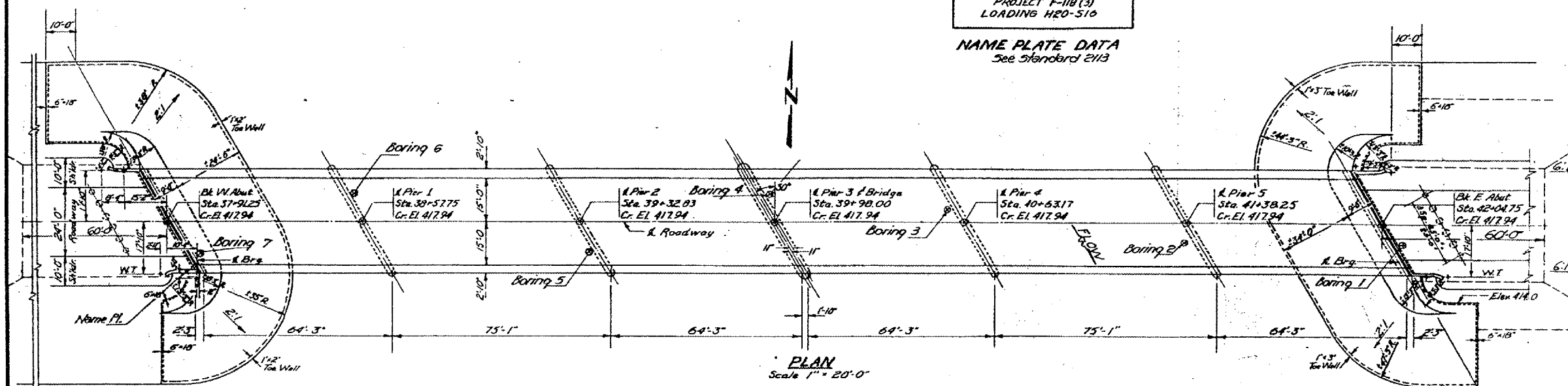

PLAN
 Scale 1" = 20'-0"

GENERAL NOTES

Class X concrete shall be used throughout except in handrail and posts and piers.
 Class A concrete shall be used in piers.
 Handrail concrete shall be used in handrail and posts.
 The concrete floor slab shall be finished in accordance with Article 51.19 of the Standard Specifications.
 Slope walls shall be reinforced with welded wire fabric 6" x 6" mesh, #4 wires, weighing 58# per 100 sq. ft.
 Layout of slope walls may be varied to suit ground conditions in the field, as directed by the Engineer.
 Rivets 3/8", Open holes 1/2", unless noted.
 Field connections riveted, unless noted.
 Railings shall be adjusted to true alignment after curbs have been poured.
 All rockers, bearing plates, lead plates, pinches and anchor bolts shall be fabricated and set in accordance with Article 51.15 of the Standard Specifications and are included in quantity of Structural Steel.
 Anchor bolts shall be set before riveting diaphragms over supports.
 Expansion guards shall be fabricated and erected in accordance with Article 51.13(a) of the Standard Specifications.
 Expansion guards are included in quantity of Structural Steel.
 Except as otherwise provided, all structural steel shall receive one shop coat of red lead paint and two field coats of aluminum paint. See Articles 56.1 to 56.5 inclusive of the Standard Specifications.
 All paint shall be furnished and applied by the Contractor.
 The Contractor shall drive four (4) steel test piles in permanent locations, one at each Abutment and one at Piers 2 & 4 before order remainder of Piles.
 Course aggregate which is to be used in parapet handrails must be absolutely free of chert flint, limonite, lignite and soft sandstone.

SECTION 108B-1
 TOTAL BILL OF MATERIALS

Item	Unit	Super	Sub	Total
Class X Concrete	Cu. Yds.	430.4	92.0	522.4
Class A Concrete	Cu. Yds.	6025	6015	
Handrail Concrete	Cu. Yds.	28,007,520	28	
Reinforcement Bars	Lbs.	483,240	34,990	518,230
Erecting Struct. Steel	Lbs.	474,820		474,820
Aluminum Handrail	Lm. Ft.	822		822
Name Plates	Each	1		1
Class A Excavation for Struct.	Cu. Yds.		1282	1282
Class B Excavation for Struct.	Cu. Yds.		239	239
Borrow Excavation	Cu. Yds.		11,850	11,850
Slope Wall	Sq. Yds.		1623	1623
Crossed Piles	Lm. Ft.		300	300
Test Piles (BBP36)	Each		4	4
Steel Piles (BBP36)	Lm. Ft.		7605	7605

Furnish Struct. Steel LBS. 483,240 484,820

WATERWAY INFORMATION

Drainage Area ----- 145,000 Acres
 Character ----- Rolling & Wooded
 Required Opening (30Y-FW) ----- 4,150 Sq. Ft.
 Present Opening ----- 4,520 Sq. Ft.
 Proposed Opening ----- 4,150 Sq. Ft.

DESIGN STRESSES

Pc - 1400 psi. Superf. Sub
 Pk - 75 psi. Footings
 Ps - 20,000 psi. Reinft.
 Pz - 10,000 psi. Struct.
 n = 10

LOADING H20-510-44

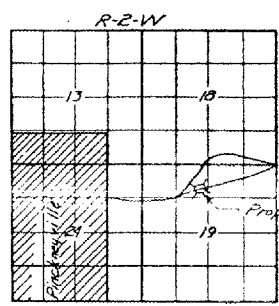

LOCATION MAP

DESIGNED *Ernst W. Boddt*
 CHECKED L. D. Winn
 DRAWN E.W.B. F. Bahr
 CHECKED L.D.W.

EXAMINED *M. J. ...*
 PASSED *E. ...*
 APPROVED *R. ...*

FOR INFORMATION ONLY:
 BRIDGE NO. 1 STRUCTURE 073-0015

PROJ. F-118(3)
 BEAUCOUP CREEK
 S.B.I. RT. 154 SEC. 108(B-1, F-1)
 PERRY COUNTY
 STA. 39+98

Revised 11/15/51 in ELEVATION & PLAN Embankments according to new policy
 AT W. Abut. Quantity of Embankment chgd. from 3770 Cu. Yds. to 5720 Cu. Yds.
 Borrow Excav. from 4710 Cu. Yds. to 6710 Cu. Yds. at 2' depth. Quantity of Embankment chgd.
 Revised 4-21-60: Class X Conc. Reinf. Bars Quantities R.R.P.
 Rev. 2-7-61 TOTAL BILL OF MATERIALS, GENERAL NOTES W.S.
 Revised 5/3/62 Reinf. Bars Quantities R.A.Z.