

FINAL SURVEY NO.	SURVEYED BY	DATE
NOTE BOOK NO.	PLOTTED TEMPLATE AREAS CHECKED	

ORIGINAL SURVEY NO.	SURVEYED BY	DATE
NOTE BOOK NO.	PLOTTED TEMPLATE AREAS CHECKED	

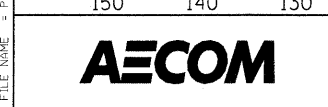
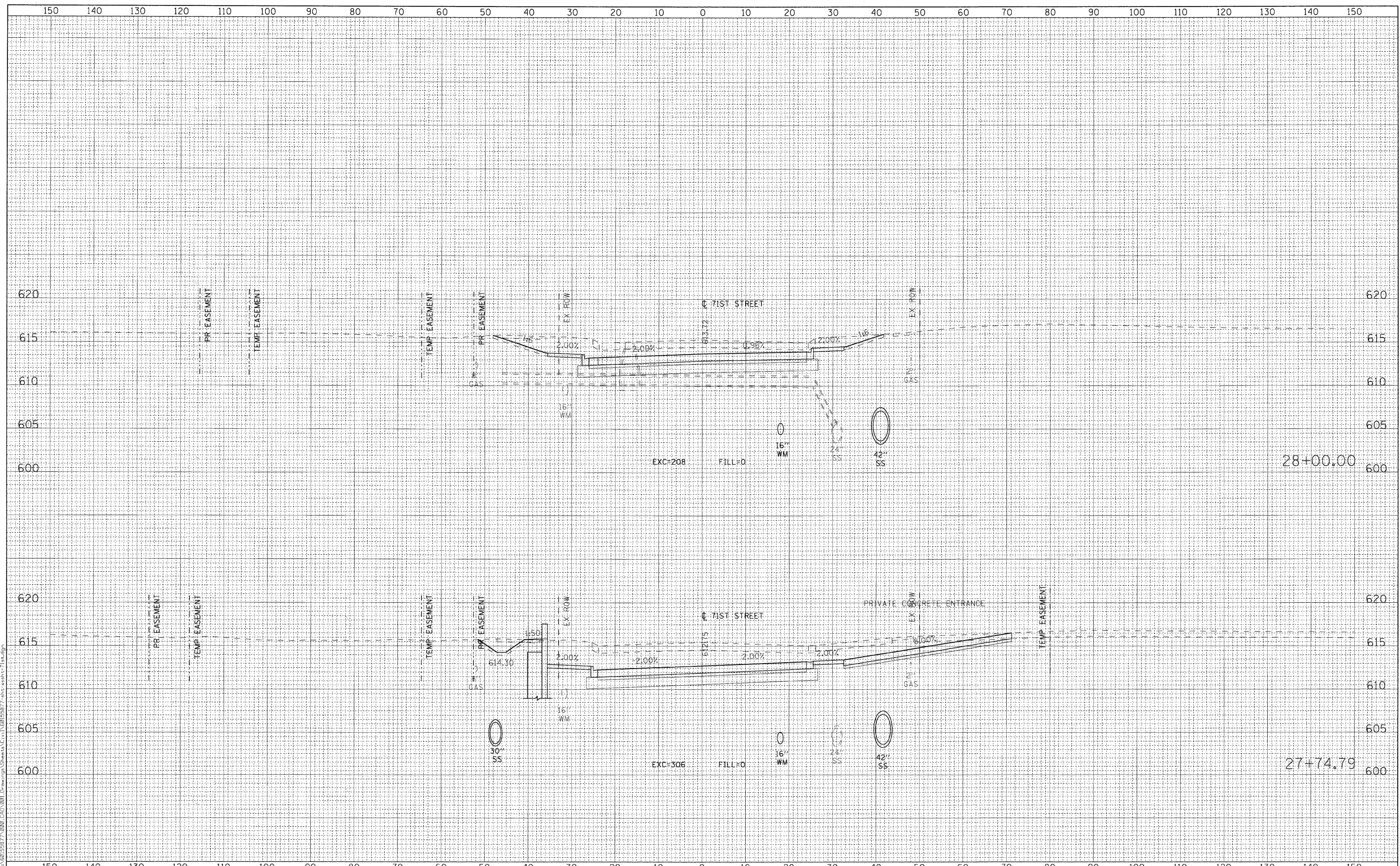

USER NAME = hslimann	DESIGNED - NJH	REVISED -
PLOT SCALE = 10.000' / IN.	DRAWN - NJH	REVISED -
PLOT DATE = 1/6/2011	CHECKED - TJW	REVISED -
	DATE - DECEMBER 12, 2010	REVISED -

**STATE OF ILLINOIS  
DEPARTMENT OF TRANSPORTATION**

<b>CROSS SECTIONS - 71ST STREET</b>	
H <sub>v</sub> 1"=10', V <sub>v</sub> 1"=5'	SHEET NO. 15 OF 20 SHEETS
STA. 27+74.79	TO STA. 28+00.00

F.A.U. RTE.	SECTION	COUNTY	TOTAL SHEETS	SHEET NO.
1537	06-00050-00-GA	COOK	209	196
CONTRACT NO. 63556			ILLINOIS FED. AID PROJECT	

FILE NAME = P:\6015687\000 CAD\001 Drawings\Sheet\Civil\60156877-dts-ss-st-71st.dgn