

INDEX OF SHEETS

| SHEET NO. | DESCRIPTION |
|-----------|---|
| 1 | TITLE SHEET & SUMMARY OF QUANTITIES |
| 2 | PLAN & PROFILE, TYPICAL SECTIONS, GENERAL NOTES & STONE RIPRAP DITCH DESIGN |
| 3-4 | ROADWAY CROSS SECTIONS |
| 5-13 | BRIDGE DESIGN |

THE FOLLOWING STANDARDS ARE A PART OF THESE PLANS AND ARE INCLUDED IN THE PROPOSAL:

| | |
|-------------|--|
| 000001-06 | STANDARD SYMBOLS, ABBREVIATIONS & PATTERNS |
| 280001-05 | TEMPORARY EROSION CONTROL SYSTEMS |
| 515001-03 | NAME PLATE FOR BRIDGES |
| 701901-01 | TRAFFIC CONTROL DEVICES |
| B.L.R. 21-8 | TYPICAL APPLICATION OF TRAFFIC CONTROL DEVICES FOR CONSTRUCTION ON RURAL LOCAL HIGHWAYS |
| B.L.R. 22-6 | TYPICAL APPLICATION OF TRAFFIC CONTROL DEVICES FOR CONSTRUCTION ON RURAL LOCAL HIGHWAYS (TWO-LANE TWO-WAY RURAL TRAFFIC) (ROAD CLOSED TO THRU TRAFFIC) |

SUMMARY OF QUANTITIES

| CODE NO. | ITEM | UNIT | QUANTITY |
|------------|---|-------|----------|
| 20200100 | EARTH EXCAVATION | CU YD | 1029.00 |
| 20300100 | CHANNEL EXCAVATION | CU YD | 226.00 |
| 20400800 | FURNISHED EXCAVATION | CU YD | 48.00 |
| 28000305 | TEMPORARY DITCH CHECKS | FOOT | 7.00 |
| 28001000 | AGGREGATE (EROSION CONTROL) | TON | 9.00 |
| 28100807 | STONE DUMPED RIPRAP, CLASS A4 | TON | 506.00 |
| 28200200 | FILTER FABRIC | SQ YD | 300.00 |
| 40200800 | AGGREGATE SURFACE COURSE, TYPE B | TON | 300.00 |
| 50100100 | REMOVAL OF EXISTING STRUCTURES | EACH | 1.00 |
| 50300225 | CONCRETE STRUCTURES | CU YD | 22.20 |
| 50300280 | CONCRETE ENCASEMENT | CU YD | 2.80 |
| 50400405 | PRECAST PRESTRESSED CONCRETE DECK BEAMS (21" DEPTH) | SO FT | 1320.00 |
| 50800105 | REINFORCEMENT BARS | POUND | 2430.00 |
| Δ 50900205 | STEEL RAILING, TYPE S1 | FOOT | 105.00 |
| 51201400 | FURNISHING STEEL PILES 10X42 | FOOT | 520.00 |
| 51202305 | DRIVING PILES | FOOT | 520.00 |
| 51500100 | NAME PLATES | EACH | 1.00 |
| * 67100100 | MOBILIZATION | L SUM | 1.00 |
| X2501000 | SEEDING, CLASS 2 (SPECIAL) | ACRE | 0.50 |

Δ SPECIALTY ITEMS

DESIGN DESIGNATION:
 DESIGN SPEED: 30 MPH
 HIGHWAY CLASS - LOCAL ROAD
 EXISTING STRUCTURE NO.: 097-3095
 PROPOSED STRUCTURE NO.: 097-3266
 CURRENT A.D.T. = 80
 CONTRACT NO. 99430

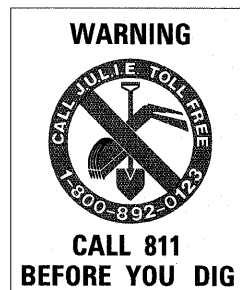

STATE OF ILLINOIS DEPARTMENT OF TRANSPORTATION DIVISION OF HIGHWAYS

PLANS FOR PROPOSED HIGHWAY BRIDGE PROGRAM

T.R. 235 WHITE COUNTY SECTION 08-04126-00-BR

PROJECT NO. BROS-193(043) JOB NO. C-99-520-09

CONTRACT # 99430 SEVEN MILE CREEK TRIBUTARY

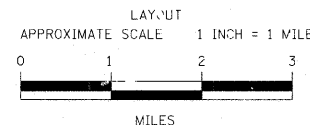
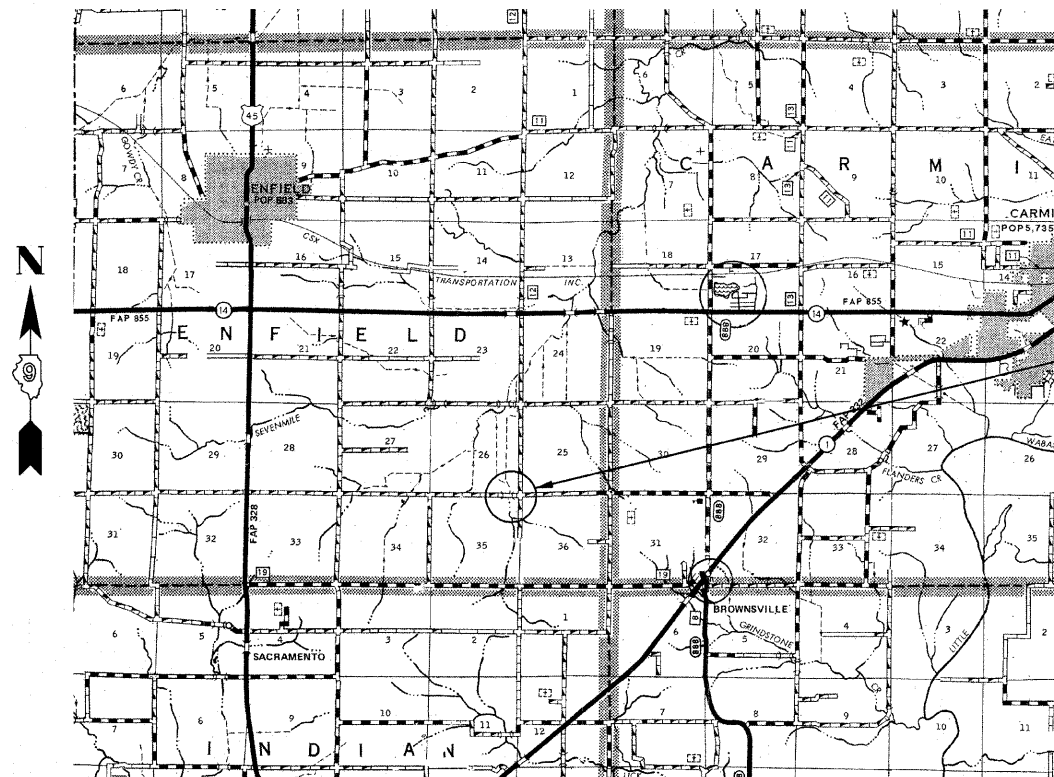

| | | |
|--------------|-----------|-------------|
| GROSS LENGTH | 500.00 FT | 0.095 MILES |
| OMISSIONS | 0.00 FT | 0.000 MILES |
| NET LENGTH | 500.00 FT | 0.095 MILES |

| TR | SECTION | COUNTY | TOTAL SHEETS | SHEET NO. |
|-----|----------------|--------|--------------|-----------|
| 235 | 08-04126-00-BR | WHITE | 13 | 1 |

FED. ROAD DIST. NO. 9 ILLINOIS FED. AID PROJECT
 PROJECT # BROS-193(043) CONTRACT # 99430
 JOB # C-99-520-09 SEVEN MILE CREEK TRIBUTARY
 LEC JOB # H091004WH

323 W. 3RD ST.
 P.O. BOX 160
 MT. CARMEL, IL 62863
 PHONE: (618)-262-8651
 FAX: (618)-263-3327

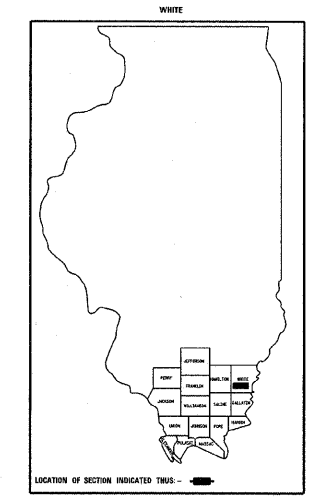

PROFESSIONAL DESIGN FIRM
 LAND SURVEY & PROFESSIONAL ENGINEERING CORPORATION
 184-00887
 (62-032435)(35-002769)

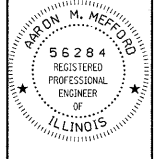

AARON M. MEFFORD
 NAME
 SIGNATURE
 DATE 10-28-10
 11-30-11 EXPIRES

| | | |
|---------------|----------|------------|
| PLAN | 1" = 50' | 0 50' 100' |
| PROFILE | 1" = 50' | 0 50' 100' |
| PROFILE VERT. | 1" = 5' | 0 5' 10' |
| CROSS SECTION | 1" = 5' | 0 5' 10' |

SECTION 08-04126-00-BR
 BEGINS STATION 2+50

STATION 5+00, STRUCTURE NO. 097-3266
 A 55' LONG SINGLE SPAN PRECAST PRESTRESSED CONCRETE DECK BEAM (21" DEPTH), 24' ROADWAY, 0.00% GRADE, 0° SKEW.

SECTION 08-04126-00-BR
 ENDS STATION 7+50

STATE OF ILLINOIS
 DEPARTMENT OF TRANSPORTATION

APPROVED 10/28/10
Brian A. Ray
 COUNTY ENGINEER

PASSED 12/7/2010
Dennis W. Hill
 ENGINEER OF LOCAL ROADS AND STREETS

RELEASING FOR BID
 BASED ON LIMITED REVIEW: 12/7/10
Mary C. Lamie
 MARY C. LAMIE, P.E.
 DEPUTY DIRECTOR OF HIGHWAYS
 REGION FIVE ENGINEER

T.R. 235
 OVER CREEK
 WHITE COUNTY, ILLINOIS

SHEET TITLE: TITLE SHEET

SCALE: VARIES

BY: AMM

DATE: 10/28/10

REV:

1 OF 13 SHEETS

SHEET NO. 1