

BENCHMARK: Iron Pin at Sta. 5+51.28, 7.63' Lt., Elev. 416.88

EXISTING STRUCTURE NO. 097-3095: 25' long single span concrete deck beam bridge with concrete caps, wood mudwalls and timber piling. Structure closed to traffic.

**GENERAL NOTES**

Layout of the slope protection system may be varied to suit ground conditions in the field as directed by the Engineer.  
 Reinforcement bars shall conform to the requirements of ASTM A 706 Gr 60. See Special Provisions.  
 Excavation required to construct the Abutments shall be included in the cost of Concrete Structures. No additional compensation will be allowed for Structure Excavation.  
 All proposed construction activities shall be in accordance with Nationwide Permit number 14 of the Department of the Army authorized under Section 404 of the Clean Water Act. The IEPA has issued Section 401 Water Quality Certification for this activity. See Special Provisions for conditions.

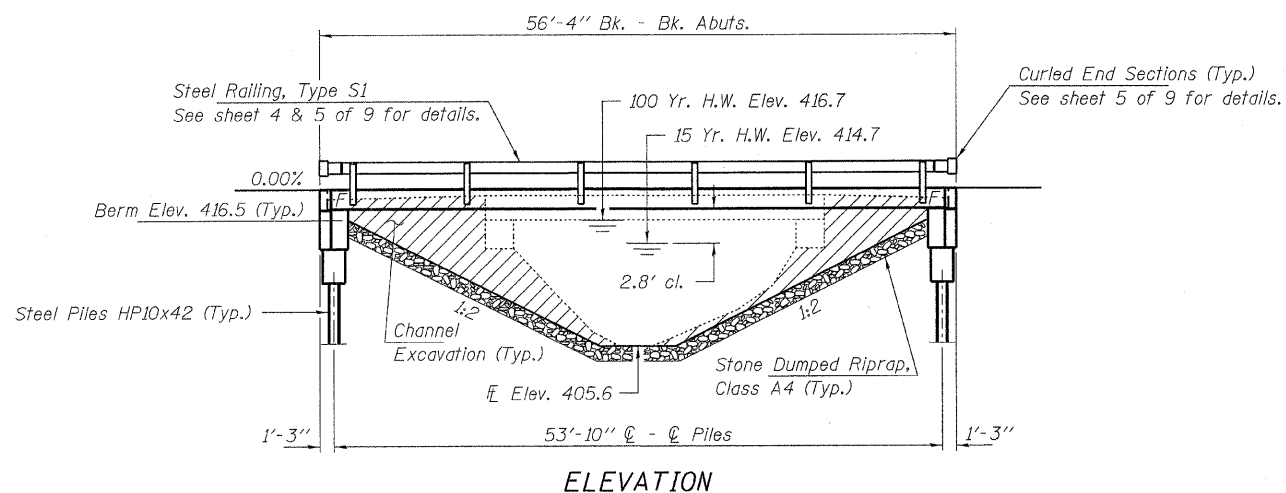

**ELEVATION**

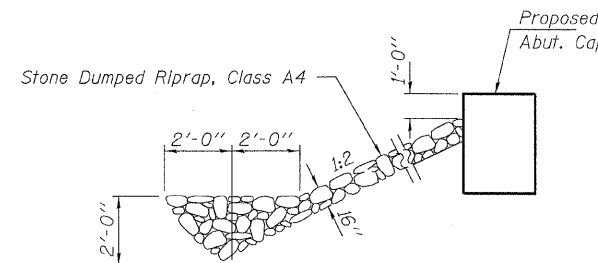

**SECTION A-A**

Note: See Special Provisions for Stone Dumped Riprap, Class A4.

**INDEX OF STRUCTURE SHEETS**

1. General Plan & Elevation
2. Superstructure
- 3.-4. Superstructure Details
5. Steel Railing, Type S-1
6. Abutments
7. HP Pile Details
- 8.-9. Borings

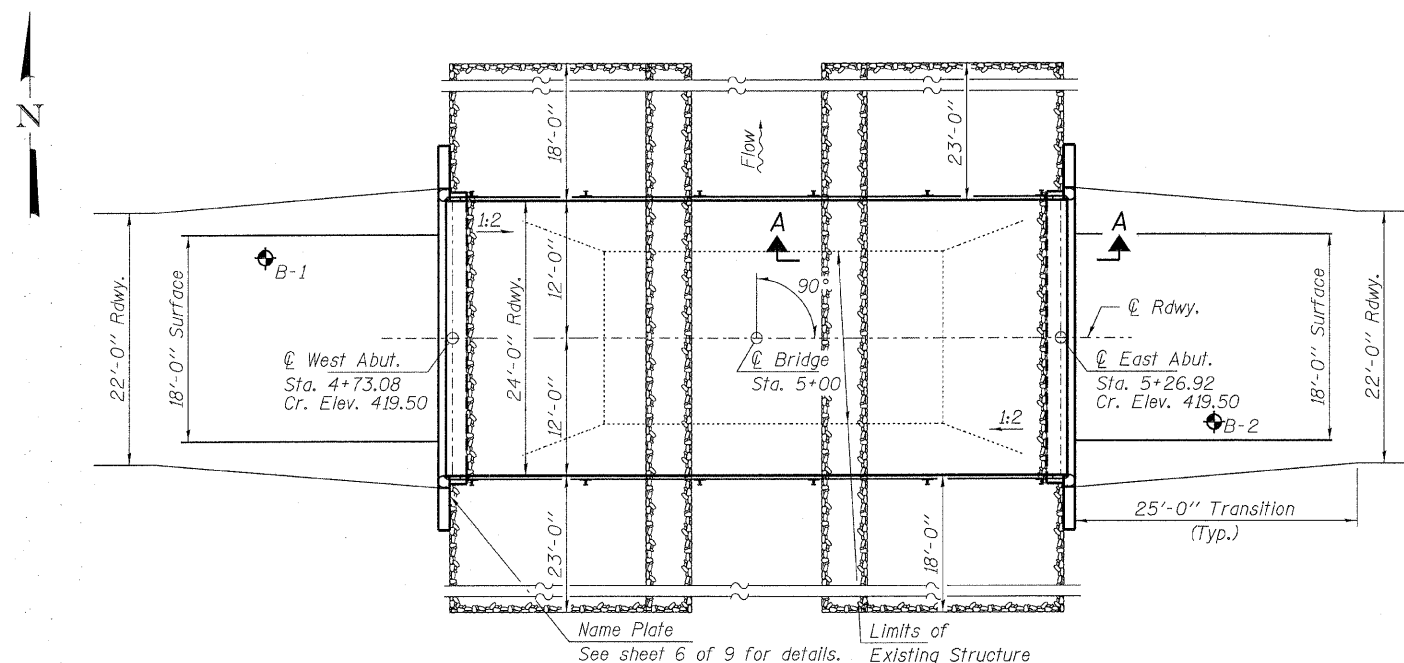

**PLAN**

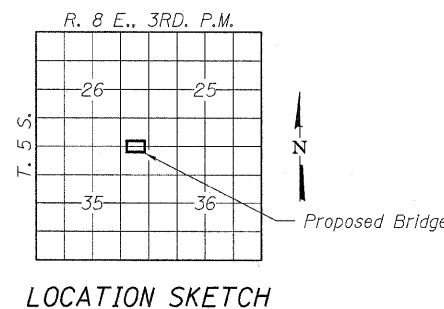

**LOCATION SKETCH**

BUILT 20\_\_ BY  
 WHITE COUNTY  
 SEC. 08-04126-00-BR  
 ENFIELD ROAD DISTRICT  
 STR. NO. 097-3266  
 LOADING HL-93

**NAME PLATE**  
 See Std. 515001

**DESIGN STRESSES**

**FIELD UNITS**

f'c = 3,500 psi  
 fy = 60,000 psi (Reinf.)

**PRECAST PRESTRESSED UNITS**

f'c = 6,000 psi  
 f'ci = 5,000 psi  
 fpu = 270,000 psi (1/2" low lax. strands)  
 fpbt = 201,960 psi (1/2" low lax. strands)  
 fy = 60,000 psi (Reinf.)

**LOADING HL-93**

Design Specifications: 2007 AASHTO LRFD with all applicable Interims.  
 50#/Sq. Ft. included in dead load for future wearing surface.

**SEISMIC DATA**

Seismic Performance Zone (SPZ) = 3  
 Design Spectral Acceleration at 1.0 sec. (SD1) = 0.459g  
 Design Spectral Acceleration at 0.2 sec. (SDS) = 0.866g  
 Soil Site Class = E

**WATERWAY INFORMATION**

Drainage Area = 1.9 Sq. Mi.		Existing Low Grade Elev. 416.2 @ Sta. 8+00		Proposed Low Grade Elev. 416.2 @ Sta. 8+00		
Flood	Freq. Yr.	Q C.F.S.	Opening Exist.	Opening Prop.	Head - Ft. H.W.E. Exist. Prop.	Headwater El. Exist. Prop.
Design	15	1111	160	235	414.7	0.1 414.8
Base	100	1960	212	332	416.7	1.1 417.8
Max. Calc.	500					416.9

I certify that to the best of my knowledge, information and belief, this bridge design is structurally adequate for the design loading shown on the plans. The design is an economical one for the style of structure and complies with requirements of the current "AASHTO LRFD Specifications."

*Steven W. Megginson* 10/12/2010  
 ILLINOIS STRUCTURAL NO. 081-6084 Expires 11-30-2012

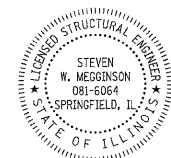

**TOTAL BILL OF MATERIAL**

ITEM	UNIT	SUPER	SUB	TOTAL
Channel Excavation	Cu. Yd.			226
Stone Dumped Riprap, Class A4	Ton			320
Removal of Existing Structures	Each			1
Concrete Structures	Cu. Yd.		22.2	22.2
Concrete Encasement	Cu. Yd.		2.8	2.8
Precast Prestressed Concrete Deck Beams (21" Depth)	Sq. Ft.	1,320		1,320
Reinforcement Bars	Pound		2,430	2,430
Steel Railing, Type S1	Foot	105		105
Furnishing Steel Piles HP10x42	Foot		520	520
Driving Piles	Foot		520	520
Name Plates	Each		1	1

FILE NAME = 090858-shr-bridge.dgn	USER NAME =	DESIGNED - A.S.L.	REVISED - 01/18/10
HAMPTON, LENZINI AND RENWICK, INC. 3083 STEVENSON DRIVE, SUITE 201 SPRINGFIELD, ILLINOIS 62793 ILLINOIS PROFESSIONAL DESIGN FIRM L/S / P/E / SE CORP. 184-000959	PLOT SCALE =	CHECKED - S.W.M.	REVISED -
PLOT DATE = 10/12/2010		DRAWN - D.T.M.	REVISED -
		CHECKED - S.W.M.	REVISED -

STATE OF ILLINOIS  
 WHITE COUNTY HIGHWAY DEPARTMENT

GENERAL PLAN & ELEVATION  
 STRUCTURE NO. 097-3266

SHEET NO. 1 OF 9 SHEETS

T.R.	SECTION	COUNTY	TOTAL SHEETS	SHEET NO.
235	08-04126-00-BR	WHITE	13	5
ENFIELD ROAD DISTRICT			CONTRACT NO. 99430	
ILLINOIS FED. AID PROJECT				