

F.A.P. RTE.	SECTION	COUNTY	TOTAL SHEETS	SHEET NO.
614	(141,143)RS-5	MASON	40	1
FED. ROAD DIST. NO.		ILLINOIS	CONTRACT NO. 72835	

STATE OF ILLINOIS  
DEPARTMENT OF TRANSPORTATION  
DIVISION OF HIGHWAYS  
**PROPOSED  
HIGHWAY PLANS**

FAP ROUTE 614 (IL 78)  
SECTION (141,143)RS-5  
PROJECT: *ESP-0614(030)*  
MASON COUNTY  
C-96-044-09

FOR INDEX OF SHEETS, SEE SHEET NO. 2

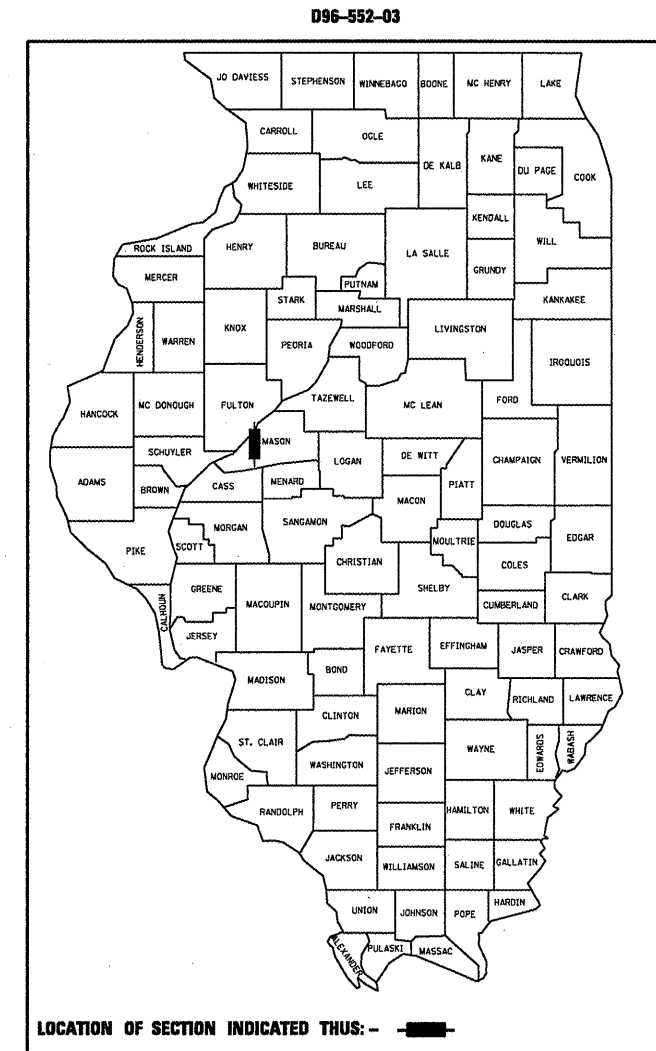

AVERAGE DAILY TRAFFIC = 1800 (2007)  
PV= 1530  
SU= 144  
MU= 126

STATE OF ILLINOIS  
DEPARTMENT OF TRANSPORTATION  
DIVISION OF HIGHWAYS

SUBMITTED *February 6, 2009*  
*Roger Z. Jankell*  
DISTRICT ENGINEER

*March 13, 2009*  
*Charles G. Ingersoll*  
ENGINEER OF DESIGN AND ENVIRONMENT

*March 13, 2009*  
*Christine M. Reed*  
DIRECTOR, DIVISION OF HIGHWAYS

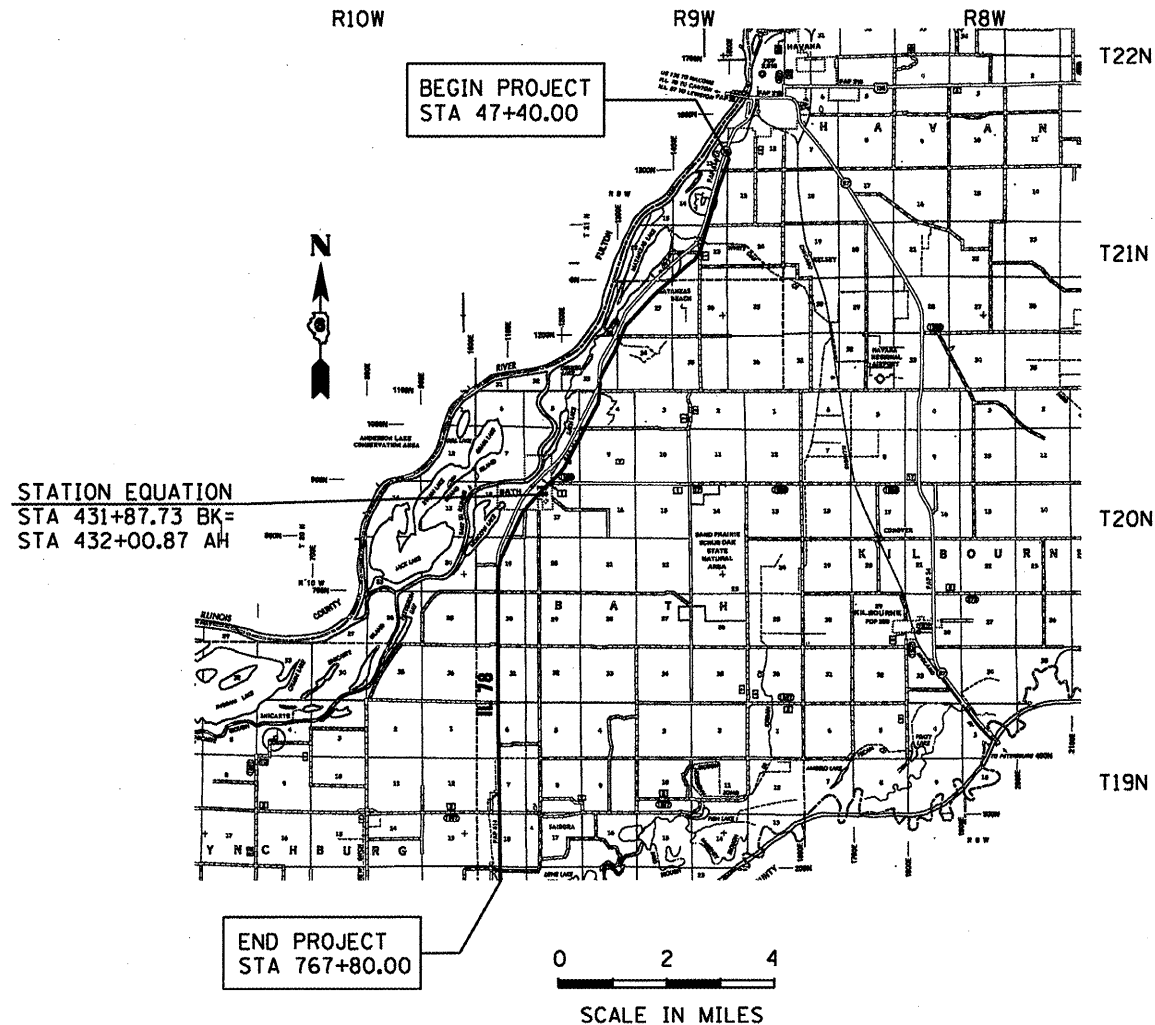

STATION EQUATION  
STA 431+87.73 BK=  
STA 432+00.87 AH

NET LENGTH OF PROJCT = 72,026.86 FT = 13.64 MI.  
GROSS LENGTH OF PROJECT = 72,026.86 FT = 13.64 MI.

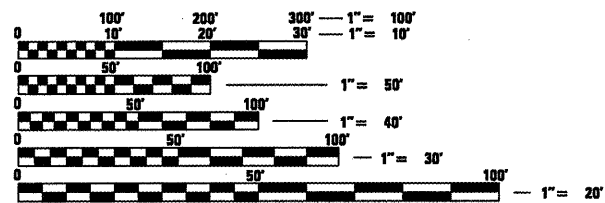

FULL SIZE PLANS HAVE BEEN PREPARED USING STANDARD ENGINEERING SCALES. REDUCED SIZED PLANS WILL NOT CONFORM TO STANDARD SCALES. IN MAKING MEASUREMENTS ON REDUCED PLANS, THE ABOVE SCALES MAY BE USED.

J.U.L.I.E.  
JOINT UTILITY LOCATION INFORMATION FOR EXCAVATION  
1-800-992-0123  
OR 811

PROJECT ENGINEER: JOHN NEGANGARD, PE  
PHONE NUMBER: (217) 782-6990  
SQUAD LEADER: MARK DUST, PE  
PHONE NUMBER: (217) 785-0597  
CONTRACT NO. 72835

**PRINTED BY THE AUTHORITY  
OF THE STATE OF ILLINOIS**