

PLAN
 REVISIONS
 DATE
 DRAWN BY
 CHECKED BY
 PROJECT NO.

PROFILE
 REVISIONS
 DATE
 DRAWN BY
 CHECKED BY
 PROJECT NO.

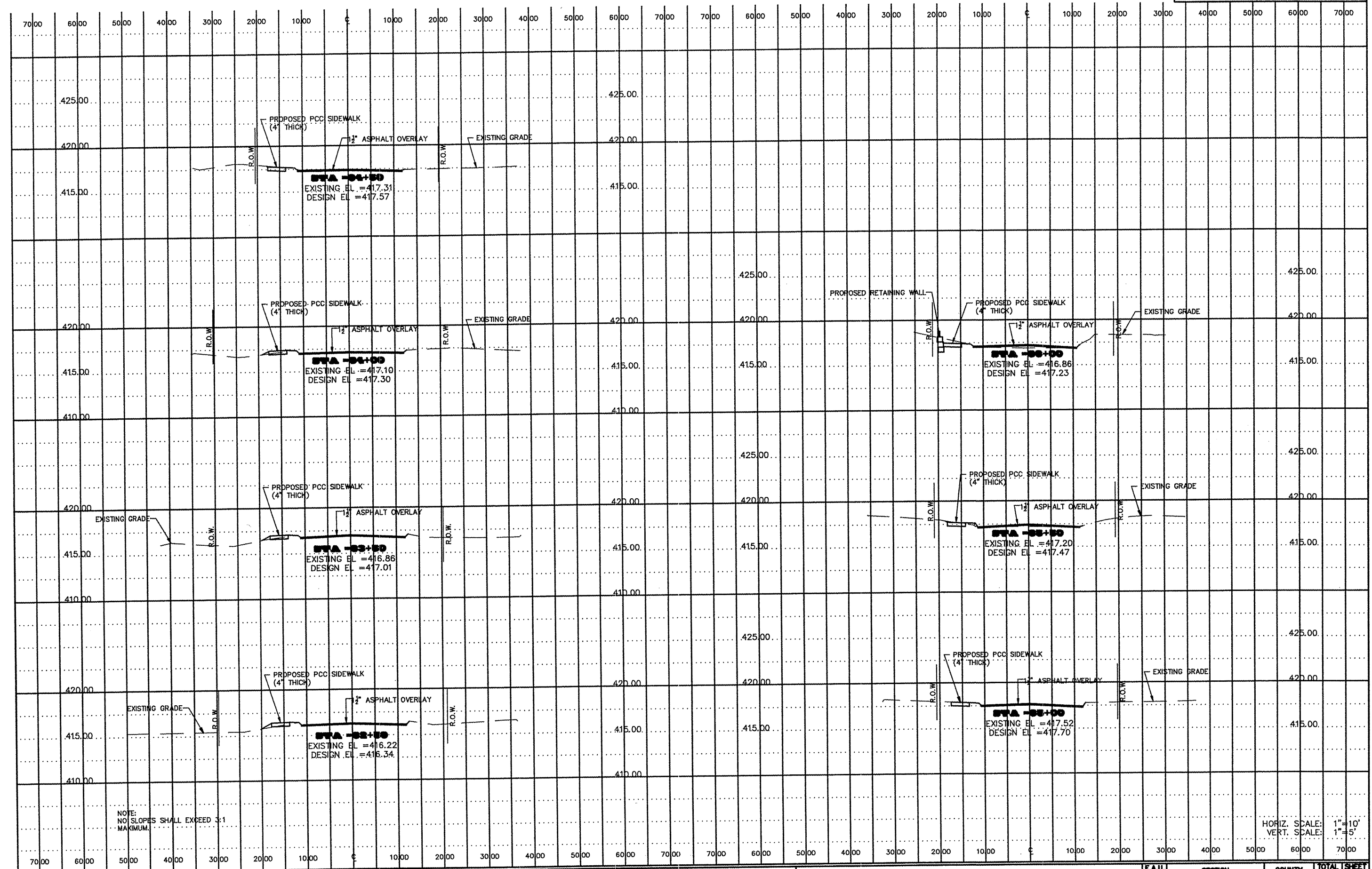

NOTE:
 NO SLOPES SHALL EXCEED 3:1
 MAXIMUM.

HORIZ. SCALE: 1"=10'
 VERT. SCALE: 1"=5'

FILE NAME: #P1415	USER NAME: #JWBRS	DESIGNED: KJW	REVISED: --
		DRAWN: JMA	REVISED: --
		CHECKED: --	REVISED: --
		DATE: 6-24-09	REVISED: --

**CITY OF CENTERVILLE
 CHURCH ROAD RESURFACING**

SCALE: 1"=20'	SHEET NO. 34 OF 36 SHEETS	STA. 62+50 TO STA. 66+00
---------------	---------------------------	--------------------------

F.A.U. RTE. 9202	SECTION 09-00016-00 RS	COUNTY ST. CLAIR	TOTAL SHEETS 36	SHEET NO. 34
FED. ROAD DIST. NO. - ILLINOIS			FED. AID PROJECT	