

PIPE UNDERDRAINS, FABRIC LINED TRENCH 4"						
UP STATION	DOWN STATION	RUN LOCATION	P UNDR FAB LINE TR 4 (FT)	DEPTH (IN)	OUTLET STRUCTURE NO.	NOTES
3350+52	3351+68	LT	116		301	
3350+52	3351+68	RT	116		302	
3351+72	3352+84	LT	112		303	
3351+72	3352+84	RT	112		304	
3352+99	3352+88	LT	11		303	
3352+99	3352+88	RT	11		304	
3353+03	900+43	LT	30		308	IL 59 / ARNOLD ST.
3354+28	3353+03	RT	125		306	
3355+00	900+80	LT	130		310	IL 59 / ARNOLD ST.
3355+72	99+67	LT	22		312	IL 59 / OAK ST.
3355+72	3354+31	RT	141		311	
3356+28	3355+76	LT	52		315	
3356+28	3355+76	RT	52		314	
3352+86		ACROSS	6		303	
3352+86		ACROSS	36		304	
SUBTOTAL			1072			

PIPE UNDERDRAINS, FABRIC LINED TRENCH 4"						
UP STATION	DOWN STATION	RUN LOCATION	P UNDR FAB LINE TR 4 (FT)	DEPTH (IN)	OUTLET STRUCTURE NO.	NOTES
3766+02	3767+21	LT	119		405	
3766+01	3767+21	RT	120		406	
3767+25	3768+07	LT	82		410	
3768+20	3768+11	LT	9		410	
3769+00	3768+24	LT	76		411	
3769+00	3768+23	RT	77		412	
3768+09		ACROSS	35		410	
3765+69	3765+98	LT	30		402	
3765+69	3765+99	RT	30		403	
SUBTOTAL			578			
SHT. TOTAL			1650			
TOTAL			6174			

LEGEND

—●— PIPE UNDERDRAINS, FABRIC LINED TRENCH 4"

▨ 6" DEEP UNDERCUT AREA
SEE CROSS SECTIONS FOR DETAILS

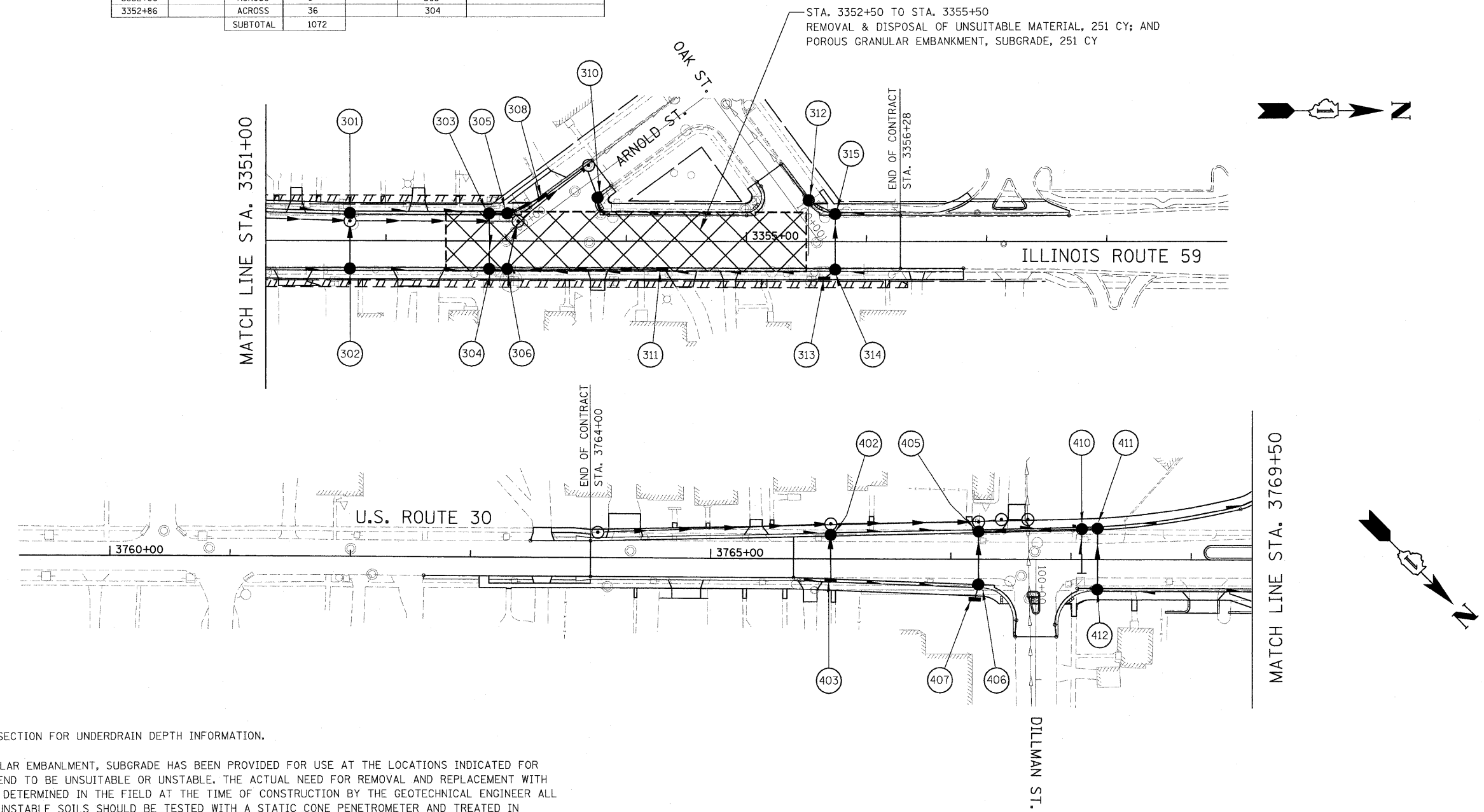

STA. 3352+50 TO STA. 3355+50
REMOVAL & DISPOSAL OF UNSUITABLE MATERIAL, 251 CY; AND
POROUS GRANULAR EMBANKMENT, SUBGRADE, 251 CY

- NOTES:**
- SEE TYPICAL SECTION FOR UNDERDRAIN DEPTH INFORMATION.
 - POROUS GRANULAR EMBANKMENT, SUBGRADE HAS BEEN PROVIDED FOR USE AT THE LOCATIONS INDICATED FOR SOILS THAT TEND TO BE UNSUITABLE OR UNSTABLE. THE ACTUAL NEED FOR REMOVAL AND REPLACEMENT WITH PGES WILL BE DETERMINED IN THE FIELD AT THE TIME OF CONSTRUCTION BY THE GEOTECHNICAL ENGINEER ALL POTENTIALLY UNSTABLE SOILS SHOULD BE TESTED WITH A STATIC CONE PENETROMETER AND TREATED IN ACCORDANCE WITH ARTICLE 301.04 AND THE IDOT SUBGRADE STABILITY MANUAL (Rev. 2005) IF UNSTABLE AND/OR UNSUITABLE MATERIAL IS NOT ENCOUNTERED, THEN THE QUANTITY SHALL BE DEDUCTED AND NO ADDITIONAL COMPENSATION WILL BE DUE TO THE CONTRACTOR.

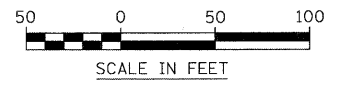

FILE NAME =	USER NAME = #USER#	DESIGNED - PJO	REVISED -	STATE OF ILLINOIS DEPARTMENT OF TRANSPORTATION	PIPE UNDERDRAINS AND UNDERCUT PLAN	F.A. RTE. 338	SECTION 113 N-2	COUNTY WILL	TOTAL SHEETS 260	SHEET NO. 115
#FILEL#	PLOT SCALE = #SCALE#	CHECKED - JCM	REVISED -			CONTRACT NO. 60E73				
	PLOT DATE = #DATE#	DATE - JANUARY 16, 2009	REVISED -			FED. ROAD DIST. NO. ILLINOIS FAP 338 (IL RTE. 59)				
						SCALE: AS SHOWN	SHEET NO. 2 OF 2 SHEETS	STA. 3327+30 TO STA. 3356+28 (IL 59)		