

FAP RTE.	SECTION	COUNTY	TOTAL SHEETS	SHEET NO.
331	3-2, BX-1, 4-2	SALINE	220	6
STA.		TO STA.		
FED. ROAD DIST. NO.		ILLINOIS	FED. AID PROJECT	

**SUMMARY OF QUANTITIES**  
**US 45 - IL 13 RELOCATION - CONTRACT 6**

CODE NUMBER	DESCRIPTION	UNIT	TOTAL QUANTITY	SALINE URBAN				CULVERT SN083-2013
				ROAD FOUR LANE	BRIDGE SN 083-0060	BRIDGE SN 083-2020	TRAFFIC SIGNAL	
44000100	PAVEMENT REMOVAL	SQ YD	32,316	32,316				
44000155	HOT-MIX ASPHALT SURFACE REMOVAL, 1 1/2"	SQ YD	9,051	9,051				
44000200	DRIVEWAY PAVEMENT REMOVAL	SQ YD	2,091	2,091				
44000500	COMBINATION CURB AND GUTTER REMOVAL	FOOT	995	995				
44002805	ISLAND REMOVAL	SQ FT	322	322				
44004250	PAVED SHOULDER REMOVAL	SQ YD	11,448	11,448				
48101200	AGGREGATE SHOULDERS, TYPE B	TON	1,349	1,349				
48203029	HOT-MIX ASPHALT SHOULDERS, SUPERPAVE 8"	SQ YD	24,586	24,586				
50100100	REMOVAL OF EXISTING STRUCTURES	EACH	3	2	1			
50104400	CONCRETE HEADWALL REMOVAL	EACH	1	1				
50105220	PIPE CULVERT REMOVAL	FOOT	776	776				
50200100	STRUCTURE EXCAVATION	CU YD	359		359			
50300100	FLOOR DRAINS	EACH	16		16			
50300225	CONCRETE STRUCTURES	CU YD	695.0		695.0			
50300255	CONCRETE SUPERSTRUCTURE	CU YD	809.5		809.5			
50300260	BRIDGE DECK GROOVING	SQ YD	2,078		2,078			
50300280	CONCRETE ENCASEMENT	CU YD	51.2		51.2			
50300300	PROTECTIVE COAT	SQ YD	2,556		2,556			
50500105	FURNISHING AND ERECTING STRUCTURAL STEEL	L SUM	1		1			
50500505	STUD SHEAR CONNECTORS	EACH	4,464		4,464			
50800205	REINFORCEMENT BARS, EPOXY COATED	POUND	316,230		255,890			60,340
50800515	BAR SPLICERS	EACH	242		242			
51201800	FURNISHING STEEL PILES HP 14x73	FOOT	6,356		6,356			
51202305	DRIVING PILES	FOOT	6,356		6,356			
51203800	TEST PILE STEEL HP 14x73	EACH	2		2			
51500100	NAME PLATES	EACH	3		1			1
52000110	PREFORMED JOIN STRIP SEAL	FOOT	242		242			
52100020	ELASTOMERIC BEARING ASSEMBLY, TYPE II	EACH	12		12			
52100520	ANCHOR BOLTS 1"	EACH	24		24			
52100530	ANCHOR BOLTS 1 1/4"	EACH	48		48			
52100540	ANCHOR BOLTS 1 1/2"	EACH	24		24			
54001000	BOX CULVERT END SECTION	EACH	6					
54002020	EXPANSION BOLTS 3/4 INCH	EACH	174					114
54011103	PRECAST CONCRETE BOX CULVERT 11'X3'	FOOT	384		384			
54003000	CONCRETE BOX CULVERTS	CU YD	260					260
54213657	PRECAST REINFORCED CONCRETE FLARED END SECTIONS 12"	EACH	6	6				
54213663	PRECAST REINFORCED CONCRETE FLARED END SECTIONS 18"	EACH	6	6				
54213666	PRECAST REINFORCED CONCRETE FLARED END SECTIONS 21"	EACH	8	8				
54213669	PRECAST REINFORCED CONCRETE FLARED END SECTIONS 24"	EACH	15	15				
54213687	PRECAST REINFORCED CONCRETE FLARED END SECTIONS 42"	EACH	2	2				
54213693	PRECAST REINFORCED CONCRETE FLARED END SECTIONS 48"	EACH	2	2				

CHECKED BY: BWM PLOT DATE: 2/4/2009  
 DRAWN BY: DMS PLOT SCALE: 1/4"=8'-0"

M:\PROJECTS\PROJ1526\ROADWAY\COMMON\  
 Active File: S:\02\3526\05.dgn

Rev. 4-16-09

Rev.

FAP RTE.	SECTION	COUNTY	TOTAL SHEETS	SHEET NO.
331	3-2, 8X-1, 4-2	SALINE	220	9
STA.		TO STA.		
FED. ROAD DIST. NO.		ILLINOIS FED. AID PROJECT		

**SUMMARY OF QUANTITIES**  
**US 45 - IL 13 RELOCATION - CONTRACT 6**

COUNTY: SALINE  
 LOCATION: URBAN  
 CONSTRUCTION TYPE CODE: 1000-2A X081-2A X028-2A Y031-1F  
 FUNDING: 100% FED.

CODE NUMBER	DESCRIPTION	UNIT	TOTAL QUANTITY	ROAD FOUR LANE	BRIDGE SN 083-0060	BRIDGE SN 083-2020	TRAFFIC SIGNAL
* A2C022G3	TREE, CARYA ILLINOINENSIS (PECAN), CONTAINER GROWN, 3-GALLON	EACH	20	20			
* A2C023G3	TREE, CARYA OVATA (SHAGBARK HICKORY), CONTAINER GROWN, 3-GALLON	EACH	19	19			
* A2C021G3	TREE, CARYA LACINIOSA (SHELLBARK HICKORY), CONTAINER GROWN, 3-GALLON	EACH	19	19			
* A2C050G3	TREE, QUERCUS BICOLOR (SWAMP WHITE OAK), CONTAINER GROWN, 3-GALLON	EACH	19	19			
* A2C062G3	TREE, QUERCUS SHUMARDII (SHUMARD OAK), CONTAINER GROWN, 3-GALLON	EACH	19	19			
D2002960	EVERGREEN, PINUS STROBUS (EASTERN WHITE PINE), 5' HEIGHT, BALLED AND BURLAPPED	EACH	72	72			
* A2C000G3	TREE, QUERCUS PALUSTRIS (PIN OAK), CONTAINER GROWN, 3-GALLON	EACH	20	20			
* X0321984	SIGN LIGHTING UNIT COMPLETE	EACH	1	1			
X0322729	MATERIAL TRANSFER DEVICE	TON	6,591	6,591			
* X0322959	WEED CONTROL, NON-SELECTIVE AND NON-RESIDUAL (WETLAND)	GAL	80	80			
X0325613	REMOVE SURFACE MOUNT LANE SEPARATOR	FOOT	136	136			
X5020501	UNDERWATER STRUCTURE EXCAVATION PROTECTION - LOCATION 1	EACH	1		1		
X5020502	UNDERWATER STRUCTURE EXCAVATION PROTECTION - LOCATION 2	EACH	1		1		
X6700410	ENGINEERS FIELD OFFICE, TYPE A SPECIAL	CAL MO	18	18			
X0325240	TEMPORARY PAVEMENT 10.5"	SQ YD	5,644	5,644			
Z0000940	AGGREGATE FOR DRIVEWAY MAINTENANCE	TON	100	100			
Z0007601	BUILDING REMOVAL NO 1	L SUM	1	1			
Z0007602	BUILDING REMOVAL NO 2	L SUM	1	1			
Z0007603	BUILDING REMOVAL NO 3	L SUM	1	1			
Z0007604	BUILDING REMOVAL NO 4	L SUM	1	1			
Z0007605	BUILDING REMOVAL NO 5	L SUM	1	1			
Z0007606	BUILDING REMOVAL NO 6	L SUM	1	1			
Z0013798	CONSTRUCTION LAYOUT	L SUM	1	1			
Z0022800	FENCE REMOVAL	FOOT	1,045	1,045			
Z0030030	IMPACT ATTENUATORS (FULLY REDIRECTIVE, NARROW), TEST LEVEL 3	EACH	2	2			
Z0040530	PIPE UNDERDRAIN REMOVAL	FOOT	100	100			
* Z0049805	REMOVAL AND DISPOSAL OF FRIABLE ASBESTOS, BUILDING NO. 5	L SUM	1	1			
* Z0049901	REMOVAL AND DISPOSAL OF NON-FRIABLE ASBESTOS, BUILDING NO. 1	L SUM	1	1			
* Z0049903	REMOVAL AND DISPOSAL OF NON-FRIABLE ASBESTOS, BUILDING NO. 3	L SUM	1	1			
* Z0049905	REMOVAL AND DISPOSAL OF NON-FRIABLE ASBESTOS, BUILDING NO. 5	L SUM	1	1			
o Z0076600	TRAINEES	HOUR	1,000	1,000			
* X5011100	FOUNDATION REMOVAL	EACH	24	24			
X0301571	GATE, SPECIAL	EACH	1	1			
XX001472	WOOD BOLLARD	EACH	8	8			
XX006582	BRICK SIGN AND CONCRETE FOUNDATION REMOVAL	L SUM	1	1			
X0326337	DRAINAGE CONTROL STRUCTURE	EACH	1	1			
X0326334	EXCAVATE MINE SHAFT	EACH	2	2			
X0326336	CAP MINE SHAFT	EACH	2	2			
X0326338	SIGN STRUCTURE	LSUM	1	1			

o 4080  
 \* Specialty Items

Rev. 4-16-09

Rev.

CHECKED BY: BWM PLOT DATE: 2/4/2009  
 DRAWN BY: DMS PLOT SCALE: 1/4"=8'99"

M:\PROJECTS\PROJECTS\ROADWAY\COMMON\ACTIVE FILES  
 SUMMS-2526338.DGN

FAP R.E.	SECTION	COUNTY	TOTAL SHEETS	SHEET NO.
331	3-2, BX-1, 4-2	SALINE	220	10
STA.		TO STA.		
FED. ROAD DIST. NO.		ILLINOIS FED. AID PROJECT		

TYPICAL SECTIONS  
PROPOSED ILL. 13 RELOCATION

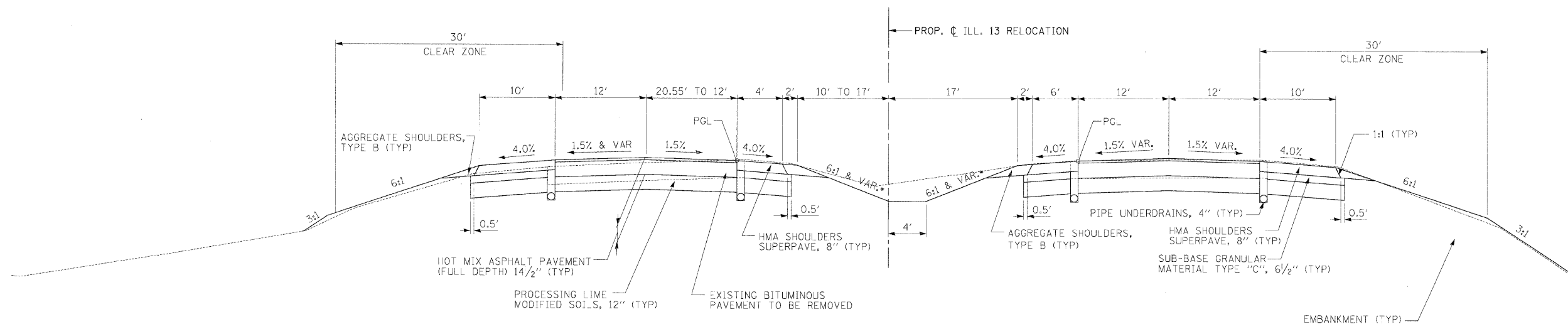

TO BE USED: STA. 949+03.45 TO 950+83.65

STRUCTURAL DESIGN TRAFFIC:	Year	2022			
PV = 25,670	SU =	545			
	MU =	545			
ROAD/STREET CLASSIFICATION:	Class	I			
PERCENT OF STRUCTURAL DESIGN TRAFFIC IN DESIGN LANE:					
P =	0.32	S =	0.45	M =	0.45
TRAFFIC FACTOR:	Actual TF =	4.27	AC Type =	AC-20	
SUBGRADE SUPPORT RATING:			FATR		

\* FOR SIDE SLOPES SEE CROSS-SECTIONS

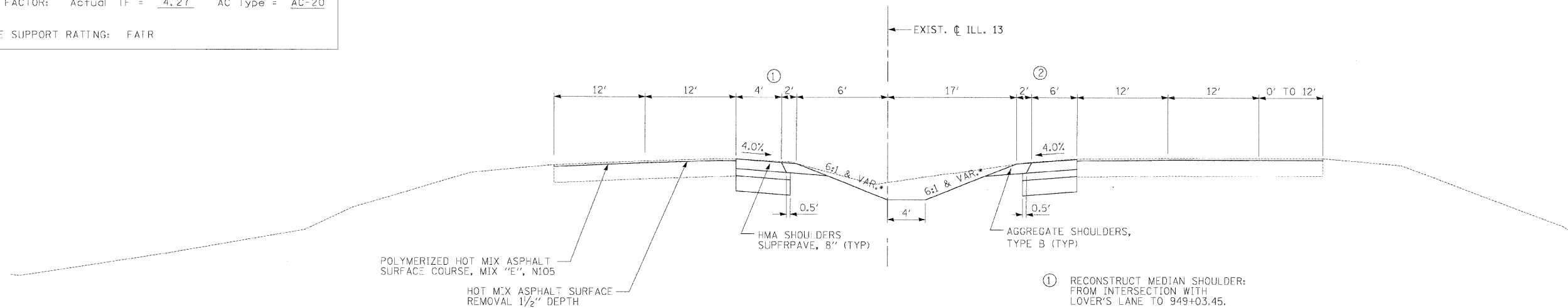

TO BE USED: STA. 949+00.00 TO 949+03.45

- ① RECONSTRUCT MEDIAN SHOULDER: FROM INTERSECTION WITH LOVER'S LANE TO 949+03.45.
- ② RECONSTRUCT MEDIAN SHOULDER AND REGRADE MEDIAN: FROM 941+00 TO INTERSECTION WITH LOVER'S LANE AND FROM INTERSECTION WITH LOVER'S LANE TO 949+03.45.

\* FOR SIDE SLOPES SEE CROSS-SECTIONS

MIXTURE REQUIREMENTS:  
THE FOLLOWING BITUMINOUS MIXTURE REQUIREMENTS ARE APPLICABLE TO THIS PROJECT:

LOCATIONS	MIXTURE USE	AC/PG	RAP% (MAX)	DESIGN AIR VOIDS	MIXTURE COMPOSITION	FRICION AGGREGATE
HOT MIX ASPHALT SURFACE COURSE	POLYMERIZED HOT-MIX ASPHALT SURFACE COURSE, MIX D, N105	SBS PG76-22	0	4.0% 105 GYRATIONS DESIGN	IL-9.5 MM OR IL-12.5 MM	D SURFACE Δ
HOT MIX ASPHALT BINDER COURSE (TOP LEFT)	POLYMERIZED HOT-MIX ASPHALT BINDER COURSE, N105, IL-19.0	SBS PG76-22	0	4.0% 105 GYRATIONS DESIGN	IL-19.0 MM	NONE
HOT MIX ASPHALT BINDER COURSE (LOWER LEFT) AND TEMPORARY PAVEMENT LEVELING BINDER	HOT-MIX ASPHALT BINDER COURSE, N90, IL-19.0	PG 64-22	10	4.0% 90 GYRATIONS DESIGN	IL-19.0 MM	NONE
HOT MIX ASPHALT SURFACE COURSE (OLD ILL 13 CONNECTOR)	HOT-MIX ASPHALT SURFACE COURSE, MIX C, N90	PG 64-22	10	4.0% 90 GYRATIONS DESIGN	IL-9.5 MM OR IL-12.5 MM	NONE
HOT MIX ASPHALT SURFACE COURSE (TOP LEFT OF OLD ILL 13 CONNECTOR)	POLYMERIZED HOT-MIX ASPHALT SURFACE COURSE, MIX D, N90	SBS PG76-22	0	4.0% 90 GYRATIONS DESIGN	IL-9.5 MM OR IL-12.5 MM	D SURFACE
HOT MIX ASPHALT BINDER COURSE (TOP LEFT OF OLD ILL 13 CONNECTOR)	POLYMERIZED HOT-MIX ASPHALT BINDER COURSE, N90, IL-19.0	SBS PG76-22	0	4.0% 90 GYRATIONS DESIGN	IL-19.0 MM	NONE

NOTES:

- 1) THE HOT MIX ASPHALT PAVEMENT (FULL DEPT-H) WILL INCLUDE 1.5" SUPERPAVE SURFACE COURSE, MIX E





NOT TO SCALE

CONTRACT NO. 78058

F.A.P. RTE.	SECTION	COUNTY	TOTAL SHEETS	SHEET NO.
331	3-2, 8X-1, 4-2	SALINE	212	54
STA. TO STA.				
FED. ROAD DIST. NO. ILLINOIS FED. AID PROJECT				

**REMOVAL OF EXISTING STRUCTURES**

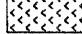
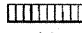
**LEGEND:**

-  HMA SURFACE REMOVAL 1 1/2"
-  PAVEMENT REMOVAL
-  AGGREGATE REMOVAL
-  PAVED SHOULDER REMOVAL
-  CURB & GUTTER REMOVAL

DESIGNED BY S.W. PLOT DATE 1/22/2009  
DRAWN BY D.M.S. PLOT SCALE 1/8"=1'-0"

NO. PROJECT / PUBLISHED / PROJECT / COUNTY	78058 / 4-16-09 / 331 / SALINE
NO. SHEET / TOTAL SHEETS	54 / 212
NO. OF SHEETS / TOTAL SHEETS	54 / 212
NO. OF SHEETS / TOTAL SHEETS	54 / 212
NO. OF SHEETS / TOTAL SHEETS	54 / 212

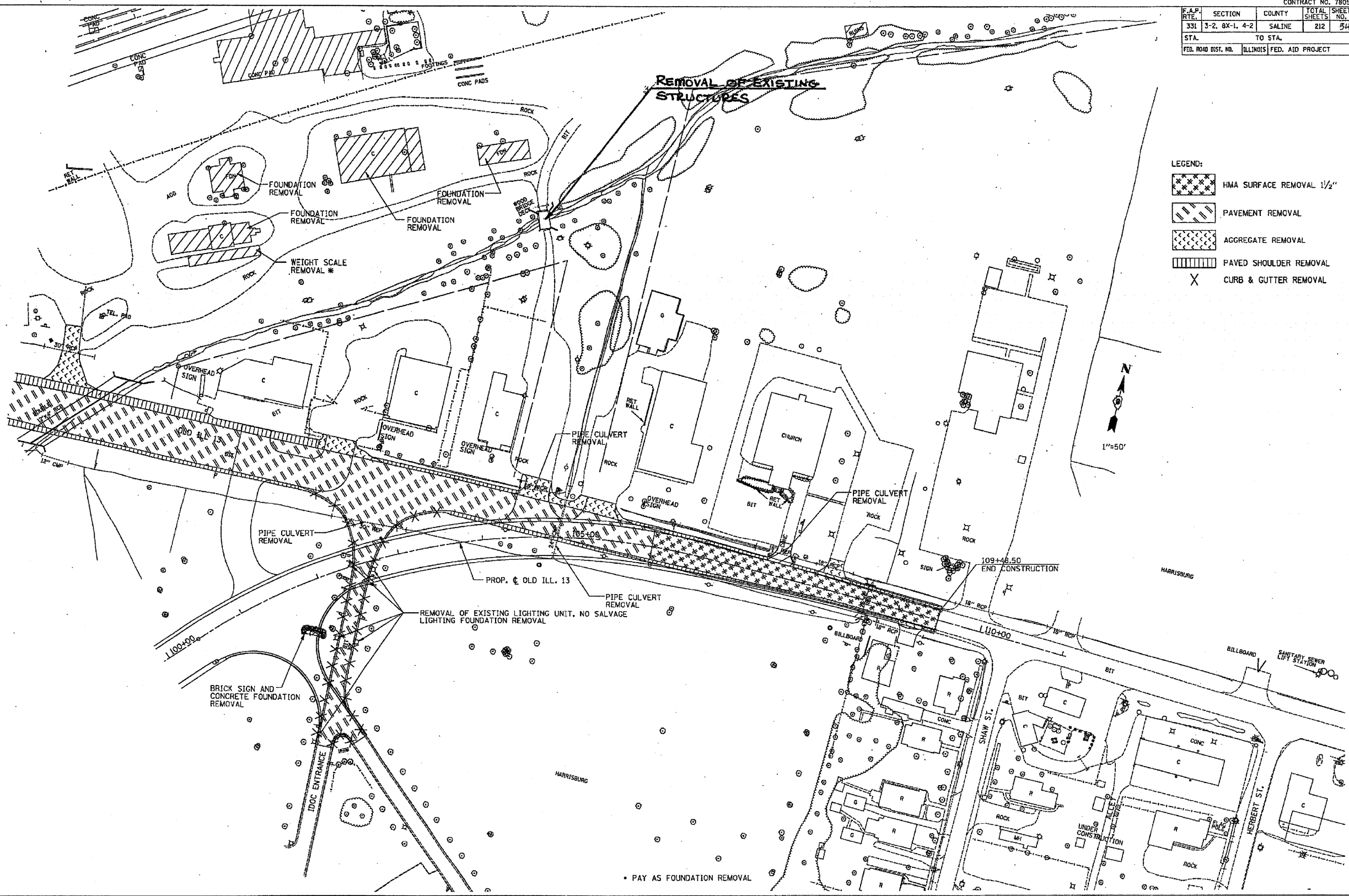

• PAY AS FOUNDATION REMOVAL

**REMOVAL PLAN - OLD ILL.13 - STA. 100+00.00 TO STA. 109+48.50**

Rev. Sheet 4-16-09