

INDEX OF SHEETS

1. COVER SHEET
2. TYPICAL SECTION
3. SUMMARY OF QUANTITIES
4. PLAN AND PROFILE
5. CROSS SECTIONS
6. CROSS SECTIONS
7. CROSS SECTIONS
8. CROSS SECTIONS
9. CROSS SECTIONS
10. GEN. PLAN & ELEVATION
11. 3 SIDED BRIDGE DETAILS
12. BORINGS

STANDARDS

- 000001-05 ABBREVIATIONS AND SYMBOLS
- 280001-04 TEMP EROSION CONTROL SYSTEMS
- 515001-03 NAME PLATES FOR BRIDGES
- 701901-01 TRAFFIC CONTROL DEVICES
- BLR 21-8 TYPICAL APPLICATION OF TRAFFIC CONTROL DEVICES
- BLR 23-3 TBT TY 1
- BLR 26-1 SPB GUARDRAIL

UTILITIES

- ATT/SBC (TELE PHONE)
- IL POWER (GAS)
- COM EDISON (ELECTRIC)

DESIGN DESIGNATION

- MAJOR COLLECTOR
- PRESENT ADT = 484 (2008)
- DESIGN TRAFFIC = 630 (2028)
- DHV:

CONTRACT NUMBER 87367

STATE OF ILLINOIS
DEPARTMENT OF TRANSPORTATION
 DIVISION OF HIGHWAYS
PLANS FOR PROPOSED BRIDGE IMPROVEMENT
HIGHWAY BRIDGE PROGRAM

F.A.S. ROUTE 1281 SECTION 09-00648-00-BR
 PROJECT BRS-1281(103)
 JOB NO. C-93-064-08
 LA SALLE COUNTY

ROUTE NUMBER	SECTION	COUNTY	TOTAL SHEETS	SHEET NO.
FAS 1281	08-00648-00-BR	LASALLE	12	1
FED. ROAD DIST. NO.7		ILLINOIS	PROJECT BRS-1281(103)	
CONTRACT NUMBER 87367				

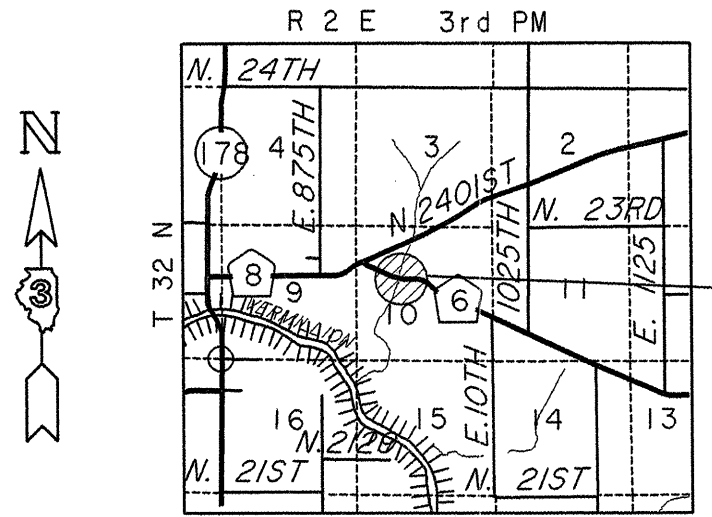
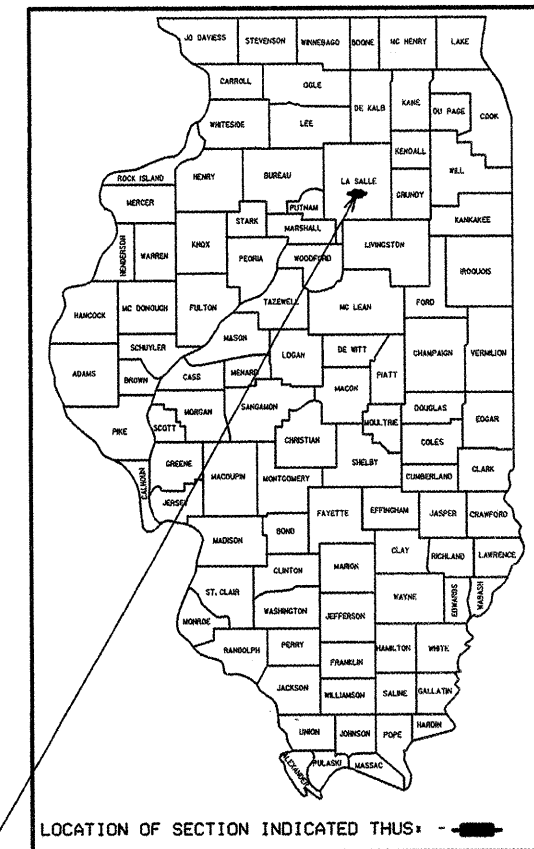

GROSS LENGTH 850 FT. 0.161 MI.
 OMISSIONS
 NET LENGTH 850 FT. 0.161 MI.



PROPOSED STRUCTURE NUMBER 050-3592
 THE CONSTRUCTION OF A 3-SIDED CONCRETE BRIDGE ON RC SPREAD FOOTINGS. 1 SPAN @ 29'-00" x 54' TL 34 FT. ROADWAY 30'-0" TOT. LENGTH AND THE NECESSARY RECONSTRUCTION OF THE APPROACH RDWY

THESE PLANS WERE PREPARED BY ME OR BY A FULL-TIME MEMBER OF MY STAFF WORKING UNDER MY PERSONAL SUPERVISION

Lawrence J. Kinzer 10/29/2008
 LAWRENCE J. KINZER DATE
 COUNTY ENGINEER
 I.R.P.E. #62-40162 11-30-09 EXP.

THE ACCEPTANCE OF THIS PROJECT IS BASED ON THE MINIMUM DESIGN CRITERIA FOR A FEDERAL AID 3-R PROJECT

PASSED: 11-12-2008
Kenneth R. Long
 DISTRICT ENGINEER OF ROADS AND STREETS
 APPROVED: 11-12-08
Mary R. Long
 DISTRICT ENGINEER
 STATE OF ILLINOIS
 DEPARTMENT OF TRANSPORTATION