

STATE OF ILLINOIS
DEPARTMENT OF TRANSPORTATION

F.A.P. RTE	SECTION	COUNTY	TOTAL SHEETS	SHEET NO
71	(113, 112)RS-3	ILLINOIS	13	1
			CONTRACT NO. 66E15	

INDEX OF SHEETS

- 1 COVER SHEET
- 2 GENERAL NOTES
- 3-5 SUMMARY OF QUANTITIES
- 6-8 SCHEDULES
- 9-11 TYPICAL SECTIONS
- 12-13 DETAILS

LIST OF ILLINOIS DOT HIGHWAY STANDARDS

000001 07	STANDARD SYMBOLS, ABBREVIATIONS AND PATTERNS
001006	DECIMAL OF AN INCH AND OF A FOOT
482011-03	HMA SHOULDER STRIPS/SHOULDERS WITH RS OR WIDENING & RS PROJECTS
630001-12	STEEL PLATE BEAM GUARDRAIL
630201-07	PCC/HMA STABILIZATION AT STEEL PLATE BEAM GUARDRAIL
630301 09	SHOULDER WIDENING FOR TYPE 1 (SPECIAL) GUARDRAIL TERMINALS
631032 09	TRAFFIC BARRIER TERMINAL, TYPE 6A
701001 02	OFF-ROAD OPERATIONS 2L, 2W, MORE THAN 15' (4.5 m) AWAY
701006-05	OFF-ROAD OPERATIONS 2L, 2W, 15' (4.5 m) TO 24' (600 mm) FROM PAVEMENT EDGE
701301-04	LANE CLOSURE, 2L, 2W, SHORT TIME OPERATIONS
701306 04	LANE CLOSURE, 2L, 2W, SLOW MOVING OPERATIONS DAY ONLY, FOR SPEEDS ≥ 45 MPH
701311-03	LANE CLOSURE, 2L, 2W, MOVING OPERATIONS - DAY ONLY
701901-08	TRAFFIC CONTROL DEVICES
780001 05	TYPICAL PAVEMENT MARKINGS
781001-04	TYPICAL APPLICATIONS RAISED REFLECTIVE PAVEMENT MARKERS
782006-01	GUARDRAIL AND BARRIER WALL REFLECTOR MOUNTING DETAILS

PROPOSED HIGHWAY PLANS

FAP ROUTE 71 (IL 54)
SECTION (113, 112)RS-3
PROJECT STP-W3T3(507)
3P MILLING & RESURFACING
FORD & IROQUOIS COUNTIES

C-93-151-14

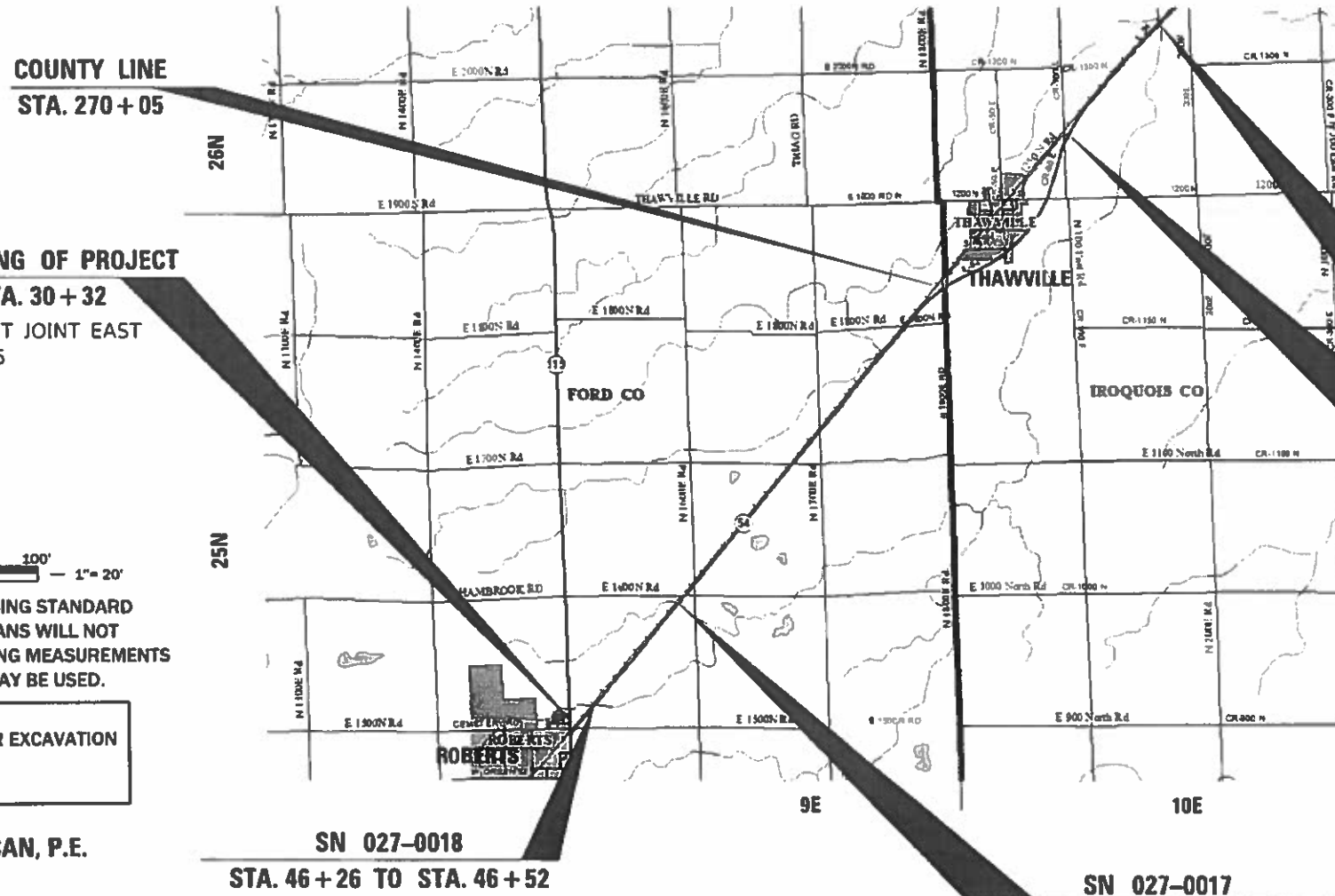
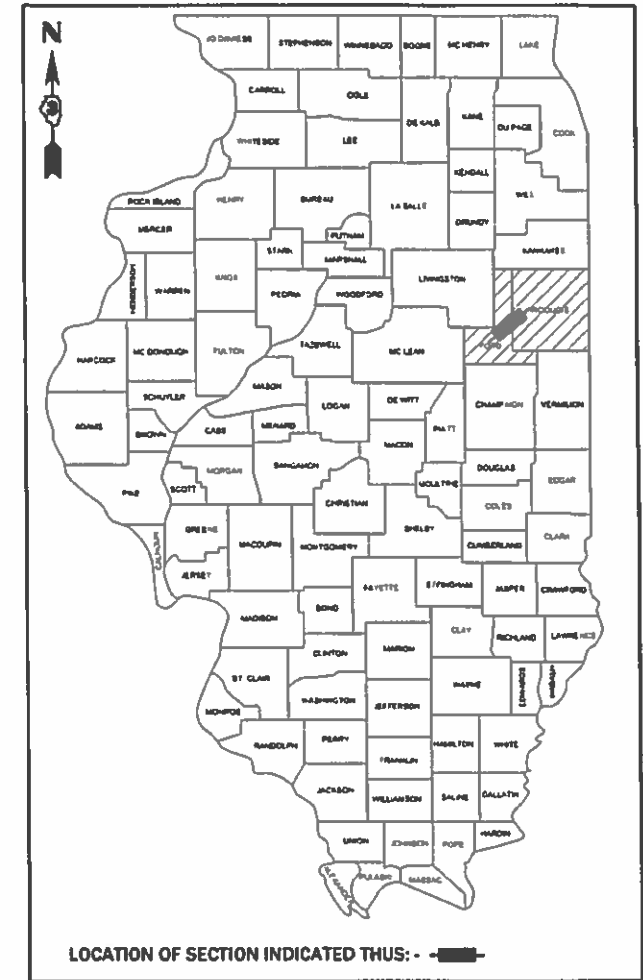

BEGINNING OF PROJECT
STA. 30 + 32
PAVEMENT JOINT EAST
OF IL 115

END OF PROJECT
STA. 222 + 42 (SN 038-0213)
WEST APPROACH PAVEMENT OF
SN 038-0213 OVER SPRING CREEK

MINOR ARTERIAL
ADT (2017) = 1000
P.V. = 78.0%
S.U. = 6.0%
M.U. = 16.0%

STATION EQUATION
363 + 26(BK) = 266 + 80 (AH)

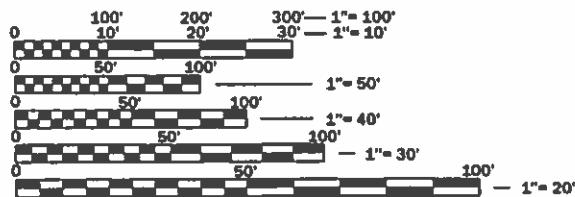

FULL SIZE PLANS HAVE BEEN PREPARED USING STANDARD ENGINEERING SCALES. REDUCED SIZED PLANS WILL NOT CONFORM TO STANDARD SCALES. IN MAKING MEASUREMENTS ON REDUCED PLANS, THE ABOVE SCALES MAY BE USED.

J.U.L.I.E.
JOINT UTILITY LOCATION INFORMATION FOR EXCAVATION
1-800-892-0123
OR 811

PROJECT ENGINEER: BRAD DUNCAN, P.E.
UNIT CHIEF: ALEX NUGENT
DISTRICT 3 NO. (815) 434-6131
CONTRACT NO. 66E15

SN 027-0018
STA. 46 + 26 TO STA. 46 + 52

GROSS LENGTH = 37,893 FT. = 7.18 MILE
NET LENGTH = 37,893 FT. = 7.18 MILE

SN 027-0017
STA. 98 + 76 TO STA. 99 + 12

STATE OF ILLINOIS
DEPARTMENT OF TRANSPORTATION

SUBMITTED Jan 30, 2020

[Signature]
REGIONAL ENGINEER

March 29, 2020
[Signature]
ENGINEER OF DESIGN AND ENVIRONMENT

March 29, 2020
[Signature]
DIRECTOR OF HIGHWAYS PROJECT IMPLEMENTATION

PRINTED BY THE AUTHORITY
OF THE STATE OF ILLINOIS

GENERAL NOTES

THE HMA SURFACE OF ALL MAILBOX TURNOUTS, PRIVATE ENTRANCES, COMMERCIAL ENTRANCES, AND SIDE ROADS SHALL BE MADE NEATLY, IN A WORKMANLIKE MANNER, AND SHALL ACCURATELY CONFORM TO THE SHAPES AND DIMENSIONS SHOWN ON THE PLAN DETAILS. IF REQUIRED BY THE ENGINEER, THE CONTRACTOR SHALL SAW CUT THE HMA SURFACE TO CONFORM TO THE SHAPES AND DIMENSIONS SHOWN ON THE PLAN DETAILS. THIS WORK WILL BE INCLUDED IN THE COST OF THE HMA SURFACE.

THE FINISHED EARTHWORK SHALL HAVE A VEGETATION SUSTAINING SOIL COVERING THE TOP FOUR INCHES (100 MILLIMETERS) IN AREAS TO BE SEEDED OR SODDED. THE VEGETATION SUSTAINING SOIL REQUIRED WILL NOT BE PAID FOR SEPARATELY BUT WILL BE INCLUDED IN THE COST OF EARTH EXCAVATION.

ALL EXCAVATED MATERIAL, WHICH INCLUDES DIGGING OR GRADING OF ANY SOIL OR FILL MATERIAL, WITH THE EXCEPTION OF AGGREGATE FILLS, MUST BE INCORPORATED WITHIN THE IDOT RIGHT OF WAY DUE TO ENVIRONMENTAL DOCUMENTATION REQUIREMENTS.

NO PARKING OF VEHICLES OR CONSTRUCTION EQUIPMENT IS ALLOWED ON THE WEST SIDE OF IL 54 TO PROTECT PRAIRIE AREA.

NO ENCROACHMENT OF WORKERS, VEHICLES, OR CONSTRUCTION EQUIPMENT IS ALLOWED ONTO RAILROAD R.O.W. ON THE WEST SIDE OF IL 54.

THE FOLLOWING RATES OF APPLICATION HAVE BEEN USED IN CALCULATING PLAN QUANTITIES:

GRANULAR MATERIALS	2.05	TONS / CU YD
HMA RESURFACING	112	LBS / SQ YD / IN
SHORT TERM PAVEMENT MARKING	10	FT /100 FT OF APPLICATION
MIX FOR CRACKS, JTS & FLGWYS	0.0003	TONS / SQ YD
HMA BINDER (HAND METHOD)	0.0005	TONS / SQ YD

THE CONTRACTOR SHALL CONTACT JULIE AT LEAST 48 HOURS PRIOR TO EXCAVATION TO DETERMINE WHICH UTILITIES ARE IN THE AREA.

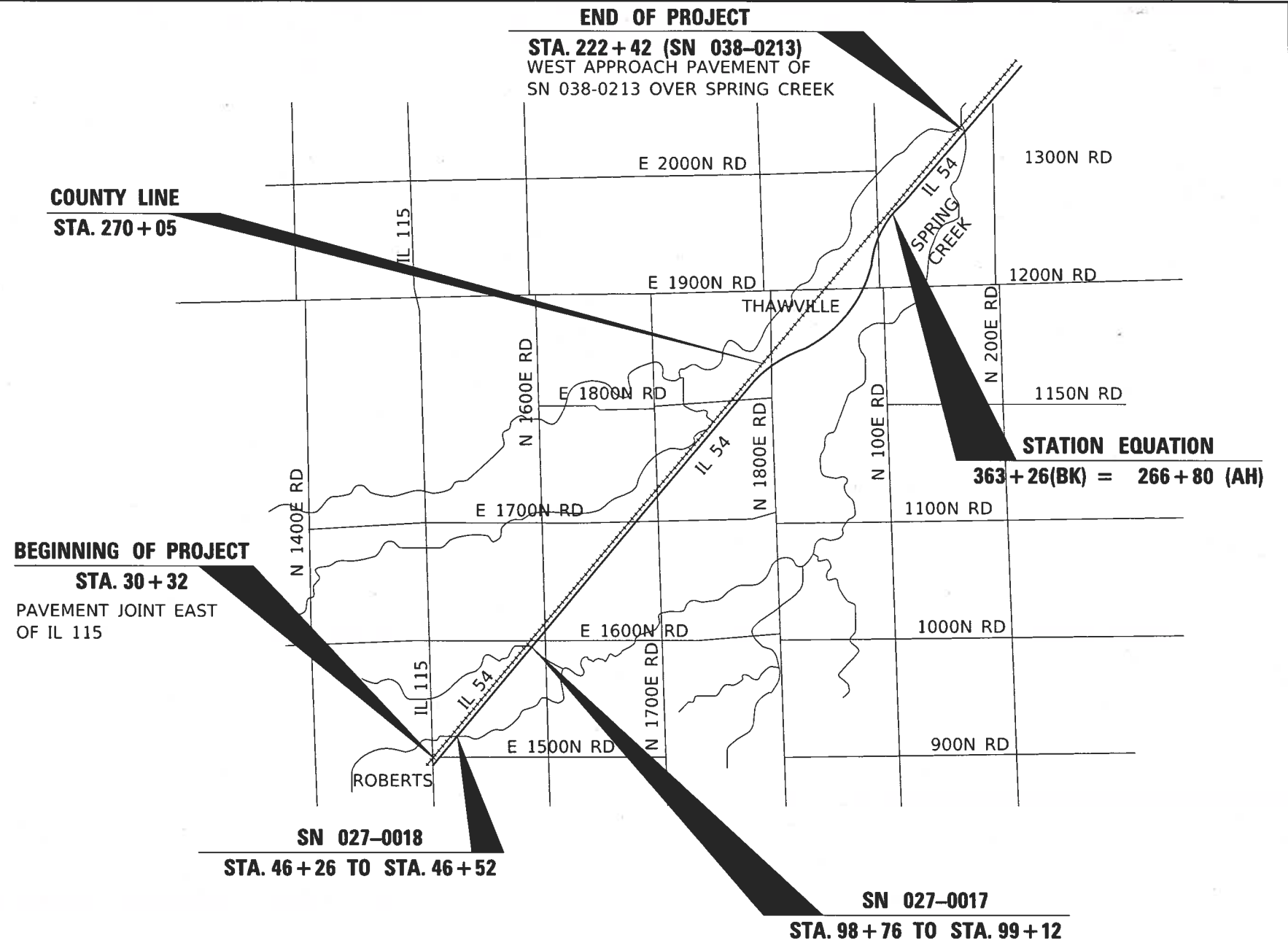

STATE OF ILLINOIS
DEPARTMENT OF TRANSPORTATION
DISTRICT THREE
AS BUILT INFORMATION

SUPERVISING CONSTRUCTION FIELD ENGINEER

RESIDENT ENGINEER / TECHNICIAN

START & END DATES
OF CONSTRUCTION:

INSPECTORS:

STATE OF ILLINOIS
DEPARTMENT OF TRANSPORTATION
DISTRICT THREE

PREPARED BY: Don Benoit
DISTRICT STUDIES & PLANS ENGINEER

DATE: 1-31-2020

EXAMINED BY: [Signature]
DISTRICT CONSTRUCTION ENGINEER

[Signature]
DISTRICT MATERIALS ENGINEER

[Signature]
DISTRICT OPERATIONS ENGINEER

FILE NAME	USER NAME	DESIGNED	REVISED
c:\pw_work\pwwork\duncanbd\04018590366E15-ent-cover.dgn	duncanbd	-	-
		DRAWN	REVISED
		-	-
		CHECKED	REVISED
		-	-
SMODEL NAMES	PLOT DATE	DATE	REVISED
	= 1/28/2020	-	-

STATE OF ILLINOIS
DEPARTMENT OF TRANSPORTATION

GENERAL NOTES

SCALE: SHEET 1 OF 1 SHEETS STA. TO STA.

F.A.P. RTE	SECTION	COUNTY	TOTAL SHEETS	SHEET NO.
71	(113, 112)RS-3		13	2
CONTRACT NO. 66E15				
ILLINOIS FED. AID PROJECT				

CODE NO.	ITEM	UNIT	TOTAL QUANTITY	CONSTRUCTION CODE	
				80% FEDERAL 20% STATE ROADWAY	80% FEDERAL 20% STATE ROADWAY
				0005 FORD	0005 IROQUOIS
20200100	EARTH EXCAVATION	CU YD	88	88	
40200800	AGGREGATE SURFACE COURSE, TYPE B	TON	108	60	48
40600290	BITUMINOUS MATERIALS (TACK COAT)	POUND	10165	6266	3899
40600400	MIXTURE FOR CRACKS, JOINTS, AND FLANGWAYS	TON	32	20	12
40600900	HOT-MIX ASPHALT BINDER COURSE (HAND METHOD), N50	TON	55	34	21
40600990	TEMPORARY RAMP	SQ YD	584	322	262
40602965	HOT-MIX ASPHALT BINDER COURSE, IL-9.5FG, N50	TON	7577	4707	2870
40604000	HOT-MIX ASPHALT SURFACE COURSE, IL-9.5FG, MIX "C", N50	TON	7630	4760	2870
40800050	INCIDENTAL HOT-MIX ASPHALT SURFACING	TON	557	327	230
44000153	HOT-MIX ASPHALT SURFACE REMOVAL, 1"	SQ YD	255	255	
44000159	HOT-MIX ASPHALT SURFACE REMOVAL, 2 1/2"	SQ YD	108824	67819	41005
48102100	AGGREGATE WEDGE SHOULDER, TYPE B	TON	2145	1336	809
* 63000001	STEEL PLATE BEAM GUARDRAIL, TYPE A, 6 FOOT POSTS	FOOT	650	650	
* 63100087	TRAFFIC BARRIER TERMINAL, TYPE 6A	EACH	8	8	

*= SPECIALTY ITEM

MODEL: Default
 FILE: \\nlsr01.pw.state.il.us\pub\room\data\illinois\pwr\DOT\Documents\DOT_Offices\Dir\ctc_3\Projects\0366E15\CADD\data\0366E15-shc-500.dgn

USER NAME = duncanbd	DESIGNED -	REVISED -	STATE OF ILLINOIS DEPARTMENT OF TRANSPORTATION	SUMMARY OF QUANTITIES			F.A.P. RTE.	SECTION	COUNTY	TOTAL SHEETS	SHEET NO.
PLOT SCALE = 100.0000' / in.	CHECKED -	REVISED -					71	(113, 112)RS-3	*	13	3
PLOT DATE = 1/30/2020	DATE -	REVISED -		SCALE: SHEET 1 OF 3 SHEETS STA. TO STA.			CONTRACT NO. 66E15				
							ILLINOIS FED. AID PROJECT				

CODE NO.	ITEM	UNIT	TOTAL QUANTITY	CONSTRUCTION CODE	
				80% FEDERAL 20% STATE ROADWAY	80% FEDERAL 20% STATE ROADWAY
				0005 FORD	0005 IROQUOIS
63100167	TRAFFIC BARRIER TERMINAL, TYPE 1 (SPECIAL) TANGENT	EACH	8	8	
63200310	GUARDRAIL REMOVAL	FOOT	1383	1383	
67000400	ENGINEER'S FIELD OFFICE, TYPE A	CAL MO	3	2	1
67100100	MOBILIZATION	L SUM	1	0.67	0.33
70100460	TRAFFIC CONTROL AND PROTECTION, STANDARD 701306	L SUM	1	0.67	0.33
70100500	TRAFFIC CONTROL AND PROTECTION, STANDARD 701326	L SUM	1	1	
70300100	SHORT TERM PAVEMENT MARKING	FOOT	11319	7061	4258
70300150	SHORT TERM PAVEMENT MARKING REMOVAL	SQ FT	1258	785	473
* 72501000	TERMINAL MARKER - DIRECT APPLIED	EACH	8	8	
* 78001110	PAINT PAVEMENT MARKING - LINE 4"	FOOT	150928	94152	56776
* 78001130	PAINT PAVEMENT MARKING - LINE 6"	FOOT	18880	11780	7100
* 78100100	RAISED REFLECTIVE PAVEMENT MARKER	EACH	472	294	178
* 78200005	GUARDRAIL REFLECTORS, TYPE A	EACH	20	20	
78300200	RAISED REFLECTIVE PAVEMENT MARKER REMOVAL	EACH	472	294	178

*= SPECIALTY ITEM

MODEL: Default
 FILE: \\blm1c2.pva\pub\lanscom\data\illinois\pva\WIDOT\Documents\DOT_Offices\Dir\trct_3\Projects\0366E15\CADD\0366E15-shc-500.dgn

USER NAME = duncanbd	DESIGNED -	REVISED -	STATE OF ILLINOIS DEPARTMENT OF TRANSPORTATION	SUMMARY OF QUANTITIES			F.A.P. RTE.	SECTION	COUNTY	TOTAL SHEETS	SHEET NO.
PLOT SCALE = 100.0000' / in.	CHECKED -	REVISED -					71	(113, 112)RS-3	*	13	4
PLOT DATE = 1/30/2020	DATE -	REVISED -		SCALE: SHEET 2 OF 3 SHEETS STA. TO STA.			CONTRACT NO. 66E15				
							ILLINOIS FED. AID PROJECT				

CODE NO.	ITEM	UNIT	TOTAL QUANTITY	CONSTRUCTION CODE	
				80% FEDERAL 20% STATE ROADWAY	80% FEDERAL 20% STATE ROADWAY
				0005 FORD	0005 IROQUOIS
X4401198	HOT-MIX ASPHALT SURFACE REMOVAL, VARIABLE DEPTH	SQ YD	4425	2593	1832
Z0005216	HOT-MIX ASPHALT STABILIZATION 6" AT STEEL PLATE BEAM GUARD RAIL	SQ YD	528	528	
Z0030850	TEMPORARY INFORMATION SIGNING	SQ FT	63	42	21
Z0033700	LONGITUDINAL JOINT SEALANT	FOOT	37732	23538	14194
Z0034105	MATERIAL TRANSFER DEVICE	TON	15154	9414	5740

MODEL: Default
 FILE: \\blm1c2.pva\pub\lancorn\data\illinois.gov\PWIDOT\Documents\DOT_Offices\District_3\Projects\1366E15\CADD\data\1366E15-shc-500.dgn

USER NAME = duncanbd	DESIGNED -	REVISED -	STATE OF ILLINOIS DEPARTMENT OF TRANSPORTATION	SUMMARY OF QUANTITIES			F.A.P. RTE.	SECTION	COUNTY	TOTAL SHEETS	SHEET NO.
PLOT SCALE = 100.0000' / in.	DRAWN -	REVISED -					71	(113, 112)RS-3	*	13	5
PLOT DATE = 1/30/2020	CHECKED -	REVISED -		SCALE: SHEET 3 OF 3 SHEETS STA. TO STA.			CONTRACT NO. 66E15				
	DATE -	REVISED -					ILLINOIS FED. AID PROJECT				

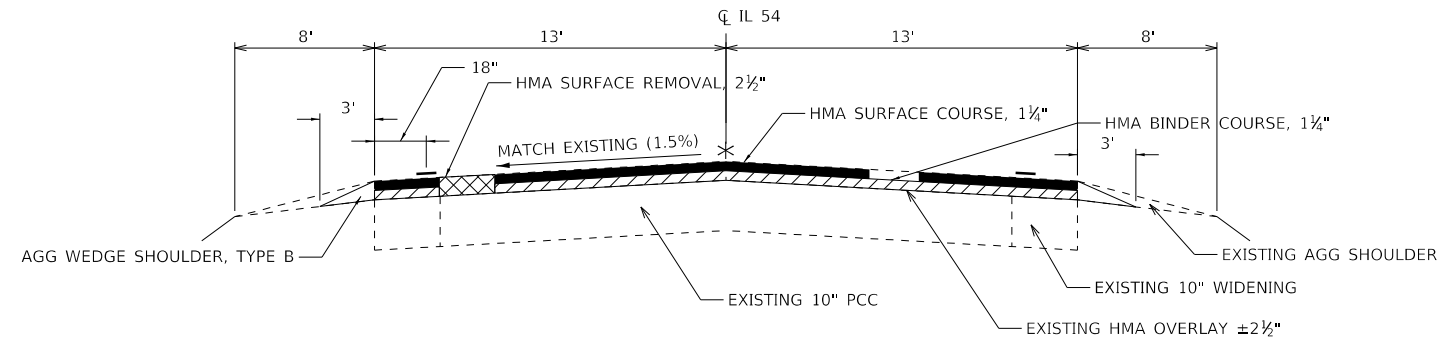

TYPICAL SECTION 1

STA. 30+32 TO STA. 46+26
 STA. 46+52 TO STA. 98+76
 STA. 99+12 TO STA. 249+79

NOTE: REMOVE EXISTING HMA DOWN TO BARE CONCRETE

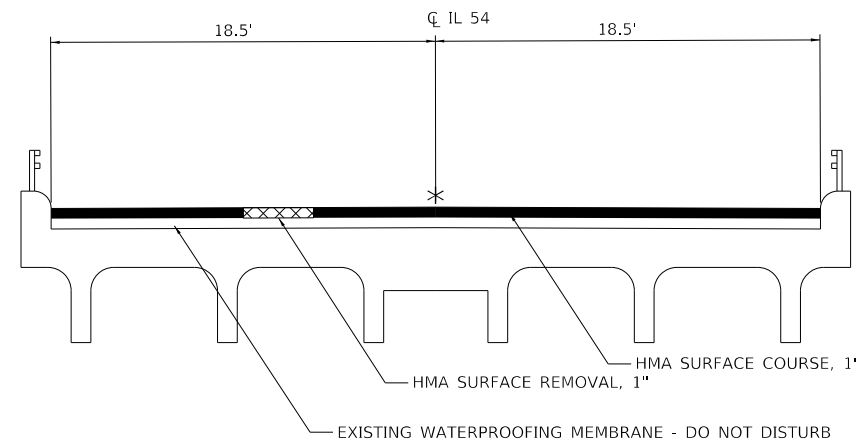

TYPICAL SECTION 2

STA. 46+26 TO STA. 46+52
 STA. 98+76 TO STA. 99+12

NOTE: DO NOT DISTURB EXISTING WATERPROOFING MEMBRANE

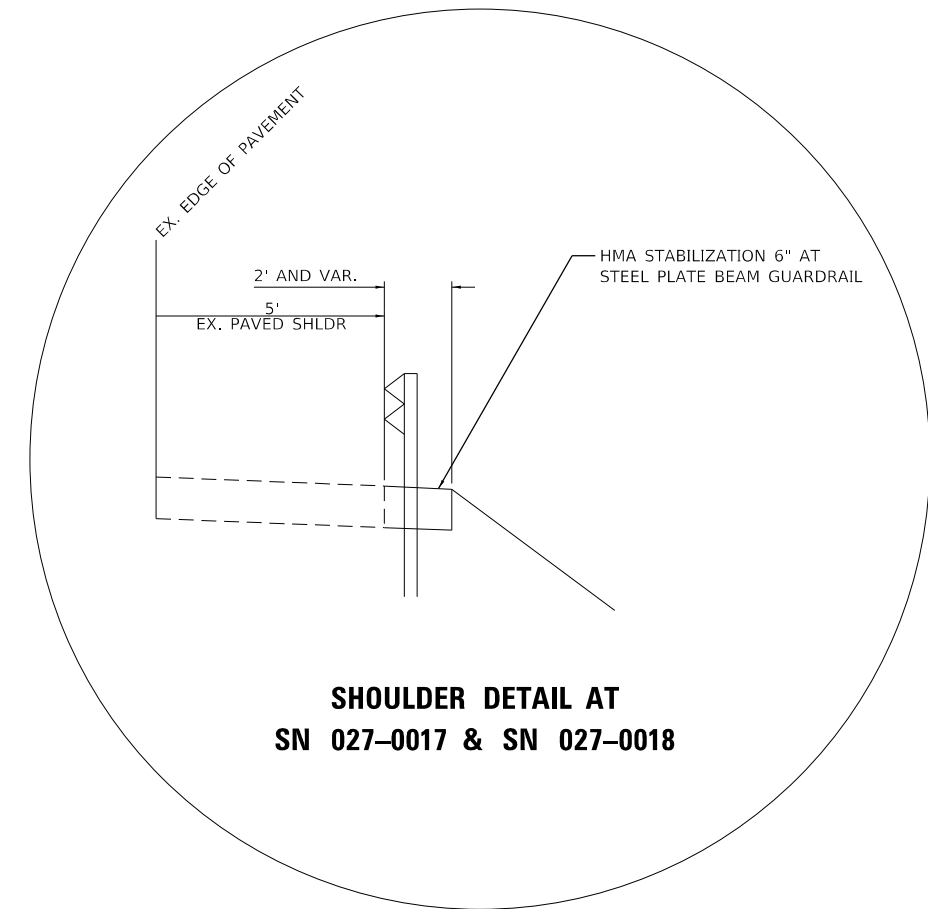

**SHOULDER DETAIL AT
 SN 027-0017 & SN 027-0018**

*LONGITUDINAL JOINT SEALANT UNDER SURFACE COURSE

STATION EQUATION: 363 + 26(BK) = 266 + 80(AH)

MODEL: Default
 FILE: h:\mhc\p\pub\harcam\dat\illinois\pwr\DOT\Documents\DOT_Offices\Illinet\3\Projects\0366E15\CADD\0366E15-shc-syp\typical.dgn

USER NAME = nugentaj	DESIGNED -	REVISED -
	DRAWN -	REVISED -
PLOT SCALE = 100.0000' / in.	CHECKED -	REVISED -
PLOT DATE = 1/23/2020	DATE -	REVISED -

**STATE OF ILLINOIS
 DEPARTMENT OF TRANSPORTATION**

TYPICAL SECTIONS

SCALE: SHEET 1 OF 3 SHEETS STA. TO STA.

F.A.P. RTE.	SECTION	COUNTY	TOTAL SHEETS	SHEET NO.
71	(113, 112)RS-3	*	13	9
CONTRACT NO. 66E15				
ILLINOIS FED. AID PROJECT				

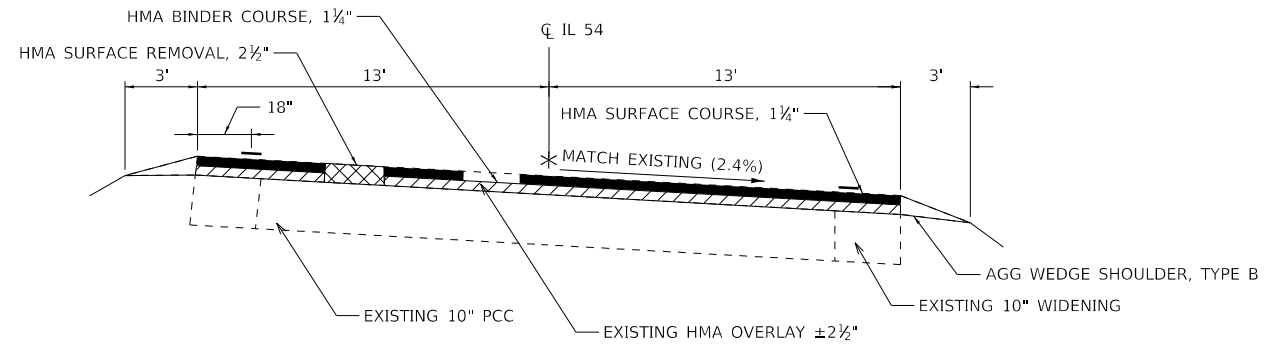

FOR INFORMATION ONLY

**EXISTING CURVE DATA
FROM OLD PLANS**

PC	PI	PT	Δ	D	R	S
249+79.4	263+02.2	275+79.4	26°-00"	1°-00"	5730'	2.4%
280+16.1	307+65.4	331+42.8	51°-16'	1°-00"	5730'	2.4%
337+61.5	350+45.7	362+88.2	25°-16'	1°-00"	5730'	2.4%

TYPICAL SECTION 3

STA. 249+79 TO STA. 275+79
STA. 337+62 TO STA. 363+26(BK)

NOTE: REMOVE EXISTING HMA DOWN TO BARE CONCRETE

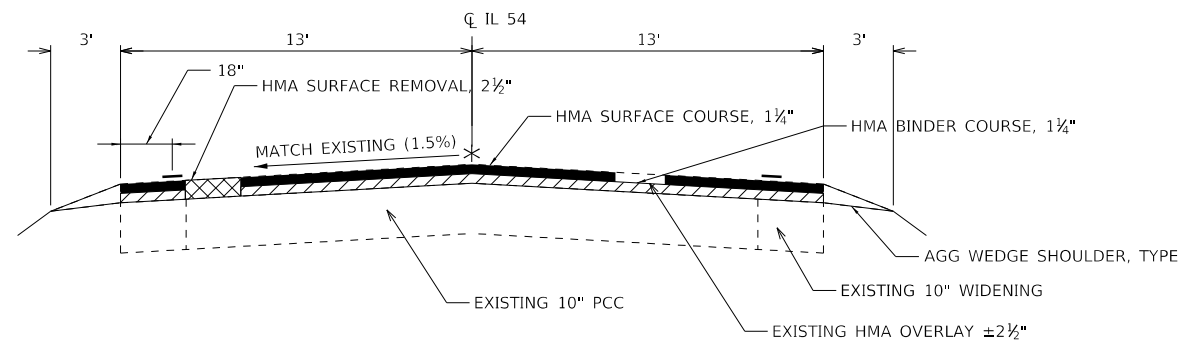

TYPICAL SECTION 4

STA. 275+79 TO STA. 280+16
STA. 331+43 TO STA. 337+62

NOTE: REMOVE EXISTING HMA DOWN TO BARE CONCRETE

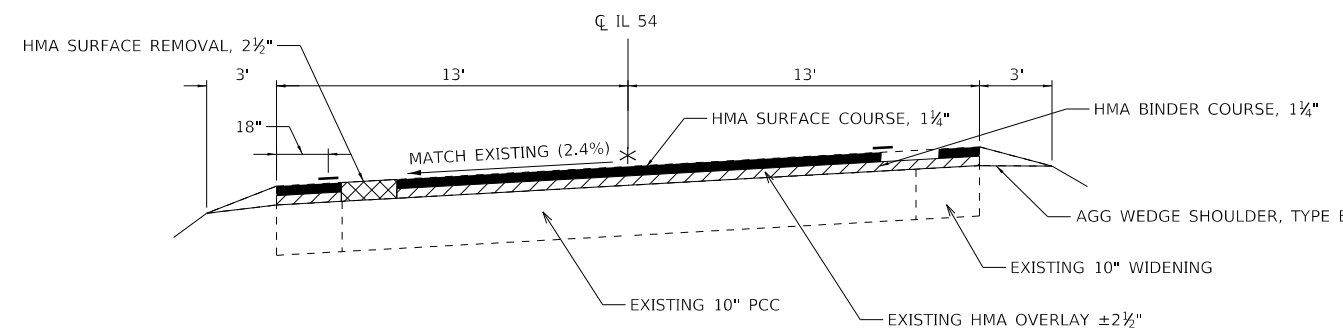

TYPICAL SECTION 5

STA. 280+16 TO STA. 331+43

NOTE: REMOVE EXISTING HMA DOWN TO BARE CONCRETE

*LONGITUDINAL JOINT SEALANT UNDER SURFACE COURSE

STATION EQUATION: 363 + 26(BK) = 266 + 80(AH)

MODEL: Default
FILE: h:\mhc\p\pub\haronom.dwg
PROJECT: I:\DOT\Documents\DOT - Office\111111\111111.dwg
DATE: 1/23/2020

USER NAME = nugentaj	DESIGNED -	REVISED -
	DRAWN -	REVISED -
PLOT SCALE = 100.0000' / in.	CHECKED -	REVISED -
PLOT DATE = 1/23/2020	DATE -	REVISED -

**STATE OF ILLINOIS
DEPARTMENT OF TRANSPORTATION**

TYPICAL SECTIONS

SCALE: SHEET 2 OF 3 SHEETS STA. TO STA.

F.A.P. RTE.	SECTION	COUNTY	TOTAL SHEETS	SHEET NO.
71	(113, 112)RS-3	*	13	10
CONTRACT NO. 66E15				

ILLINOIS FED. AID PROJECT

*FORD & IROQUOIS

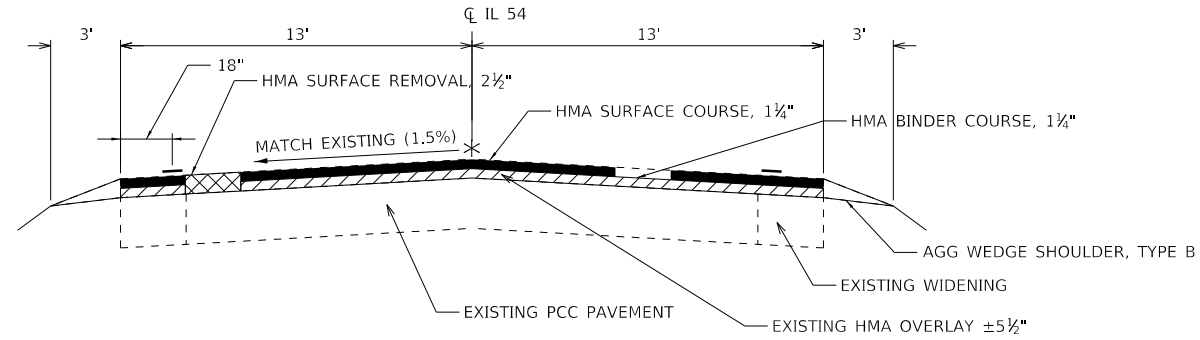

TYPICAL SECTION 6

STA. 266+80(AH) TO STA. 222+42

HMA MIXTURE REQUIREMENT TABLE

LOCATIONS:	ENTIRE PROJECT	ENTIRE PROJECT	ENTIRE PROJECT
MIXTURE USE(S):	HMA BINDER COURSE	HMA SURFACE COURSE	HMA INCIDENTAL
BINDER GRADE (PG):	PG 64-22	PG 64-22	PG 64-22
DESIGN AIR VOIDS:	4.0% @ N50	4.0% @ N50	4.0% @ N50
MIXTURE COMPOSITION: (MIXTURE GRADATION)	IL-9.5FG	IL-9.5FG	IL-9.5FG
FRICTION AGGREGATE:	N/A	MIXTURE C	MIXTURE C
MIXTURE WEIGHT:	112.0 LB/SY/IN	112.0 LB/SY/IN	112.0 LB/SY/IN
QUALITY MANAGEMENT PROGRAM:	QCP	QCP	QC/QA
SUBLOT SIZE:	1000 TONS	1000 TONS	N/A
DENSITY TEST METHOD:	CORES	CORES	SATISFACTION OF THE ENGINEER

*LONGITUDINAL JOINT SEALANT UNDER SURFACE COURSE

STATION EQUATION: 363 + 26(BK) = 266 + 80(AH)

MODEL: Default
 FILE: \\blm1c01.pw.state.il.us\blm1c01\pww\DOT\Documents\DOT_Offices\blm1c01\366E15\CADD\data\366E15-shc-syp\plc.dgn

USER NAME = duncanbd	DESIGNED -	REVISED -	STATE OF ILLINOIS DEPARTMENT OF TRANSPORTATION	TYPICAL SECTIONS			F.A.P. RTE.	SECTION	COUNTY	TOTAL SHEETS	SHEET NO.
PLOT SCALE = 100.0000 ' / in.	DRAWN -	REVISED -		71	(113, 112)RS-3	*	13	11			
PLOT DATE = 1/31/2020	CHECKED -	REVISED -		SCALE: SHEET 3 OF 3 SHEETS STA. TO STA.			CONTRACT NO. 66E15				
	DATE -	REVISED -					ILLINOIS FED. AID PROJECT				

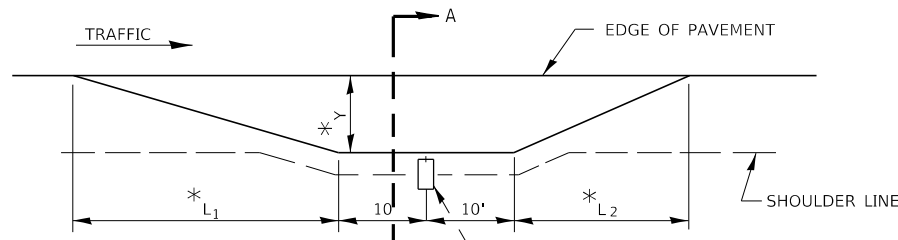

* SEE STANDARD 406201

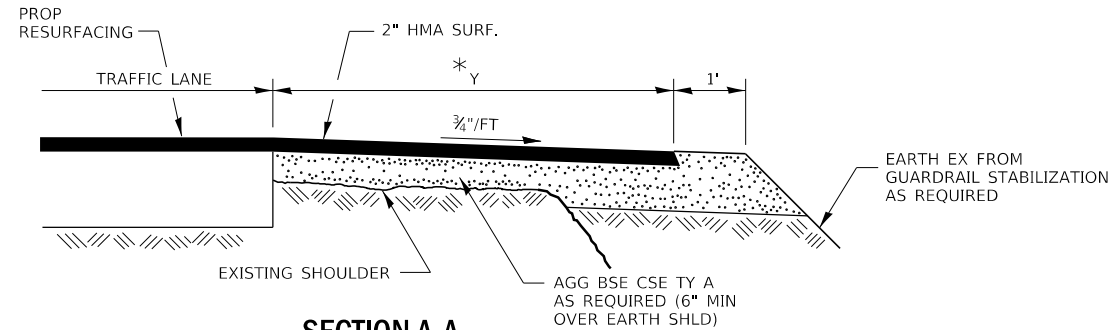

SECTION A-A

RURAL MAILBOX TURNOUT DETAILS

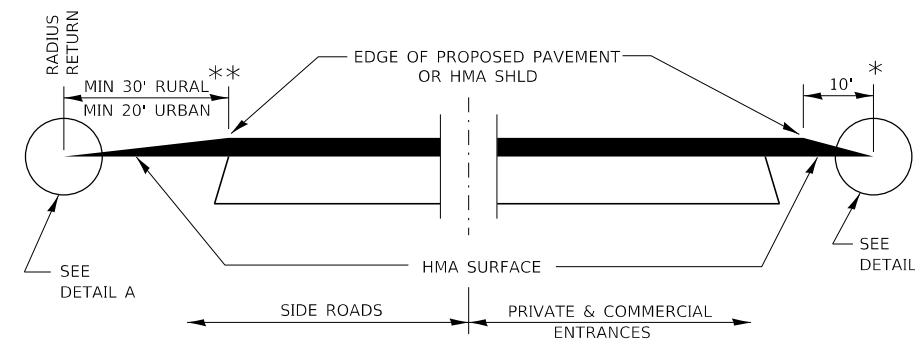

SECTION A-A

DETAILS AT ENTRANCES & SIDE ROADS

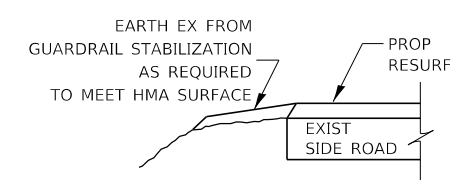

SECTION B-B

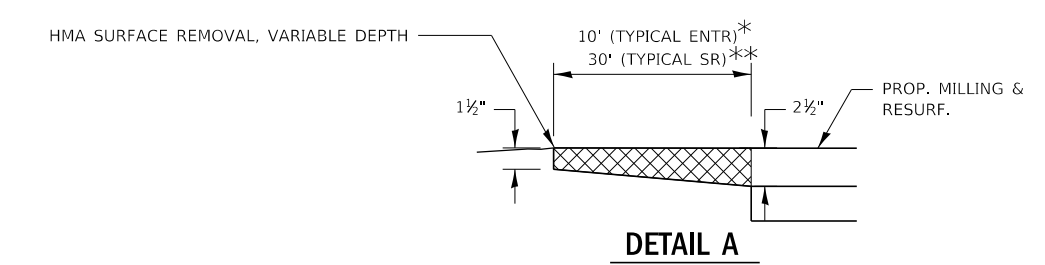

DETAIL A

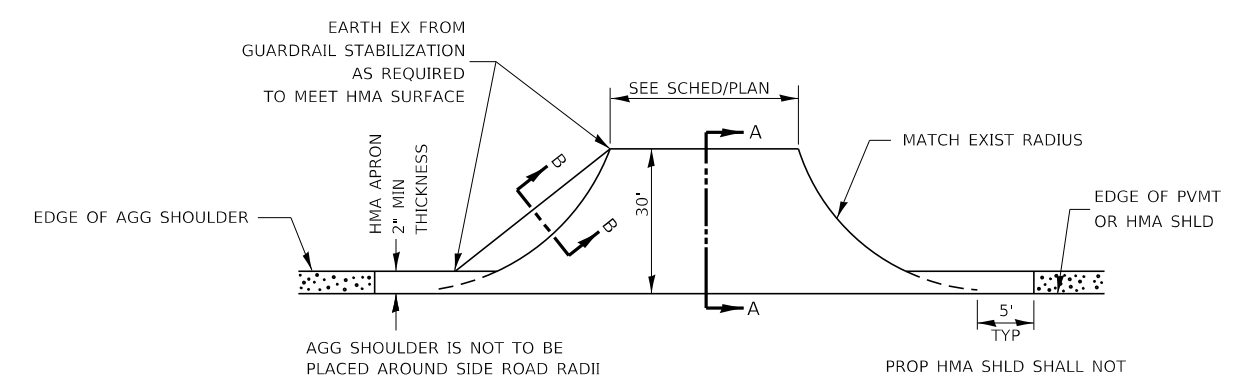

PLAN AT SIDE ROADS

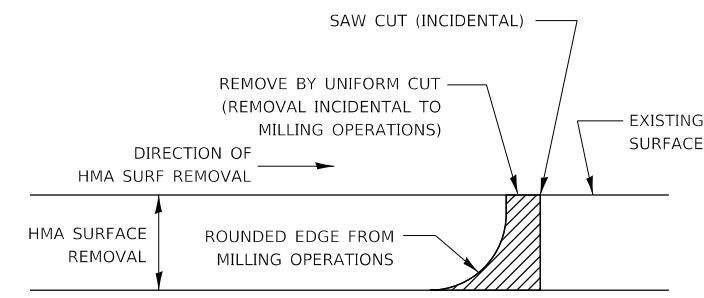

NOTE:
WHEN MILLING OPERATIONS PRODUCE A ROUNDED EDGE, THEN A SAW CUT SHALL BE USED TO MANUFACTURE A PERPENDICULAR EDGE AS SHOWN IN THE DETAIL. THE ENGINEER SHALL BE THE SOLE JUDGE CONCERNING THE USE OF THIS DETAIL

HMA DETAIL AT BUTT JOINTS

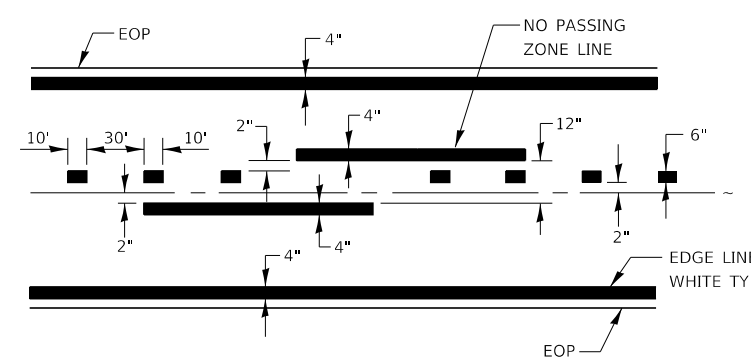

PAVEMENT MARKING

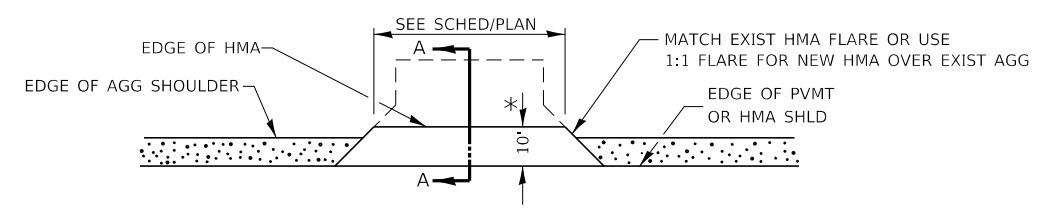

PLAN AT PRIVATE & COMMERCIAL ENTRANCES

(DO NOT RESURFACE FIELD ENTRANCES)

- * PROPOSED HMA RESURFACING AT PUBLIC EDUCATIONAL FACILITY ENTRANCES SHALL BE EXTENDED TO THE RIGHT-OF-WAY LIMITS.
- ** SIDEROAD PAVING WIDTHS HAVE BEEN SHORTENED AT SIDEROADS IMMEDIATELY CROSSING THE RAILROAD TRACKS WEST OF IL 54 TO ENSURE NO ENCROACHMENT ONTO RAILROAD R.O.W.

MODEL: Default
FILE: \\nrcs\pub\planroom\dat\illinois\p\p\DOT\Documents\DOT_Offices\Illinet\3\Projects\0366E15\Cadd\0366E15-shc-detailed.dgn

USER NAME = nugentaj	DESIGNED -	REVISED -
	DRAWN -	REVISED -
PLOT SCALE = 100,0000' / in.	CHECKED -	REVISED -
PLOT DATE = 1/23/2020	DATE -	REVISED -

**STATE OF ILLINOIS
DEPARTMENT OF TRANSPORTATION**

DETAILS			
SCALE:	SHEET 1	OF 2 SHEETS	STA. TO STA.

F.A.P. RTE.	SECTION	COUNTY	TOTAL SHEETS	SHEET NO.
71	(113, 112)RS-3	*	13	12
CONTRACT NO. 66E15				
ILLINOIS FED. AID PROJECT				

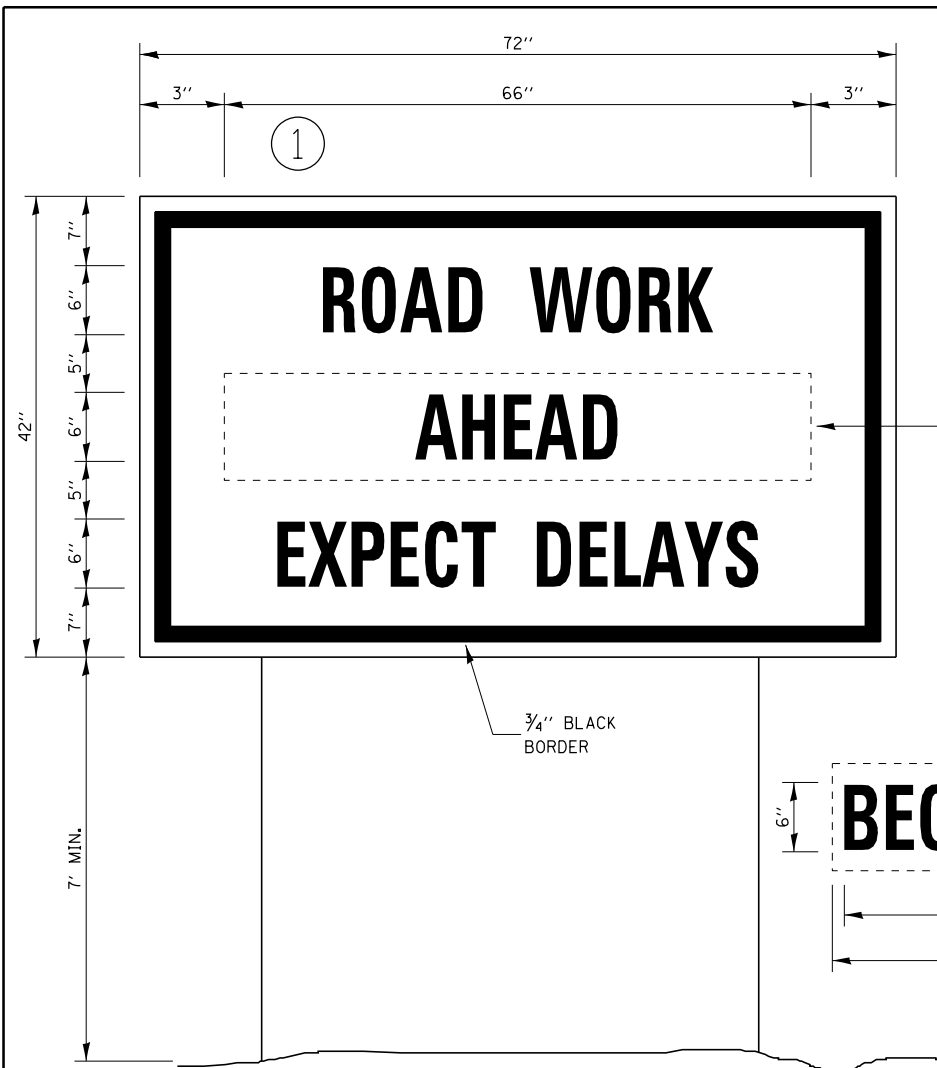

TEMPORARY INFORMATION SIGNING

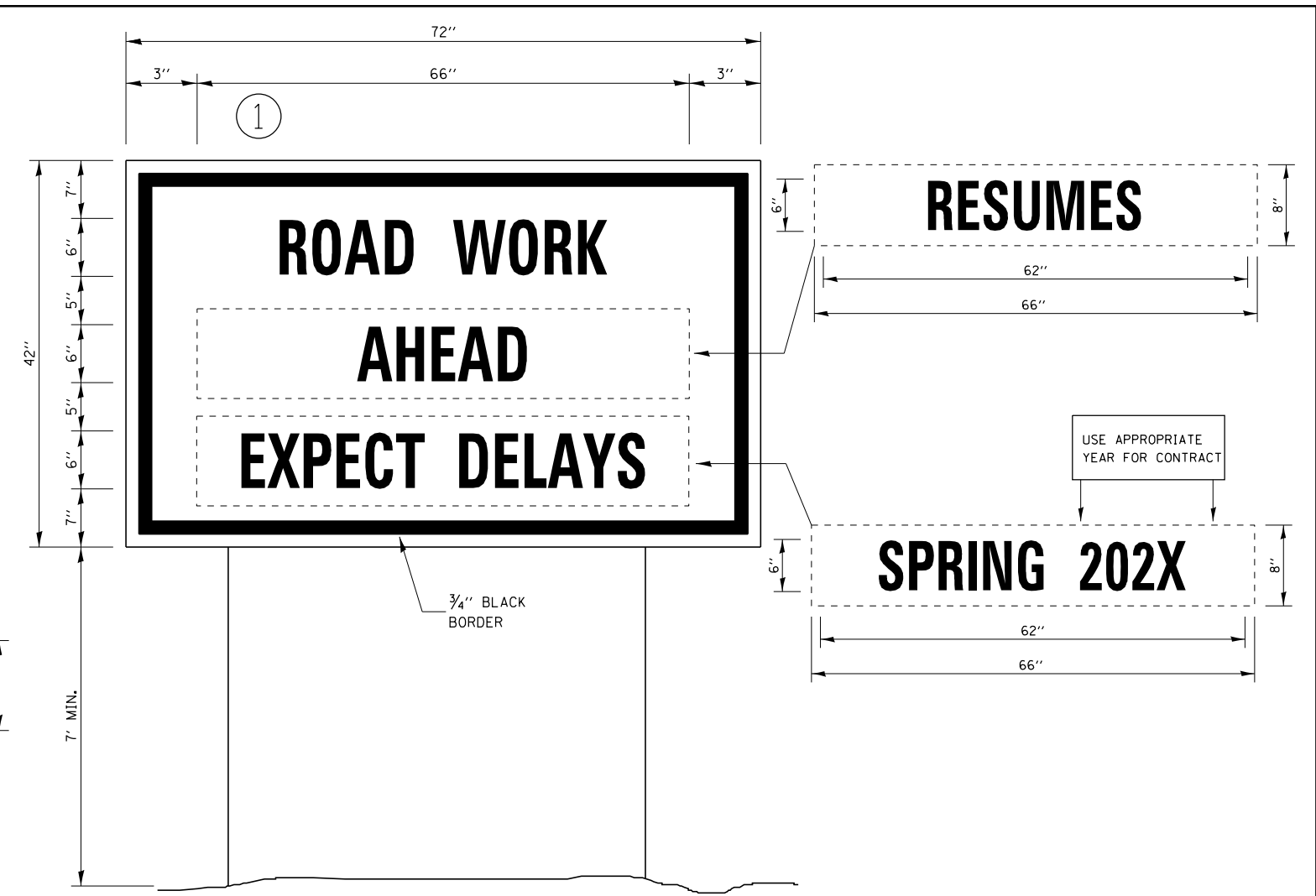

WINTER SHUTDOWN SIGNING

NOTES:

1. USE 6" D BLACK LETTERING ON FLOURESENT ORANGE BACKGROUND.
2. ERECT SIGNS AT LOCATIONS IN ADVANCE OF THE "ROAD CONSTRUCTION AHEAD" SIGNS AS DIRECTED BY THE ENGINEER.
3. ERECT SIGN ① WITH INSTALLED PANEL ② A MINIMUM OF ONE WEEK PRIOR TO THE START OF THE LANE CLOSURE.
4. REMOVE PANEL ② ON THAT DATE.
5. SEE SPECIAL PROVISION "TEMPORARY INFORMATION SIGNING" FOR ADDITIONAL INFORMATION.
6. WILL BE PAID FOR PER SQ FT AS "TEMPORARY INFORMATION SIGNING". EACH SIGN = 21 SQ FT AND THE DATE PANEL ② WILL NOT BE MEASURED SEPARATELY FOR PAYMENT.

MODEL: Default
 FILE: Model: 20200101\Projects\DOT Documents\DOT Office\District 3\Projects\0366E15\CADD\data\0366E15-shc-setalle.dgn

USER NAME = nugentaj	DESIGNED -	REVISED -
PLOT SCALE = 100,0000 ' / in.	DRAWN -	REVISED -
PLOT DATE = 1/23/2020	CHECKED -	REVISED -
	DATE -	REVISED -

STATE OF ILLINOIS
DEPARTMENT OF TRANSPORTATION

DETAILS			
SCALE:	SHEET 2	OF 2	SHEETS
	STA.		TO STA.

F.A.P. RTE.	SECTION	COUNTY	TOTAL SHEETS	SHEET NO.
71	(113, 112)RS-3	*	13	13
CONTRACT NO. 66E15				
ILLINOIS FED. AID PROJECT				