

STATE OF ILLINOIS  
DEPARTMENT OF TRANSPORTATION

F.A.P. RTE.	SECTION	COUNTY	TOTAL SHEETS	SHEET NO.
066	2025-1098-RS	MCHENRY	16	1
		ILLINOIS	CONTRACT NO. 80B10	

FOR INDEX OF SHEETS, SEE SHEET NO. 2

THIS PROJECT IS LOCATED  
IN THE UNINCORPORATED  
MCHENRY COUNTY

PROPOSED  
HIGHWAY PLANS

FAP ROUTE 066: US ROUTE 14  
STATE LINE ROAD TO N OF OAK GROVE ROAD  
SECTION: 2025-1098-RS  
PROJECT: NHPP-D7KJ (766)  
SMART OVERLAY  
MCHENRY COUNTY

C-91-243-25

TRAFFIC DATA:

ADT = 6,500 VPD (2023)  
SPEED LIMIT = 45-55 MPH (POSTED)

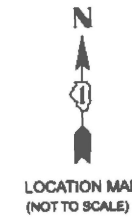

PROJECT ENDS  
STA 155+00

PROJECT BEGINS  
STA 23+64

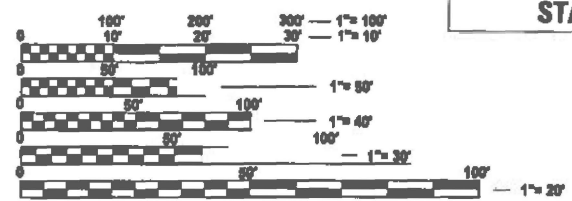

FULL SIZE PLANS HAVE BEEN PREPARED USING STANDARD ENGINEERING SCALES. REDUCED SIZED PLANS WILL NOT CONFORM TO STANDARD SCALES. IN MAKING MEASUREMENTS ON REDUCED PLANS, THE ABOVE SCALES MAY BE USED.

J.U.L.I.E.  
JOINT UTILITY LOCATION INFORMATION FOR EXCAVATION  
1-800-892-0123  
OR 811

PROJECT ENGINEER: VESELIN VELICHKOV (847) 705-4432  
PROJECT MANAGER: VESELIN VELICHKOV

CHEMUNG TOWNSHIP  
GROSS AND NET LENGTH = 13,136 FT. = 2.49 MILE

STATE OF ILLINOIS  
DEPARTMENT OF TRANSPORTATION

SUBMITTED Dec 15 20 25  
Regional Engineer

March 20 20 26  
Engineer of Design and Environment

March 20 20 26  
Director of Highways Project Implementation

PRINTED BY THE AUTHORITY  
OF THE STATE OF ILLINOIS

CONTRACT NO. 80B10

## INDEX OF SHEETS

## STATE STANDARDS

## GENERAL NOTES

**SHEET NO.**

**DESCRIPTION**

**STANDARD NO.**

**DESCRIPTION**

1	TITLE SHEET	000001-09	STANDARD SYMBOLS, ABBREVIATIONS, AND PATTERNS
2	INDEX OF SHEETS, STATE STANDARDS, AND GENERAL NOTES	442201-04	CLASS C AND D PATCHES
3	SUMMARY OF QUANTITIES	482011-03	HMA SHLD. STRIPS/SHLDS. WITH RESURFACING OR WIDENING AND RESURFACING PROJECTS
4	EXISTING AND PROPOSED TYPICAL SECTIONS	701006-05	OFF-RD OPERATIONS, 2L, 2W, 15' (4.5M) TO 24" (600MM) FROM PAVEMENT EDGE
5-9	ROADWAY AND PAVEMENT MARKING PLANS	701011-04	OFF-RD MOVING OPERATIONS, 2L, 2W, DAY ONLY
10	BD-22: PAVEMENT PATCHING FOR HMA SURFACED PAVEMENT	701201-05	LANE CLOSURE, 2L, 2W, DAYS ONLY, FOR SPEEDS ≥ 45 MPH
11	BD-32: BUTT JOINT AND HMA TAPER DETAILS	701301-04	LANE CLOSURE, 2L, 2W, SHORT TIME OPERATIONS
12	TC-10: TRAFFIC CONTROL AND PROTECTION FOR SIDE ROADS, INTERSECTIONS AND DRIVEWAYS	701306-04	LANE CLOSURE, 2L, 2W, SLOW MOVING OPERATIONS DAY ONLY, FOR SPEEDS ≥ 45 MPH
13	TC-11: TYPICAL APPLICATIONS RAISED REFLECTIVE PAVEMENT MARKERS (SNOW-PLOW RESISTANT)	701311-03	LANE CLOSURE, 2L, 2W, SLOW MOVING OPERATIONS DAY ONLY
14	TC-13: DISTRICT ONE TYPICAL PAVEMENT MARKING	701336-07	LANE CLOSURE, 2L, 2W, WORK AREAS IN SERIES FOR SPEEDS ≥ 45 MPH
15	TC-16: SHORT TERM PAVEMENT MARKING LETTERS & SYMBOLS	701501-06	URBAN LANE CLOSURE, 2L, 2W, UNDIVIDED
16	TC-22: ARTERIAL ROAD INFORMATION SIGN	701701-10	URBAN LANE CLOSURE, MULTILANE INTERSECTION
		701901-11	TRAFFIC CONTROL DEVICES
		780001-05	TYPICAL PAVEMENT MARKINGS

1. BEFORE STARTING ANY EXCAVATION, THE CONTRACTOR SHALL CALL "JULIE AT (800) 892-0123 OR 811 FOR FIELD LOCATIONS OF BURIED ELECTRIC, TELEPHONE AND GAS FACILITIES, (48 HOURS NOTIFICATION IS REQUIRED).
2. THE CONTRACTOR SHALL COORDINATE CONSTRUCTION ACTIVITIES WITH UTILITY COMPANIES, CHEMUNG TOWNSHIP AND MCHENRY COUNTY DIVISION OF TRANSPORTATION.
3. THE CONTRACTOR WILL NOT BE ALLOWED TO SET UP A YARD OR FIELD OFFICE ON STATE PROPERTY WITHOUT WRITTEN PERMISSION FROM THE DEPARTMENT.
4. THE CONTRACTOR SHALL CONTACT THE DISTRICT TRAFFIC CONTROL SUPERVISOR AT KALPANA.KANNAN-HOSADURGA@ILLINOIS.GOV A MINIMUM OF 72 HOURS IN ADVANCE OF BEGINNING WORK.
5. UNLESS OTHER CONDITIONS WARRANT EXTENDED LANE CLOSURE AS DETERMINED AND APPROVED IN WRITING BY THE RESIDENT ENGINEER OR AS PROVIDED FOR IN THE CONTRACT SPECIFICATIONS, OVERNIGHT CLOSURES SHALL NOT BE ALLOWED FOR REHABILITATION PROJECTS INVOLVING DAYTIME MILLING AND RESURFACING OPERATIONS AND CLASS D PATCHING.
6. BEFORE BEGINNING ANY WORK, THE CONTRACTOR SHALL RETAIN AND RECORD FOR FUTURE REFERENCE, ALL EXISTING PAVEMENT MARKING LINES (AND RAISED REFLECTIVE PAVEMENT MARKERS) IN ORDER THAT THESE LOCATIONS CAN BE RE-ESTABLISHED FOR STRIPING. EXACT LOCATIONS OF ALL PAVEMENT MARKINGS SHALL BE AS DIRECTED BY THE ENGINEER.
7. WHEN MILLED PAVEMENT IS OPEN TO TRAFFIC, THE MAXIMUM GRADE DIFFERENTIAL BETWEEN PASSES OF THE MILLING MACHINE SHALL NOT EXCEED 1 1/2 INCHES WHERE THE SPEED LIMIT IS 45 MPH OR LESS, AND 1 INCH WHERE THE SPEED LIMIT IS OVER 45 MPH. WITH WRITTEN APPROVAL FROM THE RESIDENT ENGINEER, A MAXIMUM GRADE DIFFERENTIAL OF 3 INCHES MAY BE ALLOWED IF THE EDGE OF THE MILLING IS SLOPED A MINIMUM OF 1V:3H.
8. ANY LOOSE MATERIAL DEPOSITED IN THE FLOW LINE OF CURB OR DRAINAGE STRUCTURES, WHICH OBSTRUCTS THE NATURAL FLOW OF WATER, SHALL BE REMOVED AT THE CLOSE OF EACH WORKING DAY. PRIOR TO ACCEPTANCE OF THE IMPROVEMENT, ALL DRAINAGE STRUCTURES SHALL BE FREE OF DIRT AND DEBRIS. THIS WORK WILL NOT BE PAID FOR SEPARATELY BUT SHALL BE CONSIDERED AS INCIDENTAL.
9. BUTT JOINTS WILL BE INSTALLED AT THE ENDS OF ALL RESURFACING (WHERE RESURFACING MEETS EXISTING PAVEMENT) ACCORDING TO THE "BUTT JOINT AND HOT-MIX ASPHALT TAPER DETAILS" SHEET INCLUDED IN THE PLANS, UNLESS OTHERWISE SPECIFIED.
10. RAISED REFLECTIVE PAVEMENT MARKERS SHALL BE PLACED THROUGHOUT THE IMPROVEMENT ACCORDING TO THE DISTRICT STANDARDS AS NOTED IN THE DETAIL.
11. THE RESIDENT ENGINEER SHALL CONTACT BRANDY KENNEDY, AREA TRAFFIC FIELD ENGINEER, VIA EMAIL AT BRANDY.KENNEDY@ILLINOIS.GOV A MINIMUM OF TWO (2) WEEKS PRIOR TO THE PLACEMENT OF PERMANENT PAVEMENT MARKINGS.
12. ANY DAMAGE TO EXISTING PAVEMENT MARKINGS OR RAISED REFLECTIVE PAVEMENT MARKERS OUTSIDE THE REMOVAL LINE SHOWN ON THE PLANS SHALL BE REPLACED AT THE CONTRACTOR'S EXPENSE.
13. ALL PAVEMENT MARKINGS SHALL BE PLACED THROUGHOUT THE IMPROVEMENT ACCORDING TO DISTRICT 1 TYPICAL PAVEMENT MARKING.
14. ALL PAVEMENT PATCHING LOCATIONS WILL BE DETERMINED IN THE FIELD BY THE ENGINEER.
15. IT SHALL BE THE CONTRACTOR'S RESPONSIBILITY TO VERIFY ALL DIMENSIONS AND CONDITIONS EXISTING IN THE FIELD PRIOR TO CONSTRUCTION AND ORDERING OF MATERIALS.
16. ALL MILLED SURFACES SHALL BE AT UNIFORM CROSS SLOPE PER LANE AND FREE OF RIDGES BETWEEN PASSES. ANY DEVIATIONS SHALL BE CORRECTED AT NO COST TO THE DEPARTMENT.
17. DO NOT SCALE PLANS FOR CONSTRUCTION DIMENSIONS.
18. TEMPORARY PAVEMENT MARKINGS OR SHORT TERM PAVEMENT MARKINGS ON INTERMEDIATE SURFACES SHALL NOT BE REMOVED, UNLESS DIRECTED BY THE ENGINEER.
19. PAVEMENT MARKING TAPE TYPE IV SHALL BE USED FOR SHORT TERM PAVEMENT MARKINGS ON ALL FINAL SURFACES.

MODEL: GenNotesSh01 [Sheet]  
FILE NAME: c:\pw\work\project\shiransbd111961\16325-shir-geomnote.dgn

USER NAME = Sarah.Shirani	DESIGNED -	REVISED -
	DRAWN -	REVISED -
PLOT SCALE = \$\$CALE\$	CHECKED -	REVISED -
PLOT DATE = 11/21/2025	DATE -	REVISED -

**STATE OF ILLINOIS  
DEPARTMENT OF TRANSPORTATION**

**INDEX OF SHEETS, STATE STANDARDS, AND GENERAL NOTES  
US 14 - STATE LINE ROAD TO N OF OAK GROVE ROAD**

SCALE: SHEET OF SHEETS STA. TO STA.

F.A.P. RTE.	SECTION	COUNTY	TOTAL SHEETS	SHEET NO.
066	2025-1098-RS	MCHENRY	16	2
CONTRACT NO. 80B10				
ILLINOIS FED. AID PROJECT				

SUMMARY OF QUANTITIES				CONSTRUCTION TYPE CODE					SUMMARY OF QUANTITIES				CONSTRUCTION TYPE CODE				
CODE NO	ITEM	UNIT	TOTAL QUANTITIES	80% FED 20% STATE ROADWAY 0005					CODE NO	ITEM	UNIT	TOTAL QUANTITIES	80% FED 20% STATE ROADWAY 0005				
40600290	BITUMINOUS MATERIALS (TACK COAT)	POUND	19336	19336					70300100	SHORT TERM PAVEMENT MARKING	FOOT	4790	4790				
40600370	LONGITUDINAL JOINT SEALANT	FOOT	13136	13136					70300150	SHORT TERM PAVEMENT MARKING REMOVAL	SQ FT	1595	1595				
40600400	MIXTURE FOR CRACKS, JOINTS, AND FLANGEWAYS	TON	65	65					70300221	TEMPORARY PAVEMENT MARKING - LINE 4" - PAINT	FOOT	43760	43760				
40600982	HOT-MIX ASPHALT SURFACE REMOVAL - BUTT JOINT	SQ YD	110	110					70300261	TEMPORARY PAVEMENT MARKING - LINE 12" - PAINT	FOOT	975	975				
40604062	HOT-MIX ASPHALT SURFACE COURSE, IL-9.5, MIX "D", N70	TON	3610	3610					70300281	TEMPORARY PAVEMENT MARKING - LINE 24" - PAINT	FOOT	50	50				
44000155	HOT-MIX ASPHALT SURFACE REMOVAL, 1 1/2"	SQ YD	42968	42968					70307120	TEMPORARY PAVEMENT MARKING - LINE 4" - TYPE IV TAPE	FOOT	1595	1595				
44201815	CLASS D PATCHES, TYPE II, 14 INCH	SQ YD	1450	1450				* 72501000	TERMINAL MARKER - DIRECT APPLIED	EACH	1	1					
44201819	CLASS D PATCHES, TYPE III, 14 INCH	SQ YD	1100	1100				* 78000200	THERMOPLASTIC PAVEMENT MARKING - LINE 4"	FOOT	43760	43760					
44201821	CLASS D PATCHES, TYPE IV, 14 INCH	SQ YD	1050	1050				* 78000600	THERMOPLASTIC PAVEMENT MARKING - LINE 12"	FOOT	975	975					
48102100	AGGREGATE WEDGE SHOULDER, TYPE B	TON	305	305				* 78000650	THERMOPLASTIC PAVEMENT MARKING - LINE 24"	FOOT	50	50					
63100167	TRAFFIC BARRIER TERMINAL, TYPE 1 (SPECIAL) TANGENT	EACH	1	1				* 78100100	RAISED REFLECTIVE PAVEMENT MARKER	EACH	550	550					
63200310	GUARDRAIL REMOVAL	FOOT	50	50				* 78200005	GUARDRAIL REFLECTOR, TYPE A	EACH	1	1					
67100100	MOBILIZATION	LSUM	1	1				78300200	RAISED REFLECTIVE PAVEMENT MARKER REMOVAL	EACH	545	545					
70100450	TRAFFIC CONTROL AND PROTECTION, STANDARD 701201	LSUM	1	1				X2020110	GRADING AND SHAPING SHOULDERS	UNIT	221	221					
70100460	TRAFFIC CONTROL AND PROTECTION, STANDARD 701306	LSUM	1	1				X6700407	ENGINEER'S FIELD OFFICE, TYPE A (D1)	CAL MO	6	6					
70102620	TRAFFIC CONTROL AND PROTECTION, STANDARD 701501	LSUM	1	1				Z0030850	TEMPORARY INFORMATION SIGNING	SQ FT	51.4	51.4					
70102635	TRAFFIC CONTROL AND PROTECTION, STANDARD 701701	LSUM	1	1													

\* = SPECIALTY ITEMS

MODEL: SOCO1 (Sheet)  
FILE NAME: c:\p\work\11961\11961.dwg

USER NAME = Sarah.Shirani	DESIGNED -	REVISED -
	DRAWN -	REVISED -
PLOT SCALE = \$\$SCALE\$	CHECKED -	REVISED -
PLOT DATE = 11/21/2025	DATE -	REVISED -

**STATE OF ILLINOIS  
DEPARTMENT OF TRANSPORTATION**

<b>SUMMARY OF QUANTITIES</b>			
<b>US 14 - STATE LINE ROAD TO N OF OAK GROVE ROAD</b>			
SCALE:	SHEET	OF	SHEETS
			STA. TO STA.

F.A.P. RTE.	SECTION	COUNTY	TOTAL SHEETS	SHEET NO.
066	2025-1098-RS	MCHENRY	16	3
CONTRACT NO. 80B10				
ILLINOIS   FED. AID PROJECT				

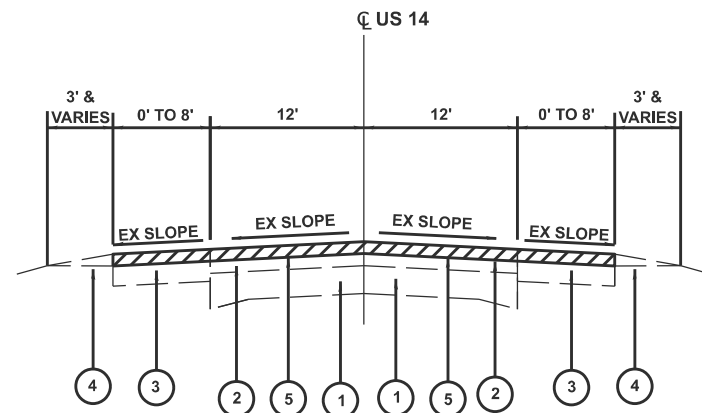

**US 14**  
**EXISTING TYPICAL SECTION**  
 STA. 23+64 TO STA. 155+00

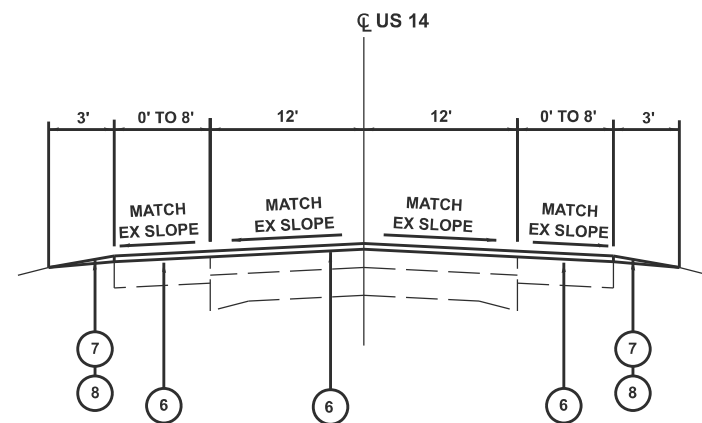

**US 14**  
**PROPOSED TYPICAL SECTION**  
 STA. 23+64 TO STA. 155+00

**LEGEND:**

- ① EX PCC PAVEMENT, ± 9"
- ② EX HMA SURFACE COURSE, ± 6½"
- ③ EX HMA SHOULDER
- ④ EX AGGREGATE SHOULDER
- ⑤ PROP HMA SURFACE COURSE REMOVAL, 1½"
- ⑥ PROP HMA SURFACE COURSE, IL-9.5, MIX "D", N70, 1½"
- ⑦ PROP GRADING AND SHAPING SHOULDERS
- ⑧ PROP AGGREGATE WEDGE SHOULDER, TYPE B

**NOTES:**

1. THE CONTRACTOR SHALL MILL HMA SURFACE BEFORE THE PAVEMENT PATCHING OPERATION. SEE DETAIL PAVEMENT PATCHING FOR HMA SURFACED PAVEMENT BD-22 FOR ADDITIONAL INFORMATION.
2. THE LONGITUDINAL JOINT SEALANT SHALL BE PLACED OVER THE MILLED SURFACE.

HMA MIXTURE REQUIREMENTS			
MIXTURE USES	MIXTURE TYPE	AIR VOIDS @ Ndes	QUALITY MANAGEMENT PROGRAM (QMP)
PAVEMENT AND SHOULDER RESURFACING	HMA SURFACE COURSE, MIX "D", IL-9.5, N70; 1½"	4% @ 70 GYR.	QCP
PATCHING	CLASS D PATCHES (HMA BINDER IL-19.0)	4% @ 70 GYR.	QC/QA

QMP DESIGNATIONS: QUALITY CONTROL/QUALITY ASSURANCE (QC/QA) & QUALITY CONTROL FOR PERFORMANCE (QCP)

NOTE #1: THE UNIT WEIGHT USED TO CALCULATE ALL HMA SURFACE MIXTURE QUANTITIES IS 112 LBS/SQ YD/IN.

NOTE #2: THE "AC TYPE" FOR POLYMERIZED HMA MIXES SHALL BE "SBS/SBR PG 76 -22" AND FOR NON-POLYMERIZED HMA THE "AC TYPE" SHALL BE "PG 64 -22" UNLESS MODIFIED BY RECLAIMED MATERIALS SPECIFICATIONS.

MODEL: Typical Section-1 (Sheet)  
 FILE NAME: c:\p\work\wisconsin\shirani\1115961\116325-shh-typical.dgn

USER NAME = Sarah,Shirani	DESIGNED -	REVISED -
	DRAWN -	REVISED -
	CHECKED -	REVISED -
PLOT DATE = 12/5/2025	DATE -	REVISED -

**STATE OF ILLINOIS**  
**DEPARTMENT OF TRANSPORTATION**

**EXISTING AND PROPOSED TYPICAL SECTIONS**  
**US 14 - STATE LINE ROAD TO N OAK GROVE ROAD**

SCALE: SHEET Typical Section-1 SHEETS STA. TO STA.

F.A.P. RTE.	SECTION	COUNTY	TOTAL SHEETS	SHEET NO.
066	2025-1098-RS	MCHENRY	16	4
ILLINOIS FED. AID PROJECT			CONTRACT NO. 80B10	

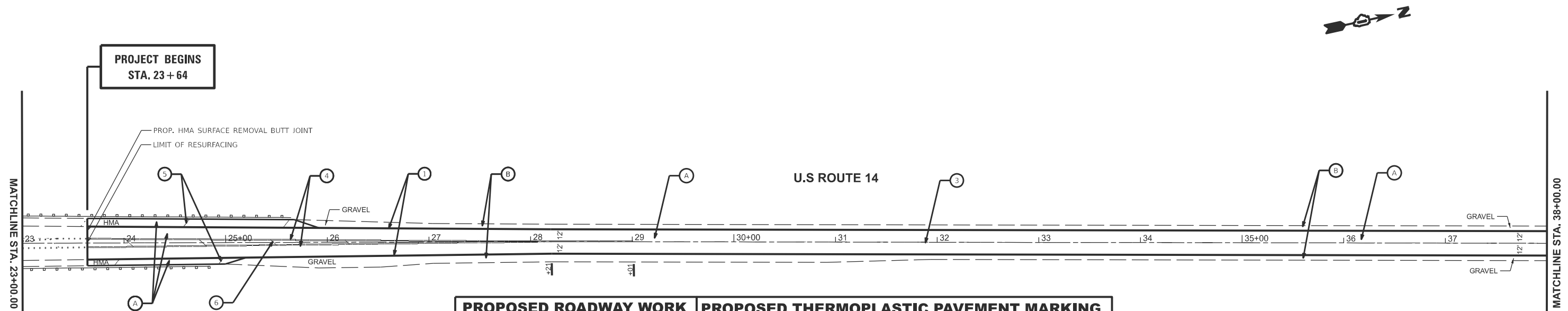
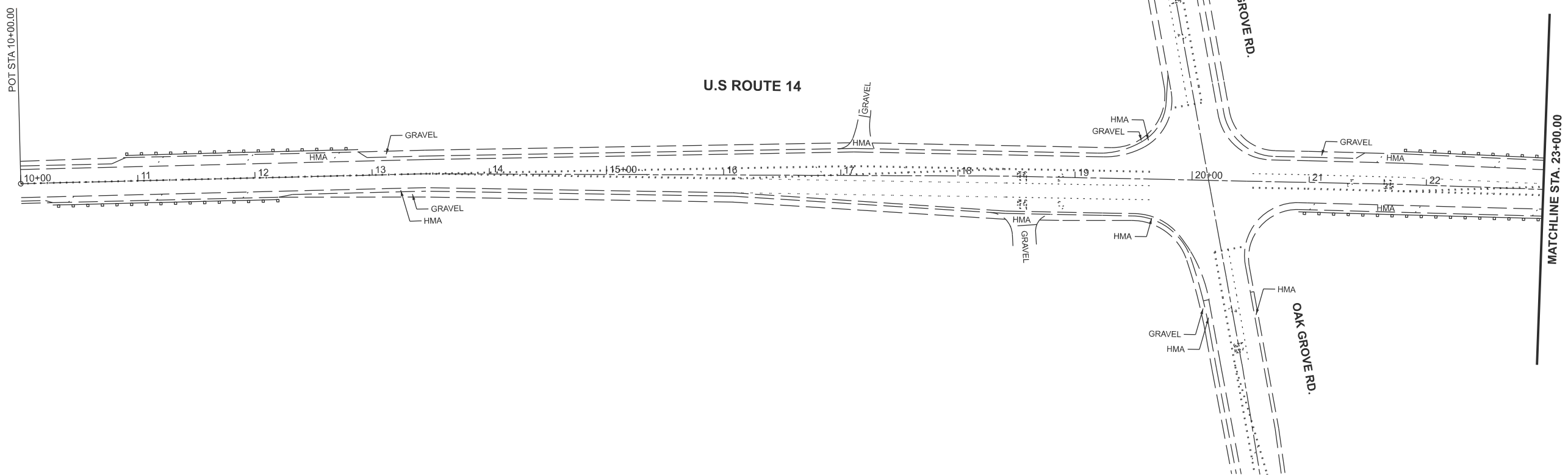

PROPOSED ROADWAY WORK		PROPOSED THERMOPLASTIC PAVEMENT MARKING	
<b>A</b>	PROP. HMA SURFACE REMOVAL, 1 1/2" PROP. HMA SURFACE COURSE, MIX "D", IL-9.5, N70, 1 1/2"	<b>1</b>	4" SOLID WHITE EDGE LINE (TYP.)
<b>B</b>	PROP. AGG. WEDGE SHOULDER, TYPE B PROP. GRADING AND SHAPING SHOULDER	<b>2</b>	4" SOLID YELLOW LINE (TYP.)
		<b>3</b>	4" SKIP DASH YELLOW LINE @ 30' SKIP & 10' DASH (TYP.)
		<b>4</b>	4" DOUBLE SOLID YELLOW LINE, 2 @ 11' C-C (TYP.)
		<b>5</b>	12" DIAGONAL SOLID WHITE SHOULDER DIAGONAL LINE (TYP.)
		<b>6</b>	12" DIAGONAL SOLID YELLOW LINE @ 75' SPACING OR 5 MIN. (TYP.)
		<b>7</b>	24" SOLID WHITE STOP BAR (TYP.)
INSTALL FINAL PAVEMENT MARKINGS AND RAISED REFLECTIVE MARKERS PER DISTRICT DETAIL TC-11 AND TC-13.			

MODEL: US14\_E - Rdwy Plan 1 (Sheet)  
 FILE NAME: c:\pwworking\shirani\111961\116325-shr-plan.dgn

USER NAME = Sarah,Shirani	DESIGNED -	REVISED -
	DRAWN -	REVISED -
	CHECKED -	REVISED -
PLOT DATE = 11/21/2025	DATE -	REVISED -

**STATE OF ILLINOIS**  
**DEPARTMENT OF TRANSPORTATION**

**ROADWAY AND PAVEMENT MARKING PLAN**  
**US 14 - STATE LINE ROAD TO N OF OAK GROVE ROAD**

SCALE: 1"=50'    SHEET 1 OF 6 SHEETS    STA. 8+00.00 TO STA. 38+00.00

F.A.P. RTE.	SECTION	COUNTY	TOTAL SHEETS	SHEET NO.
066	2025-1098-RS	MCHENRY	16	5
CONTRACT NO. 80B10				
ILLINOIS FED. AID PROJECT				

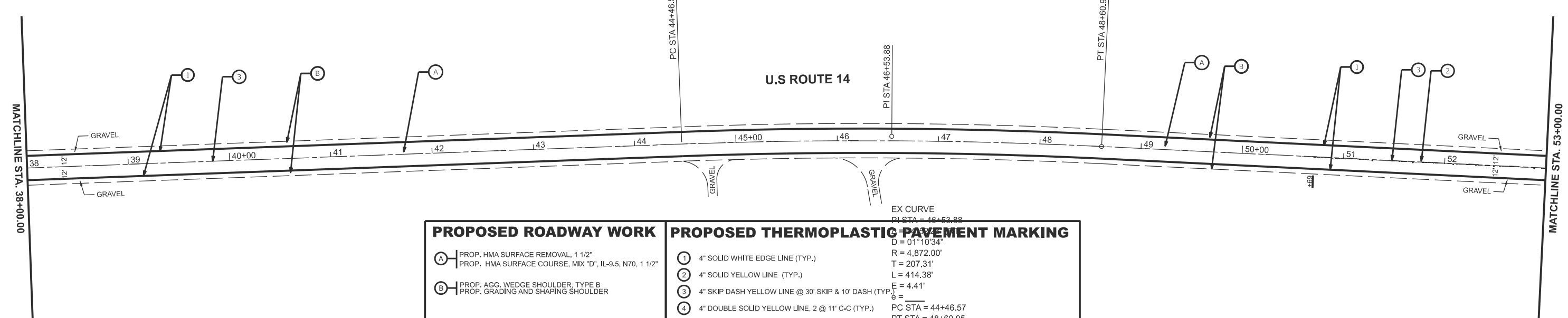

PROPOSED ROADWAY WORK		PROPOSED THERMOELASTIC PAVEMENT MARKING	
(A)	PROP. HMA SURFACE REMOVAL, 1 1/2" PROP. HMA SURFACE COURSE, MIX "D", IL-9.5, N70, 1 1/2"	(1)	4" SOLID WHITE EDGE LINE (TYP.)
(B)	PROP. AGG. WEDGE SHOULDER, TYPE B PROP. GRADING AND SHAPING SHOULDER	(2)	4" SOLID YELLOW LINE (TYP.)
		(3)	4" SKIP DASH YELLOW LINE @ 30' SKIP & 10' DASH (TYP.)
		(4)	4" DOUBLE SOLID YELLOW LINE, 2 @ 11' C-C (TYP.)
		(5)	12" DIAGONAL SOLID WHITE SHOULDER DIAGONAL LINE (TYP.)
		(6)	12" DIAGONAL SOLID YELLOW LINE @ 75' SPACING OR 5 MIN. (TYP.)
		(7)	24" SOLID WHITE STOP BAR (TYP.)

EX CURVE  
 PI STA = 46+53.88  
 D = 01°10'34"  
 R = 4,872.00'  
 T = 207.31'  
 L = 414.38'  
 E = 4.41'  
 e = \_\_\_\_\_  
 PC STA = 44+46.57  
 PT STA = 48+60.95  
 (TYP.)

INSTALL FINAL PAVEMENT MARKINGS AND RAISED REFLECTIVE MARKERS PER DISTRICT DETAIL TC-11 AND TC-13.

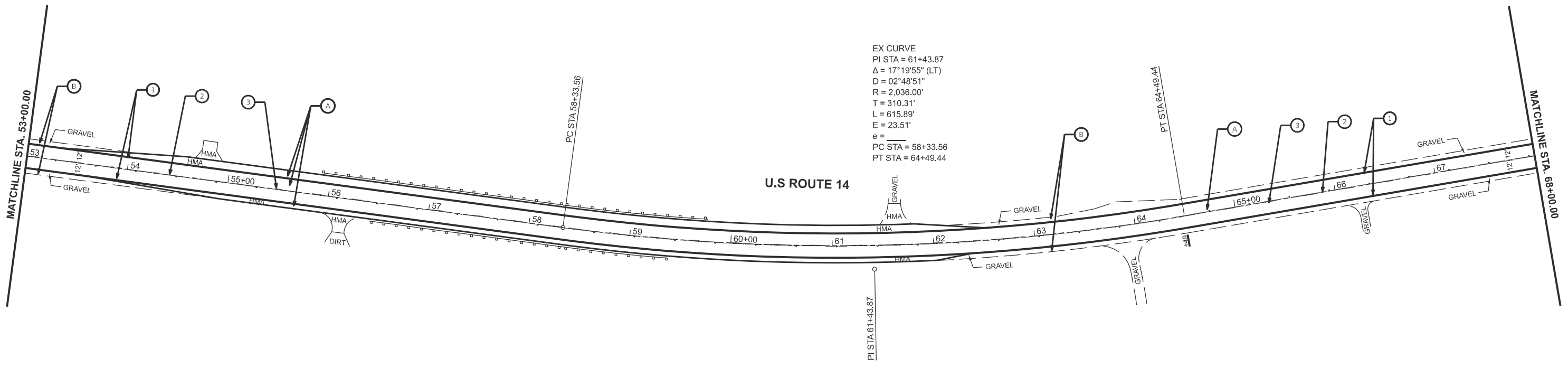

EX CURVE  
 PI STA = 61+43.87  
 Δ = 17°19'55" (LT)  
 D = 02°48'51"  
 R = 2,036.00'  
 T = 310.31'  
 L = 615.89'  
 E = 23.51'  
 e = \_\_\_\_\_  
 PC STA = 58+33.56  
 PT STA = 64+49.44

MODEL: US14\_E - Rdwy Plan 3 (Sheet)  
 FILE NAME: c:\pwworking\shirani\111961\111961.dwg

USER NAME = Sarah, Shirani	DESIGNED -	REVISED -
	DRAWN -	REVISED -
	CHECKED -	REVISED -
PLOT DATE = 11/21/2025	DATE -	REVISED -

STATE OF ILLINOIS  
 DEPARTMENT OF TRANSPORTATION

ROADWAY AND PAVEMENT MARKING PLAN  
 US 14 - STATE LINE ROAD TO N OF OAK GROVE ROAD

SCALE: 1"=50' SHEET 2 OF 6 SHEETS STA. 38+00.00 TO STA. 68+00.00

F.A.P. RTE.	SECTION	COUNTY	TOTAL SHEETS	SHEET NO.
066	2025-1098-RS	MCHENRY	16	6
CONTRACT NO. 80B10				
ILLINOIS FED. AID PROJECT				

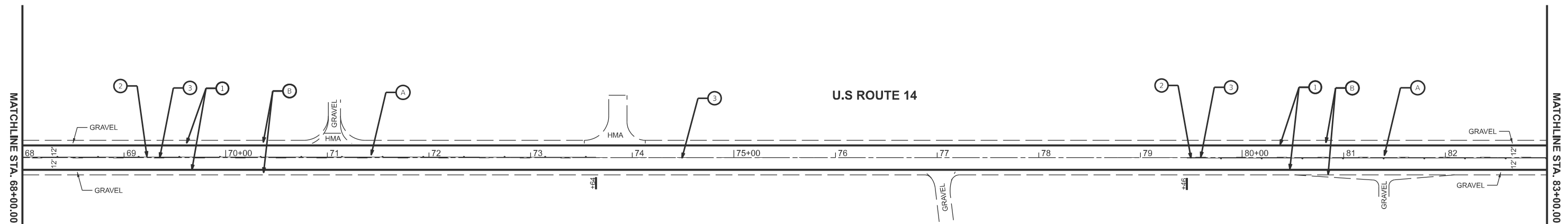

PROPOSED ROADWAY WORK		PROPOSED THERMOPLASTIC PAVEMENT MARKING	
(A)	PROP. HMA SURFACE REMOVAL, 1 1/2" PROP. HMA SURFACE COURSE, MIX "D", IL-9.5, N70, 1 1/2"	(1)	4" SOLID WHITE EDGE LINE (TYP.)
(B)	PROP. AGG. WEDGE SHOULDER, TYPE B PROP. GRADING AND SHAPING SHOULDER	(2)	4" SOLID YELLOW LINE (TYP.)
		(3)	4" SKIP DASH YELLOW LINE @ 30' SKIP & 10' DASH (TYP.)
		(4)	4" DOUBLE SOLID YELLOW LINE, 2 @ 11' C-C (TYP.)
		(5)	12" DIAGONAL SOLID WHITE SHOULDER DIAGONAL LINE (TYP.)
		(6)	12" DIAGONAL SOLID YELLOW LINE @ 75' SPACING OR 5 MIN. (TYP.)
		(7)	24" SOLID WHITE STOP BAR (TYP.)
INSTALL FINAL PAVEMENT MARKINGS AND RAISED REFLECTIVE MARKERS PER DISTRICT DETAIL TC-11 AND TC-13.			

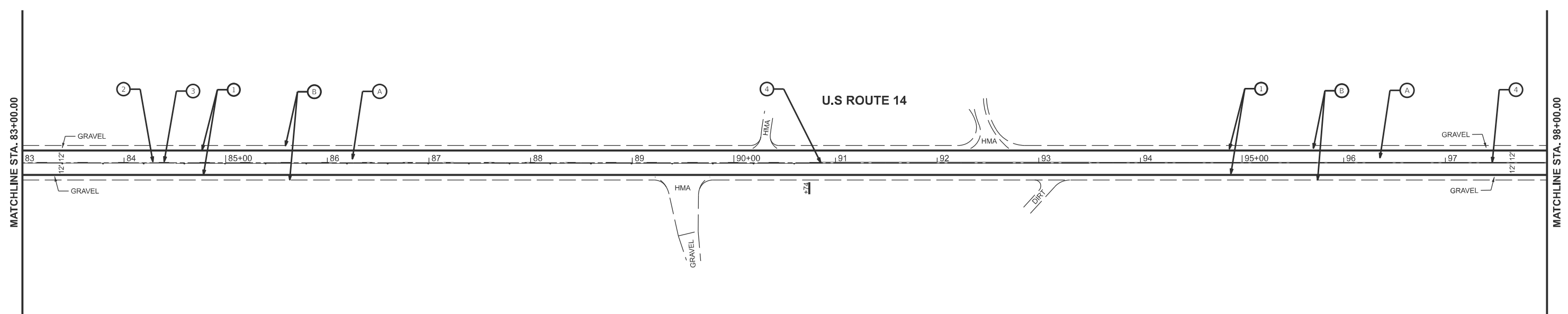

MODEL: US14\_E - Rdwy Plan 5 (Sheet)  
 FILE NAME: c:\pwworking\shirani\111961\116325-shr-plan.dgn

USER NAME = Sarah,Shirani	DESIGNED -	REVISED -
	DRAWN -	REVISED -
	CHECKED -	REVISED -
PLOT DATE = 11/21/2025	DATE -	REVISED -

**STATE OF ILLINOIS**  
**DEPARTMENT OF TRANSPORTATION**

**ROADWAY AND PAVEMENT MARKING PLAN**  
**US 14 - STATE LINE ROAD TO N OF OAK GROVE ROAD**

SCALE: 1"=50'      SHEET 3 OF 6 SHEETS      STA. 68+00.00 TO STA. 98+00.00

F.A.P. RTE.	SECTION	COUNTY	TOTAL SHEETS	SHEET NO.
066	2025-1098-RS	MCHENRY	16	7
CONTRACT NO. 80B10				
ILLINOIS FED. AID PROJECT				

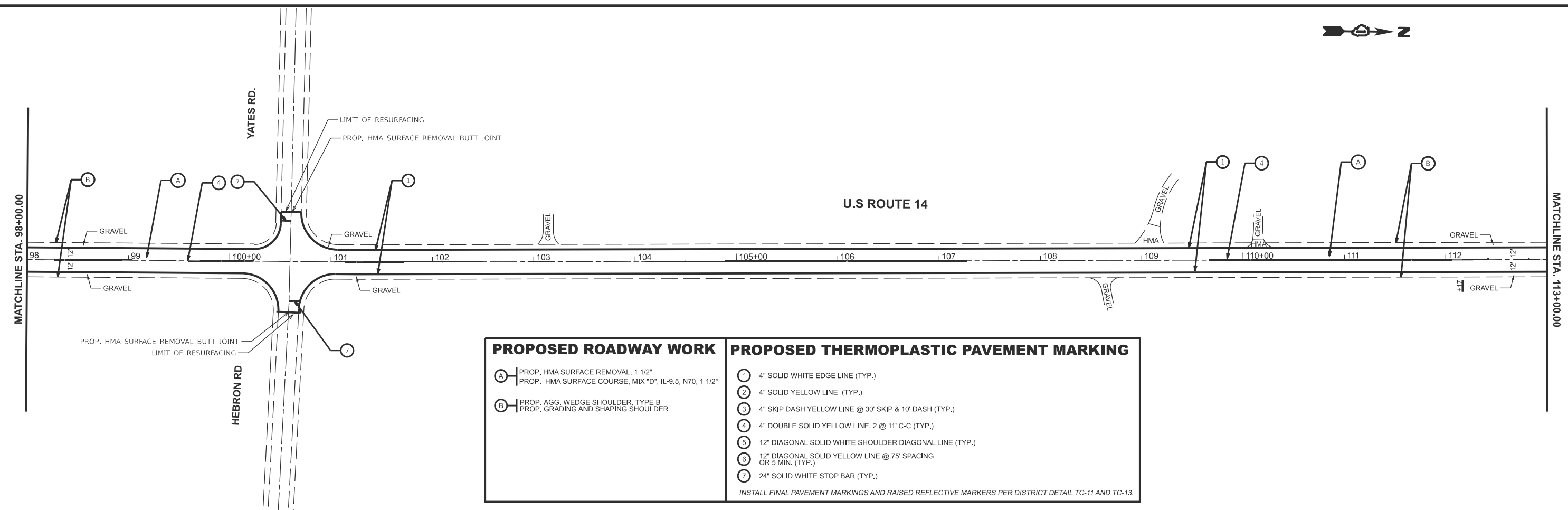

PROPOSED ROADWAY WORK	PROPOSED THERMOPLASTIC PAVEMENT MARKING
(A) PROP. HMA SURFACE REMOVAL, 1 1/2" PROP. HMA SURFACE COURSE, MIX "D", IL-9.5, N70, 1 1/2"	(1) 4" SOLID WHITE EDGE LINE (TYP.)
(B) PROP. AGG. WEDGE SHOULDER, TYPE B PROP. GRADING AND SHAPING SHOULDER	(2) 4" SOLID YELLOW LINE (TYP.)
	(3) 4" SKIP DASH YELLOW LINE @ 30' SKIP & 10' DASH (TYP.)
	(4) 4" DOUBLE SOLID YELLOW LINE, 2 @ 11' C-C (TYP.)
	(5) 12" DIAGONAL SOLID WHITE SHOULDER DIAGONAL LINE (TYP.)
	(6) 12" DIAGONAL SOLID YELLOW LINE @ 75' SPACING OR 5 MIN. (TYP.)
	(7) 24" SOLID WHITE STOP BAR (TYP.)
	INSTALL FINAL PAVEMENT MARKINGS AND RAISED REFLECTIVE MARKERS PER DISTRICT DETAIL TC-11 AND TC-13.

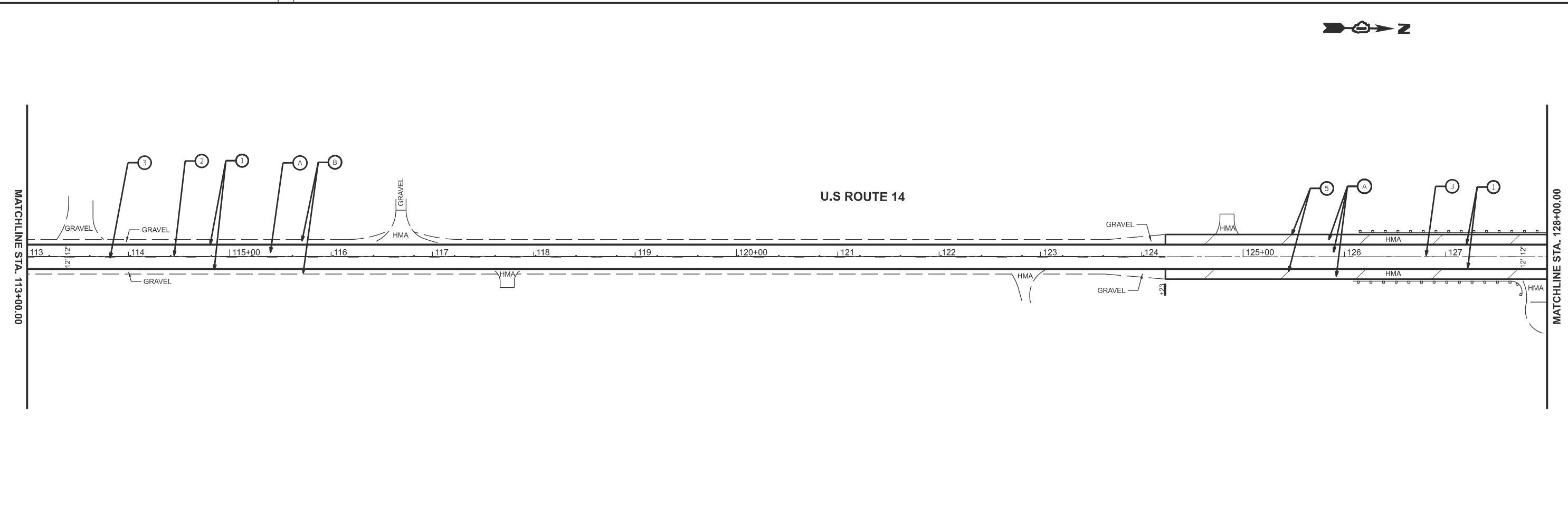

MODEL: US14\_E - Rdwy Plan 7 (Sheet)  
 FILE NAME: c:\pwworking\shirani\111961\116325-shr-plan.dgn

USER NAME = Sarah,Shirani	DESIGNED -	REVISED -
	DRAWN -	REVISED -
	CHECKED -	REVISED -
PLOT DATE = 11/21/2025	DATE -	REVISED -

**STATE OF ILLINOIS**  
**DEPARTMENT OF TRANSPORTATION**

**ROADWAY AND PAVEMENT MARKING PLAN**  
**US 14 - STATE LINE ROAD TO N OF OAK GROVE ROAD**

SCALE: 1"=50'    SHEET 4 OF 6 SHEETS    STA. 98+00.00 TO STA. 128+00.00

F.A.P. RTE.	SECTION	COUNTY	TOTAL SHEETS	SHEET NO.
066	2025-1098-RS	MCHENRY	16	8
CONTRACT NO. 80B10				
ILLINOIS FED. AID PROJECT				

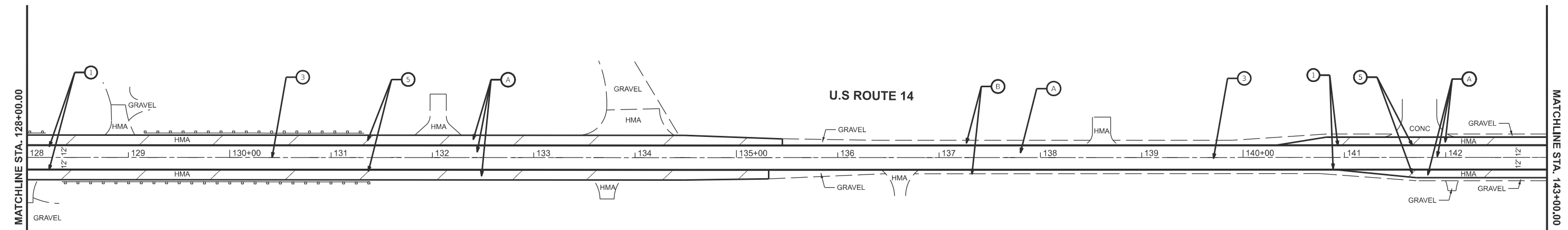

PROPOSED ROADWAY WORK		PROPOSED THERMOPLASTIC PAVEMENT MARKING	
(A)	PROP. HMA SURFACE REMOVAL, 1 1/2" PROP. HMA SURFACE COURSE, MIX "D", IL-9.5, N70, 1 1/2"	(1)	4" SOLID WHITE EDGE LINE (TYP.)
(B)	PROP. AGG. WEDGE SHOULDER, TYPE B PROP. GRADING AND SHAPING SHOULDER	(2)	4" SOLID YELLOW LINE (TYP.)
		(3)	4" SKIP DASH YELLOW LINE @ 30' SKIP & 10' DASH (TYP.)
		(4)	4" DOUBLE SOLID YELLOW LINE, 2 @ 11' C-C (TYP.)
		(5)	12" DIAGONAL SOLID WHITE SHOULDER DIAGONAL LINE (TYP.)
		(6)	12" DIAGONAL SOLID YELLOW LINE @ 75' SPACING OR 5 MIN. (TYP.)
		(7)	24" SOLID WHITE STOP BAR (TYP.)
INSTALL FINAL PAVEMENT MARKINGS AND RAISED REFLECTIVE MARKERS PER DISTRICT DETAIL TC-11 AND TC-13.			

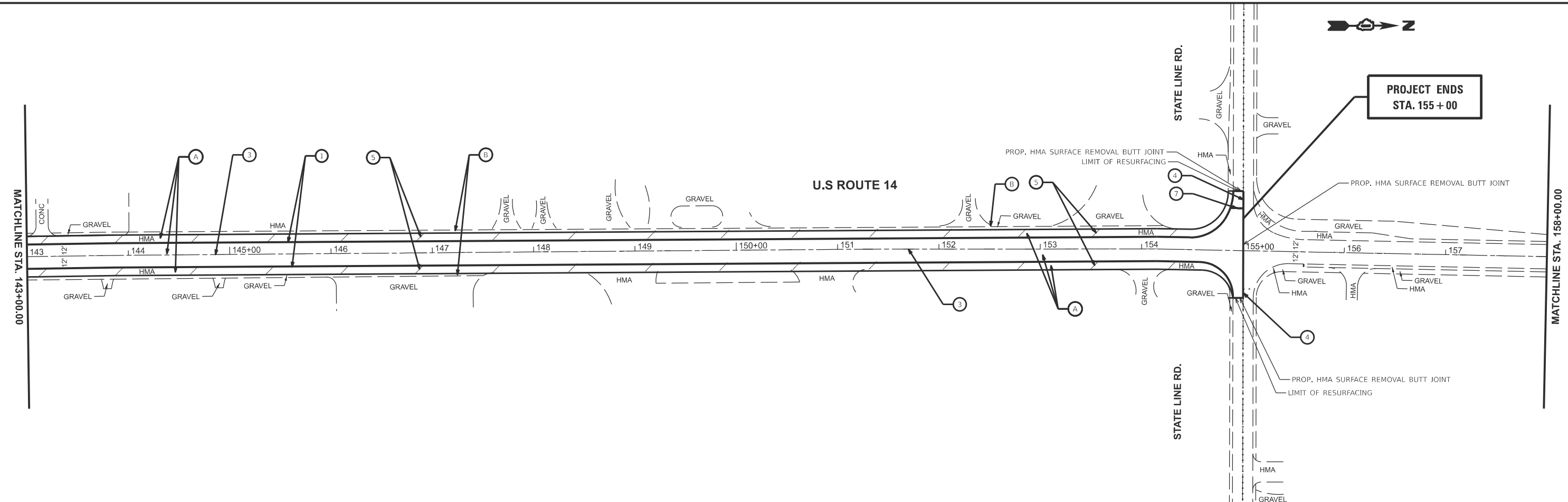

MODEL: US14\_E - Rdwy Plan 9 (Sheet)  
 FILE NAME: c:\pwworking\shirani\111961\116325-shr-plan.dgn

USER NAME = Sarah,Shirani	DESIGNED -	REVISED -
	DRAWN -	REVISED -
	CHECKED -	REVISED -
PLOT DATE = 11/21/2025	DATE -	REVISED -

**STATE OF ILLINOIS  
DEPARTMENT OF TRANSPORTATION**

**ROADWAY AND PAVEMENT MARKING PLAN  
US 14 - STATE LINE ROAD TO N OF OAK GROVE ROAD**

SCALE: 1"=50'      SHEET 5 OF 6 SHEETS      STA. 128+00.00 TO STA. 158+00.00

F.A.P. RTE.	SECTION	COUNTY	TOTAL SHEETS	SHEET NO.
066	2025-1098-RS	MCHENRY	16	9
CONTRACT NO. 80B10				
ILLINOIS FED. AID PROJECT				

## METHOD OF MEASUREMENT

REFER TO SECTION 442 OF THE STANDARD SPECIFICATIONS FOR ROAD AND BRIDGE CONSTRUCTION AND THE RECURRING SPECIAL PROVISION "PATCHING WITH HOT-MIX ASPHALT OVERLAY REMOVAL."

## BASIS OF PAYMENT

1. REFER TO SECTION 442 OF THE STANDARD SPECIFICATIONS FOR ROAD AND BRIDGE CONSTRUCTION AND THE RECURRING SPECIAL PROVISION "PATCHING WITH HOT-MIX ASPHALT OVERLAY REMOVAL."
2. SAW CUT/SCORING OF EXISTING HMA OVERLAY IS INCLUDED IN THE COST OF PAVEMENT PATCHING.
3. SAW CUT/SCORING OF EXISTING PAVEMENT IS INCLUDED IN THE COST OF PAVEMENT PATCHING.

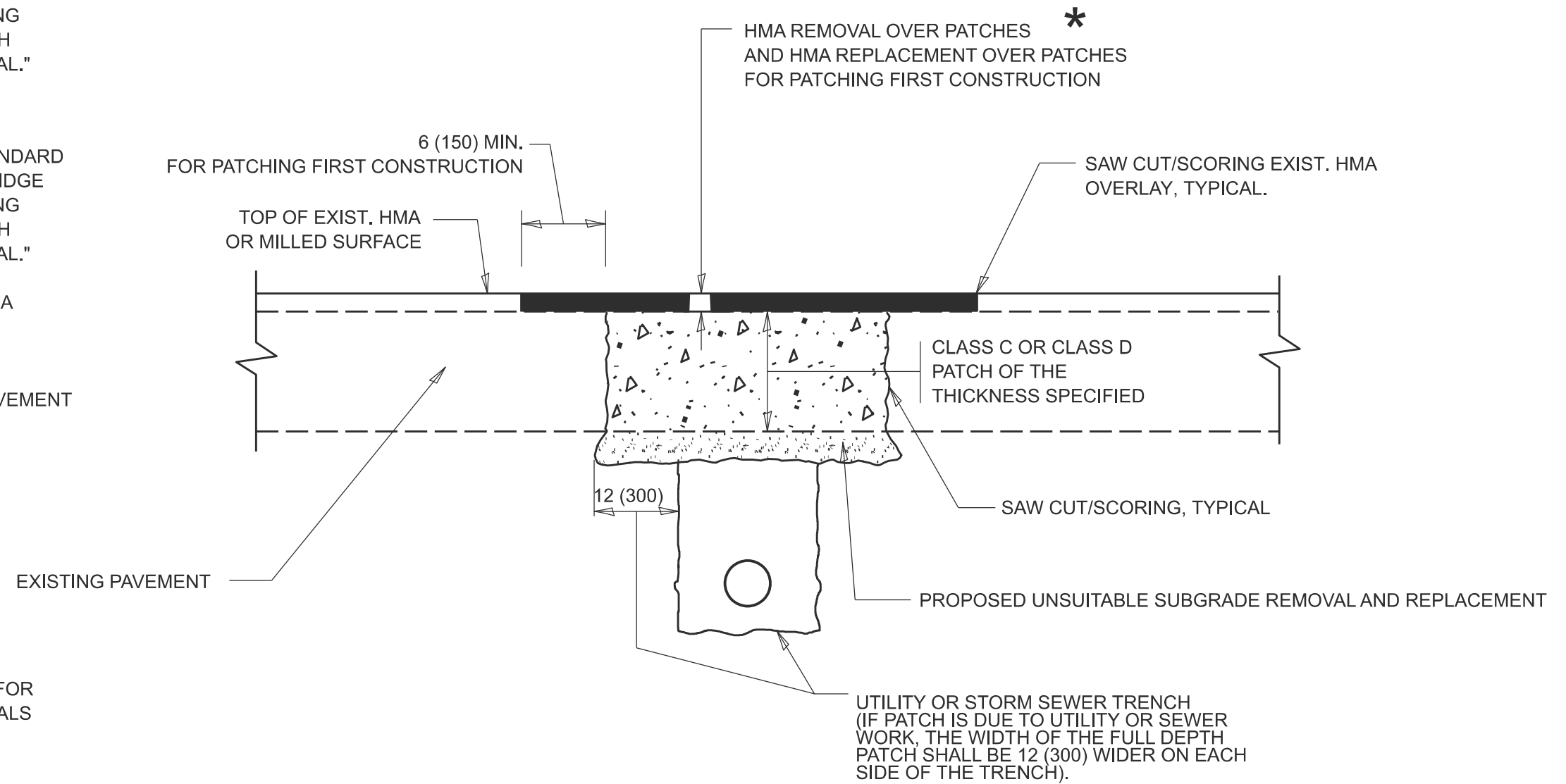

## SEQUENCE OF CONSTRUCTION (PATCHING FIRST)

1. REMOVE THE EXISTING HMA MATERIAL OVER THE AREA TO BE PATCHED.
2. REMOVE AND REPLACE WITH CLASS C OR D PATCH.
3. REPLACE HMA MATERIAL OVER THE AREA TO BE PATCHED.

## SEQUENCE OF CONSTRUCTION (MILLING FIRST)

1. MILL HMA FIRST IF THERE IS AT LEAST 4 ½ INCHES OR MORE OF HMA MATERIAL ON TOP OF THE EXISTING PAVEMENT OR IF THE PAVEMENT IS FULL DEPTH HMA. A MINIMUM OF 2 INCHES OF HMA MATERIAL SHALL BE IN PLACE AFTER MILLING.
2. REMOVE AND REPLACE WITH FULL DEPTH CLASS D PATCHES TO TOP OF MILLED SURFACE.

ALL DIMENSIONS ARE IN INCHES (MILLIMETERS) UNLESS OTHERWISE SHOWN.

MODEL: Plan Stride (Sheet)  
FILE NAME: \\illinois.gov\DOT\Users\COTTHOMASELM\Documents\Bentley\CONNECT1012\Organization-Civil\IDOT\_Standards\Drawings\Sheet Seede\Civil\_Named\_Boundary\_SheetSeeds.dgn

USER NAME = Eric.L.Thomas	DESIGNED - R. SHAH	REVISED - R. BORO 01-01-07
	DRAWN -	REVISED - R. BORO 09-04-07
	CHECKED -	REVISED - K. ENG 10-27-08
PLOT DATE = 8/20/2024	DATE - 10-25-94	REVISED - K. SMITH 11-18-22

STATE OF ILLINOIS  
DEPARTMENT OF TRANSPORTATION

PAVEMENT PATCHING FOR  
HMA SURFACED PAVEMENT

SCALE: NONE SHEET 1 OF 1 SHEETS STA. TO STA.

F.A.P. RTE.	SECTION	COUNTY	TOTAL SHEETS	SHEET NO.
066	2025-1098-RS	MCHENRY	16	10
BD400-04 (BD-22)			CONTRACT NO. 80B10	
ILLINOIS FED. AID PROJECT				

MODEL: Plan Stride (Sheet)  
 FILE NAME: \\illinois.gov\DOT\Users\COT\HOMASELM\My Documents\Bentley\CONNECT\1012\Organization-Civil\IDOT\_Standards\Drawings\Sheet Seede\Civil\_Named\_Boundary\_SheetSeeds.dgn

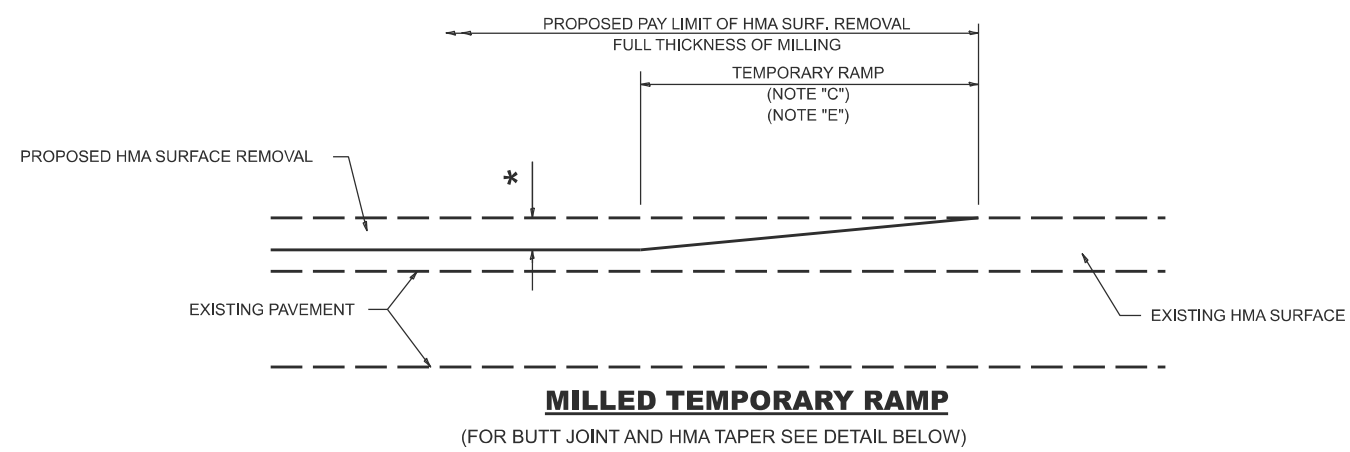

**OPTION 1**

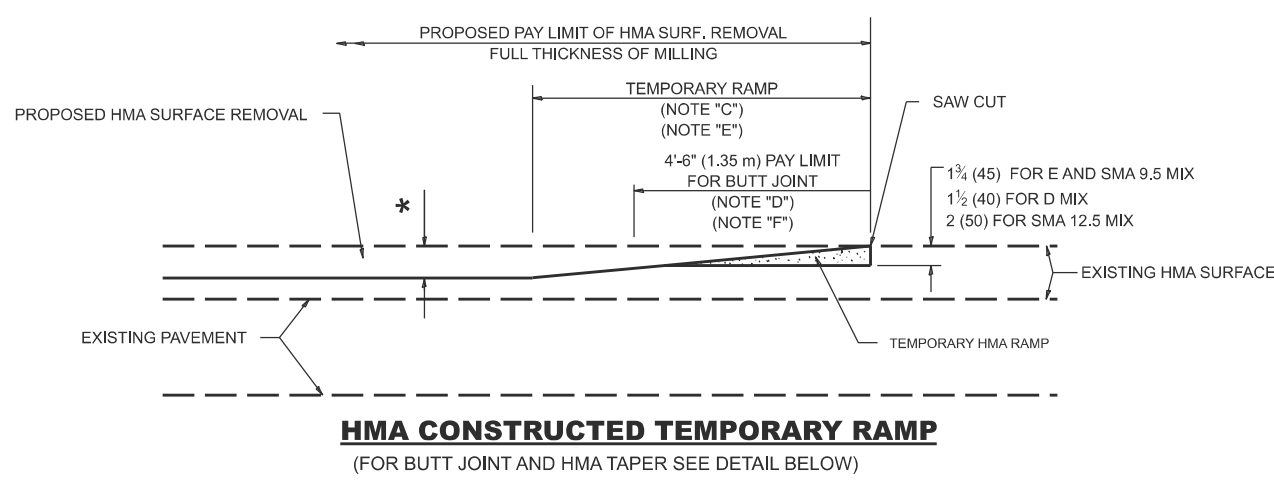

**OPTION 2**

**TYPICAL TEMPORARY RAMP**

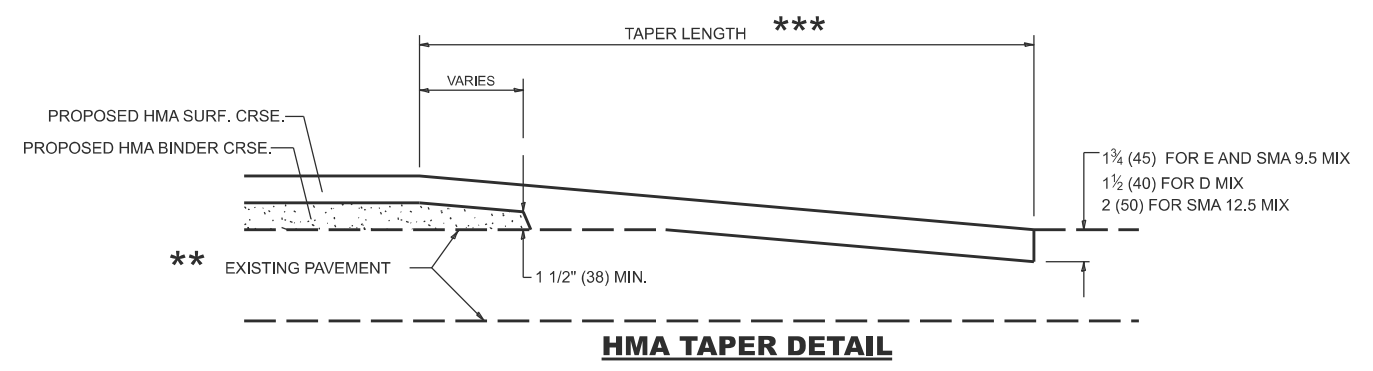
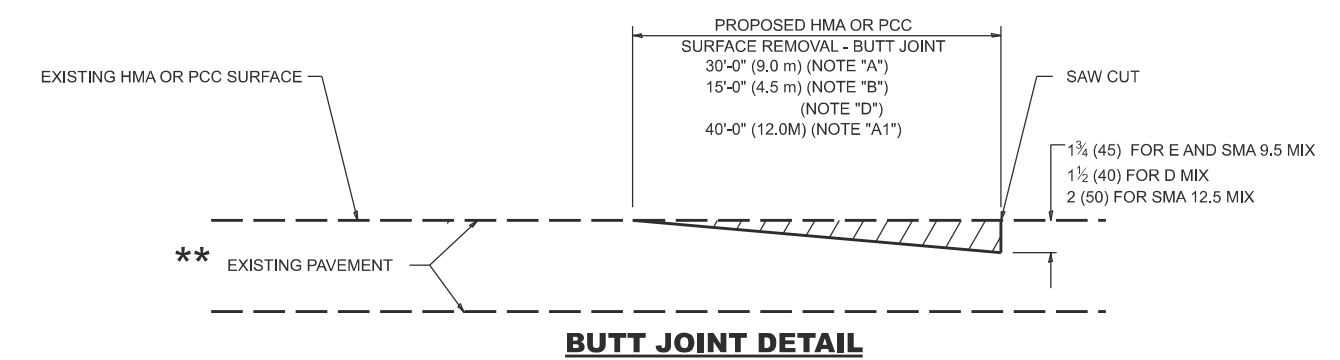

**TYPICAL BUTT JOINT AND HMA TAPER FOR RESURFACING ONLY**

\*\* PC CONCRETE, HMA OR HMA RESURFACED PAVEMENT.

**GENERAL NOTES**

- A. MAINLINE ARTERIAL ROADWAYS AND MAJOR SIDE ROADS.
- A1. INTERSTATES
- B. MINOR SIDE ROADS.
- C. THE TEMP. RAMP SHALL BE CONSTRUCTED IMMEDIATELY UPON REMOVAL OF THE EXISTING HMA SURFACE.
- D. THE BUTT JOINT SHALL BE CONSTRUCTED IMMEDIATELY PRIOR TO PLACING THE PROPOSED HMA COURSES.
- E. TAPER THE TEMP. RAMP AT A RATE OF 3' - 4" (1.02m) PER 1 INCH (25 mm) OF MILLING THICKNESS.  
 \* SEE TYPICAL SECTIONS FOR MILLING THICKNESS.
- F. SEE ARTICLE 406.08 AND 406.14 OF THE STANDARD SPECIFICATIONS FOR "HMA AND/OR PCC SURFACE REMOVAL, BUTT JOINT".  
 \*\*\*  
 20'-0" (6.1 m) PER 1 (25) RESURFACING (NOTE "A")  
 10'-0" (3.0 m) PER 1 (25) RESURFACING (NOTE "B")

**BASIS OF PAYMENT**

- 1. THE BUTT JOINT WILL BE PAID FOR AT THE CONTRACT UNIT PRICE PER SQUARE YARD (SQUARE METER) FOR "HOT-MIX ASPHALT SURFACE REMOVAL - BUTT JOINT" OR FOR "PORTLAND CEMENT CONCRETE SURFACE REMOVAL - BUTT JOINT".
- 2. THE TEMPORARY RAMP AND SAW CUT SHALL BE INCLUDED IN THE UNIT COST FOR HMA OR PCC SURFACE REMOVAL-BUTT JOINT.

ALL DIMENSIONS ARE IN INCHES (MILLIMETERS) UNLESS OTHERWISE SHOWN.

**TYPICAL BUTT JOINT AND HMA TAPER FOR MILLING AND RESURFACING**

USER NAME = Eric.L.Thomas	DESIGNED - M. DE YONG	REVISED - A. ABBAS 03-21-97
	DRAWN -	REVISED - M. GOMEZ 04-06-01
	CHECKED -	REVISED - R. BORO 01-01-07
PLOT DATE = 8/20/2024	DATE - 06-13-90	REVISED - K. SMITH 11-18-22

STATE OF ILLINOIS  
 DEPARTMENT OF TRANSPORTATION

BUTT JOINT AND  
 HMA TAPER DETAILS

SCALE: NONE SHEET 1 OF 1 SHEETS STA. TO STA.

F.A.P. RTE.	SECTION	COUNTY	TOTAL SHEETS	SHEET NO.
066	2025-1098-RS	MCHENRY	16	11
<b>BD400-05 BD-32</b>		CONTRACT NO. 80B10		
ILLINOIS FED. AID PROJECT				

MODEL: Plan Single (Sheet)  
 FILE NAME: \\illinois.gov\DOT\Users\COTTHOMASEL\My Documents\Bentley\CONNECT\1012\Organization-Civil\DOT\_Standards\Drawings\Sheet\Seeds\Civil\_Named\_Boundary\_Sheet\Seeds.dgn

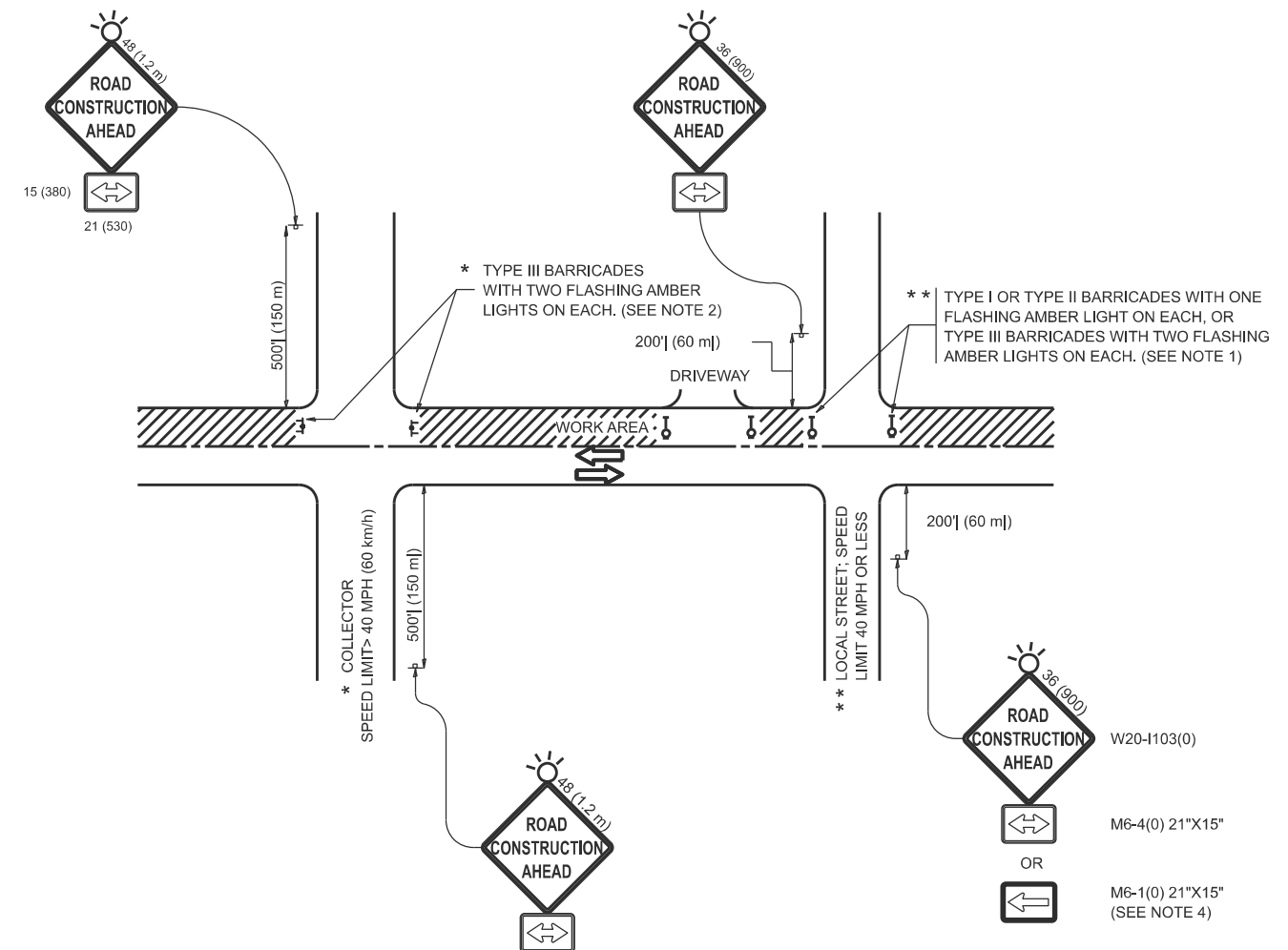

**NOTES:**

1. SIDE ROAD WITH A SPEED LIMIT OF 40 MPH (60 km/h) OR LESS AS SHOWN ON THE DRAWING AND AS DIRECTED BY THE ENGINEER:
  - a) ONE "ROAD CONSTRUCTION AHEAD" SIGN 36 x 36 (900x900) WITH A FLASHER MOUNTED ON IT APPROXIMATELY 200' (60 m) IN ADVANCE OF THE MAIN ROUTE.
  - b) THE CLOSED PORTION OF THE MAIN ROUTE SHALL BE PROTECTED BY BLOCKING WITH TYPE I, TYPE II OR TYPE III BARRICADES, 1/3 OF THE CROSS SECTION OF THE CLOSED PORTION.
2. SIDE ROAD WITH A SPEED LIMIT GREATER THAN 40 MPH (60 km/h) AS SHOWN ON THE DRAWING AND AS DIRECTED BY THE ENGINEER:
  - a) ONE "ROAD CONSTRUCTION AHEAD" SIGN 48 x 48 (1.2 m x 1.2 m) WITH A FLASHER MOUNTED ON IT APPROXIMATELY 500' (150 m) IN ADVANCE OF THE MAIN ROUTE.
  - b) THE CLOSED PORTION OF THE MAIN ROUTE SHALL BE PROTECTED BY BLOCKING WITH TYPE III BARRICADES, 1/2 OF THE CROSS SECTION OF THE CLOSED PORTION.
3. CONES MAY BE SUBSTITUTED FOR BARRICADES OR DRUMS AT HALF THE SPACING DURING DAY OPERATIONS. CONES SHALL BE A MINIMUM OF 28 (710) IN HEIGHT.
4. WHEN THE SIDE ROAD LIES BETWEEN THE BEGINNING OF THE MAINLINE SIGNING AND THE WORK ZONE, A SINGLE HEADED ARROW (M6-1) SHALL BE USED IN LIEU OF THE DOUBLE HEADED ARROW (M6-4).
5. WHEN WORK IS BEING PERFORMED ON A SIDE ROAD OR DRIVEWAY, FOLLOW THE APPLICABLE STANDARD(S). THE DIRECTIONAL ARROW (M6-1 OR M6-4) SHALL BE COVERED OR REMOVED WHEN NO LONGER CONSISTENT WITH THE TRAFFIC CONTROL SET-UP.
6. ADVANCE WARNING SIGNS ARE TO BE OMITTED ON DRIVEWAYS UNLESS OTHERWISE SPECIFIED IN THE PLANS OR BY THE ENGINEER.
7. THE TRAFFIC CONTROL AND PROTECTION FOR SIDE ROADS, INTERSECTIONS, AND DRIVEWAYS SHALL BE INCLUDED IN THE COST OF SPECIFIED TRAFFIC CONTROL STANDARDS OR ITEMS.

All dimensions are in inches (millimeters) unless otherwise shown.

USER NAME = Eric.L.Thomas	DESIGNED - L.H.A.	REVISED - T. RAMMACHER 01-06-00
	DRAWN -	REVISED - A. SCHUETZE 07-01-13
	CHECKED -	REVISED - A. SCHUETZE 09-15-06
PLOT DATE = 8/20/2024	DATE - 06-89	REVISED - D. SENDERAK 05-03-25

**STATE OF ILLINOIS  
 DEPARTMENT OF TRANSPORTATION**

**TRAFFIC CONTROL AND PROTECTION FOR  
 SIDE ROADS, INTERSECTIONS, AND DRIVEWAYS**

SCALE: SHEET OF SHEETS STA. TO STA.

F.A.P. RTE.	SECTION	COUNTY	TOTAL SHEETS	SHEET NO.
066	2025-1098-RS	MCHENRY	16	12
<b>TC-10</b>			CONTRACT NO. 80B10	
ILLINOIS FED. AID PROJECT				

MODEL: Plan Single (Sheet)  
 FILE NAME: \\illinois.gov\DOT\Users\COTTHOMASELM\Documents\Bentley\CONNECT\1012\Organization-Civil\IDOT\_Standards\Drawings\Sheet Seals\Civil\_Named\_Boundary\_SheetSeals.dgn

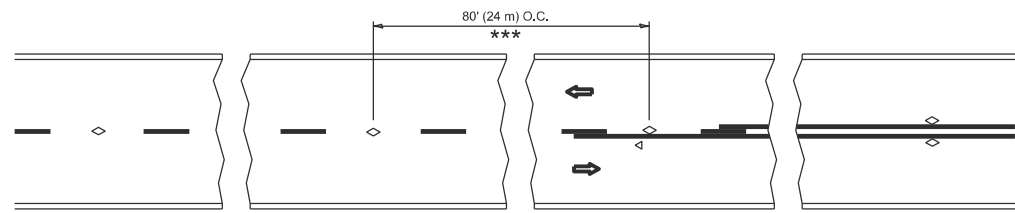

\*\*\* REDUCE TO 40' (12 m) O.C. ON CURVES WITH POSTED OR ADVISORY SPEED 45 M.P.H. (70 km/h) OR LESS.

**TWO-LANE/TWO-WAY**

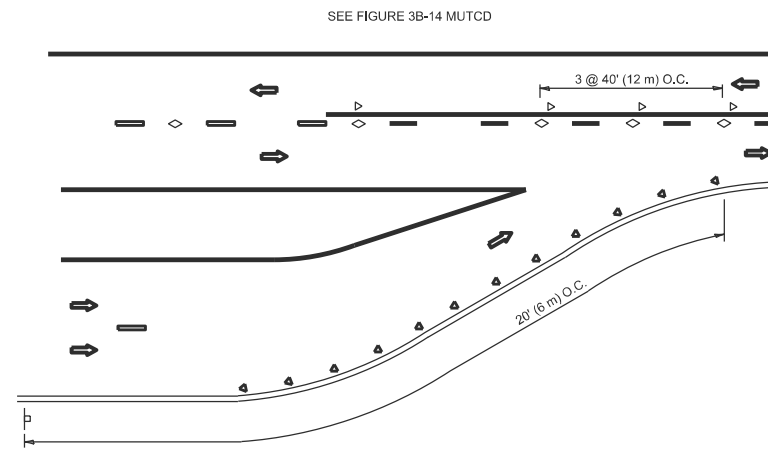

**LANE REDUCTION TRANSITION**

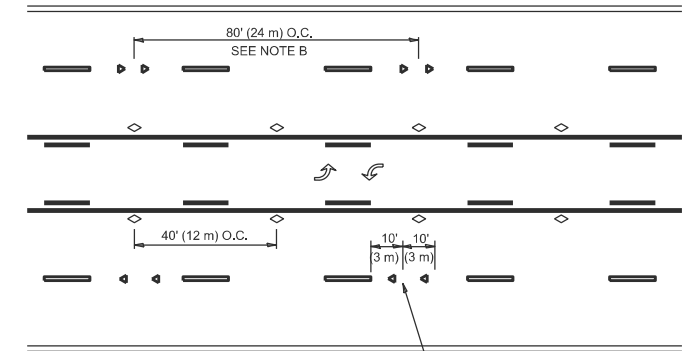

**TWO-WAY LEFT TURN**

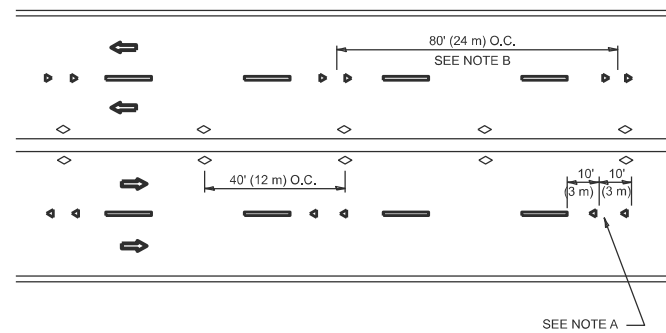

**MULTI-LANE/UNDIVIDED**

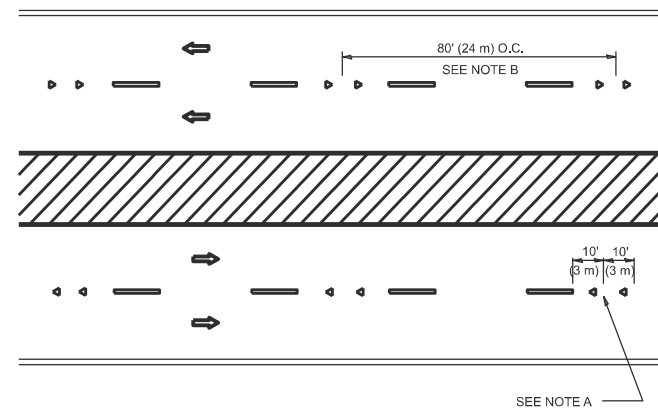

**MULTI-LANE/DIVIDED**

**GENERAL NOTES**

1. MARKERS USED WITH DASHED LINES SHALL BE CENTERED IN THE GAP BETWEEN SEGMENTS.
2. MARKERS USED ADJACENT TO SOLID LINES SHALL BE OFFSET 2 TO 3 (50 TO 75) TOWARD TRAFFIC AS SHOWN.
3. MARKERS THROUGH TANGENTS LESS THAN 500' (150 m) IN LENGTH BETWEEN CURVES SHALL BE INSTALLED AT THE LESSER OF THE TWO CURVE SPACINGS.
4. MARKERS ARE TO BE USED ADJACENT TO BOTH SOLID WHITE LINES IN DUAL LEFT TURN LANES

**SYMBOLS**

- YELLOW STRIPE
- WHITE STRIPE
- ◀ ONE-WAY AMBER MARKER
- ◀ ONE-WAY CRYSTAL MARKER (W/O)
- ◊ TWO-WAY AMBER MARKER

**LANE MARKER NOTES**

- A. USE DOUBLE LANE LINE MARKERS SPACED AS SHOWN.
- B. REDUCE TO 40' (12 m) O.C. ON CURVES WHERE ADVISORY SPEEDS ARE 10 M.P.H (20 km/h) LOWER THAN POSTED SPEEDS.

**DESIGN NOTES**

1. DOUBLE LANE LINE MARKERS SHALL BE USED UNLESS SPECIFIED OTHERWISE.
2. EXCEPT AS SHOWN ON THE LANE REDUCTION TRANSITION AND FREEWAY EXIT RAMP DETAIL, MARKERS ARE NOT TO BE SPECIFIED ON RIGHT EDGE LINES.
3. THE EXACT MARKER LIMITS, SPACING, AND COLOR SHALL BE INCLUDED IN THE PLANS WHEN STANDARD SPECIFICATIONS ARE NOT BEING USED.
4. MARKERS SHOULD NOT BE USED ALONGSIDE CURBS EXCEPT FOR EXTREMELY SHORT SECTIONS OF CURBS WHERE NOT MORE THAN TWO MARKERS WOULD BE INVOLVED.

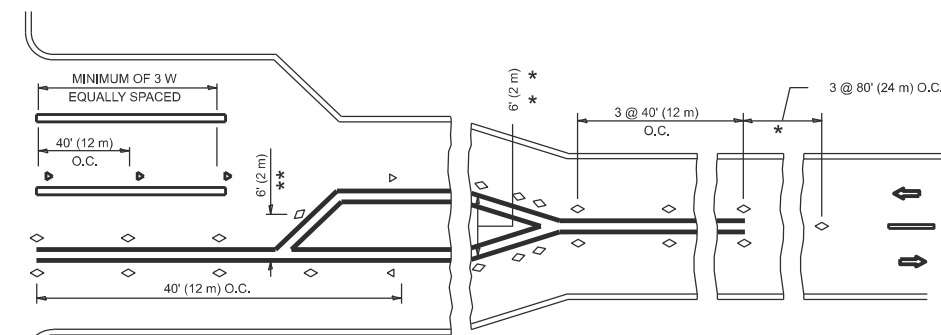
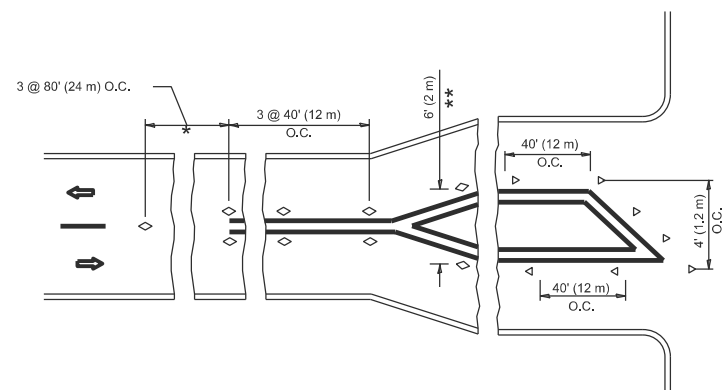

\* SEE TWO-LANE/TWO-WAY WHERE MARKERS CONTINUE  
 \*\* WHERE THE MEDIAN WIDTH IS 6' (2 m) OR LESS USE TWO-WAY MARKERS.

**TURN LANES**

All dimensions are in inches (millimeters) unless otherwise shown.

USER NAME = Eric.L.Thomas	DESIGNED -	REVISED - T. RAMMACHER 03-12-99
	DRAWN -	REVISED - T. RAMMACHER 01-06-00
	CHECKED -	REVISED - C. JUCIUS 09-09-09
PLOT DATE = 8/20/2024	DATE -	REVISED - C. JUCIUS 07-01-13

STATE OF ILLINOIS  
 DEPARTMENT OF TRANSPORTATION

TYPICAL APPLICATIONS  
 RAISED REFLECTIVE PAVEMENT MARKERS (SNOW-PLOW RESISTANT)

SCALE: NONE SHEET 1 OF 1 SHEETS STA. TO STA.

F.A.P. RTE.	SECTION	COUNTY	TOTAL SHEETS	SHEET NO.
066	2025-1098-RS	MCHENRY	16	13
TC-11			CONTRACT NO. 80B10	
ILLINOIS FED. AID PROJECT				

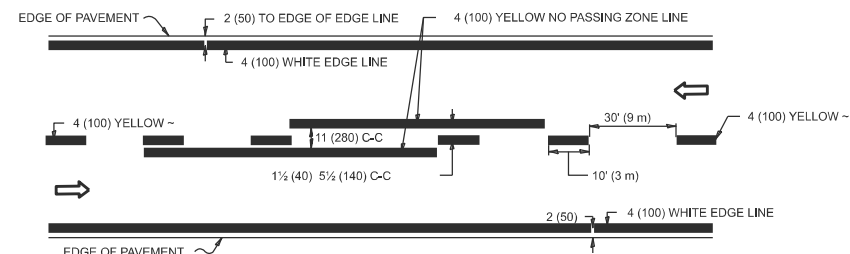

**2-LANE ROADWAY**

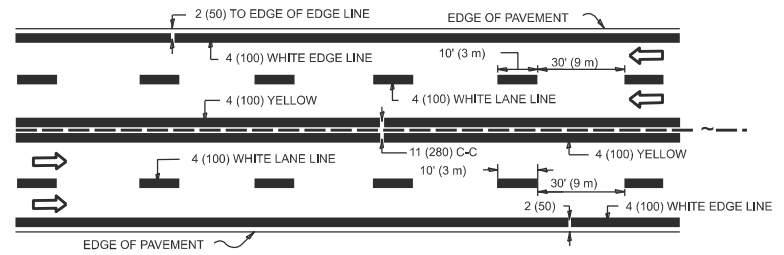

**MULTI-LANE UNDIVIDED**

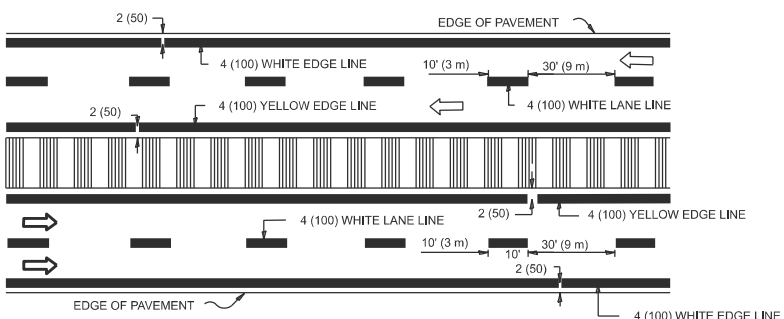

**MULTI-LANE DIVIDED WITH MEDIAN**

**TYPICAL LANE AND EDGE LINE MARKING**

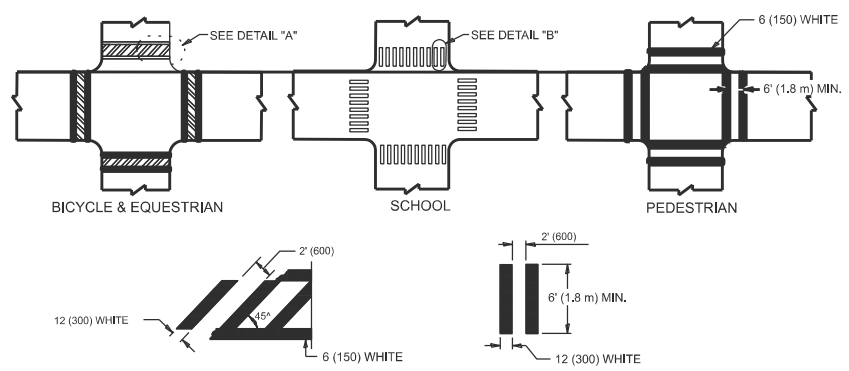

**DETAIL "A"**

**DETAIL "B"**

**TYPICAL CROSSWALK MARKING**

\* MARKINGS SHALL BE INSTALLED PARALLEL TO THE CENTERLINE OF THE ROAD WHICH IT CROSSES

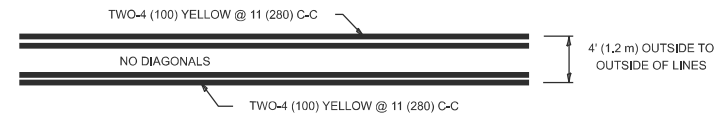

**4' (1.2 m) WIDE MEDIANS ONLY**

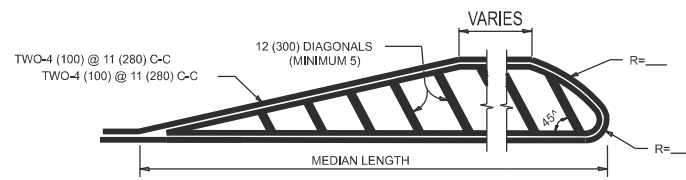

**MEDIANS OVER 4' (1.2 m) WIDE**

DIAGONAL LINE SPACING: 50' (15 m) C-C (LESS THAN 30MPH (50 km/h))  
75' (25 m) C-C 30MPH (50 km/h) TO 45MPH (70 km/h)  
150' (45 m) C-C (MORE THAN 45MPH (70 km/h))

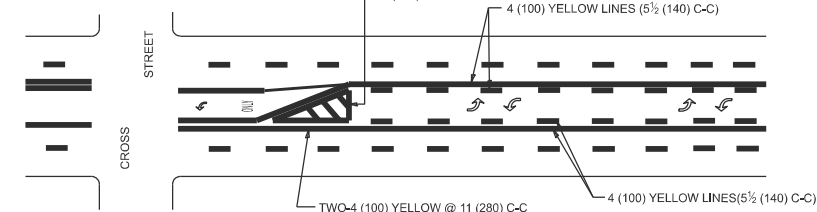

**MEDIAN WITH TWO-WAY LEFT TURN LANE TYPICAL PAINTED MEDIAN MARKING**

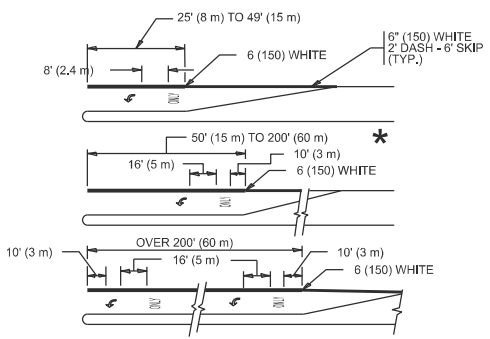

**TYPICAL LEFT (OR RIGHT) TURN LANE**

**TYPICAL TURN LANE MARKING**

FULL SIZE LETTERS 8' (2.4 m) AND ARROWS SHALL BE USED. AREA = 15.6 SQ. FT. (1.5 m<sup>2</sup>) ONLY AREA = 20.8 SQ. FT. (1.9 m<sup>2</sup>)

\* TURN LANES IN EXCESS OF 400' (120 m) IN LENGTH MAY HAVE AN ADDITIONAL SET OF ARROW - "ONLY" INSTALLED MIDWAY BETWEEN THE OTHER TWO SETS OF ARROW - "ONLY".

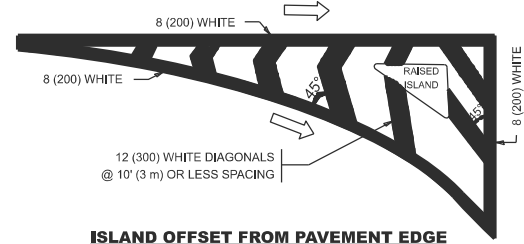

**ISLAND OFFSET FROM PAVEMENT EDGE**

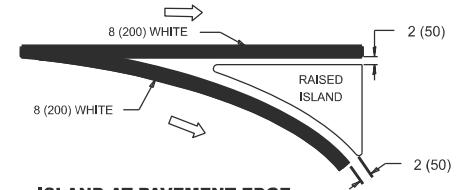

**ISLAND AT PAVEMENT EDGE**

**TYPICAL ISLAND MARKING**

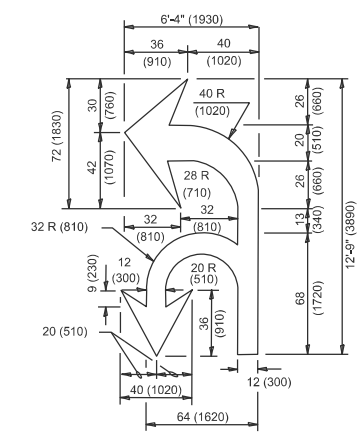

**COMBINATION LEFT AND U-TURN**

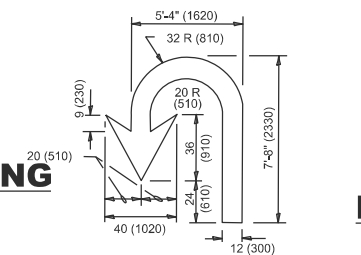

**U-TURN**

**LANE REDUCTION TRANSITION**

\* LANE REDUCTION ARROWS REQUIRED AT SPEEDS OF 45 MPH OR GREATER OR WHEN SPECIFIED IN PLANS.

D(FT)	SPEED LIMIT
345	30
425	35
500	40
580	45
665	50
750	55

TYPE OF MARKING	WIDTH OF LINE	PATTERN	COLOR	SPACING / REMARKS
CENTERLINE ON 2 LANE PAVEMENT	4 (100)	SKIP-DASH	YELLOW	10' (3 m) LINE WITH 30' (9 m) SPACE
CENTERLINE ON MULTI-LANE UNDIVIDED PAVEMENT	2 @ 4 (100)	SOLID	YELLOW	11 (280) C-C
NO PASSING ZONE LINES: FOR ONE DIRECTION FOR BOTH DIRECTIONS	4 (100) 2 @ 4 (100)	SOLID SOLID	YELLOW YELLOW	5 1/2 (140) C-C FROM SKIP-DASH CENTERLINE 11 (280) C-C OMIT SKIP-DASH CENTERLINE BETWEEN
LANE LINES	4 (100) 5 (125) ON FREEWAYS	SKIP-DASH SKIP-DASH	WHITE WHITE	10' (3 m) LINE WITH 30' (9 m) SPACE
DOTTED LINES (EXTENSIONS OF CENTER, LANE OR TURN LANE MARKINGS)	SAME AS LINE BEING EXTENDED	SKIP-DASH	SAME AS LINE BEING EXTENDED	2' (600) LINE WITH 6' (1.8 m) SPACE
EDGE LINES	4 (100)	SOLID	YELLOW-LEFT WHITE-RIGHT	OUTLINE MEDIANS IN YELLOW
TURN LANE MARKINGS	6 (150) LINE: FULL SIZE LETTERS & SYMBOLS (8' (2.4m))	SOLID	WHITE	SEE TYPICAL TURN LANE MARKING DETAIL
TWO WAY LEFT TURN MARKING	2 @ 4 (100) EACH DIRECTION 8' (2.4m) LEFT ARROW	SKIP-DASH AND SOLID IN PAIRS	YELLOW WHITE	10' (3 m) LINE WITH 30' (9 m) SPACE FOR SKIP-DASH; 5 1/2 (140) C-C BETWEEN SOLID LINE AND SKIP-DASH LINE SEE TYPICAL TWO-WAY LEFT TURN MARKING DETAIL
CROSSWALK LINES (PEDESTRIAN) A. DIAGONALS (BIKE & EQUESTRIAN) B. LONGITUDINAL BARS (SCHOOL)	2 @ 6 (150) 12 (300) @ 45° 12 (300) @ 90°	SOLID SOLID SOLID	WHITE WHITE WHITE	NOT LESS THAN 6' (1.8 m) APART 2' (600) APART 2' (600) APART SEE TYPICAL CROSSWALK MARKING DETAILS.
STOP LINES	24 (600)	SOLID	WHITE	PLACE 4' (1.2 m) IN ADVANCE OF AND PARALLEL TO CROSSWALK, IF PRESENT. OTHERWISE, PLACE AT DESIRED STOPPING POINT, PARALLEL TO CROSSROAD CENTERLINE, WHERE POSSIBLE
PAINTED MEDIANS	2 @ 4 (100) WITH 12 (300) DIAGONALS @ 45° NO DIAGONALS USED FOR 4' (1.2 m) WIDE MEDIANS	SOLID	YELLOW: TWO WAY TRAFFIC WHITE: ONE WAY TRAFFIC	11 (280) C-C FOR THE DOUBLE LINE SEE TYPICAL PAINTED MEDIAN MARKING.
GORE MARKING AND CHANNELIZING LINES	8 (200) WITH 12 (300) DIAGONALS @ 45°	SOLID	WHITE	DIAGONALS: 15' (4.5 m) C-C (LESS THAN 30MPH (50 km/h)) 20' (6 m) C-C 30MPH (50 km/h) TO 45MPH (70 km/h) 30' (9 m) C-C (OVER 45MPH (70 km/h))
RAILROAD CROSSING	24 (600) TRANSVERSE LINES: "RR" IS 6' (1.8 m) LETTERS: 16 (400) LINE FOR "X"	SOLID	WHITE	SEE STATE STANDARD 780001 AREA OF: "R"=3.8 SQ. FT. (0.33 m <sup>2</sup> ) EACH "X"=54.0 SQ. FT. (5.0 m <sup>2</sup> )
SHOULDER DIAGONALS (REQUIRED FOR SHOULDERS ≥ 8')	12 (300) @ 45°	SOLID	WHITE - RIGHT YELLOW - LEFT	50' (15 m) C-C (LESS THAN 30MPH (50 km/h)) 75' (25 m) C-C 30 MPH (50 km/h) TO 45MPH (70 km/h) 150' (45 m) C-C (OVER 45MPH (70 km/h))
U TURN ARROW	SEE DETAIL	SOLID	WHITE	16.3 SF
2 ARROW COMBINATION LEFT AND U TURN	SEE DETAIL	SOLID	WHITE	30.4 SF

FOR FURTHER DETAILS ON PAVEMENT MARKING REFER TO STANDARD SPECIFICATIONS FOR ROAD AND BRIDGE CONSTRUCTION AND STATE STANDARD 780001.

All dimensions are in inches (millimeters) unless otherwise shown.

MODEL: Plan Single (Sheet) FILE NAME: \\illinois.gov\DOT\Users\COTTHOMAS\My Documents\Bentley\CONNECT\1012\Organization-Civil\DOT\_Standards\Drawings\Sheet\Standards\Boundary\_Sheet\Seeds.dgn

USER NAME = Eric.L.Thomas	DESIGNED - EVERS	REVISED - C. JUCIUS 09-09-09
	DRAWN -	REVISED - C. JUCIUS 07-01-13
	CHECKED -	REVISED - C. JUCIUS 12-21-15
PLOT DATE = 8/20/2024	DATE - 03-19-90	REVISED - C. JUCIUS 04-12-16

**STATE OF ILLINOIS DEPARTMENT OF TRANSPORTATION**

**DISTRICT ONE TYPICAL PAVEMENT MARKINGS**

SCALE: NONE	SHEET 1 OF 1 SHEETS	STA. TO STA.
-------------	---------------------	--------------

F.A.P RTE. 066	SECTION 2025-1098-RS	COUNTY MCHENRY	TOTAL SHEETS 16	SHEET NO. 14
<b>TC-13</b>		CONTRACT NO. 80B10		
ILLINOIS		FED. AID PROJECT		

MODEL: Plan Stride (Sheet)  
 FILE NAME: \\illinois.gov\DOT\Users\COTTHOMASELM\Documents\Bentley\CONNECT\1012\Organization-Civil\IDOT\_Standards\Drawings\Sheet Seeds\Civil\_Named\_Boundary\_SheetSeeds.dgn

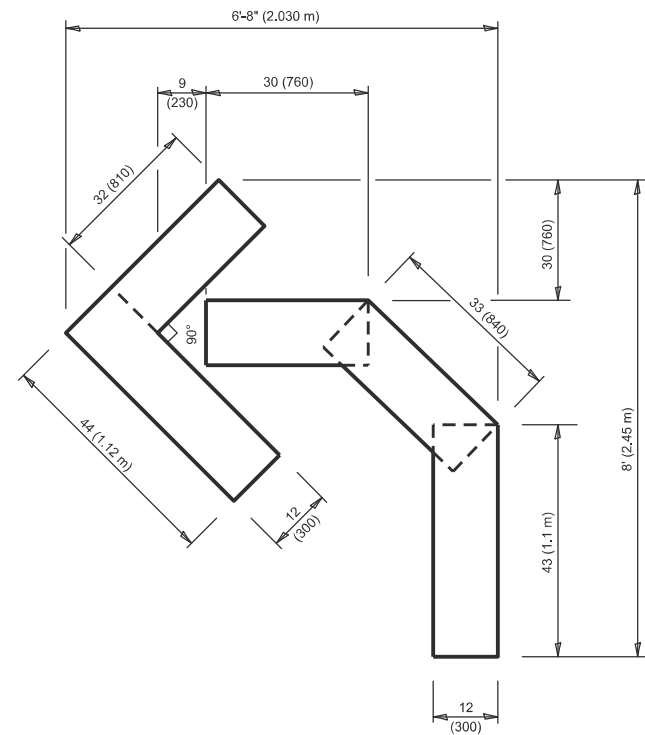

**QUANTITY**

4 (100) LINE = 45.5 ft. (13.9 m)  
 15.2 sq. ft. (1.41 sq. m)

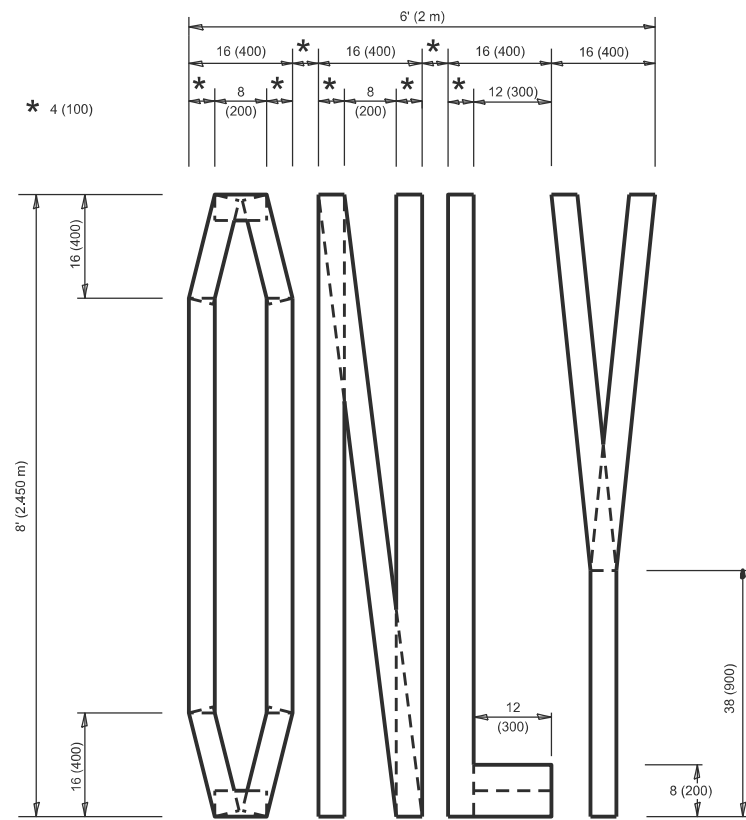

**QUANTITY**

4 (100) LINE = 64.1 ft. (19.5 m)  
 21.4 sq. ft. (1.99 sq. m)

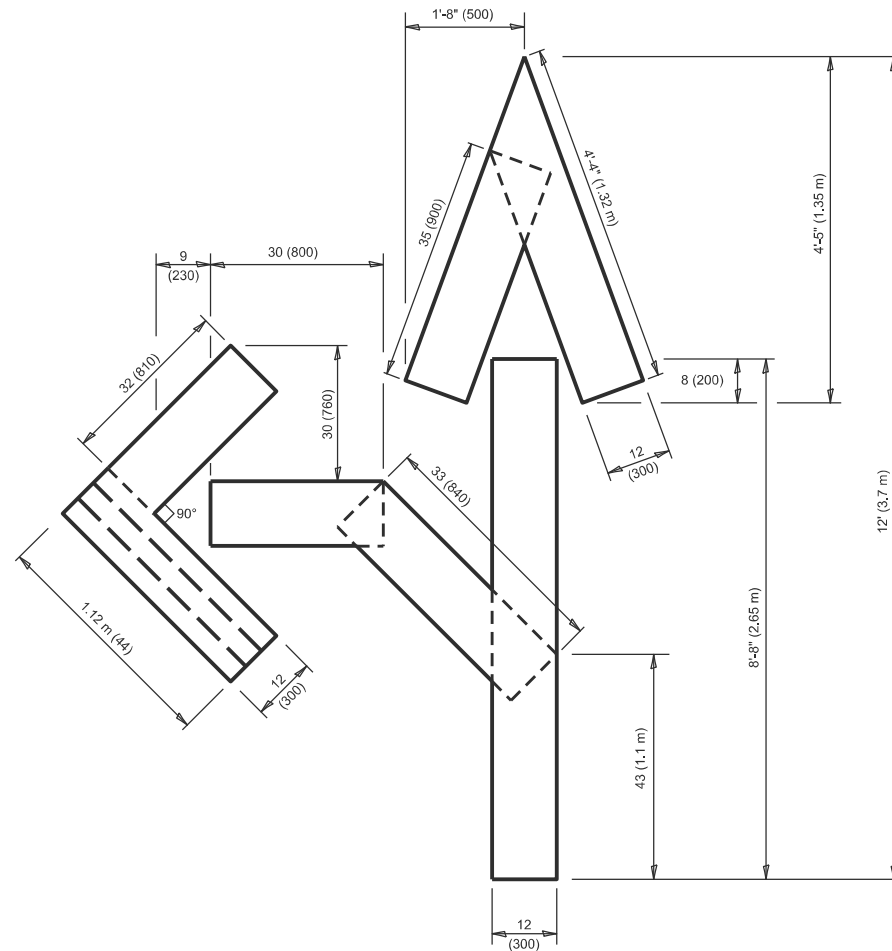

**QUANTITY**

4 (100) LINE = 82.5 ft. (25.1 m)  
 27.5 sq. ft. (2.53 sq. m)

**NOTE:**

ALL QUANTITIES OF PLACEMENT ARE REPRESENTED IN LINEAR FEET OF 4" LINES TO MATCH THE 4" TEMPORARY TAPE PAY ITEM AND REPRESENTS THE TOTAL QUANTITY OF 4" TAPE REQUIRED.

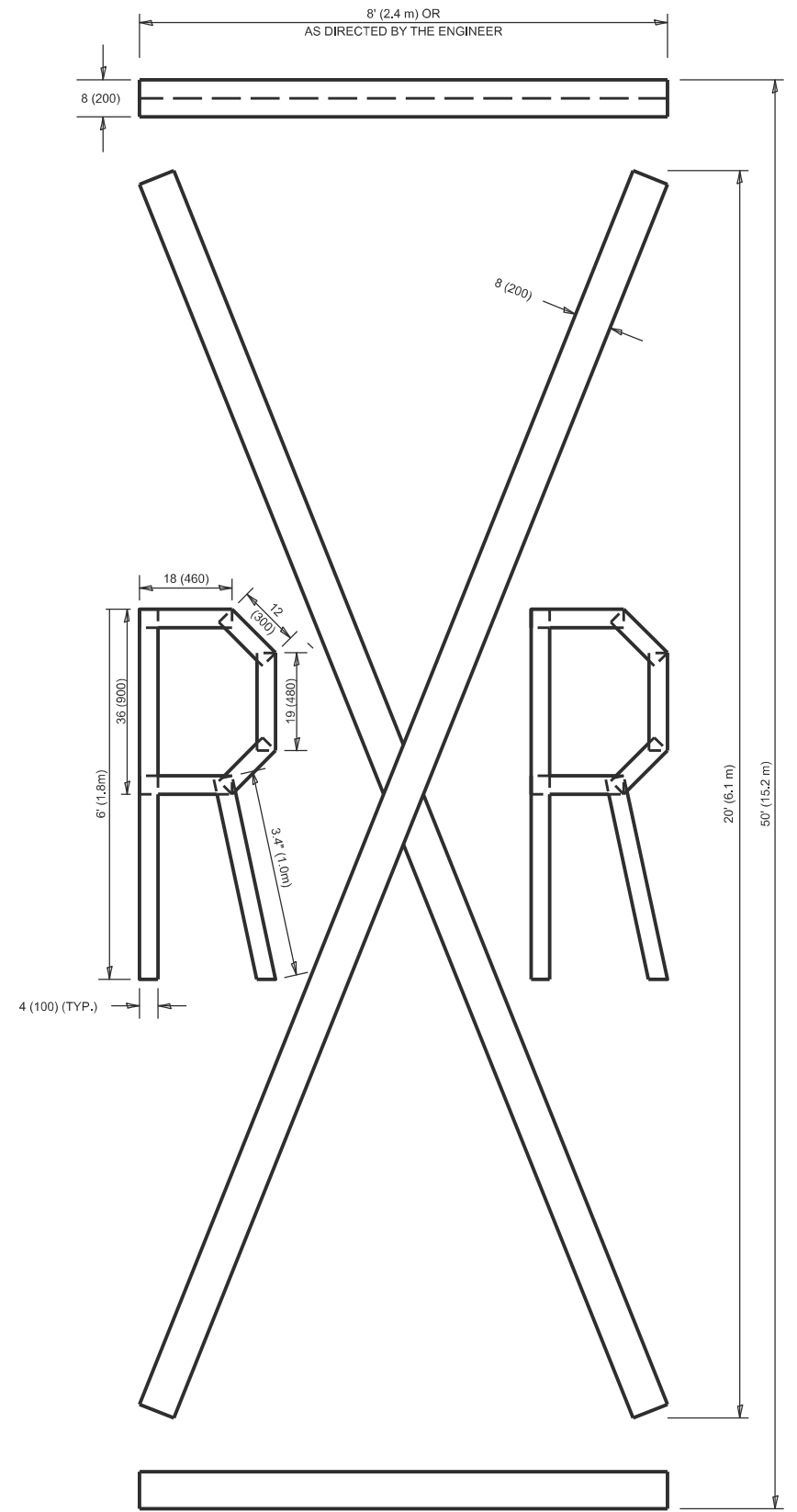

**QUANTITY**

4 (100) LINE = 225.9 ft. (68.9 m)  
 75.3 sq. ft. (6.99 sq. m)

All dimensions are in inches (millimeters) unless otherwise shown.

USER NAME = Eric.L.Thomas	DESIGNED -	REVISED - T. RAMMACHER 03-02-98
	DRAWN -	REVISED - E. GOMEZ 08-28-00
	CHECKED -	REVISED - E. GOMEZ 08-28-00
PLOT DATE = 8/20/2024	DATE - 09-18-94	REVISED - A. SCHUETZE 09-15-16

**STATE OF ILLINOIS  
 DEPARTMENT OF TRANSPORTATION**

**SHORT TERM PAVEMENT MARKING LETTERS AND SYMBOLS**

SCALE: NONE SHEET 1 OF 1 SHEETS STA. TO STA.

F.A.P. RTE.	SECTION	COUNTY	TOTAL SHEETS	SHEET NO.
066	2025-1098-RS	MCHENRY	16	15
<b>TC-16</b>		CONTRACT NO. 80B10		
ILLINOIS FED. AID PROJECT				

MODEL: Plan Single (Sheet)  
 FILE NAME: \\illinois.gov\DOT\Users\COTTHOMASELM\Documents\Bentley\CONNECT\1012\Organization-Civil\DOT\_Standards\Drawings\Sheet Seede\Civil\_Named\_Boundary\_SheetSeeds.dgn\lib

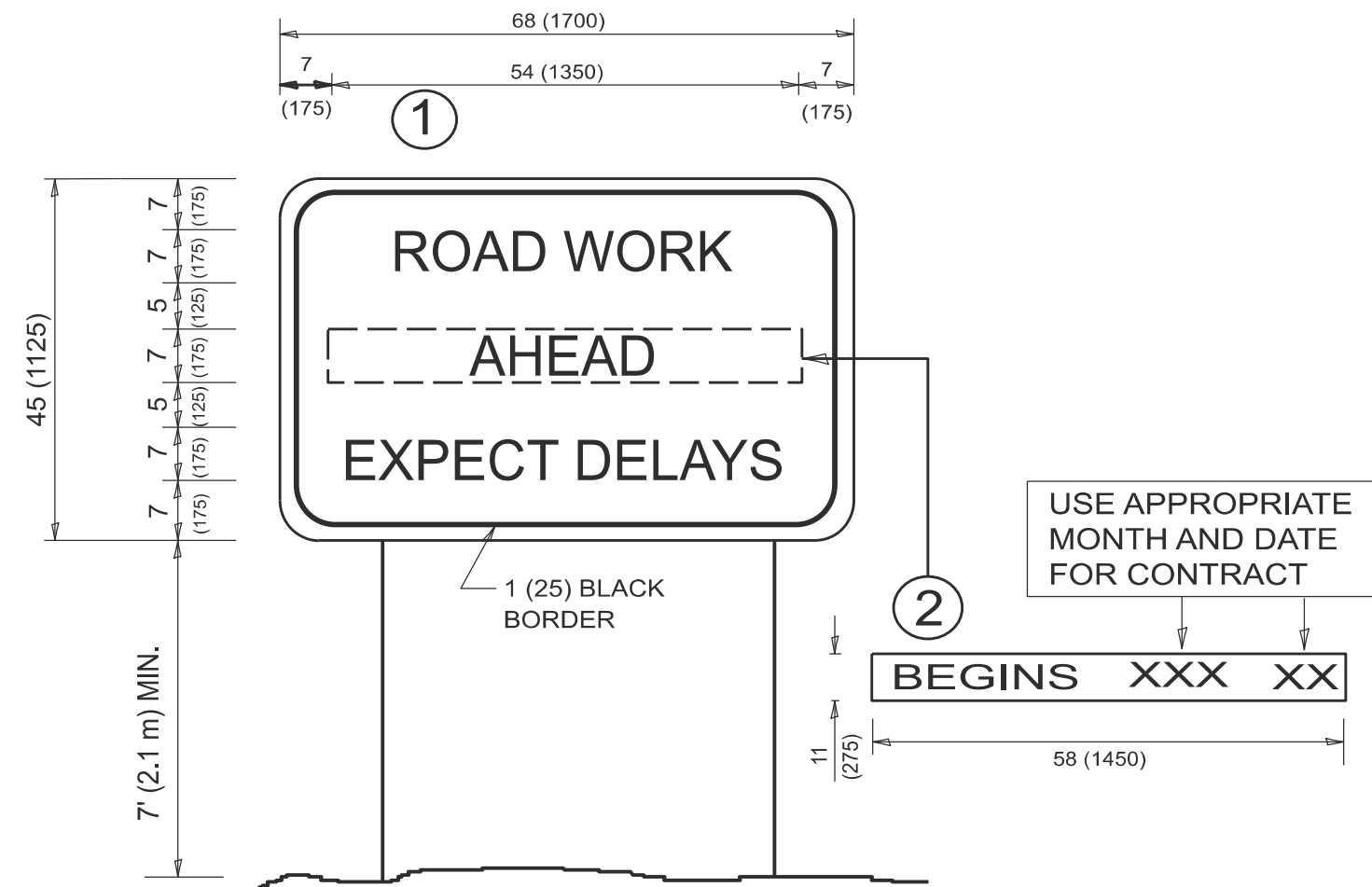

**NOTES:**

1. USE BLACK LETTERING ON ORANGE BACKGROUND.
2. ERECT SIGNS IN ADVANCE OF THE LOCATION FOR THE "ROAD CONSTRUCTION AHEAD" SIGN AT LOCATIONS AS DIRECTED BY THE ENGINEER.
3. ERECT SIGN ① WITH INSTALLED PANEL ② ONE WEEK PRIOR TO THE START OF CONSTRUCTION.
4. REMOVE PANEL ② SOON AFTER THE START OF CONSTRUCTION.
5. SEE SPECIAL PROVISION FOR "TEMPORARY INFORMATION SIGNING" FOR ADDITIONAL INFORMATION.
6. ONE SIGN ASSEMBLY EQUALS 25.70 SQ. FT. (2.3 SQ. M.)
7. SHALL BE PAID FOR AS TEMPORARY INFORMATION SIGNING.

ALL DIMENSIONS ARE IN INCHES (MILLIMETERS)  
 UNLESS OTHERWISE SHOWN.

USER NAME = Eric.L.Thomas	DESIGNED -	REVISED - R. MIRS 09-15-97	<b>STATE OF ILLINOIS DEPARTMENT OF TRANSPORTATION</b>	<b>ARTERIAL ROAD INFORMATION SIGN</b>			F.A.P. RTE.	SECTION	COUNTY	TOTAL SHEETS	SHEET NO.
	DRAWN -	REVISED - R. MIRS 12-11-97					066	2025-1098-RS	MCHENRY	16	16
	CHECKED -	REVISED - T. RAMMACHER 02-02-99		<b>TC-22</b>			CONTRACT NO. 80B10				
PLOT DATE = 8/20/2024	DATE -	REVISED - C. JUCIUS 01-31-07		SCALE: NONE	SHEET 1	OF 1 SHEETS	STA.	TO STA.			