

04-24-2026 LETTING ITEM 121

FOR INDEX OF SHEETS, SEE SHEET NO. 2

FOR SUMMARY OF QUANTITIES, SEE SHEET NO. 3

STATE OF ILLINOIS DEPARTMENT OF TRANSPORTATION

PROPOSED HIGHWAY PLANS

FAI ROUTE 55 (I-55/I-74/US 51) SECTION (57-6,7,20)PP PATCHING MCLEAN COUNTY

F.A.I. RTE	SECTION	COUNTY	TOTAL SHEETS	SHEET NO.
55	(57-6,7,20)PP	MCLEAN	13	1
		ILLINOIS	CONTRACT NO. 70H85	

CURRENT TRAFFIC DATA

FAI 55/74

LEG "A"

2025 ADT = 43,100
 P.U. & P.C.% = 62.7
 SU% = 4.1
 MU% = 33.2

TRAFFIC DATA LOCATION

LEG "A" = I-55 FROM FOX CREEK RD TO N. OF WASHINGTON ST IN BLOOMINGTON

D-95-014-26

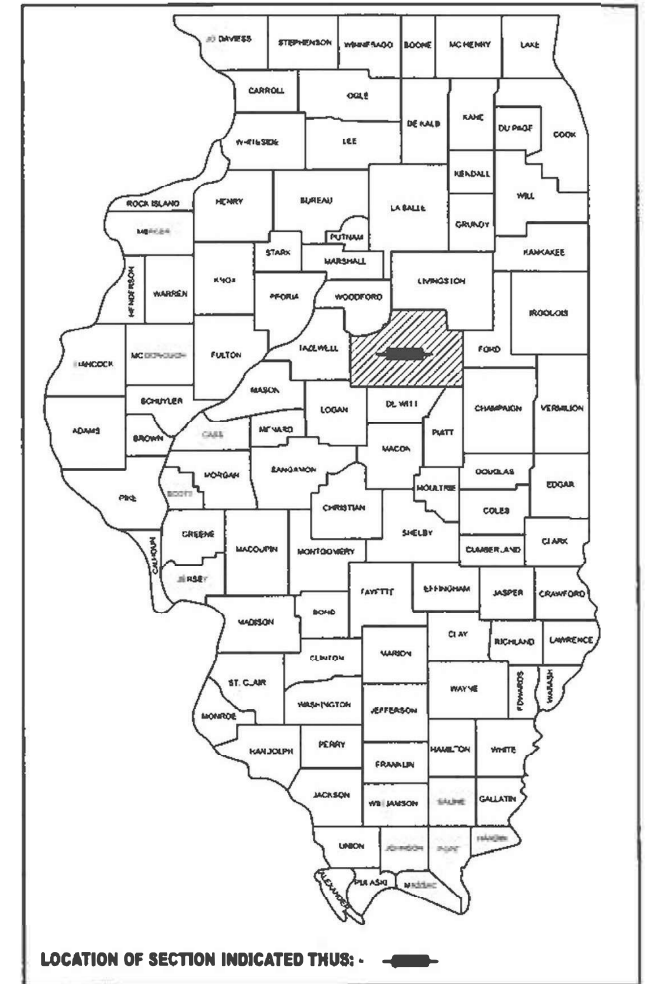

C-95-021-26

FOX CREEK RD TO N OF WASHINGTON ST IN BLOOMINGTON

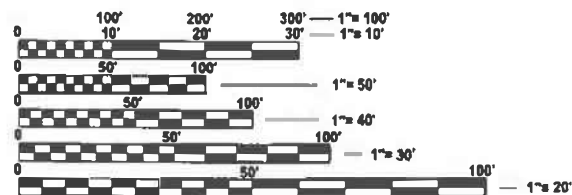
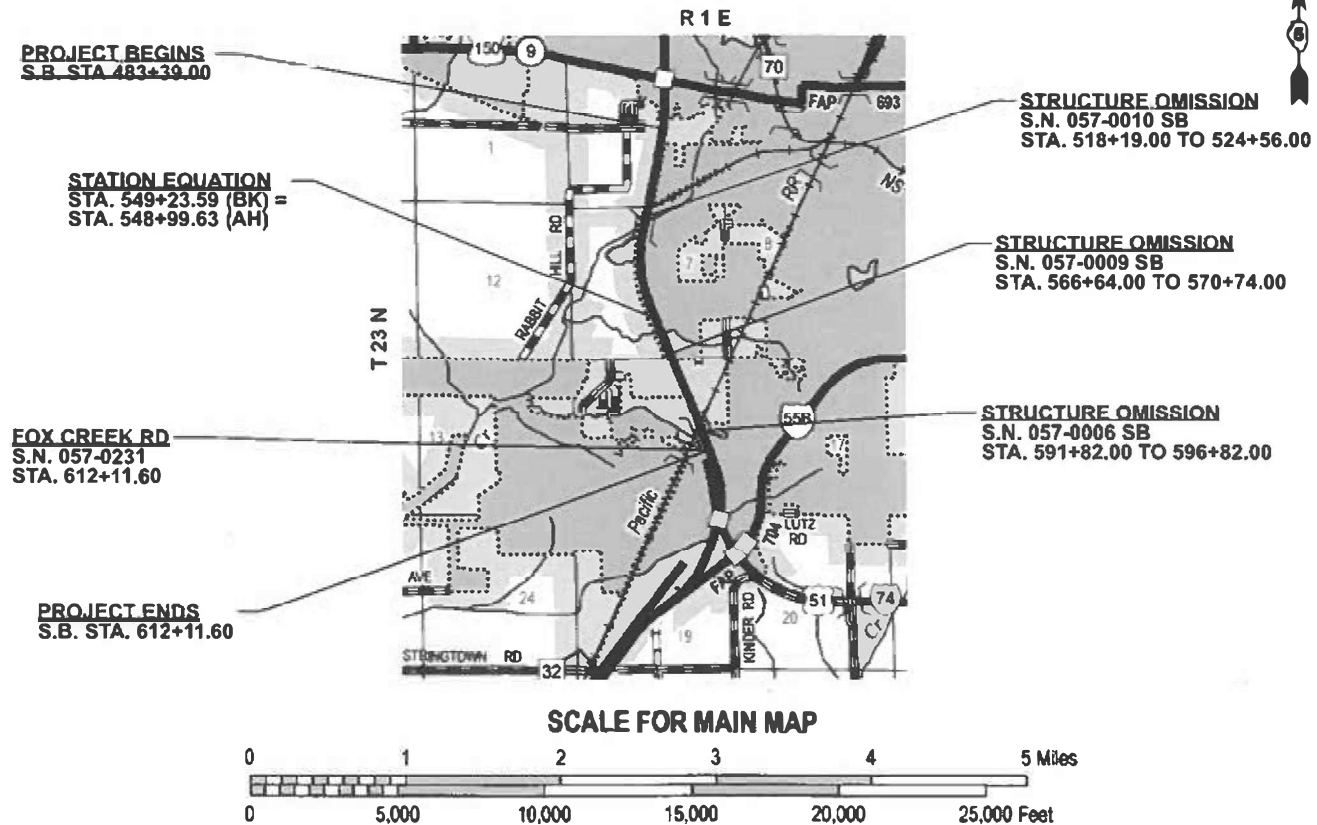

FULL SIZE PLANS HAVE BEEN PREPARED USING STANDARD ENGINEERING SCALES. REDUCED SIZED PLANS WILL NOT CONFORM TO STANDARD SCALES. IN MAKING MEASUREMENTS ON REDUCED PLANS, THE ABOVE SCALES MAY BE USED.

J.U.L.I.E.
 JOINT UTILITY LOCATION INFORMATION FOR EXCAVATION
 1-800-892-0123
 OR 811
 BLOOMINGTON TOWNSHIP

PROJECT ENGINEER: CLARE B. DIETZ
 DESIGNER: JACKSON CHEN
 PHONE: (217) 465-4181

CONTRACT NO. 70H85

GROSS LENGTH = 11563.20 FT. = 2.190 MILES
 NET LENGTH = 9995.04 FT. = 1.893 MILES

STATE OF ILLINOIS
DEPARTMENT OF TRANSPORTATION

SUBMITTED 11/25 20 25
Kenneth A. Bennett REGIONAL ENGINEER

March 20 26
 ENGINEER OF DESIGN AND ENVIRONMENT

March 20 26
 DIRECTOR OF HIGHWAYS PROJECT IMPLEMENTATION

PRINTED BY THE AUTHORITY
OF THE STATE OF ILLINOIS

INDEX OF SHEETS

SHEET NO.	DESCRIPTION
1	COVER SHEET
2	INDEX OF SHEETS
2	LIST OF HIGHWAY STANDARDS
2	GENERAL NOTES
3	SUMMARY OF QUANTITIES
4-6	EXISTING TYPICAL SECTIONS
7-11	SCHEDULE OF QUANTITIES
12-13	CLASS A PATCHES (SPECIAL)

GENERAL NOTES

G.N.-100A
ELECTRONIC FILES AND/OR ELECTRONIC SURVEY INFORMATION INCLUDING CADD FILES WILL NOT BE AVAILABLE TO THE CONTRACTOR.

G.N.-440B
THE EXISTING TIE BARS BETWEEN THE EXISTING PAVEMENT AND EXISTING MEDIANS, GUTTERS AND/OR COMBINATION CURB AND GUTTERS THAT ARE FOUND SUITABLE FOR REUSE SHALL BE CLEANED, STRAIGHTENED AND INCORPORATED INTO THE NEW CONSTRUCTION. ANY EXISTING TIE BARS THAT ARE FOUND UNSUITABLE TO BE INCORPORATED INTO THE PROPOSED CONSTRUCTION DUE TO EXCESSIVE RUSTING OR DISTRESS SHALL BE REMOVED FLUSH WITH THE FACE OF THE EXISTING CONCRETE AND DISPOSED OF OUTSIDE THE LIMITS OF THE RIGHT-OF-WAY IN ACCORDANCE WITH ARTICLE 202.C3 OF THE STANDARD SPECIFICATIONS.

THIS WORK WILL NOT BE PAID FOR SEPARATELY BUT SHALL BE CONSIDERED INCLUDED IN THE VARIOUS REMOVAL PAY ITEMS AND NO ADDITIONAL COMPENSATION WILL BE ALLOWED.

HIGHWAY STANDARDS

STANDARD NO.	DESCRIPTION
000001-09	STANDARD SYMBOLS, ABBREVIATIONS AND PATTERNS
001001-02	AREAS OF REINFORCEMENT BARS
001006	DECIMAL OF AN INCH AND OF A FOOT
421001-03	BAR REINFORCEMENT FOR CRC PAVEMENT
421101-10	24' (7.2 M) CRC PAVEMENT (WITH WIDE FLANGE BEAM TERMINAL JOINT)
442001-04	CLASS A PATCHES
483001-06	PCC SHOULDERS
701400-12	APPROACH TO LANE CLOSURE, FREEWAY/EXPRESSWAY
701401-13	LANE CLOSURE, FREEWAY/EXPRESSWAY
701411-09	LANE CLOSURE, MULTILANE, AT ENTRANCE OR EXIT RAMP, FOR SPEEDS ≥ 45 MPH
701428-01	TRAFFIC CONTROL, SETUP AND REMOVAL, FREEWAY/EXPRESSWAY
701446-11	TWO LANE CLOSURE, FREEWAY/EXPRESSWAY
701901-11	TRAFFIC CONTROL DEVICES

NO COMMITMENTS

MODEL: Gen Notes 1 [Sheet]
FILE NAME: c:\pw\work\pwrto\illinois.gov\1130707\0570H85_Sht_GenNotes.dgn

USER NAME = jackson.chen	DESIGNED -	REVISED -
	DRAWN -	REVISED -
	CHECKED -	REVISED -
PLOT DATE = 11/18/2025	DATE -	REVISED -

**STATE OF ILLINOIS
DEPARTMENT OF TRANSPORTATION**

INDEX OF SHEETS, LIST OF HIGHWAY STANDARDS, GENERAL NOTES & COMMITMENTS

SCALE: SHEET 1 OF 1 SHEETS STA. TO STA.

F.A.I RTE.	SECTION	COUNTY	TOTAL SHEETS	SHEET NO.
55	(57-6,7,20)PP	MCLEAN	11	2
CONTRACT NO. 70H85				
ILLINOIS FED. AID PROJECT				

SUMMARY OF QUANTITIES

LOCATION OF WORK:	FAI 55/FAI 74 INTERSTATE URBAN STA. 495+15.40 STA. 610+78.60 MCLEAN
FUNDING BREAKOUT:	100% STATE
CONSTRUCTION TYPE CODE:	0006

CODE NO.	ITEM	UNIT	TOTAL QUANTITY	STATE QUANTITY
44213000	PATCHING REINFCRCEMENT	SQ YD	1,842	1,842
44213200	SAW CUTS	FOOT	8,398.0	8,398.0
44213204	TIE BARS 3/4"	EACH	2,665	2,665
67100100	MOBILIZATION	L SUM	1	1
70100420	TRAFFIC CONTROL AND PROTECTION, STANDARD 701411	EACH	2	2
70100800	TRAFFIC CONTROL AND PROTECTION, STANDARD 701401	L SUM	1	1
70100815	TRAFFIC CONTROL AND PROTECTION, STANDARD 701446	L SUM	1	1
70107025	CHANGEABLE MESSAGE SIGN	CAL DA	7	7
70200100	NIG-TTIME WORK ZONE LIGHTING	L SUM	1	1
X4420581	CLASS A PATCHES, TYPE I, 13 INCH (SPECIAL)	SQ YD	249	249
X4420583	CLASS A PATCHES, TYPE II, 13 INCH (SPECIAL)	SQ YD	472	472
X4420585	CLASS A PATCHES, TYPE III, 13 INCH (SPECIAL)	SQ YD	91	91
X4420587	CLASS A PATCHES, TYPE IV, 13 INCH (SPECIAL)	SQ YD	1,030	1,030
Z0013798	CONSTRUCTION LAYOUT	L SUM	1	1
* DENOTES SPECIALTY ITEM				

MODEL: SOQ_1 [Sheet]
FILE NAME: c:\pw\work\pwr\illinois.gov\1130707\0570H85_Sht_SOQ.dgn

USER NAME = jackson.chen	DESIGNED -	REVISED -
	DRAWN -	REVISED -
	CHECKED -	REVISED -
PLOT DATE = 11/24/2025	DATE -	REVISED -

**STATE OF ILLINOIS
DEPARTMENT OF TRANSPORTATION**

SUMMARY OF QUANTITIES

SCALE: SHEET 1 OF 1 SHEETS STA. TO STA.

F.A.I RTE.	SECTION	COUNTY	TOTAL SHEETS	SHEET NO.
55	(57-6,7,20)PP	MCLEAN	13	3
CONTRACT NO. 70H85				
ILLINOIS FED. AID PROJECT				

(A) EXISTING TYPICAL CROSS SECTION

STATION TO STATION
483+39.00 TO 495+57.00 (C)

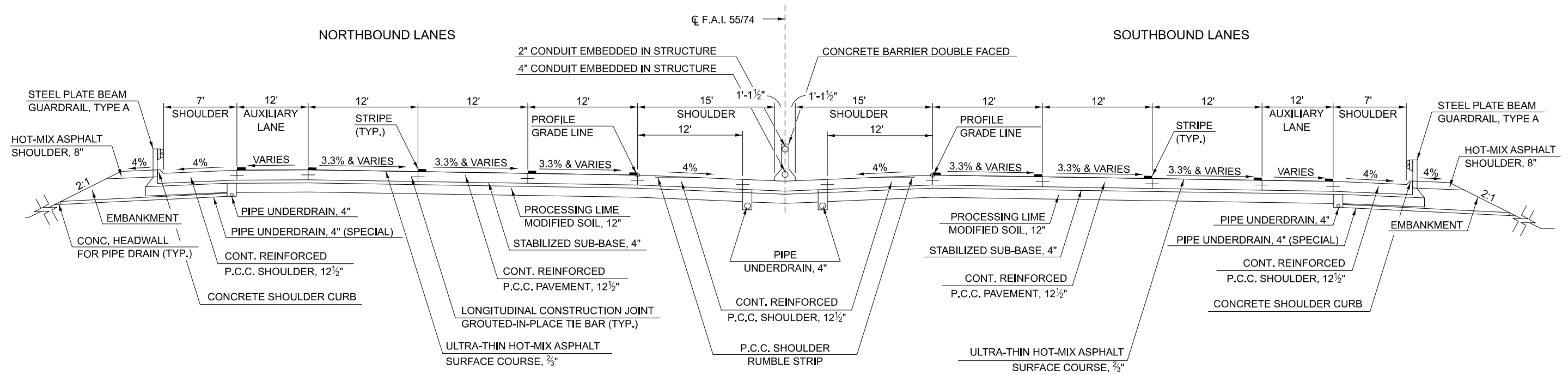

(B) EXISTING TYPICAL CROSS SECTION

STATION TO STATION
(C) 509+86.00 TO 525+00.00 (D)
(D) 550+00.00 TO 588+82.46 (E)

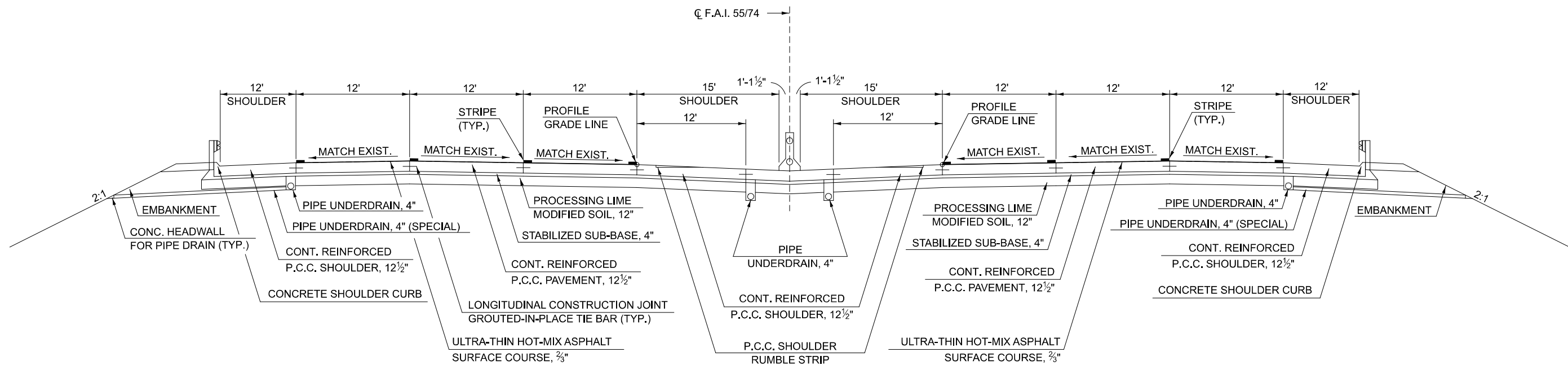

MODEL: Typical-1 (Sheet)
FILE NAME: c:\p\work\70H85\Illinois.gov\1130707\0570H85_Sht_Typicals.dgn

USER NAME = jackson.chen	DESIGNED -	REVISED -
	DRAWN -	REVISED -
	CHECKED -	REVISED -
PLOT DATE = 11/18/2025	DATE -	REVISED -

**STATE OF ILLINOIS
DEPARTMENT OF TRANSPORTATION**

EXISTING TYPICAL CROSS SECTIONS

SCALE: SHEET 1 OF 3 SHEETS STA. TO STA.

F.A.I. RTE.	SECTION	COUNTY	TOTAL SHEETS	SHEET NO.
55	(57-6,7,20)PP	MCLEAN	11	4
CONTRACT NO. 70H85				
ILLINOIS FED. AID PROJECT				

C EXISTING TYPICAL CROSS SECTION

STATION TO STATION
 (A) 495+57.00 509+86.00 (B)

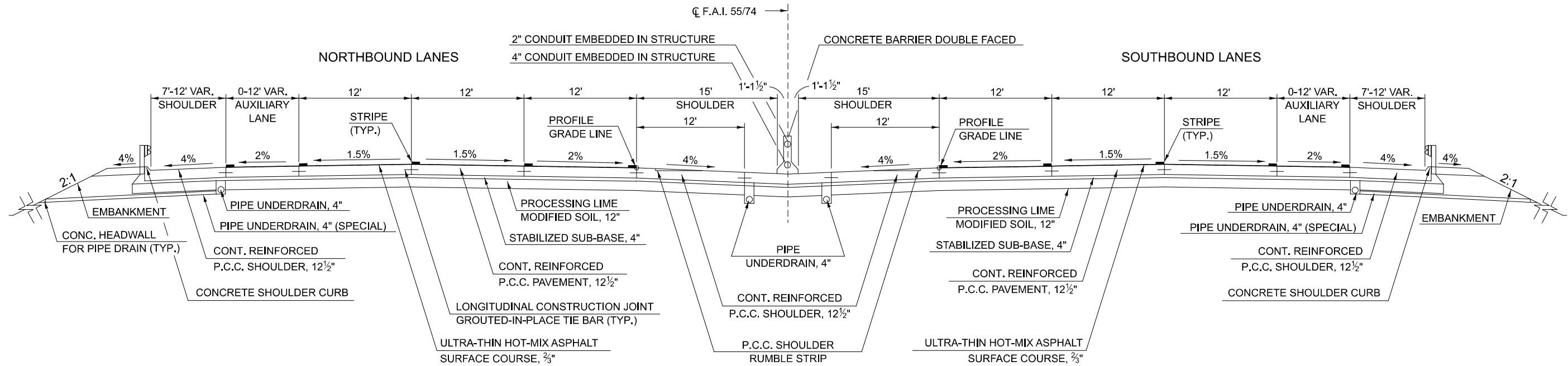

D EXISTING TYPICAL CROSS SECTION

STATION TO STATION
 (B) 525+00.00 550+00.00 (B)

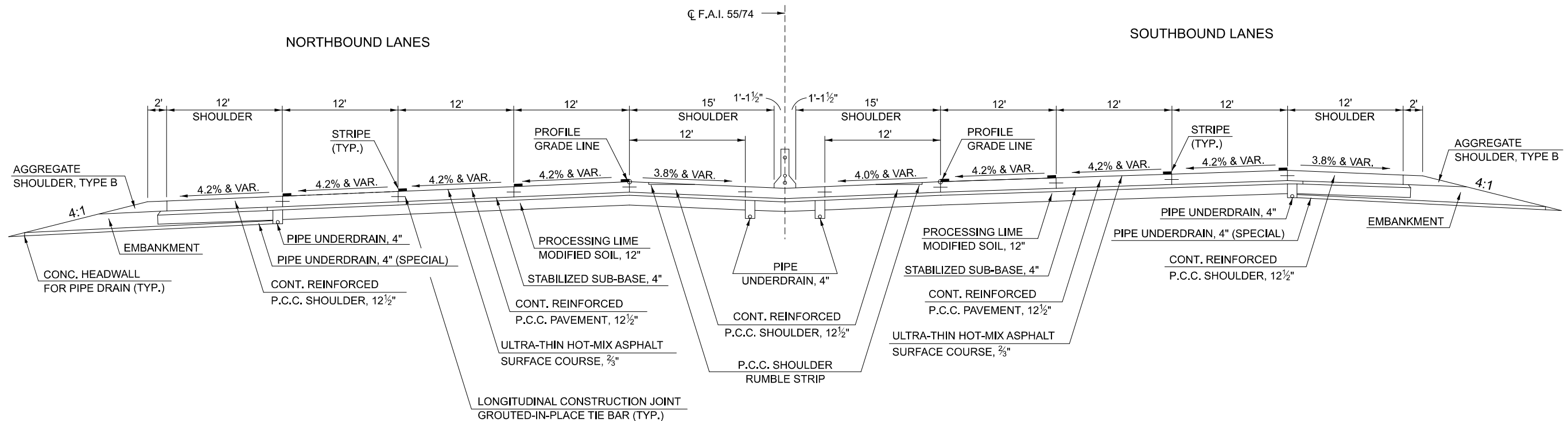

MODEL: Typical-2 (Sheet)
 FILE NAME: c:\p\work\70H85\Illinois.gov\1130707\0570H85_Sht_Typicals.dgn

USER NAME = jackson.chen	DESIGNED -	REVISED -
	DRAWN -	REVISED -
	CHECKED -	REVISED -
PLOT DATE = 11/18/2025	DATE -	REVISED -

**STATE OF ILLINOIS
 DEPARTMENT OF TRANSPORTATION**

EXISTING TYPICAL CROSS SECTIONS

SCALE: SHEET 2 OF 3 SHEETS STA. TO STA.

F.A.I. RTE.	SECTION	COUNTY	TOTAL SHEETS	SHEET NO.
55	(57-6,7,20)PP	MCLEAN	11	5
CONTRACT NO. 70H85				
ILLINOIS FED. AID PROJECT				

SCHEDULE OF QUANTITIES

APPROX.	STATION	DIR	LANE	LENGTH	WIDTH	SQ. YD	CLASS A PATCHES, TYPE I, SPECIAL 13.0" (sq. yd)	CLASS A PATCHES, TYPE II, SPECIAL 13.0" (sq. yd)	CLASS A PATCHES TYPE III, SPECIAL 13.0" (sq. yd)	CLASS A PATCHES TYPE IV, SPECIAL 13.0" (sq. yd)	SAW CUTS (ft)	TIE BARS (TRANS) 3/4" (each)	TIE BARS (LONG) 3/4" (each)	PATCH REINFORCEMENT (sq. yd)
							X4420581	X4420583	X4420585	X4420587	44213200	44213204	44213204	44213000
LOCATION														
487+50	SB	DL	6	12	8.0	0.0	8.0	0.0	0.0	42	22	0	8.0	
487+60	SB	DL	11	6	7.3	0.0	7.3	0.0	0.0	45	10	0	7.3	
488+35	SB	PL	107	14	166.4	0.0	0.0	0.0	166.4	349	26	71	166.4	
488+35	SB	DL	14	6	9.3	0.0	9.3	0.0	0.0	54	10	0	9.3	
492+70	SB	DL	41	6	27.3	0.0	0.0	0.0	27.3	135	10	27	27.3	
493+15	SB	DL	14	6	9.3	0.0	9.3	0.0	0.0	54	10	0	9.3	
494+50	SB	DL	6	6	4.0	4.0	0.0	0.0	0.0	30	10	0	4.0	
495+00	SB	DL	15	12	20.0	0.0	0.0	20.0	0.0	69	22	0	20.0	
496+00	SB	PL	114	7	88.7	0.0	0.0	0.0	88.7	356	12	76	88.7	
496+00	SB	DL	8	8	7.1	0.0	7.1	0.0	0.0	40	14	0	7.1	
496+50	SB	RT	14	6	9.3	0.0	9.3	0.0	0.0	54	10	0	9.3	
497+10	SB	RT	6	6	4.0	4.0	0.0	0.0	0.0	30	10	0	4.0	
497+25	SB	LL	10	12	13.3	0.0	13.3	0.0	0.0	54	22	0	13.3	
498+75	SB	PL	9	6	6.0	0.0	6.0	0.0	0.0	39	10	0	6.0	
499+30	SB	LL	6	6	4.0	4.0	0.0	0.0	0.0	30	10	0	4.0	
499+40	SB	DL	6	6	4.0	4.0	0.0	0.0	0.0	30	10	0	4.0	
500+00	SB	DL	70	6	46.7	0.0	0.0	0.0	46.7	222	10	47	46.7	
501+10	SB	DL	17	6	11.3	0.0	11.3	0.0	0.0	63	10	0	11.3	
501+40	SB	DL	6	6	4.0	4.0	0.0	0.0	0.0	30	10	0	4.0	
501+45	SB	LL	50	6	33.3	0.0	0.0	0.0	33.3	162	10	33	33.3	
501+80	SB	DL	10	6	6.7	0.0	6.7	0.0	0.0	42	10	0	6.7	
502+05	SB	DL	6	6	4.0	4.0	0.0	0.0	0.0	30	10	0	4.0	
502+65	SB	DL	50	6	33.3	0.0	0.0	0.0	33.3	162	10	33	33.3	
503+20	SB	LL	50	6	33.3	0.0	0.0	0.0	33.3	162	10	33	33.3	
503+40	SB	DL	13	6	8.7	0.0	8.7	0.0	0.0	51	10	0	8.7	
503+90	SB	PL	20	6	13.3	0.0	13.3	0.0	0.0	72	10	13	13.3	
503+90	SB	DL	20	6	13.3	0.0	13.3	0.0	0.0	72	10	13	13.3	
504+60	SB	DL	6	6	4.0	4.0	0.0	0.0	0.0	30	10	0	4.0	
TOTAL					600.2	28.0	123.1	20.0	429.1	2509	338	346	600.2	

MODEL: Schedule 1 (Sheet)
 FILE NAME: c:\pw_work\project\illinois.gov\1130707\0570H85_Sht_Schedule.dgn

USER NAME = jackson.chen	DESIGNED -	REVISED -
	DRAWN -	REVISED -
	CHECKED -	REVISED -
PLOT DATE = 12/4/2025	DATE -	REVISED -

**STATE OF ILLINOIS
DEPARTMENT OF TRANSPORTATION**

SCHEDULE OF QUANTITIES

SCALE: SHEET 1 OF 5 SHEETS STA. TO STA.

F.A.I RTE.	SECTION	COUNTY	TOTAL SHEETS	SHEET NO.
55	(57-6,7,20)PP	MCLEAN	13	7
CONTRACT NO. 70H85				
		ILLINOIS	FED. AID PROJECT	

SCHEDULE OF QUANTITIES

APPROX.	STATION	DIR	LANE	LENGTH	WIDTH	SQ. YD	CLASS A PATCHES, TYPE I, SPECIAL 13.0" (sq. yd)	CLASS A PATCHES, TYPE II, SPECIAL 13.0" (sq. yd)	CLASS A PATCHES TYPE III, SPECIAL 13.0" (sq. yd)	CLASS A PATCHES TYPE IV, SPECIAL 13.0" (sq. yd)	SAW CUTS (ft)	TIE BARS (TRANS) 3/4" (each)	TIE BARS (LONG) 3/4" (each)	PATCH REINFORCEMENT (sq. yd)
							X4420581	X4420583	X4420585	X4420587	44213200	44213204	44213204	44213000
LOCATION														
505+40	SB	DL	6	6	4.0	4.0	0.0	0.0	0.0	30	10	0	4.0	
506+70	SB	DL	6	6	4.0	4.0	0.0	0.0	0.0	30	10	0	4.0	
507+30	SB	DL	6	6	4.0	4.0	0.0	0.0	0.0	30	10	0	4.0	
508+30	SB	LL	6	6	4.0	4.0	0.0	0.0	0.0	30	10	0	4.0	
509+00	SB	DL	10	6	6.7	0.0	6.7	0.0	0.0	42	10	0	6.7	
509+50	SB	DL	22	6	14.7	0.0	14.7	0.0	0.0	78	10	15	14.7	
510+10	SB	PL	12	12	16.0	0.0	0.0	16.0	0.0	60	22	0	16.0	
510+50	SB	PL	162	6	108.0	0.0	0.0	0.0	108.0	498	10	108	108.0	
513+50	SB	PL	10	6	6.7	0.0	6.7	0.0	0.0	42	10	0	6.7	
514+00	SB	PL	10	12	13.3	0.0	13.3	0.0	0.0	54	22	0	13.3	
516+10	SB	DL	6	6	4.0	4.0	0.0	0.0	0.0	30	10	0	4.0	
517+50	SB	PL	12	6	8.0	0.0	8.0	0.0	0.0	48	10	0	8.0	
519+20	SB	PL	6	6	4.0	4.0	0.0	0.0	0.0	30	10	0	4.0	
519+20	SB	DL	6	6	4.0	4.0	0.0	0.0	0.0	30	10	0	4.0	
525+00	SB	PL	100	6	66.7	0.0	0.0	0.0	66.7	312	10	67	66.7	
525+00	SB	DL	14	12	18.7	0.0	0.0	18.7	0.0	66	22	0	18.7	
527+20	SB	DL	6	12	8.0	0.0	8.0	0.0	0.0	42	22	0	8.0	
527+50	SB	DL	6	6	4.0	4.0	0.0	0.0	0.0	30	10	0	4.0	
528+80	SB	PL	17	6	11.3	0.0	11.3	0.0	0.0	63	10	0	11.3	
529+50	SB	PL	6	6	4.0	4.0	0.0	0.0	0.0	30	10	0	4.0	
530+00	SB	PL	10	6	6.7	0.0	6.7	0.0	0.0	42	10	0	6.7	
531+50	SB	DL	6	6	4.0	4.0	0.0	0.0	0.0	30	10	0	4.0	
532+30	SB	PL	10	6	6.7	0.0	6.7	0.0	0.0	42	10	0	6.7	
532+30	SB	DL	20	6	13.3	0.0	13.3	0.0	0.0	72	10	13	13.3	
535+00	SB	PL	6	6	4.0	4.0	0.0	0.0	0.0	30	10	0	4.0	
539+00	SB	LL	6	6	4.0	4.0	0.0	0.0	0.0	30	10	0	4.0	
539+65	SB	PL	8	12	10.7	0.0	10.7	0.0	0.0	48	22	0	10.7	
540+10	SB	PL	6	6	4.0	4.0	0.0	0.0	0.0	30	10	0	4.0	
TOTAL					367.3	52.0	106.0	34.7	174.7	1899	340	203	367.3	

MODEL: Schedule 2 (Sheet)
FILE NAME: c:\p\work\project\illinois.gov\1130707\0570H85_Sht_Schedule.dgn

USER NAME = jackson.chen	DESIGNED -	REVISED -
	DRAWN -	REVISED -
	CHECKED -	REVISED -
PLOT DATE = 12/4/2025	DATE -	REVISED -

**STATE OF ILLINOIS
DEPARTMENT OF TRANSPORTATION**

SCHEDULE OF QUANTITIES

SCALE: SHEET 2 OF 5 SHEETS STA. TO STA.

F.A.I RTE.	SECTION	COUNTY	TOTAL SHEETS	SHEET NO.
55	(57-6,7,20)PP	MCLEAN	13	8
CONTRACT NO. 70H85				
ILLINOIS FED. AID PROJECT				

SCHEDULE OF QUANTITIES

APPROX.	STATION	DIR	LANE	LENGTH	WIDTH	SQ. YD	CLASS A PATCHES, TYPE I, SPECIAL 13.0" (sq. yd)	CLASS A PATCHES, TYPE II, SPECIAL 13.0" (sq. yd)	CLASS A PATCHES TYPE III, SPECIAL 13.0" (sq. yd)	CLASS A PATCHES TYPE IV, SPECIAL 13.0" (sq. yd)	SAW CUTS (ft)	TIE BARS (TRANS) 3/4" (each)	TIE BARS (LONG) 3/4" (each)	PATCH REINFORCEMENT (sq. yd)
							X4420581	X4420583	X4420585	X4420587	44213200	44213204	44213204	44213000
LOCATION														
540+90	SB	PL	8	6	5.3	0.0	5.3	0.0	0.0	36	10	0	5.3	
542+00	SB	LL	18	6	12.0	0.0	12.0	0.0	0.0	66	10	0	12.0	
542+00	SB	PL	40	12	53.3	0.0	0.0	0.0	53.3	144	22	27	53.3	
542+00	SB	DL	6	6	4.0	4.0	0.0	0.0	0.0	30	10	0	4.0	
542+60	SB	PL	8	6	5.3	0.0	5.3	0.0	0.0	36	10	0	5.3	
543+25	SB	DL	12	6	8.0	0.0	8.0	0.0	0.0	48	10	0	8.0	
543+50	SB	DL	16	6	10.7	0.0	10.7	0.0	0.0	60	10	0	10.7	
544+80	SB	DL	6	6	4.0	4.0	0.0	0.0	0.0	30	10	0	4.0	
545+25	SB	DL	14	6	9.3	0.0	9.3	0.0	0.0	54	10	0	9.3	
545+90	SB	DL	6	6	4.0	4.0	0.0	0.0	0.0	30	10	0	4.0	
546+00	SB	DL	6	6	4.0	4.0	0.0	0.0	0.0	30	10	0	4.0	
547+75	SB	DL	6	6	4.0	4.0	0.0	0.0	0.0	30	10	0	4.0	
548+00	SB	DL	6	6	4.0	4.0	0.0	0.0	0.0	30	10	0	4.0	
548+25	SB	DL	30	6	20.0	0.0	0.0	20.0	0.0	102	10	20	20.0	
549+50	SB	DL	6	6	4.0	4.0	0.0	0.0	0.0	30	10	0	4.0	
550+10	SB	PL	6	6	4.0	4.0	0.0	0.0	0.0	30	10	0	4.0	
550+10	SB	DL	6	6	4.0	4.0	0.0	0.0	0.0	30	10	0	4.0	
552+05	SB	PL	6	6	4.0	4.0	0.0	0.0	0.0	30	10	0	4.0	
552+05	SB	DL	6	12	8.0	0.0	8.0	0.0	0.0	42	22	0	8.0	
552+60	SB	DL	6	12	8.0	0.0	8.0	0.0	0.0	42	22	0	8.0	
553+10	SB	DL	6	6	4.0	4.0	0.0	0.0	0.0	30	10	0	4.0	
553+80	SB	DL	6	12	8.0	0.0	8.0	0.0	0.0	42	22	0	8.0	
554+00	SB	DL	6	10	6.7	0.0	6.7	0.0	0.0	38	18	0	6.7	
554+25	SB	PL	6	6	4.0	4.0	0.0	0.0	0.0	30	10	0	4.0	
554+25	SB	DL	6	6	4.0	4.0	0.0	0.0	0.0	30	10	0	4.0	
555+00	SB	PL	6	6	4.0	4.0	0.0	0.0	0.0	30	10	0	4.0	
555+00	SB	DL	6	6	4.0	4.0	0.0	0.0	0.0	30	10	0	4.0	
555+40	SB	LL	6	6	4.0	4.0	0.0	0.0	0.0	30	10	0	4.0	
TOTAL					164.0	64.0	81.3	20.0	53.3	1190	336	47	218.7	

MODEL: Schedule 3 (Sheet)
FILE NAME: c:\pw_work\project\illinois.gov\1130707\0570H85_Sht_Schedule.dgn

USER NAME = jackson.chen	DESIGNED -	REVISED -
	DRAWN -	REVISED -
	CHECKED -	REVISED -
PLOT DATE = 12/4/2025	DATE -	REVISED -

**STATE OF ILLINOIS
DEPARTMENT OF TRANSPORTATION**

SCHEDULE OF QUANTITIES

SCALE: SHEET 3 OF 5 SHEETS STA. TO STA.

F.A.I RTE.	SECTION	COUNTY	TOTAL SHEETS	SHEET NO.
55	(57-6,7,20)PP	MCLEAN	13	9
CONTRACT NO. 70H85				
		ILLINOIS	FED. AID PROJECT	

SCHEDULE OF QUANTITIES

APPROX.						CLASS A PATCHES, TYPE I, SPECIAL 13.0" (sq. yd)	CLASS A PATCHES, TYPE II, SPECIAL 13.0" (sq. yd)	CLASS A PATCHES TYPE III, SPECIAL 13.0" (sq. yd)	CLASS A PATCHES TYPE IV, SPECIAL 13.0" (sq. yd)	SAW CUTS (ft)	TIE BARS (TRANS) 3/4" (each)	TIE BARS (LONG) 3/4" (each)	PATCH REINFORCEMENT (sq. yd)
STATION	DIR	LANE	LENGTH	WIDTH	SQ. YD	X4420581	X4420583	X4420585	X4420587	44213200	44213204	44213204	44213000
LOCATION													
555+40	SB	PL	6	6	4.0	4.0	0.0	0.0	0.0	30	10	0	4.0
555+40	SB	DL	6	6	4.0	4.0	0.0	0.0	0.0	30	10	0	4.0
556+10	SB	DL	6	6	4.0	4.0	0.0	0.0	0.0	30	10	0	4.0
556+65	SB	DL	6	6	4.0	4.0	0.0	0.0	0.0	30	10	0	4.0
557+80	SB	DL	6	6	4.0	4.0	0.0	0.0	0.0	30	10	0	4.0
558+50	SB	DL	8	12	10.7	0.0	10.7	0.0	0.0	48	22	0	10.7
559+70	SB	DL	6	6	4.0	4.0	0.0	0.0	0.0	30	10	0	4.0
560+15	SB	DL	6	6	4.0	4.0	0.0	0.0	0.0	30	10	0	4.0
560+85	SB	PL	6	6	4.0	4.0	0.0	0.0	0.0	30	10	0	4.0
560+85	SB	DL	6	6	4.0	4.0	0.0	0.0	0.0	30	10	0	4.0
562+00	SB	DL	6	6	4.0	4.0	0.0	0.0	0.0	30	10	0	4.0
563+05	SB	PL	6	6	4.0	4.0	0.0	0.0	0.0	30	10	0	4.0
563+05	SB	DL	6	12	8.0	0.0	8.0	0.0	0.0	42	22	0	8.0
564+25	SB	DL	36	12	48.0	0.0	0.0	0.0	48.0	132	22	24	48.0
565+00	SB	DL	6	6	4.0	4.0	0.0	0.0	0.0	30	10	0	4.0
566+20	SB	PL	24	12	32.0	0.0	0.0	0.0	32.0	96	22	16	32.0
571+00	SB	PL	24	12	32.0	0.0	0.0	0.0	32.0	96	22	16	32.0
571+00	SB	DL	24	12	32.0	0.0	0.0	0.0	32.0	96	22	16	32.0
571+80	SB	PL	6	12	8.0	0.0	8.0	0.0	0.0	42	22	0	8.0
571+80	SB	DL	6	12	8.0	0.0	8.0	0.0	0.0	42	22	0	8.0
572+35	SB	PL	43	12	57.3	0.0	0.0	0.0	57.3	153	22	29	57.3
572+35	SB	DL	24	12	32.0	0.0	0.0	0.0	32.0	96	22	16	32.0
573+00	SB	PL	6	12	8.0	0.0	8.0	0.0	0.0	42	22	0	8.0
573+00	SB	DL	6	12	8.0	0.0	8.0	0.0	0.0	42	22	0	8.0
573+75	SB	PL	6	6	4.0	4.0	0.0	0.0	0.0	30	10	0	4.0
574+00	SB	PL	10	12	13.3	0.0	13.3	0.0	0.0	54	22	0	13.3
574+45	SB	PL	14	6	9.3	0.0	9.3	0.0	0.0	54	10	0	9.3
574+45	SB	DL	6	6	4.0	4.0	0.0	0.0	0.0	30	10	0	4.0
574+90	SB	PL	9	12	12.0	0.0	12.0	0.0	0.0	51	22	0	12.0
574+90	SB	DL	6	6	4.0	4.0	0.0	0.0	0.0	30	10	0	4.0
TOTAL					378.7	60.0	85.3	0.0	233.3	1536	468	117	378.7

MODEL: Schedule-4 [Sheet]
FILE NAME: c:\p\work\project\illinois.gov\1130707\0570H85_Sht_Schedule.dgn

USER NAME = jackson.chen	DESIGNED -	REVISED -
	DRAWN -	REVISED -
	CHECKED -	REVISED -
PLOT DATE = 12/4/2025	DATE -	REVISED -

**STATE OF ILLINOIS
DEPARTMENT OF TRANSPORTATION**

SCHEDULE OF QUANTITIES

SCALE: SHEET 4 OF 5 SHEETS STA. TO STA.

F.A.I RTE.	SECTION	COUNTY	TOTAL SHEETS	SHEET NO.
55	(57-6,7,20)PP	MCLEAN	13	10
CONTRACT NO. 70H85				
ILLINOIS FED. AID PROJECT				

SCHEDULE OF QUANTITIES

APPROX.	DIR	LANE	LENGTH	WIDTH	SQ. YD	CLASS A PATCHES, TYPE I, SPECIAL 13.0" (sq. yd)	CLASS A PATCHES, TYPE II, SPECIAL 13.0" (sq. yd)	CLASS A PATCHES TYPE III, SPECIAL 13.0" (sq. yd)	CLASS A PATCHES TYPE IV, SPECIAL 13.0" (sq. yd)	SAW CUTS (ft)	TIE BARS (TRANS) 3/4" (each)	TIE BARS (LONG) 3/4" (each)	PATCH REINFORCEMENT (sq. yd)
STATION						X4420581	X4420583	X4420585	X4420587	44213200	44213204	44213204	44213000
LOCATION													
575+20	SB	PL	6	6	4.0	4.0	0.0	0.0	0.0	30	10	0	4.0
576+60	SB	PL	6	6	4.0	4.0	0.0	0.0	0.0	30	10	0	4.0
577+10	SB	PL	6	6	4.0	4.0	0.0	0.0	0.0	30	10	0	4.0
577+10	SB	DL	12	12	16.0	0.0	0.0	16.0	0.0	60	22	0	16.0
578+00	SB	DL	6	6	4.0	4.0	0.0	0.0	0.0	30	10	0	4.0
579+60	SB	DL	12	6	8.0	0.0	8.0	0.0	0.0	48	10	0	8.0
580+20	SB	LL	6	6	4.0	4.0	0.0	0.0	0.0	30	10	0	4.0
581+00	SB	DL	7	6	4.7	4.7	0.0	0.0	0.0	33	10	0	4.7
582+10	SB	DL	8	8	7.1	0.0	7.1	0.0	0.0	40	14	0	7.1
583+50	SB	PL	6	12	8.0	0.0	8.0	0.0	0.0	42	22	0	8.0
583+50	SB	DL	6	12	8.0	0.0	8.0	0.0	0.0	42	22	0	8.0
584+10	SB	PL	6	12	8.0	0.0	8.0	0.0	0.0	42	22	0	8.0
585+15	SB	PL	6	12	8.0	0.0	8.0	0.0	0.0	42	22	0	8.0
586+15	SB	PL	20	12	26.7	0.0	0.0	0.0	26.7	84	22	13	26.7
587+00	SB	DL	6	12	8.0	0.0	8.0	0.0	0.0	42	22	0	8.0
588+20	SB	DL	6	6	4.0	4.0	0.0	0.0	0.0	30	10	0	4.0
588+80	SB	DL	30	12	40.0	0.0	0.0	0.0	40.0	114	22	20	40.0
590+50	SB	DL	6	6	4.0	4.0	0.0	0.0	0.0	30	10	0	4.0
591+00	SB	DL	6	6	4.0	4.0	0.0	0.0	0.0	30	10	0	4.0
592+00	SB	DL	6	12	8.0	0.0	8.0	0.0	0.0	42	22	0	8.0
596+65	SB	DL	20	6	13.3	0.0	13.3	0.0	0.0	72	10	13	13.3
597+50	SB	DL	6	6	4.0	4.0	0.0	0.0	0.0	30	10	0	4.0
598+20	SB	DL	35	12	46.7	0.0	0.0	0.0	46.7	129	22	23	46.7
599+80	SB	DL	40	6	26.7	0.0	0.0	0.0	26.7	132	10	27	26.7
602+00	SB	DL	6	6	4.0	4.0	0.0	0.0	0.0	30	10	0	4.0
TOTAL					277.1	44.7	76.4	16.0	140.0	1264	374	96	277.1

MODEL: Schedule-5 [Sheet]
FILE NAME: c:\p\work\project\illinois.gov\1130707\0570H85_Sht_Schedule.dgn

USER NAME = jackson.chen	DESIGNED -	REVISED -
	DRAWN -	REVISED -
	CHECKED -	REVISED -
PLOT DATE = 12/4/2025	DATE -	REVISED -

**STATE OF ILLINOIS
DEPARTMENT OF TRANSPORTATION**

SCHEDULE OF QUANTITIES

SCALE: SHEET 5 OF 5 SHEETS STA. TO STA.

F.A.I RTE.	SECTION	COUNTY	TOTAL SHEETS	SHEET NO.
55	(57-6,7,20)PP	MCLEAN	13	11
CONTRACT NO. 70H85				
ILLINOIS FED. AID PROJECT				

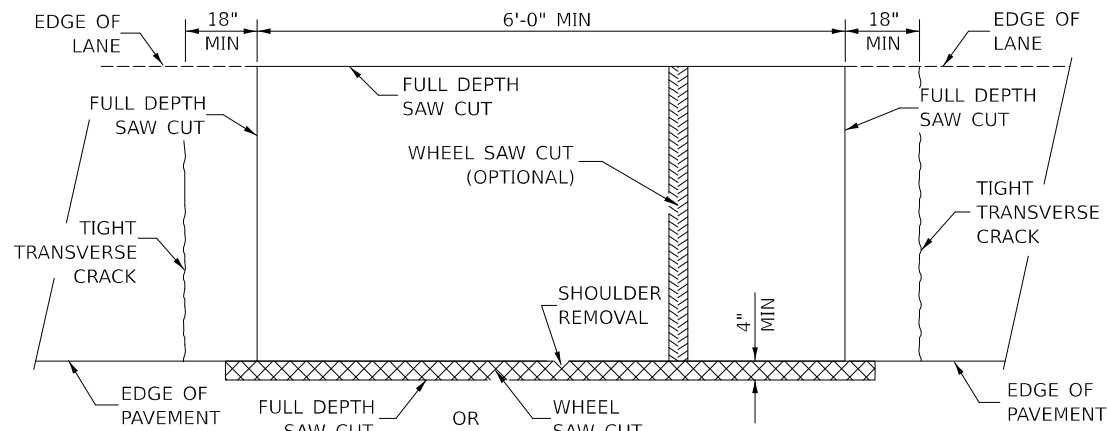

**PAVEMENT SAWING DETAIL
(HMA SHOULDER)**

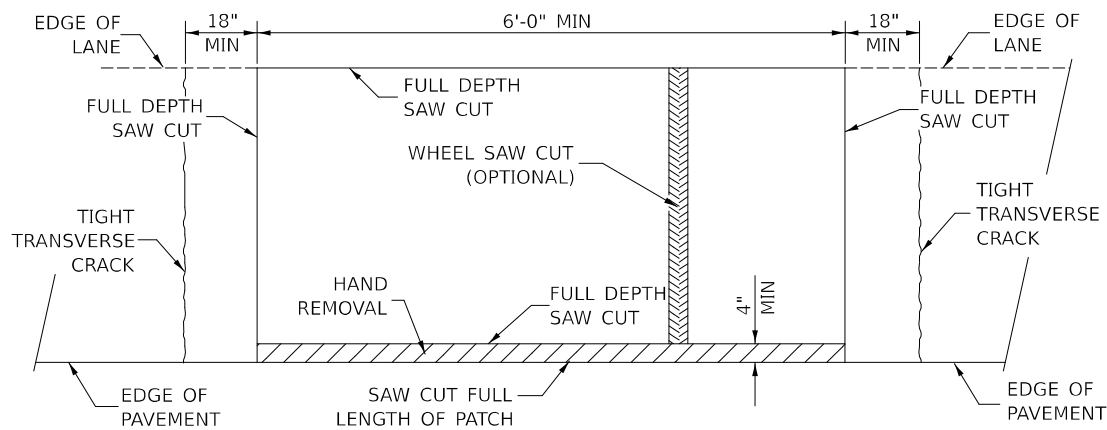

**PAVEMENT SAWING DETAIL
(PCC SHOULDER)**

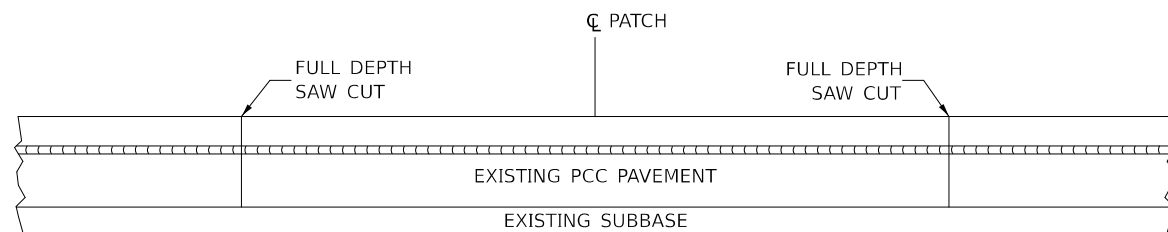

EXISTING PAVEMENT WITHOUT HMA SURFACE

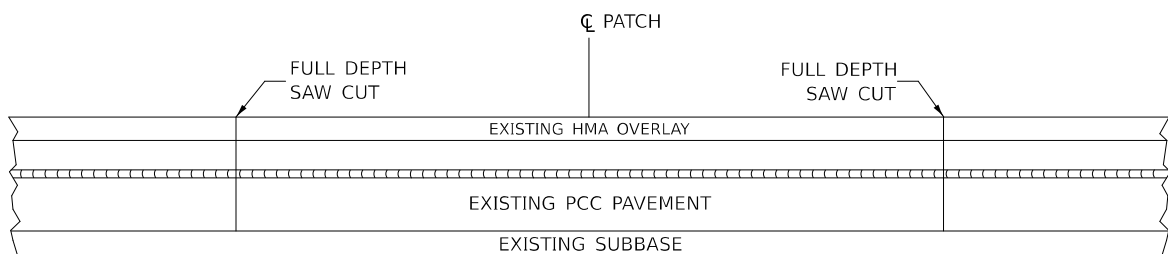

EXISTING PAVEMENT WITH HMA SURFACE

**PAVEMENT SAWING DETAIL FOR CLASS A PATCHING
(CRC PAVEMENT)**

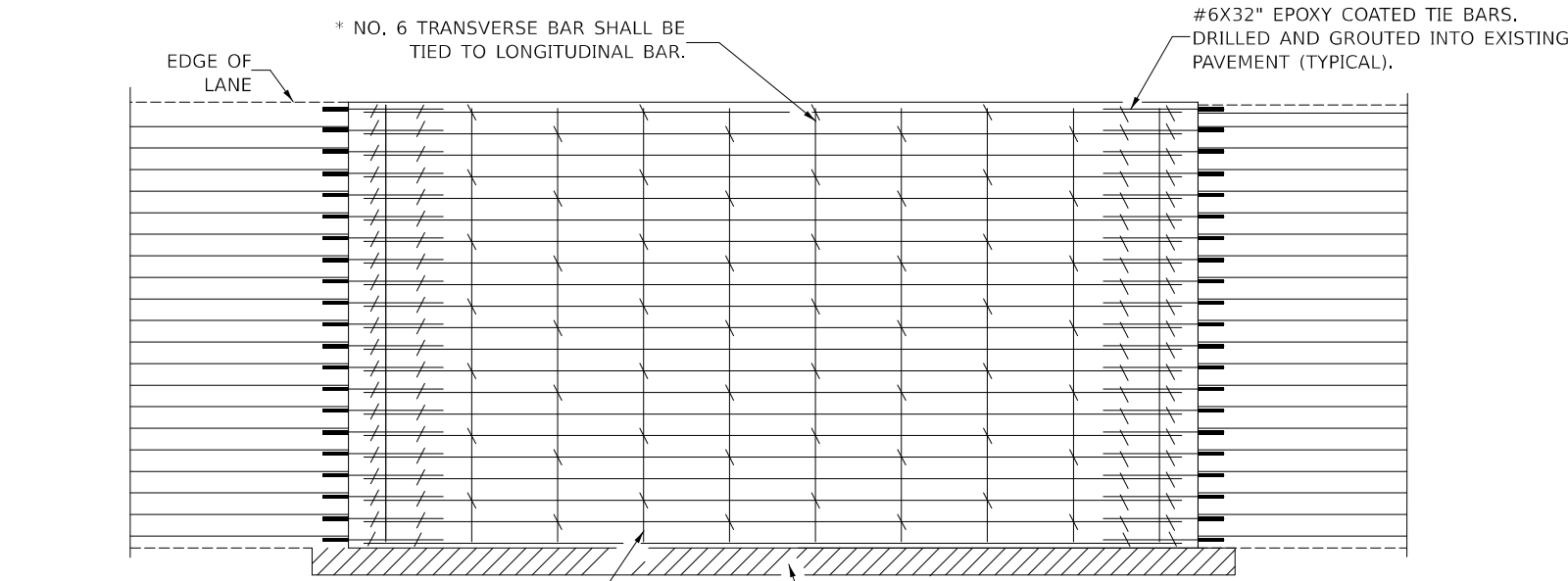

PAVEMENT REINFORCEMENT DETAIL

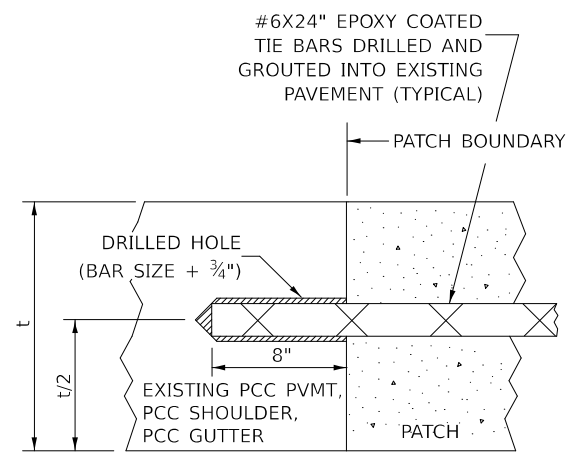

LONGITUDINAL CONSTRUCTION JOINT

PATCHES MORE THAN 20' IN LENGTH SHALL BE TIED TO ADJACENT PAVEMENT, PCC SHOULDERS OR PCC CURB AND GUTTER WITH #6x24" EPOXY COATED TIE BARS AT 36" CENTERS.

NOTES:

EXISTING LONGITUDINAL REINFORCEMENT SPACING; ±6 1/2".

SPACING OF NEW LONGITUDINAL REINFORCEMENT AND NEW LONGITUDINAL TIE BARS SHALL MATCH SPACING OF EXISTING REINFORCEMENT AND SHALL BE TIED TOGETHER WITH A MINIMUM OF TWO TIES PER BAR.

SUPPORT CHAIRS SHALL BE REQUIRED WHENEVER PATCH LENGTH EXCEEDS 6'-0"

* EVERY THIRD INTERSECTION MUST BE TIED. WHEN THE MINIMUM CLEARANCE CANNOT BE OBTAINED WITH THE TRANSVERSE REBAR ON TOP, THEN THE TRANSVERSE REBAR SHALL BE TIED TO THE BOTTOM OF THE LONGITUDINAL REBAR.

** VARIABLES WHERE S₁ AND S₂ ARE 2 1/2" MIN. AND 12" MAX.

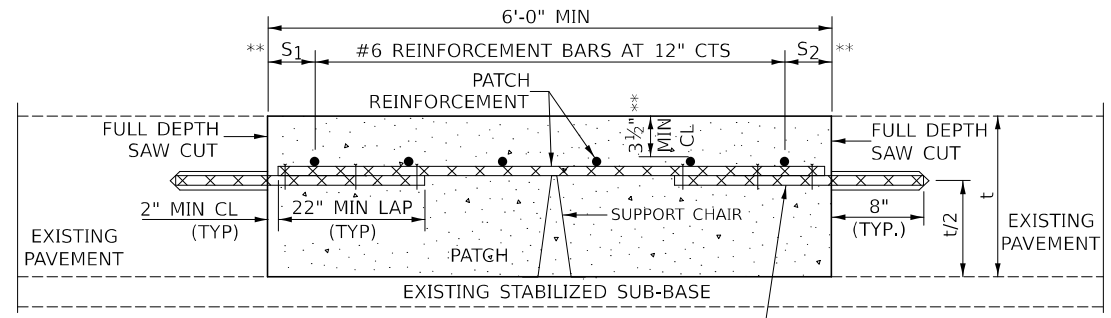

WITHOUT HMA OVERLAY

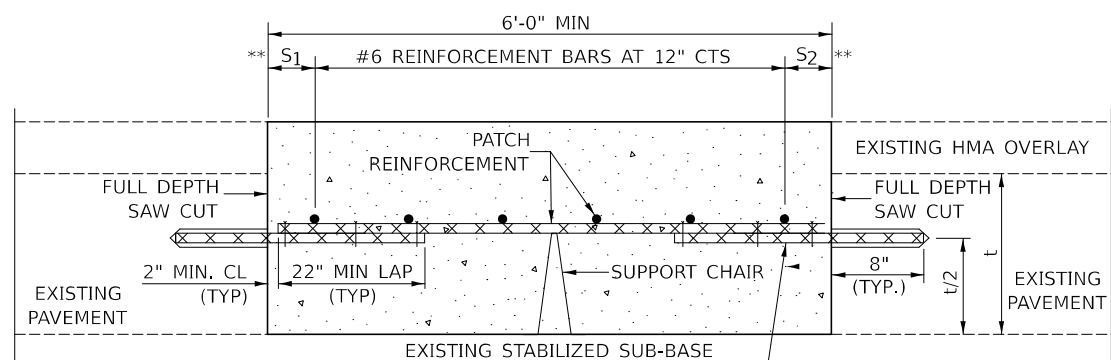

WITH HMA OVERLAY

**PATCHING DETAIL FOR CLASS A PATCHING
(CRC PAVEMENT)**

Note: All dimensions are in INCHES (millimeters) unless otherwise shown.

MODEL: 44200AAA Sheet 1 (Sheet)
FILE NAME: c:\p\work\pav\illinois.gov\jackson.chen@illinois.gov\44200AAA-Detail_44200AAA.dgn

USER NAME = jackson.chen	DESIGNED - JWS	REVISED - 01/2023 - JWS
	DRAWN -	REVISED -
	CHECKED -	REVISED -
PLOT DATE = 12/4/2025	DATE - 01/2021	REVISED -

**STATE OF ILLINOIS
DEPARTMENT OF TRANSPORTATION**

CLASS A PATCHING (SPECIAL)

SCALE: SHEET 1 OF 2 SHEETS STA. TO STA.

DISTRICT 5 DETAIL NO. 44200AAA				
F.A.I RTE.	SECTION	COUNTY	TOTAL SHEETS	SHEET NO.
55	(57-6,7,20)PP	MCLEAN	13	12
CONTRACT NO. 70H85				
ILLINOIS FED. AID PROJECT				

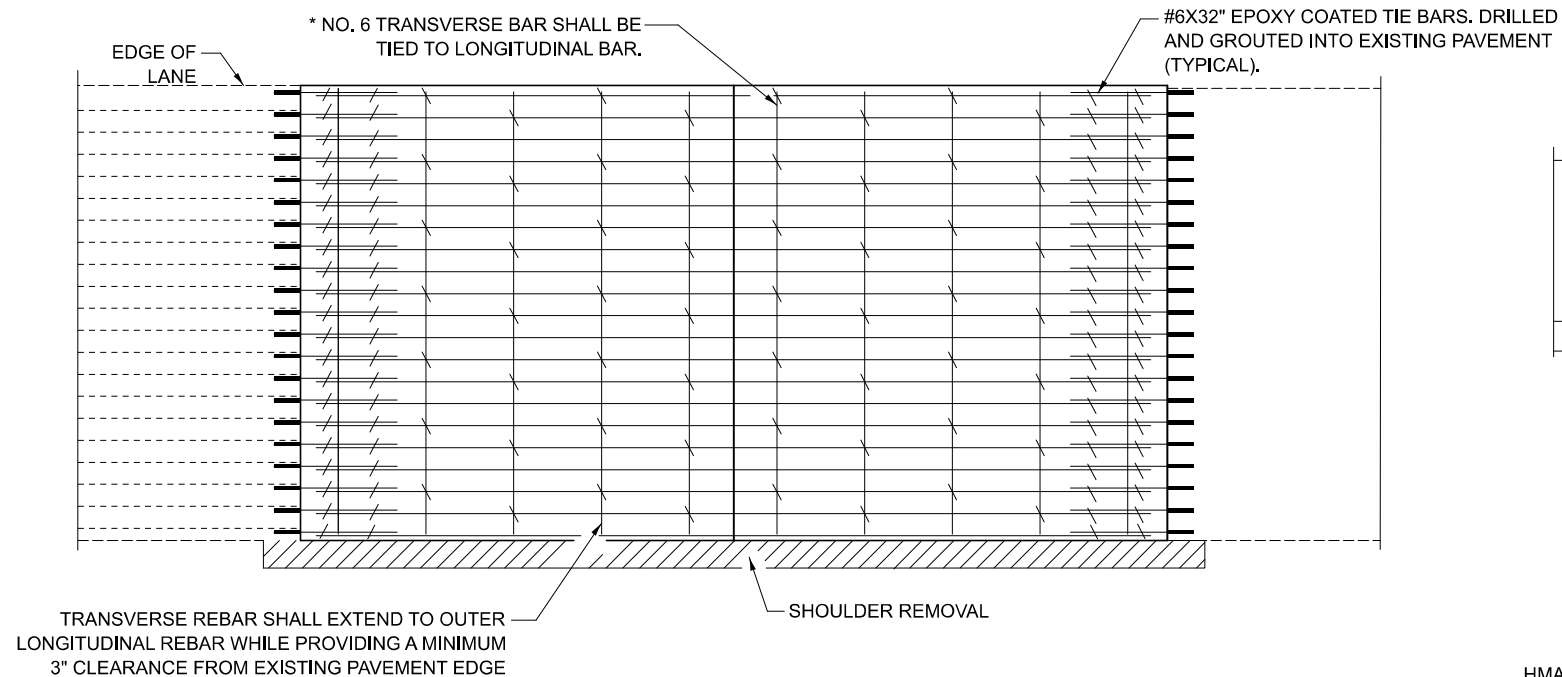

PAVEMENT REINFORCEMENT DETAIL

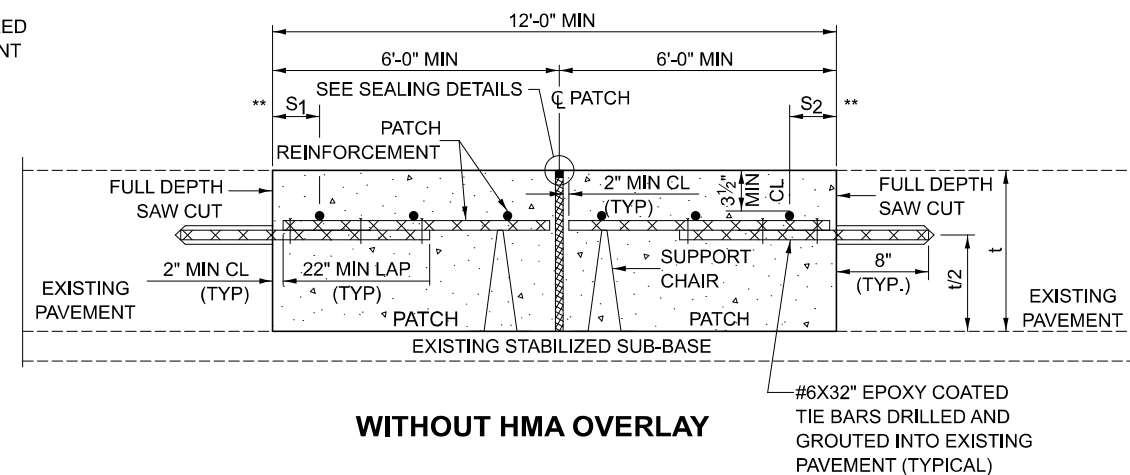

WITHOUT HMA OVERLAY

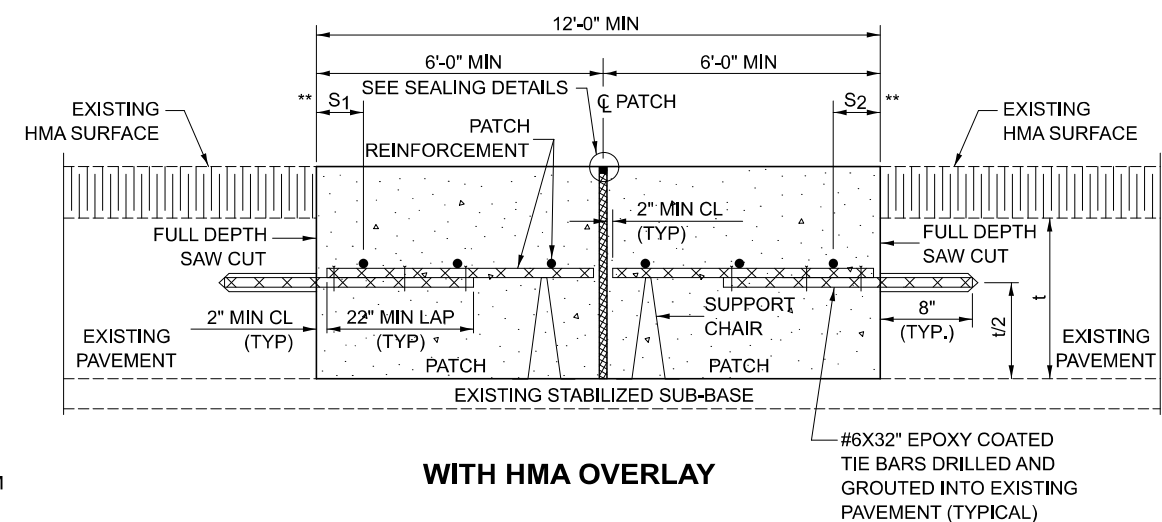

WITH HMA OVERLAY

CLASS A PATCH WITH EXPANSION JOINT

NOTES:

EXISTING LONGITUDINAL REINFORCEMENT SPACING: $\pm 6\frac{1}{2}$ ".

SPACING OF NEW LONGITUDINAL REINFORCEMENT AND NEW LONGITUDINAL TIE BARS SHALL MATCH SPACING OF EXISTING REINFORCEMENT AND SHALL BE TIED TOGETHER WITH A MINIMUM OF TWO TIES PER BAR.

SUPPORT CHAIRS SHALL BE REQUIRED WHENEVER PATCH LENGTH EXCEEDS 6'-0"

* EVERY THIRD INTERSECTION MUST BE TIED. WHEN THE MINIMUM CLEARANCE CANNOT BE OBTAINED WITH THE TRANSVERSE REBAR ON TOP, THEN THE TRANSVERSE REBAR SHALL BE TIED TO THE BOTTOM OF THE LONGITUDINAL REBAR.

** VARIABLES WHERE S_1 AND S_2 ARE $2\frac{1}{2}$ " MIN. AND 12" MAX.

Note: All dimensions are in INCHES (millimeters) unless otherwise shown.

DISTRICT 5 DETAIL NO. 44200AAA

F.A.I. RTE.	SECTION	COUNTY	TOTAL SHEETS	SHEET NO.
55	(57-6,7,20)PP	MCLEAN	13	13
CONTRACT NO. 70H85				
ILLINOIS FED. AID PROJECT				

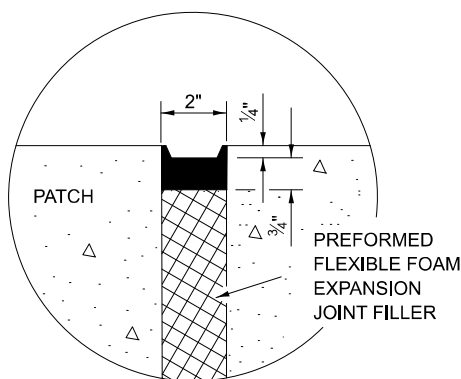

SEALING DETAIL

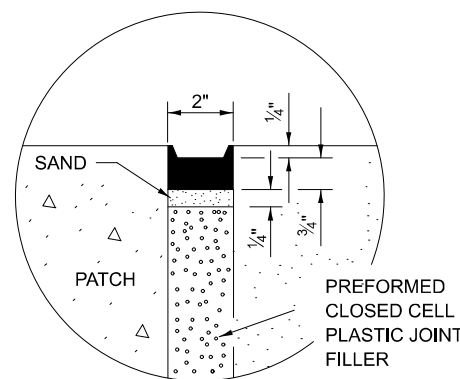

SEALING DETAIL

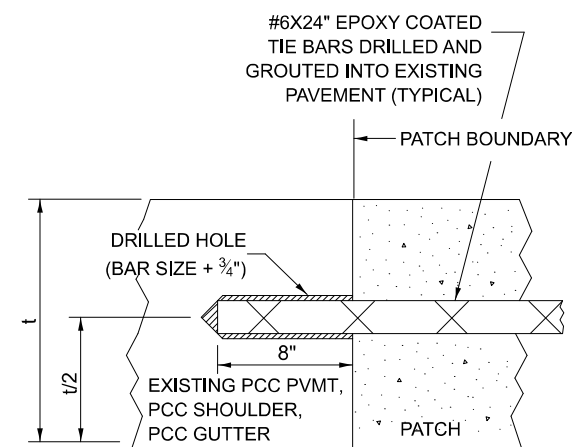

LONGITUDINAL CONSTRUCTION JOINT

PATCHES MORE THAN 20' IN LENGTH SHALL BE TIED TO ADJACENT PAVEMENT, PCC SHOULDERS OR PCC CURB AND GUTTER WITH #6x24" EPOXY COATED TIE BARS AT 36" CENTERS.

MODEL: 44200AAA Sheet 2 (Sheet)
FILE NAME: c:\p\work\pav\illinois.gov\1130707\0570H85-Sht-Detail_44200AAA.dgn

USER NAME = jackson.chen	DESIGNED - JWS	REVISED - 12/2023 - JWS
	DRAWN -	REVISED -
	CHECKED -	REVISED -
PLOT DATE = 12/4/2025	DATE - 01/2021	REVISED -

**STATE OF ILLINOIS
DEPARTMENT OF TRANSPORTATION**

CLASS A PATCHING (SPECIAL)

SCALE: SHEET 2 OF 2 SHEETS STA. TO STA.