

STATE OF ILLINOIS
DEPARTMENT OF TRANSPORTATION

F.A.S. RTE.	SECTION	COUNTY	TOTAL SHEETS	SHEET NO.
468	118RS-4	ILINOIS	12	1
			CONTRACT NO. 72443	
*LOGAN & TAZEWELL				

FOR INDEX OF SHEETS, SEE SHEET NO. 2

HIGHWAY CLASSIFICATION
FAS 468 (US 136 SPUR, ARMINGTON RD)
COLLECTION: MAJOR COLLECTOR
ADT: 425 (2016)

**PROPOSED
HIGHWAY PLANS**

**FAS ROUTE 468 (US 136 SPUR/ARMINGTON RD)
SECTION 118RS-4
FEDERAL PROJ# STP-R5KW(837)
SMART OVERLAY
LOGAN & TAZEWELL COUNTY
C-96-088-25**

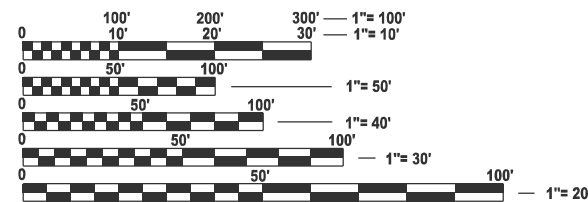
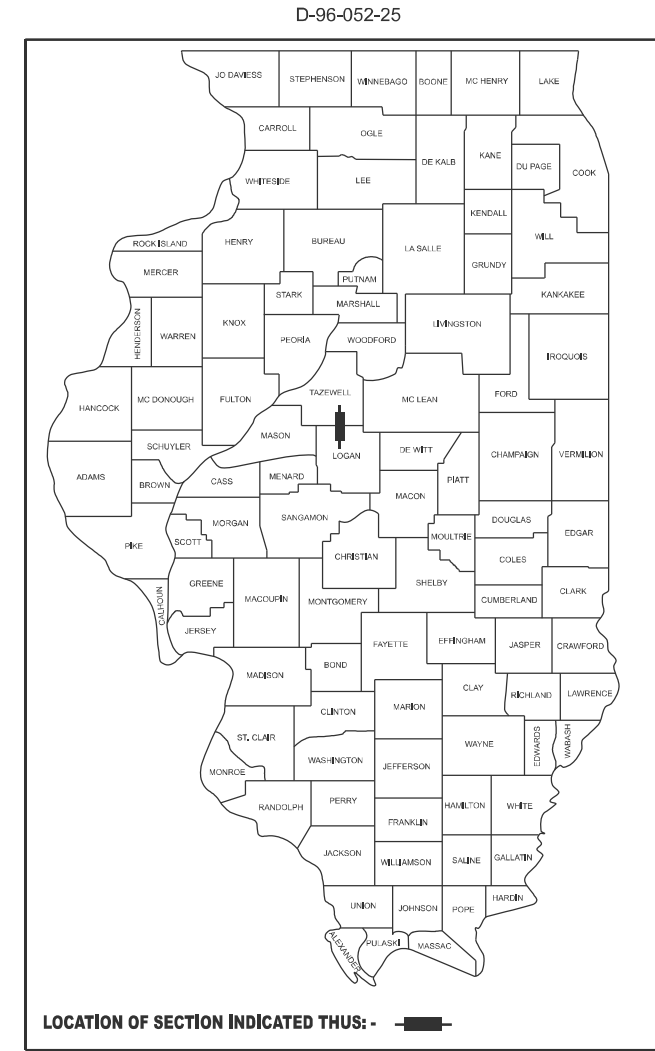

FULL SIZE PLANS HAVE BEEN PREPARED USING STANDARD ENGINEERING SCALES. REDUCED SIZED PLANS WILL NOT CONFORM TO STANDARD SCALES. IN MAKING MEASUREMENTS ON REDUCED PLANS, THE ABOVE SCALES MAY BE USED.

J.U.L.I.E.
JOINT UTILITY LOCATION INFORMATION FOR EXCAVATION
1-800-892-0123
OR 811

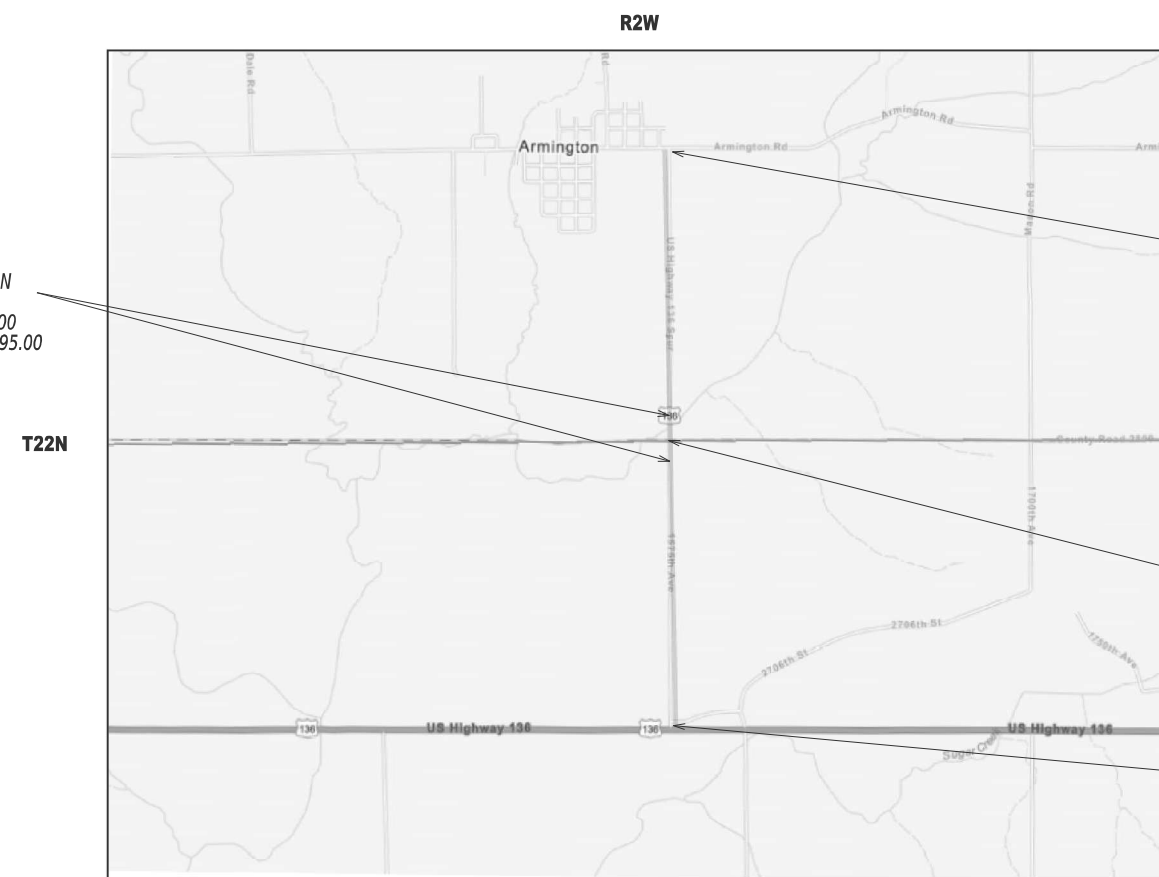

PROJECT ENGINEER: JAY EDWARDS (217) 785-0597
PROJECT MANAGER: JONATHAN COX (217) 782-1378

GROSS LENGTH = 10601.00 FT. = 2.01 MILE
NET LENGTH = 10321.00 FT. = 1.95 MILE

CONTRACT NO. 72443

STATE OF ILLINOIS
DEPARTMENT OF TRANSPORTATION

SUBMITTED January 30, 2026
Teresa C. Price
REGIONAL ENGINEER

March 20, 2026
Scott E. Price
ENGINEER OF DESIGN AND ENVIRONMENT

March 20, 2026
Gregory S. Price
DIRECTOR OF HIGHWAYS PROJECT IMPLEMENTATION

**PRINTED BY THE AUTHORITY
OF THE STATE OF ILLINOIS**

HIGHWAY STANDARDS

- 000001-09 STANDARD SYMBOLS, ABBREVIATIONS, AND PATTERNS
- 701001-02 OFF-ROAD OPERATIONS, 2L, 2W, MORE THAN 15' AWAY
- 701006-05 OFF-ROAD OPERATIONSS, 2L, 2W, 15' TO 24' FROM PAVEMENT EDGE
- 701201-05 LANE CLOSURE, 2L, 2W, DAY ONLY, FOR SPEEDS 45 MPH OR MORE
- 701301-04 LANE CLOSURE, 2L, 2W, SHORT TIME OPERATIONS
- 701306-04 LANE CLOSURE, 2L, 2W, SLOW MOVING OPERATIONS, DAY ONLY, FOR SPEEDS ≥ 45 MPH
- 701311-03 LANE CLOSURE, 2L, 2W, MOVING OPERATIONS, DAY ONLY
- 701901-11 TRAFFIC CONTROL DEVICES
- 780001-05 TYPICAL PAVEMENT MARKINGS
- 781001-04 TYPICAL APPLICATIONS RAISED REFLECTIVE PAVEMENT MARKERS

INDEX OF SHEETS

- 1 COVER SHEET
- 2 INDEX OF SHEETS, LISTS OF STANDARDS
GENERAL NOTES AND COMMITMENTS
- 3-4 SUMMARY OF QUANTITIES
- 5 SCHEDULE OF QUANTITIES
- 6-7 TYPICAL SECTIONS (2)
- 8-11 PLAN SHEETS (4)
- 12 SIDEROAD DETAILS

GENERAL NOTES

- 1 NO PASSING ZONES SHALL BE FIELD VERIFIED AND DOCUMENTED BY THE RESIDENT ENGINEER. THE RESIDENT ENGINEER SHALL NOTIFY THE BUREAU OF OPERATIONS IF THEY HAVE CONCERNS WITH ANY NO PASSING ZONES AND AT LEAST 14 DAYS PRIOR TO PLACEMENT OF FINAL PAVEMENT MARKINGS AT 217-785-5306.
- 2 THE CONTRACTOR SHALL USE TYPE IV PAVEMENT MARKING TAPE AS SHORT-TERM PAVEMENT MARKING ON THE SURFACE LIFT.

RATE TABLE

THE FOLLOWING RATES OF APPLICATION HAVE BEEN ASSUMED IN CALCULATING PLAN QUANTITIES.

HMA SURFACE	.056 TONS/(SQY*IN)
BITUMINOUS MATERIALS (TACK COAT):	0.05 LBS/SQ FT (MILLED SURFACE)
AGGREGATE WEDGE SHOULDERS TYPE B	1.6 TONS/CUY

COMMITMENTS

NONE

THE FOLLOWING MIXTURE REQUIREMENTS ARE APPLICABLE

LOCATIONS:	PAVEMENT
MIXTURE USE(S):	HMA SURFACE COURSE
AC/PG:	PG 58-28
DESIGN AIR VOIDS:	4.0% @ N DESIGN = 50
MIXTURE COMPOSITION (GRADATION MIXTURE)	IL 9.5
FRICTION AGGREGATE:	MIX "C"
QUALITY MANAGEMENT	QCP
SUBLOT SIZE:	1,000 TONS
MTD:	YES

**STATE OF ILLINOIS
DEPARTMENT OF TRANSPORTATION
DIVISION OF HIGHWAYS
DISTRICT 6**

EXAMINED January 14, 20 26
J. A. DeLeon
ENGINEER OF OPERATIONS

EXAMINED January 14, 20 26
R. P. Swetty
ENGINEER OF PROJECT IMPLEMENTATION

EXAMINED January 12, 20 26
M. V.
ENGINEER OF PROGRAM DEVELOPMENT

REV - MS

MODEL: General Notes (Sheet)
FILE NAME: c:\pw\work\paw\co\w\105778172443-sh1 Gen Notes.dgn

USER NAME = Jonathan.Cox PLOT DATE = 10/20/2025	DESIGNED - DRAWN - CHECKED - DATE -	REVISED - REVISED - REVISED - REVISED -	STATE OF ILLINOIS DEPARTMENT OF TRANSPORTATION	INDEX OF SHEETS, LISTS OF STANDARDS, GENERAL NOTES, & COMMITMENTS	F.A.S RTE. 488	SECTION 118RS-4	COUNTY *	TOTAL SHEETS 12	SHEET NO. 2
SCALE:				SHEET 1 OF 1 SHEETS	STA.		TO STA.		
					ILLINOIS FED. AID PROJECT				

CODE NO.	ITEM	UNIT	TOTAL QUANTITY	6-69180-0000	6-69180-0000
				STP FUNDING 80% FEDERAL 20% STATE	STP FUNDING 80% FEDERAL 20% STATE
				ROADWAY 0005 TAZEWELL	ROADWAY 0005 LOGAN
40600290	BITUMINOUS MATERIALS (TACK COAT)	POUND	10,870	5326	5544
40600370	LONGITUDINAL JOINT SEALANT	FOOT	10,321	5209	5112
40600405	MATERIAL TRANSFER DEVICE	TON	2,060	1025	1035
40600982	HOT-MIX ASPHALT SURFACE REMOVAL - BUTT JOINT	SQ YD	540	334	206
40600990	TEMPORARY RAMP	SQ YD	93	22	71
40604050	HOT-MIX ASPHALT SURFACE COURSE, IL-9.5, MIX "C", N50	TON	2,060	1025	1035
40800029	BITUMINOUS MATERIALS (TACK COAT)	POUND	49	0	49
40800050	INCIDENTAL HOT-MIX ASPHALT SURFACING	TON	9	0	9
44000151	HOT-MIX ASPHALT SURFACE REMOVAL, 1/2"	SQ YD	24,154	11835	12319
48102100	AGGREGATE WEDGE SHOULDER, TYPE B	TON	382	193	189
67000400	ENGINEER'S FIELD OFFICE, TYPE A	CAL MO	6	3	3
67100100	MOBILIZATION	L SUM	1	0.5	0.5
70100450	TRAFFIC CONTROL AND PROTECTION, STANDARD 701201	L SUM	1	0.5	0.5
70100460	TRAFFIC CONTROL AND PROTECTION, STANDARD 701306	L SUM	1	0.5	0.5

MODEL: Summary of Quantities (Sheet)
 FILE NAME: c:\p\work\paw\stc\proj\1105778172443.sht - SOQ.dgn

USER NAME = Jonathan.Cox	DESIGNED -	REVISED -
	DRAWN -	REVISED -
	CHECKED -	REVISED -
PLOT DATE = 10/20/2025	DATE -	REVISED -

**STATE OF ILLINOIS
DEPARTMENT OF TRANSPORTATION**

SUMMARY OF QUANTITIES

SCALE: SHEET 1 OF 2 SHEETS STA. TO STA.

F.A.S RTE.	SECTION	COUNTY	TOTAL SHEETS	SHEET NO.
488	118RS-4	*	12	3
CONTRACT NO. 72443				
ILLINOIS FED. AID PROJECT				

LOCATION	LENGTH (FOOT)	WIDTH (FOOT)	AREA (SQ YD)	BITUMINOUS MATERIALS (TACK COAT)	HMA SURFACE REM 1/2"	HMA SURFACE COURSE, IL 9.5, MIX "C", N50	LONGITUDINAL JOINT SEALANT	MATERIAL TRANSFER DEVICE		
FAS 468 ARMINGTON (TAZEWELL)				POUND	SQ YD	TON	FOOT	TON		
+06.00	TO	+75.00	4700.00	522.22	235	522	44	69	44	
+75.00	TO	1+12.00	37.00	21.75	89.42	40	89	8	37	8
1+12.00	TO	39+16.00	3804.00	20	8453.33	3804	8453	710	3804	710
39+16.00	TO	47+00.00	784.00	21.75	1894.67	853	1895	159	784	159
47+00.00	TO	52+15.00	515.00	21.75	1244.58	560	1245	105	515	105
BRIDGE OMISSION STA 52+15.00 TO STA 54+95.00 (COUNTY SPLIT STA 53+56.00)										
SUB-TOTAL (TAZEWELL)				5492	12204	1025	5209	1025		
FAS 468 ARMINGTON (LOGAN)										
54+95.00	TO	58+00.00	305	23.5	1423.33	641	1423	120	305	120
58+00.00	TO	59+00.00	100.00	21.75	241.67	109	242	20	100	20
59+00.00	TO	61+00.00	200.00	21.75	483.33	218	483	41	200	41
61+00.00	TO	63+00.00	200.00	23.5	522.22	235	522	44	200	44
63+00.00	TO	67+00.00	400	21.75	966.67	435	967	81	400	81
67+00.00	TO	106+07.00	3907.00	20	8682.22	3907	8682	729	3907	729
SUB-TOTAL (LOGAN)				5544	12319	1035	5112	1035		
TOTAL				11036	24523	2060	10321	2060		

LOCATION	LENGTH	78009005				78009024
		MODIFIED URETHANE MARKING 5"				MODIFIED URETHANE MARKING 24"
FAS 468 ARMINGTON (TAZEWELL)		FOOT				FOOT
		WHITE EDGE LINES	YELLOW-SKIP-DASH	YELLOW-SOLID	YELLOW DOUBLE SOLID	STOP BAR
+06.00	TO	31+25.00	3119	6238	779.75	
31+25.00	TO	44+50.00	1325	2650	331.25	1325
44+50.00	TO	53+56.00	906	1812	226.50	
SUB-TOTAL (TAZEWELL)		10700	1338	1325	0	0
		13363				
FAS 468 ARMINGTON (LOGAN)						
53+36.00	TO	58+75.00	539	1078	539	
58+75.00	TO	73+50.00	1475	2950		2950
73+50.00	TO	98+50.00	2500	5000	625.00	
98+50.00	TO	106+07.00	757	1514		1514
SUB-TOTAL (LOGAN)		10542	625	539	4464	10
		16170				
TOTAL		29533				10

LOCATION	LENGTH (FOOT)	WIDTH (FOOT)	DEPTH (INCH)	SIDE	48102100 AGGREGATE WEDGE SHOULDER, TYPE B		
FAS 468 ARMINGTON (TAZEWELL)							
+06.00	TO	+75.00	69	3	1.25	RT/LT	2.6
+75.00	TO	1+12.00	37	3	1.25	RT/LT	1.4
1+12.00	TO	39+16.00	3804	3	1.25	RT/LT	140.9
39+16.00	TO	47+00.00	784	3	1.25	RT/LT	29.0
47+00.00	TO	52+15.00	515	3	1.25	RT/LT	19.1
BRIDGE OMISSION STA 52+15.00 TO STA 54+95.00 (COUNTY SPLIT STA 53+56.00)							
SUB-TOTAL (TAZEWELL)						193	
FAS 468 ARMINGTON (LOGAN)							
54+95.00	TO	58+00.00	305	3	1.25	RT/LT	11.3
58+00.00	TO	59+00.00	100	3	1.25	RT/LT	3.7
59+00.00	TO	61+00.00	200	3	1.25	RT/LT	7.4
61+00.00	TO	63+00.00	200	3	1.25	RT/LT	7.4
63+00.00	TO	67+00.00	400	3	1.25	RT/LT	14.8
67+00.00	TO	106+07.00	3907	3	1.25	RT/LT	144.7
SUB-TOTAL (LOGAN)						189	
TOTAL						382	

LOCATION	DESCRIPTION	SIDE	FROM EOP	WIDTH	THICKNESS	TEMP RAMP LENGTH	TEMPORARY RAMP	40600990	40800029	40800050	40600982
							TEMPORARY RAMP	BITUMINOUS MATERIALS (TACK COAT)	INCIDENTAL HMA SURFACING	HMA SURFACE REM - BUTT JOINT	
							SQ YD	POUNDS	TON	SQ YD	
FAP 34 (IL 97, IL 123)											
+06.00	LIMITS OF IMPROVEMENT		BUTT JOINT 20'	WIDTH 2,566 SQ FT		5.00	11.11				205.11
52+15.00	BRIDGE OMISSION		BUTT JOINT 20'	WIDTH 21'-9"		5.00	11.11				48.33
BRIDGE OMISSION STA 52+15.00 TO STA 54+95.00 (COUNTY SPLIT STA 53+56.00)							22	0	0	334	
SUB-TOTAL (TAZEWELL)											
54+95.00	BRIDGE OMISSION		BUTT JOINT 20'	WIDTH 23'-5"		5.00	11.11				52.22
366+01.90	2706 ST	LT	13.00	88.00	64.00	1.50	5.00	48.89	49	9	110
106+07.00	LIMITS OF IMPROVEMENT		BUTT JOINT 20'	WIDTH 20'		5.00	11.11				44.44
SUB-TOTAL (LOGAN)							71	49	9	206	
TOTAL							93	49	9	541	

LOCATION	70300100 SHORT TERM PAVEMENT MARKING	70300150 SHORT TERM PAVEMENT MARKING REM		
FAS 468 ARMINGTON (TAZEWELL)				
+06.00	TO	52+15.00	521	174
BRIDGE OMISSION STA 52+15.00 TO STA 54+95.00 (COUNTY SPLIT STA 53+56.00)				
SUB-TOTAL AFTER MILLING		521		
AFTER SURFACE COURSE		521		
SUB-TOTAL (TAZEWELL)		1042	174	
FAS 468 ARMINGTON (LOGAN)				
54+95.00	TO	106+07.00	511	170
SUB-TOTAL AFTER MILLING		511		
AFTER SURFACE COURSE		511	170	
SUB-TOTAL (LOGAN)		1022		
TOTAL		2064	344	

LOCATION	78100100 RAISED REFLECTIVE PAVEMENT MARKER (EACH)		
FAS 468 ARMINGTON (TAZEWELL)			
+06.00	TO	53+56.00	67
SUB-TOTAL (TAZEWELL)		67	
FAS 468 ARMINGTON (LOGAN)			
53+56.00	TO	106+07.00	66
SUB-TOTAL (LOGAN)		66	
TOTAL		133	

MODEL - Schedule of Quantities (Sheet)
FILE NAME: c:\pwworking\illinois\110578172443-sh-Schedule.dgn

USER NAME = Jonathan.Cox	DESIGNED -	REVISED -
	DRAWN -	REVISED -
	CHECKED -	REVISED -
PLOT DATE = 10/20/2025	DATE -	REVISED -

**STATE OF ILLINOIS
DEPARTMENT OF TRANSPORTATION**

SCHEDULE OF QUANTITIES

SCALE: SHEET 1 OF 1 SHEETS STA. TO STA.

F.A.S. RTE.	SECTION	COUNTY	TOTAL SHEETS	SHEET NO.
468	118RS-4	*	12	5
CONTRACT NO. 72443				
ILLINOIS FED. AID PROJECT				

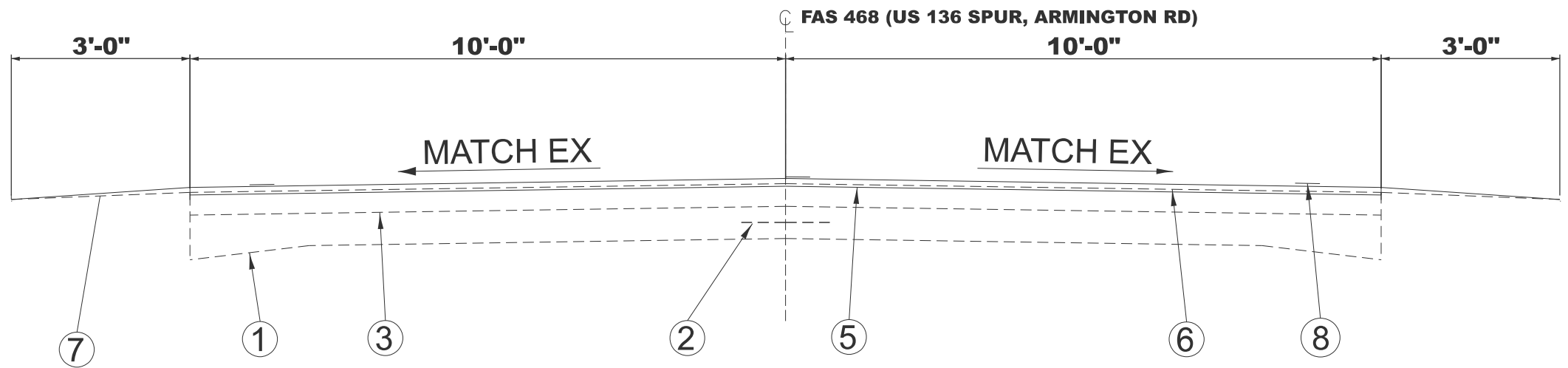

FAS 468
 STA. 0+06.00 TO 0+75.00
 STA. 1+12.00 TO 39+16.00
 STA 52+15.00 TO 54+95.00 BRIDGE OMISSION
 STA 67+00.00 TO 106+07.00

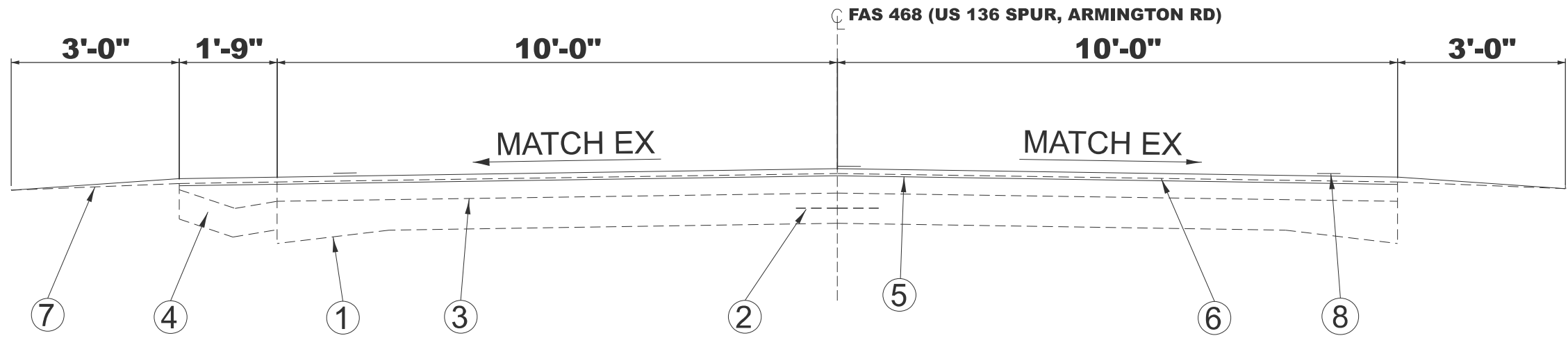

FAS 468
 STA. 39+16.00 TO 47+00.00
 STA. 59+00.00 TO 61+00.00

LEGEND

- 1- EXIST. P.C.C. PAVEMENT 9- 6 1/2- 9
- 2- EXIST. 1/2" TIE BAR
- 3- EXIST. BITUMINOUS SURFACE 5 3/4"
- 4- EXIST. CONCRETE GUTTER
- 5- PROP. HOT-MIX ASPHALT SURFACE REMOVAL 1/2"
- 6- PROP. HOT-MIX ASPHALT SURFACE COURSE, IL 9.5, MIX C. N50 1 1/2"
- 7- PROP. AGGREGATE SHOULDER. TYPE B
- 8- PROP. MODIFIED URETHANE PAVEMENT MARKING. LINE 5"

MODEL: Typical=1 (Sheet)
 FILE NAME: c:\p\work\pav\typical\110578\72443-shr\typical.sgm

USER NAME = evan.stallone	DESIGNED -	REVISED -
	DRAWN -	REVISED -
	CHECKED -	REVISED -
PLOT DATE = 12/2/2025	DATE -	REVISED -

**STATE OF ILLINOIS
 DEPARTMENT OF TRANSPORTATION**

TYPICAL SECTIONS			
SCALE:	SHEET 1	OF 2 SHEETS	STA. TO STA.

F.A.S. RTE.	SECTION	COUNTY	TOTAL SHEETS	SHEET NO.
468	118RS-4	*	12	6
CONTRACT NO. 72443				

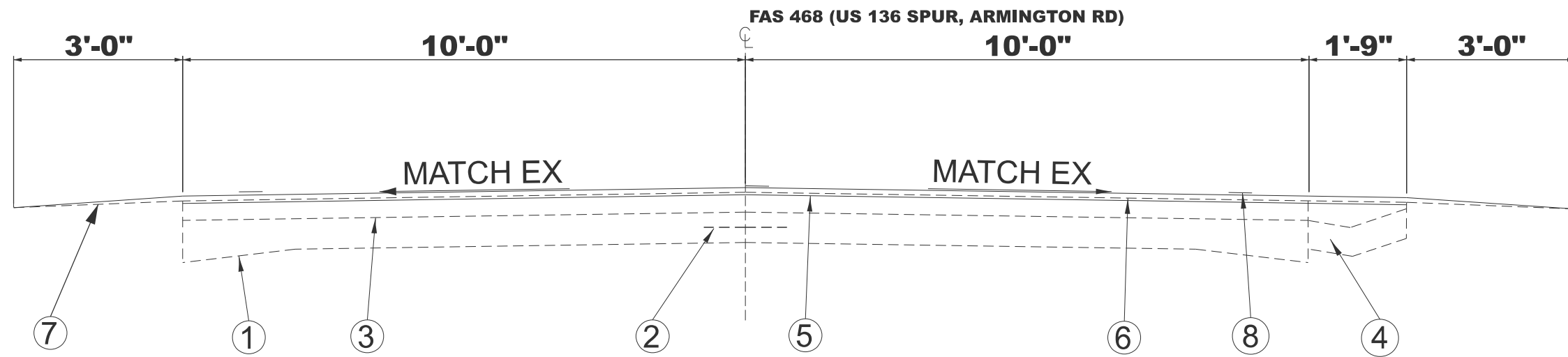

FAS 468
 STA. 0+75.00 TO 1+12.00
 STA. 47+00.00 TO 52+15.00
 STA. 58+00.00 TO 59+00.00
 STA. 63+00.00 TO 67+00.00

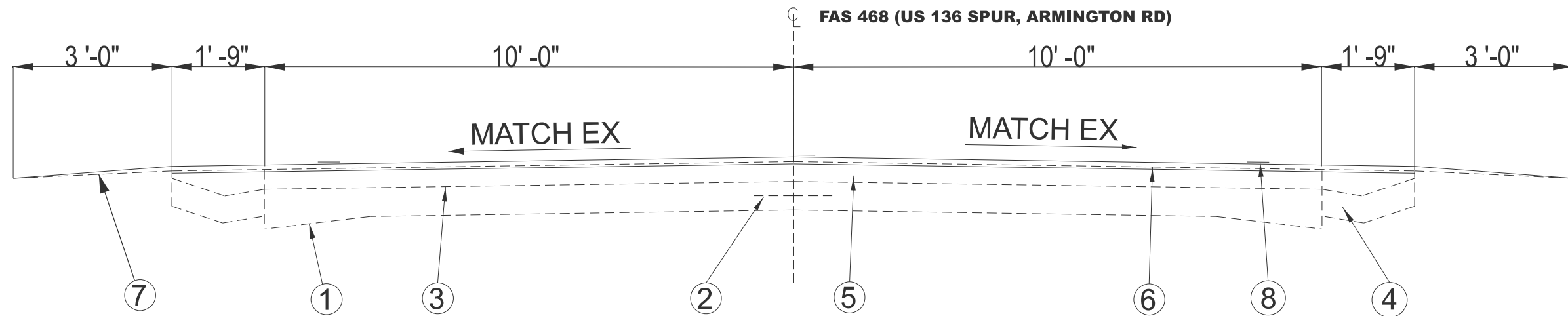

FAS 468
 STA. 54+95.00 TO 58+00.00
 STA. 61+00.00 TO 63+00.00

LEGEND

- 1- EXIST. P.C.C. PAVEMENT 9- 6 1/2- 9
- 2- EXIST. 1/2" TIE BAR
- 3- EXIST. BITUMINOUS SURFACE 5 3/4"
- 4- EXIST. CONCRETE GUTTER
- 5- PROP. HOT-MIX ASPHALT SURFACE REMOVAL 1/2"
- 6- PROP. HOT-MIX ASPHALT SURFACE COURSE, IL 9.5, MIX C. N50 1 1/2"
- 7- PROP. AGGREGATE SHOULDER. TYPE B
- 8- PROP. MODIFIED URETHANE PAVEMENT MARKING. LINE 5"

MODEL: Typical-2 (Sheet)
 FILE NAME: c:\p\work\pav\to\co\j\110578\72443-sh\typical.sgm

USER NAME = Jonathan.Cox	DESIGNED -	REVISED -
	DRAWN -	REVISED -
	CHECKED -	REVISED -
PLOT DATE = 11/21/2025	DATE -	REVISED -

STATE OF ILLINOIS
 DEPARTMENT OF TRANSPORTATION

TYPICAL SECTIONS

SCALE: SHEET 2 OF 2 SHEETS STA. TO STA.

F.A.S. RTE.	SECTION	COUNTY	TOTAL SHEETS	SHEET NO.
468	118RS-4	*	12	7
CONTRACT NO. 72443				

ILLINOIS FED. AID PROJECT

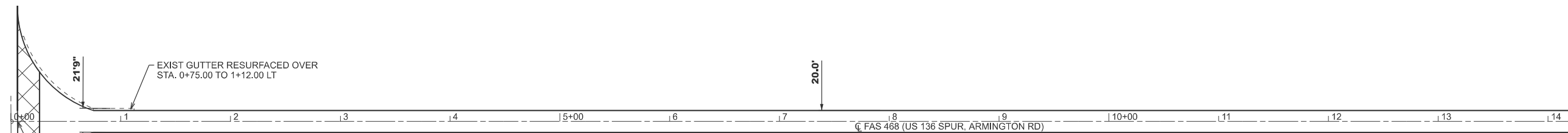

MATCHLINE STA. 15+00.00

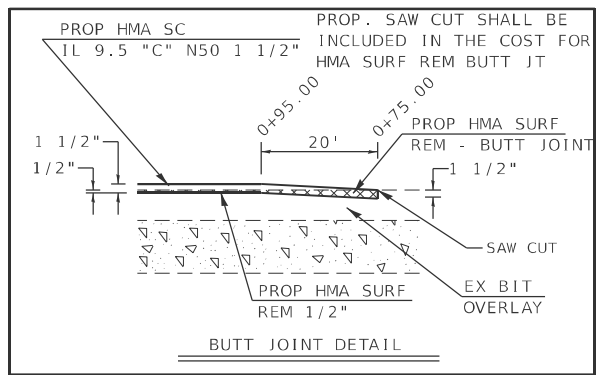

MATCHLINE STA. 15+00.00

MATCHLINE STA. 30+00.00

MODEL: ARMINGTON_RD - 72443 Plan Sheets (Sheet)
FILE NAME: c:\p\work\review\coxon\110578\72443-shr-Plans.dgn

USER NAME = Jonathan.Cox	DESIGNED -	REVISED -
	DRAWN -	REVISED -
	CHECKED -	REVISED -
PLOT DATE = 1/15/2026	DATE -	REVISED -

**STATE OF ILLINOIS
DEPARTMENT OF TRANSPORTATION**

PLAN SHEETS

SCALE: 1"=50' SHEET 1 OF 4 SHEETS STA. 0+00.00 TO STA. 30+00.00

F.A.S RTE.	SECTION	COUNTY	TOTAL SHEETS	SHEET NO.
468	118RS-4	*	12	8
CONTRACT NO. 72443				
ILLINOIS FED. AID PROJECT				

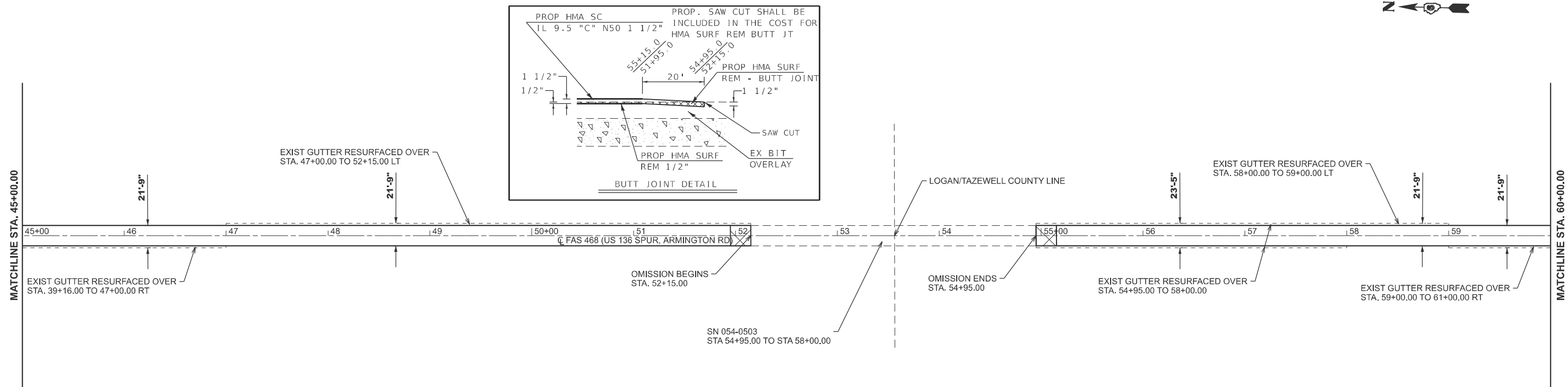
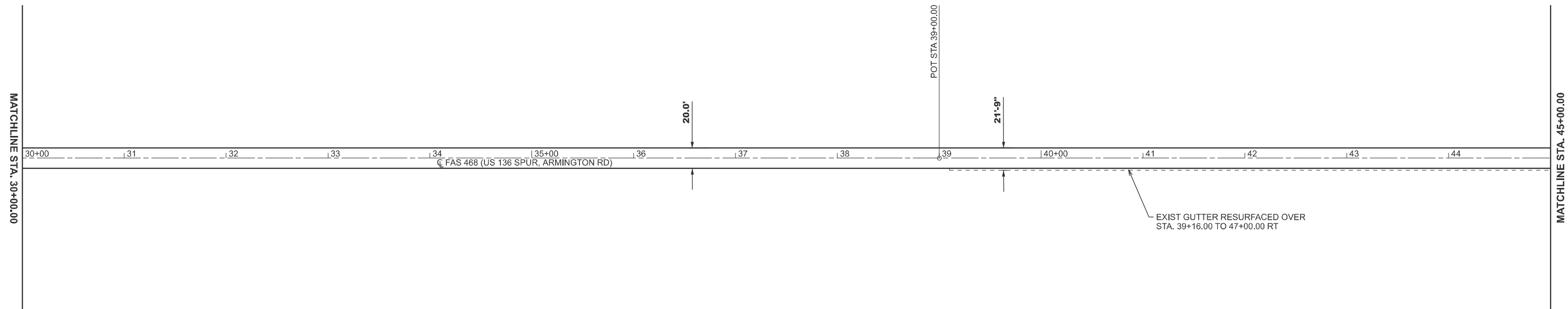

MODEL: ARMINGTON_RD - 72443 Plan Sheets-2 (Sheet)
 FILE NAME: c:\p\work\rev\illinois.gov\1105778\7243-shr-Plans.dgn

USER NAME = evan.stallone	DESIGNED -	REVISED -
	DRAWN -	REVISED -
	CHECKED -	REVISED -
PLOT DATE = 1/16/2026	DATE -	REVISED -

**STATE OF ILLINOIS
DEPARTMENT OF TRANSPORTATION**

PLAN SHEETS

SCALE: 1"=50' SHEET 2 OF 4 SHEETS STA. 30+00.00 TO STA. 60+00.00

F.A.S. RTE.	SECTION	COUNTY	TOTAL SHEETS	SHEET NO.
468	118RS-4	*	12	9
CONTRACT NO. 72443				

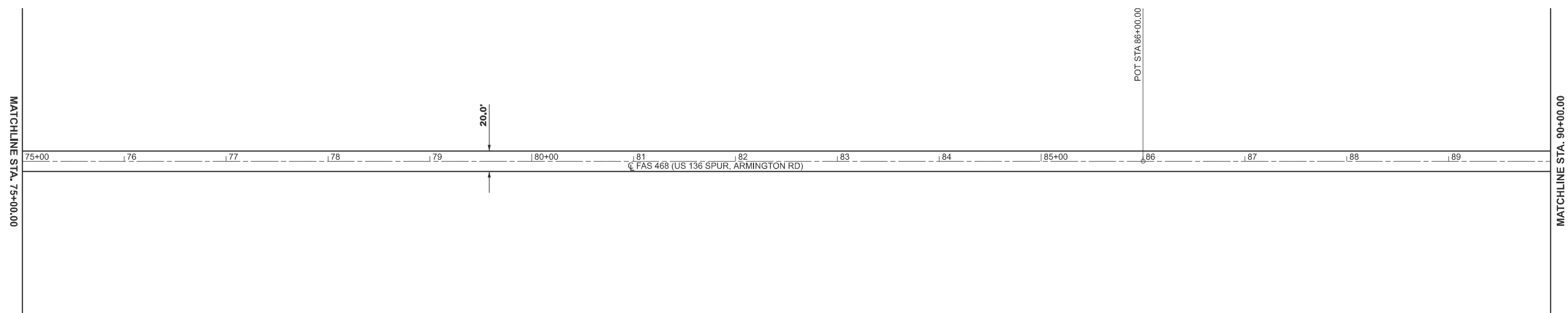
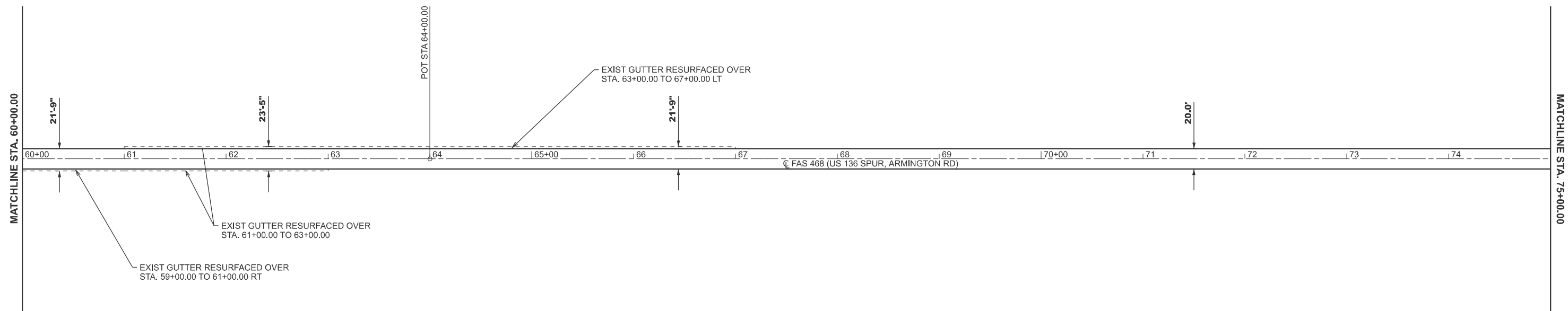

MODEL: ARMINGTON_RD - 72443 Plan Sheets-4 [Sheet]
 FILE NAME: c:\p\work\review\to\co\m\110578\72443-shr-Plans.dgn

USER NAME = Jonathan.Cox	DESIGNED -	REVISED -
	DRAWN -	REVISED -
	CHECKED -	REVISED -
PLOT DATE = 10/20/2025	DATE -	REVISED -

**STATE OF ILLINOIS
 DEPARTMENT OF TRANSPORTATION**

PLAN SHEETS

SCALE: 1"=50' SHEET 3 OF 4 SHEETS STA. 60+00.00 TO STA. 90+00.00

F.A.S RTE.	SECTION	COUNTY	TOTAL SHEETS	SHEET NO.
468	118RS-4	*	12	10
CONTRACT NO. 72443				
ILLINOIS		FED. AID PROJECT		



POT STA 11+60.66

MATCHLINE STA. 90+00.00

MATCHLINE STA. 105+00.00

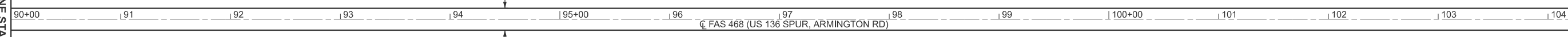

RESETTING SURVEY MARKERS							
NAD83/2007 ADJ - STATE PLANE WEST ZONE							
POINT	CORNER	EXISTING MONUMENT	NORTHING	EASTING	STATION	OFFSET	ALIGNMENT
22N2W_S34C8-9	NE COR., SW 1/4, SE 1/4 SECTION 34, T.22N., R.2W., 3RD P.M., LOGAN CO.	5/8" IRON PIN					
22N2W_S34C7-8	SW COR., SE 1/4, SE 1/4 SECTION 34, T.22N., R.2W., 3RD P.M., LOGAN CO.	ALUM. DISC	1328042.225	2536565.405	106+75.23	19.23 LT	ARMINGTON_RD

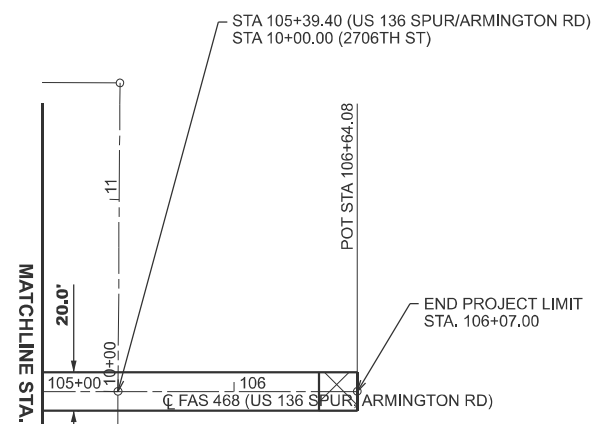

HORIZONTAL ALIGNMENT CONTROL			
NAD83/2007 ADJ - STATE PLANE WEST ZONE			
POINT TYPE	STATION	NORTHING	EASTING
ALIGNMENT NAME:		ARMINGTON_RD	
DESCRIPTION:		MAINLINE	
POT	0+00.00	1338713.470	2536273.329
POT	25+00.00	1336214.308	2536338.062
POT	39+00.00	1334814.777	2536374.313
POT	64+00.00	1332315.616	2536439.046
POT	86+00.00	1330116.353	2536496.011
POT	106+64.08	1328052.962	2536549.456
ALIGNMENT NAME:		THIRD_ST	
DESCRIPTION:		SIDE ROAD	
POT	8+15.36	1338708.186	2536088.761
POT	10+00.00	1338713.470	2536273.329
POT	12+00.00	1338719.193	2536473.247
ALIGNMENT NAME:		2706 ST	
DESCRIPTION:		SIDE ROAD	
POT	10+00.00	1328177.601	2536546.228
POT	10+56.63	1328178.683	2536602.843
POT	11+60.66	1328180.672	2536706.861

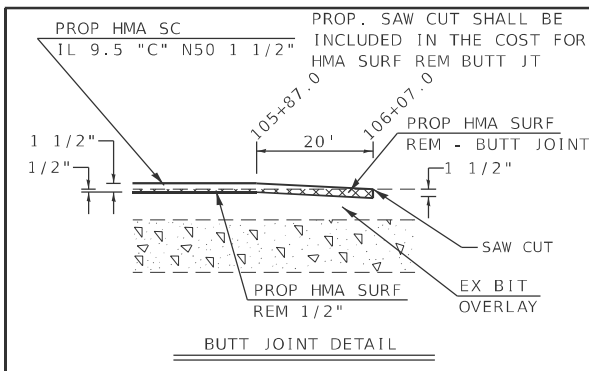

MODEL: ARMINGTON_RD - 72443 Plan Sheets-6 (Sheet)
FILE NAME: c:\p\work\armington\110578\72443-shr-Plans.dgn

USER NAME = Jonathan.Cox	DESIGNED -	REVISED -
	DRAWN -	REVISED -
	CHECKED -	REVISED -
PLOT DATE = 1/15/2026	DATE -	REVISED -

STATE OF ILLINOIS
DEPARTMENT OF TRANSPORTATION

PLAN SHEETS

SCALE: 1"=50' SHEET 4 OF 4 SHEETS STA. 90+00.00 TO STA. 120+00.00

F.A.S RTE.	SECTION	COUNTY	TOTAL SHEETS	SHEET NO.
468	118RS-4	*	12	11
CONTRACT NO. 72443				
ILLINOIS FED. AID PROJECT				

*LOGAN & TAZEWELL

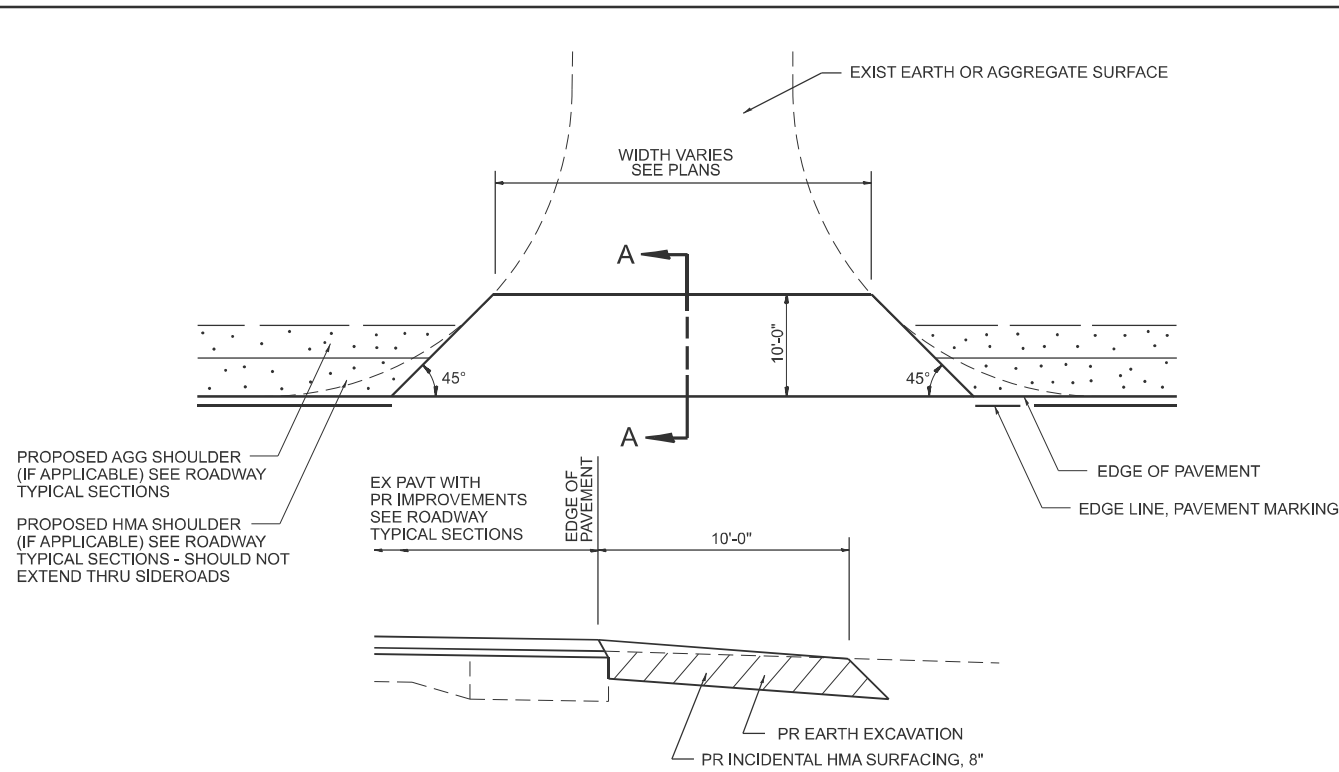

SECTION A-A
EXIST AGGREGATE SIDEROAD DETAIL
(NEW HMA APRON)

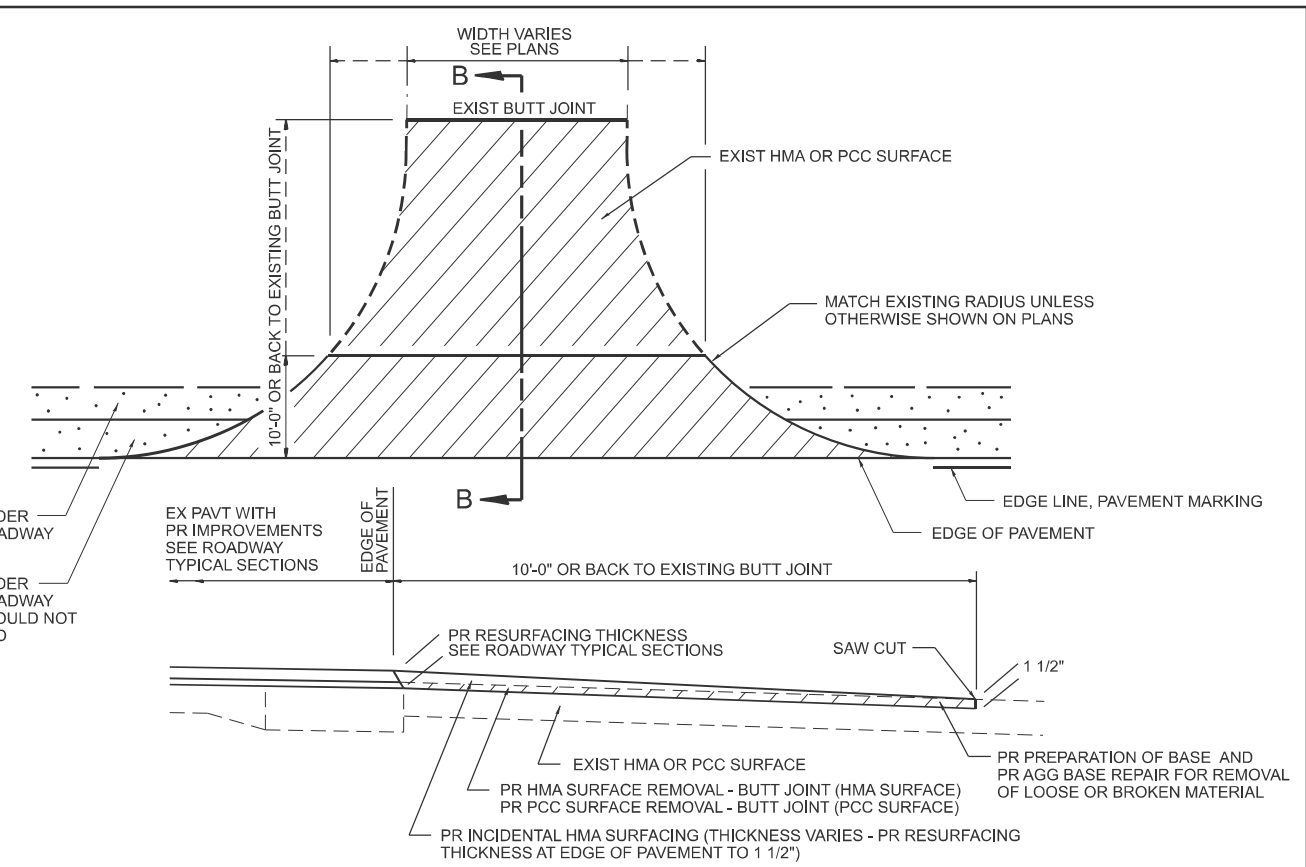

SECTION B-B
EXIST HMA OR PCC SIDEROAD DETAIL W/O CC&G (TO BE RESURFACED)

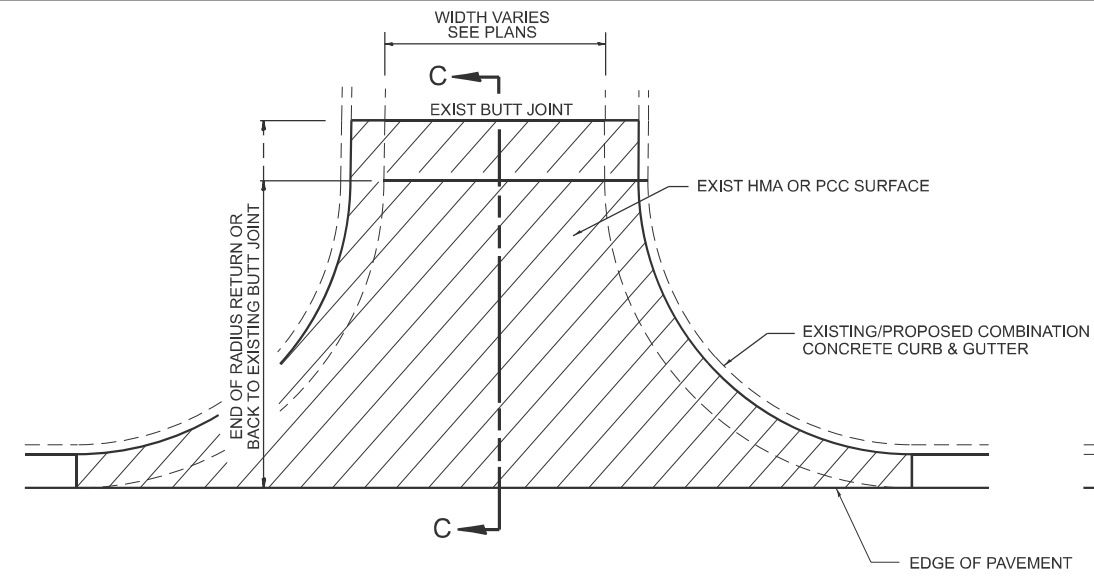

SECTION C-C
EXIST HMA SIDEROAD DETAIL W/CC&G
(TO BE RESURFACED)

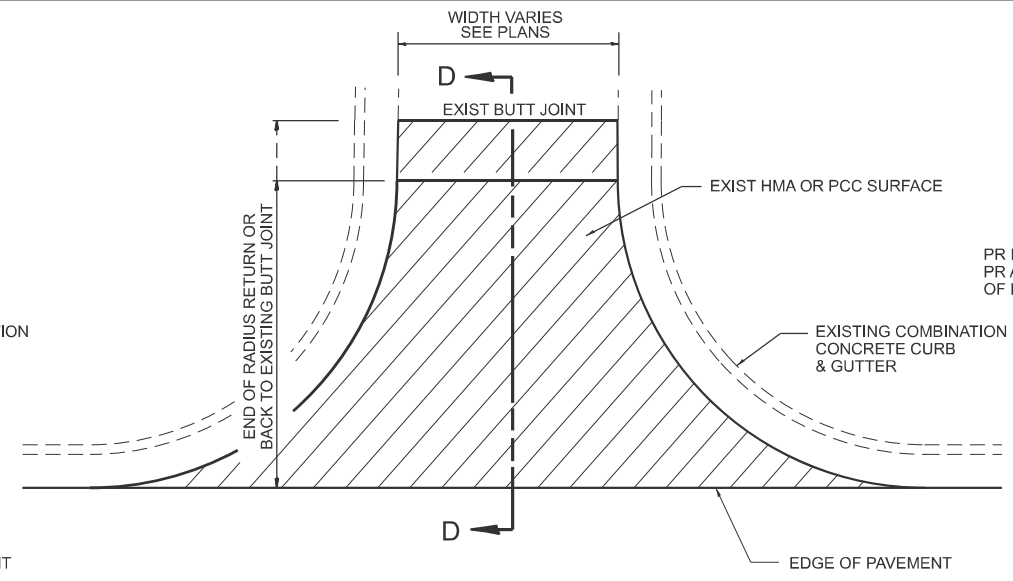

SECTION D-D
EXIST HMA OR PCC SIDEROAD DETAIL W/CC&G
(TO BE RESURFACED - MILL AND FILL ONLY)

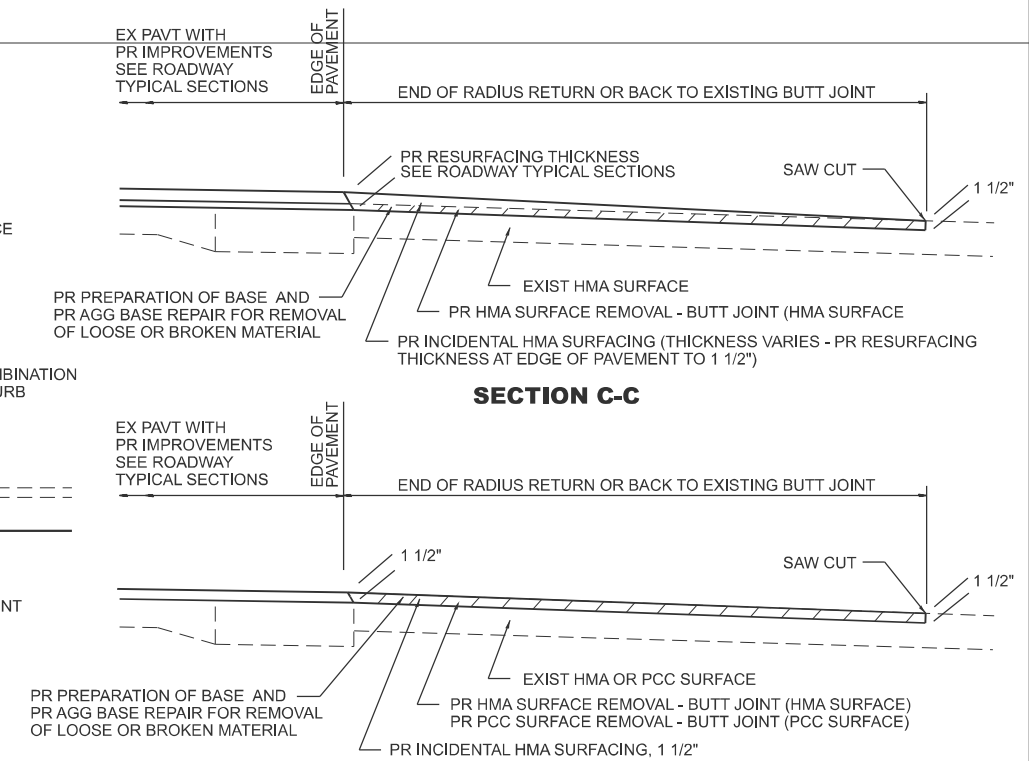

- NOTES:**
1. IF HMA SHOULDERS ARE PROPOSED, THEY SHOULD NOT EXTEND THROUGH SIDEROADS.
 2. THE COST OF SAW CUTS SHALL BE INCLUDED IN THE COST OF THE HMA SURFACE REMOVAL - BUTT JOINT OR PCC SURFACE REMOVAL - BUTT JOINT PAY ITEMS

MODEL: Detail Sheet (Sheet)
FILE NAME: c:\p\work\road\to\coj\m\1105778\72443-shr-Details.dgn

400 SIDERD_001	USER NAME = Jonathan.Cox	DESIGNED -	REVISED -
		DRAWN -	REVISED -
		CHECKED -	REVISED -
	PLOT DATE = 1/14/2026	DATE -	REVISED -

STATE OF ILLINOIS
DEPARTMENT OF TRANSPORTATION

DIST. 6 DETAILS FOR SIDEROADS (3P-PROJ.)

SCALE: SHEET 1 OF 1 SHEETS STA. TO STA.

F.A.S RTE.	SECTION	COUNTY	TOTAL SHEETS	SHEET NO.
468	118RS-4	*	12	12
CONTRACT NO. 72443				
ILLINOIS FED. AID PROJECT				

UPDATED 8/6/2025

LOGAN/TAZWELL