

| F.A.I. RTE. | SECTION | COUNTY | TOTAL SHEETS | SHEET NO. |
|-------------|-------------|----------|--------------------|-----------|
| 70 | (26-3,4)CJS | FAYETTE | 6 | 1 |
| | | ILLINOIS | CONTRACT NO. 74D56 | |

FOR INDEX OF SHEETS, SEE SHEET NO. 2

ADT = 23,800 (2023)

PROPOSED HIGHWAY PLANS

FAI 70 (I-70)
SECTION (26-3,4)CJS
PROJECT NHPP-SGNF(592)
CRACK AND JOINT SEALING
FAYETTE COUNTY

C-97-048-25



SECTION BEGINS:
STATION 656+13.00

SECTION ENDS:
STATION 1043+60.00

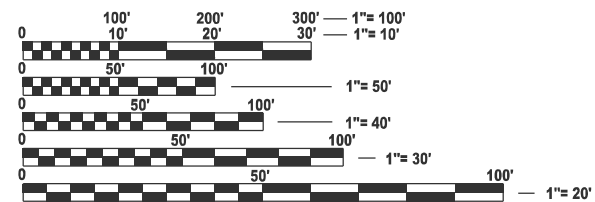

FULL SIZE PLANS HAVE BEEN PREPARED USING STANDARD ENGINEERING SCALES. REDUCED SIZED PLANS WILL NOT CONFORM TO STANDARD SCALES. IN MAKING MEASUREMENTS ON REDUCED PLANS, THE ABOVE SCALES MAY BE USED.

J.U.L.I.E.
JOINT UTILITY LOCATION INFORMATION FOR EXCAVATION
1-800-892-0123
OR 811

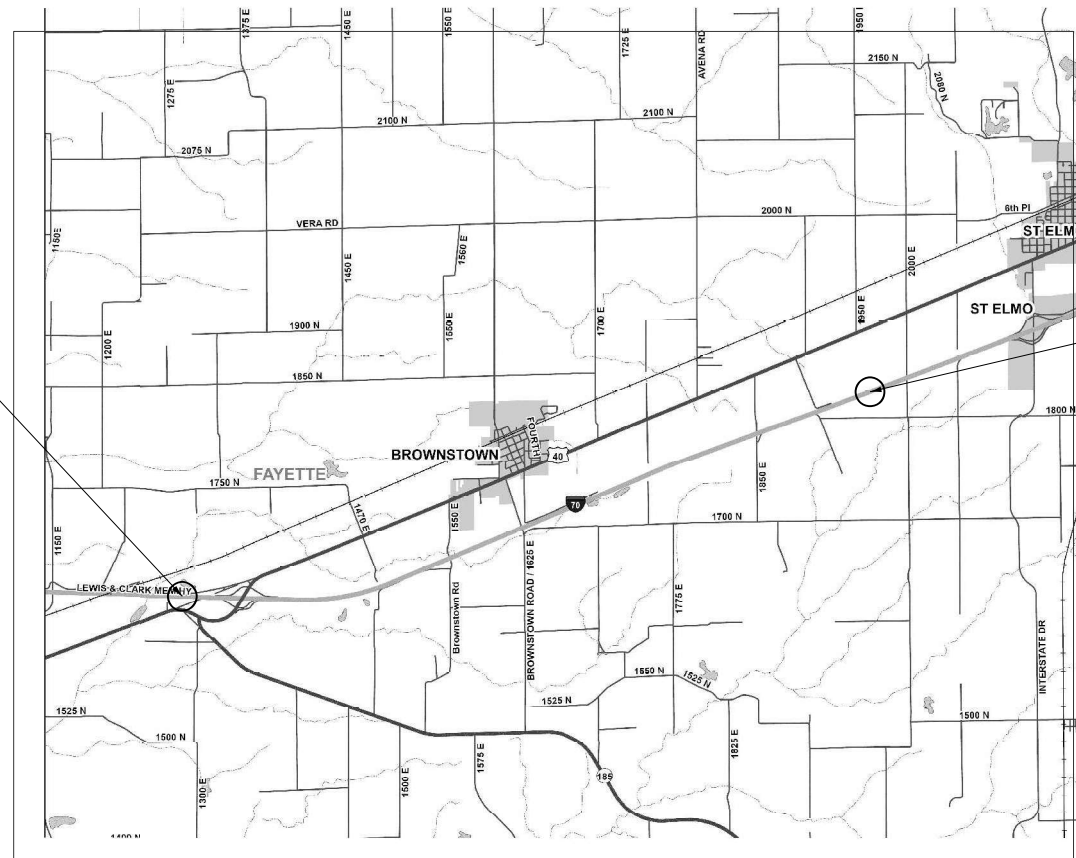

GROSS LENGTH = 38,747 FT. = 7.34 MILE
NET LENGTH = 38,747 FT. = 7.34 MILE

PROJECT ENGINEER: MATT BOWER
PROJECT MANAGER: ETHAN FOSTER

CONTRACT NO. 74D56

STATE OF ILLINOIS
DEPARTMENT OF TRANSPORTATION

SUBMITTED January 30, 2026
Teresa C. Price
REGIONAL ENGINEER

March 20, 2026
[Signature]
ENGINEER OF DESIGN AND ENVIRONMENT

March 20, 2026
[Signature]
DIRECTOR OF HIGHWAYS PROJECT IMPLEMENTATION

PRINTED BY THE AUTHORITY
OF THE STATE OF ILLINOIS

GENERAL NOTES

THE WORK INCLUDED IN THIS SECTION CONSISTS OF ROUTING, CLEANING, AND SEALING OF THE CENTERLINE AND EDGELINE LONGITUDINAL JOINTS AND REPLACEMENT OF ANY PAVEMENT MARKINGS OR RAISED REFLECTIVE PAVEMENT MARKERS DAMAGED OR COVERED BY ROUTING OR SEALING.

RAISED REFLECTIVE PAVEMENT MARKER CASTINGS AND REFLECTORS SHALL BE PROTECTED AS PER SPEC 451.04. RAISED REFLECTIVE PAVEMENT MARKER CASTINGS DAMAGED BY ROUTING OR COVERED BY SEALANT SHALL BE REPLACED. CASTINGS WILL NEED TO BE CLEANED AND FREE OF ANY EXISTING EPOXY BEFORE THE NEW LENS IS PLACED AS PER SPEC 781.03 (c). THIS WORK WILL BE THE RESPONSIBILITY OF THE CONTRACTOR AND WILL NOT BE PAID FOR SEPARATELY.

WORK BEGINS 1 MILE WEST OF US 40 AT BROWNSTOWN AND CONTINUES TO 2 MILES WEST OF ST. ELMO.

APPLICATION RATE:
SEALANT = 0.45 POUNDS PER FOOT

INDEX OF SHEETS

| SHEET NO. | ITEM |
|-----------|--|
| 1 | COVER SHEET |
| 2 | GENERAL NOTES, INDEX OF SHEETS & LIST OF STANDARDS |
| 3 | SUMMARY OF QUANTITIES |
| 4 | CRACK & JOINT SEALING DETAILS |
| 5-6 | DISTRICT 7 PAVEMENT MARKING DETAILS |

STANDARD NO. DESCRIPTION

| | |
|-----------|---|
| 000001-09 | STANDARD SYMBOLS, ABBREVIATIONS AND PATTERNS |
| 001006 | DECIMAL OF AN INCH AND OF A FOOT |
| 701101-05 | OFF-ROAD OPERATIONS, MULTILANE, 15' (4.5M) TO 24' (600MM) FROM PAVEMENT EDGE |
| 701106-02 | OFF-ROAD OPERATIONS, MULTILANE, MORE THAN 15' (4.5M) AWAY |
| 701411-09 | LANE CLOSURE, MULTILANE, AT ENTRANCE OR EXIT RAMP FOR SPEEDS \geq 45 MPH |
| 701426-09 | LANE CLOSURE, MULTILANE- INTERMITTANT OR MOVING OPERATIONS FOR SPEEDS \geq 45 MPH |
| 701901-11 | TRAFFIC CONTROL DEVICES |
| 780001-05 | TYPICAL PAVEMENT MARKINGS |
| 781001-04 | TYPICAL RAISED REFLECTIVE PAVEMENT MARKERS |

**SECTION BEGINS:
STATION 656+13.00**

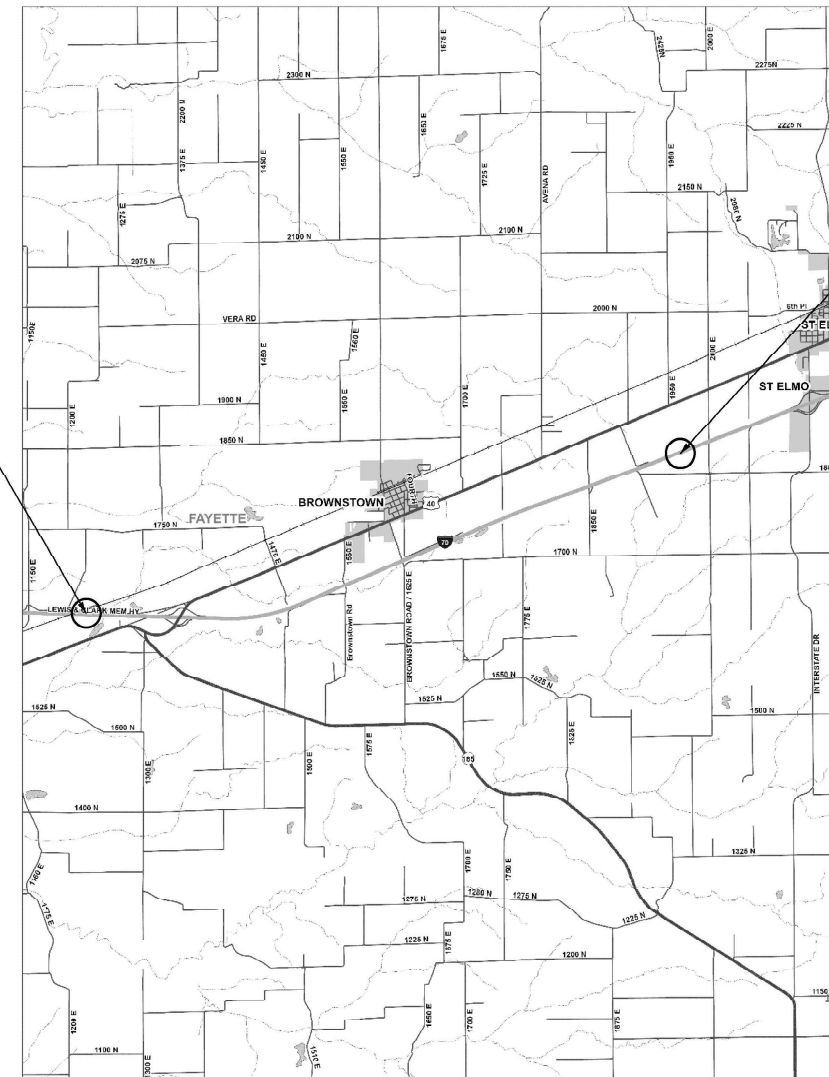

**SECTION ENDS:
STATION 1043+60.00**

STATE OF ILLINOIS
DEPARTMENT OF TRANSPORTATION

GENERAL NOTES

SCALE: SHEET OF SHEETS STA. TO STA.

| F.A.I. RTE. | SECTION | COUNTY | TOTAL SHEETS | SHEET NO. |
|---------------------------|-------------|---------|--------------|-----------|
| 70 | (26-3,4)CJS | FAYETTE | 6 | 2 |
| CONTRACT NO. 74D56 | | | | |
| ILLINOIS FED. AID PROJECT | | | | |

REV - MS

| | | |
|--------------------------|------------|-----------|
| USER NAME = Ethan.Foster | DESIGNED - | REVISED - |
| | DRAWN - | REVISED - |
| | CHECKED - | REVISED - |
| PLOT DATE = 10/14/2025 | DATE - | REVISED - |

MODEL: SOQ (Sheet)
 FILE NAME: c:\p\work\pav\illinois.gov_e\ethan.foster@illinois.gov\103917\74D56-sht-soq.dgn

| CODE NO. | ITEM | UNIT | TOTAL QUANTITY | CONSTR. CODE | |
|------------|---|--------|----------------|----------------------|--------|
| | | | | ROADWAY | RURAL |
| | | | | 90% FED 10% STATE | |
| | | | | 0005 | |
| | | | | | |
| 45100100 | CRACK ROUTING (PAVEMENT) | FOOT | 232482 | | 232482 |
| 45100200 | CRACK FILLING | POUND | 104617 | | 104617 |
| 67100100 | MOBILIZATION | L SUM | 1 | | 1 |
| 70100420 | TRAFFIC CONTROL AND PROTECTION, STANDARD 701411 | EACH | 6 | | 6 |
| 70107025 | CHANGEABLE MESSAGE SIGN | CAL DA | 28 | | 28 |
| * 78000400 | THERMOPLASTIC PAVEMENT MARKING - LINE 6" | FOOT | 174362 | | 174362 |

* SPECIALTY ITEM

| | | | | | | | | | | | | | |
|--------------------------|------------|-----------|---|------------------------------|-------|----|--------|-------------|---------|-------------|--------------|-----------|---|
| USER NAME = Ethan.Foster | DESIGNED - | REVISED - | STATE OF ILLINOIS DEPARTMENT OF TRANSPORTATION | SUMMARY OF QUANTITIES | | | | F.A.I. RTE. | SECTION | COUNTY | TOTAL SHEETS | SHEET NO. | |
| | DRAWN - | REVISED - | | SCALE: | SHEET | OF | SHEETS | STA. | TO STA. | (26-3.4)CJS | FAYETTE | 6 | 3 |
| | CHECKED - | REVISED - | | CONTRACT NO. 74D56 | | | | | | | | | |
| PLOT DATE = 10/14/2025 | DATE - | REVISED - | | ILLINOIS FED. AID PROJECT | | | | | | | | | |

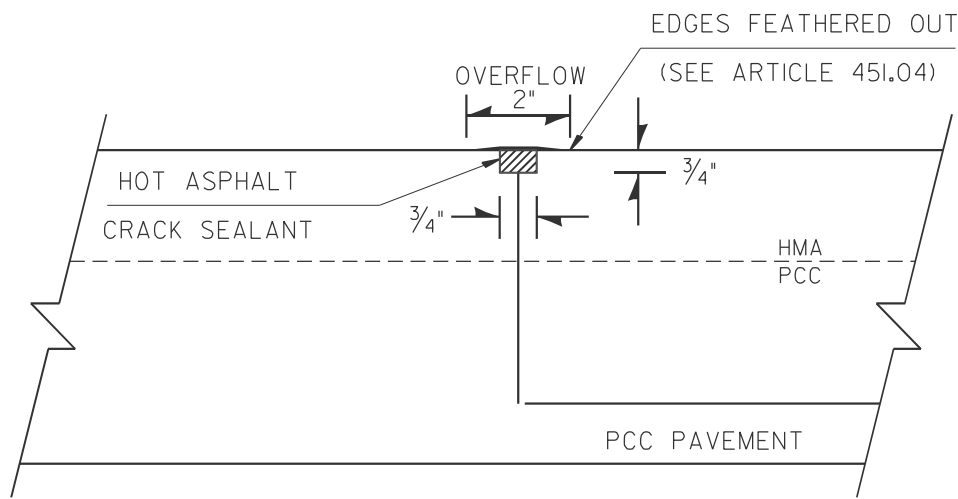

PAVEMENT CROSS-SECTION

ROUTED, CLEANED, AND SEALED

TYPICAL DETAIL FOR JOINTS

MODEL: Detail-01 [Sheet]
 FILE NAME: c:\p\work\pav\illinois.gov_e\ethan.foster@illinois.gov\103917\103917\74D56-shh-details.dgn

| | | |
|--------------------------|------------|-----------|
| USER NAME = Ethan.Foster | DESIGNED - | REVISED - |
| | DRAWN - | REVISED - |
| | CHECKED - | REVISED - |
| PLOT DATE = 10/14/2025 | DATE - | REVISED - |

STATE OF ILLINOIS
 DEPARTMENT OF TRANSPORTATION

CRACK AND JOINT SEALING

SCALE: SHEET OF SHEETS STA. TO STA.

| F.A.I. RTE. | SECTION | COUNTY | TOTAL SHEETS | SHEET NO. |
|---------------------------|-------------|---------|--------------------|-----------|
| 70 | (26-3.4)CJS | FAYETTE | 6 | 4 |
| ILLINOIS FED. AID PROJECT | | | CONTRACT NO. 74D56 | |

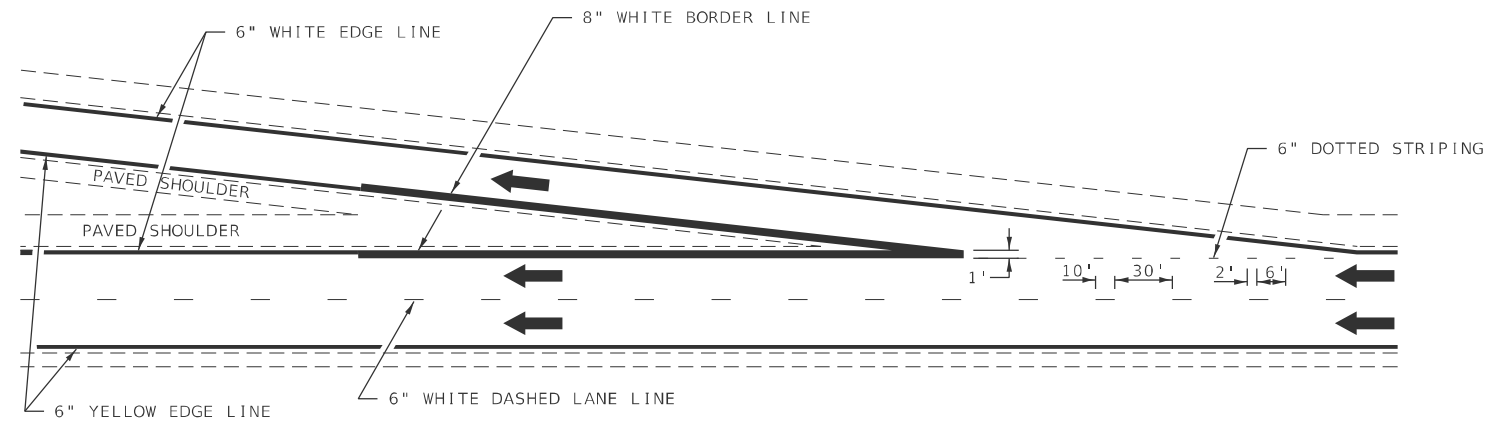

TYPICAL EXIT RAMP MARKING

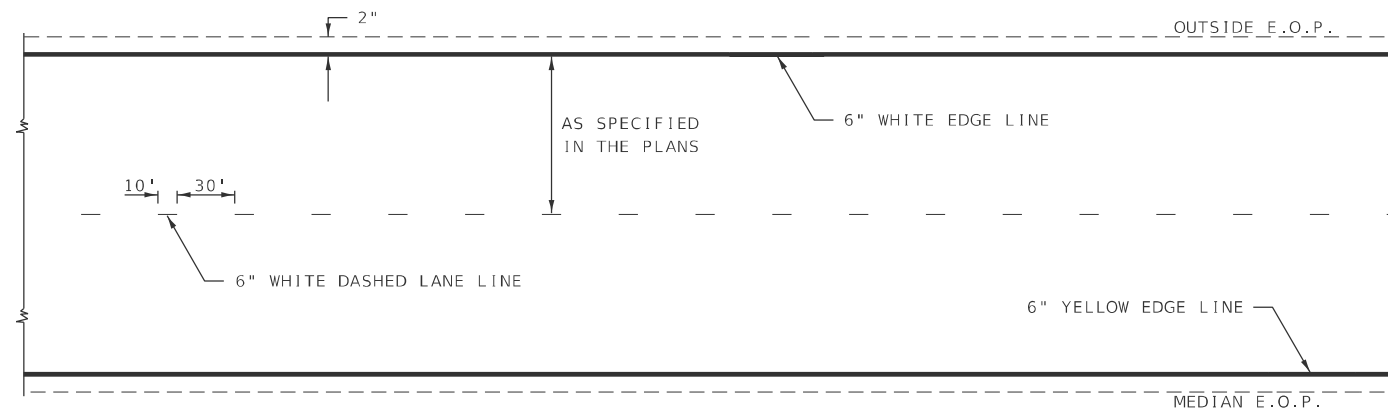

TYPICAL CENTERLINE & EDGELINE MARKINGS

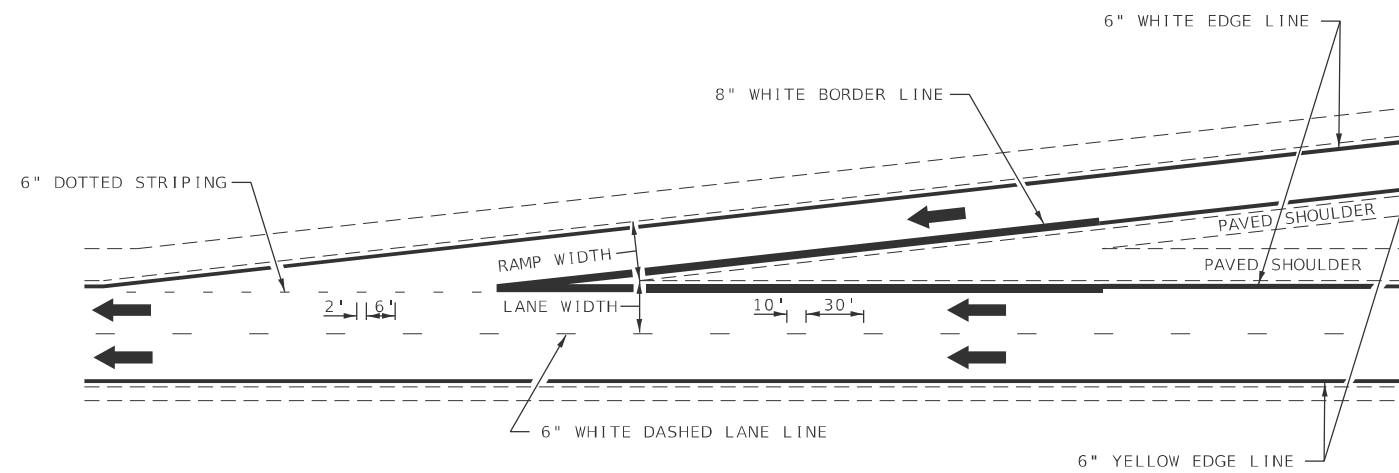

TYPICAL ENTRANCE RAMP MARKING

MODEL: Detail_3 (Sheet)
FILE NAME: c:\p\work\pav\illinois.gov\ethan.foster@illinois.gov\103917\103917\74D56-shr-details.dgn

DISTRICT 7 DETAIL NO. 78000002

| | | |
|--------------------------|------------|-----------|
| USER NAME = Ethan.Foster | DESIGNED - | REVISED - |
| | DRAWN - | REVISED - |
| | CHECKED - | REVISED - |
| PLOT DATE = 10/14/2025 | DATE - | REVISED - |

STATE OF ILLINOIS
DEPARTMENT OF TRANSPORTATION

TYPICAL APPLICATIONS OF FREEWAY/EXPRESSWAY
PAVEMENT MARKING

SCALE: SHEET OF SHEETS STA. TO STA.

| F.A.I. RTE. | SECTION | COUNTY | TOTAL SHEETS | SHEET NO. |
|---------------------------|-------------|---------|--------------|-----------|
| 70 | (26-3.4)CJS | FAYETTE | 6 | 5 |
| CONTRACT NO. 74D56 | | | | |
| ILLINOIS FED. AID PROJECT | | | | |

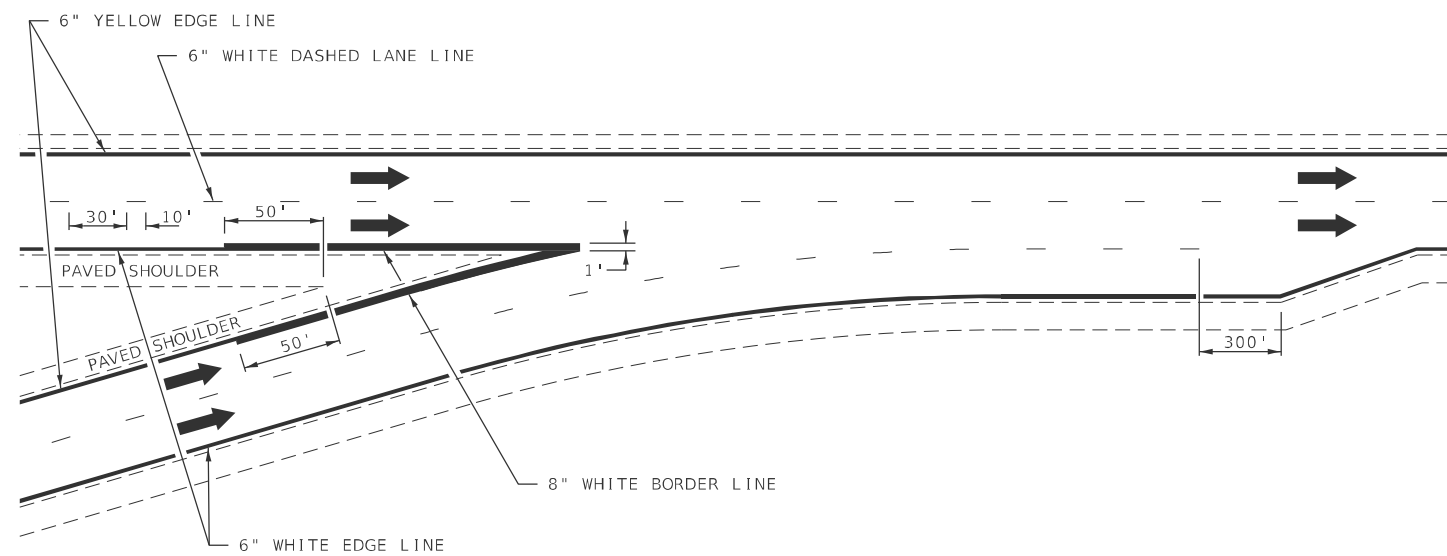

TYPICAL CONVERGENCE MARKING

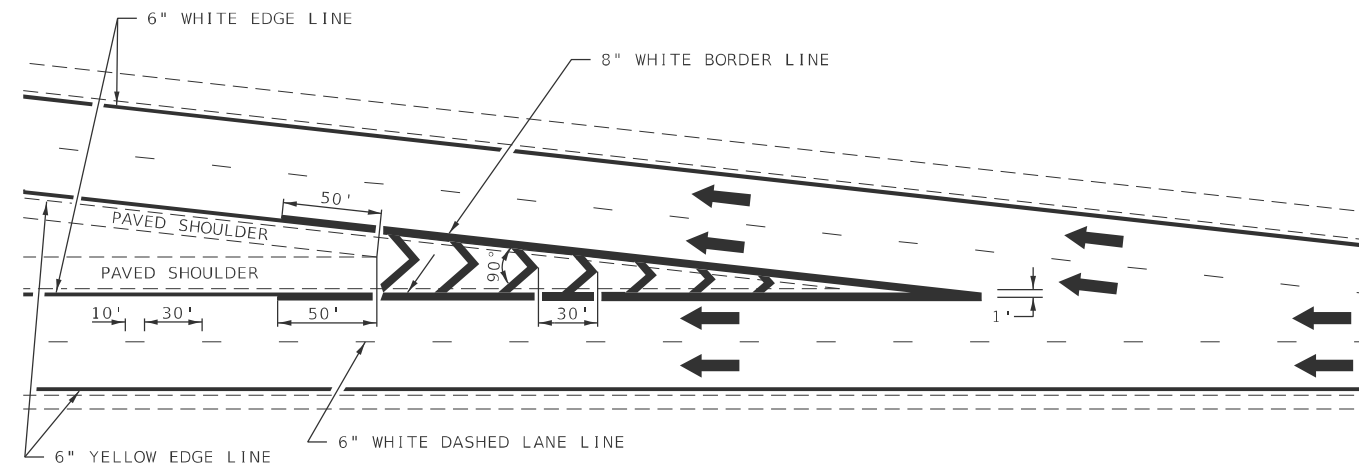

TYPICAL DIVERGENCE MARKING

AERIAL SPEED CHECK ZONES

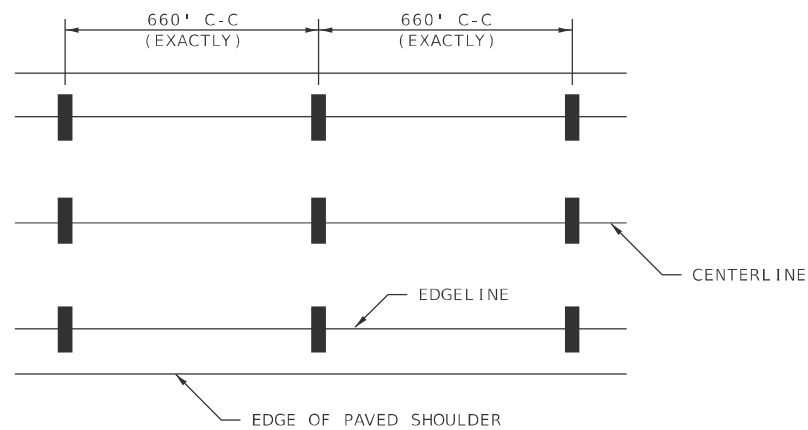

IT WILL BE NECESSARY TO HAVE A REPRESENTATIVE OF THE STATE POLICE PRESENT SO THAT THE ACCURACY OF MEASUREMENT CAN BE ATTESTED TO IN COURT.

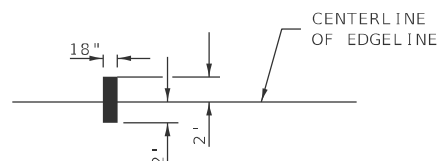

NOT TO SCALE

DISTRICT 7 DETAIL NO. 78000002

MODEL: Detail-4 (Sheet)
FILE NAME: c:\p\work\pav\illinois.gov_e\ethan.foster@illinois.gov\103917\103917\74D56-shh-details.dgn

| | | |
|--------------------------|------------|-----------|
| USER NAME = Ethan.Foster | DESIGNED - | REVISED - |
| | DRAWN - | REVISED - |
| | CHECKED - | REVISED - |
| PLOT DATE = 10/14/2025 | DATE - | REVISED - |

**STATE OF ILLINOIS
DEPARTMENT OF TRANSPORTATION**

**TYPICAL APPLICATIONS OF FREEWAY/EXPRESSWAY
PAVEMENT MARKING**

SCALE: SHEET OF SHEETS STA. TO STA.

| F.A.I. RTE. | SECTION | COUNTY | TOTAL SHEETS | SHEET NO. |
|---------------------------|-------------|---------|--------------|-----------|
| 70 | (26-3.4)CJS | FAYETTE | 6 | 6 |
| CONTRACT NO. 74D56 | | | | |
| ILLINOIS FED. AID PROJECT | | | | |