

STATE OF ILLINOIS
DEPARTMENT OF TRANSPORTATION

| F.A.U. RTE. | SECTION | COUNTY | TOTAL SHEETS | SHEET NO. |
|-------------|---------|-----------|--------------------|-----------|
| 9160 | 98Q | ST. CLAIR | 8 | 1 |
| | | ILLINOIS | CONTRACT NO. 76U79 | |

FOR INDEX OF SHEETS, SEE SHEET NO. 2

TRAFFIC DATA

37TH ST TO 45TH ST
2023 ADT = 2350 (ACTUAL)
2026 ADT = 2400 (ESTIMATED)
2046 ADT = 2800 (ESTIMATED)
SU = 3.0% MU = 1.3%

45TH ST TO IL 111
2023 ADT = 2950 (ACTUAL)
2026 ADT = 3000 (ESTIMATED)
2046 ADT = 3500 (ESTIMATED)
SU = 2.7% MU = 1.7%

FUNCTIONAL CLASSIFICATION: MAJOR COLLECTOR

PROPOSED
HIGHWAY PLANS

FAU ROUTE 9160 (BUNKUM RD., CH 34)
SECTION 98Q
CHIP SEAL / FOG SEAL - CM
ST. CLAIR COUNTY

C-98-143-25

D-98-074-25

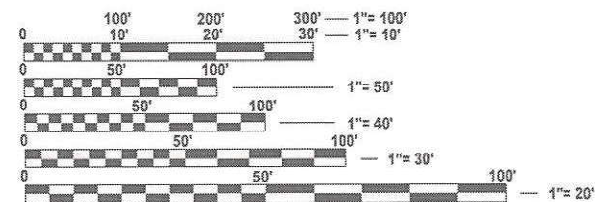
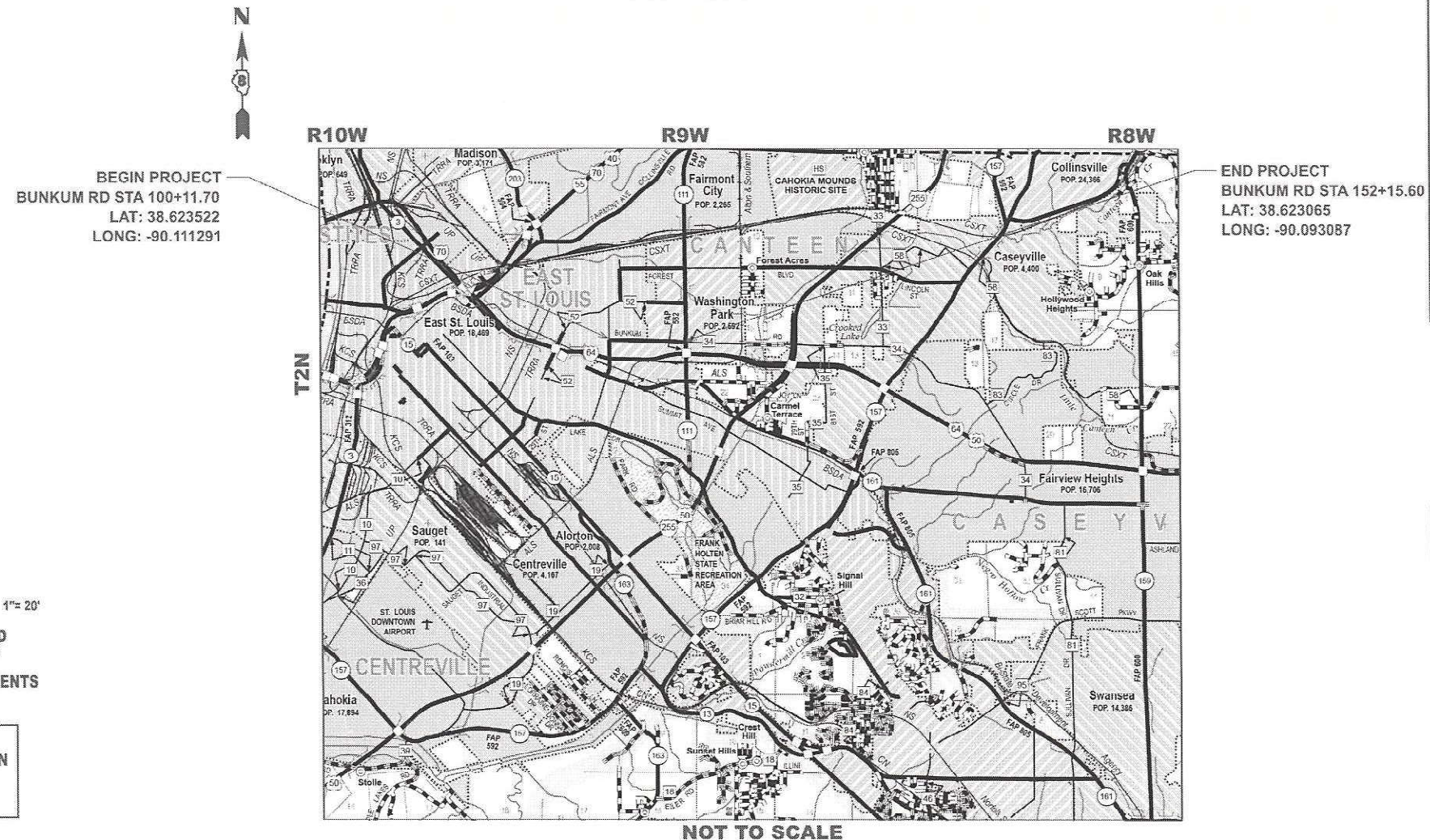
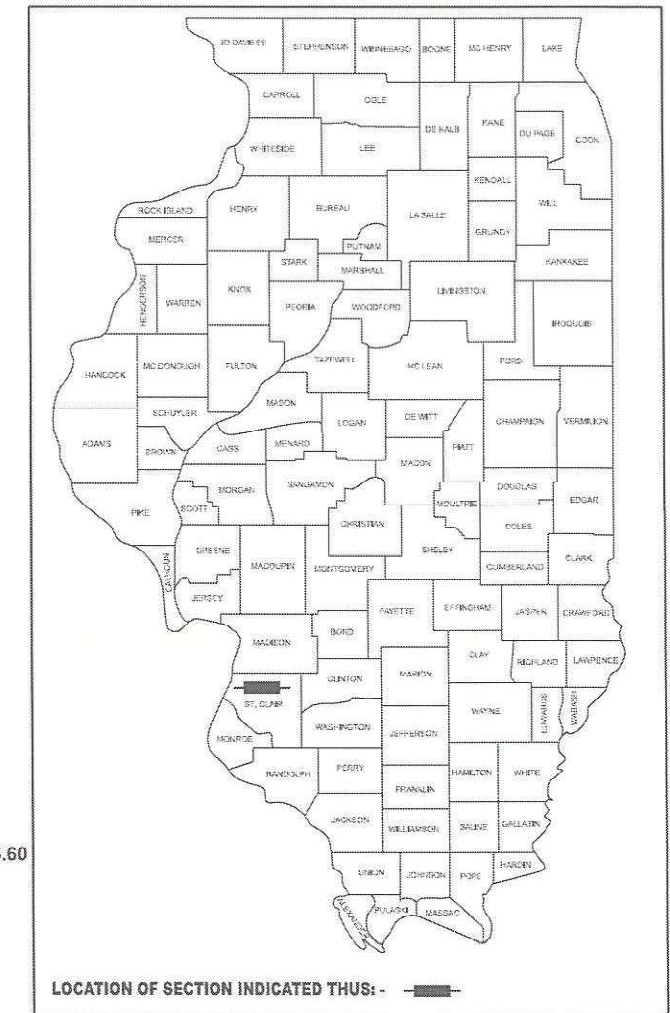

FULL SIZE PLANS HAVE BEEN PREPARED USING STANDARD ENGINEERING SCALES. REDUCED SIZED PLANS WILL NOT CONFORM TO STANDARD SCALES. IN MAKING MEASUREMENTS ON REDUCED PLANS, THE ABOVE SCALES MAY BE USED.

J.U.L.I.E.
JOINT UTILITY LOCATION INFORMATION FOR EXCAVATION
1-800-892-0123
OR 811

PROJECT ENGINEER: BILLIE OWEN
PROJECT MANAGER: MIKE BERG

CONTRACT NO. 76U79

GROSS LENGTH = 5203.90 FT. = 0.986 MILES
NET LENGTH = 5203.90 FT. = 0.986 MILES

STATE OF ILLINOIS
DEPARTMENT OF TRANSPORTATION

SUBMITTED Feb. 4 2026
[Signature]
REGIONAL ENGINEER

March 20 2026
[Signature]
ENGINEER OF DESIGN AND ENVIRONMENT

March 20 2026
[Signature]
DIRECTOR OF HIGHWAYS PROJECT IMPLEMENTATION

PRINTED BY THE AUTHORITY
OF THE STATE OF ILLINOIS

INDEX OF SHEETS

1. COVER SHEET
2. INDEX, HIGHWAY STANDARDS, GENERAL NOTES & COMMITMENTS
- 3-4 SUMMARY OF QUANTITIES
5. TYPICAL SECTIONS
6. SCHEDULE OF QUANTITIES
- 7-8. PAVEMENT MARKING SHEETS

HIGHWAY STANDARDS

| | |
|-----------|---|
| 001006 | DECIMAL OF AN INCH & OF A FOOT |
| 000001-09 | STANDARD SYMBOLS, ABBREVIATIONS & PATTERNS |
| 701006-05 | OFF-ROAD OPERATIONS, 2L, 2W, 15' (4.5 m) TO 24" (600 mm) FROM PAVEMENT EDGE |
| 701311-03 | LANE CLOSURE 2L, 2W MOVING OPERATIONS - DAY ONLY |
| 701501-06 | URBAN LANE CLOSURE, 2L, 2W, UNDIVIDED |
| 701601-09 | URBAN LANE CLOSURE, MULTILANE, 1W OR 2W WITH NONTRAVERSABLE MEDIAN |
| 701701-10 | URBAN LANE CLOSURE, MULTILANE INTERSECTION |
| 701901-11 | TRAFFIC CONTROL DEVICES |
| 780001-05 | TYPICAL PAVEMENT MARKINGS |
| 781001-04 | TYPICAL APPLICATIONS RAISED REFLECTIVE PAVEMENT MARKERS |

GENERAL NOTES

1. THE UTILITIES KNOWN TO HAVE FACILITIES WITHIN THE PROJECT AREA ARE AS FOLLOWS:
 - AMEREN ILLINOIS
 - AT&T ILLINOIS
 - BLUEBIRD NETWORK
 - BUCKEYE PARTNERS L.P. - WOOD RIVER PIPELINE
 - CHARTER COMMUNICATIONS, INC.
 - CITY OF EAST ST. LOUIS SEWER
 - ILLINOIS AMERICAN WATER COMPANY
 - VERIZON BUSINESS
 - METRO EAST SANITARY DISTRICT
 - VILLAGE OF WASHINGTON PARK SEWER
2. ANY MANHOLES OR WATER VALVES IN PAVEMENT SHALL BE COVERED WITH HEAVY PAPER AND SAND PRIOR TO SEAL COATING.
3. NO SURVEY WAS PERFORMED FOR THIS PROJECT AND THE PLANS WERE CREATED USING MICROFILM AND FIELD MEASUREMENTS.
4. THE PROPOSED PAVEMENT MARKING SHALL MATCH THE LOCATIONS OF THE EXISTING PAVEMENT MARKING, AS DIRECTED BY THE ENGINEER UNLESS NOTED OTHERWISE ON THESE PLANS.
5. THE DEPARTMENT STRONGLY ENCOURAGES THE PRIME CONTRACTOR AND THEIR APPROVED SUB-CONTRACTORS TO HIRE MINORITY, WOMEN AND DISADVANTAGED INDIVIDUALS FROM ITS FEDERALLY FUNDED HIGHWAY CONSTRUCTION CAREERS TRAINING PROGRAM (HCCTP) TO HELP MEET WORKFORCE AND TRAINEE GOALS. THIS PROGRAM IS TRAINING MINORITIES, WOMEN AND DISADVANTAGED INDIVIDUALS IN HIGHWAY CONSTRUCTION RELATED SKILLS, E.G., MATH FOR THE TRADES, JOB READINESS, TECHNICAL SKILLS COURSEWORK (CARPENTRY, CONCRETE FLATWORK, BLUEPRINT READING, SITE PLANS, SITE WORK, TOOLS USE, ETC.) AND OSHA 10 HOUR CERTIFICATION, TO PREPARE THEM FOR A CAREER IN THE HIGHWAY CONSTRUCTION TRADES. GRADUATES ARE WELL-TRAINED AND READY TO BECOME PRODUCTIVE ENTRY-LEVEL CONSTRUCTION WORKERS. CONTACT THE DISTRICT 8 EEO OFFICE AT 618-346-3360 AND/OR THE HCCTP COORDINATOR AT 618-874-6528 TO LEARN MORE ABOUT THE PROGRAM AND FOR ASSISTANCE IN MEETING WORKFORCE AND TRAINEE GOALS.
6. THE RESIDENT ENGINEER SHALL VERIFY THE EXISTENCE OF HIGHWAY LIGHTING, INTELLIGENT TRANSPORTATION SYSTEMS (I.T.S.) UTILITIES, AND/OR ELECTRICAL CABLES ASSOCIATED WITH TRAFFIC SIGNALS WITHIN THE PROJECT LIMITS. IF ANY OF THESE EXIST WITHIN THE PROJECT LIMITS, AND IF THESE ITEMS REQUIRE LOCATING, THE CONTRACTOR SHALL BE DIRECTED TO DO SO ACCORDING TO SECTION 803 OF THE STANDARD SPECIFICATIONS. THIS WORK SHALL BE PAID FOR ACCORDING TO ARTICLE 109.04 OF THE STANDARD SPECIFICATIONS.
7. TWO CHANGEABLE MESSAGE SIGNS SHALL BE REQUIRED FOR THIS PROJECT. THEY SHALL BE PLACED THE BEGINNING OF THE PROJECT AND AT THE END OF THE PROJECT TWO WEEKS PRIOR TO ANY LANE CLOSURE. THEY SHALL REMAIN UP FOR THE DURATION OF THE PROJECT.
8. THE VOID IN THE PAVEMENT WHICH RESULTS FROM THE RAISED REFLECTIVE PAVEMENT MARKER REMOVAL SHALL BE REPAIRED WITH MATERIAL AS DIRECTED BY THE ENGINEER. THE MATERIAL AND WORK SHALL BE PAID FOR IN ACCORDANCE WITH ARTICLE 783 OF THE STANDARD SPECIFICATIONS.
9. AGGREGATE QUALITY SHALL BE CLASS C OR BETTER. THE CONTRACTOR SHALL USE CA-16 FOR THE COVER AGGREGATE AND THE SEAL AGGREGATE. THE COVER COAT APPLICATION AND SEAL COAT APPLICATION CANNOT BE PERFORMED ON THE SAME DAY. THE SUBSTRATE SURFACE CONDITION OF THE EXISTING PAVEMENT SURFACE IS BADLY POKED, POROUS, OXIDIZED.

COMMITMENTS

NONE

MODEL: General Notes (Sheet)
FILE NAME: c:\pwworking\illinois.gov\137692\07\6179-shi-gennote.dgn

| | | |
|--------------------------------|------------|-----------|
| USER NAME = Joshua.huffstutler | DESIGNED - | REVISED - |
| | DRAWN - | REVISED - |
| | CHECKED - | REVISED - |
| PLOT DATE = 1/12/2026 | DATE - | REVISED - |

STATE OF ILLINOIS
DEPARTMENT OF TRANSPORTATION

INDEX, HIGHWAY STANDARDS,
GENERAL NOTES & COMMITMENTS

SCALE: SHEET 1 OF 1 SHEETS STA. TO STA.

| F.A.U. RTE. | SECTION | COUNTY | TOTAL SHEETS | SHEET NO. |
|-----------------------------|---------|-----------|--------------|-----------|
| 9160 | 98Q | ST. CLAIR | 8 | 2 |
| CONTRACT NO. 76U79 | | | | |
| ILLINOIS FED. AID PROJECT | | | | |

| CODE NO. | ITEM | UNIT | TOTAL QUANTITY | CONSTR. CODE | |
|------------|---|--------|----------------|--------------|-------|
| | | | | 100% STATE | |
| | | | | ROADWAY | |
| | | | | 0005 | |
| | | | | URBAN | |
| 67100100 | MOBILIZATION | L SUM | 1 | | 1 |
| 70102620 | TRAFFIC CONTROL AND PROTECTION, STANDARD 701501 | L SUM | 1 | | 1 |
| 70102630 | TRAFFIC CONTROL AND PROTECTION, STANDARD 701601 | L SUM | 1 | | 1 |
| 70102635 | TRAFFIC CONTROL AND PROTECTION, STANDARD 701701 | L SUM | 1 | | 1 |
| 70107025 | CHANGEABLE MESSAGE SIGN | CAL DA | 28 | | 28 |
| 70300100 | SHORT TERM PAVEMENT MARKING | FOOT | 550 | | 550 |
| 70300150 | SHORT TERM PAVEMENT MARKING REMOVAL | SQ FT | 173 | | 173 |
| * 78001100 | PAINT PAVEMENT MARKING - LETTERS AND SYMBOLS | SQ FT | 32 | | 32 |
| * 78001130 | PAINT PAVEMENT MARKING - LINE 6" | FOOT | 13550 | | 13550 |
| * 78001180 | PAINT PAVEMENT MARKING - LINE 24" | FOOT | 44 | | 44 |
| * 78100100 | RAISED REFLECTIVE PAVEMENT MARKER | EACH | 56 | | 56 |
| 78100200 | TEMPORARY RAISED REFLECTIVE PAVEMENT MARKER | EACH | 56 | | 56 |
| 78300200 | RAISED REFLECTIVE PAVEMENT MARKER REMOVAL | EACH | 56 | | 56 |
| X1500005 | BITUMINOUS SURFACE TREATMENT, A2 | SQ YD | 12734 | | 12734 |

* SPECIALTY ITEM

MODEL: SOQ (Sheet)
FILE NAME: c:\p\work\view\illinois.gov\joshua.huffstutler\illinois.gov\137682\076\179-sheet-SOQ.dgn

| | | | | | | | | | | | | |
|--------------------------------|------------|-----------|---|------------------------------|---------|-----------|--------|---------------------------|---------|--------|--------------|-----------|
| USER NAME = joshua.huffstutler | DESIGNED - | REVISED - | STATE OF ILLINOIS DEPARTMENT OF TRANSPORTATION | SUMMARY OF QUANTITIES | | | | F.A.U. RTE. | SECTION | COUNTY | TOTAL SHEETS | SHEET NO. |
| | DRAWN - | REVISED - | | 9160 | 98Q | ST. CLAIR | 8 | 3 | | | | |
| | CHECKED - | REVISED - | | CONTRACT NO. 76U79 | | | | ILLINOIS FED. AID PROJECT | | | | |
| PLOT DATE = 2/3/2026 | DATE - | REVISED - | | SCALE: | SHEET 1 | OF 2 | SHEETS | STA. | TO STA. | | | |

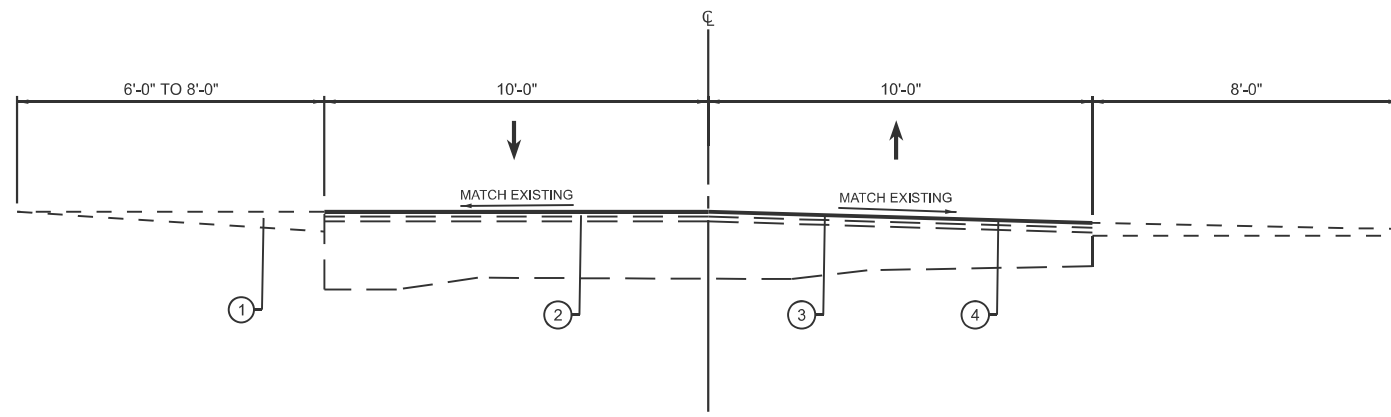

TYPICAL SECTION
STA. 103+00.00 TO STA. 149+00.00

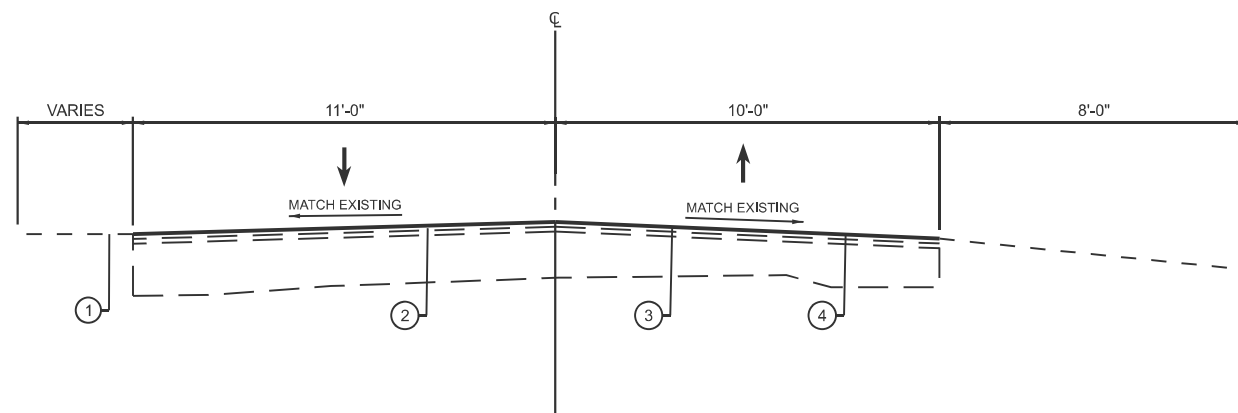

TYPICAL SECTION
STA. 101+75.00 TO STA. 103+00.00

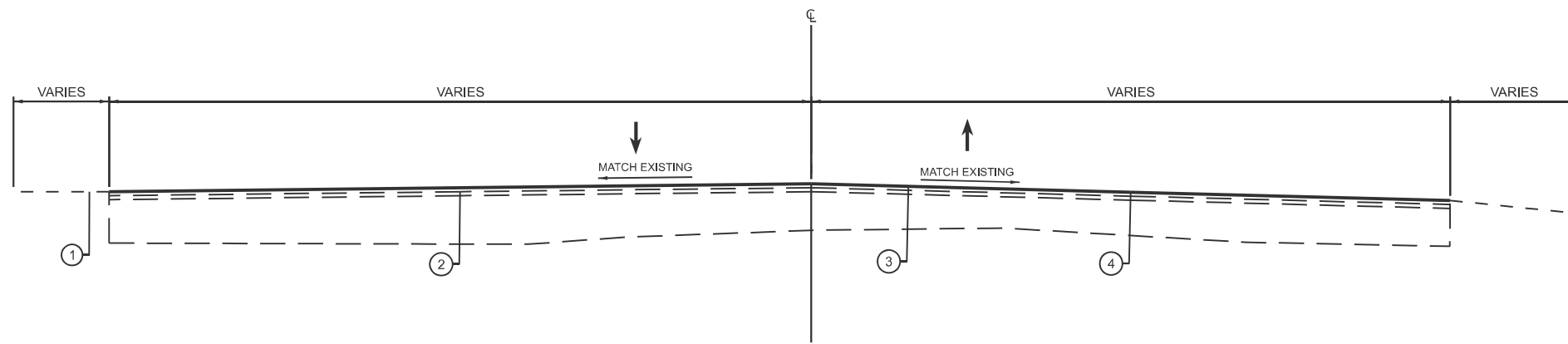

TYPICAL SECTION
STA. 100+11.17 TO STA. 101+75.00
STA. 149+00.00 TO STA. 152+15.50

- LEGEND**
- ① EXISTING AGGREGATE SHOULDER
 - ② EXISTING HMA SURFACE COURSE
 - ③ PROPOSED BITUMINOUS SURFACE TREATMENT, A2
 - ④ PROPOSED FOG SEAL TREATMENT

MODEL: Typical Sections (Sheet)
FILE NAME: c:\p\work\aviso\illinois.gov_joshua.huffstutter\137682\076\179-sheet-typical.s.dgn

| | | |
|--------------------------------|------------|-----------|
| USER NAME = joshua.huffstutter | DESIGNED - | REVISED - |
| | DRAWN - | REVISED - |
| | CHECKED - | REVISED - |
| PLOT DATE = 12/19/2025 | DATE - | REVISED - |

STATE OF ILLINOIS
DEPARTMENT OF TRANSPORTATION

TYPICAL SECTIONS

SCALE: SHEET 1 OF 1 SHEETS STA. TO STA.

| F.A.U. RTE. | SECTION | COUNTY | TOTAL SHEETS | SHEET NO. |
|---------------------------|---------|-----------|--------------|-----------|
| 9160 | 98Q | ST. CLAIR | 8 | 5 |
| CONTRACT NO. 76U79 | | | | |
| ILLINOIS FED. AID PROJECT | | | | |

| PAVEMENT MARKING SCHEDULE | | | | | | | | | | | |
|---------------------------|----------|----------------------------------|-----------------------|----------------------------|-------------------------|-----------------------------|-------------------------------------|-----------------------------------|---------------|---|--|
| LOCATION | | PAINT PAVEMENT MARKING / Removal | | | | SHORT TERM PAVEMENT MARKING | SHORT TERM PAVEMENT MARKING REMOVAL | RAISED REFLECTIVE PAVEMENT MARKER | | RAISED REFLECTIVE PAVEMENT MARKER REMOVAL | |
| STATION | | LINE - 6" PAINT | | | | | | ONE WAY CRYSTAL | TWO WAY AMBER | | |
| FROM | TO | YELLOW SOLID FEET | SKIP-DASH YELLOW FEET | WHITE SOLID EDGE LINE FEET | TURN LANE SYMBOLS SQ FT | FEET | SQ FT | EACH | EACH | EACH | |
| 100+11.2 | 141+82.7 | 0 | 2100 | 8342.96 | 0.0 | 441 | 139 | 2 | 0 | 2 | |
| 141+82.7 | 146+83.6 | 500.92 | 260 | 1001.84 | 0.0 | 53 | 17 | 0 | 26 | 26 | |
| 146+83.6 | 152+15.5 | 0 | 280 | 1063.86 | 31.2 | 56 | 18 | 2 | 26 | 28 | |
| SUBTOTAL | | 501 | 2640 | 10409 | 31.2 | 550 | 173 | 4 | 52 | 56 | |
| TOTAL | | 13550 | | | | | | | | | |

| RESURFACING SCHEDULE | | | | | | |
|----------------------|-----------|-----------|-------|---------|----------------------------------|---------------------------------|
| STATION | | DIMENSION | | AREA | BITUMINOUS SURFACE TREATMENT, A2 | BITUMINOUS MATERIALS (FOG SEAL) |
| | | LENGTH | WIDTH | | | |
| FROM | TO | FEET | FEET | SQ FT | SQ YD | LBS |
| 100+11.17 | 101+75.00 | 163.83 | 43 | 7044.69 | 782.7 | 313.1 |
| 101+75.00 | 103+00.00 | 125 | 21 | 2625 | 291.7 | 116.7 |
| 103+00.00 | 149+00.00 | 4600.00 | 20 | 92000 | 10222.2 | 4088.9 |
| 149+00.00 | 152+15.50 | 315.50 | 41 | 12935.5 | 1437.3 | 574.9 |
| TOTAL | | | | | 12734 | 5094 |

MODEL: Schedule of Quantities-1 (Sheet)
 FILE NAME: c:\p\work\wis\illinois.gov\joshua.huffstutler\illinois\proj\137682\076\079\shh-schedule.dgn

| | | |
|--------------------------------|------------|-----------|
| USER NAME = joshua.huffstutler | DESIGNED - | REVISED - |
| | DRAWN - | REVISED - |
| | CHECKED - | REVISED - |
| PLOT DATE = 2/3/2026 | DATE - | REVISED - |

STATE OF ILLINOIS
DEPARTMENT OF TRANSPORTATION

SCHEDULE OF QUANTITIES

SCALE: SHEET 1 OF 1 SHEETS STA. TO STA.

| F.A.U. RTE. | SECTION | COUNTY | TOTAL SHEETS | SHEET NO. |
|---------------------------|---------|-----------|--------------|-----------|
| 9160 | 98Q | ST. CLAIR | 8 | 6 |
| CONTRACT NO. 76U79 | | | | |
| ILLINOIS FED. AID PROJECT | | | | |

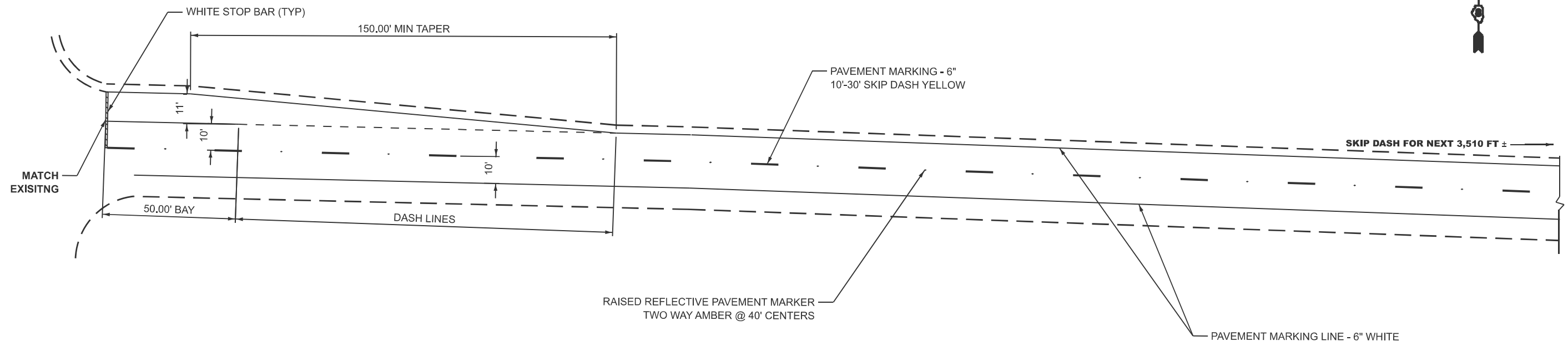

MODEL: Unnamed Plan - Plan 1
 FILE NAME: c:\p\work\wis\illinois.gov_joshua.huffstutter@illinois.gov\137682\076\179-shh-pmk.dgn

| | | |
|--------------------------------|------------|-----------|
| USER NAME = joshua.huffstutter | DESIGNED - | REVISED - |
| | DRAWN - | REVISED - |
| | CHECKED - | REVISED - |
| PLOT DATE = 12/19/2025 | DATE - | REVISED - |

STATE OF ILLINOIS
DEPARTMENT OF TRANSPORTATION

BUNKUM ROAD BY 37TH STREET
PAVEMENT MARKING SHEET

SCALE: 1"=20' SHEET 1 OF 2 SHEETS STA. 100+11.70 TO STA. 105+75.00

| | | | | |
|---------------------------|---------|-----------|--------------|-----------|
| F.A.U. RTE. | SECTION | COUNTY | TOTAL SHEETS | SHEET NO. |
| 9160 | 98Q | ST. CLAIR | 8 | 7 |
| CONTRACT NO. 76U79 | | | | |
| ILLINOIS FED. AID PROJECT | | | | |

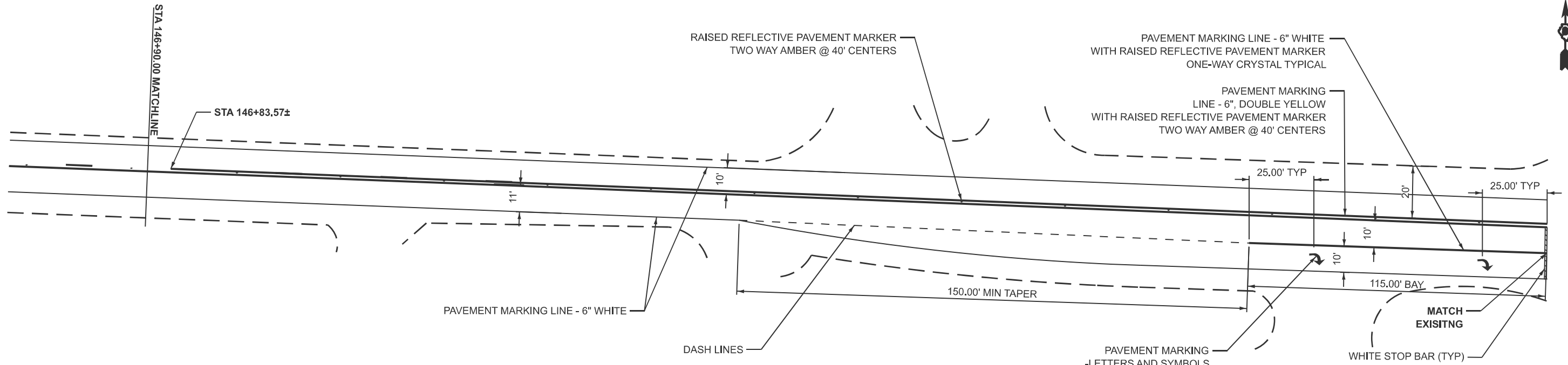
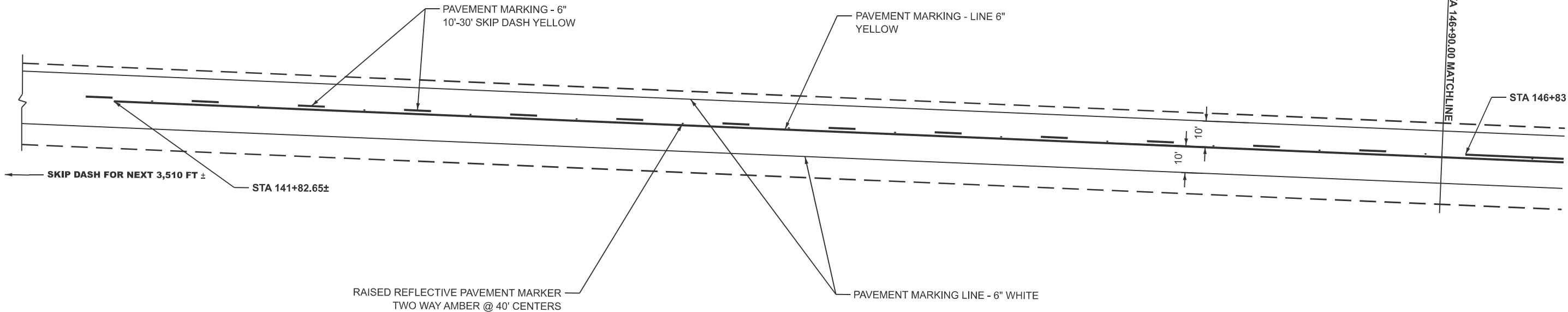

MODEL: Unnamed Plan-1 - Plan 2
 FILE NAME: c:\pw\work\avio\illinois.gov\joshua.huffstutter\illinois.gov\137682\076\179-sheet-pmk.dgn

| | | |
|--------------------------------|------------|-----------|
| USER NAME = joshua.huffstutter | DESIGNED - | REVISED - |
| | DRAWN - | REVISED - |
| | CHECKED - | REVISED - |
| PLOT DATE = 12/19/2025 | DATE - | REVISED - |

STATE OF ILLINOIS
DEPARTMENT OF TRANSPORTATION

BUNKUM ROAD BY IL 111
PAVEMENT MARKING SHEET

SCALE: 1"=20' SHEET 2 OF 2 SHEETS STA. 141+32.00 TO STA. 152+15.60

| | | | | |
|---------------------------|---------|-----------|--------------|-----------|
| F.A.U. RTE. | SECTION | COUNTY | TOTAL SHEETS | SHEET NO. |
| 9160 | 98Q | ST. CLAIR | 8 | 8 |
| CONTRACT NO. 76U79 | | | | |
| ILLINOIS FED. AID PROJECT | | | | |