

STATE OF ILLINOIS  
DEPARTMENT OF TRANSPORTATION

F.A.P. RTE.	SECTION	COUNTY	TOTAL SHEETS	SHEET NO.
849	D9 Bridge Overlay 2026-7	Hamilton	16	1
		ILLINOIS	CONTRACT NO. 78B46	

FOR INDEX OF SHEETS, SEE SHEET NO. 3

TRAFFIC DATA

TRAFFIC DATA IL 142 HAMILTON COUNTY  
IL-142 FROM FAS 880 DAHLGREN RD TO CH9A

	2023	2026	2036
PV =	2,150	2,210	2,445
SU =	90	95	100
MU =	110	115	125
ADT =	2,350	2,420	2,670

TOWNSHIPS

DAHLGREN

DESIGN DESIGNATION : N/A

COORDINATE SYSTEM : N/A

POSTED SPEED : 55 MPH

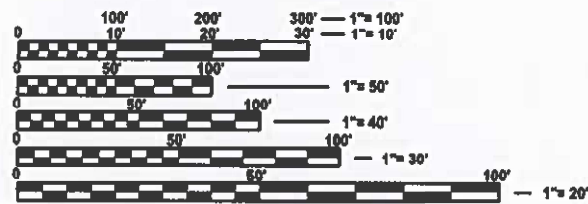

FULL SIZE PLANS HAVE BEEN PREPARED USING STANDARD ENGINEERING SCALES. REDUCED SIZED PLANS WILL NOT CONFORM TO STANDARD SCALES. IN MAKING MEASUREMENTS ON REDUCED PLANS, THE ABOVE SCALES MAY BE USED.

J.U.L.I.E.  
JOINT UTILITY LOCATION INFORMATION FOR EXCAVATION  
1-800-892-0123  
OR 811

PROJECT ENGINEER: EHREN KIRBY  
PROJECT MANAGER: ELISE KNOP

CONTRACT NO. 78B46

PROPOSED  
HIGHWAY PLANS

FAP ROUTE 849 (IL 142)  
SECTION D9 Bridge Overlay 2026-7  
PROJECT STP-B2YA(053)  
BRIDGE OVERLAY-SN 033-0041 & SN 033-0043  
HAMILTON COUNTY

C-99-088-25

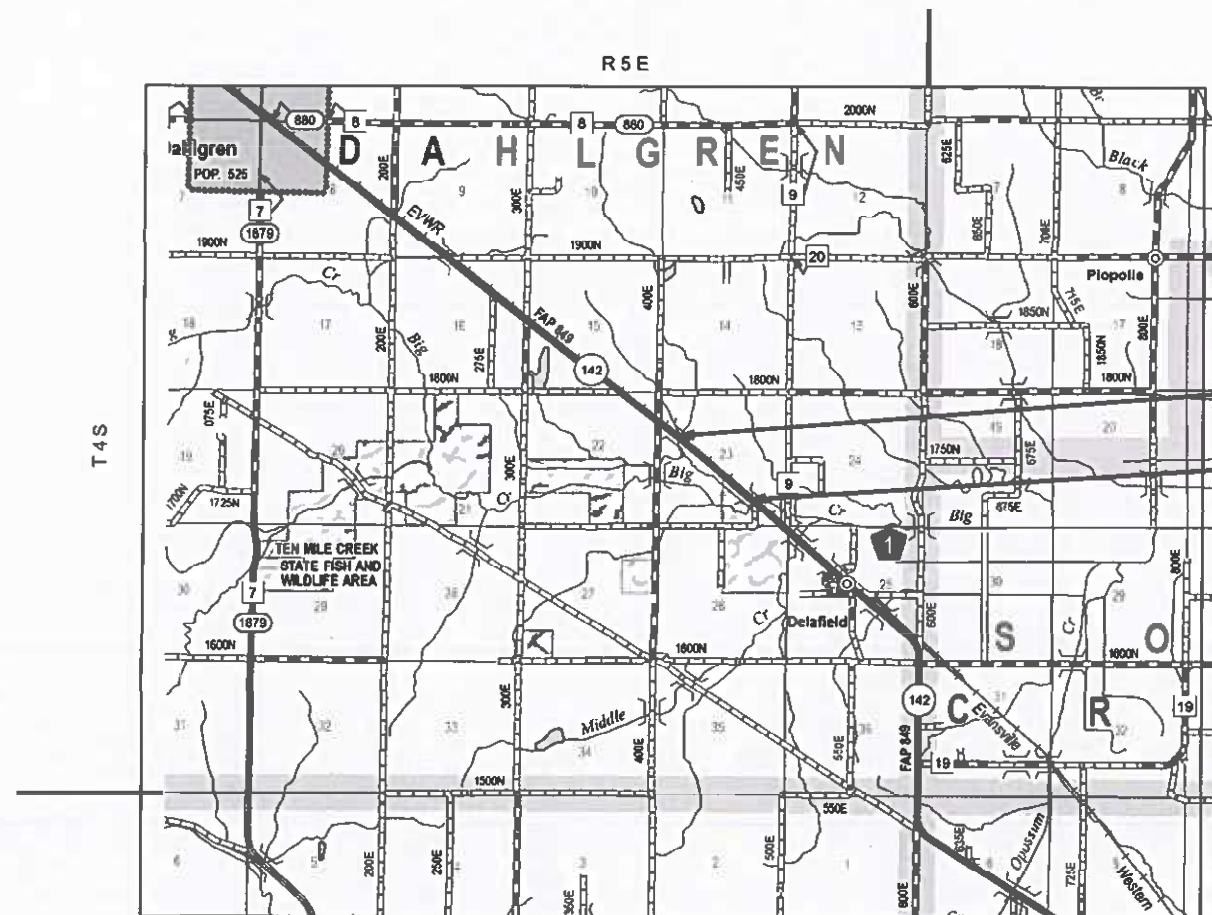

SN 033-0041  
IL 142 OVER BLUE CREEK

SN 033-0043  
IL 142 OVER BIG CREEK

GROSS LENGTH = 146.5 FT. = 0.02 MILE  
NET LENGTH = 146.5 FT. = 0.02 MILE

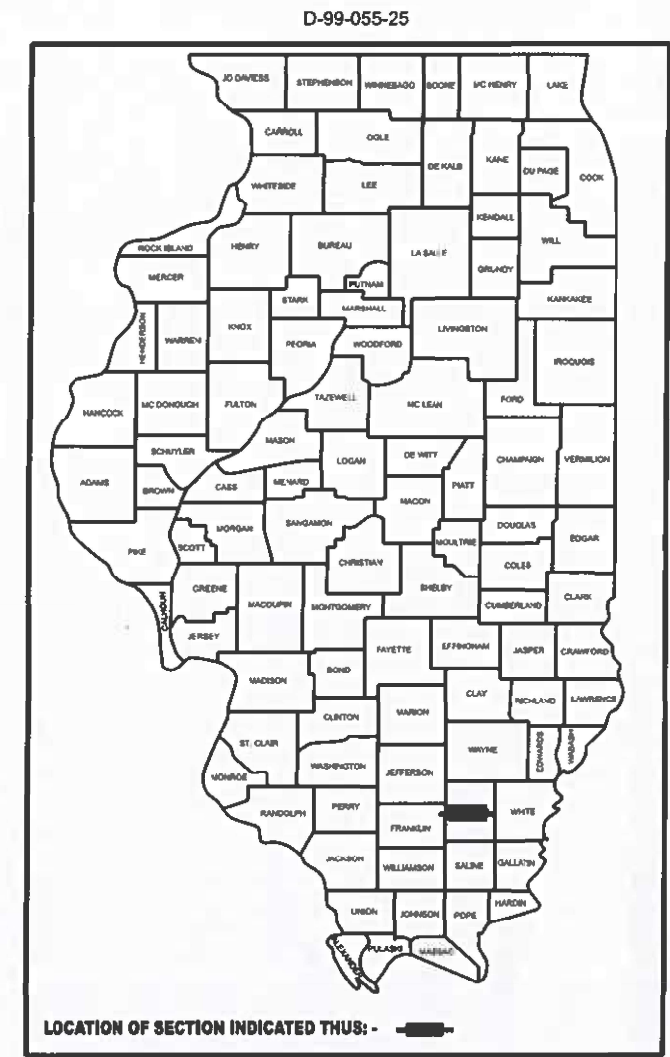

STATE OF ILLINOIS  
DEPARTMENT OF TRANSPORTATION

SUBMITTED Jan 21 2026  
Lora S. Romo  
REGIONAL ENGINEER

March 20 2026  
[Signature]  
ENGINEER OF DESIGN AND ENVIRONMENT

March 20 2026  
[Signature]  
DIRECTOR OF HIGHWAYS PROJECT IMPLEMENTATION

PRINTED BY THE AUTHORITY  
OF THE STATE OF ILLINOIS

MODEL: 02-Signature (Sheet)  
 FILE NAME: c:\pwworking\mid\project\1125621\0978B46-SHA-Cover\_Sht.dwg

Prepared By: *Susan Poe*  
 DISTRICT STUDIES & PLANS ENGINEER

Examined By: *Naughey*  
 DISTRICT LAND ACQUISITION ENGINEER

Examined By: *Con Miller*  
 DISTRICT PROGRAM DEVELOPMENT ENGINEER

Examined By: *R. COO*  
 DISTRICT OPERATIONS ENGINEER

Examined By: \_\_\_\_\_  
 DISTRICT PROJECT IMPLEMENTATION ENGINEER

Examined By: *Burrows*  
 DISTRICT CONSTRUCTION ENGINEER

Examined By: *Ann Hays*  
 DISTRICT MATERIALS ENGINEER

USER NAME = elise.knop	DESIGNED -	REVISED -
	DRAWN -	REVISED -
	CHECKED -	REVISED -
PLOT DATE = 12/15/2025	DATE -	REVISED -

**STATE OF ILLINOIS  
 DEPARTMENT OF TRANSPORTATION**

**SIGNATURE SHEET**

SCALE: SHEET 2 OF 2 SHEETS STA. TO STA.

F.A.P. RTE.	SECTION	COUNTY	TOTAL SHEETS	SHEET NO.
849	D9 Bridge Overlay 2026-7	Hamilton	16	2
CONTRACT NO. 78B46			ILLINOIS FED. AID PROJECT	

# GENERAL NOTES

FACTORS USED FOR ESTIMATING PLAN QUANTITIES ARE AS FOLLOWS AND SHALL NOT BE USED FOR THE BASIS OF FINAL QUANTITIES:

ALL HOT MIX ASPHALT 2.016 TONS/CU. YD.

THE QUANTITY OF SHORT TERM PAVEMENT MARKING SHOWN IN THE PLANS IS BASED ON ONE APPLICATION

COMMITMENTS: NONE

# INDEX OF SHEETS

SHEET NO	DESCRIPTION
1	COVER SHEET
2	SIGNATURE SHEET
3	INDEX OF SHEETS, HIGHWAY STANDARDS, GENERAL NOTES, & COMMITMENTS
4-6	SUMMARY OF QUANTITIES
7	SCHEDULES
8-11	SN 033-0041 REPAIR DETAILS
12-15	SN 033-0043 REPAIR DETAILS
16	TEMP CONCRETE BARRIER DETAIL

# HIGHWAY STANDARDS

- 000001-09 STANDARD SYMBOLS, ABBREVIATIONS, AND PATTERNS
- 001001-02 AREAS OF REINFORCEMENT BARS
- 001006 DECIMAL OF AN INCH AND OF A FOOT
- 701001-02 OFF-RD OPERATIONS, 2L, 2W, MORE THAN 15' AWAY
- 701006-05 OFF-RD OPERATIONS, 2L, 2W, 15' TO 24" FROM PAVEMENT EDGE
- 701201-05 LANE CLOSURE, 2L 2W, DAY ONLY, FOR SPEED GREATER THAN 45 MPH
- 701316-14 LANE CLOSURE, 2L, 2W, BRIDGE REPAIR
- 701321-19 LANE CLOSURE, 2L, 2W, BRIDGE REPAIR WITH BARRIER
- 701326-04 LANE CLOSURE, 2L, 2W, PAVEMENT WIDENING FOR SPEEDS GREAT THAN 45 MPH
- 701901-11 TRAFFIC CONTROL DEVICES
- 704001-08 TEMPORARY CONCRETE BARRIER
- 780001-05 TYPICAL PAVEMENT MARKINGS
- 781001-04 TYPICAL APPLICATIONS RAISED REFLECTIVE PAVEMENT MARKERS
- 862001-01 UNINTERRUPTABLE POWER SUPPLY (UPS)
- B.L.R. 21-9 TYPICAL APPLICATION OF TRAFFIC CONTROL DEVICES FOR CONSTRUCTION ON RURAL LOCAL HIGHWAYS

MODEL: INDEX [Sheet]  
FILE NAME: c:\p\work\pav\rolland\1125621\0978846-SHB-Index\_GenNotes.dgn

USER NAME = valerie.rolla	DESIGNED -	REVISED -	<b>STATE OF ILLINOIS DEPARTMENT OF TRANSPORTATION</b>	<b>INDEX OF SHEETS, HIGHWAY STANDARDS</b>			F.A.P. RTE.	SECTION	COUNTY	TOTAL SHEETS	SHEET NO.
	DRAWN -	REVISED -					849	D9 Bridge Overlay 2026-7	Hamilton	16	3
	CHECKED -	REVISED -		SCALE: SHEET 1 OF 1 SHEETS STA. TO STA.			CONTRACT NO. 78B46				
PLOT DATE = 12/31/2025	DATE -	REVISED -		ILLINOIS FED. AID PROJECT							

## SUMMARY OF QUANTITIES

COUNTY:	HAMILTON	HAMILTON
ROUTE:	IL 142	IL 142
FUNDING:	80% FEDERAL 20% STATE	80% FEDERAL 20% STATE
LOCATION:	RURAL	RURAL
	SN 033-0041	SN 033-0043
	0059	0059

CODE NUMBER	ITEM DESCRIPTION	UNIT	TOTAL QUANTITY	SN 033-0041 0059	SN 033-0043 0059
35400500	PORTLAND CEMENT CONCRETE BASE COURSE WIDENING 10"	SQ YD	370	121	249
44004250	PAVED SHOULDER REMOVAL	SQ YD	370	121	249
53016000	DECK SLAB REPAIR (PARTIAL)	SQ YD	4.6	0.6	4.0
53016001	DECK SLAB REPAIR (FULL DEPTH, TYPE I)	SQ YD	9.8		9.8
67000400	ENGINEER'S FIELD OFFICE, TYPE A	CAL MO	3	1.5	1.5
67100100	MOBILIZATION	L SUM	1	0.5	0.5
70100100	TRAFFIC CONTROL AND PROTECTION, STANDARD 701316	EACH	1	1	0
70100405	TRAFFIC CONTROL AND PROTECTION, STANDARD 701321	EACH	1		1
70100450	TRAFFIC CONTROL AND PROTECTION, STANDARD 701201	L SUM	1	0.5	0.5
70100500	TRAFFIC CONTROL AND PROTECTION, STANDARD 701326	L SUM	1	0.5	0.5
70103815	TRAFFIC CONTROL SURVEILLANCE	CAL DA	12	6	6
70106500	TEMPORARY BRIDGE TRAFFIC SIGNALS	EACH	2	1	1

MODEL: S001 (Sheet)  
FILE NAME: c:\p\work\p\work\kropen\1125621\0978B4F-SHC-S00.dgn

USER NAME = elise.knop	DESIGNED -	REVISED -
	DRAWN -	REVISED -
	CHECKED -	REVISED -
PLOT DATE = 12/16/2025	DATE -	REVISED -

**STATE OF ILLINOIS  
DEPARTMENT OF TRANSPORTATION**

**SUMMARY OF QUANTITIES**

SCALE: SHEET 1 OF 3 SHEETS STA. TO STA.

F.A.P. RTE.	SECTION	COUNTY	TOTAL SHEETS	SHEET NO.
849	D9 Bridge Overlay 2026-7	Hamilton	16	4
CONTRACT NO. 78B46				
ILLINOIS FED. AID PROJECT				

## SUMMARY OF QUANTITIES - CONT

COUNTY:	HAMILTON	HAMILTON
ROUTE:	IL 142	IL 142
FUNDING:	80% FEDERAL 20% STATE	80% FEDERAL 20% STATE
LOCATION:	RURAL	RURAL
	SN 033-0041	SN 033-0043
	0059	0059

CODE NUMBER	ITEM DESCRIPTION	UNIT	TOTAL QUANTITY	SN 033-0041 0059	SN 033-0043 0059
70106700	TEMPORARY RUMBLE STRIPS	EACH	12	6	6
70107025	CHANGEABLE MESSAGE SIGN	CAL DA	28	14	14
70300100	SHORT TERM PAVEMENT MARKING	FOOT	128	52	76
70300150	SHORT TERM PAVEMENT MARKING REMOVAL	SQ FT	44	18	26
70400100	TEMPORARY CONCRETE BARRIER	FOOT	362.5		362.5
70400200	RELOCATE TEMPORARY CONCRETE BARRIER	FOOT	362.5		362.5
70600251	IMPACT ATTENUATORS, TEMPORARY (NON- REDIRECTIVE, NARROW), TEST LEVEL 3	EACH	2		2
70600352	IMPACT ATTENUATORS, RELOCATE (NON- REDIRECTIVE, NARROW), TEST LEVEL 3	EACH	2		2
* 78001110	PAINT PAVEMENT MARKING - LINE 4"	FOOT	2,862	1,170	1,692
78300200	RAISED REFLECTIVE PAVEMENT MARKER REMOVAL	EACH	2	1	1
78300201	PAVEMENT MARKING REMOVAL - GRINDING	SQ FT	954	390	564
* 86200300	UNINTERRUPTABLE POWER SUPPLY, EXTENDED	EACH	2	1	1
X7011800	TRAFFIC CONTROL AND PROTECTION, STANDARD BLR 21	L SUM	1		1

\* SPECIALTY ITEM

REV - MS

MODEL: S002 (Sheet)  
FILE NAME: c:\p\work\pav\stl\knopan\1125621\097846-SumC-S00.dgn

USER NAME = elise.knop	DESIGNED -	REVISED -	<b>STATE OF ILLINOIS DEPARTMENT OF TRANSPORTATION</b>	<b>SUMMARY OF QUANTITIES</b>			F.A.P. RTE.	SECTION	COUNTY	TOTAL SHEETS	SHEET NO.			
	DRAWN -	REVISED -		SCALE:	SHEET 2	OF 3	SHEETS	STA.	TO STA.	849	D9 Bridge Overlay 2026-7	Hamilton	16	5
	CHECKED -	REVISED -		CONTRACT NO. 78B46										
PLOT DATE = 12/16/2025	DATE -	REVISED -		ILLINOIS   FED. AID PROJECT										

## SUMMARY OF QUANTITIES - CONT

CODE NUMBER	ITEM DESCRIPTION	UNIT	TOTAL QUANTITY	COUNTY:	HAMILTON	HAMILTON
				ROUTE:	IL 142	IL 142
			FUNDING:	80% FEDERAL 20% STATE	80% FEDERAL 20% STATE	
			LOCATION:	RURAL	RURAL	
				SN 033-0041	SN 033-0043	
				0059	0059	
Z0001800	APPROACH SLAB REPAIR (PARTIAL DEPTH)	SQ YD	11.4		4.8	6.6
Z0012102	CONCRETE BRIDGE DECK SCARIFICATION 3/8 INCH	SQ YD	532		196	336
Z0012193	BRIDGE DECK THIN POLYMER OVERLAY 3/8"	SQ YD	532		196	336

MODEL: SOQ3 (Sheet)  
 FILE NAME: c:\p\work\pww\kropen\1125621\0978B4F-SHC-SoQ.dgn

OVERLAY SCHEDULE					
STATION		BRIDGE DECK SCARIFICATION, 3/8" (SQ YD)		BRIDGE DECK THIN POLYMER OVERLAY, 3/8" (SQ YD)	
<b>SN 033-0041</b>					
227+19.00	RT TO	227+71.50	RT	94	94
227+19.00	LT TO	227+71.50	LT	94	94
<b>SN 033-0043</b>					
266+11.00	RT TO	267+05.00	RT	168	168
266+11.00	LT TO	267+05.00	LT	168	168
TOTAL=				<b>524</b>	<b>524</b>

PAVEMENT MARKING SCHEDULE							
STATION	PAINT PAVEMENT MARKING - LINE 4"		PVT MARKING REMOVAL- GRINDING	SHORT TERM	SHORT TERM		
	SOLID WHITE	YELLOW SKIP DASH		PVT MARKING	PVT MARKING REMOVAL		
	FOOT	FOOT	SQ FT	FOOT	SQ FT		
SN 033-0041							
227+19.00	TO	227+71.50	1040	130	390	52	18
SN 033-0043							
266+11.00	TO	267+05.00	1504	188	564	76	26
SUBTOTAL=			2544	318	954	128	44
TOTAL=			<b>2862</b>	<b>954</b>	<b>128</b>	<b>44</b>	

MODEL: Schedule-1 (Sheet)  
FILE NAME: c:\p\work\w10\kropen\1125621\0978B4F-Site-Schedules.dgn

USER NAME = elise.knop	DESIGNED -	REVISED -
	DRAWN -	REVISED -
	CHECKED -	REVISED -
PLOT DATE = 3/4/2026	DATE -	REVISED -

**STATE OF ILLINOIS  
DEPARTMENT OF TRANSPORTATION**

<b>SCHEDULE</b>			
SCALE:	SHEET 1	OF 1	SHEETS
	STA.		TO STA.

F.A.P. RTE.	SECTION	COUNTY	TOTAL SHEETS	SHEET NO.
849	D9 Bridge Overlay 2026-7	Hamilton	16	7
CONTRACT NO. 78B46				
ILLINOIS FED. AID PROJECT				

**GENERAL NOTES**

Plan dimensions and details relative to existing structures have been taken from existing plans are subject to nominal construction variations. The Contractor shall field verify existing dimensions and details affecting new construction and make necessary approved adjustments prior to construction or ordering of materials. Such variations shall not be cause for additional compensation for a change in scope of the work, however, the Contractor will be paid for the quantity actually furnished at the unit price bid for the work.

The deck slab repair and approach slab repair shall have its final finish tined according to Article 420.09(e)(1) of the Standard Specifications. Cost included with Deck Slab Repair and Approach Slab Repair respectively.

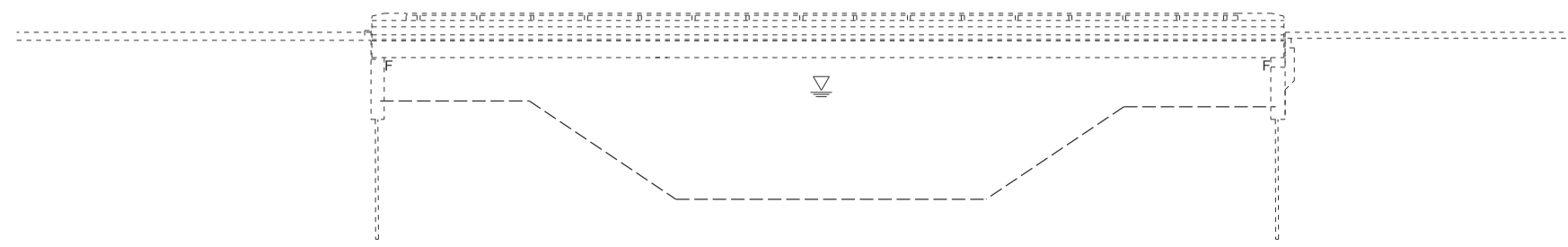

**ELEVATION**

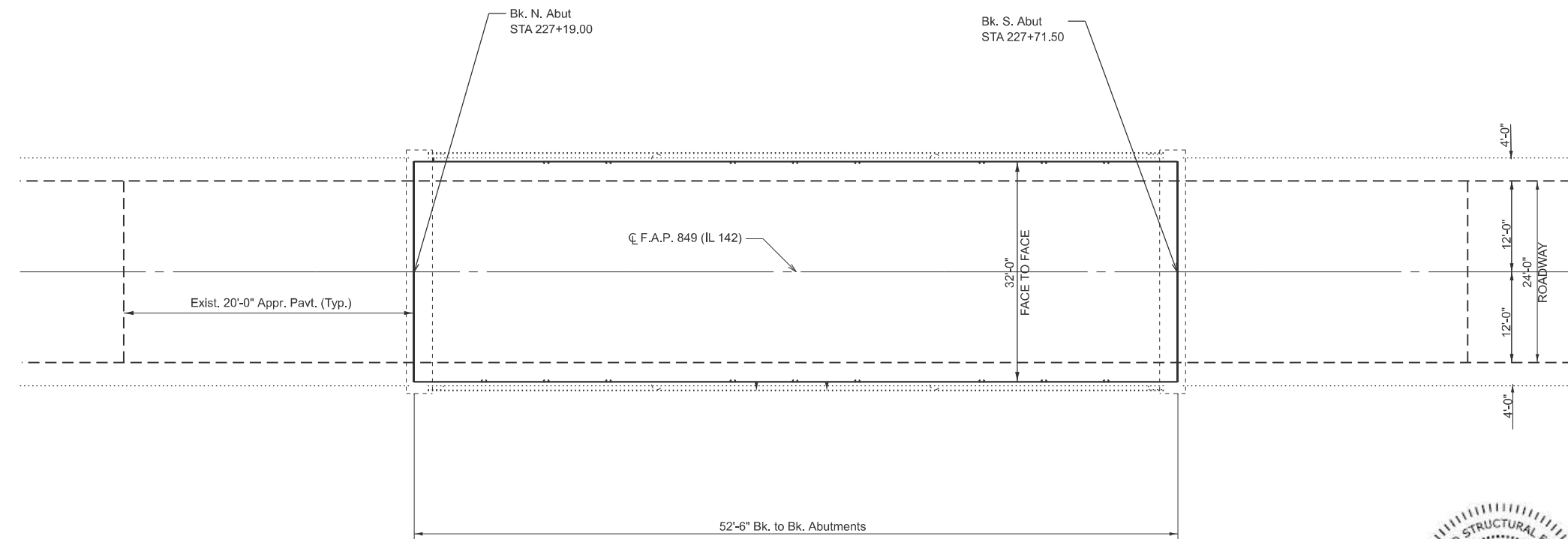
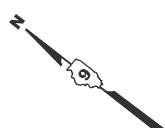

**PLAN**

**TOTAL BILL OF MATERIALS**

ITEM	UNIT	QUANTITY
CONCRETE BRIDGE DECK SCARIFICATION, 3/8"	SQ. YD	188
BRIDGE DECK THIN POLYMER OVERLAY	SQ. YD	188
DECK SLAB REPAIR (PARTIAL)	SQ. YD	0.6
APPROACH SLAB REPAIR (PARTIAL DEPTH)	SQ. YD	4.8



**Expires November 30, 2026**

*Justin W. Mann*

**BRIDGE DECK POLYMER OVERLAY  
IL 142 OVER BLUE CREEK  
F.A.P. RTE 849 - D9 BRIDGE OVERLAY 2026-7  
HAMILTON COUNTY  
STATION 227+45.25  
STRUCTURE NO. 033-0041**

MODEL: GPE [Sheet]  
FILE NAME: c:\p\work\wv\td\knopen\1125621\0978B4F-SHRF\_A\_SNO33-0041.dgn

USER NAME = elise.knop	DESIGNED -	REVISED -
	DRAWN -	REVISED -
	CHECKED -	REVISED -
PLOT DATE = 3/4/2026	DATE -	REVISED -

**STATE OF ILLINOIS  
DEPARTMENT OF TRANSPORTATION**

**GENERAL PLAN AND ELEVATION  
SN 033-0041**

SCALE: SHEET 1 OF 8 SHEETS STA. TO STA.

F.A.P. RTE.	SECTION	COUNTY	TOTAL SHEETS	SHEET NO.
849	D9 Bridge Overlay 2026-7	Hamilton	16	8
			CONTRACT NO. 78B46	
		ILLINOIS FED. AID PROJECT		

STAGE 1 REMOVAL

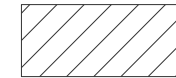
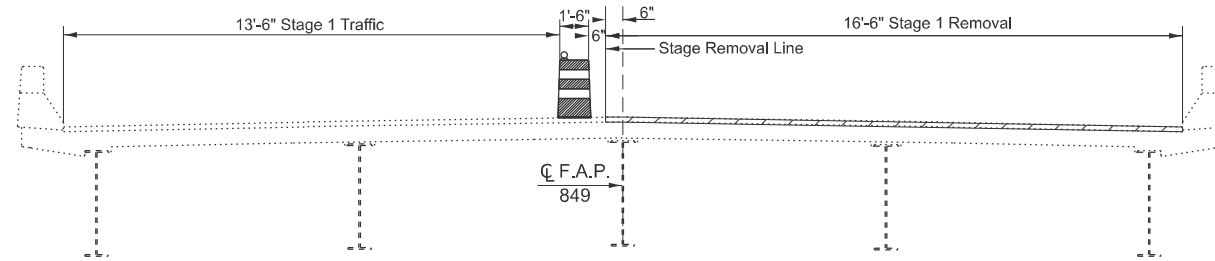

Concrete Bridge Deck Scarification,  $\frac{3}{8}$ "

STAGE 1 CONSTRUCTION

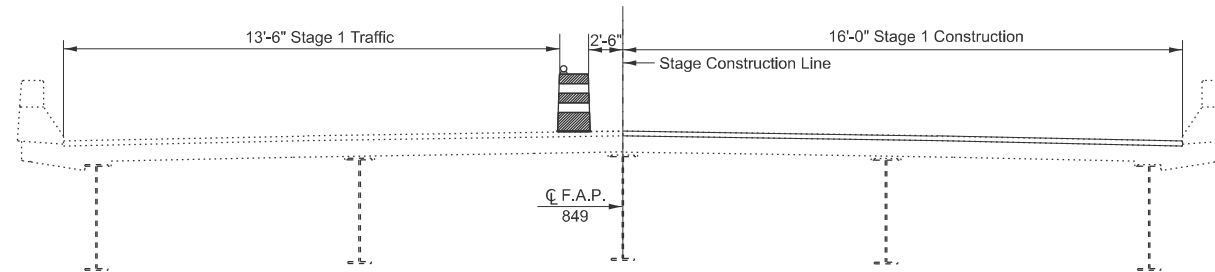

STAGE 2 REMOVAL

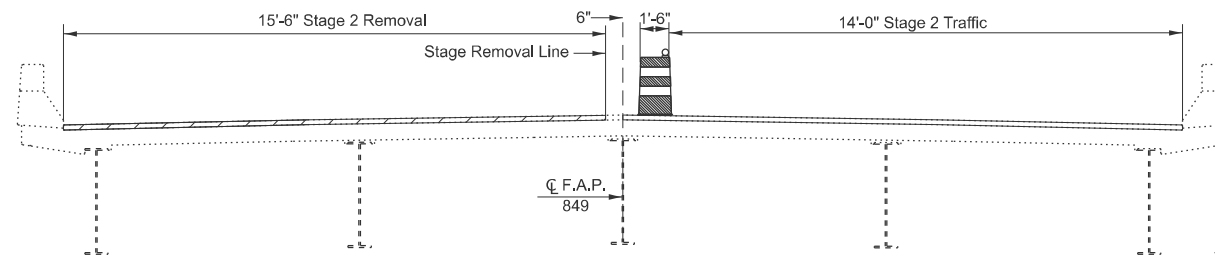

STAGE 2 CONSTRUCTION

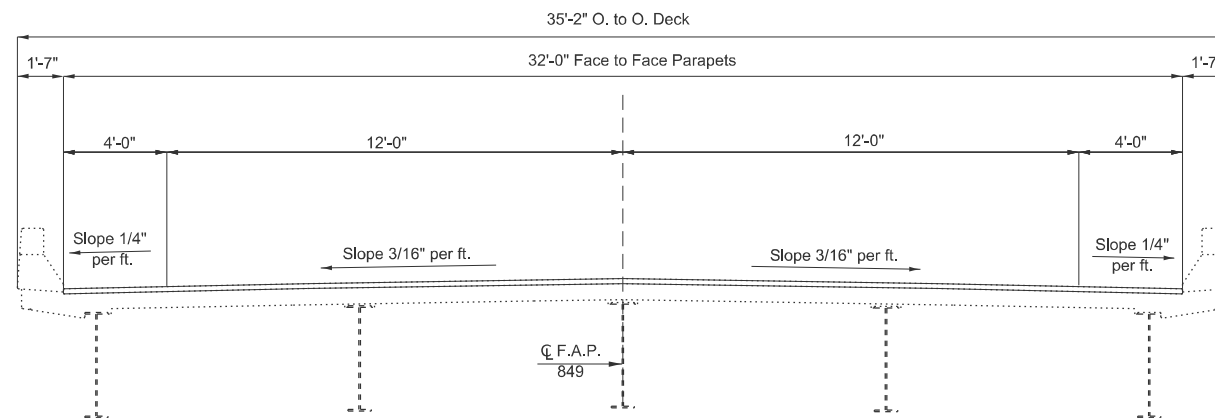
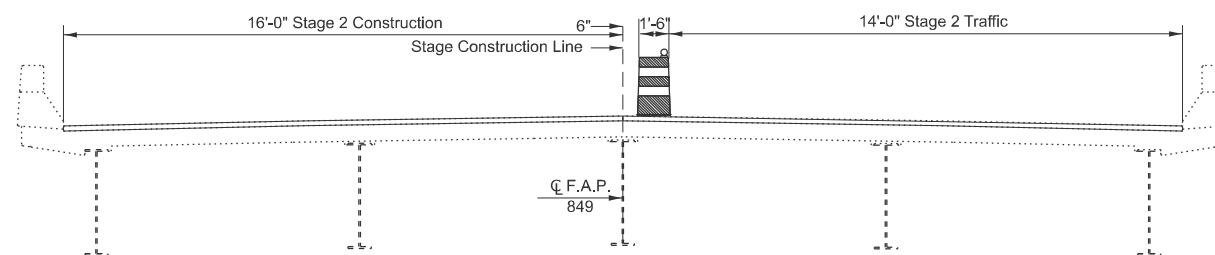

SECTION THROUGH STRUCTURE SHOWING BRIDGE DECK THIN POLYMER OVERLAY  
LOOKING SOUTH

STAGING DETAILS  
IL 142 OVER BLUE CREEK  
F.A.P. RTE 849- D9 BRIDGE OVERLAY 2026-7  
HAMILTON COUNTY  
STATION 227+45.25  
STRUCTURE NO. 033-0041

MODEL: Staging Detail (Sheet)  
FILE NAME: c:\p\work\wtd\kropen\1125621\0978B4F-SHRF\_A\_S\033-0041.dgn

USER NAME = elise.knop	DESIGNED -	REVISED -
	DRAWN -	REVISED -
	CHECKED -	REVISED -
PLOT DATE = 12/16/2025	DATE -	REVISED -

STATE OF ILLINOIS  
DEPARTMENT OF TRANSPORTATION

STAGING DETAILS SN 033-0041	
SCALE:	SHEET 2 OF 8 SHEETS STA. TO STA.

F.A.P. RTE.	SECTION	COUNTY	TOTAL SHEETS	SHEET NO.
849	D9 Bridge Overlay 2026-7	Hamilton	16	9
CONTRACT NO. 78B46				
ILLINOIS FED. AID PROJECT				

\*Must be installed pre stage 1 under traffic standard 701326.

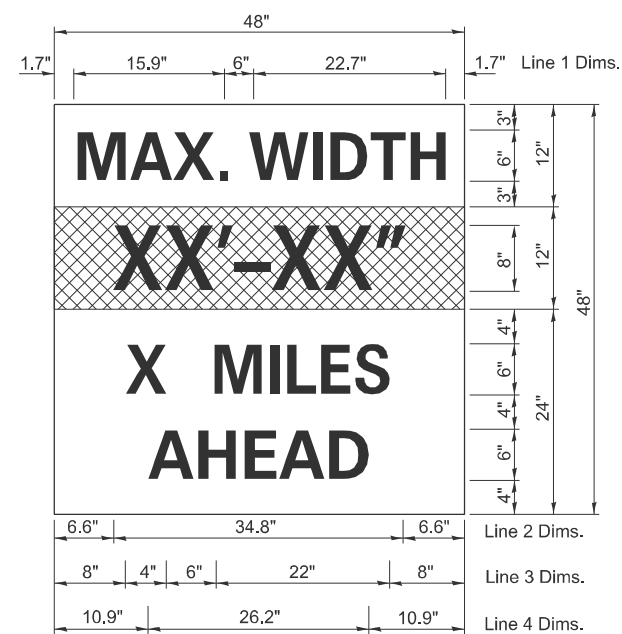
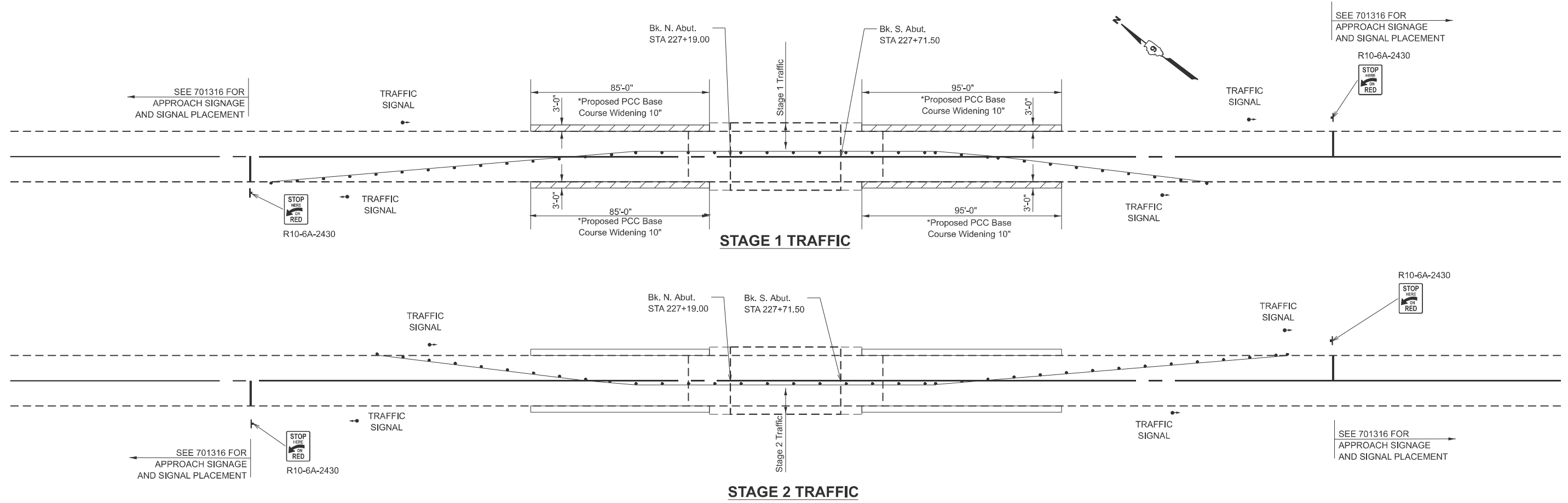

**W12-I103**

W12-I103, No Border  
 "MAX WIDTH" 6D, No Border, Black on White  
 "XX-XX" 8D, No Border, Black on Orange  
 "X MILES" 6D, No Border, Black on White  
 "AHEAD" 6D, No Border, Black on White

**Notes for Max Width Sign:**

1. Install a Max Width Sign each direction on IL 142 to give traffic approaching work zone enough advance notice to change routes if needed. Exact locations as directed by engineer.
2. The contractor shall furnish the posts and erect the signs at the locations directed by the engineer. All signs shall be post mounted.
3. The noted work, including signs, posts, hardware and labor shall be included in the contract unit price, each, for Traffic Control and Protection, Std. 701316, no other compensation will be allowed.
4. The width shown on the W12-I103 sign shall be 18" less than what is shown in the staged lane widths or as directed by the Engineer.
5. The "X" MILES AHEAD will be determined by the engineer.

MODEL: Staging Plan 2 (Sheet)  
 FILE NAME: c:\p\work\w12i103\kropen\1125621\0978B4F-ShtF\_A\_SNO33-0041.dgn

USER NAME = elise.knop	DESIGNED -	REVISED -
	DRAWN -	REVISED -
	CHECKED -	REVISED -
PLOT DATE = 12/16/2025	DATE -	REVISED -

**STATE OF ILLINOIS  
 DEPARTMENT OF TRANSPORTATION**

**STAGING PLAN  
 SN 033-0041**

SCALE: SHEET 3 OF 8 SHEETS STA. TO STA.

F.A.P. RTE.	SECTION	COUNTY	TOTAL SHEETS	SHEET NO.
849	D9 Bridge Overlay 2026-7	Hamilton	16	10
CONTRACT NO. 78B46			ILLINOIS FED. AID PROJECT	

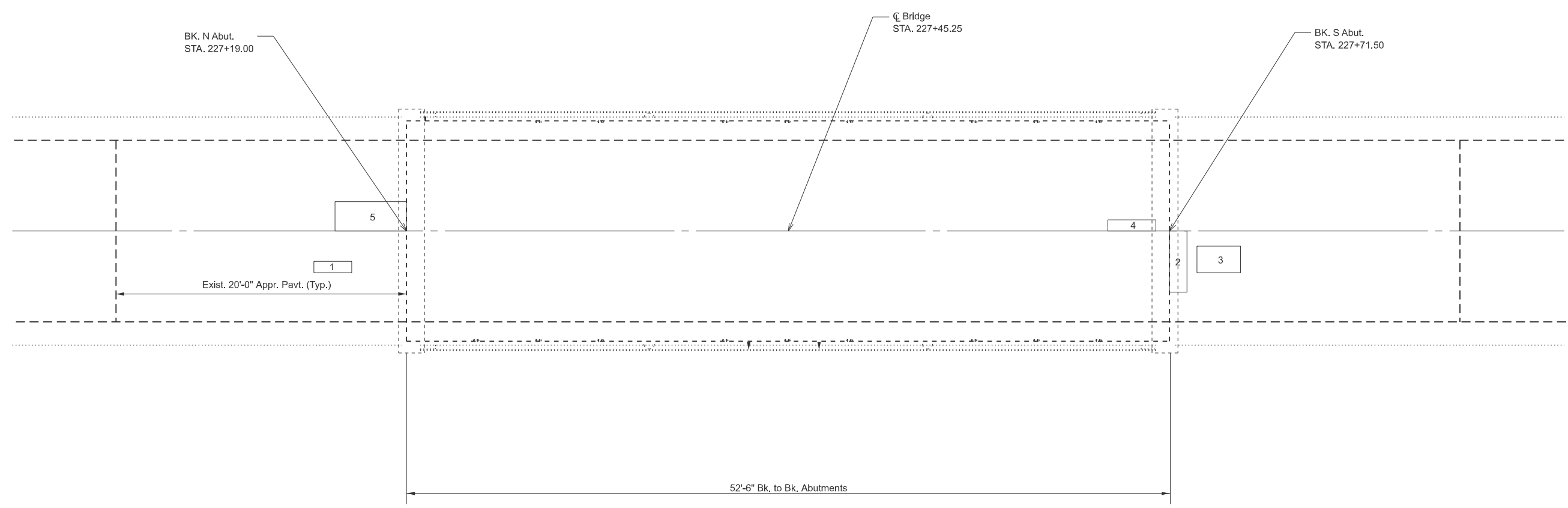
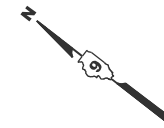

NOTE: Areas of deck repairs shown are an estimate. The Resident Engineer shall determine final patch locations and quantities in the field before bridge deck patching operations begin and mark on AS-BUILT plans.

**TOTAL BILL OF MATERIALS**

ITEM	UNIT	QUANTITY
APPROACH SLAB REPAIR (PARTIAL DEPTH)	SQ. YD	4.8
DECK SLAB REPAIR (PARTIAL)	SQ. YD	0.6

**APPROACH SLAB REPAIR (PARTIAL DEPTH)**

PATCH #	LANE	DIST. FROM $\phi$	WIDTH	LENGTH	AREA(SQ YD)
5	NBDL	0'	4.9	3.9	2.1
1	SBDL	4'	2.6	1.5	0.4
2	SBDL	0'	1.2	8.1	1.1
3	SBDL	2'	3.0	3.5	1.2
TOTAL=					4.8

**DECK SLAB REPAIR (PARTIAL)**

PATCH #	LANE	DIST. FROM $\phi$	WIDTH	LENGTH	AREA(SQ YD)
4	NBDL	0'	3.3	1.5	0.6
TOTAL=					0.6

**DECK SLAB REPAIRS**  
**IL 142 OVER BLUE CREEK**  
**F.A.P. RTE 849 - D9 BRIDGE OVERLAY 2026-7**  
**HAMILTON COUNTY**  
**STATION 227+45.5**  
**STRUCTURE NO. 033-0041**

MODEL: Partial Depth Repairs (Sheet)  
 FILE NAME: c:\p\work\w10\knopen\1125621\0978B4F-SHRF\_A\_SNO33-0041.dgn

USER NAME = elise.knop	DESIGNED -	REVISED -
	DRAWN -	REVISED -
	CHECKED -	REVISED -
PLOT DATE = 3/4/2026	DATE -	REVISED -

**STATE OF ILLINOIS**  
**DEPARTMENT OF TRANSPORTATION**

**PARTIAL DEPTH DECK SLAB REPAIRS**  
**SN 033-0041**

SCALE: SHEET 4 OF 8 SHEETS STA. TO STA.

F.A.P. RTE.	SECTION	COUNTY	TOTAL SHEETS	SHEET NO.
849	D9 Bridge Overlay 2026-7	Hamilton	16	11
CONTRACT NO. 78B46				
ILLINOIS FED. AID PROJECT				

**GENERAL NOTES**

Plan dimensions and details relative to existing structures have been taken from existing plans are subject to nominal construction variations. The Contractor shall field verify existing dimensions and details affecting new construction and make necessary approved adjustments prior to construction or ordering of materials. Such variations shall not be cause for additional compensation for a change in scope of the work, however, the Contractor will be paid for the quantity actually furnished at the unit price bid for the work.

The deck slab repair and approach slab repair shall have its final finish tined according to Article 420.09(e)(1) of the Standard Specifications. Cost included with Deck Slab Repair and Approach Slab Repair respectively.

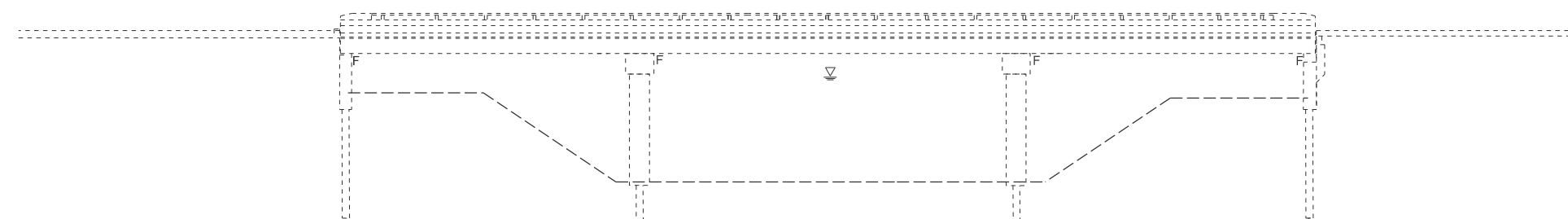

**ELEVATION**

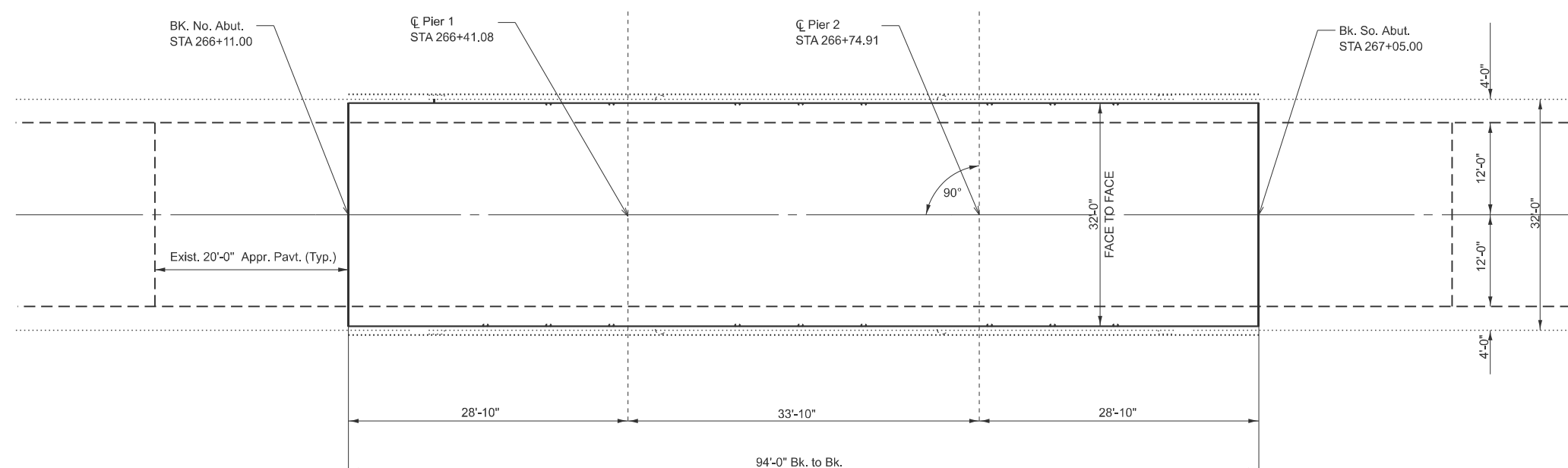

**PLAN**

**TOTAL BILL OF MATERIALS**

ITEM	UNIT	QUANTITY
CONCRETE BRIDGE DECK SCARIFICATION, 3/8"	SQ. YD	336
BRIDGE DECK THIN POLYMER OVERLAY	SQ. YD	336
DECK SLAB REPAIR (PARTIAL)	SQ. YD	4.0
APPROACH SLAB REPAIR (PARTIAL DEPTH)	SQ. YD	6.5
DECK SLAB REPAIR (FULL DEPTH) TY 1	SQ. YD	9.8

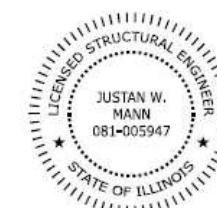

Expires November 30, 2026

*Justin W. Mann*

**BRIDGE DECK POLYMER OVERLAY**  
**IL 142 OVER BIG CREEK**  
 F.A.P. RTE 849- D9 BRIDGE OVERLAY 2026-7  
 HAMILTON COUNTY  
 STATION 226+58.00  
 STRUCTURE NO. 033-0043

MODEL: GPE [Sheet]  
 FILE NAME: c:\p\work\pwr\kropen\id112562178B46-Shif\_B\_SIN033-0043.dgn

USER NAME = elise.knop	DESIGNED -	REVISED -
	DRAWN -	REVISED -
	CHECKED -	REVISED -
PLOT DATE = 3/4/2026	DATE -	REVISED -

**STATE OF ILLINOIS**  
**DEPARTMENT OF TRANSPORTATION**

**GENERAL PLAN AND ELEVATION**  
**SN 033-0043**

SCALE: SHEET 5 OF 8 SHEETS STA. TO STA.

F.A.P. RTE.	SECTION	COUNTY	TOTAL SHEETS	SHEET NO.
849	D9 Bridge Overlay 2026-7	Hamilton	16	12
ILLINOIS FED. AID PROJECT			CONTRACT NO. 78B46	

STAGE 1 REMOVAL

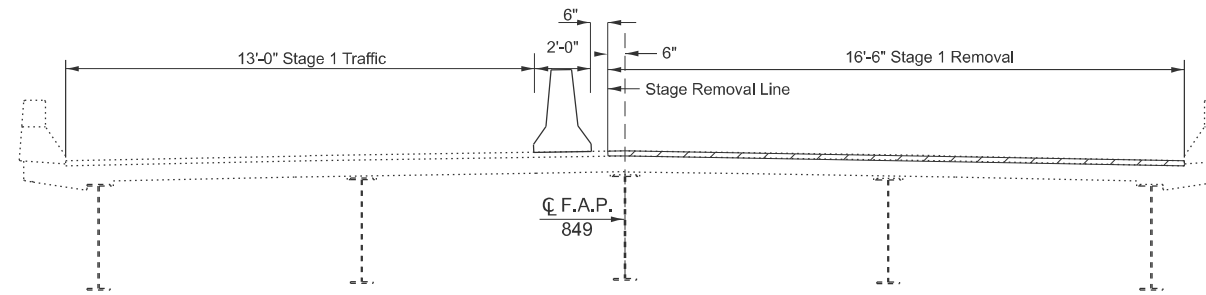

STAGE 1 CONSTRUCTION

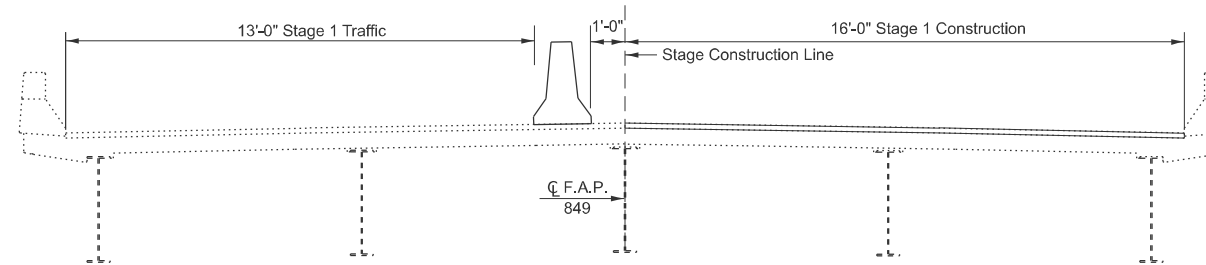

STAGE 2 REMOVAL

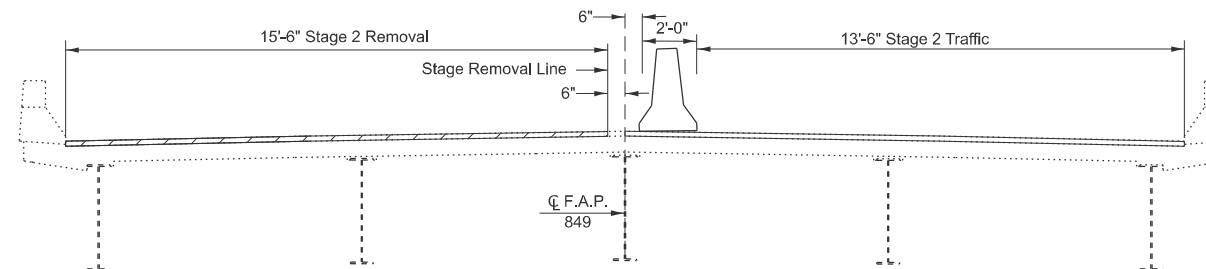

STAGE 2 CONSTRUCTION

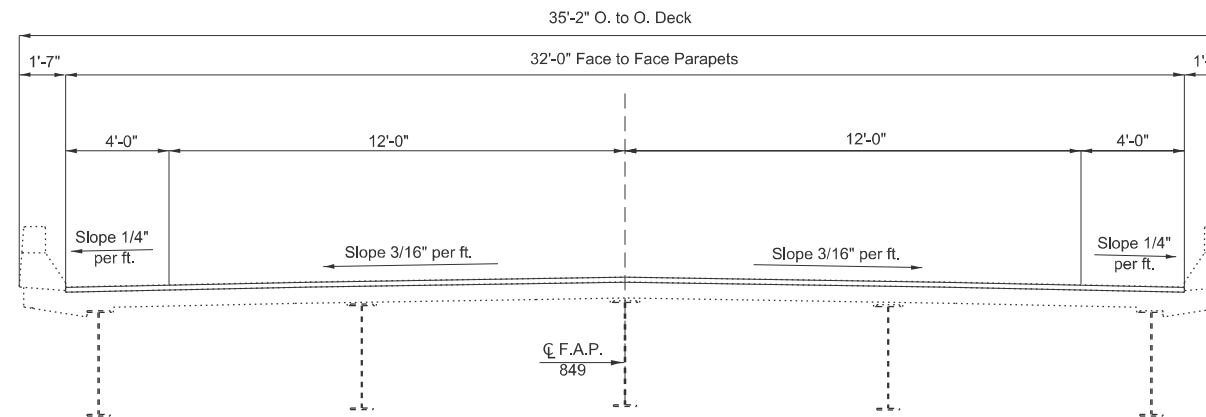
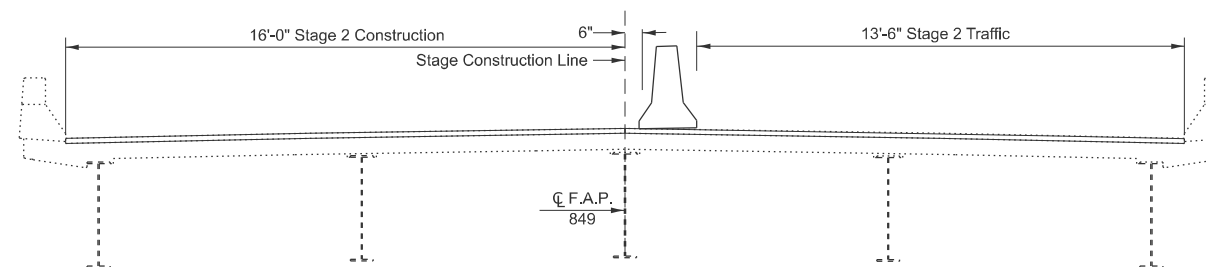

SECTION THROUGH STRUCTURE SHOWING BRIDGE DECK THIN POLYMER OVERLAY  
LOOKING SOUTH

STAGING DETAILS  
IL 142 OVER BIG CREEK  
F.A.P. RTE 849 - D9 BRIDGE OVERLAY 2026-7  
HAMILTON COUNTY  
STATION 226+58.00  
STRUCTURE NO. 033-0043

MODEL: STAGING (Sheet)  
FILE NAME: c:\p\work\project\open\112562178B46-Shif\_B\_SIN033-0043.dgn

USER NAME = elise.knop	DESIGNED -	REVISED -
	DRAWN -	REVISED -
	CHECKED -	REVISED -
PLOT DATE = 12/16/2025	DATE -	REVISED -

STATE OF ILLINOIS  
DEPARTMENT OF TRANSPORTATION

SCALE:		SHEET 6 OF 8 SHEETS		STA. TO STA.	
--------	--	---------------------	--	--------------	--

STAGING DETAILS  
SN 033-0043

F.A.P. RTE.	SECTION	COUNTY	TOTAL SHEETS	SHEET NO.
849	D9 Bridge Overlay 2026-7	Hamilton	16	13
ILLINOIS FED. AID PROJECT			CONTRACT NO. 78B46	

\*Must be installed pre stage 1 under traffic standard 701326.

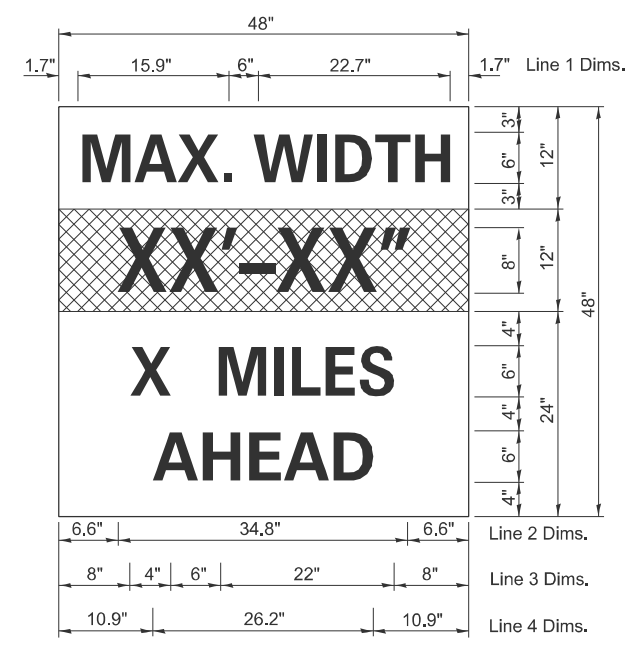
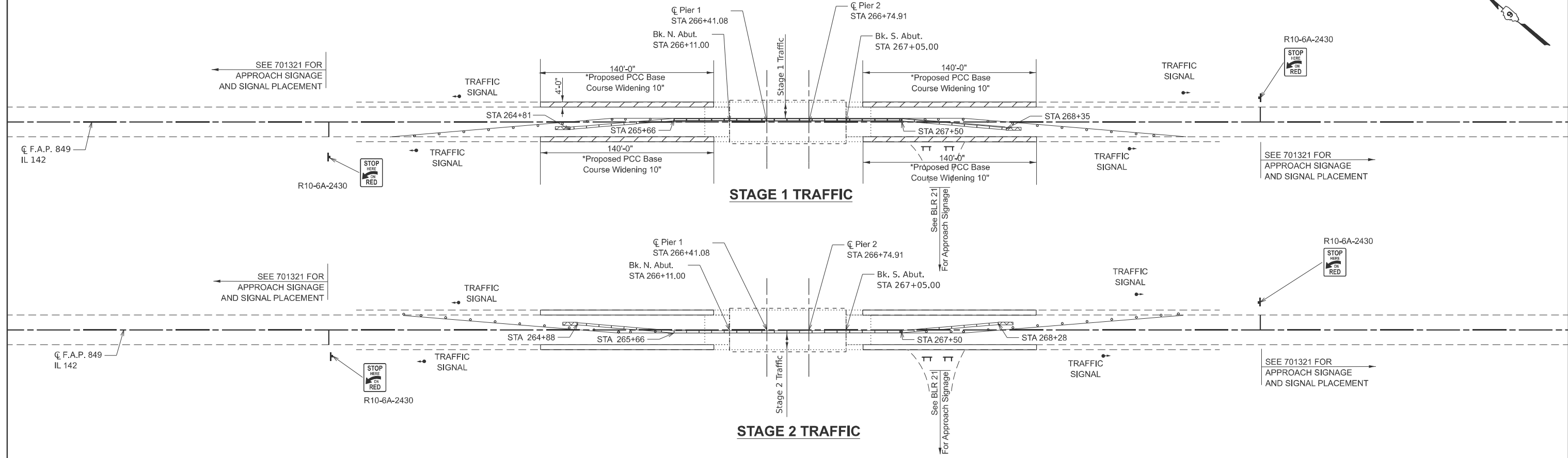
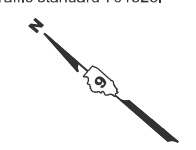

**W12-I103**

W12-I103, No Border  
 "MAX WIDTH" 6D, No Border, Black on White  
 "XX'-XX'" 8D, No Border, Black on Orange  
 "X MILES" 6D, No Border, Black on White  
 "AHEAD" 6D, No Border, Black on White

**Notes for Max Width Sign:**

1. Install a Max Width Sign each direction on IL 142 to give traffic approaching work zone enough advance notice to change routes if needed. Exact locations as directed by engineer.
2. The contractor shall furnish the posts and erect the signs at the locations directed by the engineer. All signs shall be post mounted.
3. The noted work, including signs, posts, hardware and labor shall be included in the contract unit price, each, for Traffic Control and Protection, Std. 701321, no other compensation will be allowed.
4. The width shown on the W12-I103 sign shall be 18" less than what is shown in the staged lane widths or as directed by the Engineer.
5. The "X" MILES AHEAD will be determined by the engineer.

**LEGEND**



MODEL: Traffic Staging Plan 2 (Sheet)  
 FILE NAME: c:\p\work\w12i103\open\112562178B46-Shif\_B\_SNO33-0043.dgn

USER NAME = elise.knop	DESIGNED -	REVISED -
	DRAWN -	REVISED -
	CHECKED -	REVISED -
PLOT DATE = 12/16/2025	DATE -	REVISED -

**STATE OF ILLINOIS  
 DEPARTMENT OF TRANSPORTATION**

**STAGING PLAN  
 SN 033-0043**

SCALE: SHEET 7 OF 8 SHEETS STA. TO STA.

F.A.P. RTE.	SECTION	COUNTY	TOTAL SHEETS	SHEET NO.
849	D9 Bridge Overlay 2026-7	Hamilton	16	14
CONTRACT NO. 78B46			ILLINOIS FED. AID PROJECT	

NOTE: Areas of deck repairs shown are an estimate. The Resident Engineer shall determine final patch locations and quantities in the field before bridge deck patching operations begin and mark on AS-BUILT plans.

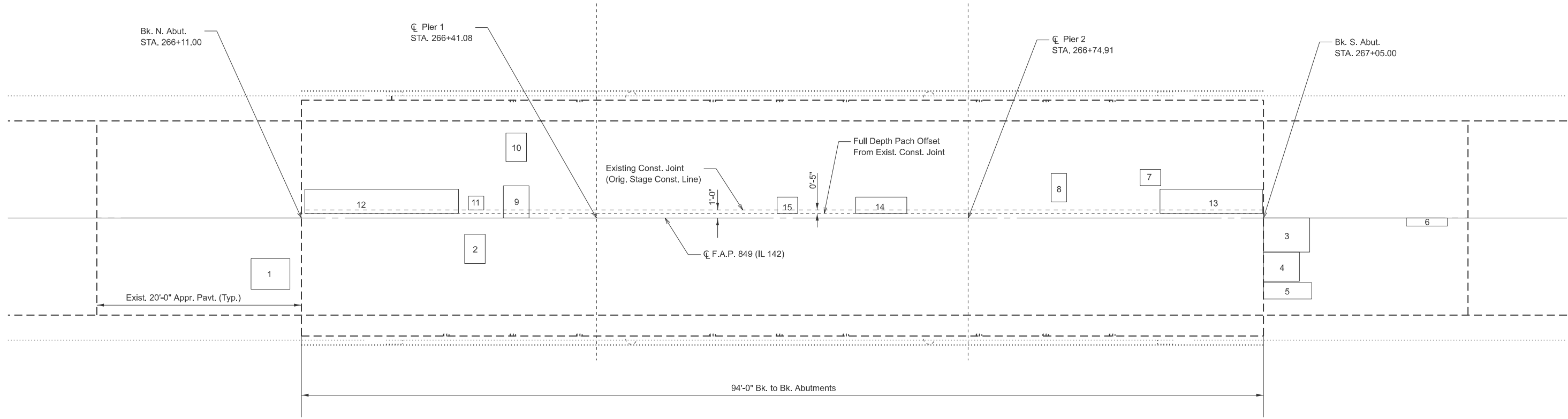
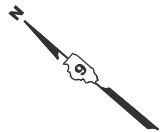

**TOTAL BILL OF MATERIALS**

ITEM	UNIT	QUANTITY
APPROACH SLAB REPAIR (PARTIAL DEPTH)	SQ. YD	6.5
DECK SLAB REPAIR (PARTIAL)	SQ. YD	4.0
DECK SLAB REPAIR (FULL DEPTH) TY 1	SQ. YD	9.8

**APPROACH SLAB REPAIR (PARTIAL DEPTH)**

PATCH #	LANE	DIST. FROM $\phi$	WIDTH	LENGTH	AREA(SQ YD)
1	SBDL	5'	3.8	3.8	1.6
3	SBDL	0'	4.5	4.2	2.1
4	SBDL	4'	3.5	3.6	1.4
5	SBDL	8'	4.7	2	1.0
6	SBDL	0'	4.0	1	0.4
<b>TOTAL=</b>					<b>6.5</b>

**DECK SLAB REPAIR (PARTIAL)**

PATCH #	LANE	DIST. FROM $\phi$	WIDTH	LENGTH	AREA(SQ YD)
7	NBDL	2'	2	2	0.4
8	NBDL	2'	1.5	3.5	0.6
9	NBDL	0'	2.5	4	1.1
10	NBDL	7'	2	3.5	0.8
11	NBDL	1'	1.5	2	0.3
2	SBDL	2'	2.0	3.6	0.8
<b>TOTAL=</b>					<b>4.0</b>

**DECK SLAB REPAIR (FULL DEPTH) TY 1**

PATCH #	WIDTH	LENGTH	AREA(SQ YD)
12	3'	15'	5.0
13	3'	10'	3.3
14	2'	5'	1.1
15	2'	2'	0.4
<b>TOTAL=</b>			<b>9.8</b>

**DECK SLAB REPAIRS**  
**IL 142 OVER BIG CREEK**  
**F.A.P. RTE 849 - D9 BRIDGE OVERLAY 2026-7**  
**HAMILTON COUNTY**  
**STATION 226+58.00**  
**STRUCTURE NO. 033-0043**

MODEL: Partial Depth (Sheet)  
FILE NAME: c:\p\work\178846-Shif\_B\_SIN033-0043.dgn

USER NAME = elise.knop	DESIGNED -	REVISED -
	DRAWN -	REVISED -
	CHECKED -	REVISED -
PLOT DATE = 1/7/2026	DATE -	REVISED -

**STATE OF ILLINOIS**  
**DEPARTMENT OF TRANSPORTATION**

**PARTIAL DEPTH DECK SLAB REPAIRS**  
**SN 033-0043**

SCALE: SHEET 8 OF 8 SHEETS STA. TO STA.

F.A.P. RTE.	SECTION	COUNTY	TOTAL SHEETS	SHEET NO.
849	D9 Bridge Overlay 2026-7	Hamilton	16	15
CONTRACT NO. 78B46				
ILLINOIS FED. AID PROJECT				

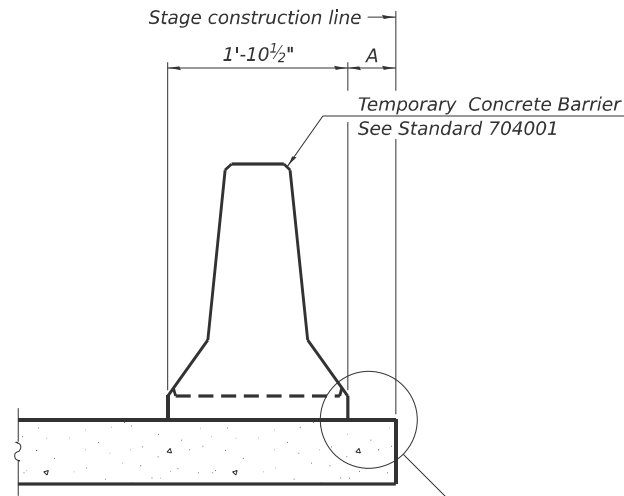

When "A" is 3'-1" or less, the temporary concrete barrier shall be restrained to the new slab according to Detail I, II or III. No restraint is required when "A" is greater than 3'-1".

NEW SLAB OR NEW DECK BEAM

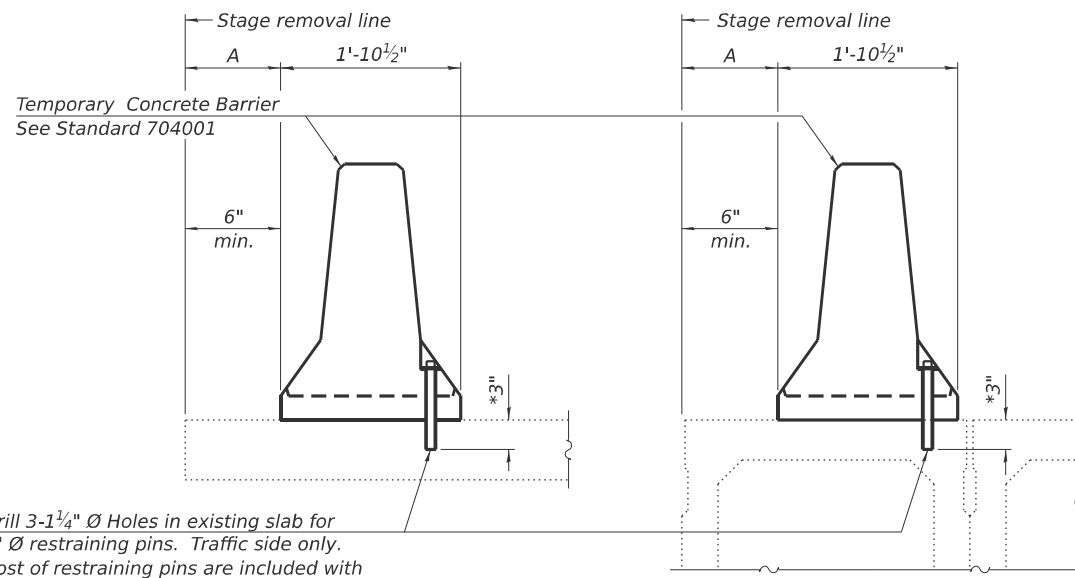

Drill 3-1/4" Ø Holes in existing slab for 1" Ø restraining pins. Traffic side only. Cost of restraining pins are included with Temporary Concrete Barrier. No restraint is required when "A" is greater than 3'-1".

EXISTING SLAB

\* When hot-mix asphalt wearing surface is present, embedment shall be 3" plus the wearing surface depth.

EXISTING DECK BEAM

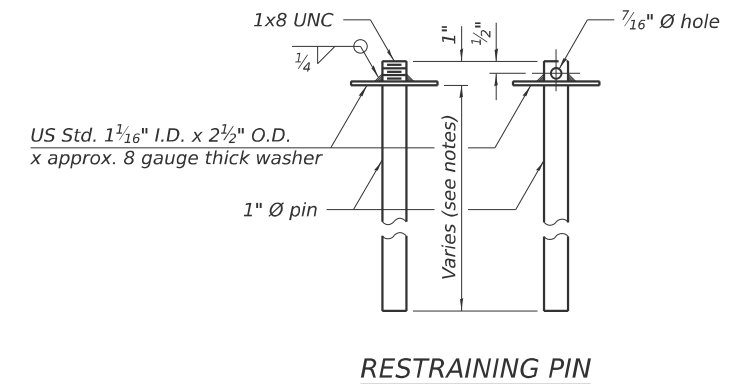

RESTRAINING PIN

SECTIONS THRU SLAB OR DECK BEAM

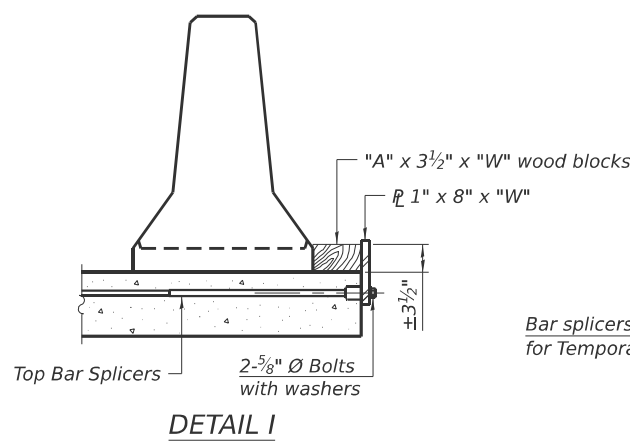

DETAIL I

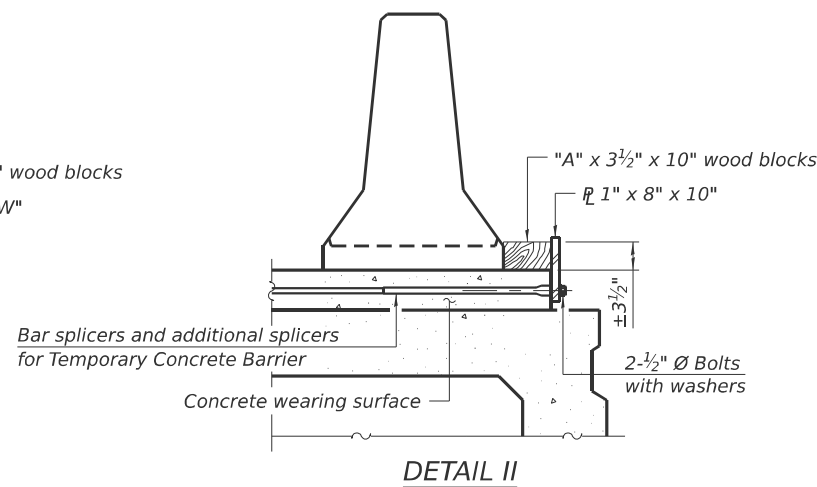

DETAIL II

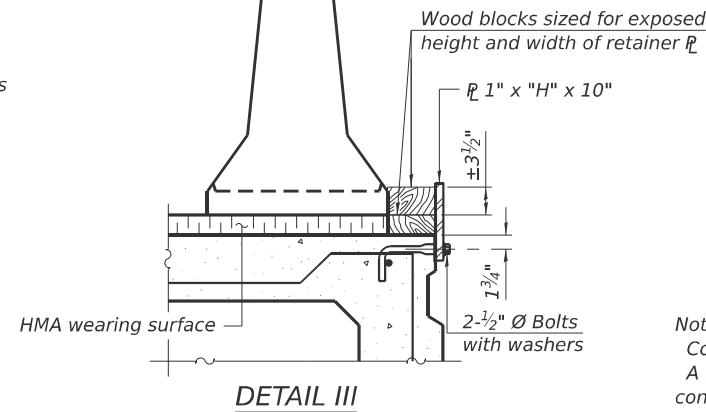

DETAIL III

BAR SPLICER FOR #4 BAR - DETAIL III

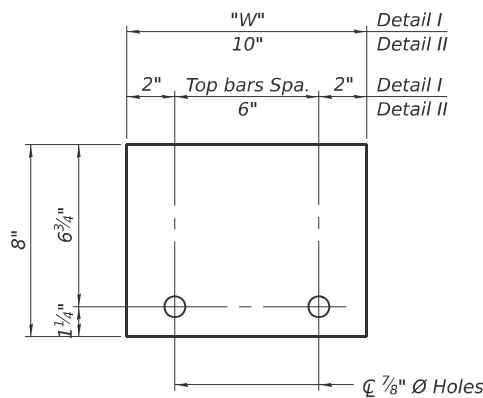

STEEL RETAINER  $R 1" \times 8" \times "W"$   
(Detail I and II)

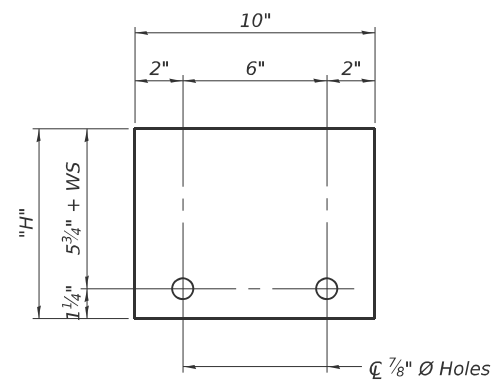

STEEL RETAINER  $R 1" \times "H" \times 10"$   
(Detail III)

Notes:

- Cost of retainer assembly is included with Temporary Concrete Barrier.
- A retainer assembly shall be located at the approximate  $\bar{C}$  of each temporary concrete barrier.
- The retainer plate shall not be removed until the concrete on the adjacent stage is ready to be poured. For Detail III applications the retainer plate shall not be removed until just prior to placing the adjacent beam.
- When the 'A' dimension is less than 1 1/2", the wood block shall be omitted and the barrier shall be placed in direct contact with the steel retainer plate.
- For deck beam applications the minimum required 'A' distance is 6" to accommodate the shear key clamping device.

Detail I - Installation for a new bridge deck or bridge slab.

Detail II - Installation for a new deck beam with an initial concrete wearing surface. Additional bar splicers shall be provided at 6'-0" centers and paired with the bar splicers of the concrete wearing surface reinforcement to accommodate the installation of the retainer assemblies. The cost of the additional bar splicers is included with the concrete wearing surface.

Detail III - Installation for a new deck beam with no initial wearing surface or with an initial hot-mix asphalt (HMA) wearing surface present. The deck beam directly beneath the temporary concrete barrier shall be fabricated with bar splicer inserts in the side of the beam, as detailed, to accommodate the installation of the retainer assemblies. A pair of bar splicers, 6" apart, shall be placed at 6'-0" centers along the length of the beam. The cost of the bar splicers is included with the deck beam.

RAILING CRITERIA

NCHRP 350 Test Level	3
Railing Weight (plf)	440

R-27 5-15-2023

MODEL: Temp Barrier Detail (Sheet)  
FILE NAME: c:\p\work\wv\kropen\112562178B46-ShiC-Details.dgn

USER NAME = ellise.knop	DESIGNED -	REVISED -
	DRAWN -	REVISED -
	CHECKED -	REVISED -
PLOT DATE = 12/4/2025	DATE -	REVISED -

STATE OF ILLINOIS  
DEPARTMENT OF TRANSPORTATION

TEMPORARY CONCRETE BARRIER  
STRUCTURE NO. 033-0043

SCALE: SHEET 1 OF 1 SHEETS STA. TO STA.

F.A.P. RTE.	SECTION	COUNTY	TOTAL SHEETS	SHEET NO.
849	D9 Bridge Overlay 2026-7	Hamilton	16	16
CONTRACT NO. 78B46				
ILLINOIS FED. AID PROJECT				