

F.A.U. RTE.	SECTION	COUNTY	TOTAL SHEETS	SHEET NO.
1248	99-00080-00-BR	LAKE	46	10
STA. 185+96		TO STA. 189+70		
FED. ROAD DIST. NO.		ILLINOIS	FED. AID PROJECT	

63020

Benchmark # 17:
Standard City of Lake Forest Control
Monument-Brass Disk in Concrete.
Elevation 652.329 (USGS)

Lake Forest

Lake Forest

City of Lake Forest Datum (LF Datum)-Lake Forest
Elevation 72.169 Ft. = 580.16 Ft. for Existing Benchmarks.

INLET 19:
Sta. 187+11.89 20.53 Lt.
Inlet Type A
Type 11 F & G
Rim Elev. = 651.33
Inv. Elev. = 647.43

SAN MH. 21:
Sta. 187+29.44, 20.53 Lt.
MH, Type A, 5' Dia.
Type 1 F, CL.
Rim Elev. = 651.60
Inv. Elev. = 635.9 (N.S.)
Inv. Elev. = 635.5 (E)
Inv. Elev. = 637.7 (W)

SAN. MH 18:
Sta. 187+62.55, 23.54 Lt.
MH, Type A, 5' Dia.
Type 1 F, CL
Rim Elev. = 651.91
Inv. Elev. = 637.41 (W.E.)

Inlet 18:
Sta. 187+11.87' Rt.
Inlet Type A
Type 11 F & G
Rim Elev. = 651.21
Inv. Elev. = 647.11 (N)
Inv. Elev. = 646.41 (SW)

30 Remove & Replace Existing
12" San Sewer, Type Ductile Iron, CL. 52
80.2' @ 0.01%
See Notes below

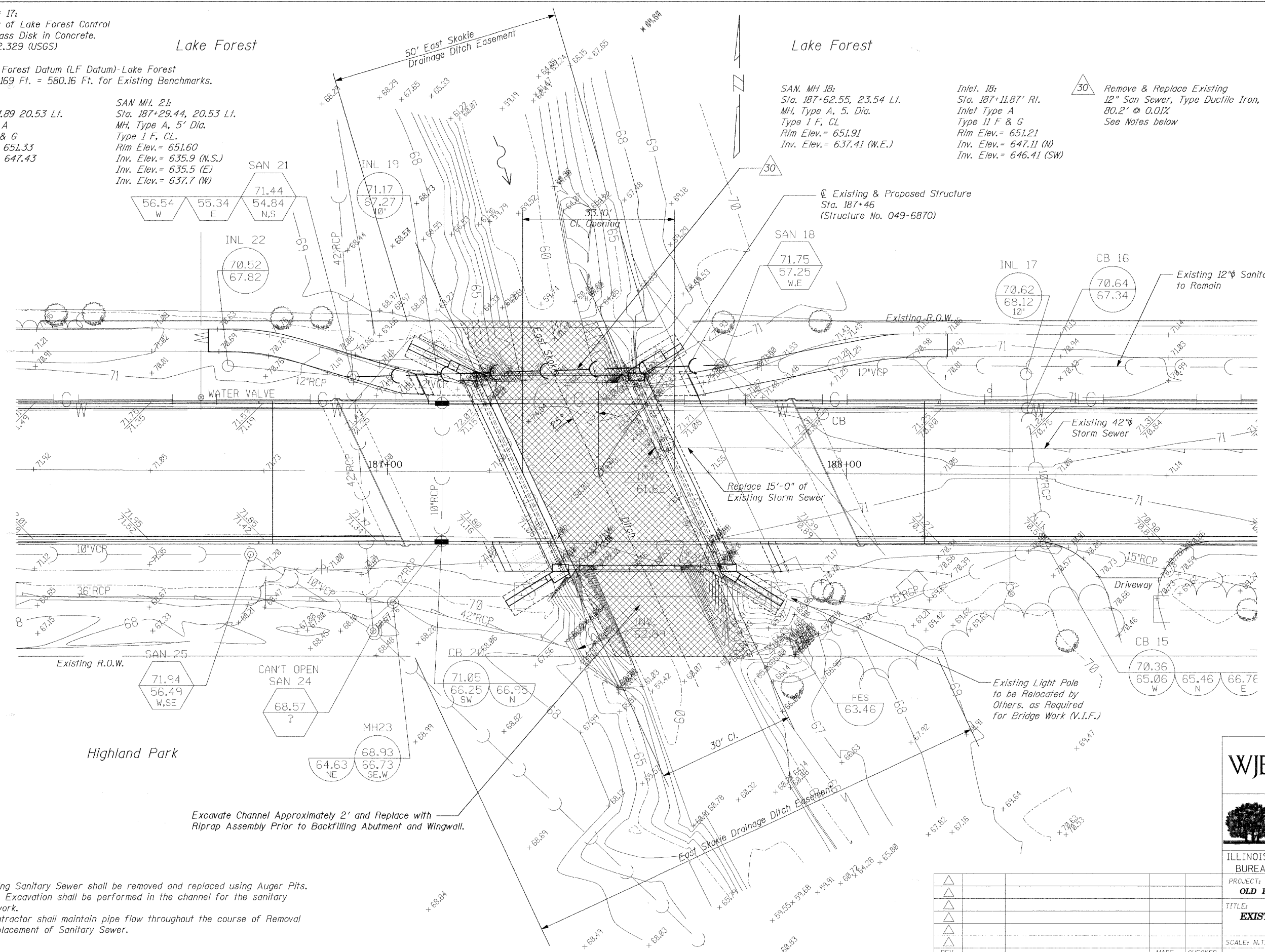

WATER VALVE

Replace 15'-0" of Existing Storm Sewer

Existing Light Pole to be Relocated by Others, as Required for Bridge Work (V.I.F.)

Excavate Channel Approximately 2' and Replace with Riprap Assembly Prior to Backfilling Abutment and Wingwall.

Notes:
Existing Sanitary Sewer shall be removed and replaced using Auger Pits.
No open Excavation shall be performed in the channel for the sanitary sewer work.
The Contractor shall maintain pipe flow throughout the course of Removal and Replacement of Sanitary Sewer.

WJE Wiss, Janney, Elstner Associates, Inc.
Engineers, Architects, Material Scientists
330 Pfingsten Road, Northbrook, IL 60062
(847) 272-7400, Fax (847) 291-4813
WJE No. 2008.2324

THE CITY OF LAKE FOREST
CHARTERED 1861

ILLINOIS DEPARTMENT OF TRANSPORTATION
BUREAU OF LOCAL ROADS AND STREETS

PROJECT: OLD ELM ROAD OVER EAST SKOKIE DITCH

TITLE: EXISTING AND PROPOSED DRAINAGE AND UTILITY PLAN

SCALE: N.T.S. DRAWN BY: IMG
DATE: JANUARY 2008 CHECKED BY: NSA

REV. NO.	DATE	REVISION RECORD	MADE BY	CHECKED BY

DATE: 2/2/2008 FILENAME: P:\2006\2301-2400\2006.2324-NAnderson-Old Elm Design\MICROSTATION-FINAL\C-10.dgn