

F.A.U. RTE.	SECTION	COUNTY	TOTAL SHEETS	SHEET NO.
1248	99-00080-00-BR	LAKE	46	16
STA.	TO STA.			
FED. ROAD DIST. NO.	ILLINOIS	FED. AID PROJECT		

Sheet S-4 of S-29 **63020**

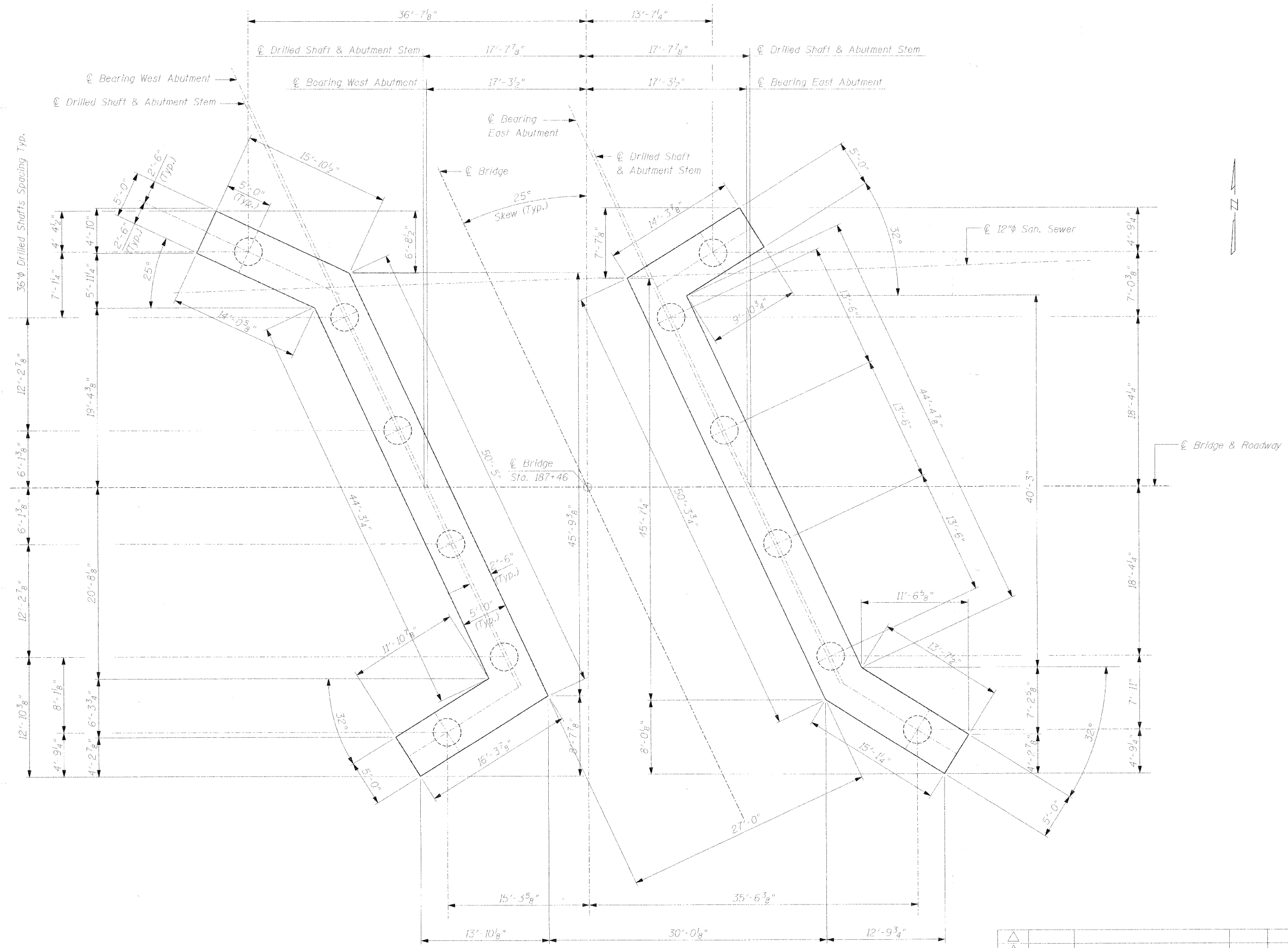

DRILLED SHAFT CAP LAYOUT

Notes:
See S-25 for Drilled Shaft and Cap Details

WJE Wiss, Janney, Elstner Associates, Inc.
Engineers, Architects, Material Scientists
330 Pfingsten Road, Northbrook, IL 60062
(847) 272-7400, Fax: (847) 291-4813
WJE No. 2006.2324

THE CITY OF LAKE FOREST
CHARTERED 1861

ILLINOIS DEPARTMENT OF TRANSPORTATION
BUREAU OF LOCAL ROADS AND STREETS

PROJECT:
OLD ELM ROAD OVER EAST SKOKIE DITCH
STA. 187+46 LAKE COUNTY
STRUCTURE NO. 049-6870

TITLE:
DRILLED SHAFT CAP LAYOUT

△					
△					
△					
△					
△					
REV. NO.	DATE	REVISION RECORD	MADE BY	CHECKED BY	

SCALE: N.T.S. DRAWN BY: IMG
DATE: JANUARY 2008 CHECKED BY: NSA

DATE: 2/2/08
FILENAME: P:\2006\2301-2400\2006.2324-NAnderson-Old Elm Design\MICROSTATION-FINAL\S-04.dgn