

F.A.U. RTE.	SECTION	COUNTY	TOTAL SHEETS	SHEET NO.
1248	99-00080-00-BR	LAKE	46	23
STA.	TO STA.			
FED. ROAD DIST. NO.	ILLINOIS	FED. AID PROJECT		
			Sheet S-11 of S-29 63020	

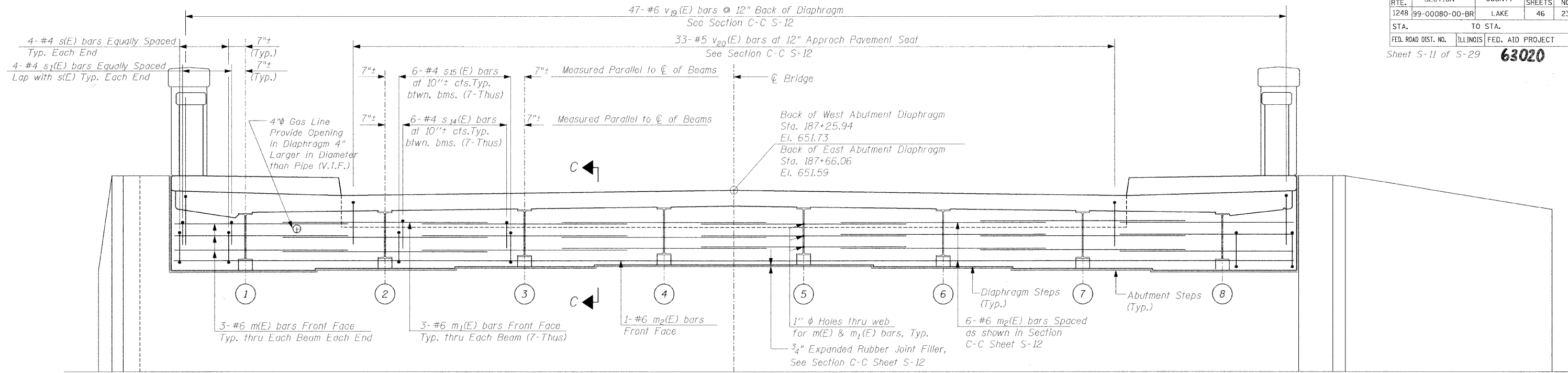

EAST ABUTMENT DIAPHRAGM ELEVATION
(WEST ABUTMENT SIMILAR, OPPOSITE HAND)

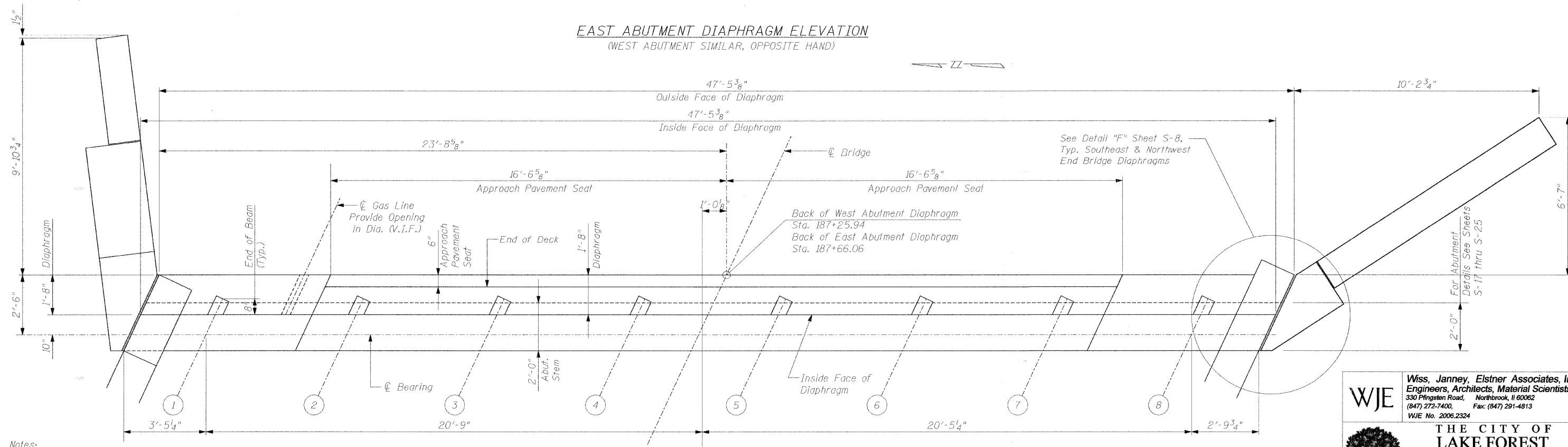

EAST ABUTMENT DIAPHRAGM PLAN
(WEST ABUTMENT SIMILAR, OPPOSITE HAND)

Notes:
 Reinforcement bars in diaphragm are billed with superstructure on sheet S-12.
 Concrete in diaphragm is included with Concrete Superstructure on sheet S-12.
 For details of bars s13(E) & s14(E) see sheet S-12.
 The s13(E) and s14(E) bars shall be placed parallel to the beams. Spacing for these bars shall be at right angles to the beams.
 For anchor bolt details see sheet S-15 & S-16.
 See Section C-C sheet S-12.

MIN. BAR LAP
 #6 bar = 2'-9"

REV. NO.	DATE	REVISION RECORD	MADE BY	CHECKED BY
△				
△				
△				
△				
△				

WJE **Wiss, Janney, Elstner Associates, Inc.**
 Engineers, Architects, Material Scientists
 330 Pfingsten Road, Northbrook, IL 60062
 (847) 272-7400, Fax: (847) 291-4813
 WJE No. 2006.2324

THE CITY OF LAKE FOREST
 CHARTERED 1861

ILLINOIS DEPARTMENT OF TRANSPORTATION
 BUREAU OF LOCAL ROADS AND STREETS

PROJECT:
OLD ELM ROAD OVER EAST SKOKIE DITCH
 STA. 187+46 LAKE COUNTY
 STRUCTURE NO. 049-6870

TITLE:
ABUTMENT DIAPHRAGM DETAILS

SCALE: N.T.S. DRAWN BY: IMG
 DATE: JANUARY 2008 CHECKED BY: NSA

DATE: 2/2/2008 FILENAME: P:\2006\2301-2400\2006.2324-NAnderson-Old Elm Design\MICROSTATION-FINAL(S-11).dgn