

F.A.P. RTE.	SECTION	COUNTY	TOTAL SHEETS	SHEET NO.
638	136T	HENRY	34	1
FED. ROAD DIST. NO.	ILLINOIS	CONTRACT NO. 64C57		

* 34
+ 1
35

P-92-100-06



LOCATION OF SECTION INDICATED THUS: - [black rectangle] -

PROJECT ENGINEER: BECKY MARRUFFO

SQUAD LEADER: JENNIFER LUBBS (815) 284-5958

FOR INDEX OF SHEETS, SEE SHEET NO. 2

STATE OF ILLINOIS
DEPARTMENT OF TRANSPORTATION
DIVISION OF HIGHWAYS

**PROPOSED
HIGHWAY PLANS**

FAP 638 (IL 82)
SECTION 136T
PROJECT ACF-0638(009)
HENRY COUNTY

C-92-122-07

IMPROVEMENT ENDS
STA 779+00.00

SECTION ENDS
STA 775+81.50

6' X 4' CULVERT
STA 775+56.50

SECTION BEGINS
STA 775+31.50

IMPROVEMENT BEGINS
STA 773+00

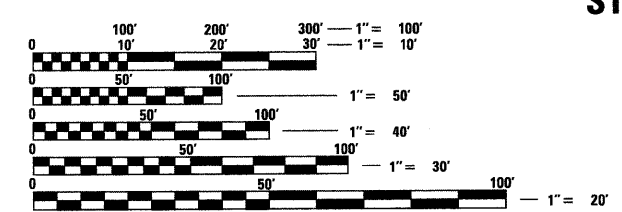
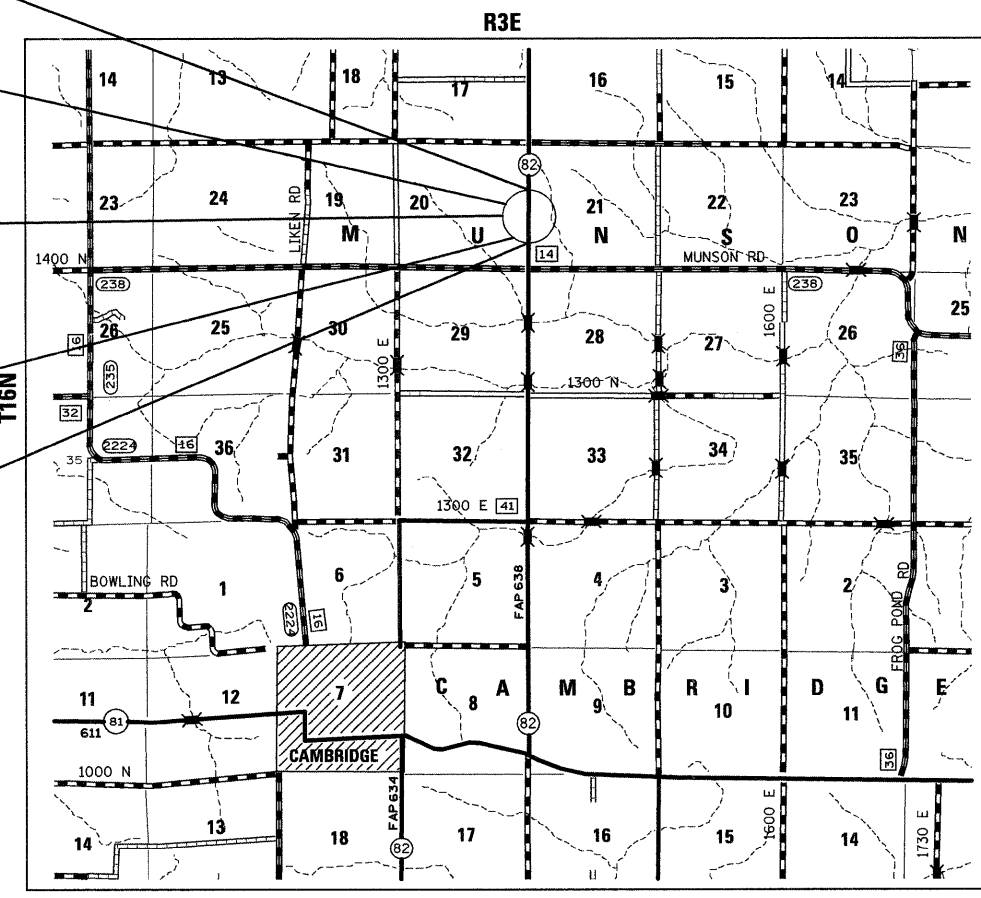

FULL SIZE PLANS HAVE BEEN PREPARED USING STANDARD ENGINEERING SCALES. REDUCED SIZED PLANS WILL NOT CONFORM TO STANDARD SCALES. IN MAKING MEASUREMENTS ON REDUCED PLANS, THE ABOVE SCALES MAY BE USED.

J.U.L.I.E.
JOINT UTILITY LOCATION INFORMATION FOR EXCAVATION
1-800-892-0123
OR 811

MUNSON TOWNSHIP 20,21
CONTRACT NO. 64C57

GROSS LENGTH OF PROJECT = 50 LIN. FT. = .01 MI.
NET LENGTH = 50 LIN. FT. = .01 MI.



EXISTING 6' X 4' CULVERT SN# 037-1080
PROPOSED 6' X 4' CULVERT SN# 037-1180

STATE OF ILLINOIS
DEPARTMENT OF TRANSPORTATION
DIVISION OF HIGHWAYS

SUBMITTED January 31, 2008

Steve F. Ryan
DEPUTY DIRECTOR OF HIGHWAYS, REGION ENGINEER

March 21, 2008
Eric E. Harshbarger
Interim ENGINEER OF DESIGN AND ENVIRONMENT

March 21, 2008
Christina M. Reed
DIRECTOR OF HIGHWAYS, CHIEF ENGINEER

PRINTED BY THE AUTHORITY
OF THE STATE OF ILLINOIS