

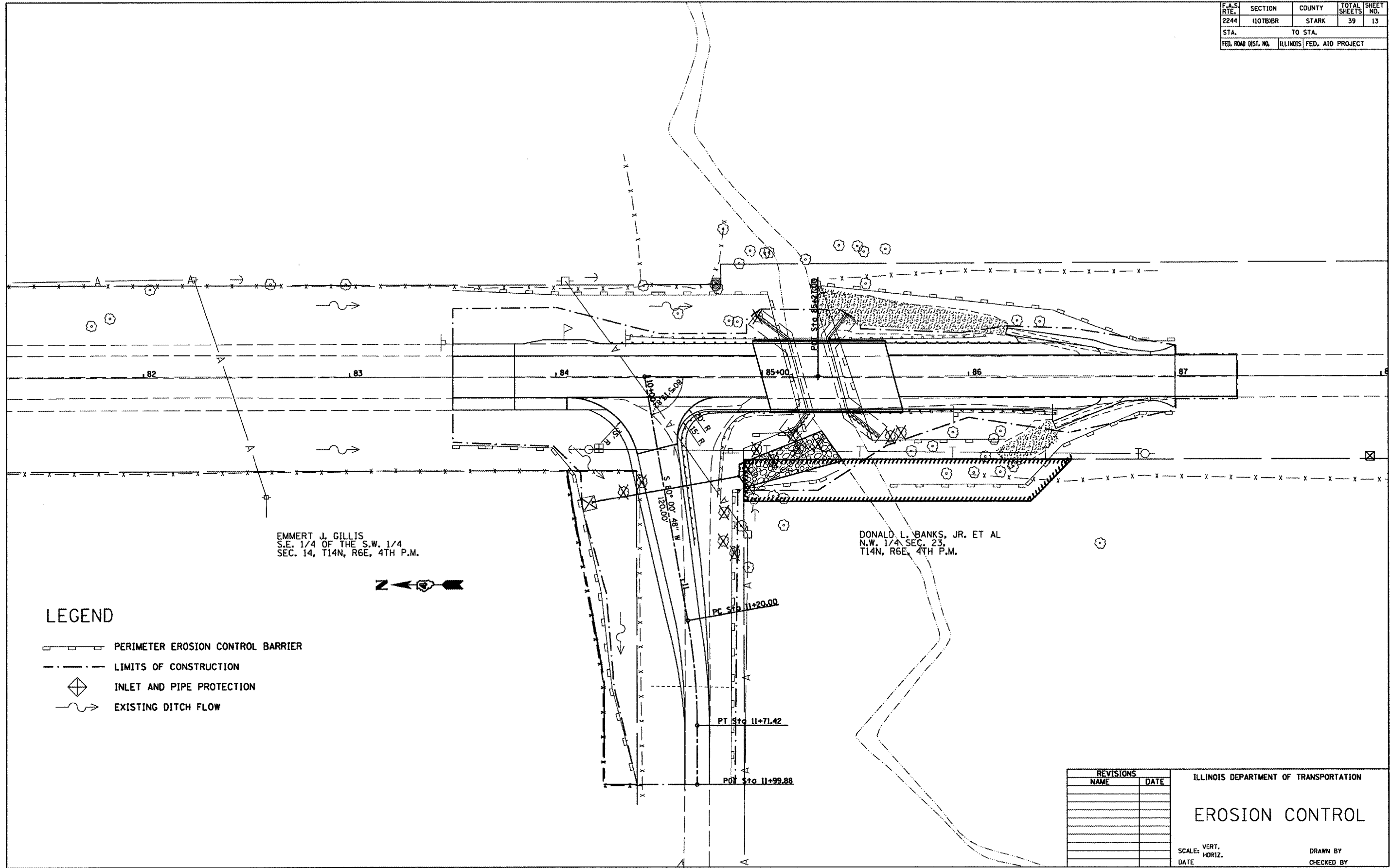

CONTRACT NO. 68115			
F.A.S. RTE.	SECTION	COUNTY	TOTAL SHEET NO.
2244	(107B)BR	STARK	39 13
STA.	TO STA.		
FED. ROAD DIST. NO.	ILLINOIS	FED. AID PROJECT	

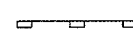
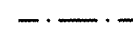

**LEGEND**

-  PERIMETER EROSION CONTROL BARRIER
-  LIMITS OF CONSTRUCTION
-  INLET AND PIPE PROTECTION
-  EXISTING DITCH FLOW

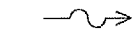
PLOT TIME : 3/29/08 10:58 AM  
 FILE NAME : D:\WORKSPACE\88\Work Draw 510.dwg\Erosion.dgn  
 PLOT SCALE : 48,00000 / IN.  
 USER NAME : ent

REVISIONS	
NAME	DATE

ILLINOIS DEPARTMENT OF TRANSPORTATION

**EROSION CONTROL**

SCALE: VERT. \_\_\_\_\_  
 HORIZ. \_\_\_\_\_

DATE \_\_\_\_\_

DRAWN BY \_\_\_\_\_  
 CHECKED BY \_\_\_\_\_

Prepared by: Foth Infrastructure & Environment, LLC

FINAL SUBMITTAL 2/1/08 FVD # 5589.80