

F.A.U. NO.	SECTION	COUNTY	TOTAL SHEETS	SHEET NO.
7982	*	SANGAMON	114	34
STA.	TO STA.			
FED. ROAD DIST. NO.		ILLINOIS	FED. AID PROJECT	
* 05-00447-01-PV		CITY OF SPRINGFIELD		

LEGEND

- CONCRETE SIDEWALK REMOVAL
 - CURB & GUTTER REMOVAL
 - PAVEMENT REMOVAL
 - BRICK SIDEWALK REMOVAL
 - BITUMINOUS REMOVAL
 - DRIVEWAY PAVEMENT REMOVAL
 - BITUMINOUS MILLING
 - TREE REMOVAL
 - TRAFFIC SIGNAL POST REMOVAL
 - SEWER REMOVAL
 - DRAINAGE STRUCTURE REMOVAL
- * NOTE: THESE ITEMS TO BE PAID FOR AS SPECIAL EXCAVATION (CU. YD.)

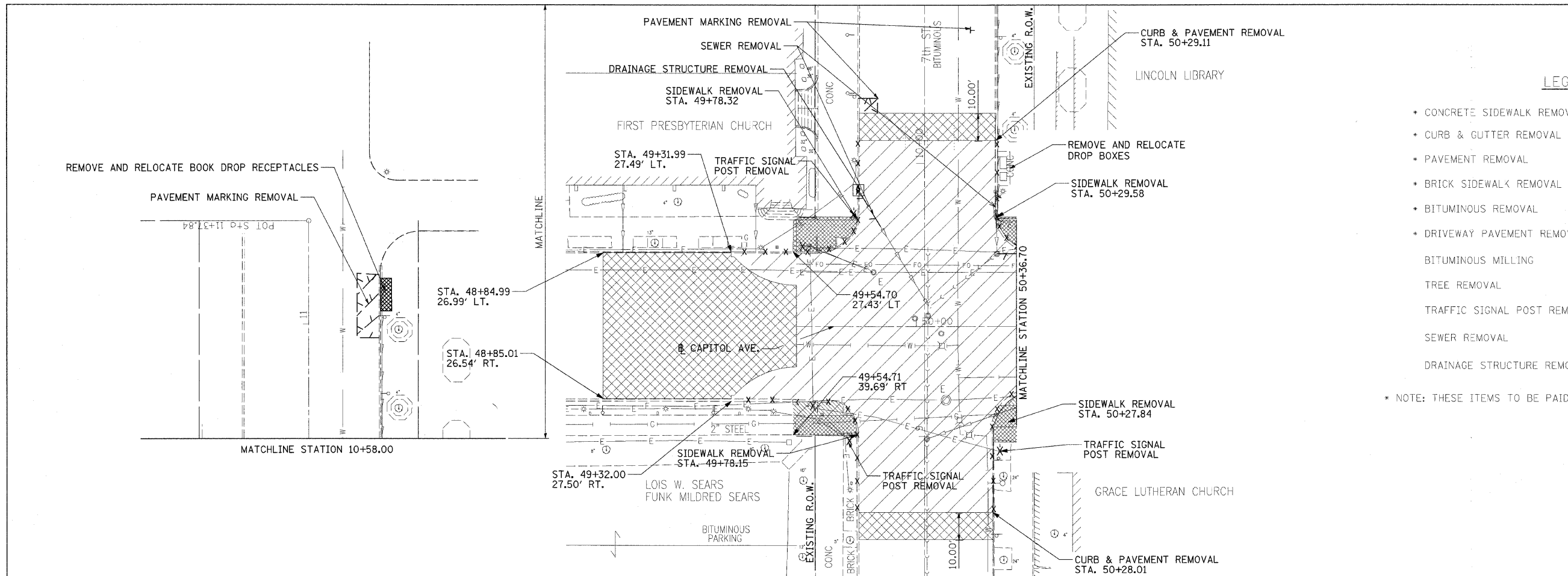
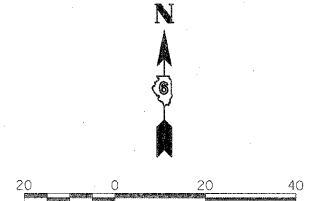

NOTE - CONTRACTOR SHALL TAKE CARE WHEN REMOVING SIDEWALK IN FRONT OF LIBRARY IN ORDER TO MAKE CLEAN SAW CUTS ADJACENT TO EXISTING SIDEWALK AND NOT TO OVERTCUT AND DAMAGE PARKING GARAGE STRUCTURE. ANY DAMAGE TO ADJACENT SIDEWALK SHALL BE REPLACED BY THE CONTRACTOR WITH MATCHING SURFACE COLOR TREATMENT AND PATTERN SIDEWALK AND ANY DAMAGE TO PARKING GARAGE STRUCTURE SHALL BE FIXED, AT NO ADDITIONAL COST TO THE DEPARTMENT.

LEGEND

- CONCRETE SIDEWALK REMOVAL
 - CURB & GUTTER REMOVAL
 - PAVEMENT REMOVAL
 - BRICK SIDEWALK REMOVAL
 - BITUMINOUS REMOVAL
 - DRIVEWAY PAVEMENT REMOVAL
 - BITUMINOUS MILLING
 - TREE REMOVAL
 - TRAFFIC SIGNAL POST REMOVAL
 - SEWER REMOVAL
 - DRAINAGE STRUCTURE REMOVAL
- * NOTE: THESE ITEMS TO BE PAID FOR AS SPECIAL EXCAVATION (CU. YD.)

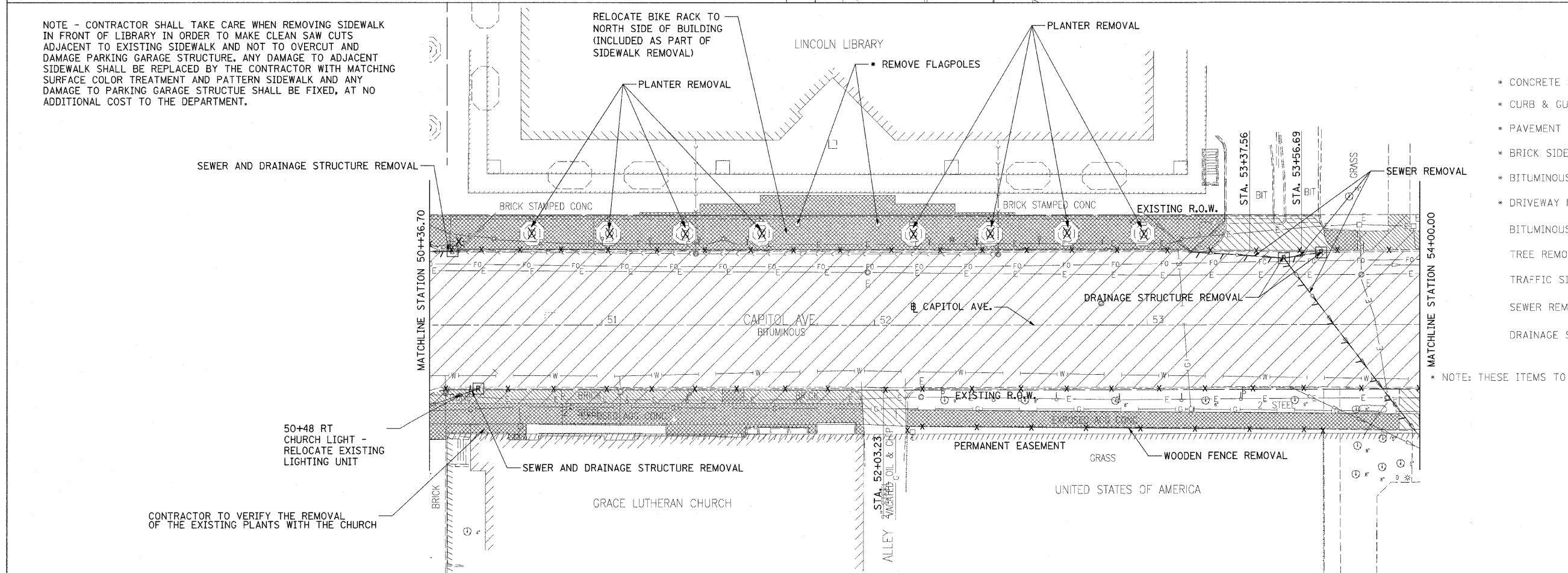
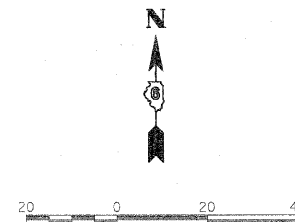

CONTRACTOR TO VERIFY THE REMOVAL OF THE EXISTING PLANTS WITH THE CHURCH



LAYOUT J.L.A. 01/02/05
 DRAIN J.L.A. 01/02/05
 REVIEWED M.H. 09/19/07
 PLOT DATE = 01/02/2008 10:22 AM
 FILE NAME = H:\2105\922041\Access\road\microstation\sheet\action.L17\h-11th\ver-305.REM.7-B.dgn
 PLOT SCALE = 20:0000 / IN.
 USER NAME = Pop00536