

F.A.U. RTE.	SECTION	COUNTY	TOTAL SHEETS	SHEET NO.
7982	*	SANGAMON	114	67
STA.		TO STA.		
FED. ROAD DIST. NO.		ILLINOIS FED. AID PROJECT		
05-00447-01-PV		CITY OF SPRINGFIELD		

PLAN ENLARGEMENT PAVEMENT KEYED NOTES

- 1 TYPE 1 PCC PAVEMENT - ROADWAY PAVEMENT
- 2 TYPE 2 PCC PAVEMENT - PRIMARY SIDEWALK PAVEMENT, BROOM FINISH
- 3 TYPE 3 PCC PAVEMENT - SIDEWALK BAND, SMOOTH TROWEL FINISH
- 4 TYPE 1-PCC PAVER AUTUMN BLEND 90° HERRINGBONE PATTERN
- 5 TYPE 2-PCC PAVER PRAIRIE BLEND 90° HERRINGBONE PATTERN
- 6 TYPE 3-PCC PAVER BUFF RUNNING BOND PATTERN
- 7 TYPE 4-PCC PAVER NATURAL BASKETWEAVE PATTERN
- 8 TYPE 5-PCC PAVER CHARCOAL SOLDIER COURSE PATTERN
- 9 DETECTABLE WARNING PAVER
- 10 TYPE 5-PCC PAVER CHARCOAL 90° HERRINGBONE PATTERN
- 11 TYPE 5-PCC PAVER CHARCOAL BASKETWEAVE PATTERN 2 COURSE WIDTH
- 12 TYPE 6-PCC PAVER GOLD BOND PATTERN
- 13 TYPE 5-PCC PAVER CHARCOAL BOND PATTERN

- GENERAL NOTES:**
- A DOUBLE RUNNING BOND TO BE USED ADJACENT TO ALL CONCRETE PAVEMENT. PAVERS TO BE CUT INSIDE THIS DOUBLE RUNNING BOND BAND. NO PAVERS TO BE CUT IN THE RUNNING BOND BAND ADJACENT TO CONCRETE.
 - ALL PATTERNS ARE SHOWN FOR DIFFERENTIATING PAVER TYPES. PATTERNS NOT REPRESENTATIVE OF ACTUAL PAVER LAYOUT.

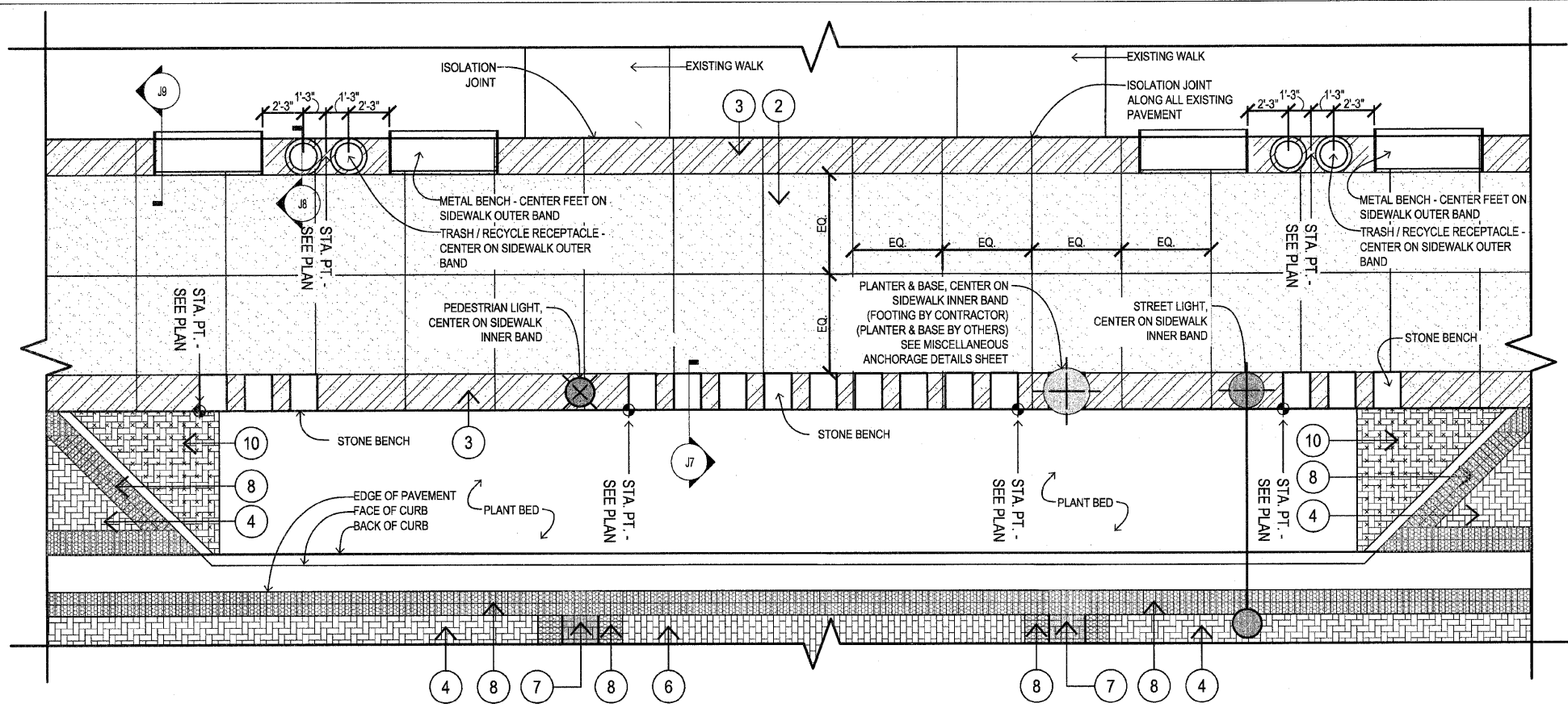

F2 PLAN: ROAD & SIDEWALK PAVEMENT AND STREETScape ELEMENTS @ 8TH ST. ROW - NORTH SIDE
N.T.S. / DO NOT SCALE

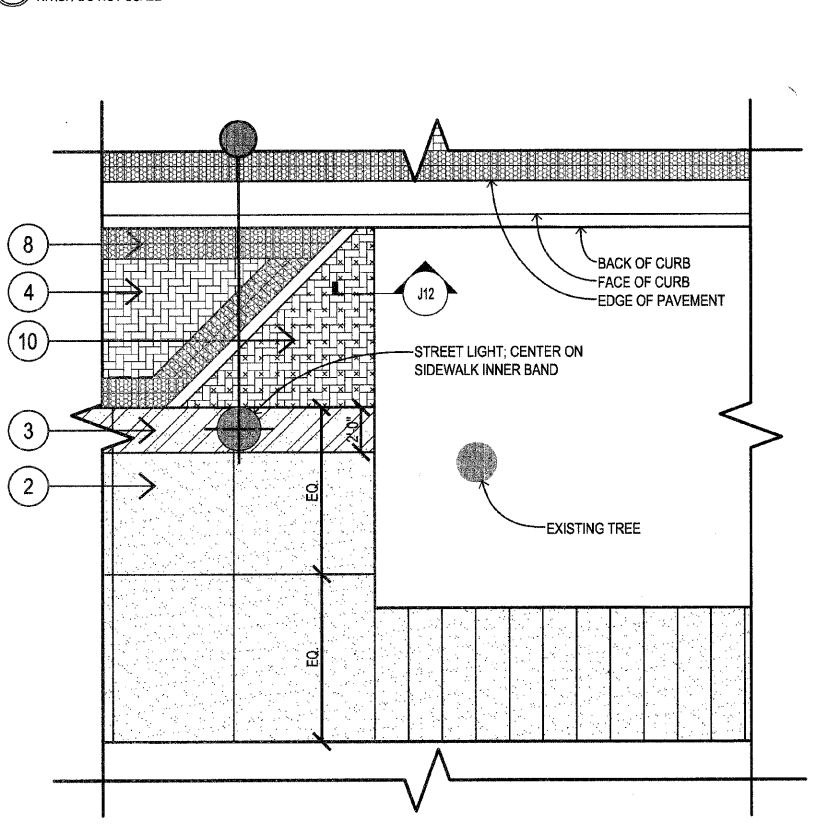

F1 PLAN: TRANSITION TO 6' SIDEWALK @ NPS PROPERTY
N.T.S. / DO NOT SCALE

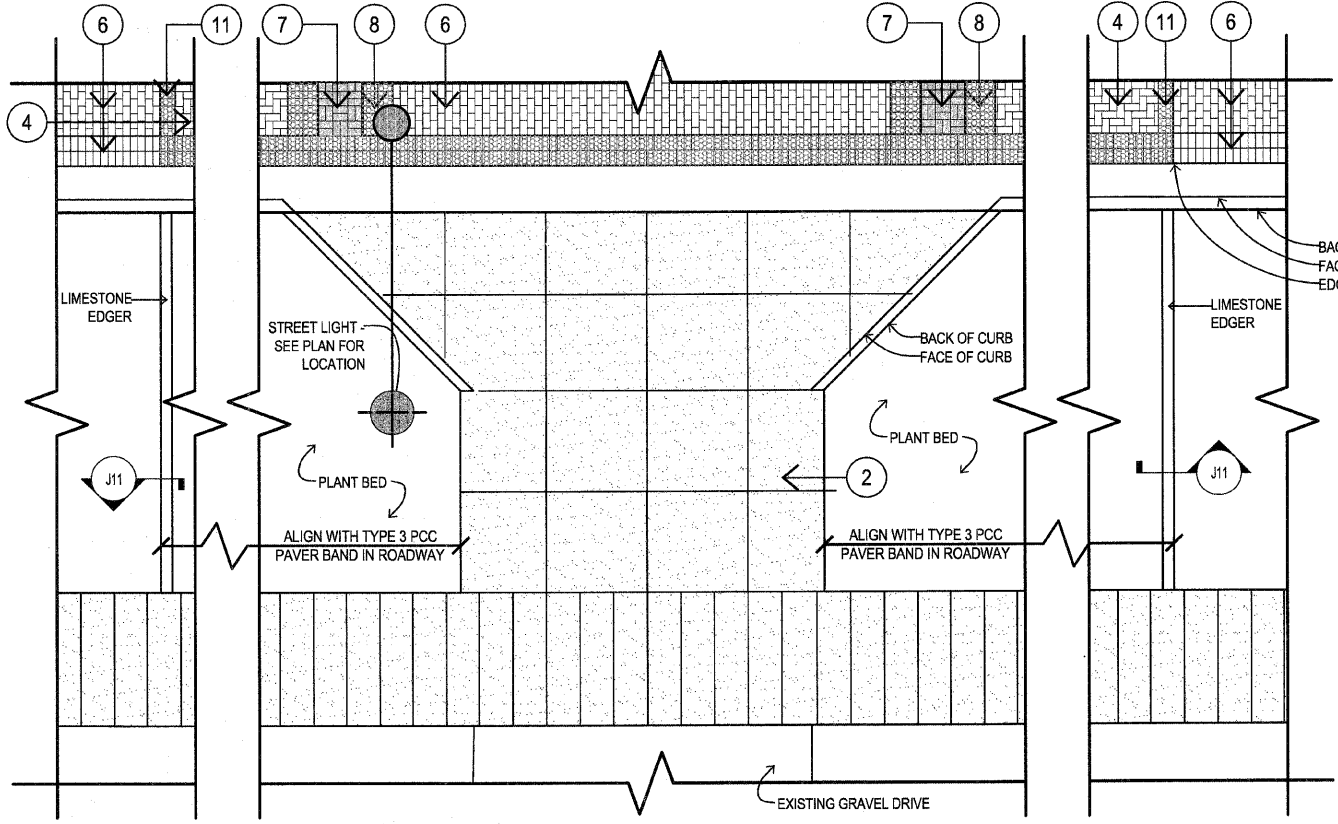

C F3 PLAN: TRANSITION TO 6' SIDEWALK @ NPS PROPERTY
N.T.S. / DO NOT SCALE

REVISIONS	
NAME	DATE

ILLINOIS DEPARTMENT OF TRANSPORTATION
STREETScape IMPROVEMENT
 PLAN ENLARGEMENTS
 FAU RTE 7982 CAPITOL AVE
 SEC NO. 05-00447-01-PV
 SANGAMON COUNTY, ILLINOIS

SCALE: VERT. _____
 HORIZ. _____
 DATE _____

DRAWN BY JM
 CHECKED BY _____