

F.A. RTE.	SECTION	COUNTY	TOTAL SHEETS	SHEET NO.
7982	05-00447-01-PV	SANGAMON	114	97
STA. 51+25.00		TO STA. 52+00.00		
FED. ROAD DIST. NO.		ILLINOIS FED. AID PROJECT		

FINAL SURVEY	BY	DATE
SURVEYED		
PLOTTED		
NOTE BOOK		
AREAS CHECKED		
NO.		

ORIGINAL SURVEY	BY	DATE
SURVEYED		
PLOTTED		
NOTE BOOK		
AREAS CHECKED		
NO.		

PLOT DATE = 06/18/2009 10:05 AM
 FILE NAME = \\s22\pub\202\20416\ADD\Road\WCS\ppp\ppp.dwg
 PLOT SCALE = 18.4801 / IN.
 USER NAME = Ppp08336

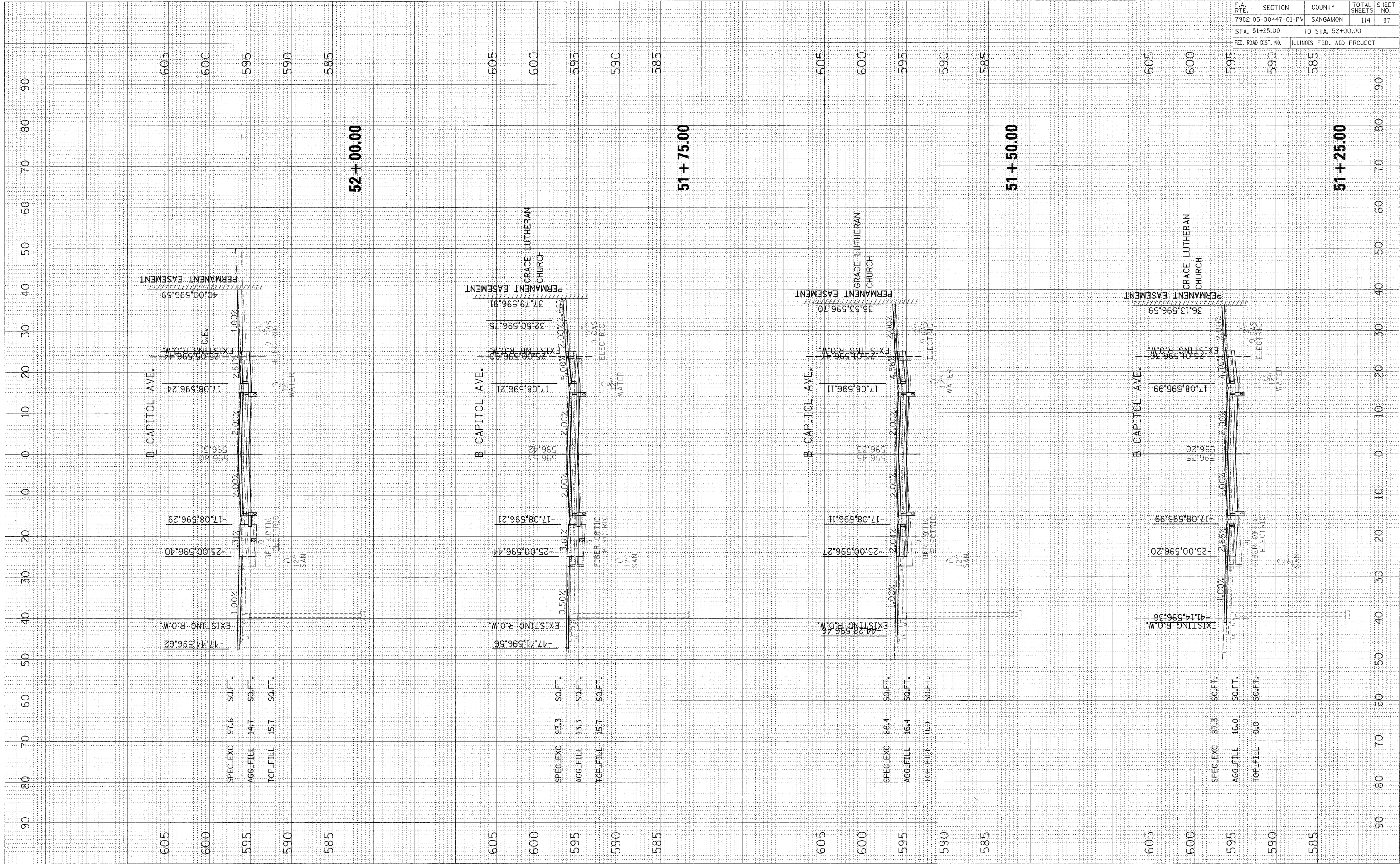

STATION: 52 + 00.00

B CAPITOL AVE.

PERMANENT EASEMENT

40.00,596.59

EXISTING N.O.W. 25.05,596.44

17.08,596.24

2.51%

1.00%

2.00%

2.00%

2.00%

2.00%

1.31%

1.00%

-17.08,596.29

-25.00,596.40

EXISTING R.O.W. -47.44,596.62

SPEC. EXC	97.6	50.FT.
AGG. FILL	14.7	50.FT.
TOP. FILL	15.7	50.FT.

UTILITIES: 10" WATER, 12" SAN, 2" GAS, 2" ELECTRIC, FIBER OPTIC

STATION: 51 + 75.00

B CAPITOL AVE.

PERMANENT EASEMENT

37.79,596.91

EXISTING N.O.W. 25.08,596.60

17.08,596.21

5.00%

2.00%

2.00%

2.00%

2.00%

3.01%

0.50%

-17.08,596.21

-25.00,596.44

EXISTING R.O.W. -47.41,596.56

SPEC. EXC	93.3	50.FT.
AGG. FILL	13.3	50.FT.
TOP. FILL	15.7	50.FT.

UTILITIES: 10" WATER, 12" SAN, 2" GAS, 2" ELECTRIC, FIBER OPTIC

GRACE LUTHERAN CHURCH

STATION: 51 + 50.00

B CAPITOL AVE.

PERMANENT EASEMENT

36.53,596.70

EXISTING N.O.W. 25.04,596.47

17.08,596.11

4.56%

2.00%

2.00%

2.00%

2.00%

2.04%

1.00%

-17.08,596.11

-25.00,596.27

EXISTING R.O.W. -44.28,596.46

SPEC. EXC	88.4	50.FT.
AGG. FILL	16.4	50.FT.
TOP. FILL	0.0	50.FT.

UTILITIES: 10" WATER, 12" SAN, 2" GAS, 2" ELECTRIC, FIBER OPTIC

GRACE LUTHERAN CHURCH

STATION: 51 + 25.00

B CAPITOL AVE.

PERMANENT EASEMENT

36.13,596.59

EXISTING N.O.W. 25.04,596.26

17.08,595.99

4.16%

2.00%

2.00%

2.00%

2.65%

1.00%

-17.08,595.99

-25.00,596.20

EXISTING R.O.W. -41.14,596.36

SPEC. EXC	87.3	50.FT.
AGG. FILL	16.0	50.FT.
TOP. FILL	0.0	50.FT.

UTILITIES: 10" WATER, 12" SAN, 2" GAS, 2" ELECTRIC, FIBER OPTIC

GRACE LUTHERAN CHURCH