







F.A. RTE.	SECTION	COUNTY	TOTAL SHEETS	SHEET NO.
7982	05-00447-01-PV	SANGAMON	114	104
STA. 56+50.00		TO STA. 57+12.00		
FED. ROAD DIST. NO.		ILLINOIS FED. AID PROJECT		

FINAL SURVEY	BY	DATE
NOTE BOOK		
AREAS CHECKED		

ORIGINAL SURVEY	BY	DATE
PLANNED SURVEY		
AREAS CHECKED		

PLOT DATE = 01/01/2009 11:05 AM  
 FILE NAME = 1112\_0102231614.CADD\Road\W\1112009\112009\_Sheet\_2.dgn  
 PLOT SCALE = 10.001 / IN.  
 USER NAME = Pp020636

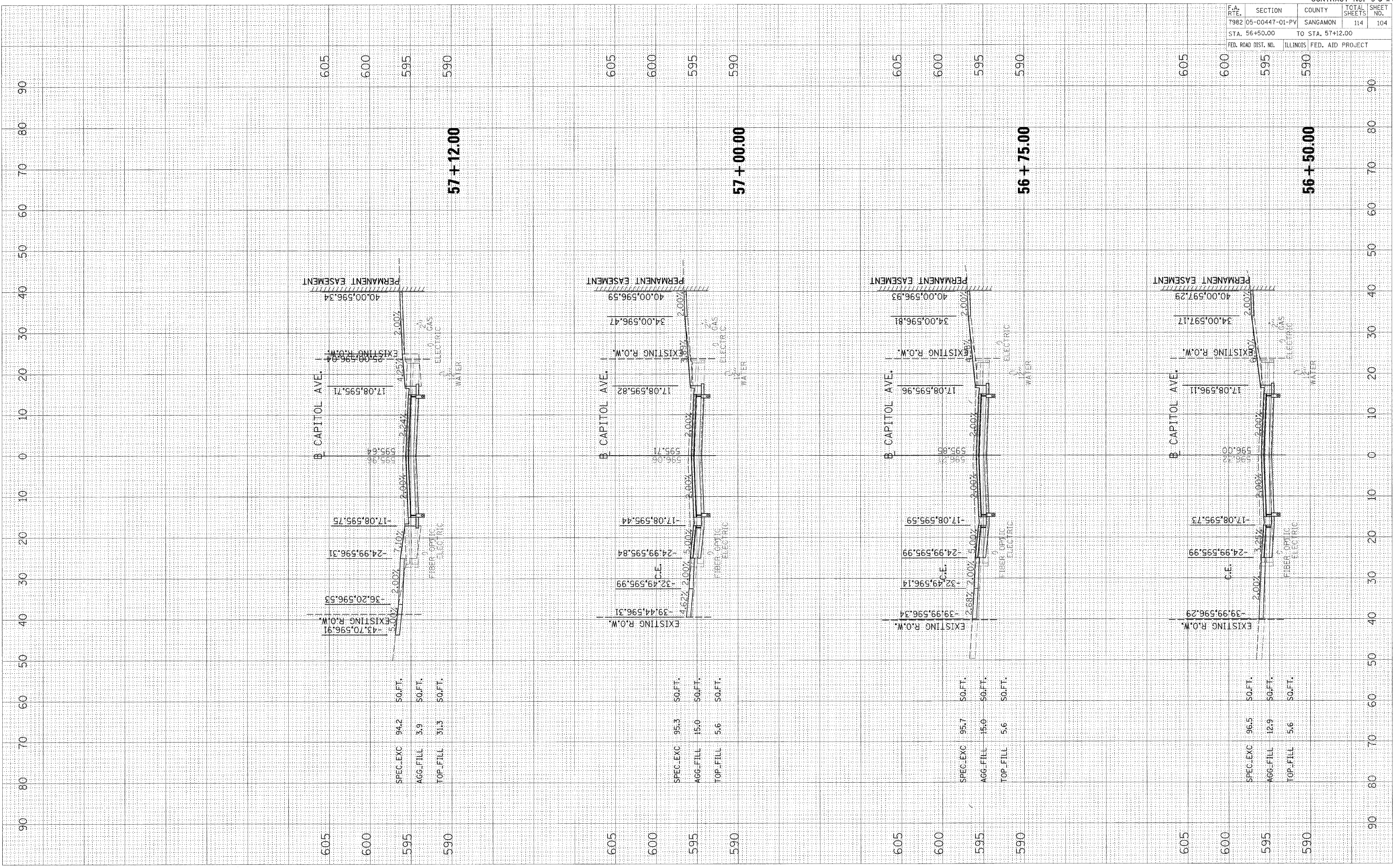





F.A. RTE.	SECTION	COUNTY	TOTAL SHEETS	SHEET NO.
7982	05-00447-01-PV	SANGAMON	114	107
STA. 59+75.00		TO STA. 60+25.00		
FED. ROAD DIST. NO.		ILLINOIS FED. AID PROJECT		

FINAL	SURVEYED	DATE
SUPPLY	PLOTTED	
NOTE BOOK	DATE	
NO.	AREAS CHECKED	

ORIGINAL	SURVEYED	DATE
SUPPLY	PLOTTED	
NOTE BOOK	DATE	
NO.	AREAS CHECKED	

PLOT DATE = 01/10/2008 11:05 AM  
 FILE NAME = I:\12\05\02\2010\CADD\Road\Highway\Sheet-7.dgn  
 PLOT SCALE = 1/8" = 1'-0"  
 USER NAME = P020836

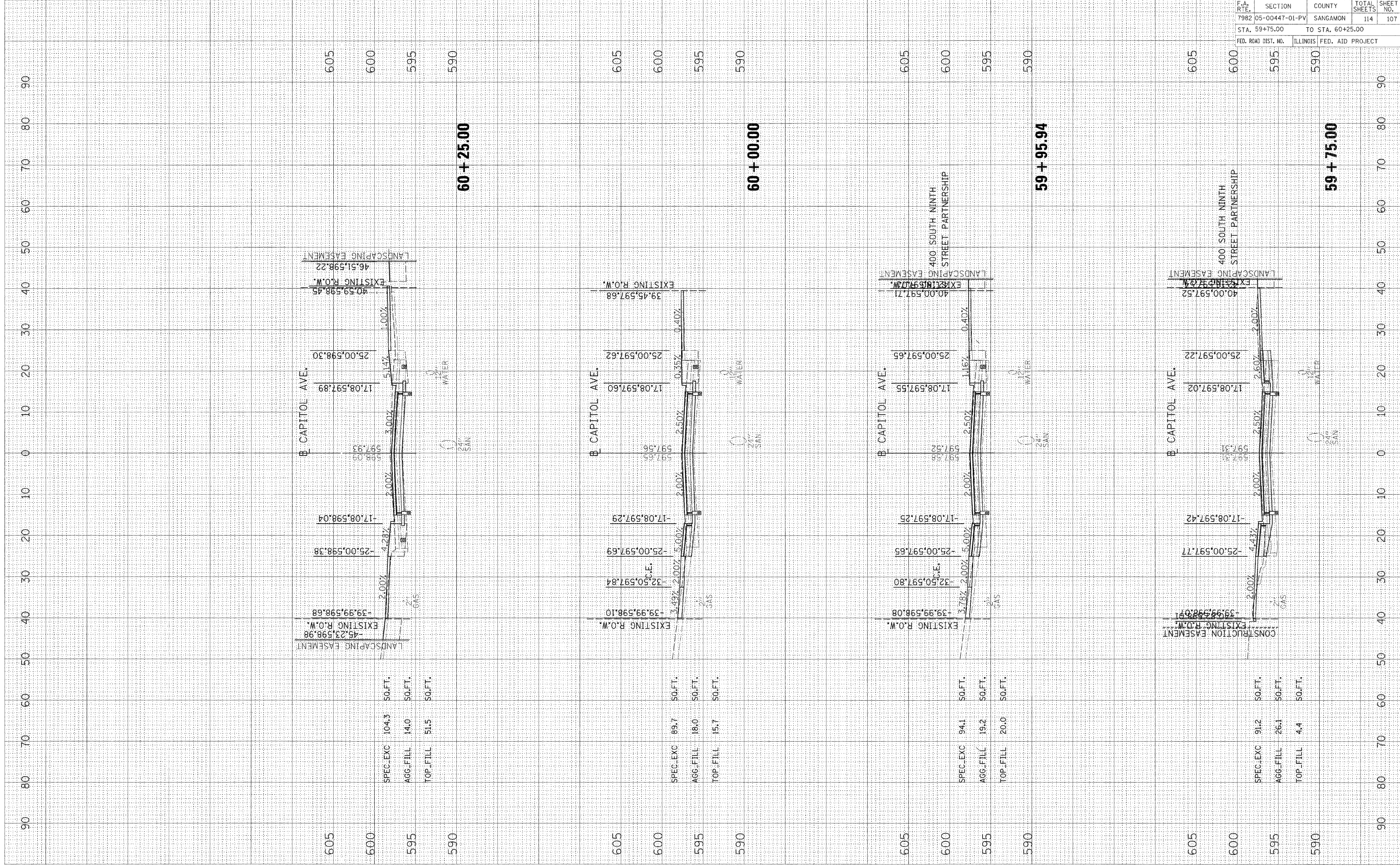

F.A. RTE.	SECTION	COUNTY	TOTAL SHEETS	SHEET NO.
7982	05-00447-01-PV	SANGAMON	114	108
STA. 60+40.13		TO STA. 61+00.00		
FED. ROAD DIST. NO.		ILLINOIS FED. AID PROJECT		

FINAL SURVEY	DATE
NO.	
BY	
NO.	
AREAS CHECKED	
NO.	

ORIGINAL SURVEY	DATE
NO.	
BY	
NO.	
AREAS CHECKED	
NO.	

PLOT DATE = 01/09/2008 11:08 AM  
 FILE NAME = S:\2007\2007-05-04\05-04-001\Road\MicroStation\112007\_2sheet\_2-1.dgn  
 PLOT SCALE = 1/8"=1'-0"  
 USER NAME = Pop200836

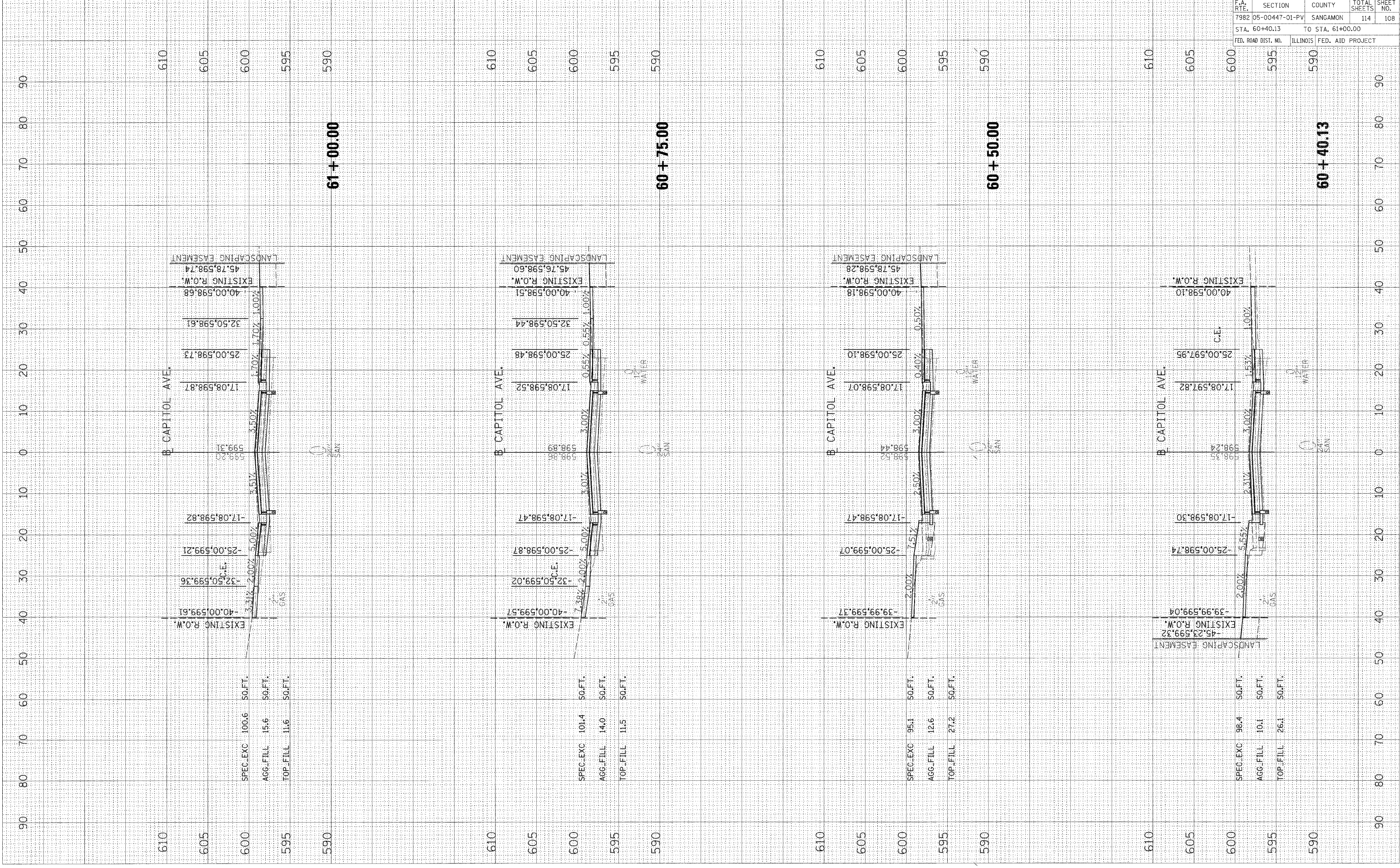



F.A. RTE.	SECTION	COUNTY	TOTAL SHEETS	SHEET NO.
7982	05-00447-01-PV	SANGAMON	114	109
STA. 61+25.00		TO STA. 61+97.35		
FED. ROAD DIST. NO.		ILLINOIS FED. AID PROJECT		

FINAL SURVEY	DATE
PLOTTED	
NOTE BOOK	
AREAS CHECKED	

ORIGINAL SURVEY	DATE
PLOTTED	
NOTE BOOK	
AREAS CHECKED	

PLOT DATE = 01/10/2008 11:06 AM  
 FILE NAME = I:\2008\05\20080510\05-00447-01-PV\05-00447-01-PV-112007-2008-7-1.dgn  
 PLOT SCALE = 1/8"=1'-0" / IN.  
 USER NAME = P020836

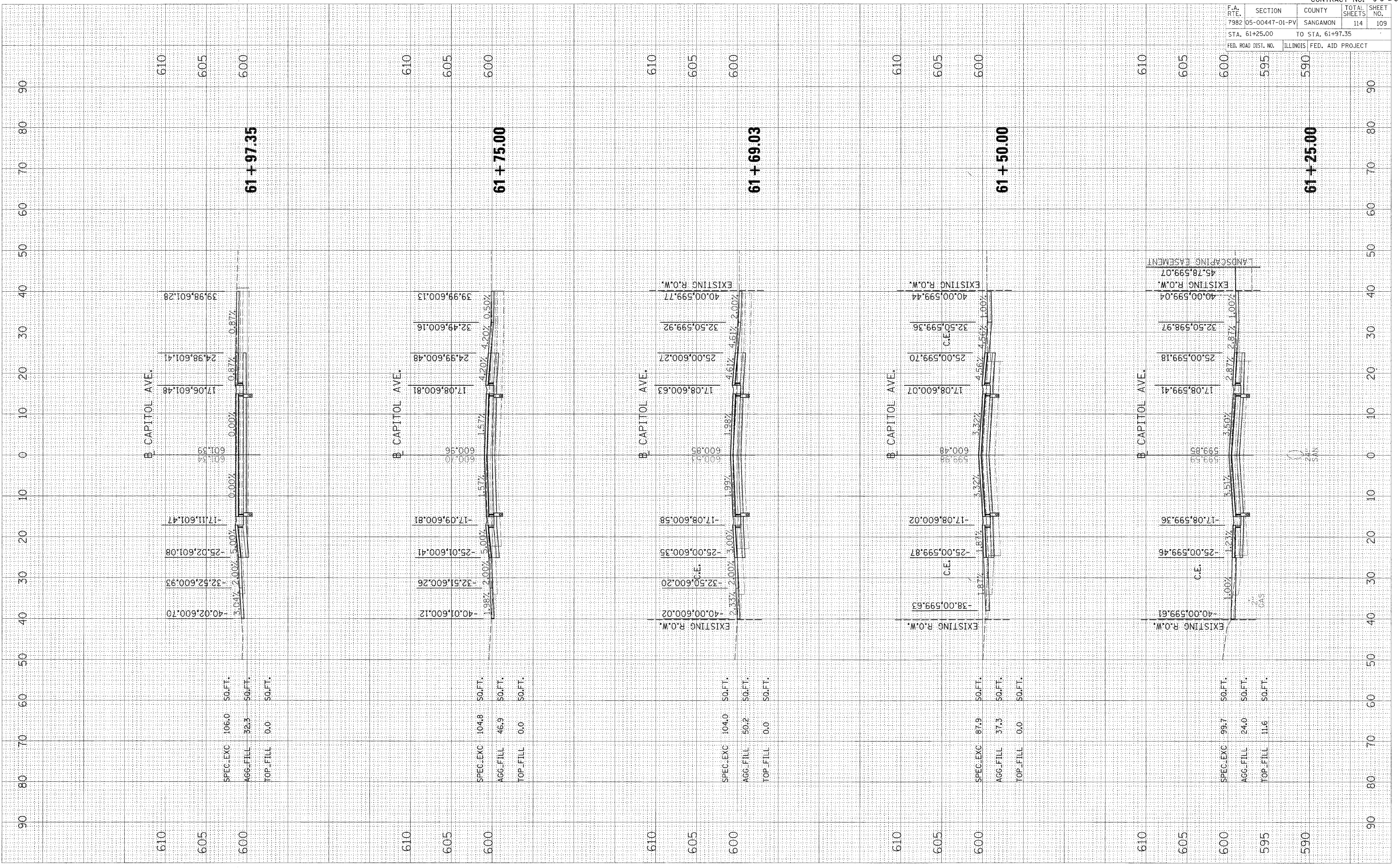

⊕ CAPITOL AVE.

⊕ CAPITOL AVE.

⊕ CAPITOL AVE.

⊕ CAPITOL AVE.

⊕ CAPITOL AVE.

LANDSCAPING EASEMENT  
45.78,599.07

2" GAS  
2" SAN

**61 + 97.35**

**61 + 75.00**

**61 + 69.03**

**61 + 50.00**

**61 + 25.00**

SPEC-EXC 106.0 SO.FT.  
 AGG-FILL 32.3 SO.FT.  
 TOP-FILL 0.0 SO.FT.

SPEC-EXC 104.8 SO.FT.  
 AGG-FILL 46.9 SO.FT.  
 TOP-FILL 0.0 SO.FT.

SPEC-EXC 104.0 SO.FT.  
 AGG-FILL 50.2 SO.FT.  
 TOP-FILL 0.0 SO.FT.

SPEC-EXC 87.9 SO.FT.  
 AGG-FILL 37.3 SO.FT.  
 TOP-FILL 0.0 SO.FT.

SPEC-EXC 99.7 SO.FT.  
 AGG-FILL 24.0 SO.FT.  
 TOP-FILL 11.6 SO.FT.

F.A. RTE.	SECTION	COUNTY	TOTAL SHEETS	SHEET NO.
7982	05-00447-01-PV	SANGAMON	114	110
STA. 62+06.26		TO STA. 62+75.00		
FED. ROAD DIST. NO.	ILLINOIS FED. AID PROJECT			

PLOT DATE = 01/11/2008 11:06 AM  
 FILE NAME = C:\Users\cadd\Road\MapInfo\MapInfo\Projects\112007\Sheet\_7.dgn  
 PLOT SCALE = 10.000 / IN.  
 USER NAME = Psp0836

ORIGINAL SURVEYED PLOTTED DATE  
 SURVEYED PLOTTED DATE  
 BY: \_\_\_\_\_  
 DATE: \_\_\_\_\_  
 NO. \_\_\_\_\_  
 AREAS CHECKED: \_\_\_\_\_

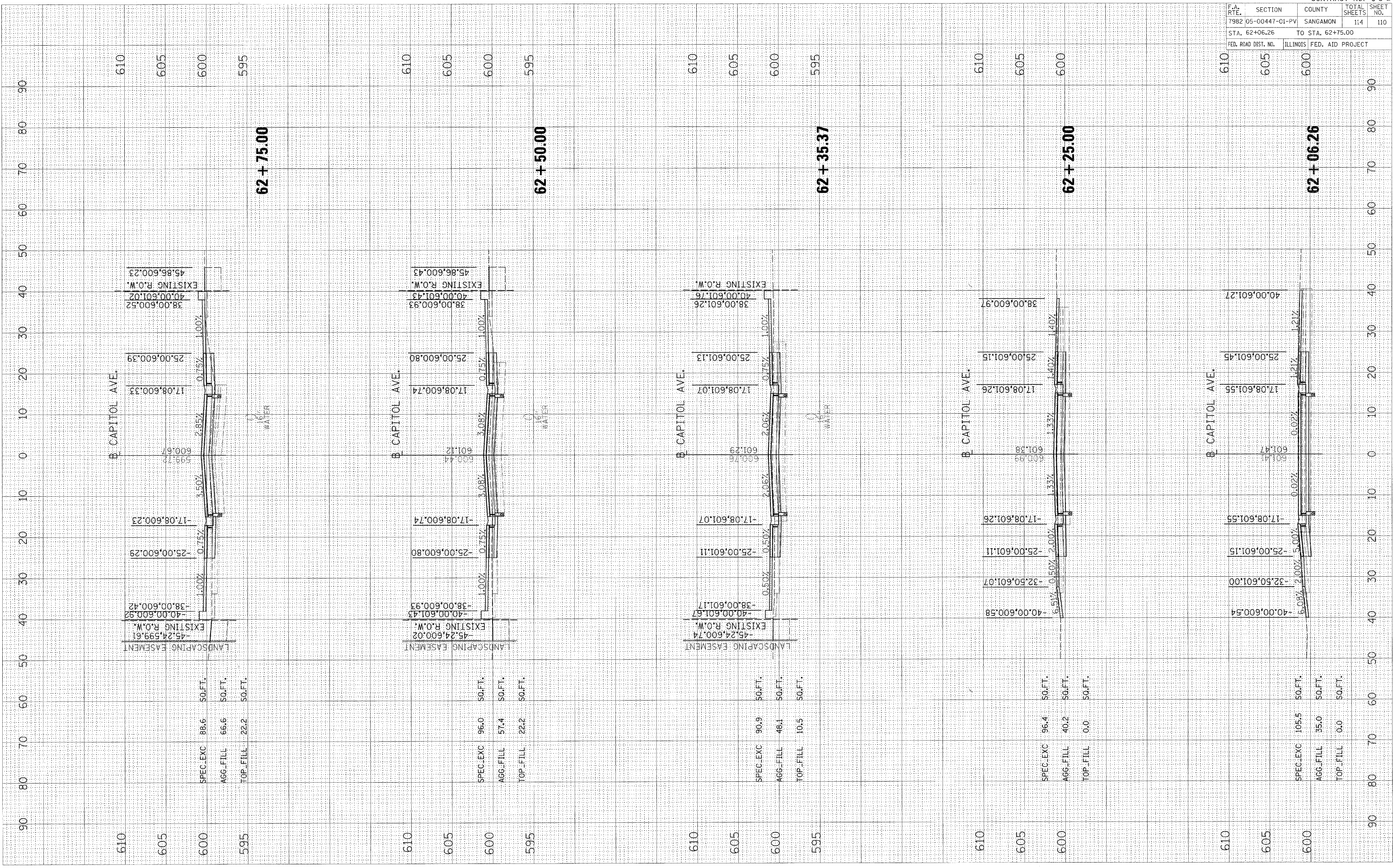

ORIGINAL SURVEYED PLOTTED DATE  
 SURVEYED PLOTTED DATE  
 BY: \_\_\_\_\_  
 DATE: \_\_\_\_\_  
 NO. \_\_\_\_\_  
 AREAS CHECKED: \_\_\_\_\_

ORIGINAL SURVEYED PLOTTED DATE  
 SURVEYED PLOTTED DATE  
 BY: \_\_\_\_\_  
 DATE: \_\_\_\_\_  
 NO. \_\_\_\_\_  
 AREAS CHECKED: \_\_\_\_\_

F.A. RTE.	SECTION	COUNTY	TOTAL SHEETS	SHEET NO.
7982	05-00447-01-PV	SANGAMON	114	111
STA. 63+00.00		TO STA. 63+50.00		
FED. ROAD DIST. NO.	ILLINOIS FED. AID PROJECT			

DATE	BY

DATE	BY

PLOT DATE = 01/19/2009 10:06 AM  
 FILE NAME = P:\02\7982\05-00447-01-PV\Drawings\05-00447-01-PV-111.dgn  
 PLOT SCALE = 1/8"=1'-0" IN.  
 USER NAME = P:\02\7982\05-00447-01-PV\Drawings\05-00447-01-PV-111.dgn

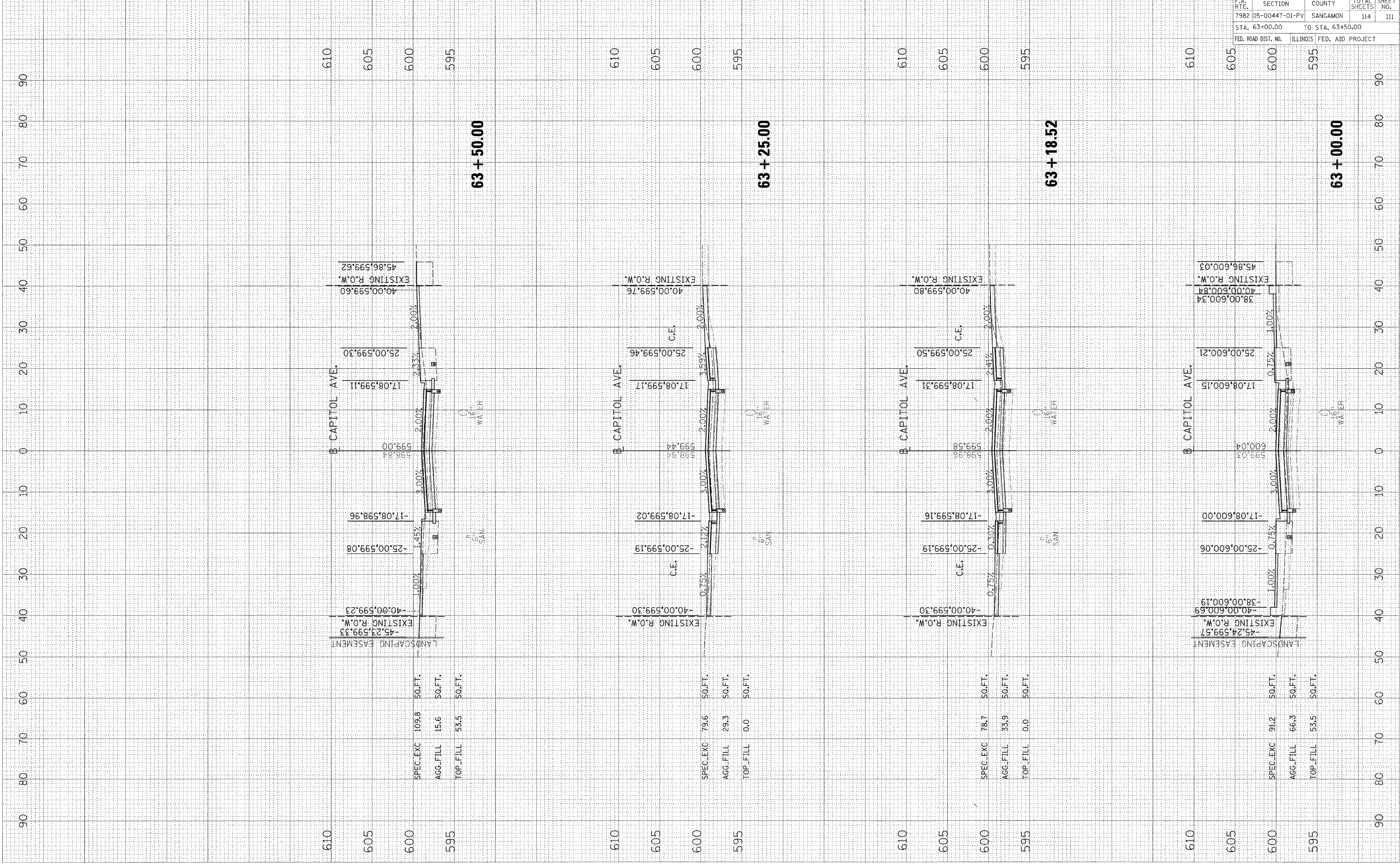

**63 + 50.00**

**63 + 25.00**

**63 + 18.52**

**63 + 00.00**

F.A. RTE.	SECTION	COUNTY	TOTAL SHEETS	SHEET NO.
7982	05-00447-01-PV	SANGAMON	114	112
STA. 63+75.00		TO STA. 64+43.28		
FED. ROAD DIST. NO.		ILLINOIS FED. AID PROJECT		

PLOT DATE = 01/10/2008 11:05 AM  
 FILE NAME = I:\12-05-07\222016\CADD\Road\Highway\93450\93450-05-00447-01-PV.dgn  
 PLOT SCALE = 1/8"=1'-0" IN.  
 USER NAME = P000036

ORIGINAL SURVEY PLOTTED AREAS CHECKED  
 SURVEYED PLOTTED AREAS CHECKED  
 BY DATE  
 NO.

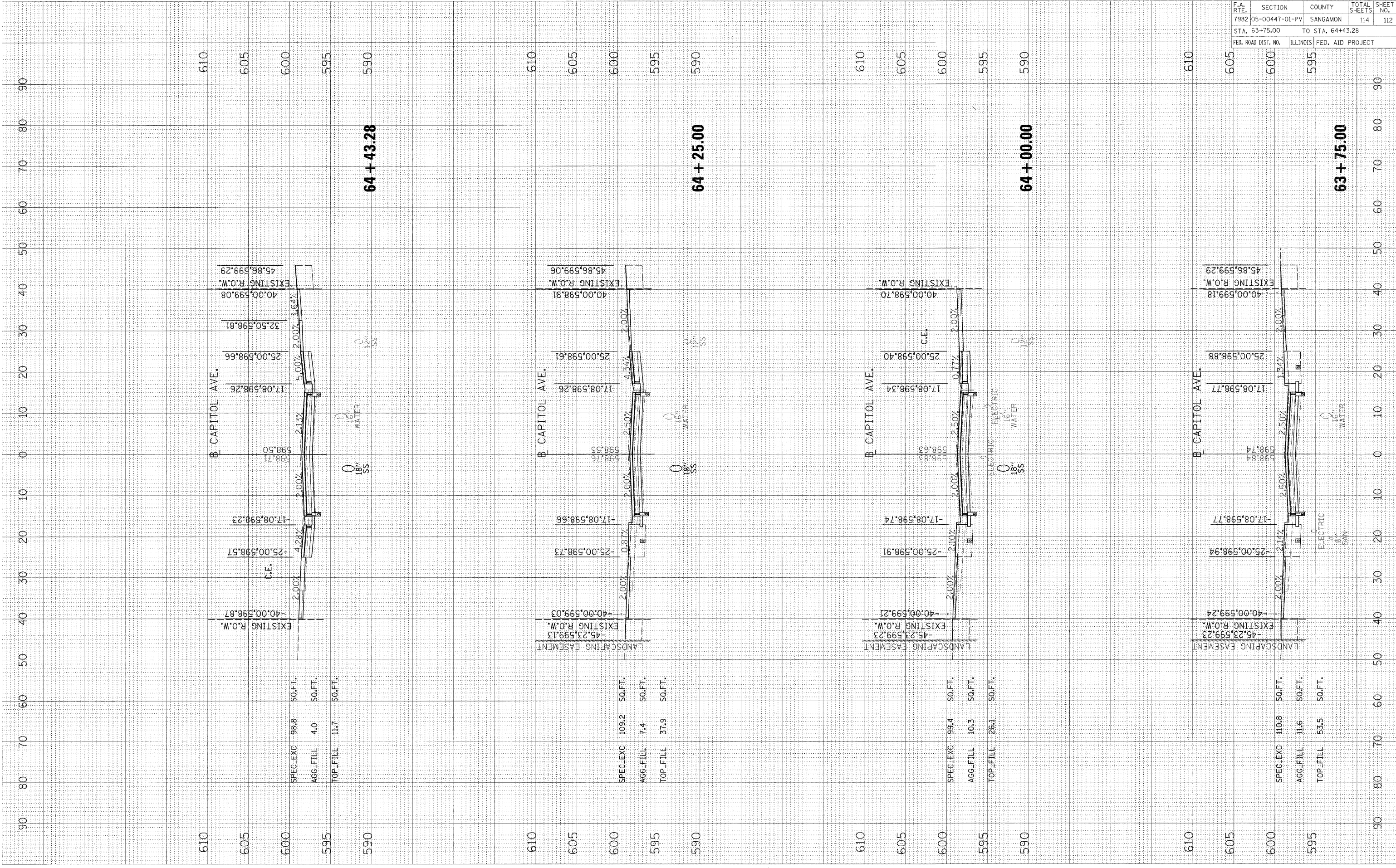

F.A. RTE.	SECTION	COUNTY	TOTAL SHEETS	SHEET NO.
7982	05-00447-01-PV	SANGAMON	114	113
STA. 64+50.00		TO STA. 65+25.00		
FED. ROAD DIST. NO.		ILLINOIS FED. AID PROJECT		

PLOT DATE = 01/10/2008 11:05 AM  
 FILE NAME = S:\2008\20080110\CADD\Road\Highway\Station 1.74-1141\Paper\05-XSEC\05-112007-2-Highway-2.dgn  
 USER NAME = Pp080335

FINAL SURVEY SURVEYED BY: \_\_\_\_\_ DATE: \_\_\_\_\_  
 PLOTTED BY: \_\_\_\_\_ DATE: \_\_\_\_\_  
 NOTE BOOK NO.: \_\_\_\_\_ AREAS CHECKED: \_\_\_\_\_

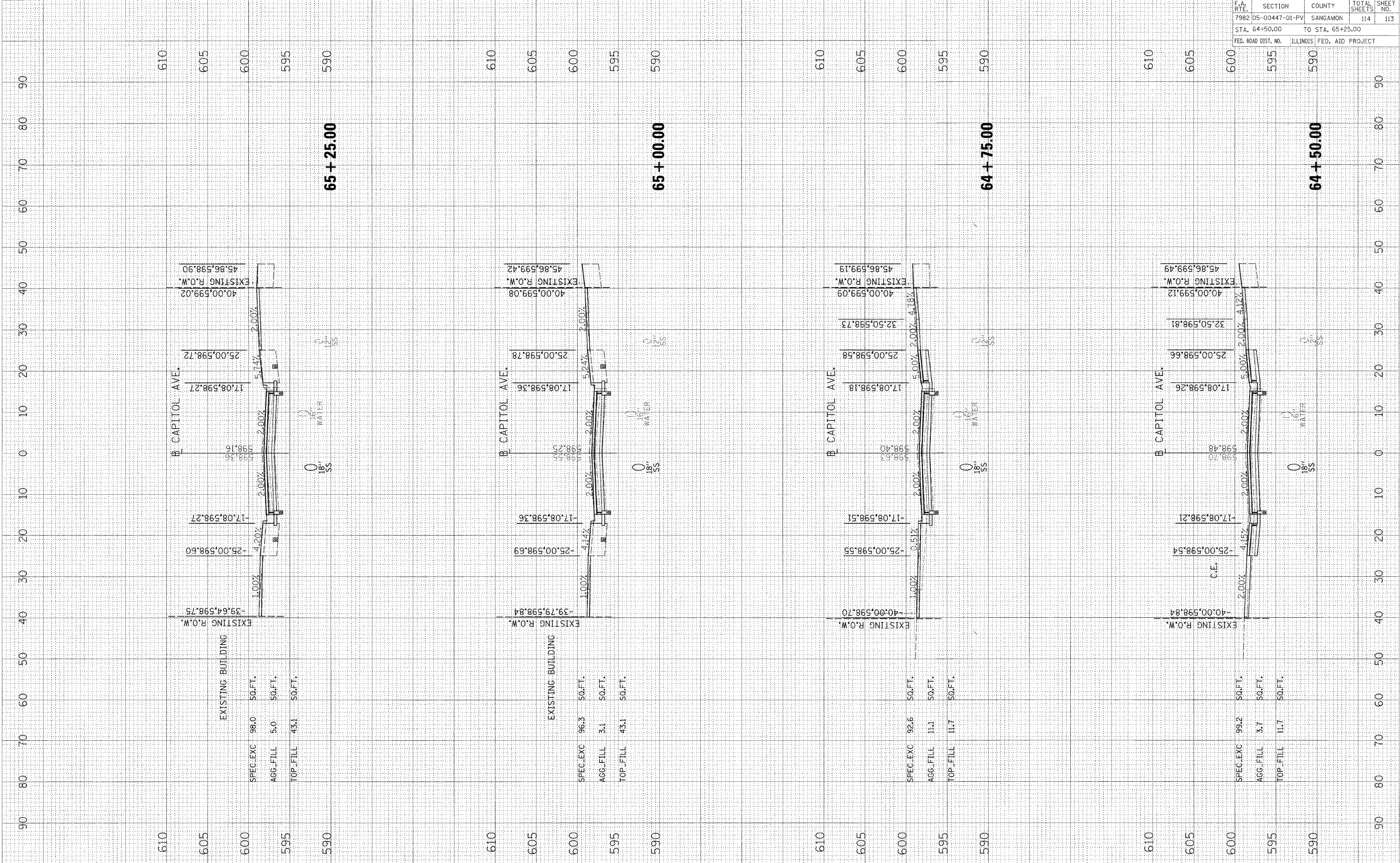

STATION	TYPE	AREA
610	EXISTING BUILDING	
605	SPEC_EXC	98.0 SQ.FT.
600	AGG_FILL	5.0 SQ.FT.
595	TOP_FILL	43.1 SQ.FT.
590		

**65 + 25.00**

STATION	TYPE	AREA
610	EXISTING BUILDING	
605	SPEC_EXC	96.3 SQ.FT.
600	AGG_FILL	3.1 SQ.FT.
595	TOP_FILL	43.1 SQ.FT.
590		

**65 + 00.00**

STATION	TYPE	AREA
610	EXISTING BUILDING	
605	SPEC_EXC	92.6 SQ.FT.
600	AGG_FILL	11.1 SQ.FT.
595	TOP_FILL	11.7 SQ.FT.
590		

**64 + 75.00**

STATION	TYPE	AREA
610	EXISTING BUILDING	
605	SPEC_EXC	99.2 SQ.FT.
600	AGG_FILL	3.7 SQ.FT.
595	TOP_FILL	11.7 SQ.FT.
590		

**64 + 50.00**

F.A. RTE.	SECTION	COUNTY	TOTAL SHEETS	SHEET NO.
7982	05-00447-01-PV	SANGAMON	114	114
STA. 65+36.50		TO STA. 65+36.50		
FED. ROAD DIST. NO.		ILLINOIS FED. AID PROJECT		

DATE	BY
DATE	BY
DATE	BY
DATE	BY
DATE	BY

DATE	BY
DATE	BY
DATE	BY
DATE	BY
DATE	BY

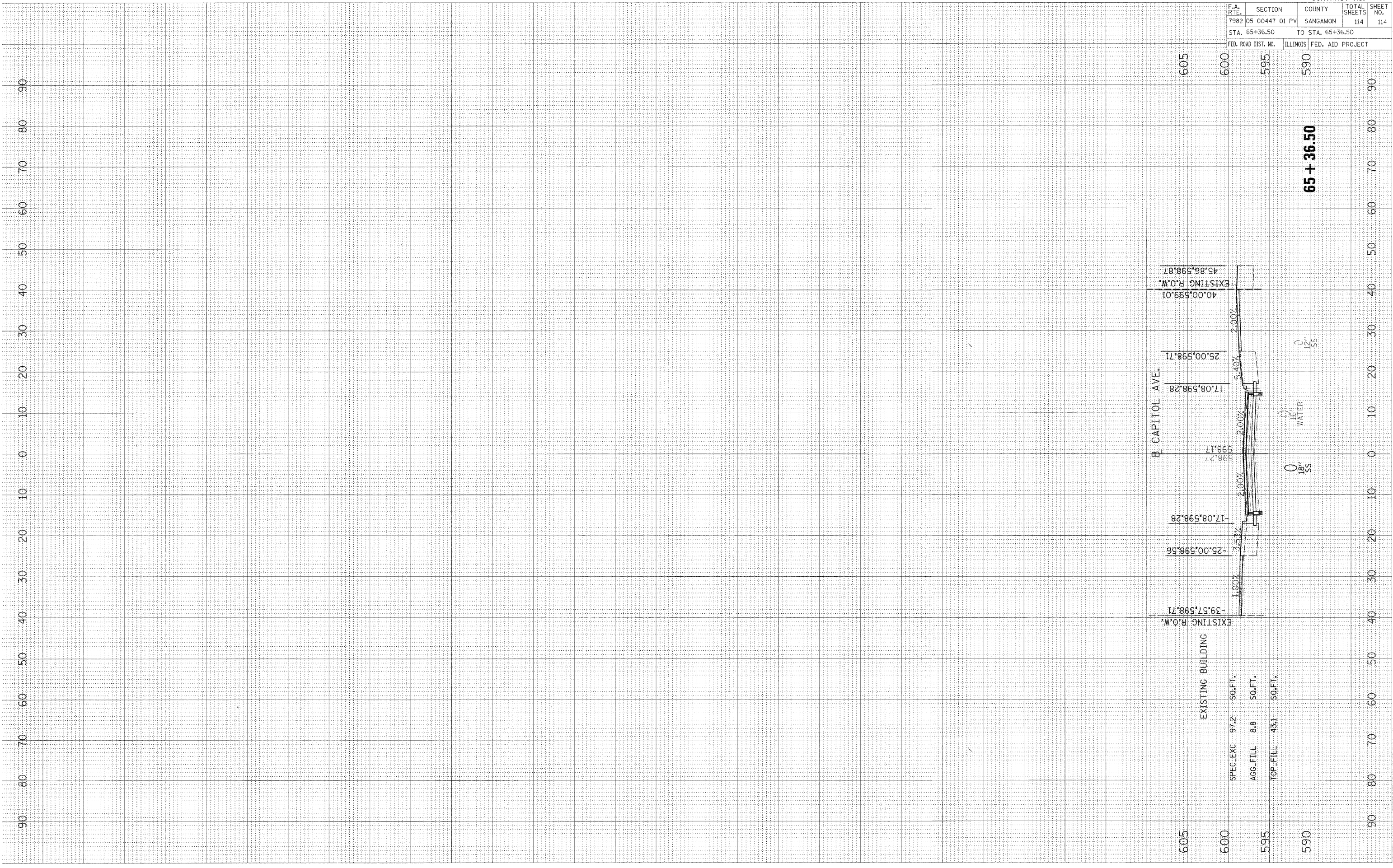

605  
600  
595  
590

65 + 36.50

90 80 70 60 50 40 30 20 10 0 10 20 30 40 50 60 70 80 90

SPEC-EXC 97.2 SQ.FT.  
AGG-FILL 8.8 SQ.FT.  
TOP-FILL 43.1 SQ.FT.