

F.A. RTE.	SECTION	COUNTY	TOTAL SHEETS	SHEET NO.
06-00071-00-RS	SCHUYLER		21	8
STA. 59+00		TO STA. 119+00		
FED. ROAD DIST. NO.	ILLINOIS	FED. AID PROJECT		

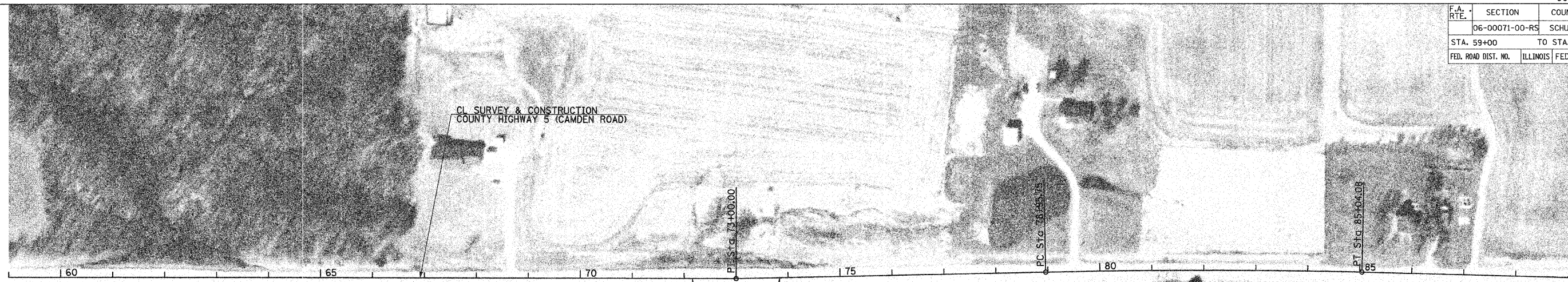

CURVE CH5-1-1  
 PI STA. = 82+00.00  
 $\Delta = 2^\circ 26' 01''$  (RT)  
 $D = 0^\circ 24' 00''$   
 $R = 14,323.95'$   
 $T = 304.25'$   
 $L = 608.33'$   
 $E = 3.30'$   
 $e = NC$   
 P.C. STA 78+95.75  
 P.T. STA 85+04.08

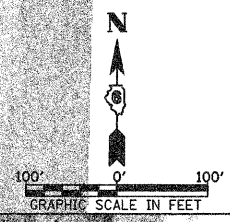

CURVE CH5-1-2  
 PI STA. = 99+04.80  
 $\Delta = 16^\circ 40' 00''$  (RT)  
 $D = 2^\circ 30' 00''$   
 $R = 2,291.83'$   
 $T = 335.72'$   
 $L = 666.67'$   
 $E = 24.44'$   
 $e = 4.8\%$   
 P.C. STA 95+63.08  
 P.T. STA 102+35.75  
 S.E. ATTAINED STA 94+69.08 TO STA 96+19.08  
 S.E. REMOVED STA 101+85.75 TO STA 103+35.75

CURVE CH5-1-3  
 PI STA. = 114+00.00  
 $\Delta = 15^\circ 30' 00''$  (RT)  
 $D = 2^\circ 30' 00''$   
 $R = 2,291.83'$   
 $T = 311.92'$   
 $L = 620.00'$   
 $E = 21.12'$   
 $e = 4.8\%$   
 P.C. STA 110+88.08  
 P.T. STA 117+08.08  
 S.E. ATTAINED STA 109+88.08 TO STA 111+38.08  
 S.E. REMOVED STA 116+56.08 TO STA 118+08.08

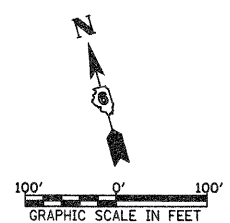

PLOT DATE = 2/1/2008  
 FILE NAME = V:\2486\FP2.dgn  
 PLOT SCALE = 98.8185' / IN.  
 USER NAME = bbargman