

PROPERTY 21, L.L.C.
 PARCEL NO. 6134109

DONALD F. SCHNEPP, II

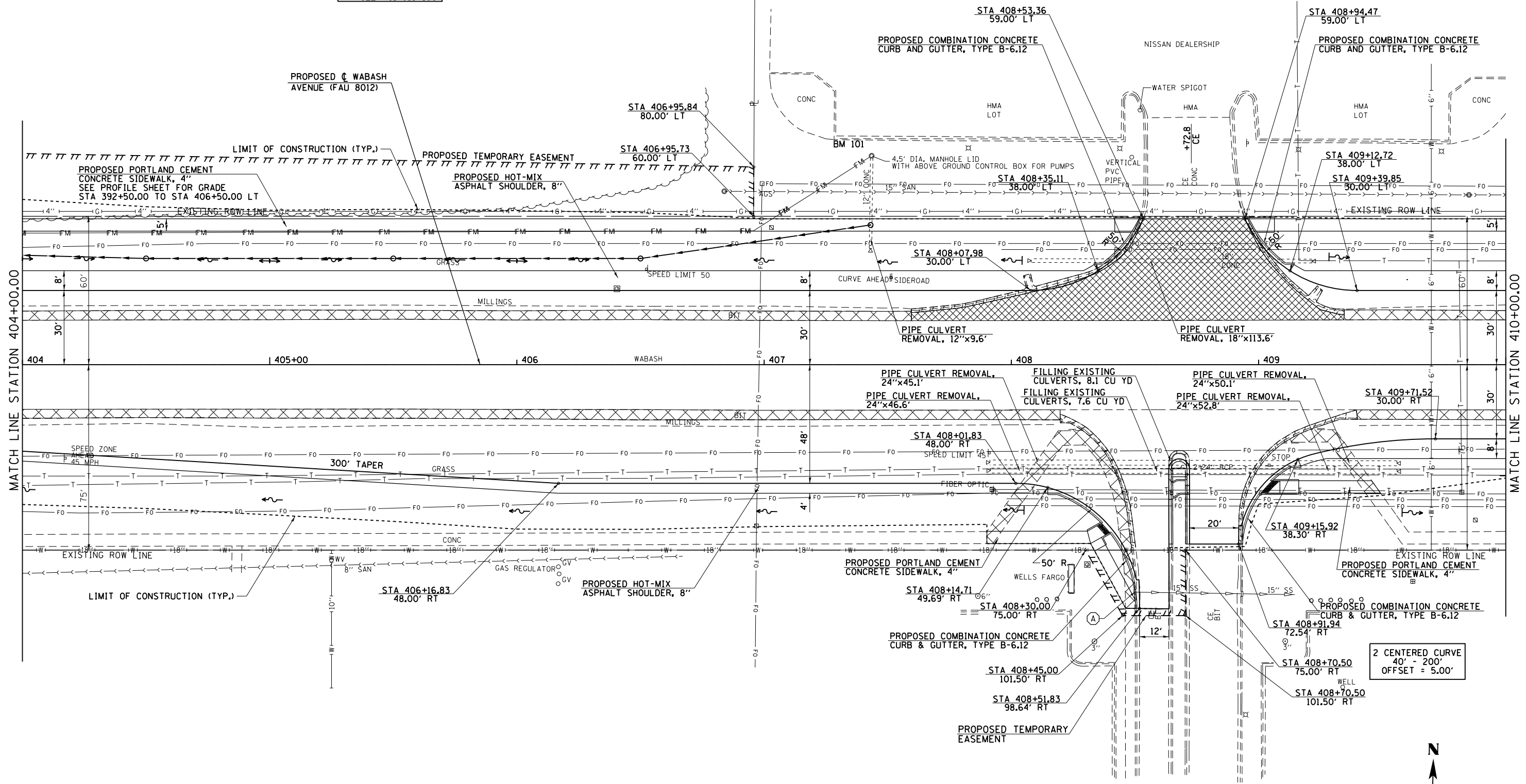

WELLS FARGO HOME MORTGAGE, INC.
 PARCEL NO. 6134152

BM 101 - SET CHIS. "□" ON S. SIDE OF CONC. LIGHT FOUNDATION,
 SET IN S.W. CORNER OF GREEN NISSAN CAR DEALERSHIP PARKING LOT
 N 1125454.379 E 2416185.818
 STA 407+24.96, 91.4' LT
 ELEV. 615.88

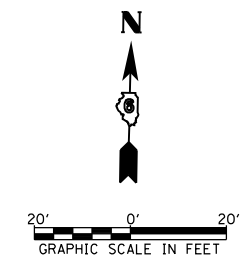

FILE NAME =	USER NAME = sparksgw	DESIGNED - AWM	REVISED -	STATE OF ILLINOIS DEPARTMENT OF TRANSPORTATION	WABASH AVENUE PLAN VIEW			F.A.U. RTE.	SECTION	COUNTY	TOTAL SHEETS	SHEET NO.	
c:\pwwork\pwwork\sparksgw\10373645\0678890-sht-plan-Wabash14.dgn		DRAWN - JCW	REVISED -		SCALE: 1=20	SHEET NO.	OF SHEETS	STA. 404+00.00 TO STA. 410+00.00	8012	21(W-3, TS-1, RS-7)	SANGAMON	679	135
PLOT SCALE = 40.0000' / in.		CHECKED - AWM	REVISED -										
PLOT DATE = Feb-04-2014 01:32:45PM		DATE - 12/04/2013	REVISED -										
CONTRACT NO. 72890													
ILLINOIS FED. AID PROJECT													