

QUANTITY	UNIT	ITEM
288	SQ FT	CONCRETE MEDIAN SURFACE, 4-INCH
1	EACH	SERVICE INSTALLATION, TYPE A
820	FOOT	UNDERGROUND CONDUIT, PVC, 1 1/2" DIA.
5	FOOT	UNDERGROUND CONDUIT, PVC, 2" DIA.
143	FOOT	UNDERGROUND CONDUIT, PVC, 2 1/2" DIA.
226	FOOT	UNDERGROUND CONDUIT, PVC, 3"
4	FOOT	UNDERGROUND CONDUIT, PVC, 4"
5	EACH	HANDHOLE
1	EACH	DOUBLE HANDHOLE
2	EACH	GULFBOX JUNCTION, COMPOSITE CONCRETE
1	EACH	FULL-ACTUATED CONTROLLER AND TYPE IV CABINET
1	EACH	UNITERUPTIBLE POWER SUPPLY, STANDARD
1	EACH	TRANSCIEVER - FIBER OPTIC
995	FOOT	FIBER OPTIC CABLE IN CONDUIT, NO. 62.5/125, MM12F SM12F
1322	FOOT	ELECTRIC CABLE IN CONDUIT, SIGNAL, NO. 14 5C
133	FOOT	ELECTRIC CABLE IN CONDUIT, SIGNAL, NO. 14 7C
485	FOOT	ELECTRIC CABLE IN CONDUIT, SIGNAL, NO. 14 9C
213	FOOT	ELECTRIC CABLE IN CONDUIT, SIGNAL, NO. 14 12C
852	FOOT	ELECTRIC CABLE IN CONDUIT, SIGNAL, NO. 18, 3C
34	FOOT	ELECTRIC CABLE IN CONDUIT, SERVICE, NO. 6 2C
615	FOOT	ELECTRIC CABLE IN CONDUIT, EQUIPMENT GROUNDING CONDUCTOR, NO. 6 1C
4	EACH	TRAFFIC SIGNAL POST, ALUMINUM, 14 FT.
230	FOOT	ELECTRIC CABLE IN CONDUIT, 600V (XLP-TYPE USE) 3-1\C NO. 10
2	EACH	LUMINAIRE, SODIUM VAPOR, HORIZONTAL MOUNT, PHOTO-CELL CONTROL, 400 WATT

MATCH LINE STA. 380 + 00.00 INTERCONNECT SHEET

MATCH LINE STA. 386 + 16.00 INTERCONNECT SHEET

QUANTITY	UNIT	ITEM
1	EACH	TRAFFIC SIGNAL POST, ALUMINUM, 16 FT.
1	EACH	STEEL COMBINATION MAST ARM ASSEMBLY AND POLE 62 FT.
1	EACH	STEEL COMBINATION MAST ARM ASSEMBLY AND POLE WITH DUAL MAST ARMS, 34 FT. AND 34 FT.
15	FOOT	CONCRETE FOUNDATION, TYPE A
3.5	FOOT	CONCRETE FOUNDATION, TYPE C
14	FOOT	CONCRETE FOUNDATION, TYPE E, 36-INCH DIAMETER
21	FOOT	CONCRETE FOUNDATION, TYPE E, 42-INCH DIAMETER
3	EACH	SIGNAL HEAD, POLYCARBONATE, LED, 1-FACE, 3-SECTION, BRACKET MOUNTED
5	EACH	SIGNAL HEAD, POLYCARBONATE, LED, 1-FACE, 3-SECTION, MAST ARM MOUNTED
1	EACH	SIGNAL HEAD, POLYCARBONATE, LED, 1-FACE, 4-SECTION, MAST ARM MOUNTED
2	EACH	SIGNAL HEAD, POLYCARBONATE, LED, 2-FACE, 3-SECTION, BRACKET MOUNTED
1	EACH	SIGNAL HEAD, POLYCARBONATE, LED, 2-FACE, 1-3 SECTION, 1-4 SECTION, BRACKET MOUNTED
16	EACH	TRAFFIC SIGNAL BACKPLATE
1	EACH	TEMPORARY TRAFFIC SIGNAL INSTALLATION
1	EACH	REMOVE EXISTING TRAFFIC SIGNAL EQUIPMENT
5	EACH	REMOVE EXISTING HANDHOLE
1	EACH	REMOVE EXISTING DOUBLE HANDHOLE
9	EACH	REMOVE EXISTING CONCRETE FOUNDATION
3	EACH	CAMERA MOUNTING ASSEMBLY
292	SQ FT	CONCRETE MEDIAN SURFACE REMOVAL
1	EACH	VIDEO VEHICLE DETECTION SYSTEM

USER NAME = sparksgw	DESIGNED -	REVISED - WCD 10/17/2013
PLOT SCALE = 40.0000' / in.	DRAWN - BDM	REVISED -
PLOT DATE = Feb-04-2014 01:44:48PM	CHECKED - JSA	REVISED -
	DATE - 7/15/09	REVISED -

**STATE OF ILLINOIS
DEPARTMENT OF TRANSPORTATION**

**PROPOSED TRAFFIC SIGNAL PLAN
WABASH AVE. & I-72 EAST INTERSECTION**

SCALE: SHEET NO. 8 OF 37 SHEETS STA. TO STA.

F.A.U. RTE.	SECTION	COUNTY	TOTAL SHEETS	SHEET NO.
8012	21(W-3, TS-1, RS-7)	SANGAMON	679	343
CONTRACT NO. 72890				
ILLINOIS FED. AID PROJECT				

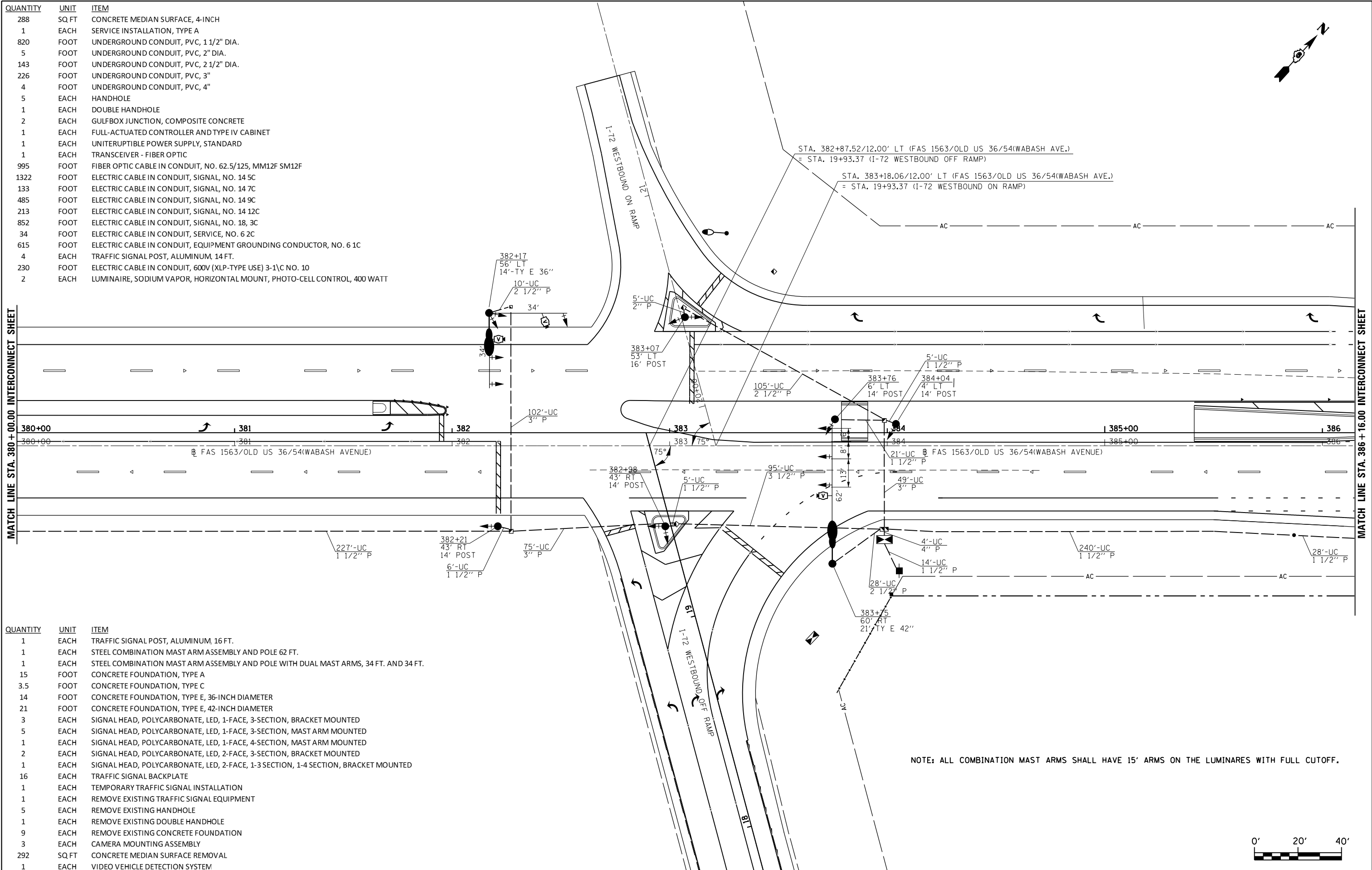
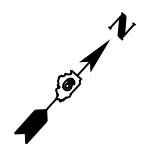

NOTE: ALL COMBINATION MAST ARMS SHALL HAVE 15' ARMS ON THE LUMINAIRES WITH FULL CUTOFF.

