

| | |
|--------------|---------------|
| DATE | |
| BY | |
| FINAL SURVEY | SURVEYED |
| NOTE BOOK | PLOTTED |
| NO. | TEMPLATE |
| | AREAS CHECKED |

| | |
|-----------------|---------------|
| DATE | |
| BY | |
| ORIGINAL SURVEY | SURVEYED |
| NOTE BOOK | PLOTTED |
| NO. | TEMPLATE |
| | AREAS CHECKED |

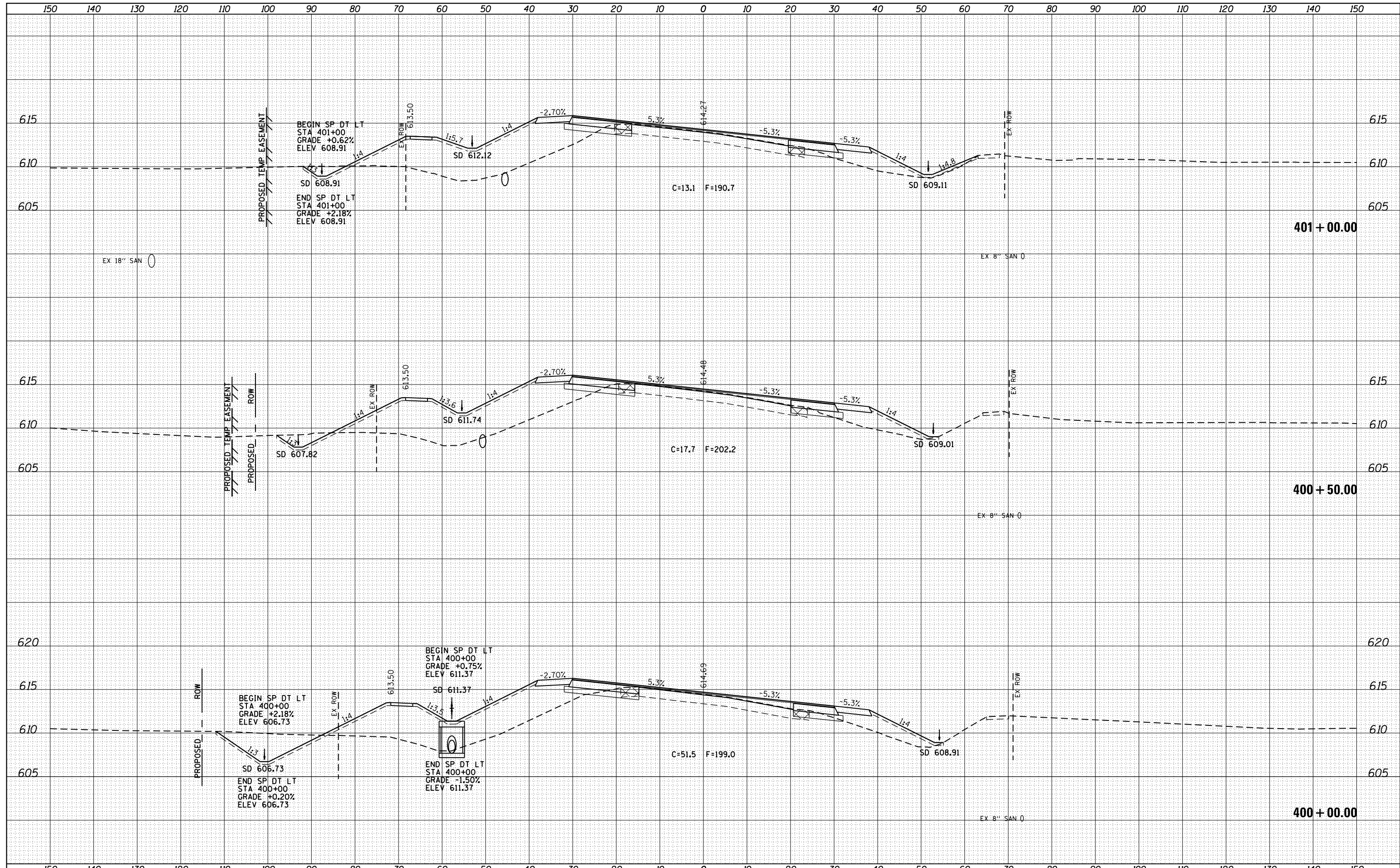

| | | | | | | | | | | |
|---|------------------------------------|-------------------|-----------|---|---|---------------------------|----------|--------|--------------|-----------|
| FILE NAME = | USER NAME = sparksq | DESIGNED - AWM | REVISED - | STATE OF ILLINOIS DEPARTMENT OF TRANSPORTATION | WABASH AVENUE CROSS SECTIONS | F.A.U. R.T.E. | SECTION | COUNTY | TOTAL SHEETS | SHEET NO. |
| c:\pw\work\p1dot\spksg\ad0373645\0672890-shd-xssht-wabash.dgn | DRAWN - TJD | REVISED - | 8012 | | | 21(W-3, TS-1, RS-7) | SANGAMON | 679 | 514 | |
| Default | PLOT SCALE = 20.0000' / in. | CHECKED - AWM | REVISED - | | | CONTRACT NO. 72890 | | | | |
| | PLOT DATE = Feb-04-2014 01:51:44PM | DATE - 12/04/2013 | REVISED - | | | ILLINOIS FED. AID PROJECT | | | | |

SCALE: 1"=10'H, 5'V SHEET 44 OF 124 SHEETS STA. 400+00.00 TO STA. 401+00.00