

**IMPROVEMENT BEGINS:
STA. 10+51**

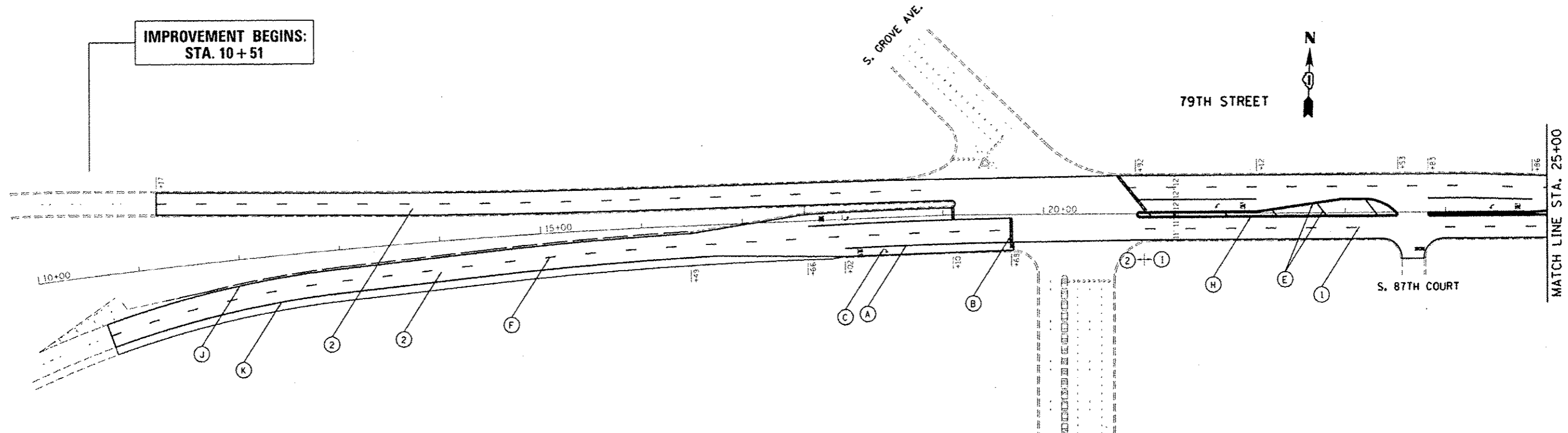

- A** PROP. THERMOPLASTIC PLASTIC PAVEMENT TURN LANE MARKING-LINE 6", WHITE (TYP.)
- B** PROP. THERMOPLASTIC PAVEMENT STOP MARKING-LINE 24", WHITE (TYP.)
- C** PROP. THERMOPLASTIC PAVEMENT MARKING LETTERS AND SYMBOLS, WHITE (TYP.)
- D** PROP. THERMOPLASTIC PAVEMENT MARKING-LINE 8", WHITE (TYP.)
- E** PROP. THERMOPLASTIC PAVEMENT MARKING-LINE 12", YELLOW (TYP.)
- F** PROP. THERMOPLASTIC PAVEMENT MARKING-LINE 4", 10' DASH-30' SKIP, WHITE (TYP.)
- G** PROP. THERMOPLASTIC PAVEMENT MARKING-LINE 12", WHITE (TYP.)
- H** PROP. THERMOPLASTIC PAVEMENT MARKING DOUBLE LINES 4" @ 11" C-C, YELLOW (TYP.)
- I** PROP. THERMOPLASTIC PAVEMENT SOLID AND SKIP-DASH MARKING-LINES 4" @ 5 1/2" C-C, YELLOW (TYP.)
- J** PROP. THERMOPLASTIC PAVEMENT MARKING-LINE 4", YELLOW (TYP.)
- K** PROP. THERMOPLASTIC PAVEMENT MARKING-LINE 4", WHITE (TYP.)
- L** PROP. THERMOPLASTIC PAVEMENT CROSSWALK MARKING-LINE 6", 2 @ 6' SPACE, WHITE (TYP.)
- M** PROP. THERMOPLASTIC PAVEMENT SCHOOL CROSSWALK MARKING-LINE 12" @ 2' SPACE, WHITE (TYP.)
- N** PROP. THERMOPLASTIC PAVEMENT MARKING-LINE 6", 2' DASH-6' SKIP, WHITE (TYP.)
- 1** PROP. HOT-MIX ASPHALT SURFACE REMOVAL, 2 1/2"
PROP. POLYMERIZED HMA SURFACE COURSE, MIX "F", N90, 1 3/4"
PROP. POLYMERIZED LEVELING BINDER COURSE (MACHINE METHOD), IL-4.75, N50, 3/4"
- 2** PROP. HOT-MIX ASPHALT SURFACE REMOVAL, 1 3/4"
PROP. POLYMERIZED HMA SURFACE COURSE, MIX "F", N90, 1 3/4"

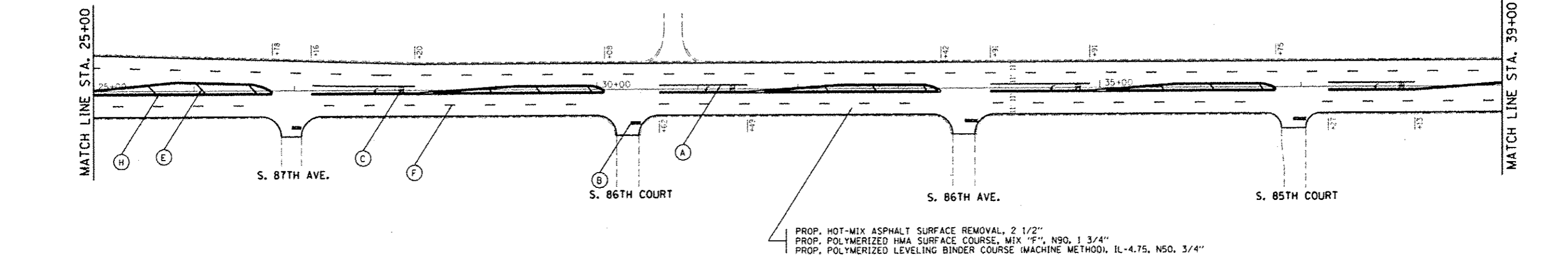

- 1** PROP. HOT-MIX ASPHALT SURFACE REMOVAL, 2 1/2"
PROP. POLYMERIZED HMA SURFACE COURSE, MIX "F", N90, 1 3/4"
PROP. POLYMERIZED LEVELING BINDER COURSE (MACHINE METHOD), IL-4.75, N50, 3/4"

SHEET REVISED 4/8/2013

<small>FILE NAME:</small> <small>USER NAME:</small> <small>DESIGNED:</small> <small>DRAWN:</small> <small>CHECKED:</small> <small>DATE:</small>	<small>DESIGNED:</small>	<small>REVISED:</small>	STATE OF ILLINOIS DEPARTMENT OF TRANSPORTATION	79TH ST. ROADWAY & PAVEMENT MARKING PLAN	<small>F.A.U. RTE.</small>	<small>SECTION</small>	<small>COUNTY</small>	<small>TOTAL SHEETS</small>	<small>SHEET NO.</small>	
	<small>4/8/2013</small>	<small>4/8/2013</small>		<small>4/8/2013</small>	<small>SCALE: 1"=50'</small>	<small>SHEET 1 OF 10 SHEETS</small>	<small>STA. 10+00 TO STA. 39+00</small>	<small>154B</small>	<small>46IRS-3</small>	<small>COOK</small>

ILLINOIS FED. AID PROJECT CONTRACT NO. 60W15