

PROPOSED LEGEND

- PROPOSED HMA BIKE PATH
(SEE TYP. CROSS SECTION)
- PROPOSED GRASS LAKE RD. PAVEMENT
SECTION (SEE TYP. CROSS SECTION)
- PROPOSED AGG. SHOULDER
(SEE TYP. CROSS SECTION)
- PROPOSED AGG. TRAIL
(SEE TYP. CROSS SECTION)
- GRADING & SHAPING DITCHES
- PROPOSED STORM SEWER STRUCTURE
- PROPOSED STORM SEWER/CULVERT

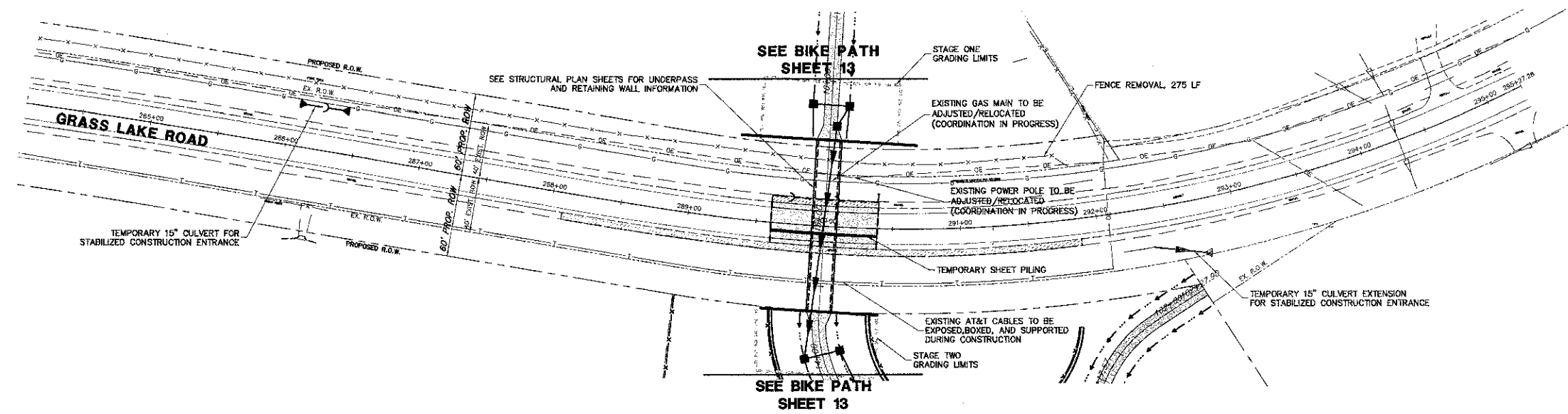

SUMMARY OF DRY UTILITIES

	EXISTING EQUIPMENT	EQUIPMENT TO BE RELOCATED
AT&T CORPORATION	BURIED CABLE ALONG SOUTH SIDE OF GRASS LAKE ROAD	AT&T TO EXPOSE, BOX, AND SUPPORT CABLES DURING CONSTRUCTION AND RUN CABLES OVER TOP OF UNDERPASS AFTER CONSTRUCTION IS COMPLETE.
COMCAST	NO FACILITIES WITHIN THE PROJECT LIMITS.	NONE
COMED	OVERHEAD 12KV ALONG NORTH SIDE OF GRASS LAKE ROAD; BURIED CABLE EXTENDING NORTH FROM ROW	UTILITY POLE AT STA 290+19 TO BE RELOCATED
NORTH SHORE GAS	4" STEEL GAS MAIN (BURIED) ON NORTH SIDE OF GRASS LAKE RD.	GAS MAIN TO BE BRACED DURING CONSTRUCTION

