

1	EACH	SERVICE INSTALLATION
1	EACH	TRAFFIC SIGNAL CABINET (COMPLETE)
1	EACH	TRAFFIC SIGNAL CONTROLLER

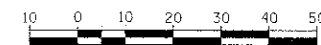

NAME	STRENGTH	DATE
BY		
NOTED		
ALIGNMENT CHECKED		
RT. OF WAY CHECKED		
CADD FILE NAME		
NO.		

PROFILE	SURVEYED	BY	DATE
NOTE BOOK	PLOTTED		
	GRADE'S CHECKED		
	B.M. NOTED		
	STRIKES NOTED AS OK'D		

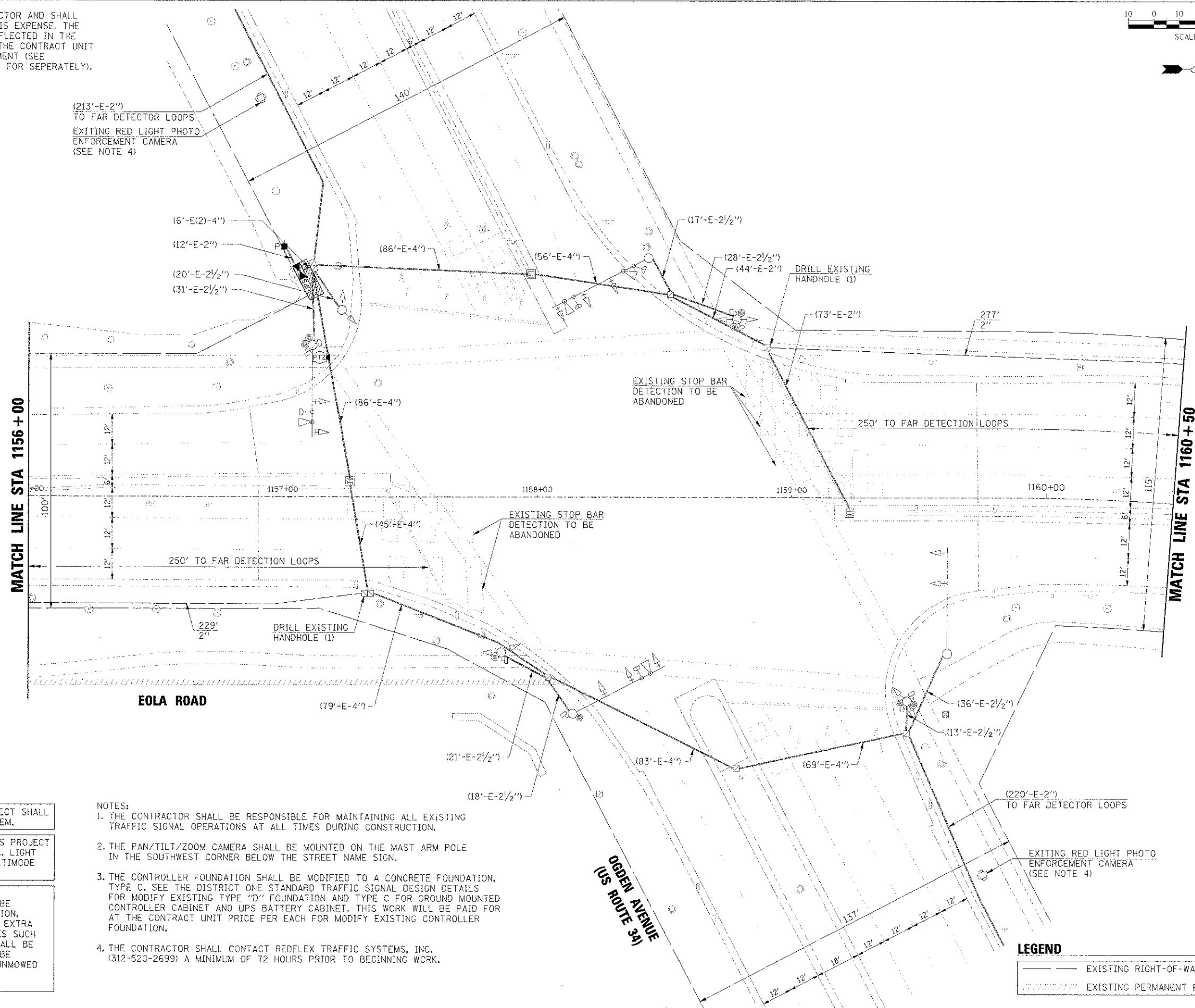

RESTORATION OF WORK AREA:  
RESTORATION OF THE TRAFFIC SIGNAL WORK AREA SHALL BE INCIDENTAL TO THE RELATED PAY ITEM SUCH AS FOUNDATION, CONDUIT, HANDHOLE, TRENCH AND BACKFILL, ETC., AND NO EXTRA COMPENSATION SHALL BE ALLOWED. ALL ROADWAY SURFACES SUCH AS SHOULDERS, MEDIANS, SIDEWALKS, PAVEMENT, ETC. SHALL BE REPLACED IN KIND. ALL DAMAGE TO MOWED LAWNS SHALL BE REPLACED WITH AN APPROVED SOD, AND ALL DAMAGE TO UNMOWED FIELDS SHALL BE SEEDED IN ACCORDANCE WITH STANDARD SPECIFICATIONS 252 AND 250 RESPECTIVELY.

- NOTES:
1. THE CONTRACTOR SHALL BE RESPONSIBLE FOR MAINTAINING ALL EXISTING TRAFFIC SIGNAL OPERATIONS AT ALL TIMES DURING CONSTRUCTION.
  2. THE PAN/TILT/ZOOM CAMERA SHALL BE MOUNTED ON THE MAST ARM POLE IN THE SOUTHWEST CORNER BELOW THE STREET NAME SIGN.
  3. THE CONTROLLER FOUNDATION SHALL BE MODIFIED TO A CONCRETE FOUNDATION, TYPE C. SEE THE DISTRICT ONE STANDARD TRAFFIC SIGNAL DESIGN DETAILS FOR MODIFY EXISTING TYPE "D" FOUNDATION AND TYPE C FOR GROUND MOUNTED CONTROLLER CABINET AND UPS BATTERY CABINET. THIS WORK WILL BE PAID FOR AT THE CONTRACT UNIT PRICE PER EACH FOR MODIFY EXISTING CONTROLLER FOUNDATION.
  4. THE CONTRACTOR SHALL CONTACT REDFLEX TRAFFIC SYSTEMS, INC. (312-520-2699) A MINIMUM OF 72 HOURS PRIOR TO BEGINNING WORK.

### LEGEND

— — — — — EXISTING RIGHT-OF-WAY  
 // // // // // EXISTING PERMANENT EASEMENT



**HRGreen.com**  
Illinois Professional Design Firm  
#184-001322

```
USER NAME = Meller
PLDT SCALE =
PLDT DATE = 1/9/2013
FILE NAME = C:\HLS\004\001\ccden.ven
```

DESIGNED	-	MJF
CHECKED	-	APS
DATE	-	12/27/2012

REVISED	..
REVISED	..
REVISED	..
REVISED	..

**STATE OF ILLINOIS  
DEPARTMENT OF TRANSPORTATION**

**TRAFFIC SIGNAL MODIFICATION PLAN**  
**OGDEN AVENUE (US ROUTE 34)**  
**(SHEET 1 OF 2)**

SCALE:	SHEET NO.	OF	SHEETS	STA.	TO STA.
--------	-----------	----	--------	------	---------

F.A.U. RTE.	SECTION	COUNTY	TOTAL SHEETS	SHEET NO.
2531	11-00296-00-TL	DUPAGE/WILL	48	19
CONTRACT NO.			63786	