

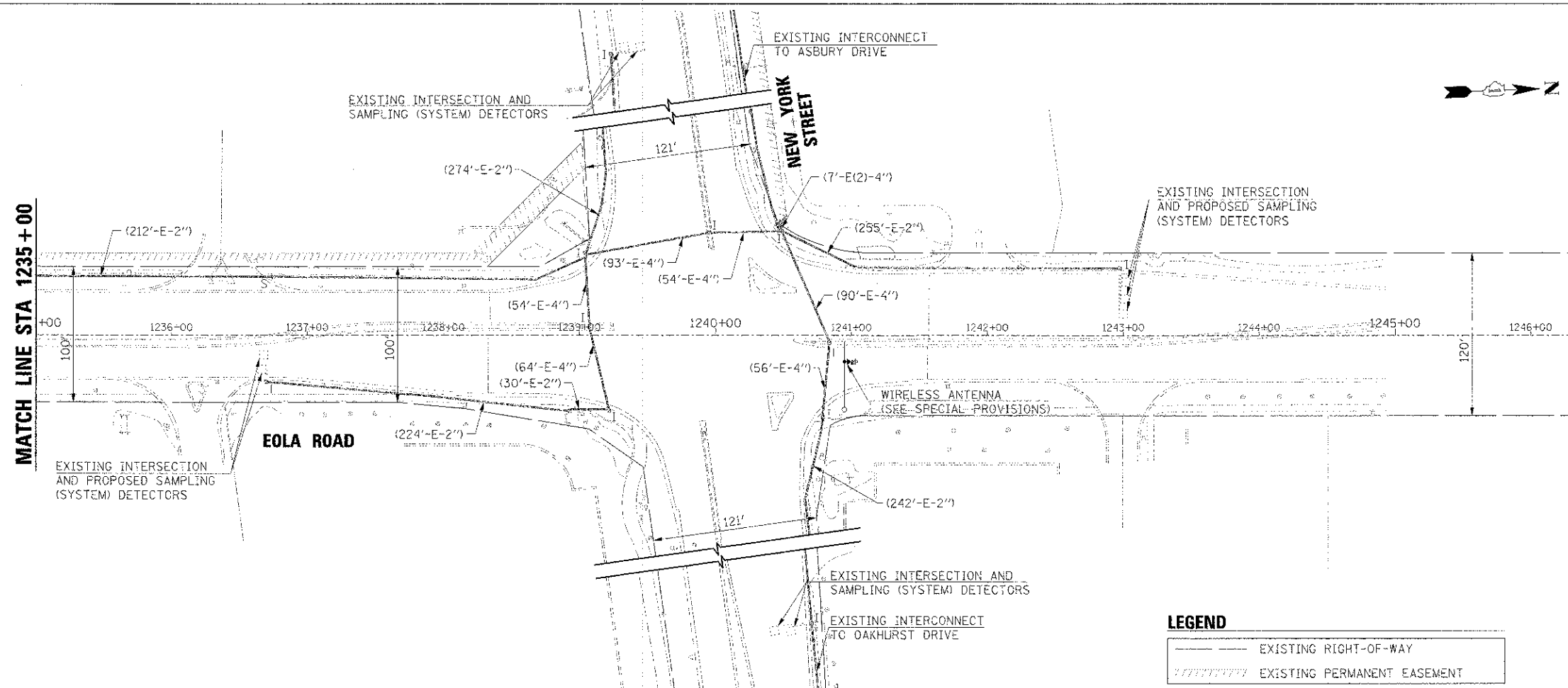

NO.	DATE	BY
SURVIVED		
PLOTTED		
GRADE'S CHECKED		
B.M. NOTED		
5. BUREAU NOTATIONS OTHERS		
NOTE BOOK		



RESTORATION OF WORK AREA:
RESTORATION OF THE TRAFFIC SIGNAL WORK AREA SHALL BE INCIDENTAL TO THE RELATED PAY ITEM SUCH AS FOUNDATION, CONDUIT, HANDHOLE, TRENCH AND BACKFILL, ETC., AND NO EXTRA COMPENSATION SHALL BE ALLOWED. ALL ROADWAY SURFACES SUCH AS SHOULDERS, MEDIANS, SIDEWALKS, PAVEMENT, ETC. SHALL BE REPLACED IN KIND. ALL DAMAGE TO MOWED LAWNS SHALL BE REPLACED WITH AN APPROVED SOD, AND ALL DAMAGE TO UNMOWED FIELDS SHALL BE SEEDED IN ACCORDANCE WITH STANDARD SPECIFICATIONS 252 AND 250 RESPECTIVELY.

 HRGreen.com Illinois Professional Design Firm #194-001322	USER NAME > MFeller	DESIGNED - MJF	REVISED -	<div>STATE OF ILLINOIS DEPARTMENT OF TRANSPORTATION</div>	<div>INTERCONNECT PLAN (SHEET 9 OF 9)</div>	F.A.D.	SECTION	COUNTY	TOTAL SHEET NO.			
	PLOT SCALE >	CHECKED - APS	REVISED -			2531	11-00296-00-TL	DUPAGE/WILL	48	40		
	PLOT DATE > 1/19/2013	DATE > 12/27/2012	REVISED -									
	FILE NAME > 6789-11.dgn	REVISED -										
				SCALE:	SHEET NO.	OF SHEETS	STA.	TO STA.	FED. ROAD DIST. NO.	ILLINOIS FED. AID PROJECT	CONTRACT NO.	63786