

RESTORATION OF WORK AREA

RESTORATION OF THE TRAFFIC SIGNAL WORK AREA SHALL BE INCIDENTAL TO THE RELATED PAY ITEM SUCH AS FOUNDATION, CONDUIT, HANDHOLE, TRENCH AND BACKFILL, ETC., AND NO EXTRA COMPENSATION SHALL BE ALLOWED. ALL ROADWAYS SURFACES SUCH AS SHOULDERS, MEDIANS, SIDEWALKS, PAVEMENT, ETC. SHALL BE REPLACED IN KIND. ALL DAMAGE TO MOWED LAWNS SHALL BE REPLACED WITH AN APPROVED SOD AND ALL DAMAGE TO UNMOWED LAWNS SHALL BE SEEDED IN ACCORDANCE WITH STANDARD SPECIFICATIONS 252 AND 250 RESPECTIVELY.

NOTE

THE TRAFFIC SIGNAL CONTROL EQUIPMENT FOR THIS PROJECT SHALL BE "EAGLE" TO MATCH THE EXISTING ADJACENT SYSTEM.

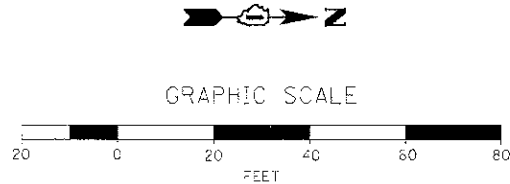
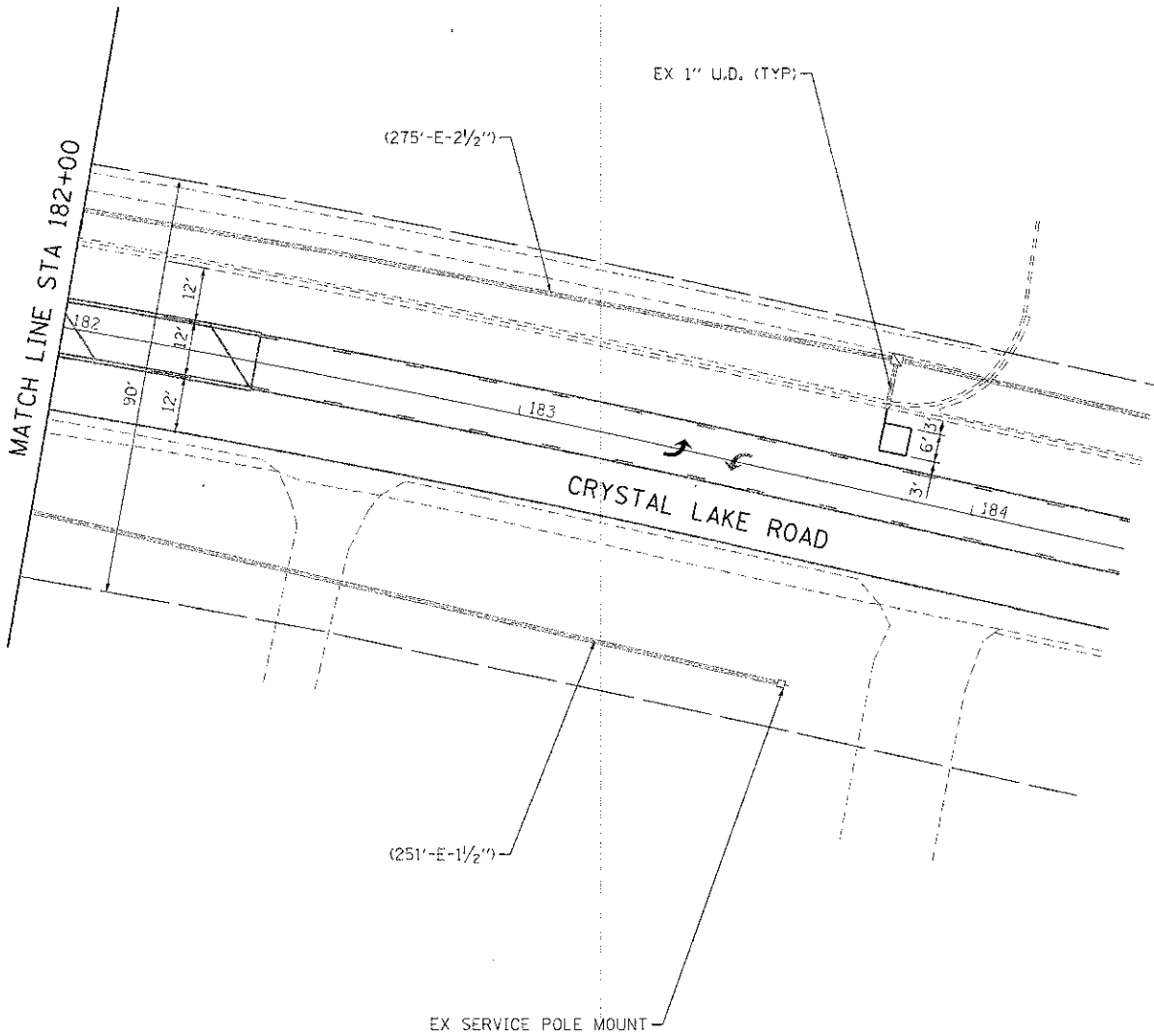
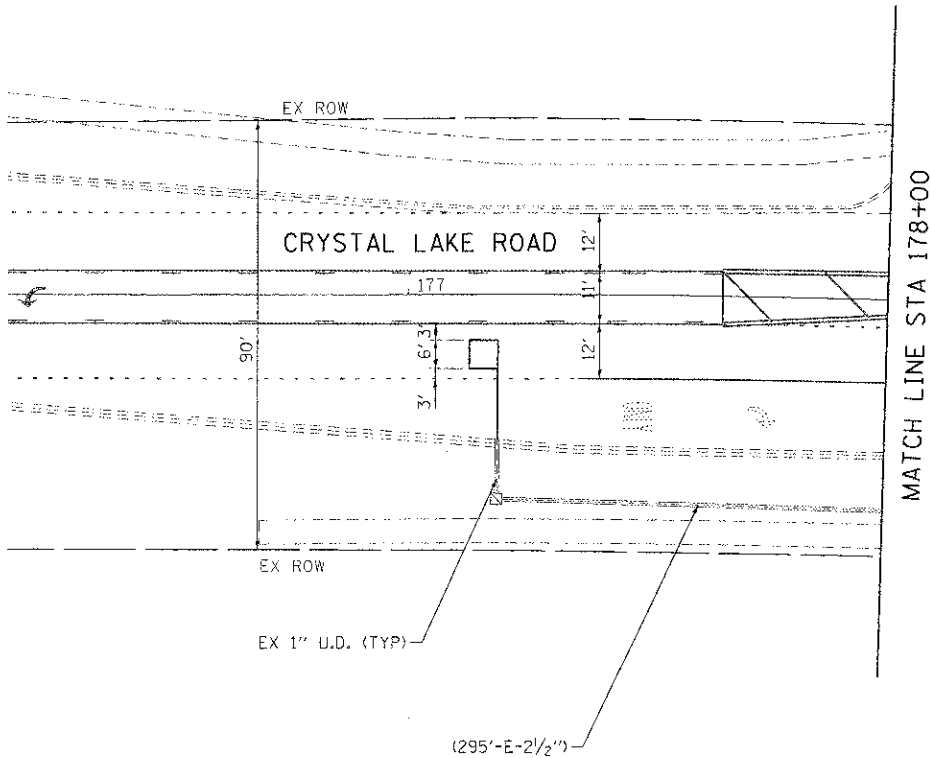

COMPANY NAME: HRGreen
PROJECT CONTACT: J. J. S.
CLIENT: CITY OF MCHENRY
DATE PLOTTED: 06/10/2014
FILE NAME: 06101069-sig-0302.dgn
PLOT DRIVER: J. J. S.
PEN TABLE: Standard Trans.tbl

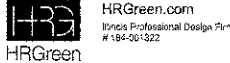

USER NAME = jstrzel	DESIGNED - JJS	REVISED -
	DRAWN - JJS	REVISED -
PLOT SCALE = 1"=20'	CHECKED - CP	REVISED -
PLOT DATE = .DATE1.	DATE -	REVISED -

CITY OF MCHENRY

TRAFFIC SIGNAL INSTALLATION PLAN
CRYSTAL LAKE ROAD AT ROYAL DRIVE

SCALE: 1"=20' SHEET NO. 2 OF 2 SHEETS STA. NA TO STA. NA

F.A. RTE.	SECTION	COUNTY	TOTAL SHEETS	SHEET NO.
0085	11-00073-00-RS	MCHENRY	44	31
CONTRACT NO. 63794				
ILLINOIS FED. AID PROJECT				