

- NOTES:
1. TRENCH EDGE DETAIL SHALL BE USED AT ALL LAWN EDGES AND AT EDGES OF MULCHED AREAS (FOR CONTAINMENT)
 2. TRENCH EDGE SHALL CREATE A CLEAN SEPARATION BETWEEN AREAS, AND SHALL CREATE SMOOTH AND EVEN LINES (AS INDICATED ON PLANS)

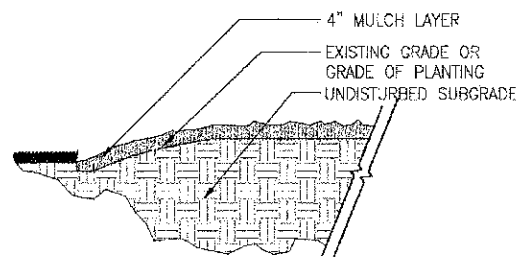

1 TRENCH EDGE DETAIL

SCALE: 1"=1'-0"

DT-is-trench-gyn

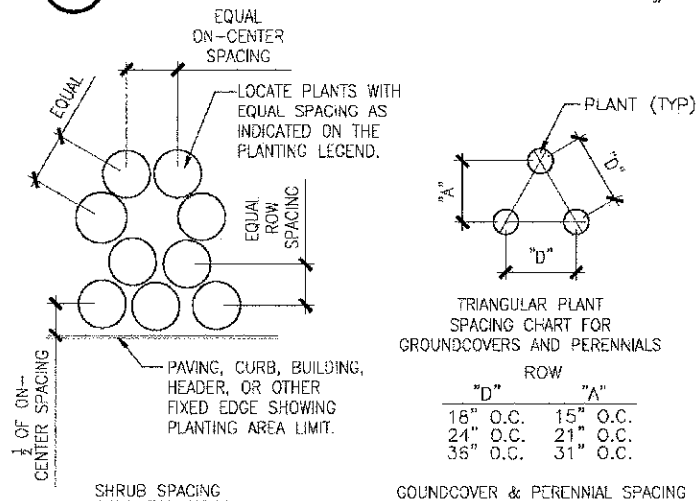

GROUND COVER & PERENNIAL SPACING

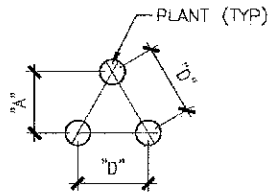

TRIANGULAR PLANT SPACING CHART FOR GROUNDCOVERS AND PERENNIALS

ROW	"D"	"A"
1	18" O.C.	15" O.C.
2	24" O.C.	21" O.C.
3	36" O.C.	31" O.C.

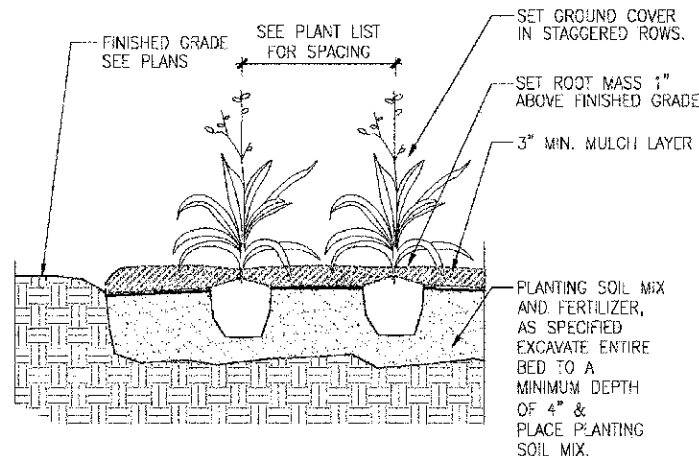

2 GROUND COVER PLANTING

SCALE: 1"=1'-0"

DT-groundcover-gyn

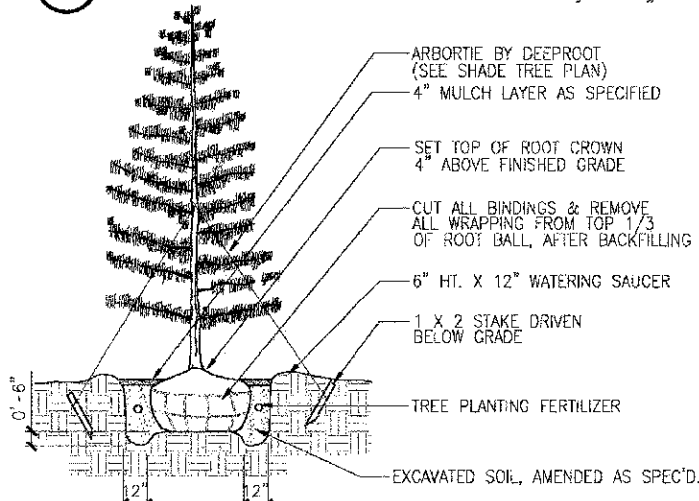

3 SHADE TREE PLANTING

SCALE: 1/4"=1'-0"

DT-tree-w-wire-gyn

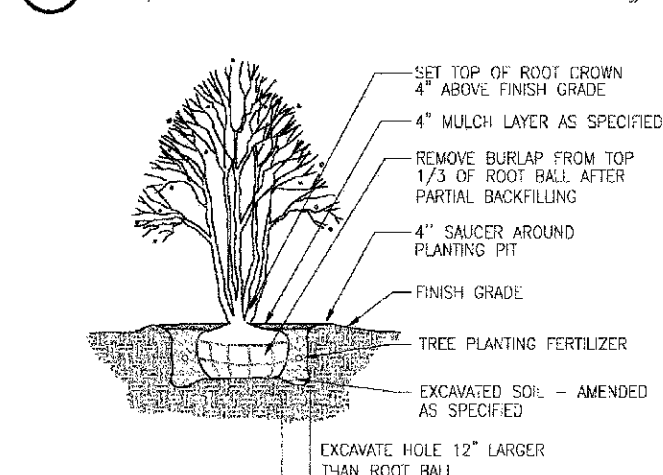

6 ORNAMENTAL TREE PLANTING

SCALE: 1/4"=1'-0"

DT-ornamentaltree-gyn

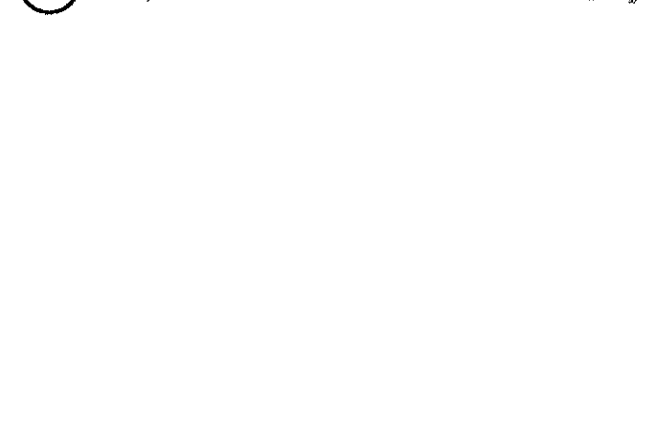

ARBORTIE BY DEEPROOT IN TRIPLICATE

TREE TRUNK

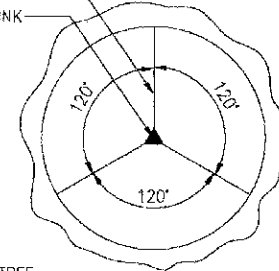

SINGLE - TRUNKED TREE
PLAN VIEW

1. THE LANDSCAPE CONTRACTOR SHALL BE RESPONSIBLE FOR MAKING HIMSELF FAMILIAR WITH ALL UNDERGROUND UTILITIES AND STRUCTURES. SEE CONSTRUCTION NOTES.

2. DO NOT WILLFULLY PROCEED WITH PLANTINGS AS DESIGNED WHEN IT IS OBVIOUS THAT OBSTRUCTIONS AND/OR GRADE DIFFERENCES EXIST THAT MAY NOT HAVE BEEN KNOWN DURING THE DESIGN PROCESS. SUCH CONDITIONS SHALL BE IMMEDIATELY BROUGHT TO THE ATTENTION OF THE PROJECT MANAGER. THE LANDSCAPE CONTRACTOR WILL BE HELD RESPONSIBLE FOR ANY NECESSARY REVISIONS AND COSTS DUE TO FAILURE TO GIVE SUCH NOTIFICATION.

3. THE LANDSCAPE CONTRACTOR SHALL BE RESPONSIBLE FOR ANY COORDINATION WITH SUBCONTRACTORS AND/OR SUPPLIERS AS REQUIRED TO ACCOMPLISH PLANTING OPERATIONS.

4. REFER TO SPECIFICATIONS FOR PLANTING REQUIREMENTS, MATERIALS, AND EXECUTION.

5. FINAL LOCATION OF ALL PLANT MATERIAL SHALL BE SUBJECT TO APPROVAL OF THE PROJECT MANAGER PRIOR TO DIGGING ANY HOLES. THE LANDSCAPE CONTRACTOR IS RESPONSIBLE FOR PROVIDING PROJECT MANAGER ADEQUATE ADVANCE NOTICE FOR ON-SITE APPROVALS. THE LANDSCAPE CONTRACTOR IS TO THE FOLLOWING BEFORE BEGINNING INSTALLING PLANTINGS:

SHRUBS - LAY OUT THE ACTUAL CONTAINERS ON-SITE BEFORE DIGGING HOLES.

TREES - STAKE THE LOCATIONS BEFORE DIGGING HOLES. ANY TREE PLANTED WITHOUT ITS FINAL LOCATION APPROVED BY THE PROJECT MANAGER MAY BE REQUESTED TO BE RELOCATED AT THE SOLE EXPENSE OF THE LANDSCAPE CONTRACTOR.

6. THE LANDSCAPE CONTRACTOR SHALL NOTIFY THE PROJECT MANAGER AT LEAST 48 HOURS IN ADVANCE PRIOR TO COMMENCEMENT OF WORK TO COORDINATE PROJECT OBSERVATION SCHEDULES.

7. IF CONFLICTS ARISE BETWEEN THE ACTUAL SIZE OF AREAS ON THE SITE AND THE DRAWINGS, CONTACT THE PROJECT MANAGER FOR RESOLUTION.

8. IT IS THE LANDSCAPE CONTRACTOR'S OBLIGATION TO WARRANTY ALL PLANT MATERIAL PER THE SPECIFICATIONS.

9. GROUNDCOVERS AND SHRUBS ARE TO BE TRIANGULARLY SPACED UNLESS INDICATED ON THE PLANS.

10. ALL TREES WITHIN A SPECIES SHALL HAVE MATCHING FORM, UNLESS OTHERWISE NOTED.

11. ALL TREES, SHRUB AND GROUND COVER AREAS (EXCLUDING TURF AND SLOPE AREAS) ARE TO BE MULCHED PER DETAILS. ALL MULCH TO BE SHREDDED HARDWOOD MULCH.

12. TREES SHALL BE SET BACK A MINIMUM OF TEN FEET (10') HORIZONTALLY FROM UTILITY STRUCTURES, INCLUDING, BUT NOT LIMITED TO, MANHOLES, VALVE VAULTS, VALVE BOXES, FIRE HYDRANTS, TRANSFORMERS AND SWITCH CANS. TREES SHALL BE SET BACK A MINIMUM OF FIVE (5') HORIZONTALLY FROM SANITARY SEWER AND WATER SERVICES. CONTRACTOR TO MAKE NECESSARY ADJUSTMENTS UNDER THE APPROVAL OF OWNER. REFER TO CIVIL DRAWINGS PREPARED BY OTHERS.

8 PLANTING NOTES

SCALE: NTS

DT-plantnote-gyn

4 PLANT SPACING DETAIL

SCALE: 1/2"=1'-0"

DT-plantspace-gyn

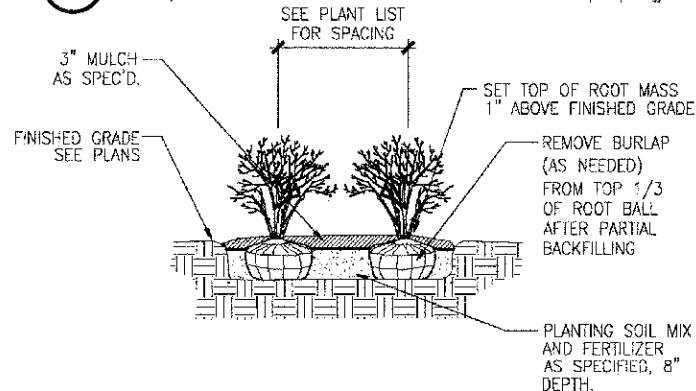

ALL PLANTS TO BE INSTALLED IN STAGGERED ROWS UNLESS OTHERWISE NOTED ON PLANS

7 SHRUB PLANTING DETAIL

SCALE: 1/2"=1'-0"

DT-shrub-gyn

