

F.A.U. RTE.	SECTION	COUNTY	TOTAL SHEETS	SHEET NO.
5885	11-00064-00-RP	HENRY	99	1

S21, T17N, R3E

99+1 = 100

STATE OF ILLINOIS
DEPARTMENT OF TRANSPORTATION



DIVISION OF HIGHWAYS
**PROPOSED
HIGHWAY PLANS**

FAU 5665 (STATE STREET)
SECTION 11-00064-00-RP
PROJECT M-5026 (012)
SOUTH STATE STREET RECONSTRUCTION
CITY OF GENESEO
JOB NO. C-92-117-12
CITY OF GENESEO

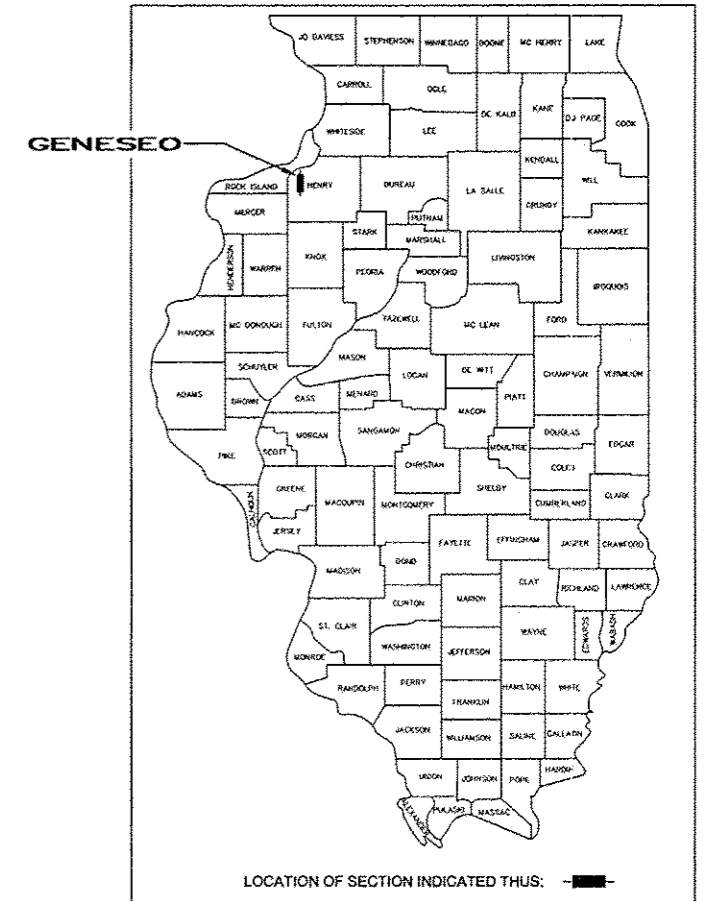

PRINTED BY THE AUTHORITY
OF THE STATE OF ILLINOIS

STATE OF ILLINOIS
DEPARTMENT OF TRANSPORTATION

APPROVED *[Signature]* 2013
LOCAL AGENCY OFFICIAL

PASSED *[Signature]* 20
DISTRICT ENGINEER-LOCAL ROADS AND STREETS

RELEASING FOR BID
BASED ON
LIMITED REVIEW *[Signature]* 20
DEPUTY DIRECTOR OF HIGHWAYS/REGION 2 ENGINEER

I hereby certify that this plan was prepared by me or under my direct personal supervision and that I am a duly licensed Professional Engineer under the laws of the State of Illinois.

[Signature] 2-21-13
Date

Jason L. McKenzie
License No. 092-058089
My license renewal date is November 30, 2013
Pages or sheets covered by this seal: *CS, SL, 99*

UTILITY NOTE

THE LOCATIONS OF THOSE BURIED AND ABOVE GROUND UTILITIES SHOWN ARE APPROXIMATE, ARE SHOWN FOR CONTRACTOR INFORMATIONAL USE ONLY, AND ARE NOT TO BE REFERENCED FOR CONSTRUCTION PURPOSES. THE IMPLIED PRESENCE OR ABSENCE OF UTILITIES IS NOT TO BE CONSTRUED BY THE OWNER, ENGINEER, CONTRACTOR, OR SUBCONTRACTORS TO BE AN ACCURATE AND COMPLETE REPRESENTATION OF UTILITIES THAT MAY OR MAY NOT EXIST ON THE CONSTRUCTION SITE. BURIED AND ABOVE GROUND UTILITY LOCATION, IDENTIFICATION, AND MARKING ARE THE SOLE RESPONSIBILITY OF THE CONTRACTOR. REROUTING, DISCONNECTION, PROTECTION, ETC. OF ANY UTILITY MUST BE COORDINATED BETWEEN THE CONTRACTOR, UTILITY COMPANY AND OWNER. SITE SAFETY, INCLUDING THE AVOIDANCE OF HAZARDS ASSOCIATED WITH BURIED AND ABOVEGROUND UTILITIES, REMAINS THE SOLE RESPONSIBILITY OF THE CONTRACTOR.

INDEX OF SHEETS	
SHT NO	TITLE
1	COVER SHEET
2	HIGHWAY STANDARDS AND GENERAL NOTES
3	SUMMARY OF QUANTITIES
4-8	SCHEDULE OF QUANTITIES
9-13	TYPICAL SECTIONS
14	HORIZONTAL AND VERTICAL CONTROL
15-21	TRAFFIC CONTROL PLAN
22-23	REMOVAL PLAN
24-28	PAVEMENT - PLAN AND PROFILE SHEETS
29-33	DRAINAGE - PLAN AND PROFILE SHEETS
34-39	UTILITY - PLAN AND PROFILE SHEETS
40-41	EROSION AND SEDIMENT CONTROL PLAN
42-43	PAVEMENT JOINTS
44-52	PAVEMENT AND SIDEWALK ELEVATIONS
53-54	PAVEMENT MARKING PLAN
55	TRAFFIC SIGNAL PLAN
56-57	LANDSCAPING PLAN
58-60	IRRIGATION PLAN
61-66	DISTRICT STANDARDS
67-68	SPECIAL DETAILS
69-99	CROSS SECTIONS

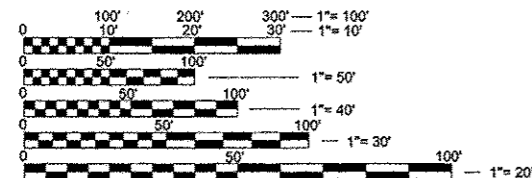

FULL SIZE PLANS HAVE BEEN PREPARED USING STANDARD ENGINEERING SCALES. REDUCED SIZED PLANS WILL NOT CONFORM TO STANDARD SCALES. IN MAKING MEASUREMENTS ON REDUCED PLANS, THE ABOVE SCALES MAY BE USED.

J.U.L.I.E.
JOINT UTILITY LOCATION INFORMATION FOR EXCAVATION
1-800-892-0123

CONTRACT NO. 85576

MISSMAN, INC. HAS ADOPTED SAFETY PROCEDURES FOR ITS EMPLOYEES WHO PROVIDE PROFESSIONAL ENGINEERING AND SURVEYING SERVICES. A COPY OF THESE PROCEDURES IS AVAILABLE FROM THE SAFETY OFFICER. MISSMAN, INC. PERSONNEL ARE NOT TRAINED IN CONTRACTOR (CONSTRUCTION) SAFETY AND COMPLIANCE PROCEDURES. THE METHODS AND MEANS TO COMPLY WITH CONSTRUCTION SITE SAFETY ARE THE SOLE RESPONSIBILITY OF THE CONTRACTOR.



Know what's below.
Call before you dig.
OR CALL:
800-892-0123

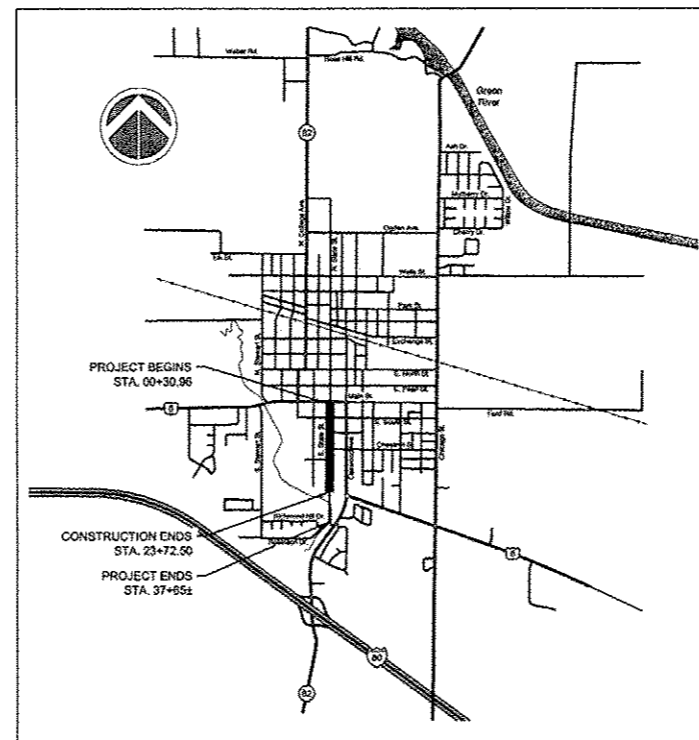

LOCATION MAP
NO SCALE

CONSTRUCTION LENGTH = 2,342 FEET / 0.44 MILES
PROJECT LENGTH = 3,734 FEET / 0.71 MILES

20 YR ADT : 3,150 (1% TRUCKS FOR DESIGN)
(0% TRUCKS BY ORDINANCE)
RTE CLASS : MINOR ARTERIAL
DESIGN SPEED : 30 MPH

PREPARED BY



Rock Island, IL • Bettendorf, IA • Rockford, IL • Sycamore, IL
(309) 788-7844 • (563) 344-0280 • (815) 965-0400 • (815) 895-3825
www.missman.com