

STATE OF ILLINOIS  
DEPARTMENT OF TRANSPORTATION

F.A.P. RTE.	SECTION	COUNTY	TOTAL SHEETS	SHEET NO.
312	(74-1,75,75-1)RS-4	RANDOLPH	15	1
		ILLINOIS	CONTRACT NO. 76T60	

FOR INDEX OF SHEETS, SEE SHEET NO. 2

ADT  
OTHER PRINCIPAL ARTERIAL  
2021 ADT = 3150 (ACTUAL)  
2024 ADT = 3250 (ESTIMATED)  
2044 ADT = 4000 (ESTIMATED)  
SU = 3.5% MU = 6.3%

# PROPOSED HIGHWAY PLANS

FAP ROUTE 312 (IL 003)  
SECTION (74-1,75,75-1)RS-4  
PROJECT NHPP-SKS3(675)  
ULTRA-THIN BONDED WEARING COURSE  
RANDOLPH COUNTY

C-98-094-24

END PROJECT  
STA: 481+03.00  
LAT: 38°1'5.98"N  
LON: 89°54'28.69"W

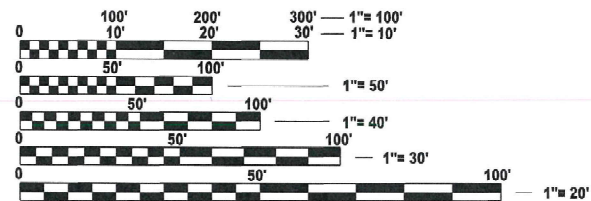

FULL SIZE PLANS HAVE BEEN PREPARED USING STANDARD ENGINEERING SCALES. REDUCED SIZED PLANS WILL NOT CONFORM TO STANDARD SCALES. IN MAKING MEASUREMENTS ON REDUCED PLANS, THE ABOVE SCALES MAY BE USED.

J.U.L.I.E.  
JOINT UTILITY LOCATION INFORMATION FOR EXCAVATION  
1-800-892-0123  
OR 811

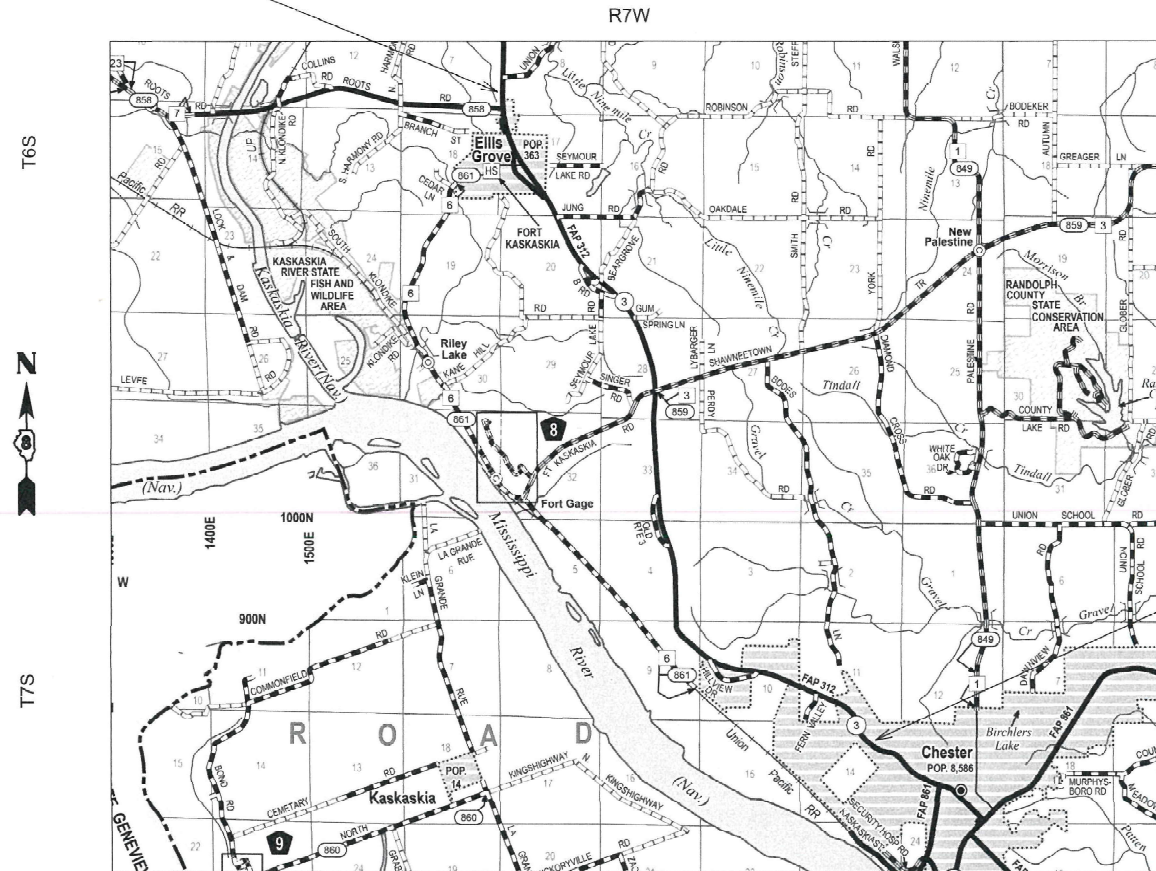

BEGIN PROJECT  
STA: 611+00.00  
LAT: 37°55'38.57"N  
LON: 89°50'36.68"W

PROJECT ENGINEER : BILLIE OWEN  
PROJECT MANAGER : MIKE BERG

GROSS LENGTH = 42,003.0 FT. = 7.96 MILE  
NET LENGTH = 42,003.0 FT. = 7.96 MILE

CONTRACT NO. 76T60

STATE OF ILLINOIS  
DEPARTMENT OF TRANSPORTATION

SUBMITTED JANUARY 26 20 24

*Kurt B. Brown*  
REGIONAL ENGINEER

March 22, 2024  
*John A. Etk*  
ENGINEER OF DESIGN AND ENVIRONMENT

March 22, 2024  
*Stephen M. Smith*  
DIRECTOR OF HIGHWAYS PROJECT IMPLEMENTATION

PRINTED BY THE AUTHORITY  
OF THE STATE OF ILLINOIS

**INDEX OF SHEETS**

- 1. COVER SHEET
- 2. INDEX OF SHEETS, STANDARDS, GENERAL NOTES, COMMITMENTS
- 3. SUMMARY OF QUANTITIES
- 4-7. EXISTING TYPICAL SECTIONS
- 8-11. PROPOSED TYPICAL SECTIONS
- 12-13. SCHEDULES
- 14-15. LOCATION MAP

**STANDARDS**

- 000001-08
- 001006
- 642006-01
- 701001-02
- 701006-05
- 701301-04
- 701306-04
- 701501-06
- 701311-03
- 701901-09
- 780001-05
- 781001-04

**GENERAL NOTES**

- 1. UTILITIES KNOWN TO HAVE FACILITIES WITHIN THE PROJECT AREA ARE AS FOLLOWS:

AMEREN ILLINOIS  
 CITY OF CHESTER  
 CLEARWAVE FIBER LLC  
 EGYPTIAN ELECTRIC COOPERATIVE ASSOCIATION  
 VILLAGE OF ELLIS GROVE  
 FRONTIER COMMUNICATIONS  
 NEWWAVE COMMUNICATIONS

- 2. NO SURVEY WAS PERFORMED FOR THIS PROJECT AND THE PLANS WERE CREATED USING MICROFILM AND FIELD MEASUREMENTS.
- 3. TWO CHANGEABLE MESSAGE SIGNS SHALL BE REQUIRED FOR THIS PROJECT. THEY SHALL BE PLACED TWO WEEKS PRIOR TO ANY LANE CLOSURE AND SHALL REMAIN UP FOR THE DURATION OF THE PROJECT. THE CHANGEABLE MESSAGE SIGNS SHALL BE PLACED AT THE DIRECTION OF THE ENGINEER.
- 4. THE USE OF VIBRATORY ROLLERS WILL NOT BE PERMITTED WITHIN THE CITY LIMITS OF CHESTER. THIS DOES NOT RELIEVE THE CONTRACTOR OF DENSITY REQUIREMENTS FOR THE CONSTRUCTION OF THE BITUMINOUS PAVEMENTS AS SPECIFIED IN SECTIONS 406 & 407 OF THE STANDARD SPECIFICATIONS
- 5. THE RESIDENT ENGINEER SHALL VERIFY THE EXISTENCE OF HIGHWAY LIGHTING, INTELLIGENT TRANSPORTATION SYSTEMS (I.T.S.) UTILITIES, AND/OR ELECTRICAL CABLES ASSOCIATED WITH TRAFFIC SIGNALS WITHIN THE PROJECT LIMITS. IF ANY OF THESE EXIST WITHIN THE PROJECT LIMITS, AND IF THESE ITEMS REQUIRE LOCATING, THE CONTRACTOR SHALL BE DIRECTED TO DO SO ACCORDING TO SECTION 803 OF THE STANDARD SPECIFICATIONS. THIS WORK SHALL BE PAID FOR ACCORDING TO ARTICLE 109.04 OF THE STANDARD SPECIFICATIONS.
- 6. THE FOLLOWING MIXTURE REQUIREMENT IS APPLICABLE FOR THIS PROJECT.

MIXTURE USE :	ULTRA-THIN BWC
AC/PG :	
DESIGN AIR VOIDS :	
MIX COMPOSITION :	IL 9.5 UTB
FRICITION AGG :	MIXTURE "E"

**COMMITMENTS**

NONE

REV. - MS

MODEL: Unlited [Sheet]  
 FILE NAME: c:\pwworking\robert.hughes@illinois.gov\40633007\08760-shr-gemote.dgn

USER NAME = Robert Hughes	DESIGNED -	REVISED -
	DRAWN -	REVISED -
PLOT SCALE = 0.16666633 / in.	CHECKED -	REVISED -
PLOT DATE = 1/23/2024	DATE -	REVISED -

**STATE OF ILLINOIS  
 DEPARTMENT OF TRANSPORTATION**

**INDEX OF SHEETS, STANDARDS, GENERAL NOTES  
 AND COMMITMENTS**

SCALE: NTS SHEET 1 OF 1 SHEETS STA. TO STA.

F.A.P. RTE.	SECTION	COUNTY	TOTAL SHEETS	SHEET NO.
312	(74-1,75,75-1)RS-4	RANDOLPH	15	2
CONTRACT NO. 76T60				
ILLINOIS FED. AID PROJECT				

MODEL: I:\united [Sheet]  
 FILE NAME: c:\p\work\paw\robert.hughes@illinois.gov\0933007\08760-shr-SCQ.dgn

CODE NO.	ITEM	UNIT	TOTAL QUANTITY	CONSTRUCTION CODE					
				80% FED 20% STATE ROADWAY 0005 RURAL	80% FED 20% STATE ROADWAY 0005 URBAN				
				40600250	RAPID SETTING POLYMER MODIFIED EMULSION	POUND	178753	136409	42344
				44000152	HOT-MIX ASPHALT SURFACE REMOVAL, 3/4"	SQ YD	148961	113674	35287
64200108	SHOULDER RUMBLE STRIPS, 8 INCH	FOOT	84006	64106	19900				
67100100	MOBILIZATION	L SUM	1	0.76	0.24				
70100460	TRAFFIC CONTROL AND PROTECTION, STANDARD 701306	L SUM	1	0.76	0.24				
70102620	TRAFFIC CONTROL AND PROTECTION, STANDARD 701501	L SUM	1		1				
70107025	CHANGEABLE MESSAGE SIGN	CAL DA	138	105	33				
70300100	SHORT TERM PAVEMENT MARKING	FOOT	4200	3205	995				
70300150	SHORT TERM PAVEMENT MARKING REMOVAL	SQ FT	1400	1068	332				
* 78000400	THERMOPLASTIC PAVEMENT MARKING - LINE 6"	FOOT	139944	105979	33965				
* 78100100	RAISED REFLECTIVE PAVEMENT MARKER	EACH	525	400	125				
78300200	RAISED REFLECTIVE PAVEMENT MARKER REMOVAL	EACH	525	400	125				
X0300032	ULTRA-THIN BONDED WEARING COURSE, IL-9.5 UTB, MIX "E"	SQ YD	148961	113674	35287				
∅ Z0076600	TRAINEES	HOUR	1500	1500					
∅ Z0076604	TRAINEES TRAINING PROGRAM GRADUATE	HOUR	1500	1500					

\* SPECIALTY ITEM  
 ∅ 0042

REV. - MS

USER NAME = Robert.Hughes	DESIGNED -	REVISED -	<b>STATE OF ILLINOIS DEPARTMENT OF TRANSPORTATION</b>	<b>SUMMARY OF QUANTITIES</b>			F.A.P. RTE.	SECTION	COUNTY	TOTAL SHEETS	SHEET NO.	
PLOT SCALE = 0.16666633 1/in.	DRAWN -	REVISED -					312	(74-1,75,75-1)RS-4	RANDOLPH	15	3	
PLOT DATE = 1/22/2024	CHECKED -	REVISED -		SCALE:	SHEET 1	OF 1	SHEETS	STA.	TO STA.	CONTRACT NO. 76T60		
	DATE -	REVISED -		ILLINOIS   FED. AID PROJECT								

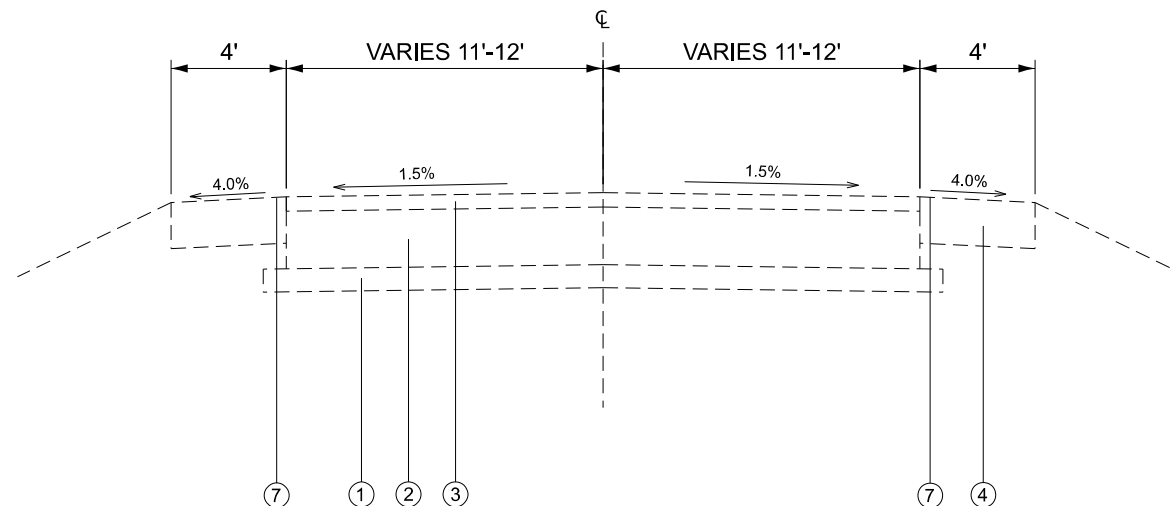

**IL ROUTE 3**

- STA. 79+82 TO STA. 113+03
- STA. 124+70 TO STA. 132+46
- STA. 156+13 TO STA. 164+92
- STA. 189+43 TO STA. 200+32
- STA. 237+93 TO STA. 253+09
- STA. 273+86 TO STA. 279+45
- STA. 287+54 TO STA. 295+61
- \* 12': STA. 317+98 TO STA. 329+39
- STA. 362+53 TO STA. 367+71
- STA. 394+65 TO STA. 411+08
- STA. 423+17 TO STA. 443+02
- STA. 472+87 TO STA. 481+03

**LEGEND**

1. SUB-BASE GRANULAR MATERIAL
2. EXISTING PCC PAVEMENT 10"
3. EXISTING HMA SURFACE COURSE 2 1/2"
4. EXISTING HMA SHOULDER 8"
5. EXISTING PCC WIDENING
6. EXISTING STEEL PLATE BEAM GUARDRAIL TYP A, 6' POST
7. EXISTING SHOULDER RUMBLE STRIPS 8"
8. PROPOSED ULTRA-THIN BONDED WEARING COURSE
9. PROPOSED SHOULDER RUMBLE STRIPS 8"

MODEL: Typical 1 [Sheet]  
 FILE NAME: c:\p\work\p\robert.hughes@illinois.gov\40933007\0876160-shr-typical.dgn

USER NAME = Robert.Hughes	DESIGNED -	REVISED -
	DRAWN -	REVISED -
PLOT SCALE = 0.16666633' / in.	CHECKED -	REVISED -
PLOT DATE = 1/23/2024	DATE -	REVISED -

**STATE OF ILLINOIS  
DEPARTMENT OF TRANSPORTATION**

**EXISTING TYPICAL SECTIONS**

SCALE: NTS SHEET 1 OF 4 SHEETS STA. TO STA.

F.A.P. RTE.	SECTION	COUNTY	TOTAL SHEETS	SHEET NO.
312	(74-1,75,75-1)RS-4	RANDOLPH	15	4
CONTRACT NO. 76T60				
ILLINOIS FED. AID PROJECT				



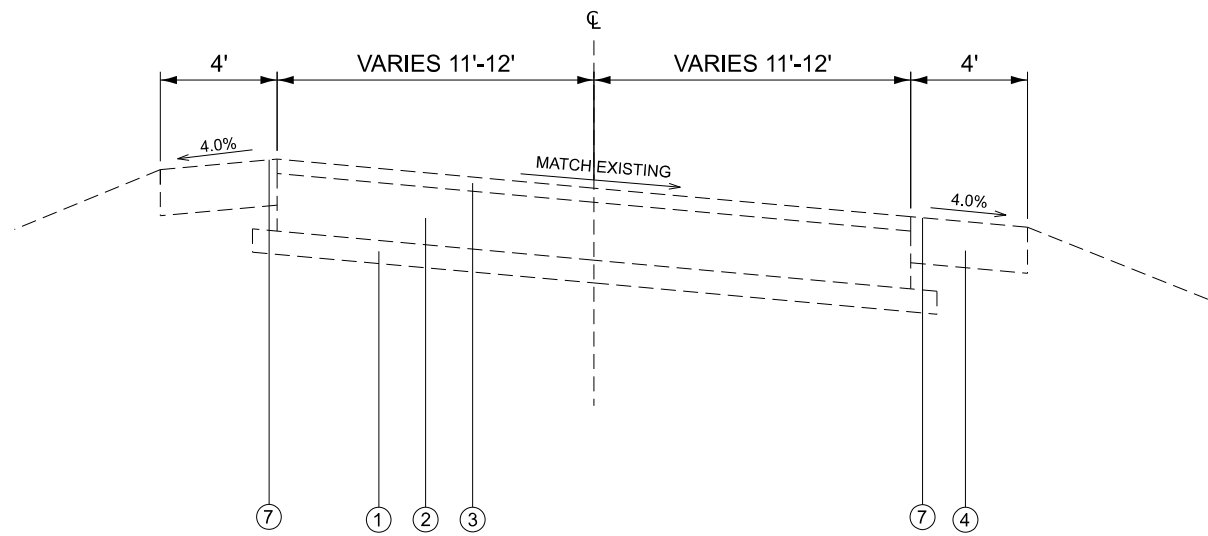

**IL ROUTE 3**  
 STA. 132+46 TO STA. 156+13  
 STA. 224+07 TO STA. 237+93  
 STA. 279+45 TO STA. 287+54  
 \*12': STA. 367+71 TO STA. 394+65  
 STA. 443+02 TO STA. 472+87

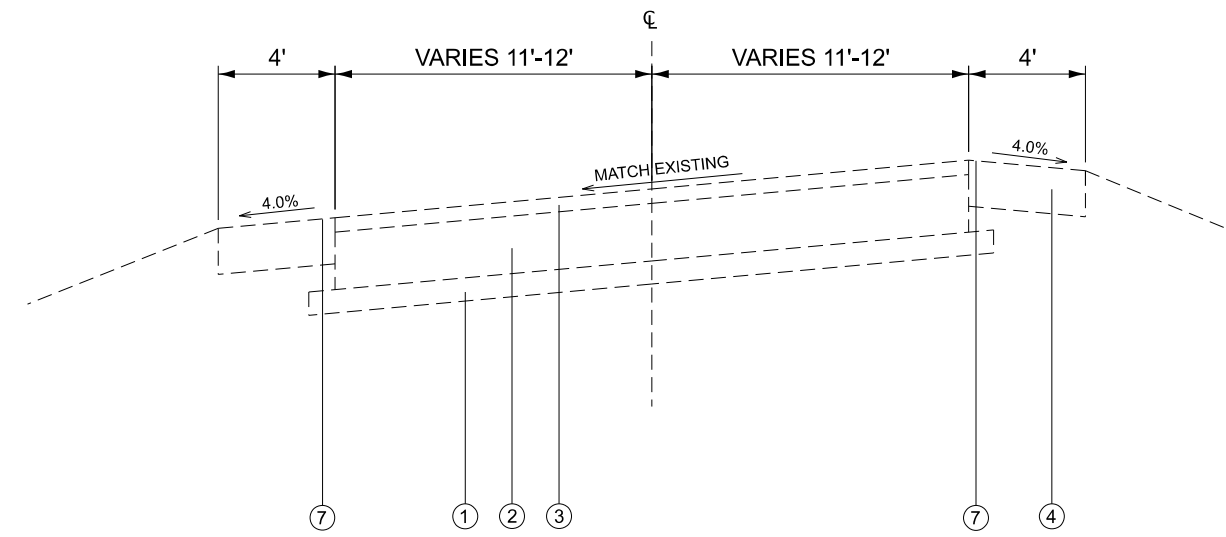

**IL ROUTE 3**  
 STA. 61+00 TO STA. 74+46  
 STA. 113+13 TO STA. 124+70  
 STA. 200+32 TO STA. 224+07  
 STA. 295+61 TO STA. 317+98  
 \*12': STA. 329+39 TO STA. 362+53  
 \*12': STA. 411+08 TO STA. 423+17

**LEGEND**

1. SUB-BASE GRANULAR MATERIAL
2. EXISTING PCC PAVEMENT 10"
3. EXISTING HMA SURFACE COURSE 2 1/2"
4. EXISTING HMA SHOULDER 8"
5. EXISTING PCC WIDENING
6. EXISTING STEEL PLATE BEAM GUARDRAIL TYP A, 6' POST
7. EXISTING SHOULDER RUMBLE STRIPS 8"
8. PROPOSED ULTRA-THIN BONDED WEARING COURSE
9. PROPOSED SHOULDER RUMBLE STRIPS 8"

MODEL: Typical 2 (Sheet)  
 FILE NAME: c:\p\work\pvd\robert.hughes@illinois.gov\40933007\0876160-sh-typical.dgn

USER NAME = Robert.Hughes	DESIGNED -	REVISED -
	DRAWN -	REVISED -
PLOT SCALE = 0.16666633' / in.	CHECKED -	REVISED -
PLOT DATE = 1/23/2024	DATE -	REVISED -

**STATE OF ILLINOIS  
 DEPARTMENT OF TRANSPORTATION**

**EXISTING TYPICAL SECTIONS**

SCALE: SHEET 2 OF 4 SHEETS STA. TO STA.

F.A.P. RTE.	SECTION	COUNTY	TOTAL SHEETS	SHEET NO.
312	(74-1,75,75-1)RS-4	RANDOLPH	15	5
CONTRACT NO. 76T60				
ILLINOIS FED. AID PROJECT				

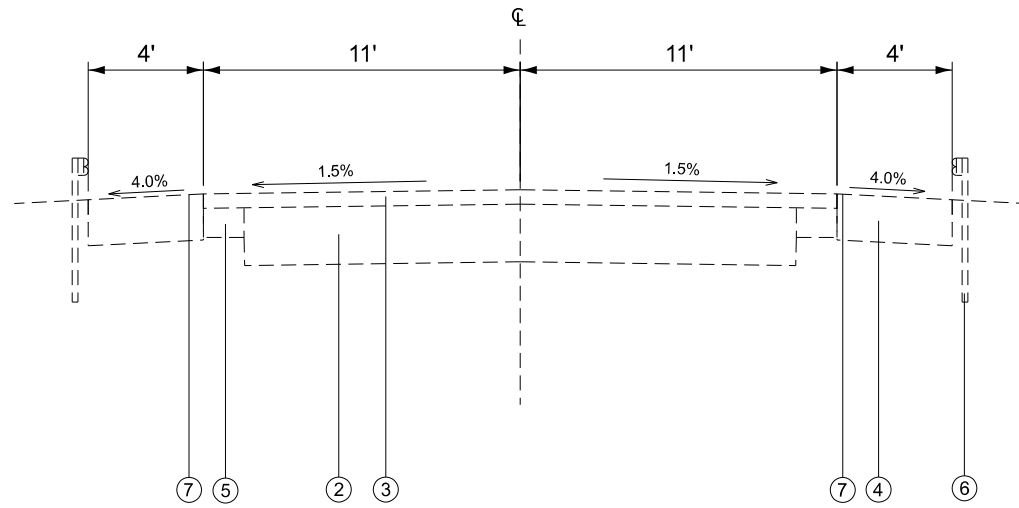

IL ROUTE 3  
STA. 253+09 TO STA. 259+39

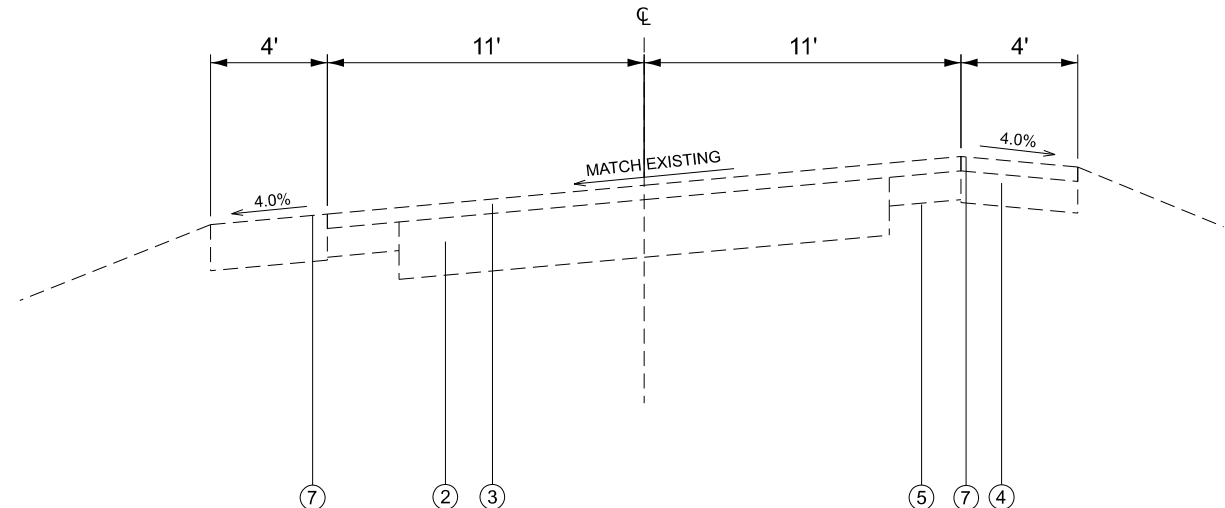

IL ROUTE 3  
74+46 TO 77+72

LEGEND

1. SUB-BASE GRANULAR MATERIAL
2. EXISTING PCC PAVEMENT 10"
3. EXISTING HMA SURFACE COURSE 2 1/2"
4. EXISTING HMA SHOULDER 8"
5. EXISTING PCC WIDENING
6. EXISTING STEEL PLATE BEAM GUARDRAIL TYP A, 6' POST
7. EXISTING SHOULDER RUMBLE STRIPS 8"
8. PROPOSED ULTRA-THIN BONDED WEARING COURSE
9. PROPOSED SHOULDER RUMBLE STRIPS 8"

MODEL: Typical 3 (Sheet)  
FILE NAME: c:\pwworking\dwg\robert.hughes@illinois.gov\40933007\0876160-shr-typical.dgn

USER NAME = Robert.Hughes	DESIGNED -	REVISED -
	DRAWN -	REVISED -
PLOT SCALE = 0.16666633' / in.	CHECKED -	REVISED -
PLOT DATE = 1/23/2024	DATE -	REVISED -

STATE OF ILLINOIS  
DEPARTMENT OF TRANSPORTATION

EXISTING TYPICAL SECTIONS

SCALE: SHEET 3 OF 4 SHEETS STA. TO STA.

F.A.P. RTE.	SECTION	COUNTY	TOTAL SHEETS	SHEET NO.
312	(74-1,75,75-1)RS-4	RANDOLPH	15	6
CONTRACT NO. 76T60				
ILLINOIS FED. AID PROJECT				

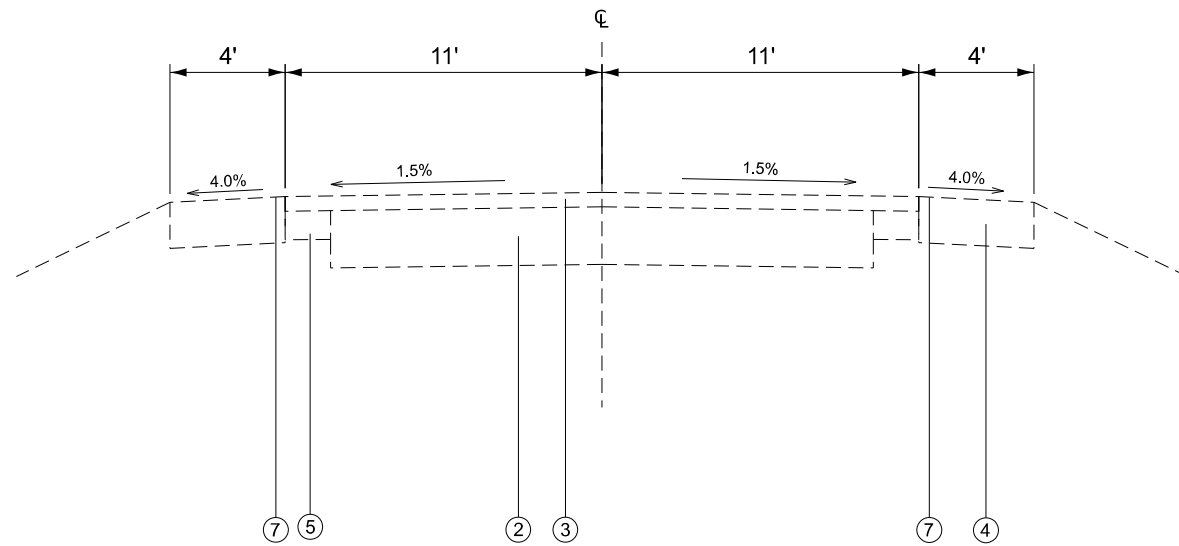

**IL ROUTE 3**

STA. 77+72 TO STA. 79+82  
 STA. 164+92 TO STA. 169+03  
 STA. 177+65 TO STA. 189+43  
 STA. 259+39 TO STA. 273+86

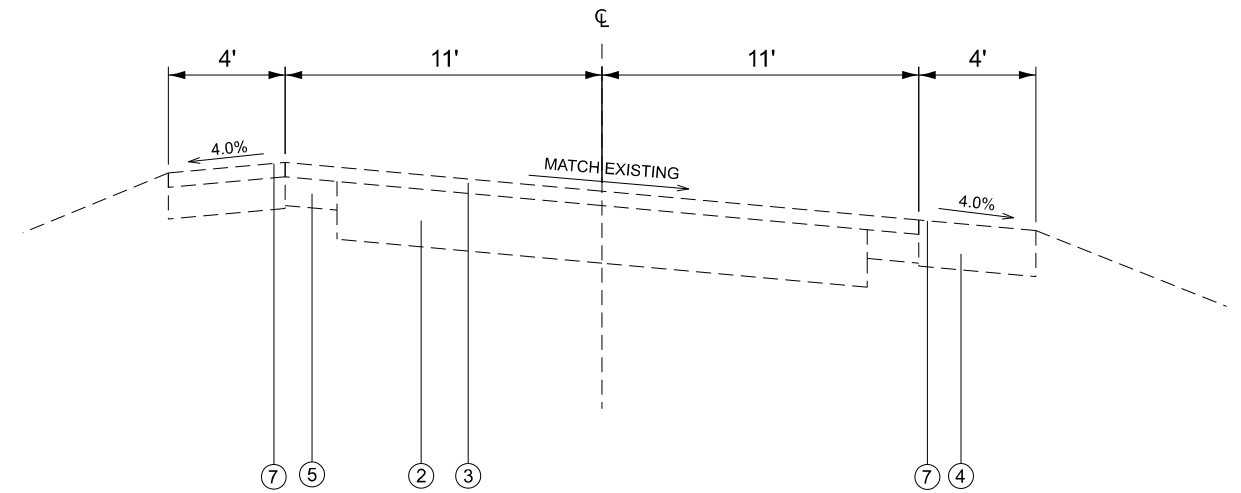

**IL ROUTE 3**

STA. 169+03 TO STA. 177+65

**LEGEND**

1. SUB-BASE GRANULAR MATERIAL
2. EXISTING PCC PAVEMENT 10"
3. EXISTING HMA SURFACE COURSE 2 1/2"
4. EXISTING HMA SHOULDER 8"
5. EXISTING PCC WIDENING
6. EXISTING STEEL PLATE BEAM GUARDRAIL TYP A, 6' POST
7. EXISTING SHOULDER RUMBLE STRIPS 8"
8. PROPOSED ULTRA-THIN BONDED WEARING COURSE
9. PROPOSED SHOULDER RUMBLE STRIPS 8"

MODEL: Typical 4 [Sheet]  
 FILE NAME: c:\p\work\p\rd\robert.hughes@illinois.gov\40933007\0876160-sh-typical.dgn

USER NAME = Robert.Hughes	DESIGNED -	REVISED -
	DRAWN -	REVISED -
PLOT SCALE = 0.16666633' / in.	CHECKED -	REVISED -
PLOT DATE = 1/23/2024	DATE -	REVISED -

**STATE OF ILLINOIS  
 DEPARTMENT OF TRANSPORTATION**

**EXISTING TYPICAL SECTIONS**

SCALE: SHEET 4 OF 4 SHEETS STA. TO STA.

F.A.P. RTE.	SECTION	COUNTY	TOTAL SHEETS	SHEET NO.
312	(74-1,75,75-1)RS-4	RANDOLPH	15	7
CONTRACT NO. 76T60				
ILLINOIS FED. AID PROJECT				

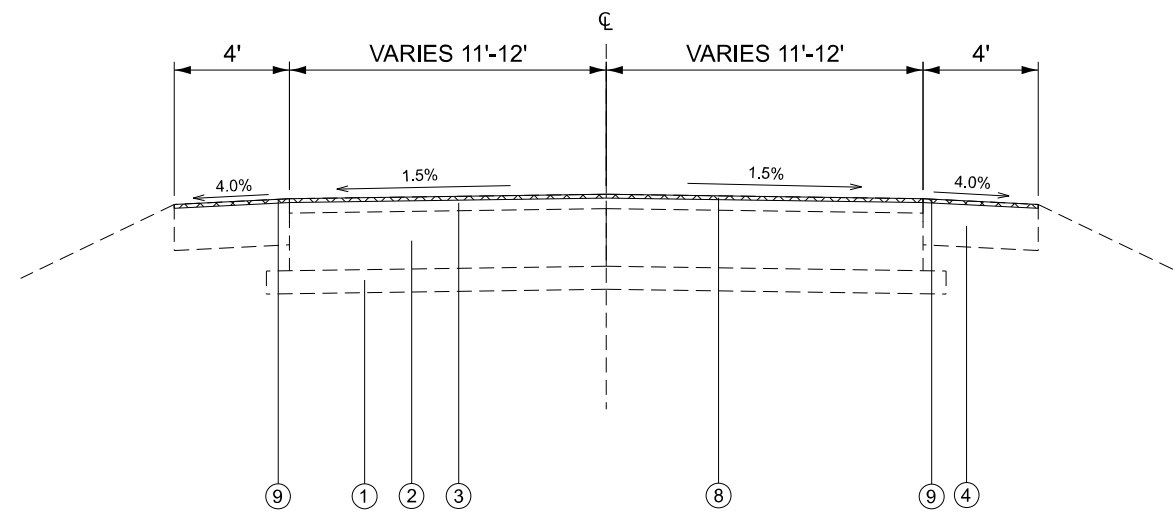

**IL ROUTE 3**

- STA. 79+82 TO STA. 113+03
- STA. 124+70 TO STA. 132+46
- STA. 156+13 TO STA. 164+92
- STA. 189+43 TO STA. 200+32
- STA. 237+93 TO STA. 253+09
- STA. 273+86 TO STA. 279+45
- STA. 287+54 TO STA. 295+61
- \* 12': STA. 317+98 TO STA. 329+39
- STA. 362+53 TO STA. 367+71
- STA. 394+65 TO STA. 411+08
- STA. 423+17 TO STA. 443+02
- STA. 472+87 TO STA. 481+03

**LEGEND**

1. SUB-BASE GRANULAR MATERIAL
2. EXISTING PCC PAVEMENT 10"
3. EXISTING HMA SURFACE COURSE 2 1/2"
4. EXISTING HMA SHOULDER 8"
5. EXISTING PCC WIDENING
6. EXISTING STEEL PLATE BEAM GUARDRAIL TYP A, 6' POST
7. EXISTING SHOULDER RUMBLE STRIPS 8"
8. PROPOSED ULTRA-THIN BONDED WEARING COURSE
9. PROPOSED SHOULDER RUMBLE STRIPS 8"

= HMA SURFACE REMOVAL 3/4"

MODEL: Typical 5 (Sheet)  
FILE NAME: c:\p\work\pvt\robert.hughes@illinois.gov\40933007\B876T60-sh-typical.dgn

USER NAME = Robert,Hughes	DESIGNED -	REVISED -
	DRAWN -	REVISED -
PLOT SCALE = 0.16666633' / in.	CHECKED -	REVISED -
PLOT DATE = 1/23/2024	DATE -	REVISED -

**STATE OF ILLINOIS  
DEPARTMENT OF TRANSPORTATION**

**PROPOSED TYPICAL SECTIONS**

SCALE: SHEET 1 OF 4 SHEETS STA. TO STA.

F.A.P. RTE.	SECTION	COUNTY	TOTAL SHEETS	SHEET NO.
312	(74-1,75,75-1)RS-4	RANDOLPH	15	8
CONTRACT NO. 76T60				
ILLINOIS FED. AID PROJECT				

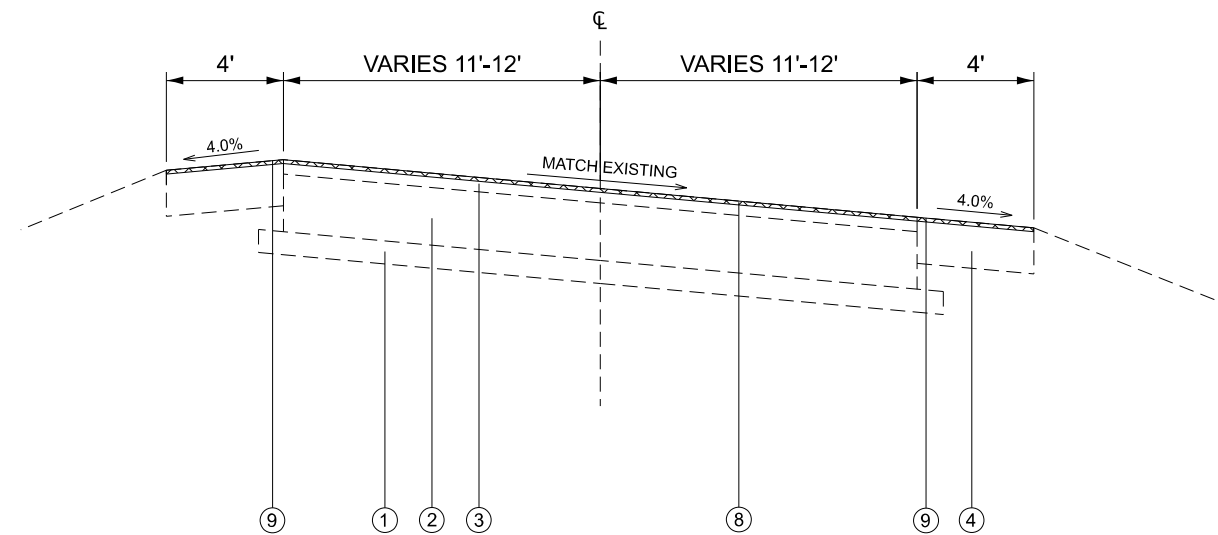

**IL ROUTE 3**

STA. 132+46 TO STA. 156+13  
 STA. 224+07 TO STA. 237+93  
 STA. 279+45 TO STA. 287+54  
 \*12': STA. 367+71 TO STA. 394+65  
 STA. 443+02 TO STA. 472+87

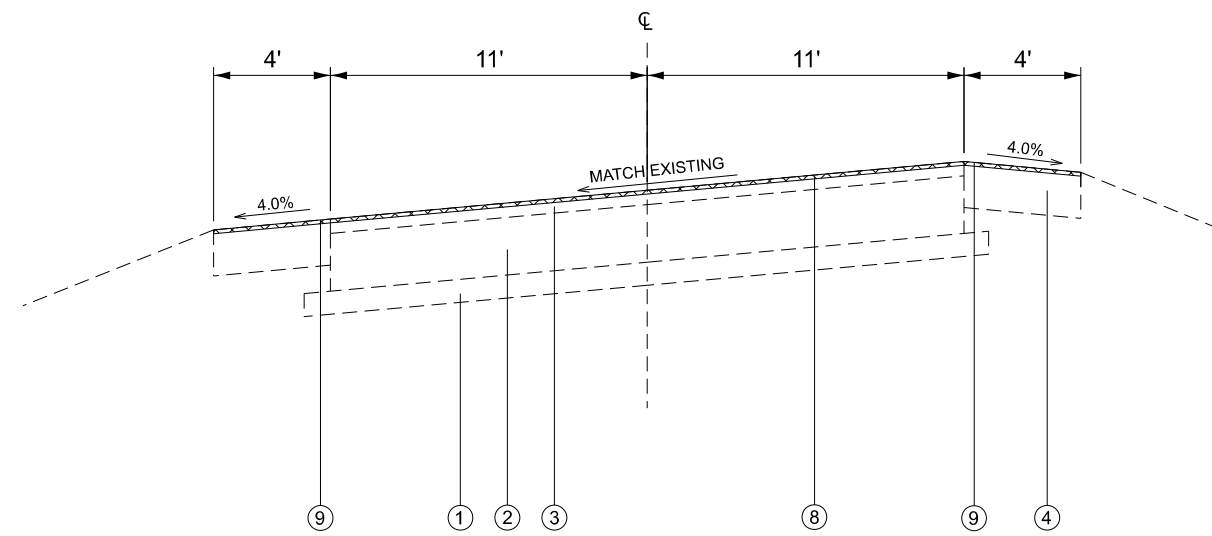

**IL ROUTE 3**

STA. 61+00 TO STA. 74+46  
 STA. 113+13 TO STA. 124+70  
 STA. 200+32 TO STA. 224+07  
 STA. 295+61 TO STA. 317+98  
 \*12': STA. 329+39 TO STA. 362+53  
 \*12': STA. 411+08 TO STA. 423+17

**LEGEND**

1. SUB-BASE GRANULAR MATERIAL
2. EXISTING PCC PAVEMENT 10"
3. EXISTING HMA SURFACE COURSE 2 1/2"
4. EXISTING HMA SHOULDER 8"
5. EXISTING PCC WIDENING
6. EXISTING STEEL PLATE BEAM GUARDRAIL TYP A, 6' POST
7. EXISTING SHOULDER RUMBLE STRIPS 8"
8. PROPOSED ULTRA-THIN BONDED WEARING COURSE
9. PROPOSED SHOULDER RUMBLE STRIPS 8"

= HMA SURFACE REMOVAL 3/4"

MODEL: Typical 6 (Sheet)  
 FILE NAME: c:\p\work\pwr\robert.hughes@illinois.gov\40933007\B876T60-sh-typical.dgn

USER NAME = Robert, Hughes	DESIGNED -	REVISED -
	DRAWN -	REVISED -
PLOT SCALE = 0.16666633' / in.	CHECKED -	REVISED -
PLOT DATE = 1/23/2024	DATE -	REVISED -

**STATE OF ILLINOIS  
 DEPARTMENT OF TRANSPORTATION**

**PROPOSED TYPICAL SECTIONS**

SCALE: SHEET 2 OF 4 SHEETS STA. TO STA.

F.A.P. RTE.	SECTION	COUNTY	TOTAL SHEETS	SHEET NO.
312	(74-1,75,75-1)RS-4	RANDOLPH	15	9
CONTRACT NO. 76T60				
ILLINOIS FED. AID PROJECT				



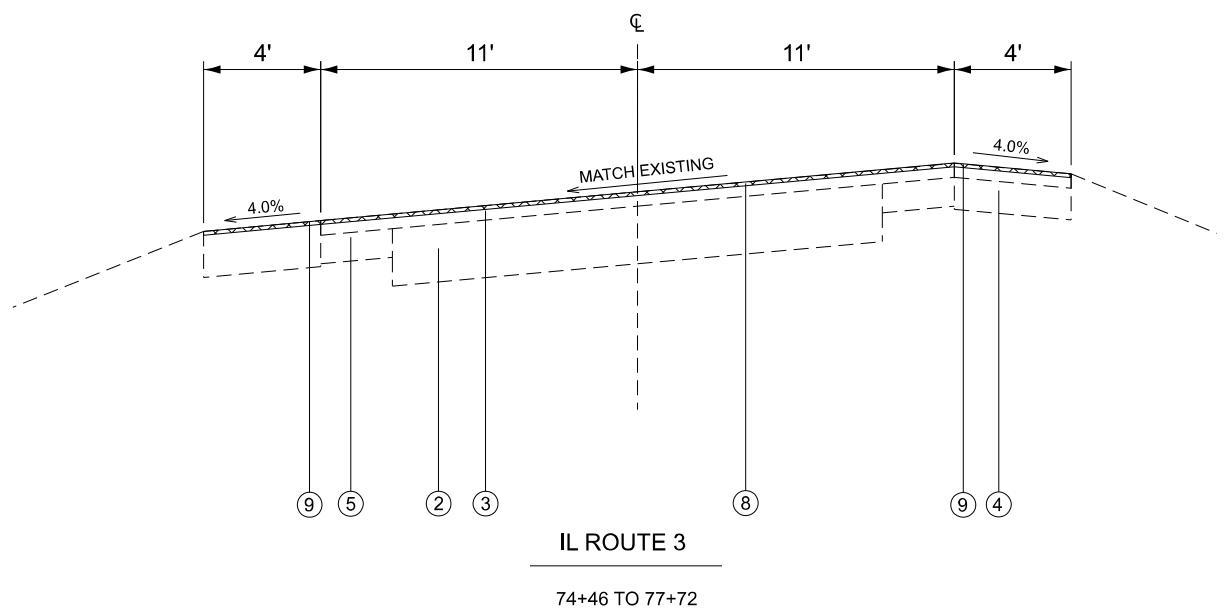
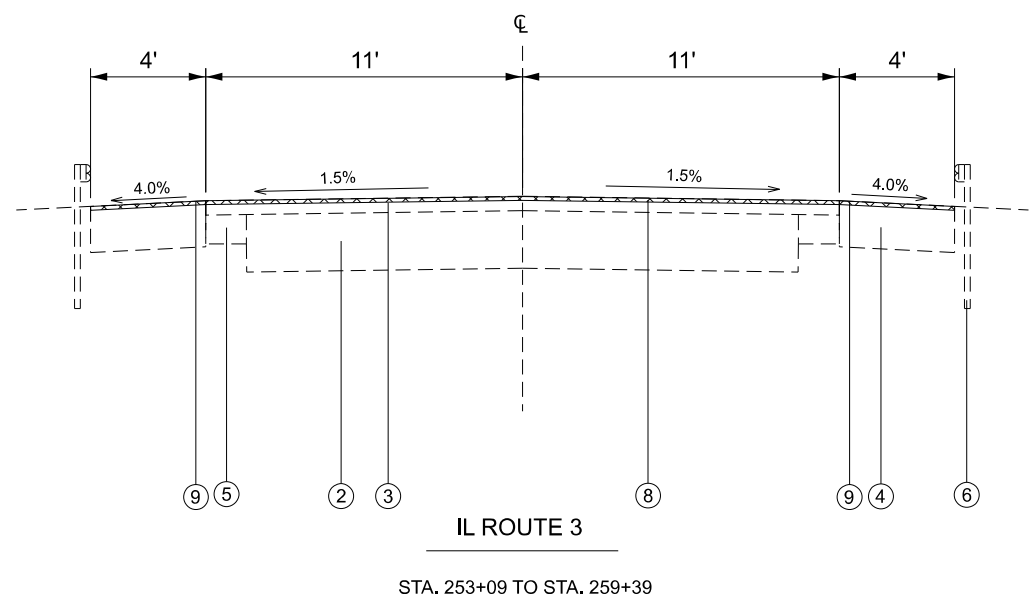

**LEGEND**

- 1. SUB-BASE GRANULAR MATERIAL
- 2. EXISTING PCC PAVEMENT 10"
- 3. EXISTING HMA SURFACE COURSE 2 1/2"
- 4. EXISTING HMA SHOULDER 8"
- 5. EXISTING PCC WIDENING
- 6. EXISTING STEEL PLATE BEAM GUARDRAIL TYP A, 6' POST
- 7. EXISTING SHOULDER RUMBLE STRIPS 8"
- 8. PROPOSED ULTRA-THIN BONDED WEARING COURSE
- 9. PROPOSED SHOULDER RUMBLE STRIPS 8"

= HMA SURFACE REMOVAL 3/4"

MODEL: Typical 7 (Sheet)  
FILE NAME: c:\pwworking\robert.hughes@illinois.gov\d0933007\0876T60-sh-typical.dgn

USER NAME = Robert.Hughes	DESIGNED -	REVISED -
	DRAWN -	REVISED -
PLOT SCALE = 0.16666633' / in.	CHECKED -	REVISED -
PLOT DATE = 1/23/2024	DATE -	REVISED -

**STATE OF ILLINOIS**  
**DEPARTMENT OF TRANSPORTATION**

**PROPOSED TYPICAL SECTIONS**

SCALE: SHEET 3 OF 4 SHEETS STA. TO STA.

F.A.P. RTE.	SECTION	COUNTY	TOTAL SHEETS	SHEET NO.
312	(74-1,75,75-1)RS-4	RANDOLPH	15	10
CONTRACT NO. 76T60				
ILLINOIS FED. AID PROJECT				

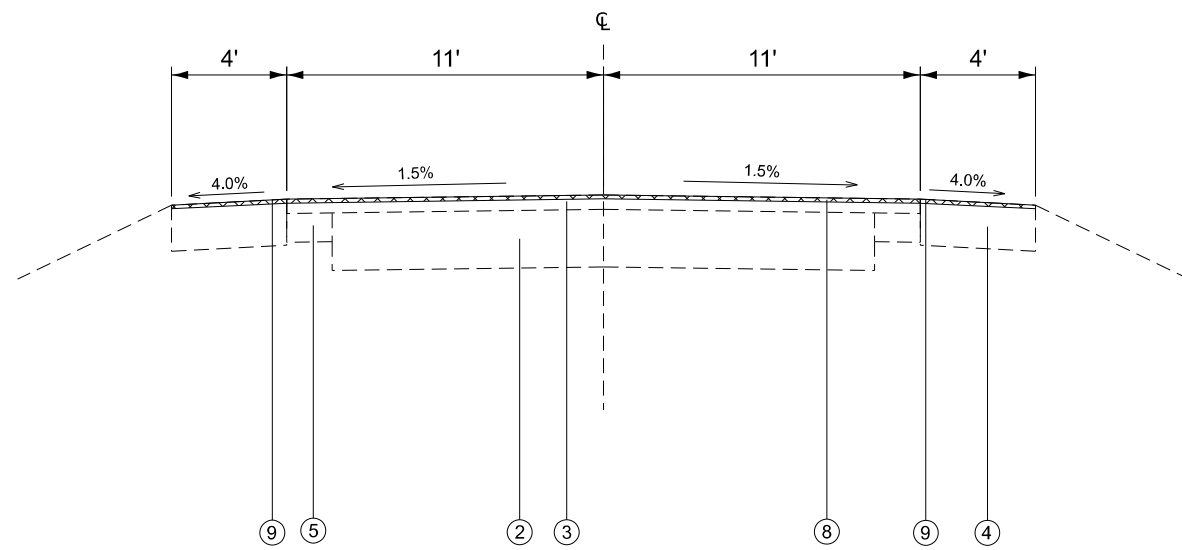

**IL ROUTE 3**  
 STA. 77+72 TO STA. 79+82  
 STA. 164+92 TO STA. 169+03  
 STA. 177+65 TO STA. 189+43  
 STA. 259+39 TO STA. 273+86

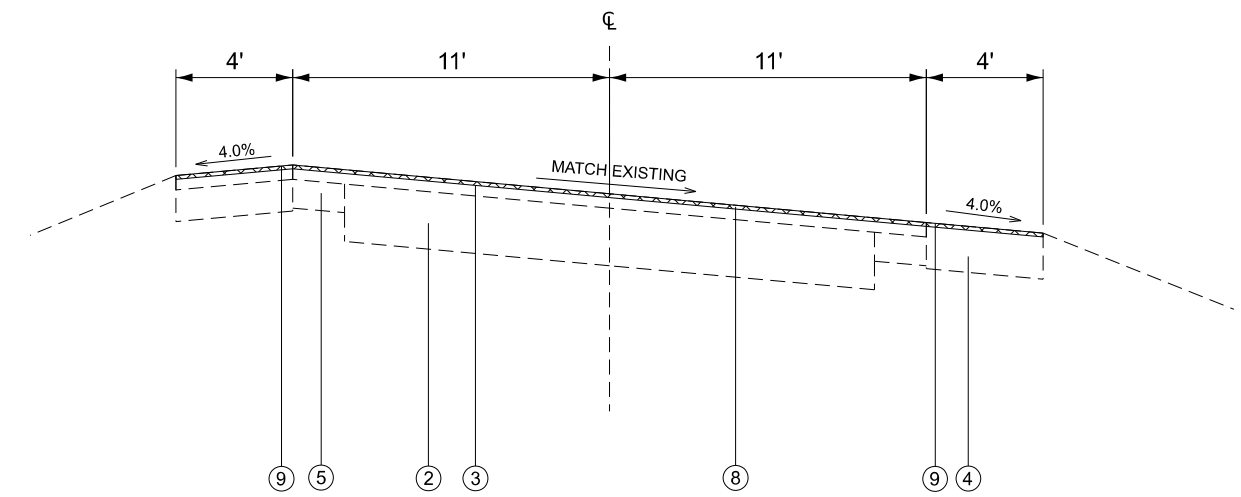

**IL ROUTE 3**  
 STA. 169+03 TO STA. 177+65

**LEGEND**

1. SUB-BASE GRANULAR MATERIAL
2. EXISTING PCC PAVEMENT 10"
3. EXISTING HMA SURFACE COURSE 2 1/2"
4. EXISTING HMA SHOULDER 8"
5. EXISTING PCC WIDENING
6. EXISTING STEEL PLATE BEAM GUARDRAIL TYP A, 6' POST
7. EXISTING SHOULDER RUMBLE STRIPS 8"
8. PROPOSED ULTRA-THIN BONDED WEARING COURSE
9. PROPOSED SHOULDER RUMBLE STRIPS 8"

= HMA SURFACE REMOVAL 3/4"

MODEL: Typical 8 (Sheet)  
 FILE NAME: c:\p\work\pwr\robert.hughes@illinois.gov\d0933007\0876160-sh1-typical.dgn

USER NAME = Robert, Hughes	DESIGNED -	REVISED -
	DRAWN -	REVISED -
PLOT SCALE = 0.16666633' / in.	CHECKED -	REVISED -
PLOT DATE = 1/23/2024	DATE -	REVISED -

**STATE OF ILLINOIS  
 DEPARTMENT OF TRANSPORTATION**

**PROPOSED TYPICAL SECTIONS**

SCALE: SHEET 4 OF 4 SHEETS STA. TO STA.

F.A.P. RTE.	SECTION	COUNTY	TOTAL SHEETS	SHEET NO.
312	(74-1,75,75-1)RS-4	RANDOLPH	15	11
CONTRACT NO. 76T60				
ILLINOIS FED. AID PROJECT				

RESURFACING SCHEDULE									
STA.	TO	STA.	WIDTH (FT)	LENGTH (FT)	HOT MIX ASPHALT REMOVAL 3/4" (SQ YD)	ULTRA-THIN BONDED WEARING COURSE, IL-9.5 UTB, MIX "E"		RAPID SETTING POLYMER MODIFIED EMULSION (LB)	SHOULDER RUMBLE STRIPS, 8"
						MAIN LINE (SQ YD)	SHOULDERS (SQ YD)		SHOULDERS (FT)
61+00	TO	74+46	11	1346	4487	3290	1196	5653	2692
74+46	TO	77+72	11	326	1087	797	290	1369	652
77+72	TO	79+82	11	210	700	513	187	882	420
79+82	TO	113+03	11	3321	11070	8118	2952	13948	6642
113+03	TO	124+70	11	1167	3890	2853	1037	4901	2334
124+70	TO	132+46	11	776	2587	1897	690	3259	1552
132+46	TO	156+13	11	2367	7890	5786	2104	9941	4734
156+13	TO	164+92	11	879	2930	2149	781	3692	1758
164+92	TO	169+03	11	411	1370	1005	365	1726	822
169+03	TO	177+65	11	862	2873	2107	766	3620	1724
177+65	TO	189+43	11	1178	3927	2880	1047	4948	2356
189+43	TO	200+32	11	1089	3630	2662	968	4574	2178
200+32	TO	224+07	11	2375	7917	5806	2111	9975	4750
224+07	TO	237+93	11	1386	4620	3388	1232	5821	2772
237+93	TO	253+09	11	1516	5053	3706	1348	6367	3032
253+09	TO	259+39	11	630	2100	1540	560	2646	1260
259+39	TO	273+86	11	1447	4823	3537	1286	6077	2894
273+86	TO	279+45	11	559	1863	1366	497	2348	1118
279+45	TO	287+54	11	809	2697	1978	719	3398	1618
287+54	TO	295+61	11	807	2690	1973	717	3389	1614
295+61	TO	317+98	11	2237	7457	5468	1988	9395	4474
317+98	TO	329+39	12	1141	4057	3043	1014	5112	2282
329+39	TO	362+53	12	3314	11783	8837	2946	14847	6628
362+53	TO	367+71	11	518	1727	1266	460	2176	1036
367+71	TO	394+65	12	2694	9579	7184	2395	12069	5388
394+65	TO	411+08	11	1643	5477	4016	1460	6901	3286
411+08	TO	423+17	12	1209	4299	3224	1075	5416	2418
423+17	TO	443+02	11	1985	6617	4852	1764	8337	3970
443+02	TO	472+87	11	2985	9950	7297	2653	12537	5970
472+87	TO	481+03	11	816	2720	1995	725	3427	1632
MISC (5%):					7093	5227	1867	8938	4200
TOTAL:					148961	148961	178753	178753	84006

URBAN/RURAL SWITCH OCCURS AT STATION 130+94.12

MODEL: Unlited2 [Sheet]  
FILE NAME: c:\pw\work\pav\robert.hughes@illinois.gov\40933007\0876760-shr-schedule.dgn

USER NAME = Robert,Hughes	DESIGNED -	REVISED -
	DRAWN -	REVISED -
PLOT SCALE = 0.16666633' / in.	CHECKED -	REVISED -
PLOT DATE = 1/23/2024	DATE -	REVISED -

STATE OF ILLINOIS  
DEPARTMENT OF TRANSPORTATION

SCHEDULES			
SCALE:	SHEET 1	OF 2 SHEETS	STA. TO STA.

F.A.P. RTE.	SECTION	COUNTY	TOTAL SHEETS	SHEET NO.
312	(74-1,75,75-1)RS-4	RANDOLPH	15	12
CONTRACT NO. 76T60				
ILLINOIS FED. AID PROJECT				

PAVEMENT MARKING SCHEDULE									
STA.	TO	STA.	LENGTH (FT)	NO PASSING DIRECTION NB/SB	THERMOPLASTIC PAVEMENT MARKING - LINE 6"			RAISED REFLECTIVE PAVEMENT MARKER REMOVAL (EACH)	RAISED REFLECTIVE PAVEMENT MARKER AMBER (EACH)
					SOLID WHITE	SOLID YELLOW	SKIP DASH YELLOW		
					(FT)	(FT)	(FT)		
61+00	TO	481+03	42003	NB/SB	84006			525	525
EDGE LINE GAP DEDUCTIONS**					2734				
61+00	TO	84+57	2357	NB/SB		4714			
84+57	TO	93+95	938	SB		938	240		
93+95	TO	107+28	1333			1333	340		
107+28	TO	118+22	1094	NB		1094	280		
118+22	TO	132+62	1440	NB/SB		2880			
132+62	TO	147+00	1438	SB		1438	360		
147+00	TO	149+30	230			230	60		
149+30	TO	161+15	1185	NB		1185	300		
161+15	TO	173+73	1258	NB/SB		2516			
173+73	TO	185+00	1127	SB		1127	290		
185+00	TO	186+00	100			100	30		
186+00	TO	193+54	754	NB		754	190		
193+54	TO	200+87	733	SB		733	190		
200+87	TO	204+73	386	NB/SB		772			
204+73	TO	212+80	807	NB		807	210		
212+80	TO	213+41	61	NB/SB		122	20		
213+41	TO	219+46	605	SB		605	160		
219+46	TO	224+00	454	NB/SB		908			
224+00	TO	231+00	700	NB		700	180		
231+00	TO	232+00	100	NB/SB		200			
232+00	TO	240+00	800			800	200		
240+00	TO	242+72	272	NB/SB		544			
242+72	TO	248+00	528	NB		528	140		
248+00	TO	250+00	200			200	50		
250+00	TO	255+28	528	SB		528	140		
255+28	TO	259+28	400	NB/SB		800			
259+28	TO	267+00	772			772	200		
267+00	TO	272+87	587	NB/SB		1174			
272+87	TO	279+45	658	NB		658	170		
279+45	TO	287+54	809	SB		809	210		
287+54	TO	404+11	11657			11657	2920		
404+11	TO	412+62	851	NB		851	220		
412+62	TO	415+50	288			288	80		
415+50	TO	422+00	650	SB		650	170		
422+00	TO	423+17	117	SB		117	30		
423+17	TO	433+59	1042			1042	270		
433+59	TO	444+67	1108	NB		1108	280		
444+67	TO	451+51	684	NB/SB		1368			
451+51	TO	463+10	1159	SB		1159	290		
463+10	TO	481+03	1793			1793	450		
TOTAL:						139944		525	525

\*\* SEE EDGE LINE GAP DEDUCTIONS SCHEDULE FOR DETAILS  
URBAN/RURAL SWITCH OCCURS AT STATION 130+94.12

EDGE LINE GAP DEDUCTIONS	
STREET	GAP LENGTH (FT)
BODES LN	96
FERN VALLEY RD	48
LONGEST DR	64
PSYCHIATRIC	100
HILLVIEW DR (S)	100
FAIRWAY LN	100
HILLVIEW DR (N)	110
OLD RTE 3 (W)	90
OLD RTE 3 (E)	100
SHAWNEETOWN TRAIL	225
GUM SPRING LN	50
B RD (S)	75
BEARE GROVE RD	55
ROADSIDE PARK	140
B RD (N)	75
ELLIS BLVD	115
ROSE LN (S)	40
ROSE LN (N)	40
E FIRST	90
SEYMOUR LAKE RD	85
3RD ST	161
FLORENCE DR	55
BRANCH ST	200
VALLEY STREET	60
EGGEMEYER PLAZA	185
WAGON WHEEL DRIVE	60
BRIAN ST	65
ROOTS RD	150
TOTAL:	2734

SHORT TERM PAVEMENT MARKING SCHEDULE					
STA.	TO	STA.	LENGTH (FT)	SHORT TERM PAVEMENT MARKING	SHORT TERM PAVEMENT MARKING REMOVAL (SQ FT)
				YELLOW STRIPES - 4'	
61+00	TO	481+03	42003	4200	1400
TOTAL:				4200	1400

MODEL: Unlited-1 [Sheet]  
FILE NAME: c:\p\work\pav\robert.hughes@illinois.gov\40933007\0876760-shr-schedule.dgn

USER NAME = Robert.Hughes	DESIGNED -	REVISED -
	DRAWN -	REVISED -
PLOT SCALE = 0.16666633' / in.	CHECKED -	REVISED -
PLOT DATE = 1/23/2024	DATE -	REVISED -

STATE OF ILLINOIS  
DEPARTMENT OF TRANSPORTATION

SCHEDULES

SCALE: NTS SHEET 2 OF 2 SHEETS STA. TO STA.

F.A.P. RTE.	SECTION	COUNTY	TOTAL SHEETS	SHEET NO.
312	(74-1,75,75-1)RS-4	RANDOLPH	15	13
CONTRACT NO. 76T60				
ILLINOIS FED. AID PROJECT				

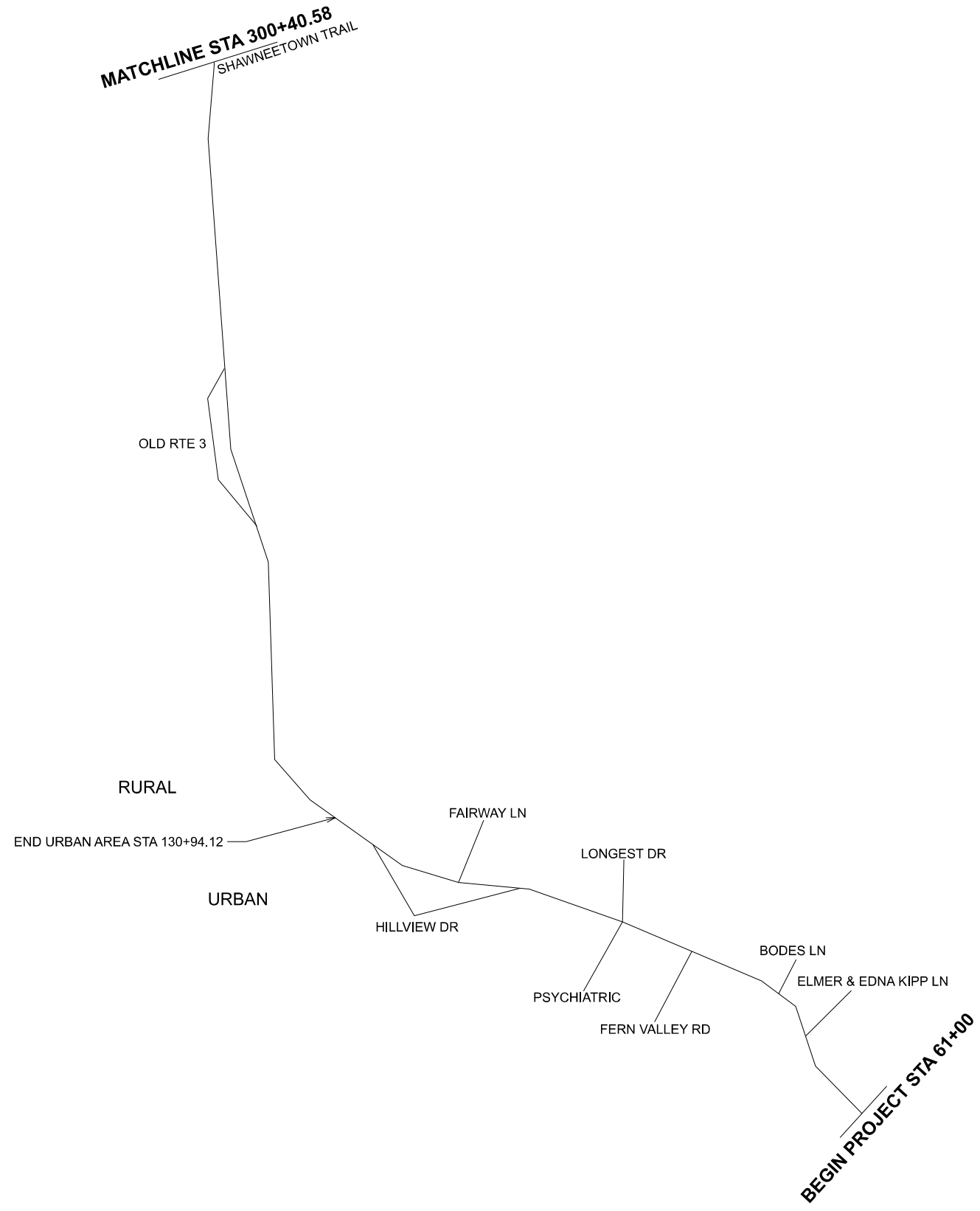

MODEL: I:\utils\1 [Sheet]  
 FILE NAME: c:\pw\work\pav\robert.hughes@illinois.gov\40933007\0876T60-sh-cv\plan.dgn

USER NAME = Robert,Hughes	DESIGNED -	REVISED -
	DRAWN -	REVISED -
PLOT SCALE = 0.16666633' / in.	CHECKED -	REVISED -
PLOT DATE = 1/23/2024	DATE -	REVISED -

**STATE OF ILLINOIS  
DEPARTMENT OF TRANSPORTATION**

**LOCATION MAP**

SCALE:      SHEET 1    OF 2    SHEETS    STA.            TO STA.

F.A.P RTE. 312	SECTION (74-1,75,75-1)RS-4	COUNTY RANDOLPH	TOTAL SHEETS 15	SHEET NO. 14
CONTRACT NO. 76T60				ILLINOIS   FED. AID PROJECT



END PROJECT STA 481+03

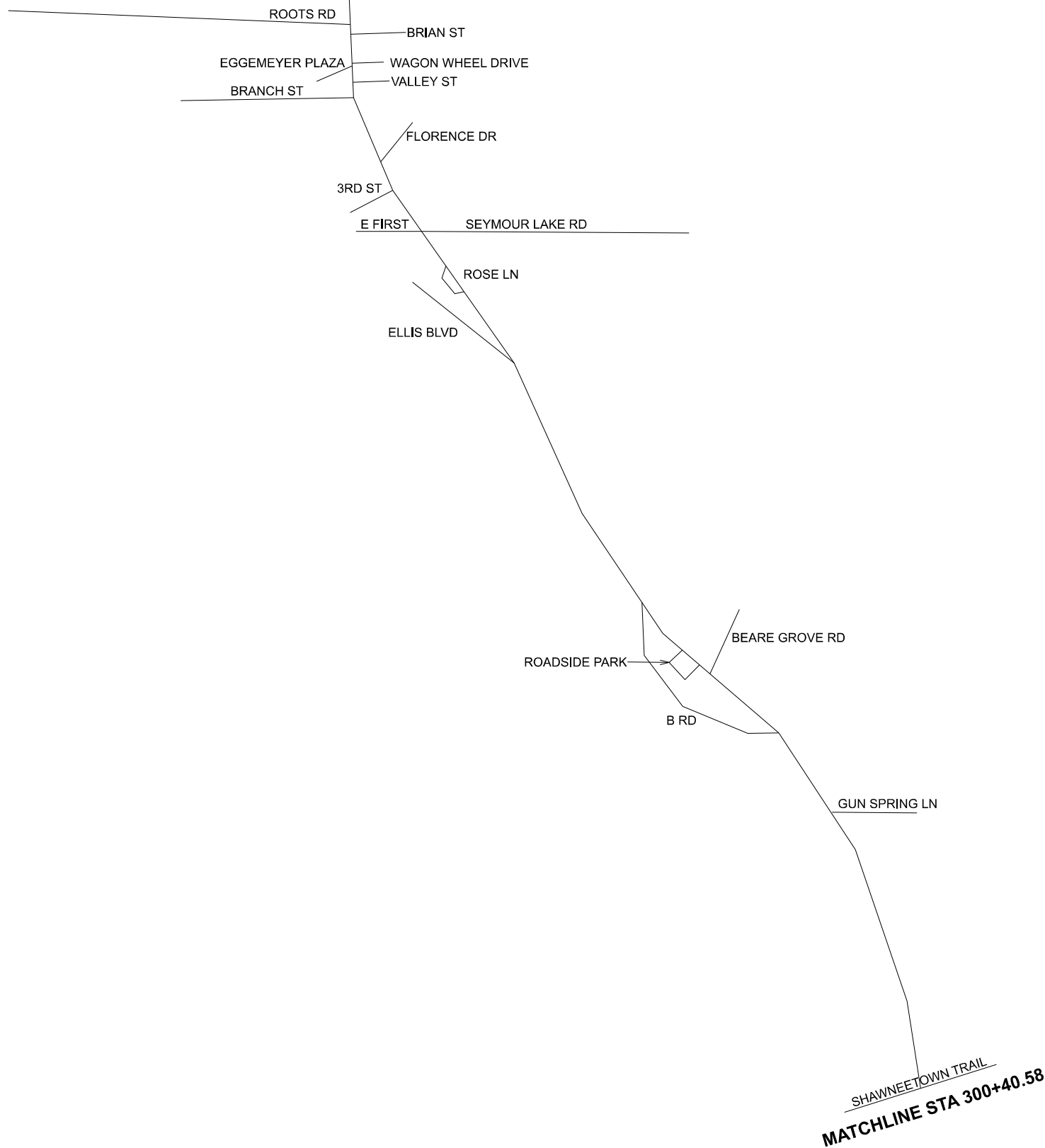

MODEL: I:\unfiled (Sheet)  
 FILE NAME: c:\p\work\pav\robert.hughes@illinois.gov\40933007\0876T60-sh-cv\plan.dgn

USER NAME = Robert,Hughes	DESIGNED -	REVISED -
	DRAWN -	REVISED -
PLOT SCALE = 0.16666633' / in.	CHECKED -	REVISED -
PLOT DATE = 1/22/2024	DATE -	REVISED -

**STATE OF ILLINOIS  
DEPARTMENT OF TRANSPORTATION**

**LOCATION MAP**

SCALE: SHEET 2 OF 2 SHEETS STA. TO STA.

F.A.P RTE.	SECTION	COUNTY	TOTAL SHEETS	SHEET NO.
312	(74-1,75,75-1)RS-4	RANDOLPH	15	15
CONTRACT NO. 76T60				
ILLINOIS FED. AID PROJECT				