

F.A. RTE.	SECTION	COUNTY	TOTAL SHEETS	SHEET NO.
..	..	...	9	1

For Index of Sheets, See Sheet 2

STATE OF ILLINOIS  
DEPARTMENT OF TRANSPORTATION  
DIVISION OF HIGHWAYS

**PROPOSED  
CONTRACT MAINTENANCE**

FAI ROUTE 39 (I-39) & FAP ROUTE 754 (IL 76)  
SECTION (201-2HB & 101BR)M  
WINNEBAGO & BOONE COUNTIES  
C-92-047-07 /D-92-044-07

- FAI Route 39 (I-39) & FAP Route 754 (IL 76)
- Section (201-2HB & 101BR)M
- Winnebago & Boone Counties



LOCATION #1  
STRUCTURE NO. 004-0016

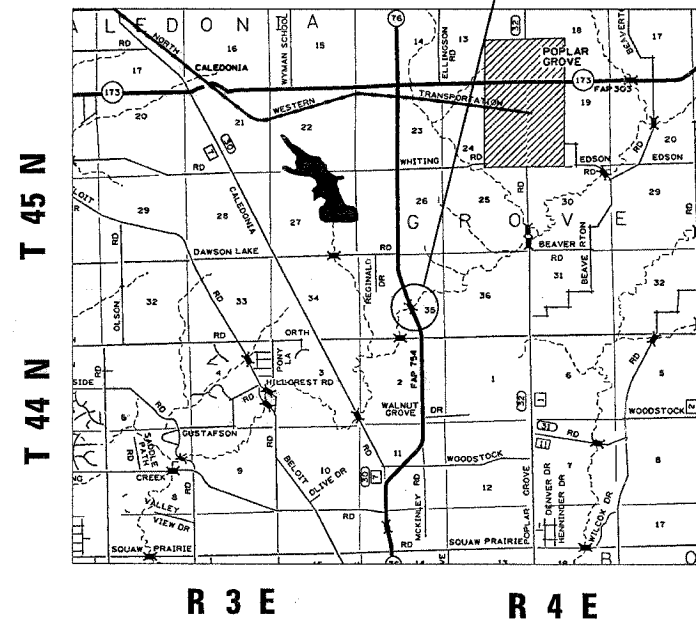

BOONE COUNTY

T 43 N

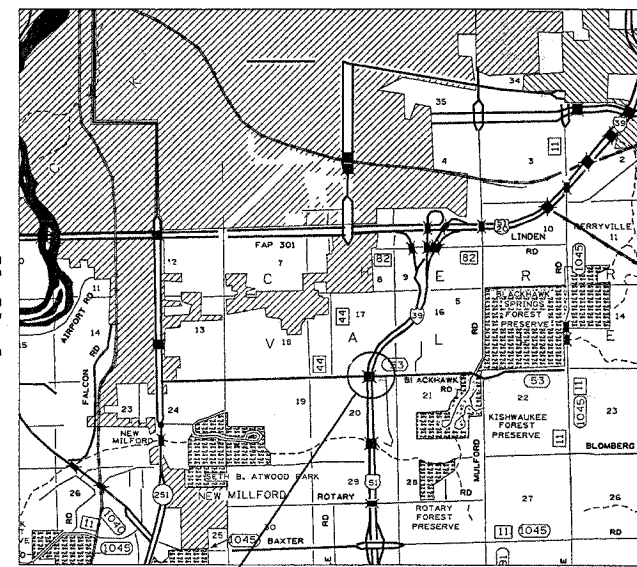

LOCATION #2  
STRUCTURE NO. 101-0143

R 2 E  
WINNEBAGO COUNTY

J.U.L.I.E.  
JOINT UTILITY LOCATION INFORMATION FOR EXCAVATION  
1-800-892-0123

CONTRACT NO. 64D04

Bridge Maintenance Engineer: Mahmoud Etemadi (815) 284-5393

STATE OF ILLINOIS  
DEPARTMENT OF TRANSPORTATION  
DIVISION OF HIGHWAYS

SUBMITTED January 31<sup>st</sup> 20 07

Joseph E. Cannon  
DEPUTY DIRECTOR OF HIGHWAYS, REGION ENGINEER

March 23, 20 07  
Eric E. Harnett  
INTERIM ENGINEER OF DESIGN AND ENVIRONMENT

March 23, 20 07  
Milton R. Sees, P.E.  
DIRECTOR OF HIGHWAYS/CHIEF ENGINEER

PRINTED BY THE AUTHORITY  
OF THE STATE OF ILLINOIS