

SECTION	COUNTY	TOTAL SHEETS	SHEET NO.
94-F3000-05-BT	COOK	102	34
STA. TO STA.			
IDOT PROJECT NO. TE-D001(610)			
CENTENNIAL TRAIL			
CONTRACT NO. 83859			

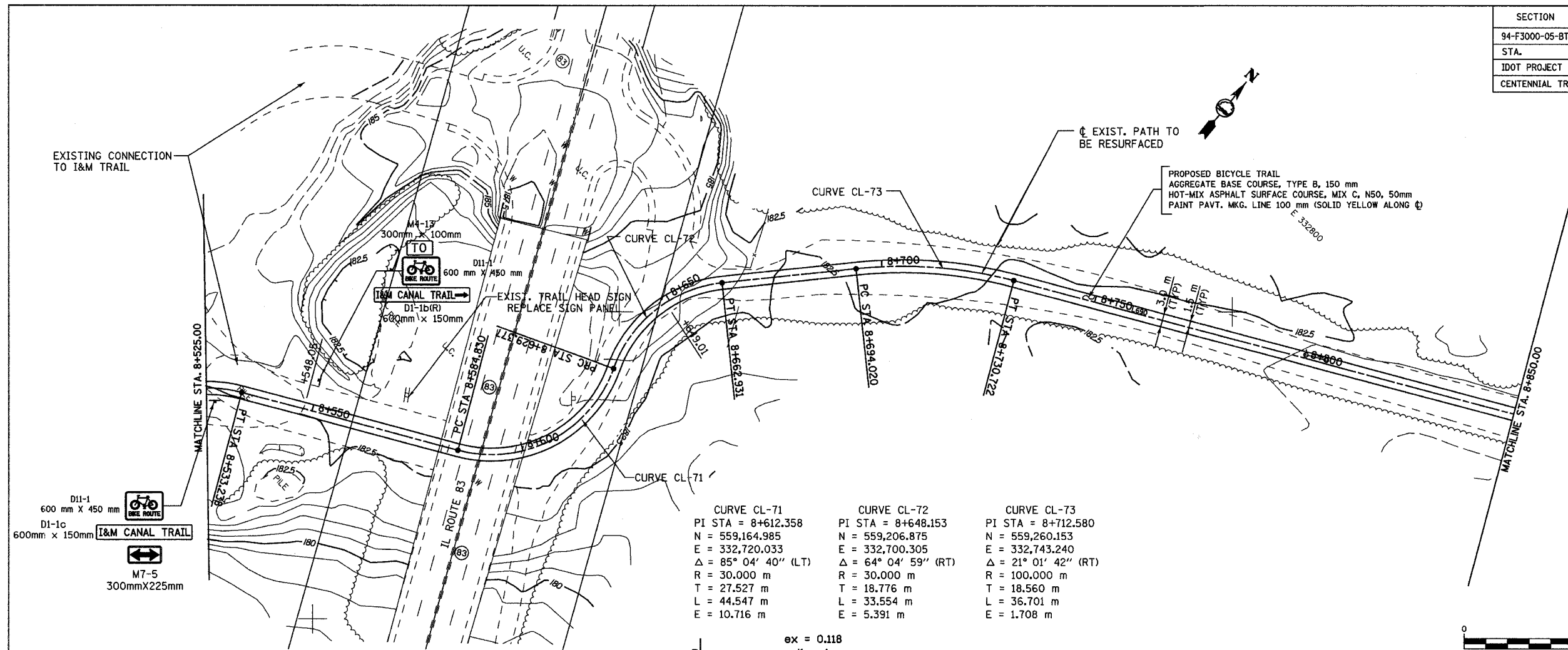

<b>CURVE CL-71</b>	<b>CURVE CL-72</b>	<b>CURVE CL-73</b>
PI STA = 8+612.358	PI STA = 8+648.153	PI STA = 8+712.580
N = 559,164.985	N = 559,206.875	N = 559,260.153
E = 332,720.033	E = 332,700.305	E = 332,743.240
Δ = 85° 04' 40" (LT)	Δ = 64° 04' 59" (RT)	Δ = 21° 01' 42" (RT)
R = 30.000 m	R = 30.000 m	R = 100.000 m
T = 27.527 m	T = 18.776 m	T = 18.560 m
L = 44.547 m	L = 33.554 m	L = 36.701 m
E = 10.716 m	E = 5.391 m	E = 1.708 m

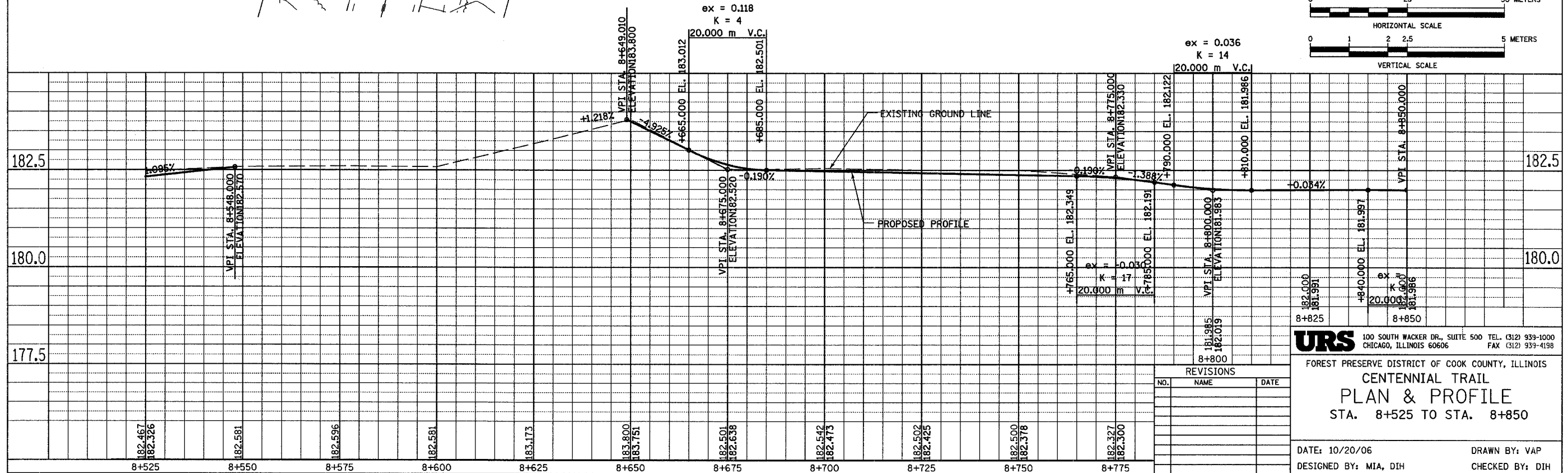
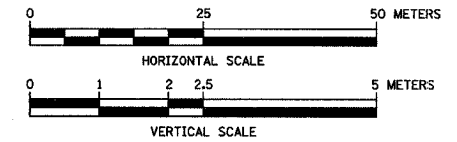

**URS** 100 SOUTH WACKER DR., SUITE 500 TEL. (312) 939-1000  
CHICAGO, ILLINOIS 60606 FAX (312) 939-4198

FOREST PRESERVE DISTRICT OF COOK COUNTY, ILLINOIS  
**CENTENNIAL TRAIL**  
**PLAN & PROFILE**  
STA. 8+525 TO STA. 8+850

DATE: 10/20/06 DRAWN BY: VAP  
DESIGNED BY: MIA, DIH CHECKED BY: DIH

REVISIONS		
NO.	NAME	DATE