

SECTION	COUNTY	TOTAL SHEETS	SHEET NO.
94-F3000-05-BT	COOK	102	50
STA. TO STA.			
IDOT PROJECT NO. TE-D001(610)			
CENTENNIAL TRAIL			
CONTRACT NO. 83859			

OLD WILLOW SPRINGS ROAD BRIDGE TO BE RECONSTRUCTED BY IDOT FOR PEDESTRIAN AND BICYCLE USE, THE COOK COUNTY FOREST PRESERVE DISTRICT WILL ASSUME MAINTENANCE AND JURISDICTION

CURVE CL-134  
 PI STA = 14+585.173  
 N = 562,629.480  
 E = 337,523.969  
 $\Delta = 13^\circ 32' 07''$  (LT)  
 R = 175.000 m  
 T = 20.767 m  
 L = 41.341 m  
 E = 1.228 m

CURVE CL-136  
 PI STA = 14+751.603  
 N = 562,750.380  
 E = 337,638.386  
 $\Delta = 89^\circ 07' 32''$  (LT)  
 R = 30.000 m  
 T = 29.546 m  
 L = 46.666 m  
 E = 12.106 m

PROPOSED BICYCLE TRAIL  
 AGGREGATE BASE COURSE, TYPE B, 150 mm  
 HOT-MIX ASPHALT SURFACE COURSE, MIX C, N50, 50mm  
 PAINT PAVT. MKG. LINE 100 mm (SOLID YELLOW ALONG  $\phi$ )

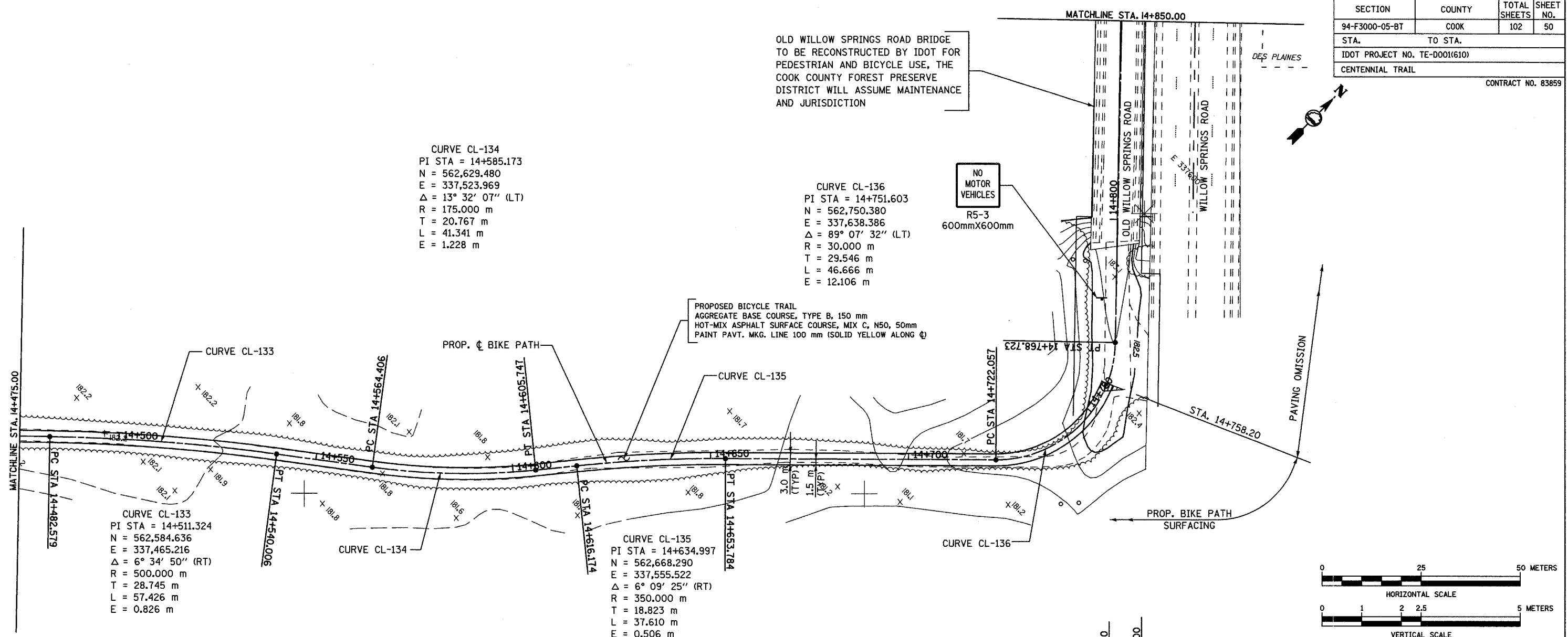

CURVE CL-133  
 PI STA = 14+511.324  
 N = 562,584.636  
 E = 337,465.216  
 $\Delta = 6^\circ 34' 50''$  (RT)  
 R = 500.000 m  
 T = 28.745 m  
 L = 57.426 m  
 E = 0.826 m

CURVE CL-135  
 PI STA = 14+634.997  
 N = 562,668.290  
 E = 337,555.522  
 $\Delta = 6^\circ 09' 25''$  (RT)  
 R = 350.000 m  
 T = 18.823 m  
 L = 37.610 m  
 E = 0.506 m

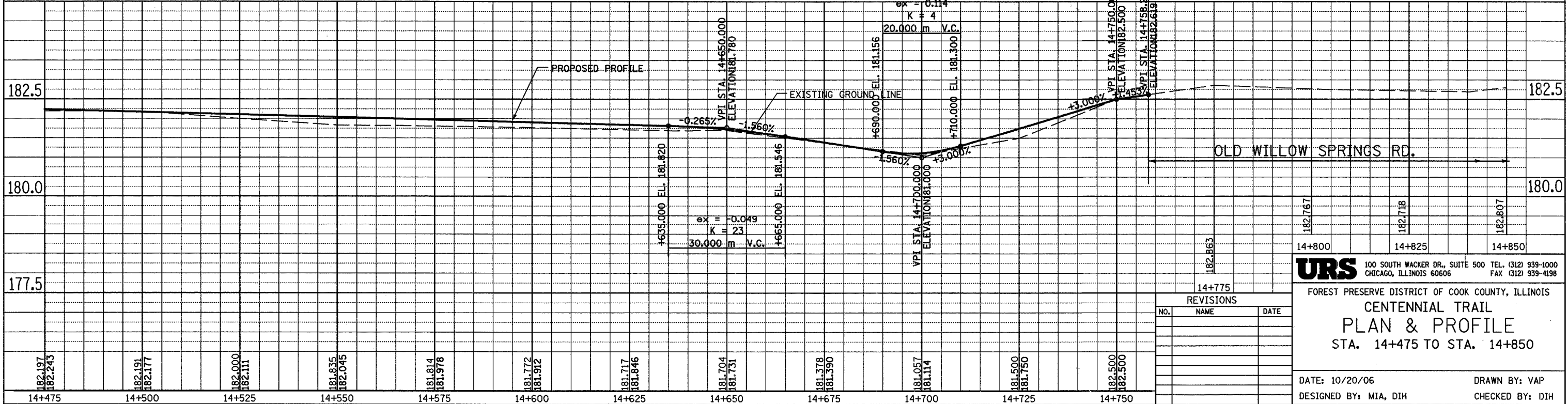
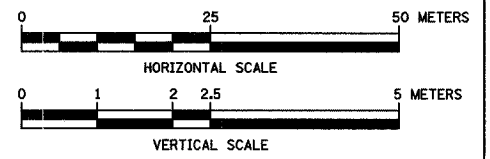

REVISIONS		
NO.	NAME	DATE

**URS** 100 SOUTH WACKER DR., SUITE 500 TEL. (312) 939-1000  
 CHICAGO, ILLINOIS 60606 FAX (312) 939-4198

FOREST PRESERVE DISTRICT OF COOK COUNTY, ILLINOIS  
**CENTENNIAL TRAIL**  
**PLAN & PROFILE**  
 STA. 14+475 TO STA. 14+850

DATE: 10/20/06 DRAWN BY: VAP  
 DESIGNED BY: MIA, DIH CHECKED BY: DIH